



Service Bulletin

American Honda Motor Co., Inc.

CBR1000 #10
Revised February 2024

SAFETY RECALL

2018-2019 CBR1000RR/RA/S1 Fuel Pump Replacement

BACKGROUND

Honda is launching a **SAFETY RECALL** on **CERTAIN** 2018-2019 CBR1000RR/RA/S1 motorcycles to replace the fuel pump assembly. Due to a manufacturing defect, the impeller inside the fuel pump can warp or swell when exposed to fuel causing the impeller to lock in place and prevent fuel flow to the engine. A locked impeller can cause the engine to stall without warning while riding, potentially increasing the risk of a crash or injury.

AFFECTED UNITS

As of February 9, 2024, **YOU MUST NOT SELL CERTAIN NEW or USED** 2018-2019 CBR1000RR/RA/S1 motorcycles until they are repaired according to this Service Bulletin.

- To search for applicable recalls on a specific unit, you **MUST** use *Unit Information* on **iN**.
- To manage your affected new inventory, use your dealer *eResponsibility Report* on **iN**.

CUSTOMER NOTIFICATION

American Honda intends to mail customer letters to all owners of affected 2018-2019 CBR1000RR/RA/S1 motorcycles in April 2024. Customers will be informed that their motorcycle is affected by a safety related defect and will be advised to make an appointment with an authorized Honda dealer for repair.

PARTS INFORMATION

Parts are currently unavailable. You will be notified at a later date when you can order parts.

Model	Description	Part Number	Qty.
2018-2019 CBR1000RR/RA/S1	Fuel Pump Kit	06160-MKF-306	1
Kit Includes:			
Description		Part Number	Qty.
Assembly, Fuel Pump Unit		16700-MKF-D42	1
Packing, Fuel Pump		17574-MFJ-D00	1
Seal, Outer		17576-MFJ-D00	1
Damper, Connector		16719-MFJ-D00	1
Retainer		17711-S0X-931	1

NEW

DEALER REPAIR RESPONSIBILITY

- Repairs must be performed by a qualified technician.
- Performing this repair exactly as shown in Repair Procedure instructions is critical for the remedy to be effective. Carefully follow all instructions.
- Service Management should inspect and confirm the repair.
- Dealer submission of a warranty claim affirms this repair was properly performed.

WARRANTY CLAIM INFORMATION

After completing this *Service Bulletin* update, submit one warranty claim per unit with the following template number.

MODEL	TEMPLATE	FLAT RATE
2018-2019 CBR1000RR/RA/S1	Replacement: KP9A	0.8

DEALER SUPPORT

TECHNICAL QUESTIONS

If you have any technical questions relating to this update procedure, please contact: Motorcycle TechLine Online:

iN > Service > TechLine > TechLine > TechLine Connect

Or call (800) 421-1900, option 9

WARRANTY QUESTIONS

If you have any warranty administration questions relating to warranty claim templates, and claim filing procedures, please contact:

Motorcycle Warranty Online:

iN > Service > Warranty & HondaCare > Warranty Connect Filing

Or call (800) 421-1900, option 7

FUEL PUMP REPLACEMENT

FUEL REMOVAL / REFILL

Remove as much fuel as possible from the fuel tank.

Drain the fuel into a clean container for refilling the tank after procedure is complete.

SEAT REMOVAL / INSTALLATION

1. Remove the socket screws [1] and washers [2].
2. Remove the main seat [3] by sliding it rearward.

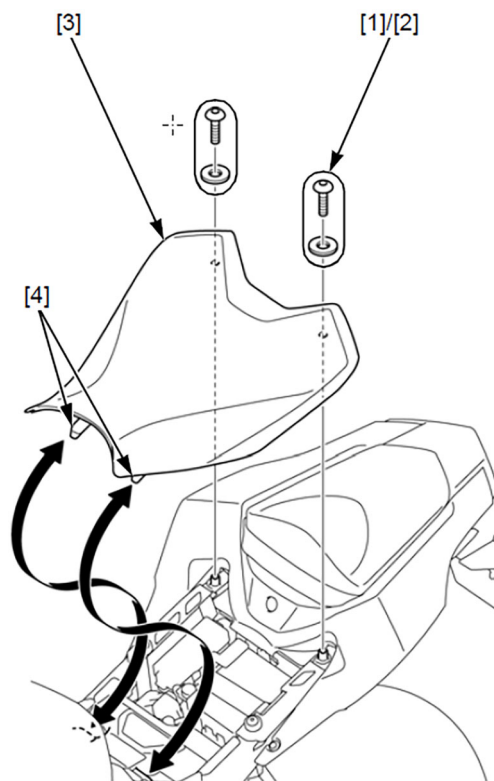

3. Install the seat by inserting the prongs [4] under the frame.
4. Install the washers and screws, and tighten the screws securely.

IMU COVER REMOVAL / INSTALLATION

Remove the socket screws [1] and IMU cover [2].

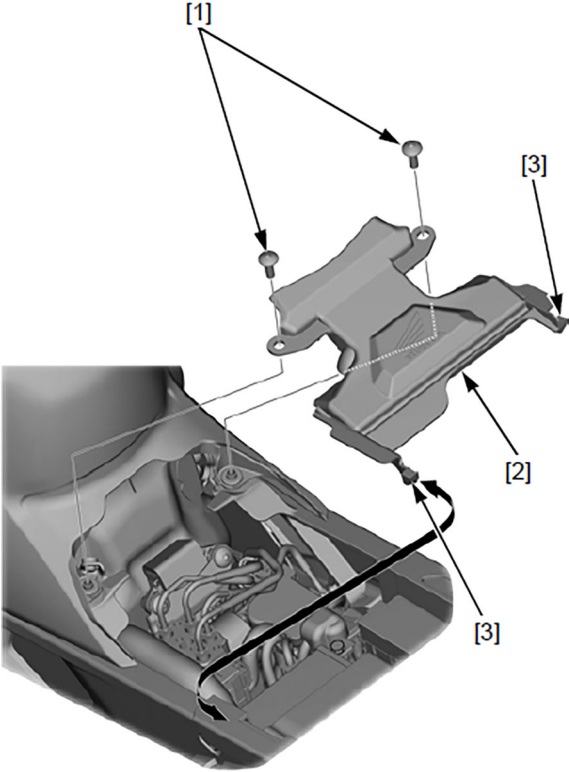

Installation is the reverse of removal.

NOTE:
Insert the tabs [3] under the rear fender B.

TOP SHELTER REMOVAL / INSTALLATION

Remove the socket screws [1] and top shelter [2].

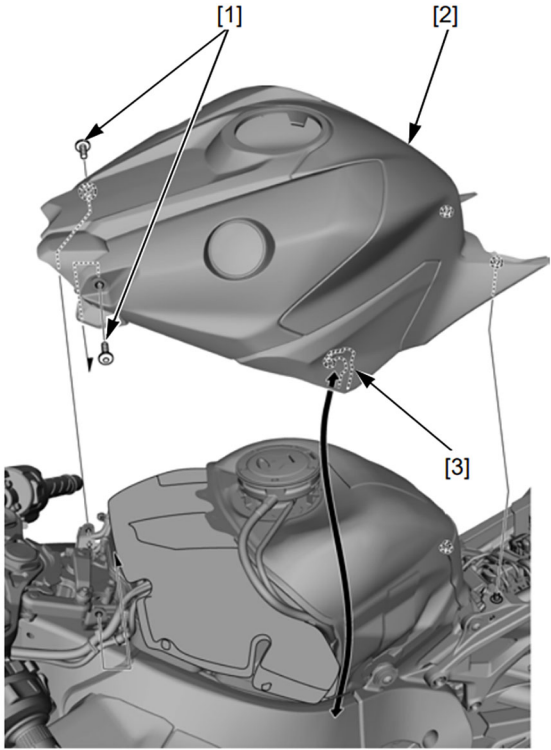

Installation is the reverse of removal.

NOTE:
Hook the retainers [3] onto the frame properly.

FUEL TANK LIFTING / LOWERING

- 1. Disconnect the fuel tank drain hose [1] from the fuel tank tray.
- 2. Disconnect the fuel tank-to-canister hose [2] from the breather joint.

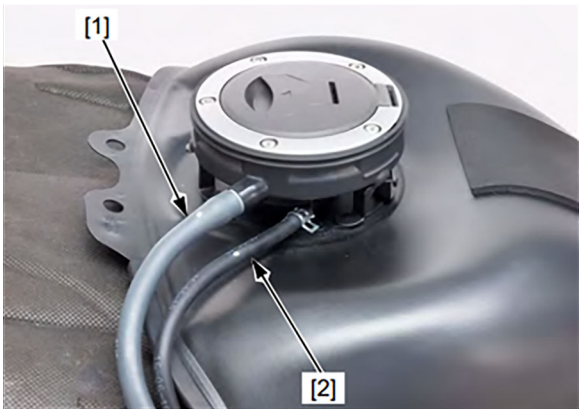

3. Remove the fuel tank mounting bolts/washers [3].

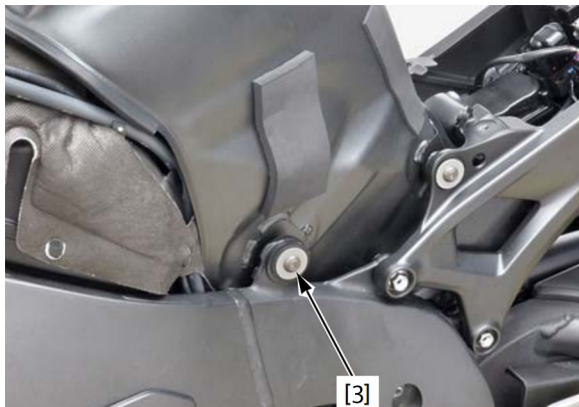

4. Lift the fuel tank front end and support the fuel tank by inserting a suitable support [4] under the tank as shown.

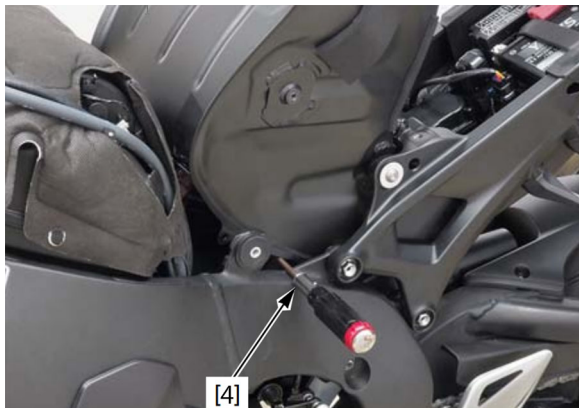

5. Remove the air cleaner cover [4].

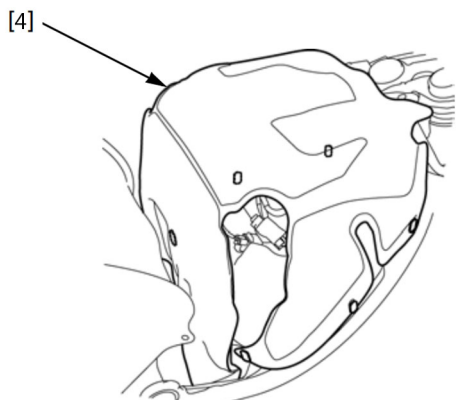

Installation is the reverse of removal.

TORQUE:

Fuel tank mounting bolt:
10 N·m (1.0 kgf·m, 88 in·lb)

FUEL PRESSURE RELIEVING

Before disconnecting the fuel hose, relieve any fuel pressure from the system as follows.

1. Turn the ignition switch OFF.



2. Lift and support the fuel tank.
3. Remove the quick connect fitting cover [2] (fuel pump side only).
4. Disconnect the fuel pump 2P (Brown) connector [3].
5. Start the engine and let it idle until the engine stalls.
6. Turn the ignition switch OFF.

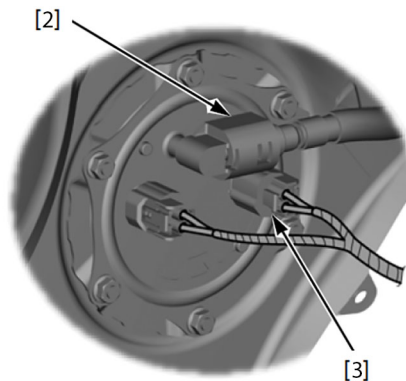

7. Disconnect the battery negative (-) cable [1] from the negative (-) battery terminal.

QUICK CONNECT FITTING REMOVAL

NOTES:

- Clean around the quick connect fitting before disconnecting the fuel feed hose, and be sure that no dirt is allowed to enter into the fuel system.
 - Do not bend or twist the fuel feed hose.
1. Check the fuel quick connect fitting for dirt, and clean if necessary.
Place a shop towel over the quick connect fitting.
 2. Pull and release the rubber damper [2] from the retainer.
 3. Hold the connector [3] with one hand and squeeze the retainer tabs [4] with the other hand to release them from the locking pawls [5]. Pull the connector off, then remove the rubber damper and retainer from the fuel joint.

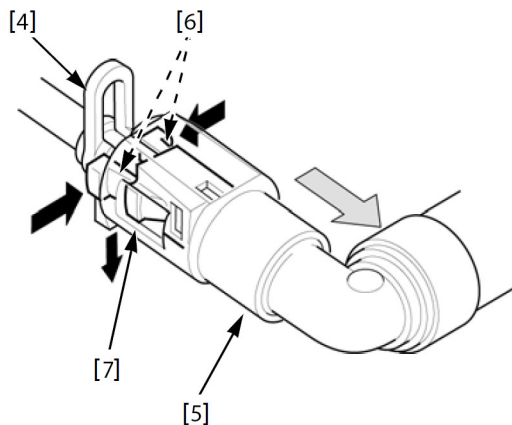

NOTES:

- Absorb the remaining fuel in the fuel hose from flowing out with a shop towel.
- Be careful not to damage the hose or other parts.
- Do not use tools.
- If the connector does not move, keep the retainer tabs pressed down, and alternately pull and push the connector until it comes off easily.

4. To prevent damage and keep foreign matter out, cover the disconnected connector and fuel joint with plastic bags [6].

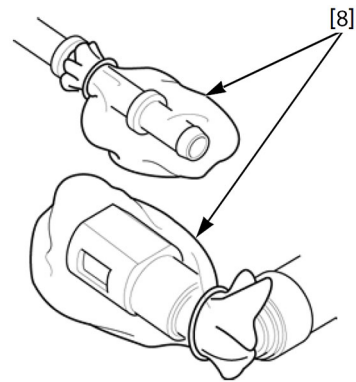

NOTE:

To prevent damage and keep foreign matter out, cover the disconnected connector and joint end with the plastic bags.

FUEL TANK REMOVAL / INSTALLATION

1. Disconnect the fuel reserve sensor 2P (Black) connector [1].
2. Remove the support, fuel tank pivot bolts [2], collars [3] and fuel tank [4].

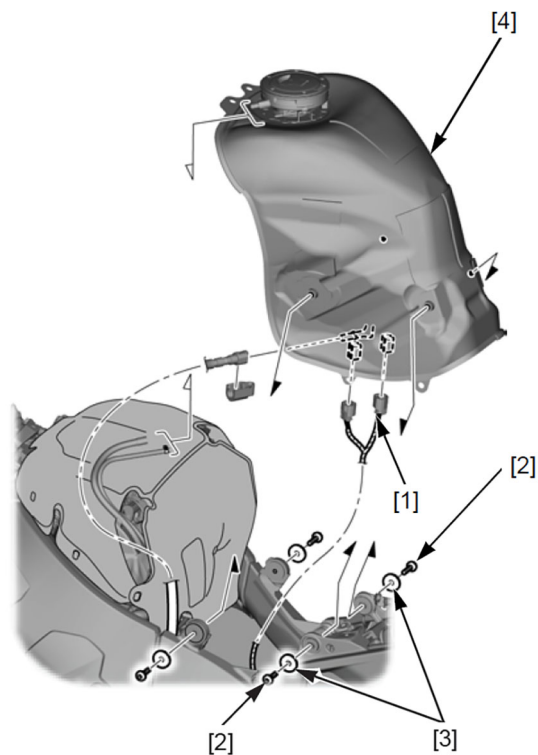

Installation is in the reverse order of removal.

FUEL PUMP UNIT REMOVAL / INSTALLATION

1. Remove the fuel pump unit mounting nuts [1] and setting plate [2].

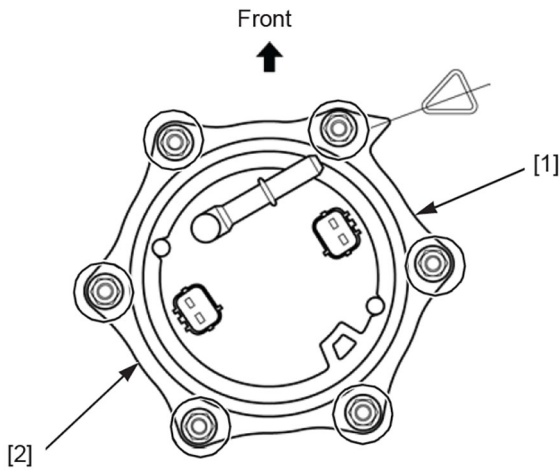

2. Remove the fuel pump unit [3] and packings [4].

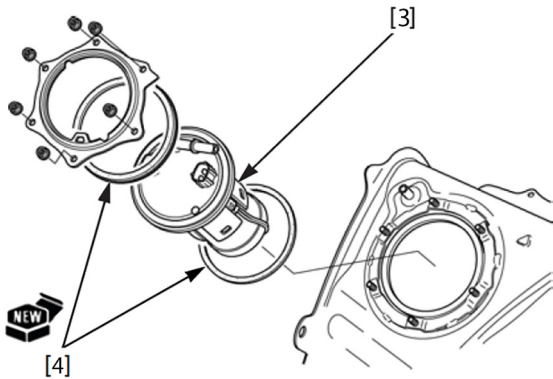

NOTE:

Be careful not to damage the pump wire.

Installation is the reverse order of removal.

NOTES:

- Place new packings [4] onto the fuel pump unit [3].
- Install the new fuel pump unit to the fuel tank.
- Be careful not to damage the pump wire.

- Install the setting plate [2] and tighten the fuel pump mounting nuts [1] to the specified torque in the specified sequence as shown.

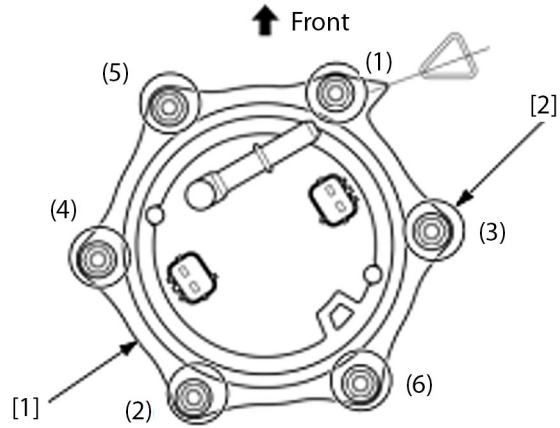

TORQUE:

12 N·m (1.2 kgf·m, 106 in·lb)

QUICK CONNECT FITTING INSTALLATION

NOTES:

- Always replace the retainer of the quick connect fitting when the fuel hose is disconnected.
- If the rubber damper is damaged or cut, replace it with a new one.
- Do not bend or twist the fuel feed hose.
- If any retainer needs replacing, use the same manufacturer's retainer as the ones being removed (The various manufacturers feature different retainer specifications).

1. Insert a new retainer [1] into the connector [2].

NOTE:

Align the retainer locking pawls with the connector grooves.

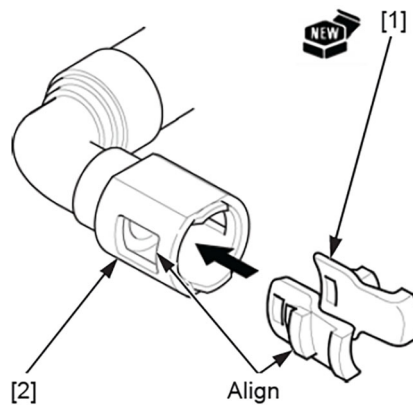

2. Install the rubber damper [3] and seat it onto the fuel joint [4] as shown. Align the quick connect fitting [5] with the fuel joint. Then press the quick connect fitting onto the pipe until both retainer pawls [6] lock with a "CLICK". If it is hard to connect, put a small amount of engine oil on the pipe end.

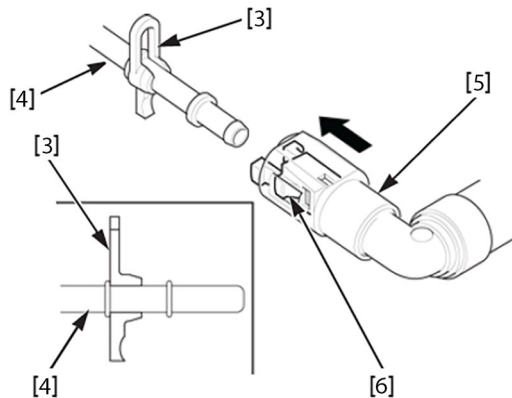

3. Make sure the connection is secure and that the pawls are firmly locked into place; check visually and by pulling the connector [7].
4. Make sure the rubber damper [8] is in place (between the flange [9] and retainer tab [10]).

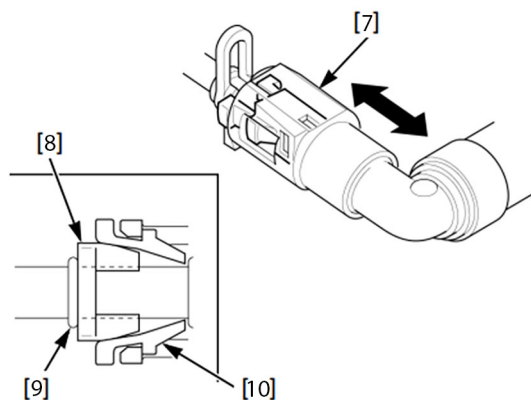

FUEL PRESSURE NORMALIZATION

1. Connect the fuel pump unit 2P (Brown) connector [1].

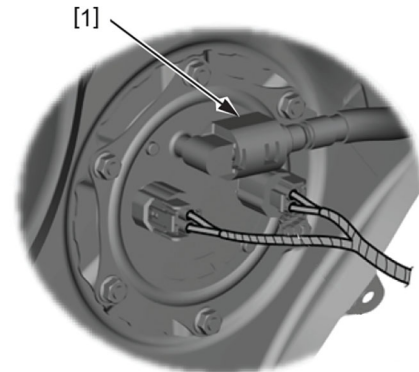

2. Install the quick connect fitting cover [2] (fuel pump side only).
3. Connect the battery negative (-) cable.
4. Turn the ignition switch ON and engine stop switch.

The fuel pump will run for about 2 seconds and fuel pressure will rise.

NOTE:

Do not start the engine.

5. Turn the ignition switch OFF.
6. Repeat two or three times, and check that there is no leakage in the fuel supply system.
7. Remove the support and close the fuel tank.
8. Adjust the clock on the meter if it reset.
9. For California registered vehicles, please fill out the Vehicle Emission Recall - Proof of Correction certificate (example shown on page 8) and provide it to the customer after the Safety Recall repair has been completed.

