



# Service Bulletin

American Honda Motor Co., Inc.

CBR1000 #10  
Revised May 2024

## SAFETY RECALL

### 2018-2019 CBR1000RR/RA/S1 Fuel Pump Replacement

#### BACKGROUND

Honda is launching a **SAFETY RECALL** on **CERTAIN** 2018-2019 CBR1000RR/RA/S1 motorcycles to replace the fuel pump assembly. Due to a manufacturing defect, the impeller inside the fuel pump can warp or swell when exposed to fuel causing the impeller to lock in place and prevent fuel flow to the engine. A locked impeller can cause the engine to stall without warning while riding, potentially increasing the risk of a crash or injury.

#### AFFECTED UNITS

As of February 9, 2024, **YOU MUST NOT SELL CERTAIN NEW or USED** 2018-2019 CBR1000RR/RA/S1 motorcycles until they are repaired according to this Service Bulletin.

- To search for applicable recalls on a specific unit, you **MUST** use *Unit Information* on **iN**.
- To manage your affected new inventory, use your dealer *eResponsibility Report* on **iN**.

#### CUSTOMER NOTIFICATION

American Honda has mailed customer letters to all owners of affected 2018-2019 CBR1000RR/RA/S1 motorcycles in April 2024. Customers were informed that their motorcycle is affected by a safety related defect and will be advised to make an appointment with an authorized Honda dealer for repair.

#### PARTS INFORMATION

Parts are currently available and must be ordered through the controlled parts process. Click the following link for instructions: [CONTROLLED PARTS ORDER PROCEDURE on page 9](#).

Model	Description	Part Number	Qty.
2018-2019 CBR1000RR/RA/S1	Fuel Pump Kit	06160-MKF-305	1
<b>Kit Includes:</b>			
	Description	Part Number	Qty.
	Assembly, Fuel Pump Unit	16700-MKF-D42	1
	Packing, Fuel Pump	17574-MFJ-D00	1
	Seal, Outer	17576-MFJ-D00	1
	Damper, Connector	16719-MFJ-D00	1
	Retainer	17711-S0X-931	1

**NEW**

#### DEALER REPAIR RESPONSIBILITY

- Repairs must be performed by a qualified technician.
- Performing this repair exactly as shown in Repair Procedure instructions is critical for the remedy to be effective. Carefully follow all instructions.
- Service Management should inspect and confirm the repair.
- Dealer submission of a warranty claim affirms this repair was properly performed.

**CUSTOMER INFORMATION:** The information in this bulletin is intended for use only by skilled technicians who have the proper tools, equipment, and training to correctly and safely maintain your Honda. These procedures should not be attempted by any other individuals and you should not assume this bulletin applies to your Honda, or that your Honda has the condition described. To determine whether this information applies, contact an authorized Honda dealer.

**WARRANTY CLAIM INFORMATION**

After completing this *Service Bulletin* update, submit one warranty claim per unit with the following template number.

MODEL	TEMPLATE	FLAT RATE
2018-2019 CBR1000RR/RA/S1	Replacement: KP9A	0.8

**Note:** All KP9A warranty template claims will reimburse freight. To ensure your dealership receives the freight credit, follow these steps.

1. Make sure 'YES' is selected from the *Freight Involved* drop down window.
2. Make sure to include the *Part Order Reference Number*.
3. Include the freight *Amount* associated with the listed *Part Order Reference Number*.
  - The *Part Order Reference Number* can be found on your *Parts Order Statement* on *iN*.

**NEW**

Template Warranty Claim

Template Number\*

Basic Claim Information (required for all claim types)

Claim No.\*  Repair Order Number\*

VIN\*  Repair Order Date (open)\*

Mileage\*  Work Completed Date\*

Sublet Involved?  NO

Freight Involved?  YES  NO  Freight Information

Part Order Reference Number\*  Amount\*

Submit Save View Claim CHANGE CLAIM TYPE

**DEALER SUPPORT**

**TECHNICAL QUESTIONS**

If you have any technical questions relating to this update procedure, please contact: Motorcycle TechLine Online:

***iN > Service > TechLine > TechLine > TechLine Connect***

Or call (800) 421-1900, option 9

**WARRANTY QUESTIONS**

If you have any warranty administration questions relating to warranty claim templates, and claim filing procedures, please contact:

Motorcycle Warranty Online:

***iN > Service > Warranty & HondaCare > Warranty Connect Filing***

Or call (800) 421-1900, option

**FUEL PUMP REPLACEMENT**

**FUEL REMOVAL / REFILL**

Remove as much fuel as possible from the fuel tank.

**Drain the fuel into a clean container for refilling the tank after procedure is complete.**

**SEAT REMOVAL / INSTALLATION**

1. Remove the socket screws [1] and washers [2].
2. Remove the main seat [3] by sliding it rearward.

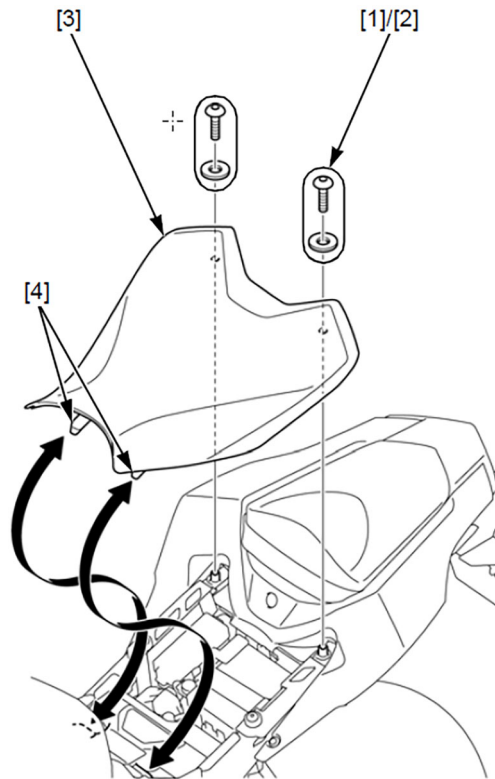

3. Install the seat by inserting the prongs [4] under the frame.
4. Install the washers and screws, and tighten the screws securely.

### IMU COVER REMOVAL / INSTALLATION

Remove the socket screws [1] and IMU cover [2].

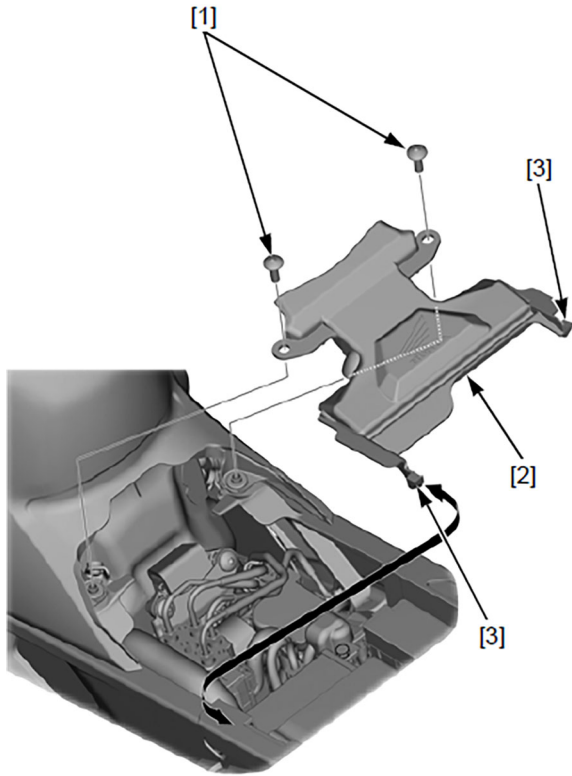

Installation is the reverse of removal.

**NOTE:**

Insert the tabs [3] under the rear fender B.

### TOP SHELTER REMOVAL / INSTALLATION

Remove the socket screws [1] and top shelter [2].

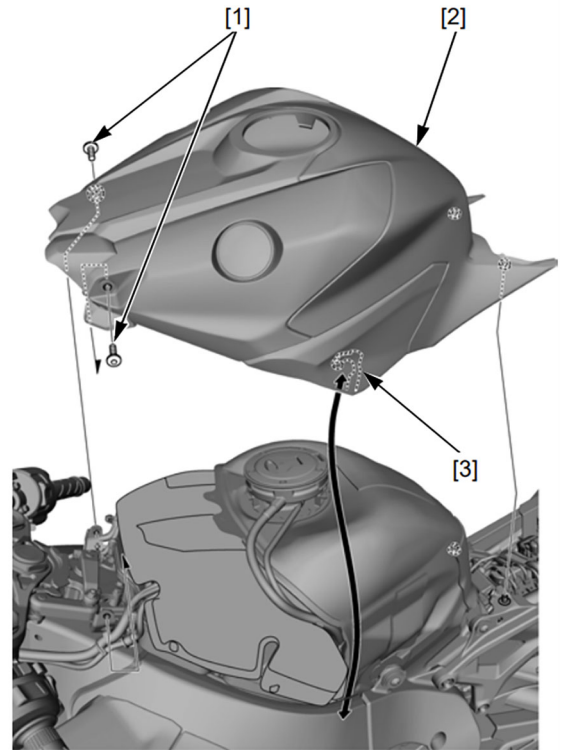

Installation is the reverse of removal.

**NOTE:**

Hook the retainers [3] onto the frame properly.

### FUEL TANK LIFTING / LOWERING

1. Disconnect the fuel tank drain hose [1] from the fuel tank tray.
2. Disconnect the fuel tank-to-canister hose [2] from the breather joint. Plug the fuel tank-to-canister hose to prevent fuel leakage when the tank is inverted

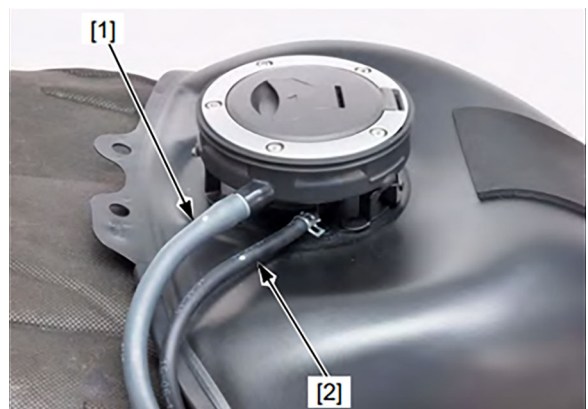

3. Remove the fuel tank mounting bolts/washers [3].

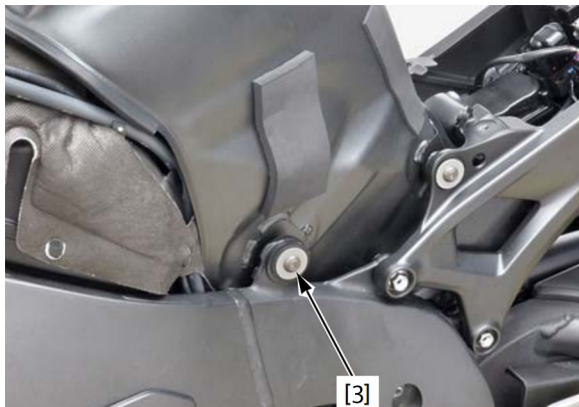

4. Lift the fuel tank front end and support the fuel tank by inserting a suitable support [4] under the tank as shown.

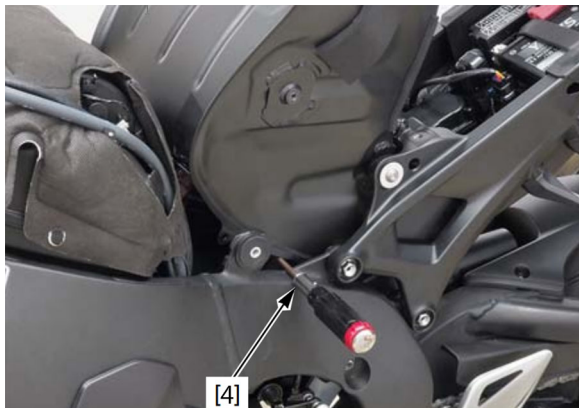

5. Remove the air cleaner cover [4].

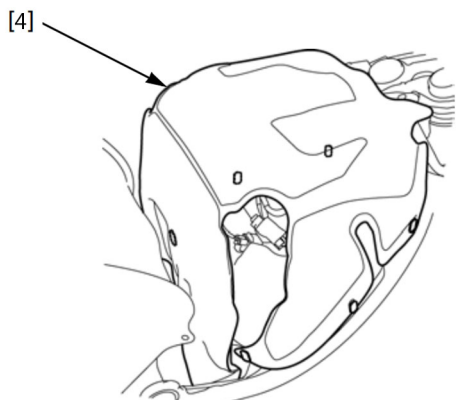

Installation is the reverse of removal.

**TORQUE:**

Fuel tank mounting bolt:  
10 N·m (1.0 kgf·m, 88 in·lb)

**FUEL PRESSURE RELIEVING**

Before disconnecting the fuel hose, relieve any fuel pressure from the system as follows.

1. Turn the ignition switch OFF.



2. Lift and support the fuel tank.  
3. Remove the quick connect fitting cover [2] (fuel pump side only).  
4. Disconnect the fuel pump 2P (Brown) connector [3].  
5. Start the engine and let it idle until the engine stalls.  
6. Turn the ignition switch OFF.

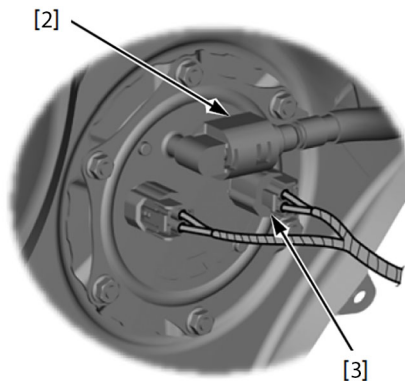

7. Disconnect the battery negative (-) cable [1] from the negative (-) battery terminal.

## QUICK CONNECT FITTING REMOVAL

### NOTES:

- Clean around the quick connect fitting before disconnecting the fuel feed hose, and be sure that no dirt is allowed to enter into the fuel system.
  - Do not bend or twist the fuel feed hose.
1. Check the fuel quick connect fitting for dirt, and clean if necessary.  
Place a shop towel over the quick connect fitting.
  2. Pull and release the rubber damper [2] from the retainer.
  3. Hold the connector [3] with one hand and squeeze the retainer tabs [4] with the other hand to release them from the locking pawls [5]. Pull the connector off, then remove the rubber damper and retainer from the fuel joint.

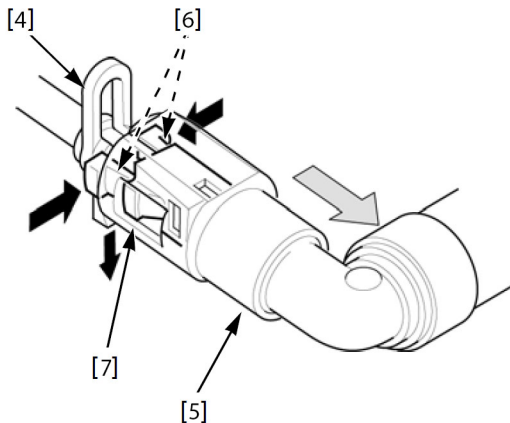

### NOTES:

- Absorb the remaining fuel in the fuel hose from flowing out with a shop towel.
- Be careful not to damage the hose or other parts.
- Do not use tools.
- If the connector does not move, keep the retainer tabs pressed down, and alternately pull and push the connector until it comes off easily.

4. To prevent damage and keep foreign matter out, cover the disconnected connector and fuel joint with plastic bags [6].

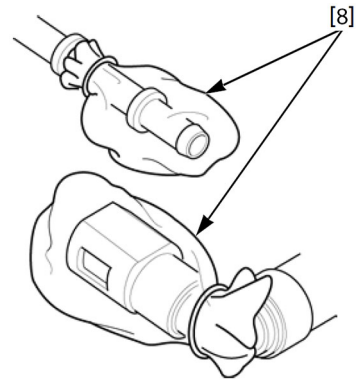

### NOTE:

To prevent damage and keep foreign matter out, cover the disconnected connector and joint end with the plastic bags.

## FUEL TANK REMOVAL / INSTALLATION

1. Disconnect the fuel reserve sensor 2P (Black) connector [1].
2. Remove the support, fuel tank pivot bolts [2], collars [3] and fuel tank [4].

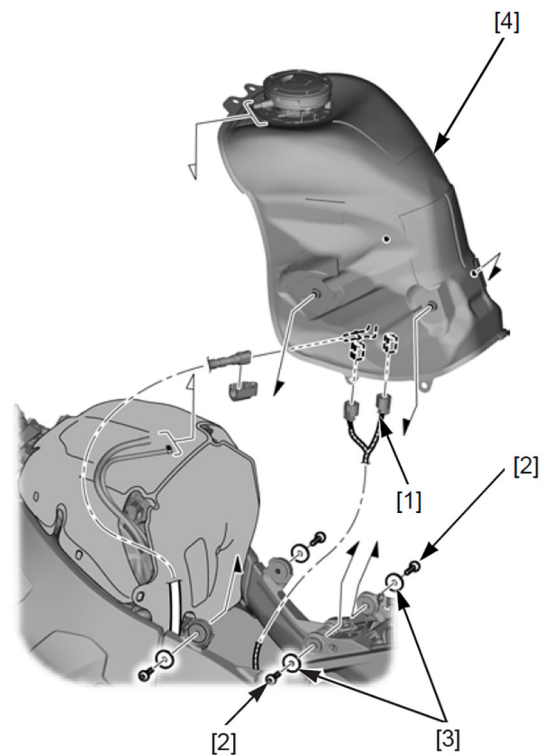

Installation is in the reverse order of removal.

## FUEL PUMP UNIT REMOVAL / INSTALLATION

1. Remove the fuel pump unit mounting nuts [1] and setting plate [2].

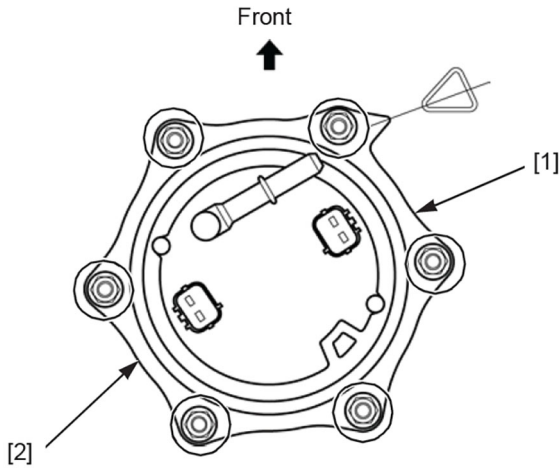

2. Remove the fuel pump unit [3] and packings [4].

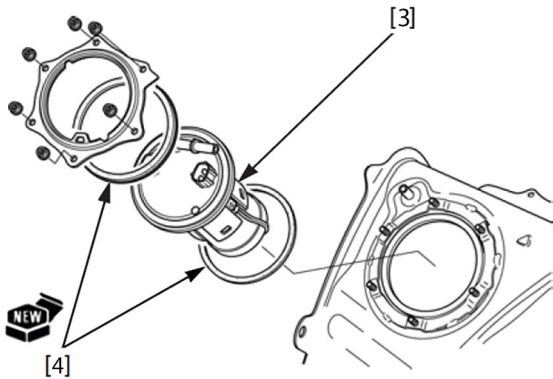

**NOTE:**

Be careful not to damage the pump wire.

Installation is the reverse order of removal.

**NOTES:**

- Place new packings [4] onto the fuel pump unit [3].
- Install the new fuel pump unit to the fuel tank.
- Be careful not to damage the pump wire.

- Install the setting plate [2] and tighten the fuel pump mounting nuts [1] to the specified torque in the specified sequence as shown.

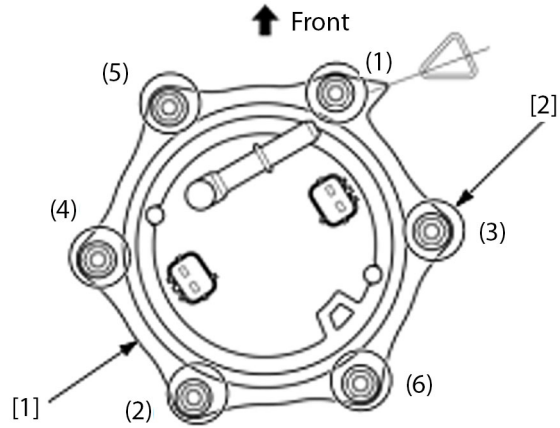

**TORQUE:**

12 N·m (1.2 kgf·m, 106 in·lb)

## QUICK CONNECT FITTING INSTALLATION

**NOTES:**

- Always replace the retainer of the quick connect fitting when the fuel hose is disconnected.
- If the rubber damper is damaged or cut, replace it with a new one.
- Do not bend or twist the fuel feed hose.
- If any retainer needs replacing, use the same manufacturer's retainer as the ones being removed (The various manufacturers feature different retainer specifications).

1. Insert a new retainer [1] into the connector [2].

**NOTE:**

Align the retainer locking pawls with the connector grooves.

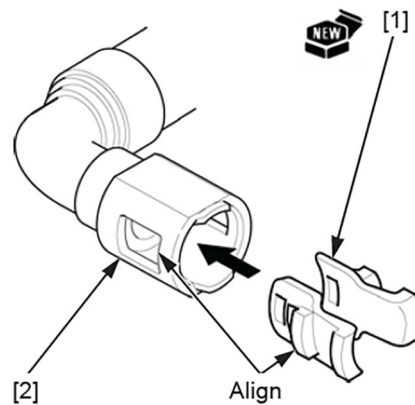

2. Install the rubber damper [3] and seat it onto the fuel joint [4] as shown. Align the quick connect fitting [5] with the fuel joint. Then press the quick connect fitting onto the pipe until both retainer pawls [6] lock with a "CLICK". If it is hard to connect, put a small amount of engine oil on the pipe end.

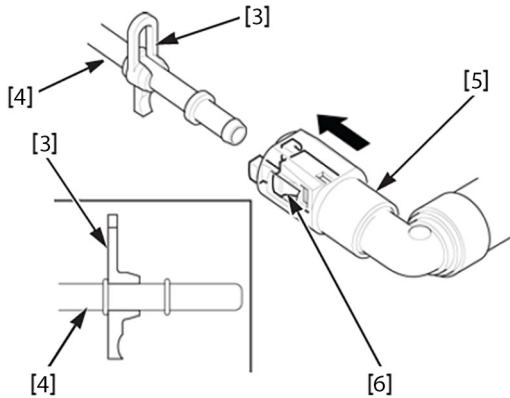

3. Make sure the connection is secure and that the pawls are firmly locked into place; check visually and by pulling the connector [7].
4. Make sure the rubber damper [8] is in place (between the flange [9] and retainer tab [10]).

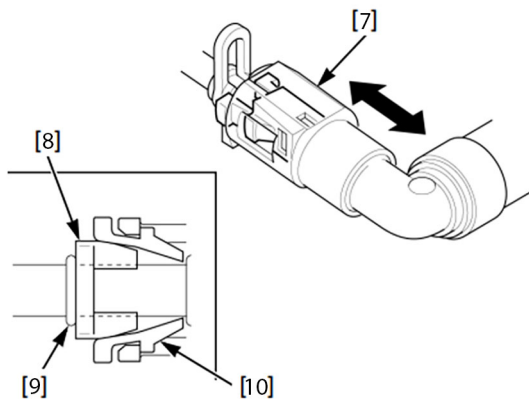

## FUEL PRESSURE NORMALIZATION

1. Connect the fuel pump unit 2P (Brown) connector [1].

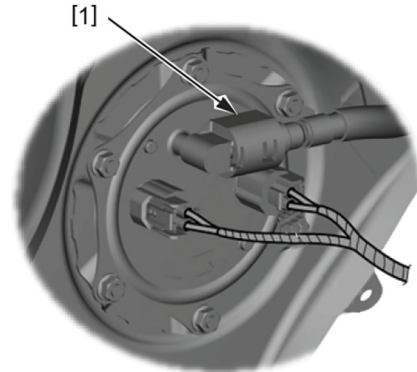

2. Install the quick connect fitting cover [2] (fuel pump side only).
3. Connect the battery negative (-) cable.
4. Turn the ignition switch ON and engine stop switch.

The fuel pump will run for about 2 seconds and fuel pressure will rise.

### NOTE:

Do not start the engine.

5. Turn the ignition switch OFF.
6. Repeat two or three times, and check that there is no leakage in the fuel supply system.
7. Remove the support and close the fuel tank.
8. Adjust the clock on the meter if it reset.
9. For California registered vehicles, please fill out the Vehicle Emission Recall - Proof of Correction certificate (example shown on page 8) and provide it to the customer after the Safety Recall repair has been completed.





## CONTROLLED PARTS ORDER PROCEDURE

To order parts through the Controlled Parts Order process, follow the steps below:

1. From the **IN** home page go to:

**Parts > Parts Order Management > Controlled Parts Order**

Select the desired shipping method from the **Ship Via** drop down list.

**NOTE:** The default *Ship Via* is 2ND DAY DELIVERY, which will incur additional freight charges to the dealer. Normal freight charges apply if the order does not meet the pre-paid freight minimum.

SALES SERVICE **PARTS** MANAGEMENT HONDAPRO TRAINING

Hide This Menu

- Acknowledgements
- Transactions
- Parts Bulletins
- Unit Information
- Web Parts Catalog
- Parts Order
- Parts Information
- Parts Order Management
  - Controlled Parts order**
  - Order Maintenance
  - Summary Inquiry

• = Required

### Controlled Parts Order

**Dealer Information**

Dealer No WMD03D Back Order\* YES  Ship Via\* 2- 2ND DAY DELIVERY

Reference\* D  Cross Shipment YES  Alt Ship Via\* 2- 2ND DAY DELIVERY   
3- SURFACE

Total Price \$0.00

**Customer Information**

VIN\*  Dealer Contact\*  Memo

LastName\*  FirstName\*

Comment  Vehicle in Collision\* YES

2. Enter the required information: *VIN, Dealer Contact, Customer Name, Part Number* and *Quantity* (you may order only one (1) part per part number).
3. Set *Vehicle in Collision* and *Specification Label Request* to **NO**.
4. Click Submit.

• = Required

### Controlled Parts Order

Dealer Information

Dealer No  Back Order\* YES  Ship Via\* 3- SURFACE

Reference\* D  Cross Shipment YES  Alt Ship Via\* 3- SURFACE

Total Price

Customer Information

VIN\* 3H1JK07  Dealer Contact\*  Memo KP1

LastName\*  FirstName\*

Comment KP1 CAMPAIGN  Vehicle in Collision\* NO

Specification Label Request\* NO

Submit  Save  Confirm  Search by PART NUMBER  Search

It.	Part*	Qty*	Description	Unit Price	
1	<input type="text" value="44830-KTE-D12"/>	<input type="text" value="1"/>	<input type="text" value="CABLE COMP, SPDMT"/>	<input type="text"/>	Delete
2	<input type="text"/>	<input type="text"/>	<input type="text"/>	<input type="text"/>	Delete