



# FIELD KIT

## Vermeer Corporation

Environmental  
Pella, Iowa 50219 USA

<b>FIELD CAMPAIGN KIT #:</b>	<b>IK004524</b>	<b>DATE:</b>	<b>22 August 2024</b>
<b>For Dealer Reference: Service Bulletin #: SVC2024-079</b>			

### Surge Brake Drawbar Replacement Kit

<b>CAMPAIGN TYPE:</b>	<b>Mandatory - Product Safety</b> <b>Dealer Installation Only</b>
<b>CAMPAIGN CATEGORY:</b>	<b>Kit and Bulletin</b>

MACHINE/ ATTACHMENT MODEL(S):	SERIAL NUMBERS:		
	Included	Excluded	Kit version
BC1800XL	6018, 6031, 6050, 6059, 6060, 6080, 6092, 6141, 6161, 6162, 6194, 6211, 6305, 7260, 8571, 10114, 10118, 10120, 10124, 10127, 10128, 10129, 10131, 10132, 10134, 10136, 10137, 10143, 50304, 50301, 50308, 50309, 50310, 50311, 50312, 50316, 52320, 52139, 52419	None	IK01



**Purpose:** Surge brake drawbar failure may occur. One or more cracks can develop in the surge brake drawbar which can result in severe damage to the brush chipper. If a crack develops and is not identified during the maintenance interval inspections, the drawbar can bend and/or break resulting in loss of stability while towing.

#### DEATH OR SERIOUS INJURY POSSIBLE

When towing the brush chipper on public roadways, death or serious injury may result due to the loss of control of the brush chipper and/or towing vehicle. A drawbar failure may increase the risk of a crash. Property or equipment damage may also occur.

## IMMEDIATE MACHINE MODIFICATIONS REQUIRED

IK004524 has been created to provide the necessary parts and instructions to replace affected drawbars. **The kit must be installed as soon as possible.** Please be reminded that it is a violation of federal law for you to sell or lease the machines covered by this notification until this recall has been performed on these machines. Substantial civil penalties apply to violations of this law.

### Special tools and conditions:

- None

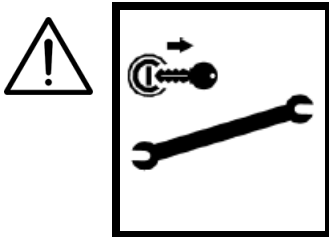

**WARNING:** Failure to use shutdown procedure can result in unexpected hazard(s). Death or serious injury could result due to entanglement, crushing, cutting, or other hazardous contact. Follow shutdown procedure after operating, before performing any service or maintenance, and before transporting.

### Shutdown procedure:

For your safety and the safety of others, use shutdown procedure before working on the machine for any reason, including servicing, cleaning, unclogging, inspecting, or transporting the chipper.

A variation of this procedure may be used if instructed within this kit, or if an emergency requires it.

1. Return *upper feed control bar* to stop position.
2. Set *throttle* to low idle using button on control panel.
3. Whenever practical and consistent with good safety practice, idle engine without load for three minutes before shutting it off. This allows engine temperatures to decrease and equalize, which will increase engine life.
4. Wait for cutter drum to slow.
5. Move *clutch lever* to disengaged position.
6. If equipped, shut off remote control if in use.
7. Shut off engine and remove key.
8. Wait for cutter drum and belt to stop.

Cutter drum rotation can be checked by looking at the end of the shaft (1) on the left side of the cutter drum housing. The cutter drum will continue to turn for a short time after the engine has stopped.

9. Close and latch feed table or leave open if needed for removing plugs or for performing maintenance or service.

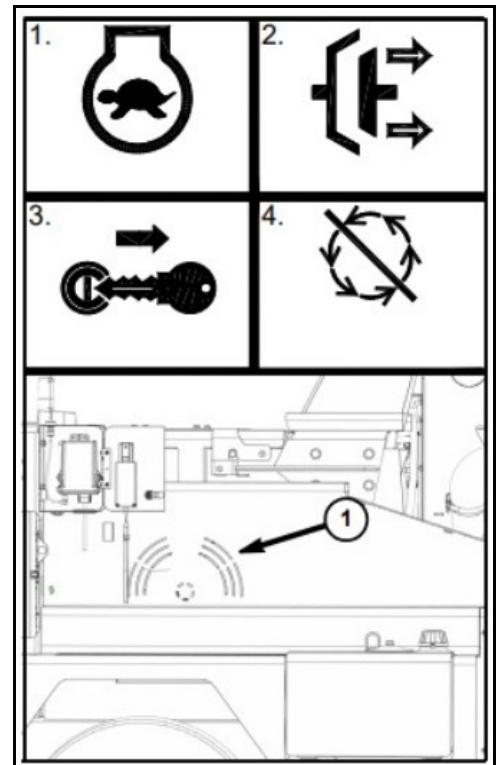

Unless indicated, new parts from kit have callouts with numbers. Callouts with letters indicate existing parts or general items.

**Procedure 1: Removal of Old Tongue**

1. Support machine with jack (A) on frame.

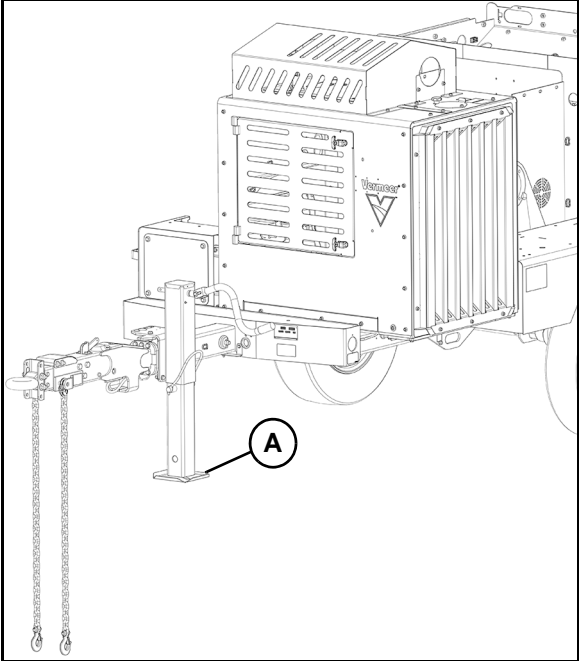

2. Disconnect hydraulic brake line (B) from tongue.

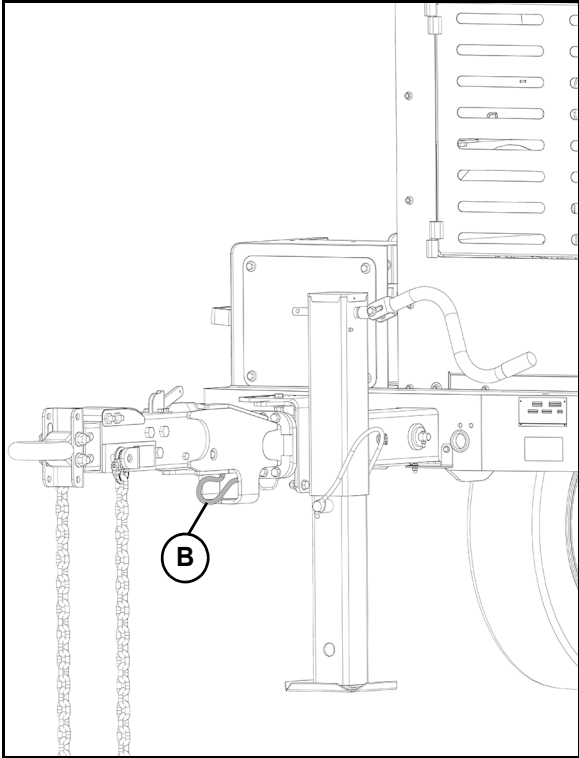

3. Remove and retain two screws (C) and two nuts (D) from two hitch pins (E).

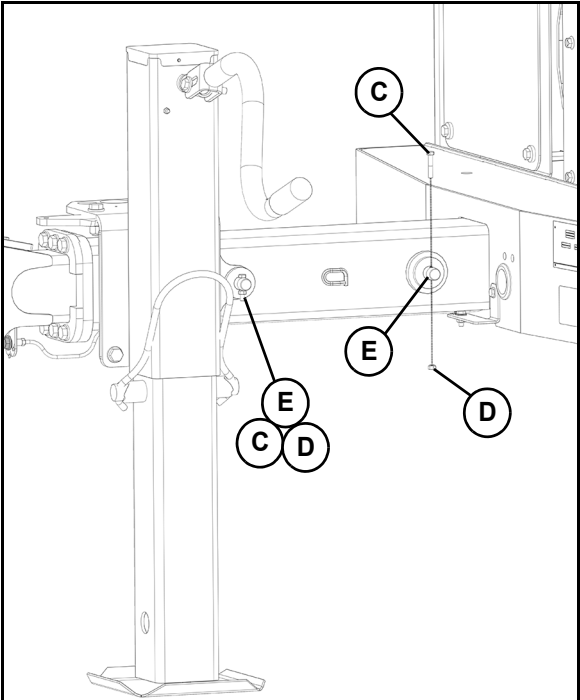

4. Remove and retain two hitch pins (E), four washers (F), and two washers (G) that hold tongue into frame.

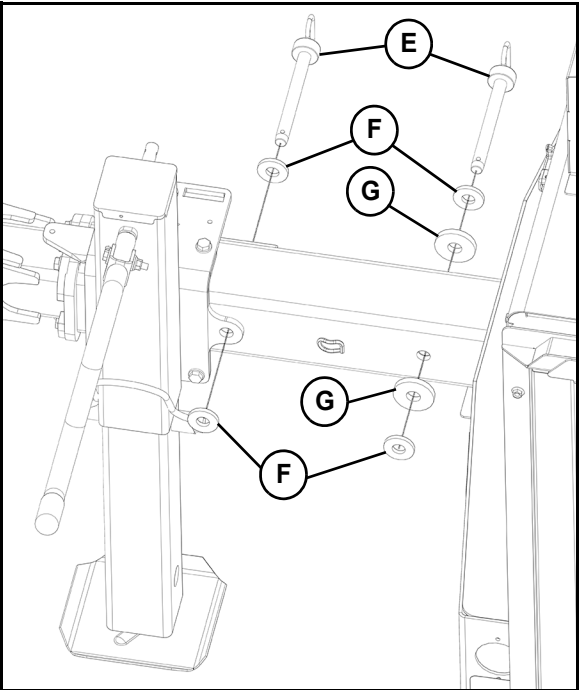

5. Remove and discard six screws (**H**), six washers (**I**), and two collar clamps (**J**) that attach tongue to frame.

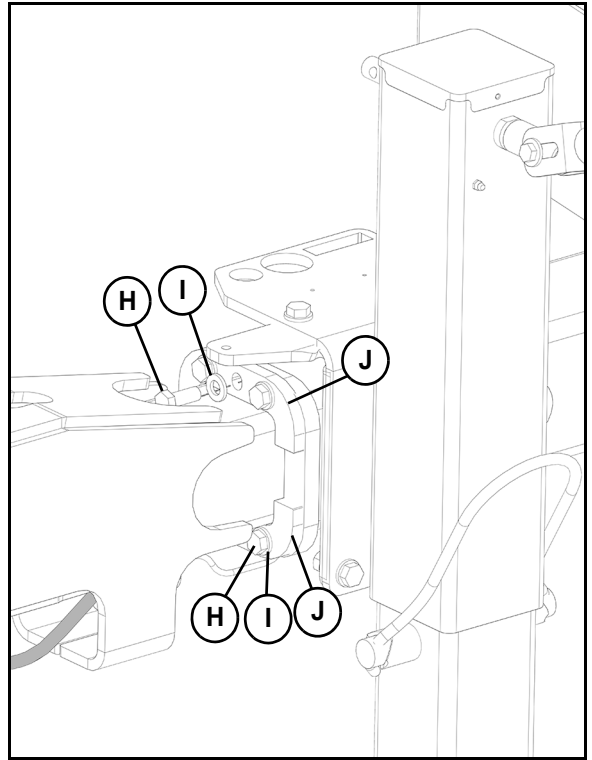

6. Attach a suitable lifting device to tongue assembly (**K**). Tongue assembly weighs approximately 200 lb (91 kg).
7. Remove and discard tongue assembly from frame of machine.

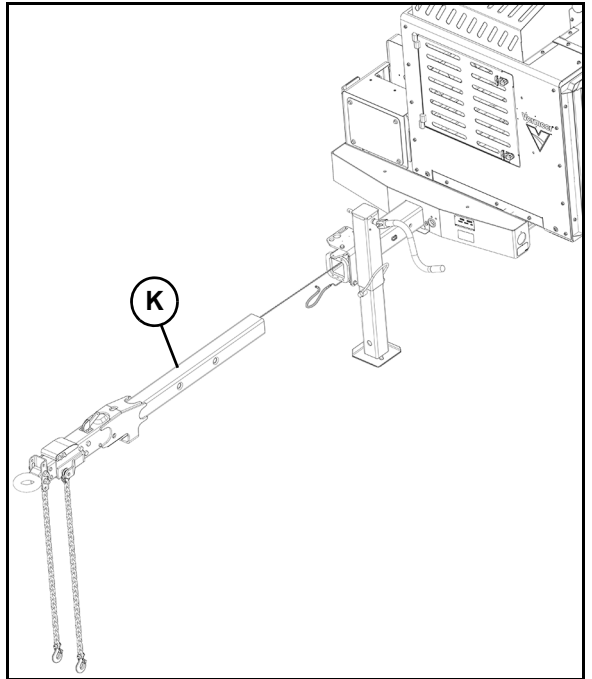

### Procedure 1: New Tongue Assembly

1. Support machine with jack (A) on frame.
2. Attach a suitable lifting device to new tongue weldment (1). Tongue weldment weighs approximately 165 lb (75 kg). Install new tongue weldment (1) into frame of machine.
3. Install two retained hitch pins (E), four washers (F), and two washers (G) through frame and new tongue weldment (1).

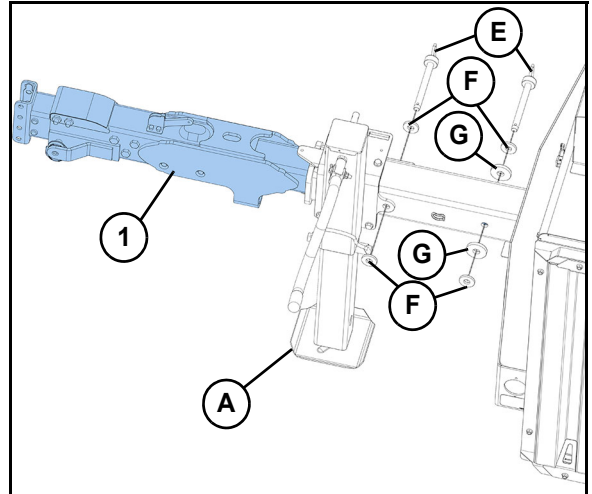

4. Secure two hitch pins (E) using two retained screws (C) and two nuts (D).

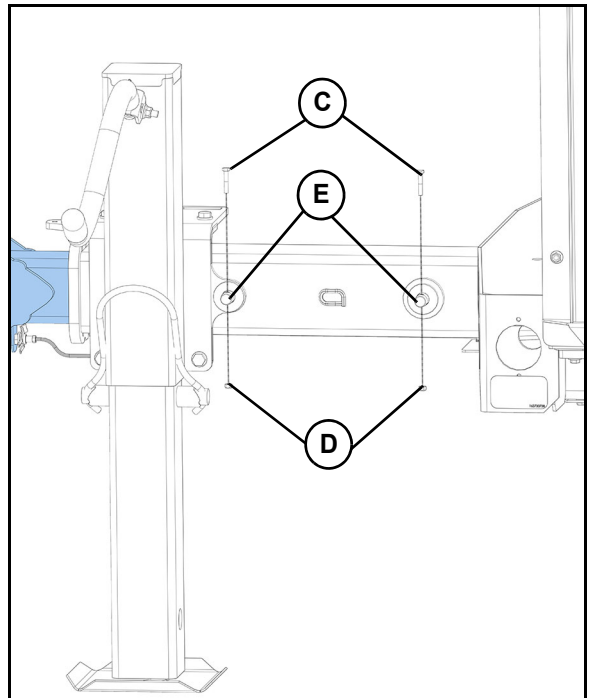

5. Install new tongue on frame using two collar clamps (2), six screws (3), and six washers (4). Torque screws to 70 ft-lb (95 Nm).

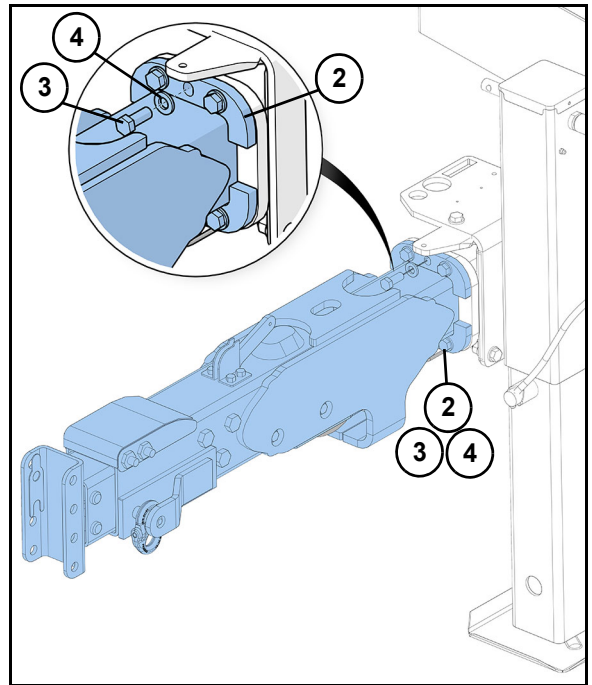

6. Install new pintle ring (5) in new tongue using two shims (6), two screws (7) and two nuts (8). Torque screws to 140 ft-lb (190 Nm).

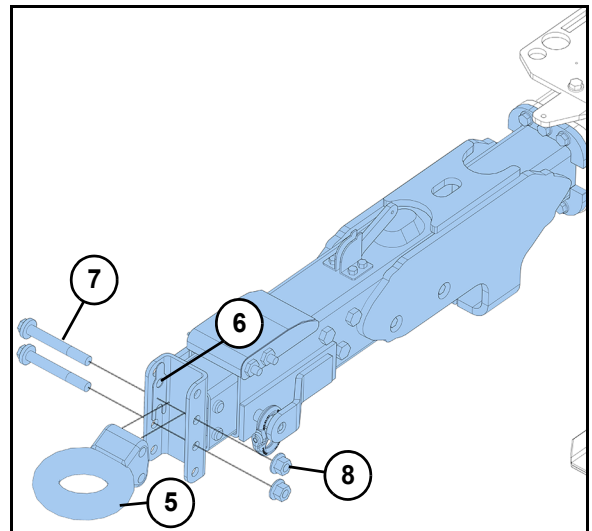

7. Remove and discard bolt and clevis pin (L) from two new safety chains (10).

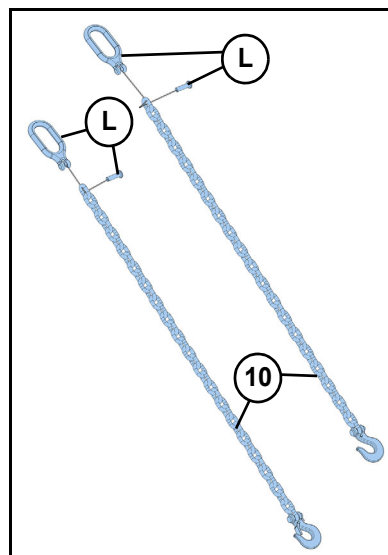

8. Disassemble each new hammerlock (9) by removing pin/bushing with a punch. Insert chain link end of safety chain (10) in one loop of hammerlock (9).

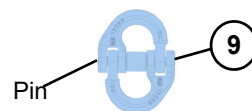

9. Place other loop of hammerlock (9) on safety chain bracket pin on frame.

10. Secure two hammerlock (9) ends together by reinserting pin/bushing.

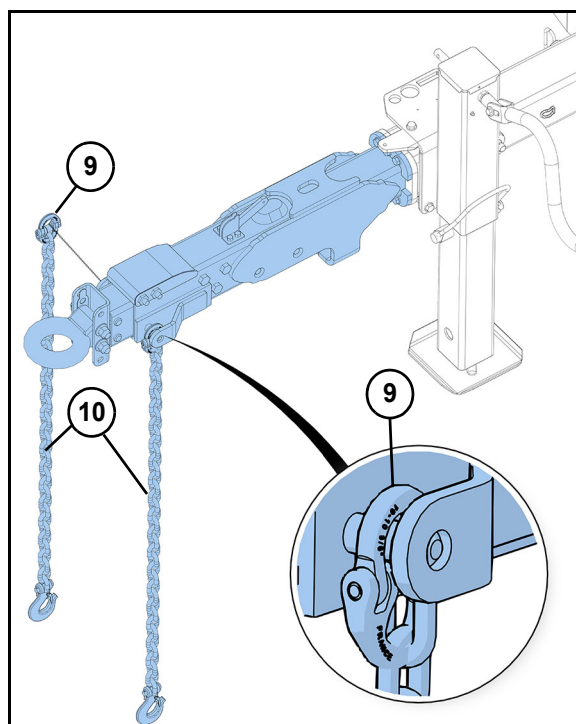

11. Reconnect hydraulic brake line (B).

12. Remove Figure 1 and attach to the invoice or place in the manual storage box so unit owner can place with existing parts manual.

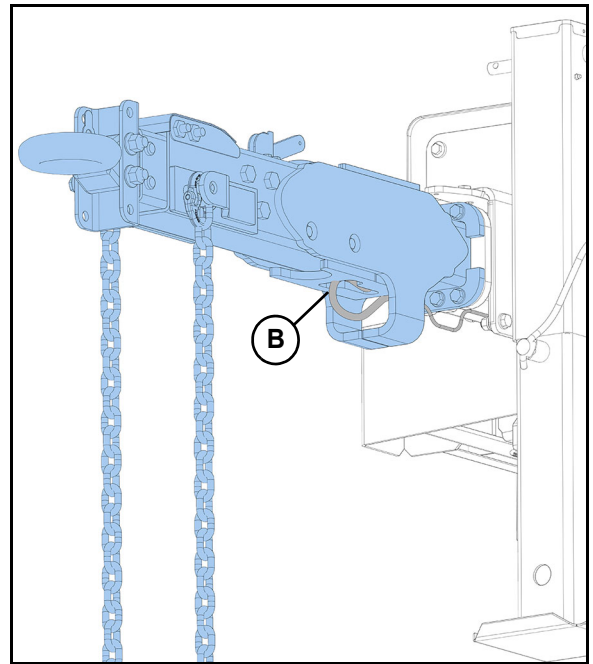

**Figure 1**

UNIT OWNER COPY  
Insert into parts manual  
for future reference.

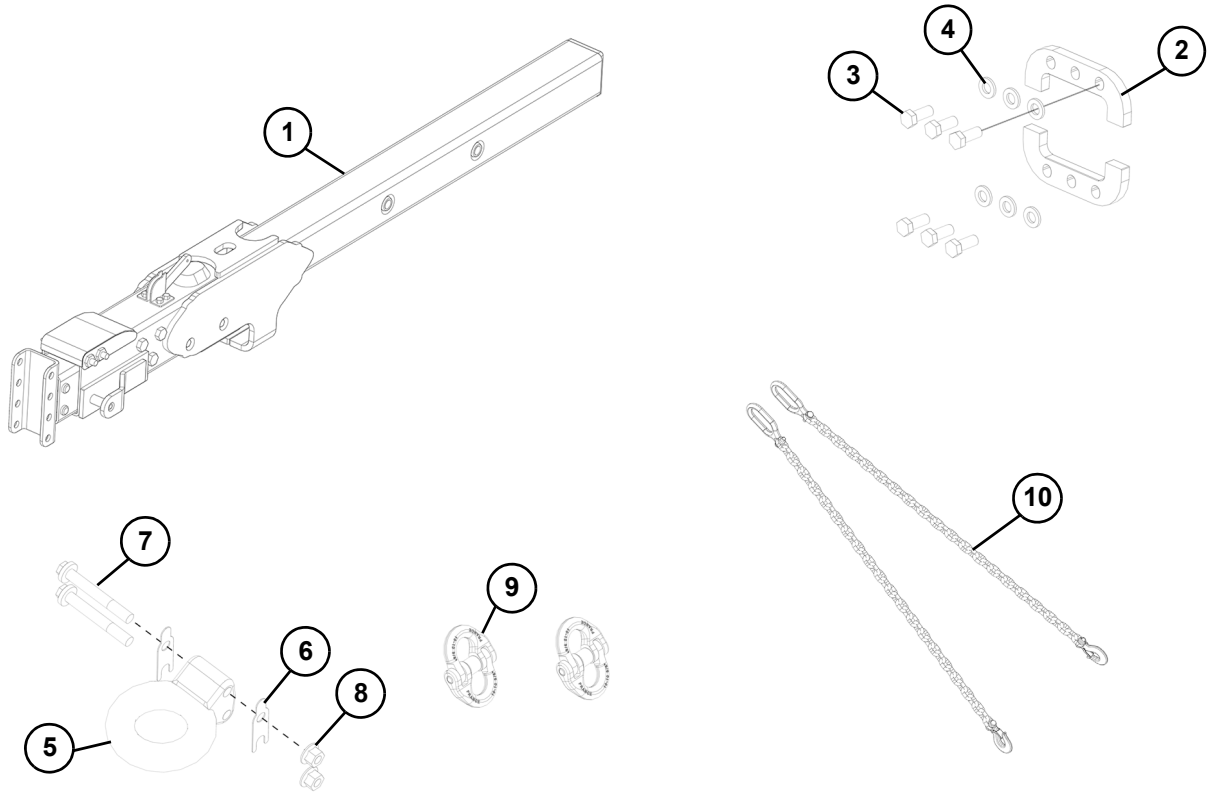

**Figure 1 parts list**

<b>REF. NO.</b>	<b>PART NO.</b>	<b>DESCRIPTION</b>	<b>IK01 QTY.</b>
1	163843403	WELDMENT - TONGUE - INNER HYD. BRAKES	1
2	163709465	COLLAR CLAMP	2
3	142401001	SCREW-HCS-M12-1.75X30-10.9-PLN-D933-FT	6
4	508486012	WASHER-FLATHARD-M12-13.0X24.0-3.0-D6916	6
5	163829379	HITCH - PINTLE RING 12.5 TON 3.0ID	1
6	163677498	HITCH - SHIM	2
7	507614120	SCREW-HFS-M16-2.00X120-10.9	2
8	507085016	NUT-HEXFLGL-M16-2.00	2
9	163811727	3/8" GRADE 80 HAMMERLOCK	2
10	163821344	ASSY - SAFETY CHAIN 3/8" G70	2
		Kit includes all items in Figure 1 parts list.	