

July 17, 2024

Version 1

Safety Recall: Fit Seat Weight Sensor (DTC U3000-49)

AFFECTED VEHICLES

Year	Model	Trim Level	VIN Range
2020	Fit	EX, LX, Sport	Check the iN VIN status for eligibility.

BACKGROUND

Affected vehicles may be equipped with seat weight sensors that are not built to proper specifications. Improperly built sensors could lead to cracking and/or a short circuit of the sensor, resulting in the illumination of the SRS warning light and the passenger airbag indicator remaining OFF. In certain collisions, these seat weight sensors may cause improper deployment of the front passenger airbags, increasing the risk of injury.

CUSTOMER NOTIFICATION

Owners of affected vehicles will be sent a notification of this safety recall.

Do an iN VIN status inquiry to verify eligibility.

Some vehicles affected by this campaign may be in your new or used vehicle inventory.

Failure to repair a vehicle subject to a recall or campaign may subject your dealership to claims or lawsuits from the client or anyone else harmed as a result of such failure. To see if a vehicle in inventory is affected by this safety recall, do a VIN status inquiry before selling it.

CORRECTIVE ACTION

- If the SRS indicator light is not illuminated, refer to *Campaign Notice 24-050*.
- If the SRS indicator light is illuminated, follow the inspection procedure outlined in this bulletin.

PARTS INFORMATION

Due to a limited supply of controlled parts, they require prior approval before shipping. This will be determined by the INSPECTION PROCEDURE, follow the steps provided by the QR code.

REQUIRED MATERIALS

Part Name	Part Number	Quantity
Hondalock 2 (1 bottle will service approximately 40 vehicles)	08713-0002	1

CUSTOMER INFORMATION: The information in this bulletin is intended for use only by skilled technicians who have the proper tools, equipment, and training to correctly and safely maintain your vehicle. These procedures should not be attempted by "do-it-yourselfers," and you should not assume this bulletin applies to your vehicle, or that your vehicle has the condition described. To determine whether this information applies, contact an authorized Honda automobile dealer.

WARRANTY CLAIM INFORMATION

NOTE: If an Inspection Procedure was performed and this service bulletin does not apply, use template B to submit a warranty claim for the inspection.

Operation Number	Description	Flat Rate Time	Defect Code	Symptom Code	Template ID	Failed Part Number
8611L0	Replace seat cushion frame (includes inspect and DTC clear)	1.4 hr	6XW00	QMH00	A24035A	81136-T5R-A02
7495A1	For stored DTCs other than DTC U3000-49, or inspection determines this service bulletin does not apply.	0.3 hr	6XZ00	KIT00	A24035B	81136-T20-A61

Skill Level: Repair Technician

INSPECTION PROCEDURE

1. Check of the SRS airbag light is ON.
2. If the indicator is ON, do an All DTC using the i-HDS.
3. If DTC U3000-49 (Internal Failure of the SRS Unit) is present, continue to step 4.
If DTCs other than U3000-49 are found, this service bulletin does not apply. Continue with normal troubleshooting.
4. Disconnect the negative terminal of the 12-volt battery.
 - *12 Volt Battery Terminal Disconnection and Reconnection* ([Click Here](#))NOTE: Wait at least 3 minutes before starting work.
5. From the front passenger seat area, do the following:
 - *Front Seat Removal and Installation* ([Click Here](#))
 1. Remove the front passenger's seat track end covers.
 2. Remove the front passenger's seat mounting bolts.
 3. Tilt the seat assembly back.
 4. Disconnect the seat weight sensor connectors from each sensor.
6. Reconnect the negative terminal of the 12-volt battery.
7. With the seat weight sensors disconnected, clear the DTC and perform an All DTC check again.
NOTE: Other new DTCs may be stored due to the seat weight sensors being unplugged. Disregard these new DTCs at this time.
 - This form must be filled out before parts can be ordered.
 - If you can't scan the QR code ([Click Here](#))



- If DTC U3000-49 does return, this service bulletin does not apply. Reconnect the SWS connectors and continue with normal troubleshooting.

REPAIR PROCEDURE

1. Disconnect the negative terminal of the 12-volt battery.
NOTE: Wait at least **3 minutes** before starting work.
2. Remove the passenger side front seat belt lower anchor bolt.
 - Step 2, *Front Seat Belt Removal and Installation* ([Click Here](#))
3. Remove the remaining front passenger seat harness connectors.
 - Step 5, *Front Seat Removal and Installation* ([Click Here](#))
4. Remove the front passenger's seat from the vehicle and set it on a clean, flat work surface.
5. Remove the front passenger's seat recline knob and recline covers.
 - Steps 2-5, *Front Seat Recline Cover Removal and Installation* ([Click Here](#))
6. Remove the front seat back cover/pad.
 - *Front Seat-Back Cover Removal and Installation* ([Click Here](#))
7. Remove the front seat cushion cover/pad.
 - *Front Seat Cushion Cover Removal and Installation* ([Click Here](#))
8. Remove the seat back frame from the seat cushion frame.
NOTE: Apply medium strength liquid thread lock to the threads of the bolts during reassembly.

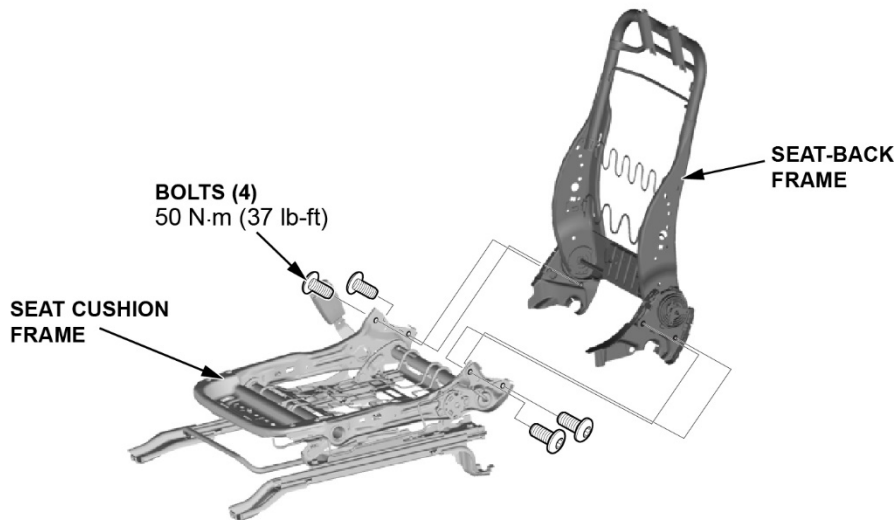

9. Remove the seat-back recline lever arm pivot bolt, then remove the spring from the lower seat frame.

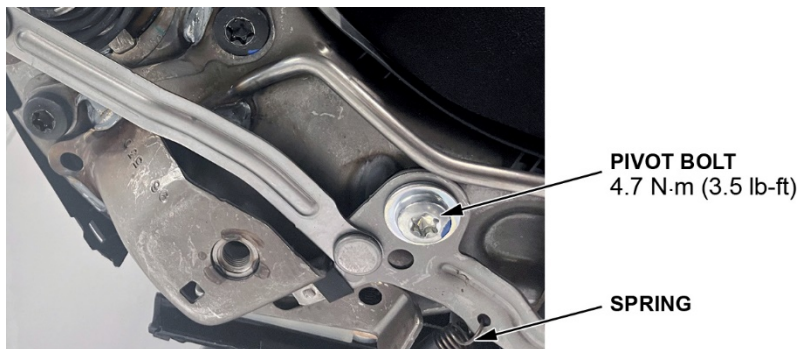

10. Remove the passenger's front seat belt buckle and wiring harness.

- Front Seat Belt Buckle Removal and Installation [\(Click Here\)](#)

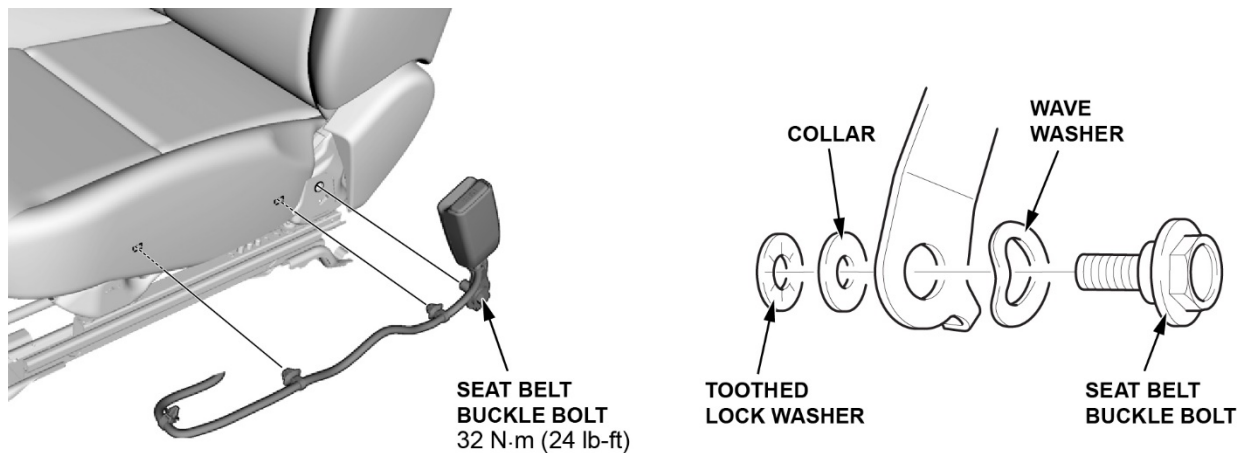

11. Remove the front seat recline inner and outer covers.

- Step 5, *Front Seat Frame Removal and Installation* [\(Click Here\)](#)

12. Transfer all removed parts to the replacement lower seat frame.

13. Install the remaining parts in reverse order of removal.

14. Install passenger's front seat.

- *Front Seat Removal and Installation* [\(Click Here\)](#)

15. Do the *Front Passenger's Weight Sensor Unit Initialization* [\(Click Here\)](#)

16. Do the *Front Passenger's Weight Sensor Unit Operation Check* [\(Click Here\)](#)

17. Do the *VSA Sensor Neutral Position Memorization* [\(Click Here\)](#)

18. Confirm SRS Operation

- Turn the vehicle to the ON mode and check that the SRS indicator comes on for about **6 seconds**, then goes off.