



SIB 77 02 24  
RECALL 24E-020: Vario top case rework

2024-06-06

## MODEL

Part Number	Part Description
77 43 9 443 542	Vario Top Case

The **potentially** affected vehicles have been marked with campaign number **0000770300** in AIR.

Note: all R 1300 GS motorcycles are listed as affected because of the potential of an affected case being able to be installed on the bike.

In order to determine if a specific Vario case is affected by this campaign, it will be necessary to verify the Data Matrix Code sticker on the inside of the Vario case (picture of location below). If the case has 1 or 2 stickers and one of these stickers has the part number "77 43 4 B0E 654" printed on it, then the case has been reworked already and no further action is needed. If the case has 1 sticker and it does not have the number "77 43 4 B0E 654" printed on it, then the case must be reworked per instructions below.

## SITUATION

It has been found after a quality inspection that the Vario top case with part number 77 43 9 443 542 can be installed onto the vehicle incorrectly, leading to the top case possibly falling off while in motion.

The Vario top case with Part number 77 43 4 B0E 654 is not affected and can be checked using the data matrix sticker on the inside of the top case.



## PROCEDURE

Verify the vario case must be reworked or not by verifying the Data Matrix Code sticker.

For Vario top cases still in dealer stock the reworking of the top case latch must be performed prior to sale of the accessory.

According to repair instructions "00 60 439 - Reworking top case latch", the currently installed thrust plate on the left for the locking flap and the toothed lock washer on the lock barrel are replaced. A New Data-Matrix-Code sticker comes with the repair kit and must be installed onto the top case to identify the completed repair. The old Data Matrix Code sticker does not need to be removed.

Any customer buying the top case must be instructed on the correct operation of locking the top case to the vehicle and be provided the insert to the operating instructions.

## NHTSA STATEMENT

Please be reminded that it is a violation of federal law (The Safety Act) for you to sell, lease or deliver any new motorcycle covered by this notification until the recall repair has been performed. This means that dealers may not legally deliver new motorcycles to consumers until they are fixed or use/sell replacement equipment/parts subject to this recall. Note also that substantial civil penalties apply to violations of the Safety Act. Also, you should not sell, lease or deliver any used motorcycles subject to a safety recall until the repair is completed. Please follow any special instructions that we provide to you for the return or disposition of recall parts.

## PARTS INFORMATION

Obtain and confirm the part numbers for your specific vehicle by entering the chassis number in ETK which takes into account specific equipment and/or options.

Additional parts like gaskets, hardware and chemicals may be required for the complete repair.

### **Part Number**

77 43 5 B55 147	Lock barrel repair kit
-----------------	------------------------

## CLAIM INFORMATION

Please submit claims via the normal claim process using the information below:

**Note:** As these are optional accessories, they must be claimed under "Type 2" warranty.

For **in dealer stock unsold** Vario Side cases being reworked, please use **VIN ZA00000** for the warranty claim. For customer owned Vario side cases, please use the customers vin for claim processing.

### **Defect code**

00 00 77 03 00	Reworking Vario case top case latch
----------------	-------------------------------------

### **Labor Operation**

00 60 439	Reworking top case locking bracket	8 FRU
+00 60 926	Reworking top case locking bracket	7 FRU

FRUs includes all repair procedures to complete the task with allowance for necessary ancillary tasks (e.g., visual inspection, lubrication, cleaning parts etc.) and administrative tasks.

Labor operation code 00 60 439 is a Main labor operation. If you are using a Main labor code for another repair, use the Plus code labor operation instead.

## **TREAD Act Reimbursement - Qualifying Prior Customer-Pay Repairs**

Copyright ©2024 MOTORRAD USA, a division of BMW of North America, LLC. All Rights Reserved

If your center is presented with a reimbursement request, BMW of North America, LLC will reimburse qualifying customer-pay repairs that were performed on affected vehicles up to 10 days after the date the owner notification letter was sent out by BMW.

If the customer previously paid for a qualifying repair, verify in AIR that the VIN is affected by the recall campaign and proceed as applicable:

#### **The customer arrives with an affected vehicle to your workshop**

- Perform the open Recall repair outlined in this bulletin, regardless of previous repair history.
- If the prior repair qualifies (see below), submit for both the Recall repair and the customer-pay reimbursement (Separate repair line items/separate defect codes).

Or:

#### **The customer only presents your center with a customer-pay invoice for the prior repair**

- If the vehicle and the prior repair qualifies (see below), submit for the customer-pay reimbursement portion only.

#### **Customer-pay Invoice Review and Reimbursement Qualification and Procedure**

Review and verify that the prior customer-pay invoice (BMW center or independent repair shop) contains a repair that pertains to the recall campaign. Only the repair outlined in the published safety recall service bulletin is eligible for reimbursement.

If this prior repair qualifies, submit a claim for reimbursement:

- Verify in AIR that the VIN was affected by the recall campaign
- Use defect code 85 99 00 45 NA for the amount requested under sublet 03.
- Comment: (RECALL 24E-020 Vario Top Case) - Reimbursement for allowable expenses that relate to performing the prior qualifying customer-pay repair.
- Use current repair date and mileage for claim submission.
- Retain copies of the customer paid invoice and the current repair invoice in your records.
- Reimburse the customer directly (parts and labor).

Contact warranty via an IDS ticket with any questions.

Retain the original customer pay invoice in your files; this documentation may be requested by BMW during the claim review process.

**Note:** A repair performed on a non-affected vehicle, or the diagnosis and repair of other unrelated issues do not qualify for reimbursement.

This claim submission for the prior customer-pay reimbursement, when it is submitted as outlined under Defect Code 85 99 00 45 NA, **will not close** the Open Safety Recall on the vehicle.

### **QUESTIONS REGARDING THIS BULLETIN**

Technical inquiries	Contact the BMW Technical Support Group via TSARA
Warranty inquiries	Submit an IDS ticket to the Warranty Department
Parts inquiries	Submit an IDS ticket to the Motorrad Parts Department

#### Supporting Materials

[picture as pdf RM\\_0060439\\_0M21\\_EN.pdf](#)

[picture as pdf OM\\_0000770300\\_EN.pdf](#)

[picture as pdf 77 02 24 Recall 24E-020 Vario Top Case.pdf](#)

Copyright ©2024 MOTORRAD USA, a division of BMW of North America, LLC. All Rights Reserved



## 0M21 - R 1300 GS

### 00 60 439 Rework topcase locking bracket

# 1

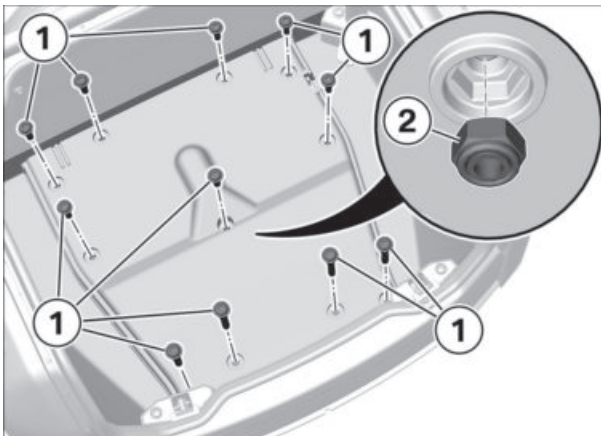

#### ► Removing lock for topcase

- Remove screws **(1)** with nuts **(2)**.

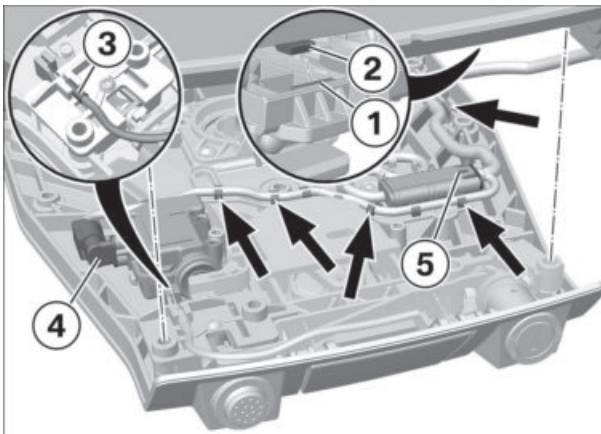

- Carefully fold up lock **(1)** and loosen from hooks **(2)**.
- Detach Bowden cable **(3)**.
- Disconnect connector **(4)** for servomotor and connector **(5)** for power supply.
- Loosen cable from locators **(arrows)**.
- Remove lock **(1)**.



# 2

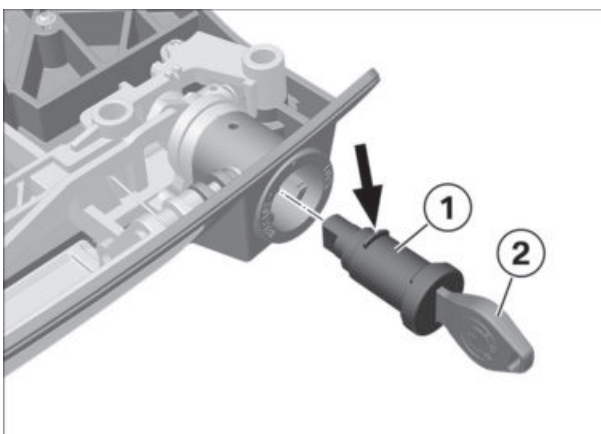

#### ► Removing lock barrel for topcase

- Insert key **(2)** in lock barrel **(1)**.
- Press down lock **(arrow)** via bore hole and remove lock barrel **(1)**.

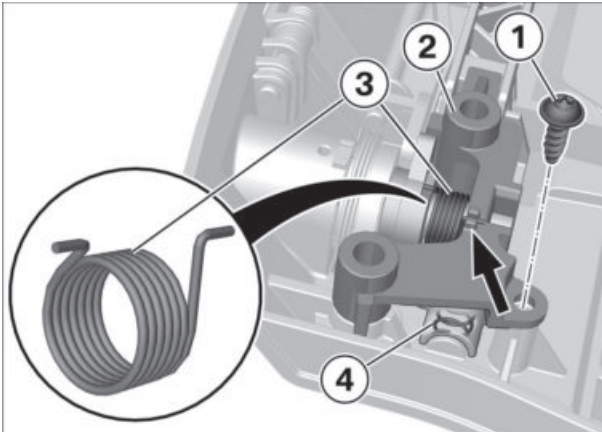

## 3

▶ **Removing hold-down device on lock barrel**

- Remove screw (1).
- Remove hold-down device (2) and spring (3).
- Pay attention to spring (4), do not remove.

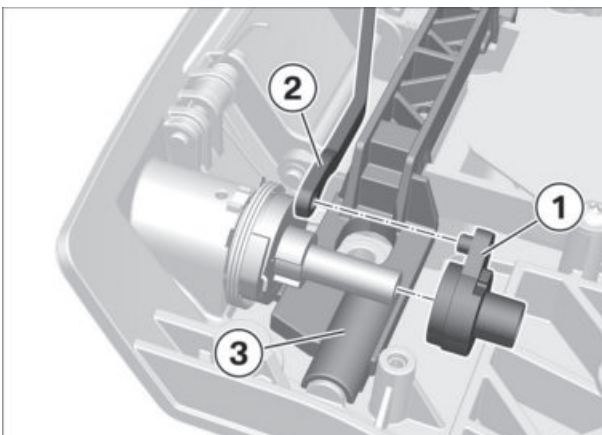

## 4

▶ **Removing release lever on lock barrel**

- Loosen and remove release lever (1) from pushrod (2).
- Press cover (3) downwards.

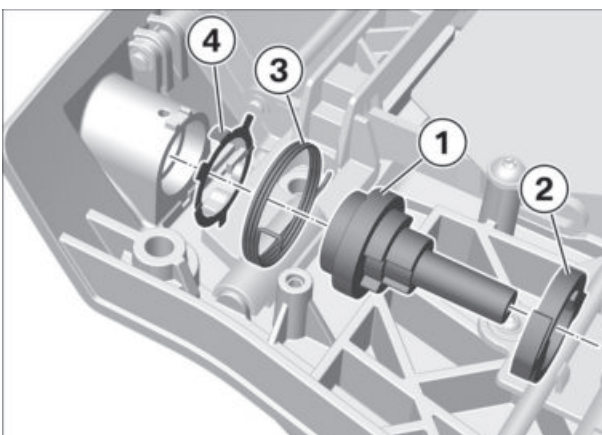

## 5

▶ **Removing lock barrel shaft with toothed lock washer**

- Loosen and remove lock barrel shaft (1) with toothed lock washer (2).
- Remove return spring (3) and spring washers (4).





## 6

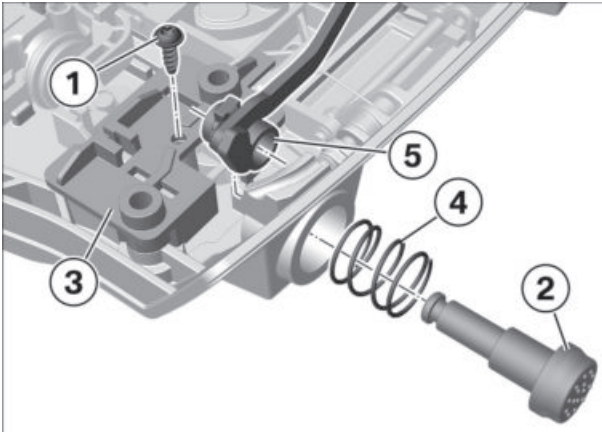

## ► Remove push lever for cover mechanism

- Remove screw (1).
- While doing so, push in and hold push-button (2).
- Remove retaining panel (3), push-button (2) and spring (4).
- Remove trigger (5) with locking rod.

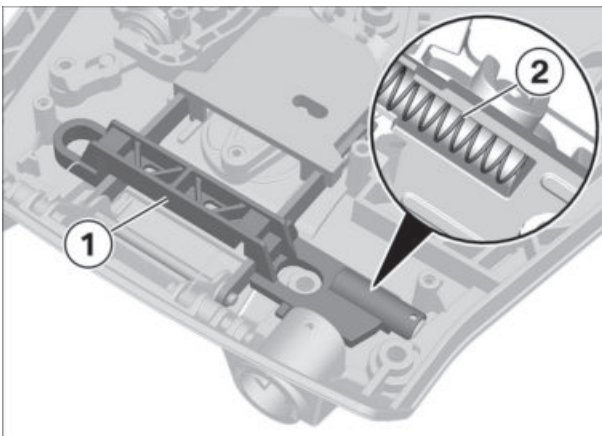

- Remove push lever (1) with spring (2).
- Spring (2) is tensioned, carefully raise the push lever.



## 7

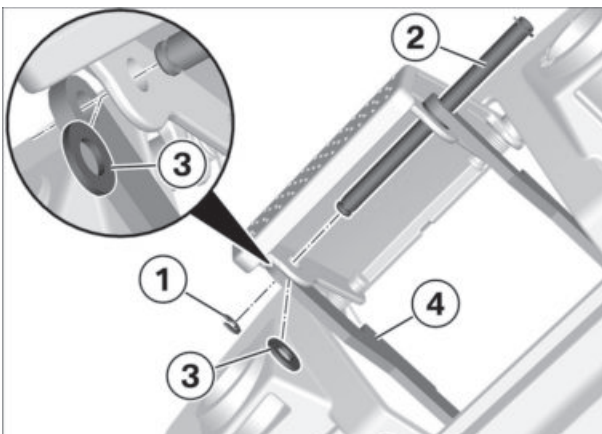

## ► Schublech links für Verriegelung ausbauen

- Verriegelungshebel öffnen.
- Sicherungsring (1) ausbauen.
- Achse (2) etwas nach rechts ziehen und Anlaufscheibe (3) unter Schublech (4) ausbauen.

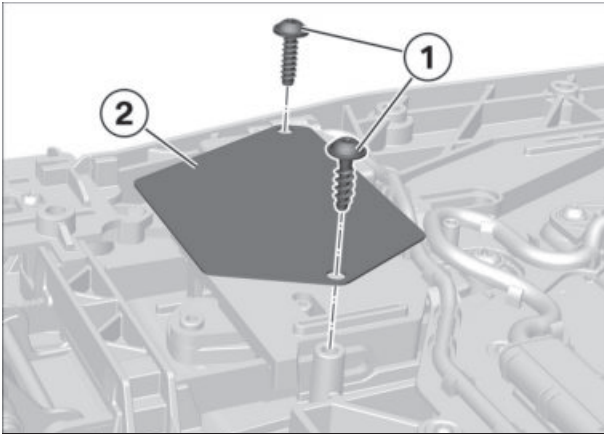

- Schrauben (1) ausbauen.
- Abdeckblech (2) ausbauen.

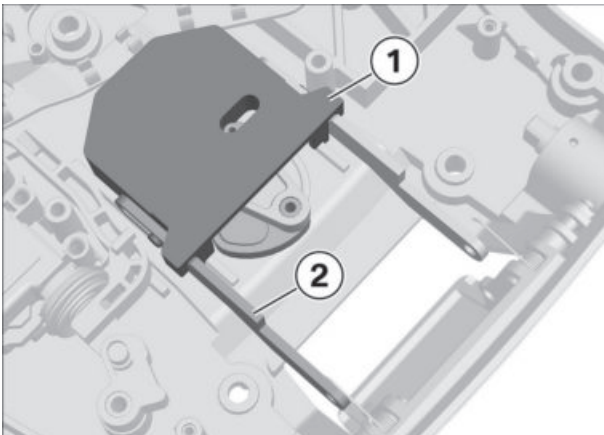

- Abdeckung für Schiebestück (1) anheben und Schublech links (2) ausbauen.



## 8

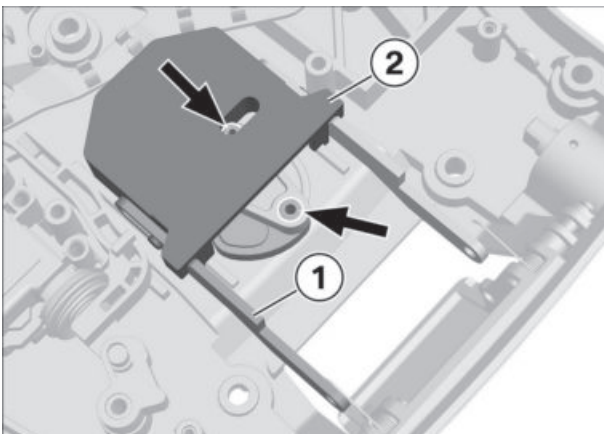

### ► Install thrust plate for latch

- Position thrust plate (1) on sliding piece (2).  
– Red markings face outwards!
- Position sliding piece (1) on the bolt on the knee joint (arrows).



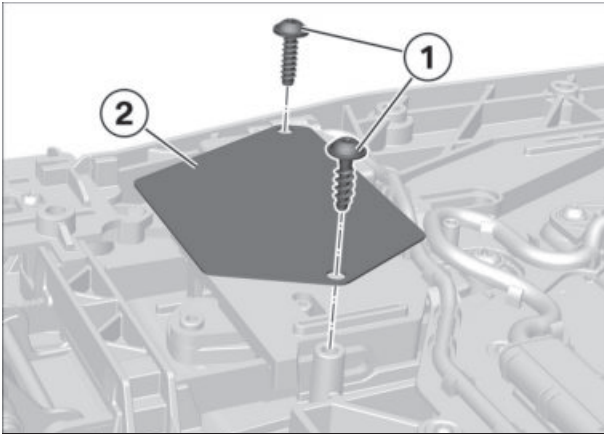

- Attach cover plate (2) and install screws (1).

 <b>Tightening torques</b>		
Cover plate for sliding piece to topcase latch		
5 x 16	0.8 Nm	

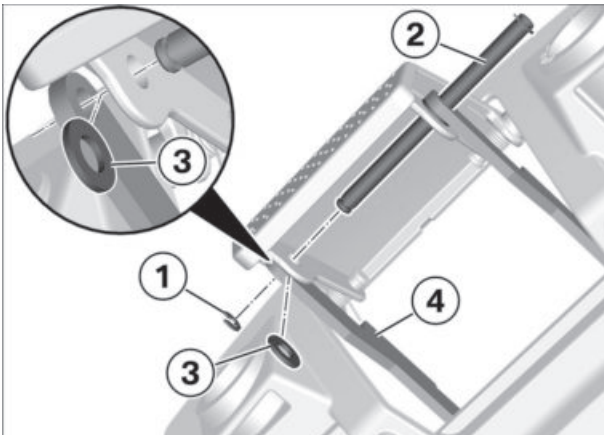

- Install thrust washer (3) and slide in axle (2).
- Thrust washer is positioned **between** locking lever and thrust plate (4).
- Install circlip (1).
- Close the locking lever.



**9**

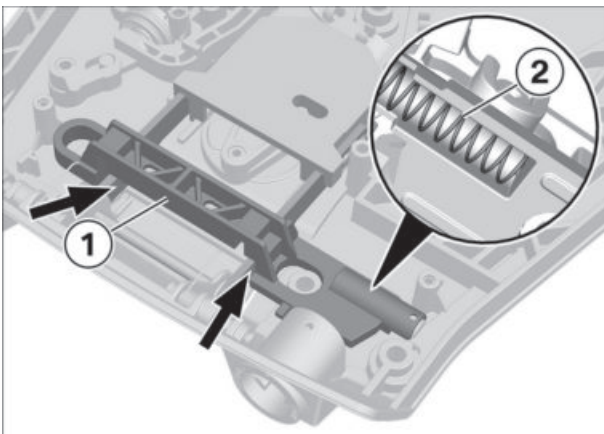

► **Install push lever for cover mechanism**

- Install push lever (1) with spring (2).
- Insert spring (2) between push lever and limit position in the housing.
- Position push lever (1) on the thrust plate (arrows).

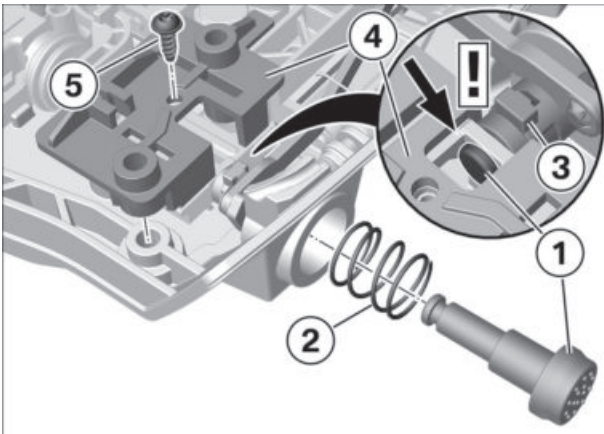

- Insert push-button (1), spring (2) and trigger with locking rod (3), keep push-button pressed.
- Install retaining panel (4), positioning it on the mushroom head of push-button (1) (arrow).
- Install screw (5).

# 10

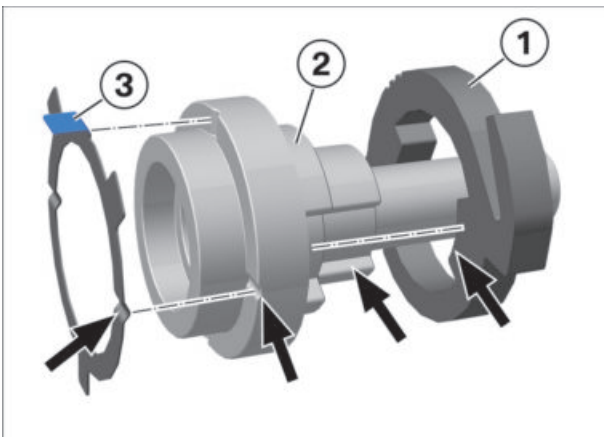

## ► Installing lock barrel shaft with toothed lock washer

- Install **new** toothed lock washer (1) on shaft (2).
  - New toothed lock washer is marked with 3 notches.
  - Note segments, only possible in one position (arrows).
- Install spring washer (3).
  - Note notches (arrows), sheet metal tab points upwards.

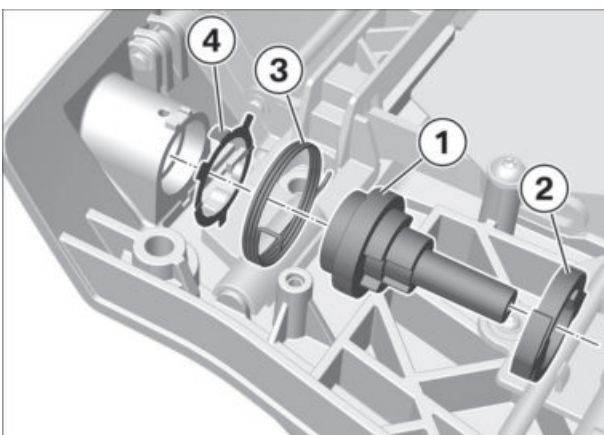

- Install lock barrel shaft (1) with toothed lock washer (2), return spring (3) and spring washer (4).

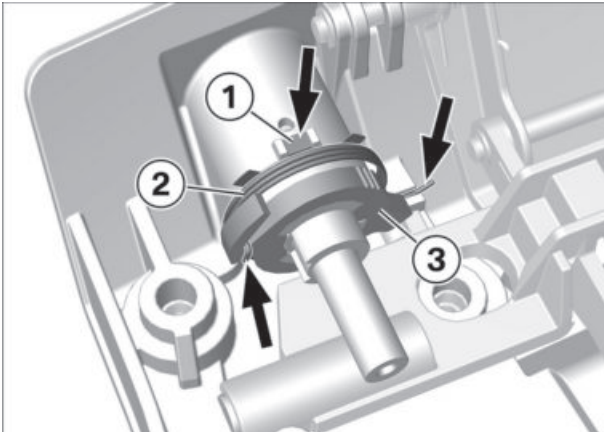

- Lay spring washer (1) with tab in locator (arrow).
- Hook return spring (2) onto toothed lock washer (3), long arm lies in groove (arrows).

# 11

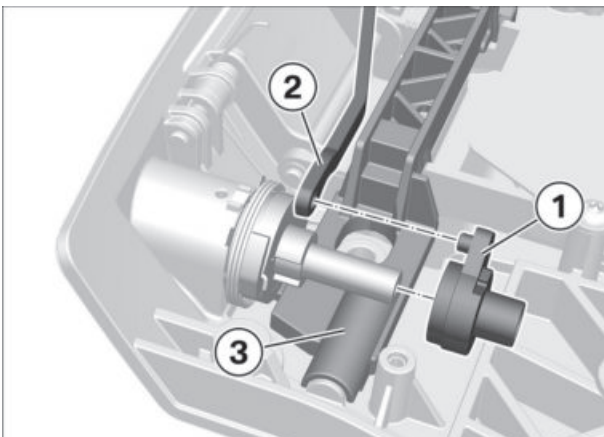

## ► Installing release lever on lock barrel

- Install release lever (1), inserting it in pushrod (2).
- Press cover (3) downwards.

# 12

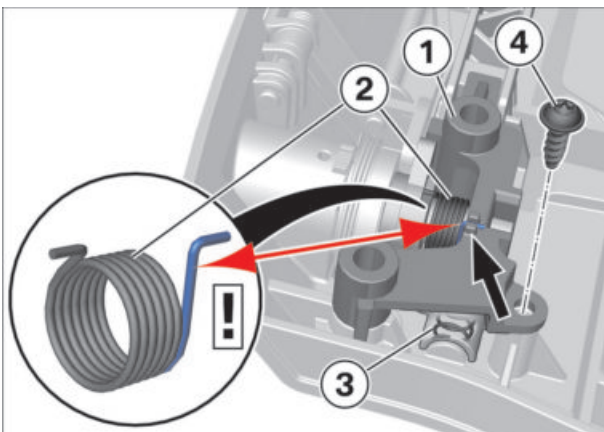

## ► Installing hold-down device on lock barrel

- Install hold-down device (1) with spring (2).
- Long arm of spring points towards hold-down device.
- Attach spring (2) to release lever and hold-down device (arrows).
- Note correct position of spring (3).
- Install screw (4).

Tightening torques	
Hold-down device to topcase latch	
	1 Nm

## 13

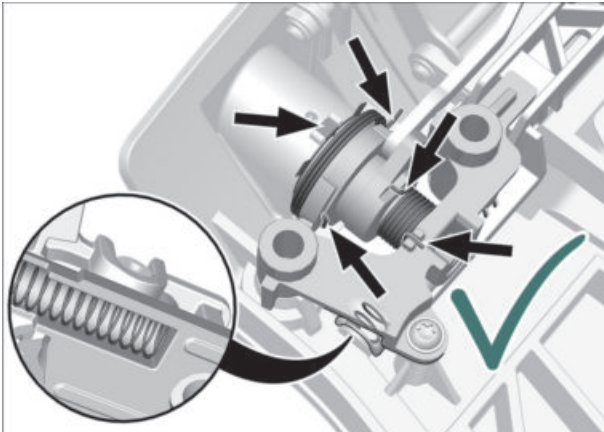
▶ **Checking mounting orientation**

- Note correct position of springs and spring washer.

## 14

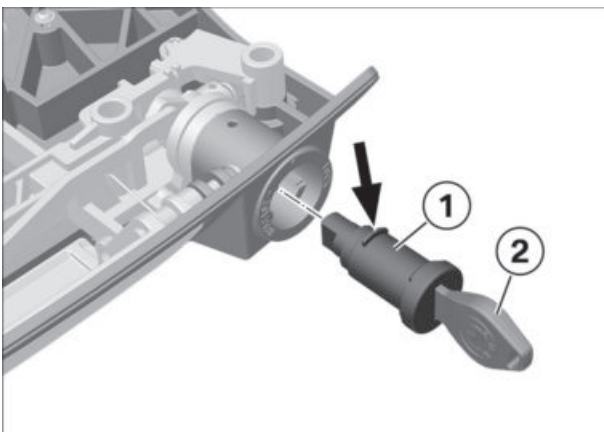
▶ **Installing lock barrel for topcase**

- Insert key **(2)** in lock barrel **(1)**.
- Install lock barrel **(1)**, ensuring that the stop plate engages.
  - The stop plate **(arrow)** must be on the point-marking side.
- Test lock barrel for function.

## 15

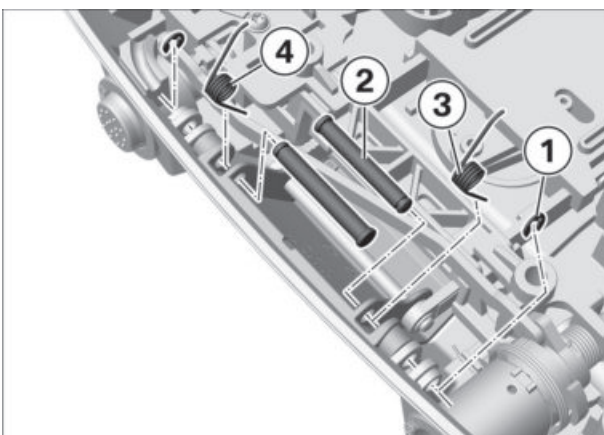
▶ **Remove springs on release handle**

- Loosen and remove the circlip **(1)** from the axle **(2)**.
  - Press off the circlip with a large, sharpened screwdriver (blade thickness approx. 0.6 mm)
- Remove axle **(2)**, take off spring **(3)**.
- Remove spring **(4)** in a similar way.

## 16

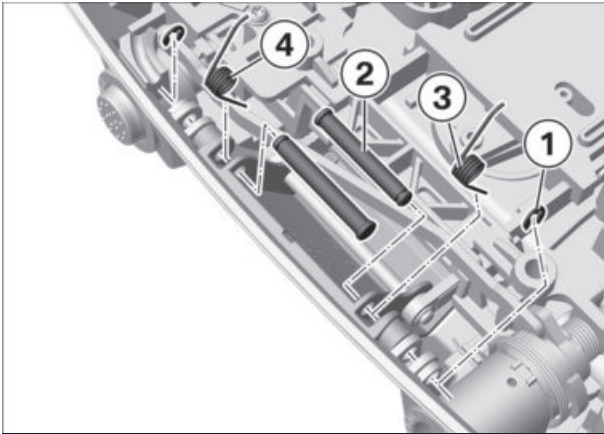
► **Install springs on the release handle**

- Install spring (3) and axle (2).
  - Curved leg points towards the topcase bottom section.
- Install circlip (1) on axle (2).
- Install spring (4) in a similar way.

## 17

► **Checking function of latch**

- Check the function of the latch using the vehicle key.
  - Centre position point marking: Push-button can be pressed.
  - Turn anti-clockwise RELEASE: locking flap jumps open.
  - Turn clockwise LOCK: pushrod actuates lid latch (push-button is locked).
  - Vehicle key jumps back to point marking (vertical) after each actuation.
- In case of malfunction, check installation situation again and correct if necessary.

## 18

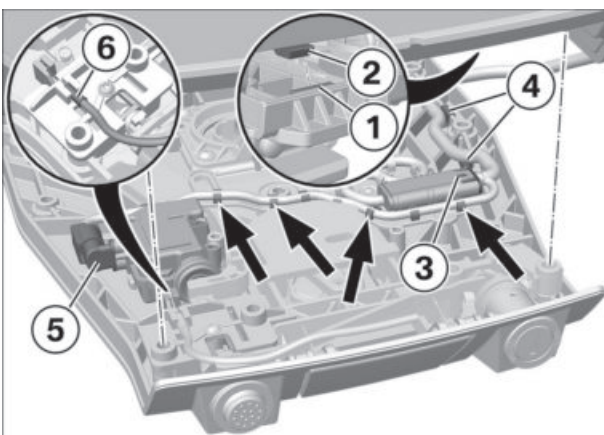
► **Installing lock for topcase**

- Insert lock (1) in hooks (2).
- Connect connector (3) for power supply; secure cable in cable terminals (4).
- Connect connector (5) for servomotor.
- Secure cable in locators (arrows).
- Hook Bowden cable (6).



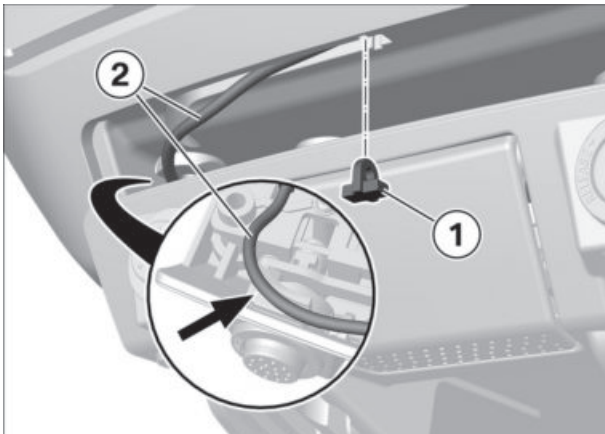

- Route rubber grommet **(1)** and Bowden cable **(2)** in topcase bottom section.
- Bowden cable lies in the mount **(arrow)**.
- Do not pinch Bowden cable.

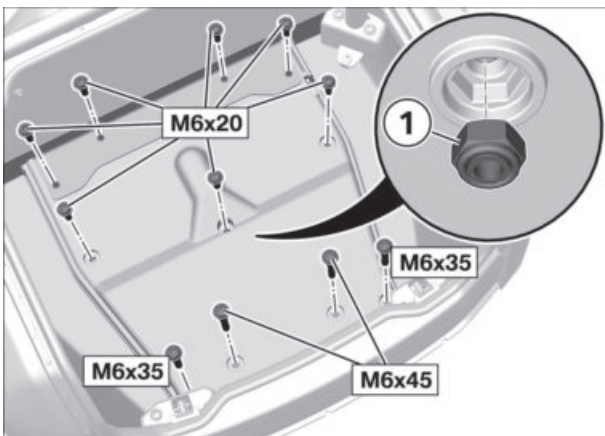

- Install screws with nuts **(1)**.

Tightening torques		
Latch to topcase		
M6, Replace nuts	3 Nm	

- **Only close the lid following final function check of the latch.**
- Centre position point marking: Push-button actuates both locking hooks.
- Turn anti-clockwise RELEASE: locking flap jumps open.
- Turn clockwise LOCK: pushrod actuates lid latch (push-button is locked).
- Vehicle key jumps back to point marking (vertical) after each actuation.

# 19

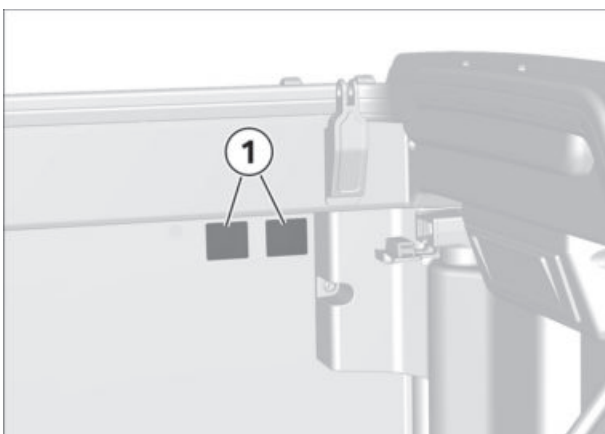

## ► Affixing data matrix code in topcase

- Affix new sticker **(1)** with data matrix code **next to** the existing sticker.



## INSTALLING TOPCASE

- with Vario topcase<sup>OA</sup>
- with central locking system<sup>OE</sup>

### ! WARNING

#### Luggage on topcase not secured in compliance with correct procedure

Impairment of handling stability

- Do not lash luggage carried on the topcase to the topcase carrier or to other movable parts.
- Before riding off, check that the topcase carrier has clearance on both sides.

### ! WARNING

#### Topcase not properly secured

Driving safety is impaired

- The topcase must not wobble and must be secured free from play.

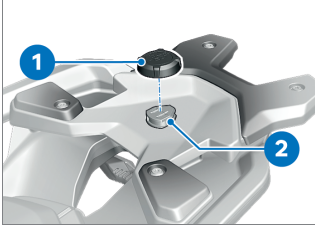

- with Vario topcase<sup>OA</sup>
- with central locking system<sup>OE</sup>
- Unlock the protective cap.
- Remove protective cap **1** from magnetic plug connection **2**.

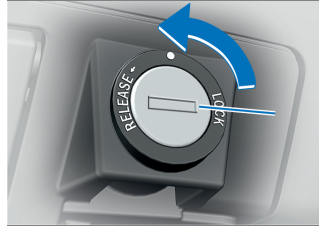

- Turn the key to the **RELEASE** position in the topcase lock.
- » The locking flap pops up.

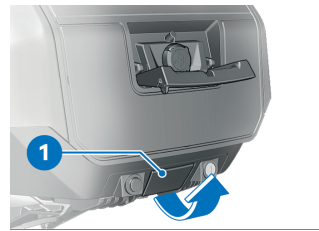

- Fully open locking flap **1**.

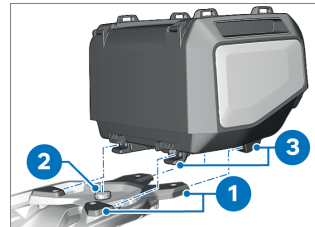

- Check magnetic plug connection **2** of topcase and topcase holder for dirt and damage.
- Engage hooks **3** securely in mounts **1**.

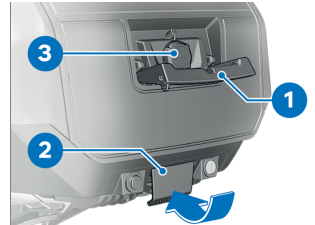

- Attach the protective cap **3** to the holder and lock.
- Close carry handle **1**.
- » Carry handle **1** engages with an audible click.
- Fully close locking flap **2**. The » latch engages with an audible click.

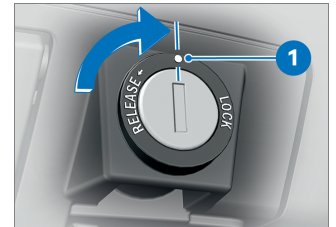

- The key automatically jumps into position **1**.
- Make sure that the topcase is correctly seated on the luggage carrier.
- Turn the key to position **1** and remove the key.
- » The Topcase locks and unlocks with a central locking system.
- Alternatively, turn the key to the **LOCK** position and remove the key.
- » The Topcase remains locked even when the central locking system is unlocked.

- 1 -

- 2 -

## INSTALLING TOPCASE

- with Vario topcase<sup>OA</sup>
- with central locking system<sup>OE</sup>

### ! WARNING

#### Luggage on topcase not secured in compliance with correct procedure

Impairment of handling stability

- Do not lash luggage carried on the topcase to the topcase carrier or to other movable parts.
- Before riding off, check that the topcase carrier has clearance on both sides.

### ! WARNING

#### Topcase not properly secured

Driving safety is impaired

- The topcase must not wobble and must be secured free from play.

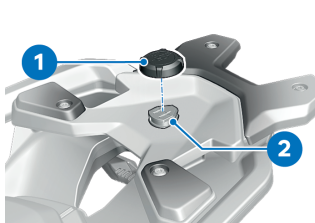

- with Vario topcase<sup>OA</sup>
- with central locking system<sup>OE</sup>
- Unlock the protective cap.
- Remove protective cap **1** from magnetic plug connection **2**.

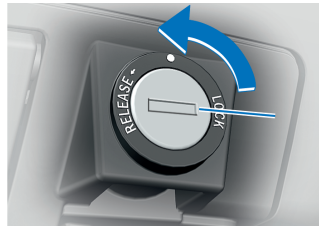

- Turn the key to the **RELEASE** position in the topcase lock.
- » The locking flap pops up.

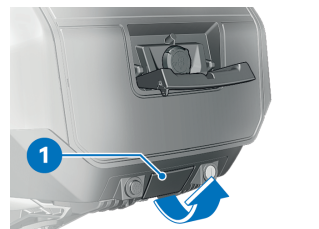

- Fully open locking flap **1**.

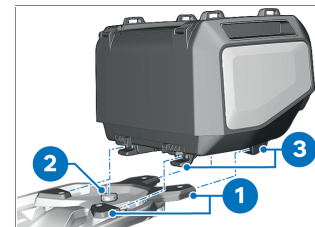

- Check magnetic plug connection **2** of topcase and topcase holder for dirt and damage.
- Engage hooks **3** securely in mounts **1**.

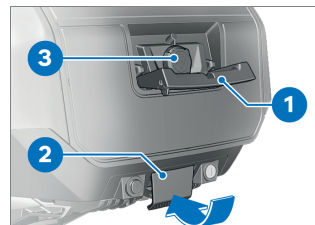

- Attach the protective cap **3** to the holder and lock.
- Close carry handle **1**.
- » Carry handle **1** engages with an audible click.
- Fully close locking flap **2**. The » latch engages with an audible click.

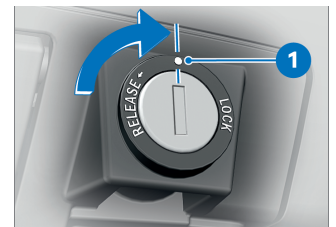

- The key automatically jumps into position **1**.
- Make sure that the topcase is correctly seated on the luggage carrier.
- Turn the key to position **1** and remove the key.
- » The Topcase locks and unlocks with a central locking system.
- Alternatively, turn the key to the **LOCK** position and remove the key.
- » The Topcase remains locked even when the central locking system is unlocked.

- 1 -

- 2 -