



FIELD KIT

Vermeer Corporation

Environmental
Pella, Iowa 50219 USA

FIELD CAMPAIGN KIT #:	IK004561 Rev. 1	DATE:	2025 June 17
For Dealer Reference: Service Bulletin #: SVC2024-068 Rev. 1			

BC900XL Lug Nut Torque Instruction Correction Kit

CAMPAIGN TYPE:	Mandatory–Product Safety
CAMPAIGN CATEGORY:	Kit and Bulletin

MACHINE/ ATTACHMENT MODEL(S):	SERIAL NUMBERS:		
	Included	Excluded	Kit version
BC900XL	526, 2001 – 50107	None	IK01 Maintenance Manual
BC900XL	2085, 2124, 2214, 2248, 2251, 2257, 2272, 2338, 2401, 2458, 2465, 2523, 2588, 2594, 2633, 2743, 2757, 3588, 3589, 3600	None	IK02 Service Manual only
BC900XL	Units determined to need studs and lug nut kit after inspection	None	IK03 Install studs and lug nut kit DEALER INSTALLATION ONLY

<p>BC900XL</p>	<p>526, 2001 – 50107</p>	<p>2019, 2034, 2042, 2052, 2065, 2084, 2085, 2093, 2100, 2105, 2124, 2128, 2130, 2134, 2148, 2167, 2172, 2175, 2180, 2201, 2210, 2212, 2231, 2302, 2312, 2313, 2323, 2329, 2330, 2333, 2336, 2343, 2344, 2375, 2384, 2390, 2392, 2431, 2442, 2450, 2461, 2469, 2470, 2472, 2475, 2476, 2481, 2485, 2486, 2496, 2499, 2502, 2506, 2508, 2511, 2527 – 2529, 2537, 2542, 2544, 2572; 2583, 2588, 2593, 2612, 2626, 2628, 2633, 2654, 2655, 2660, 2663, 2685, 2694, 2695, 2698, 2713, 2720, 2726, 2737, 2738, 2740, 2741, 2756, 2768, 2786, 2788, 2789, 2799, 2818, 3511, 3516, 3520, 3525, 3528, 3529, 3532, 3534, 3538, 3539, 3544, 3545, 3560, 3572, 3585, 3594, 3600, 3607, 3609, 3614, 3615, 3620 – 3622, 3628, 3629, 3633, 3642, 3653 – 3655, 3661, 3663, 3664, 3669, 3674, 3675, 3678, 5004, 5013, 5016, 5018, 5027, 50017, 50018, 50025, 50032, 50033, 50038, 50046, 50059, 50068, 50069, 50078, 50082, 50088, 50089, 50103</p>	<p>IK04 Inspection only</p>
-----------------------	---------------------------------	----------------------------------------------------------------------------------------------------------------------------------------------------------------------------------------------------------------------------------------------------------------------------------------------------------------------------------------------------------------------------------------------------------------------------------------------------------------------------------------------------------------------------------------------------------------------------------------------------------------------------------------------------------------------------------------------------------------------------------------------------------------------------------------------------------------------------------------------------------------------------------------------------------------------------------------------------------------------------------------------------------------------------------------------------------------	----------------------------------------



Reason for Revision: The kit instructions and bulletin are being revised to separate the inspection form from IK01 and adding it to new kit version IK04.

Purpose: Wheel lug nuts may loosen, loss of wheel possible. Wheel bearing grease/repack procedure in the Maintenance and Service Manuals included incorrect lug nut torque specification. Incorrectly torqued lug nuts can become loose. Loose lug nuts can cause damage to the wheel rim, and result in separation from the brush chipper.

Death or serious injury possible. Death or serious injury is possible if wheel separates from the brush chipper while being towed on a public highway, resulting in a crash. Property or equipment damage may also occur.

Immediate machine modifications required. IK004561 has been created to provide necessary parts and instructions to replace incorrect Maintenance and Service Manuals, inspect existing parts for damage, and replace damaged parts.

IK014561 will provide an updated maintenance manual form directly to owners. Owners will be instructed to begin using the updated manual information immediately.

IK024561 will provide updated service manuals to current owners of a Service Manual.

IK034561 will be provided, based on inspection results, to replace damaged lug nuts and studs.

IK044561 will provide an inspection form directly to owners instructing them to check all lug nuts and studs on affected machines for damage, return the inspection form with the required information, and coordinate with their dealer to replace damaged parts.

The kit must be installed as soon as possible.

Special tools and conditions:

- None

Shutdown procedure:

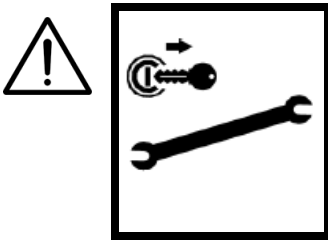

WARNING: Failure to use shutdown procedure can result in unexpected hazard(s). Death or serious injury could result due to entanglement, crushing, cutting, or other hazardous contact. Follow shutdown procedure after operating, before performing any service or maintenance and before transporting.

For your safety and the safety of others, use shutdown procedure before working on machine for any reason, including servicing, cleaning, unclogging, inspecting, or transporting the chipper.

A variation of this procedure may be used if instructed within this manual or if an emergency requires it.

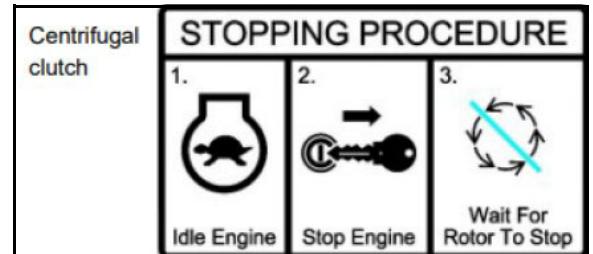

1. Return *upper feed control bar* to NEUTRAL.

2. Reduce engine speed to idle.

- For machines equipped with centrifugal clutch, cutter disc will disengage.
- For machines equipped with manual clutch, use clutch handle **(2)** to disengage cutter disc.
- Whenever practical and safe, allow engine to idle for one to five minutes before shutting down after operating at full power. Consult machine Engine Manual for details.

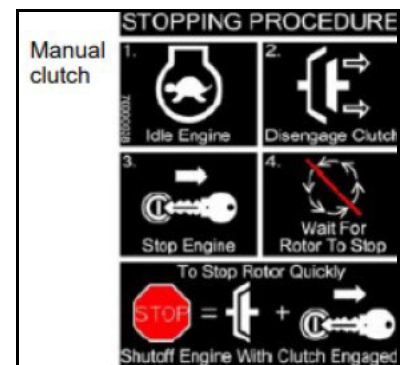

3. Shut off engine and remove key.

4. Wait for cutter disc and belt to stop.

NOTICE: Check cutter disc rotation by looking through the viewing slots **(1)** on belt housing shield. Cutter disc will continue to turn for a short time after engine has stopped.

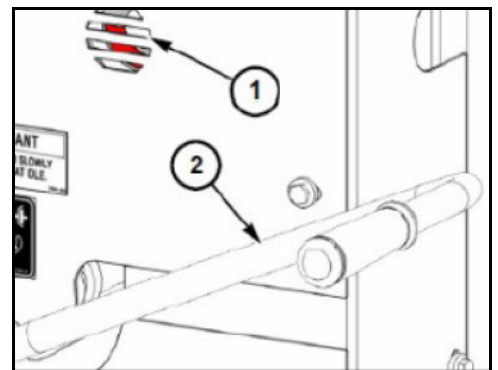

5. Close and latch feed table.



Unless indicated, new parts from kit have callouts with numbers. Callouts with letters indicate existing parts or general items.

IK01 Procedure:

1. Disregard current Maintenance Manual and replace with new Maintenance Manual **(1)**.

IK02 Procedure:

1. Disregard current Service Manual and replace with new Service Manual **(2)**.

IK03 Lug Nut and Stud Replace Procedure:



WARNING: Raised load can shift or fall. Death or serious injury could be possible if struck or crushed by falling load. Never allow anyone under a raised load unless load is securely supported to prevent it from shifting or falling.

1. Follow shutdown procedure
2. Secure machine so it cannot roll.
3. Jack up machine until one wheel is off the ground and secure with suitable jackstands or blocks.
4. Remove and discard five lug nuts **(A)** from axle **(B)**.
Repeat for other wheel.

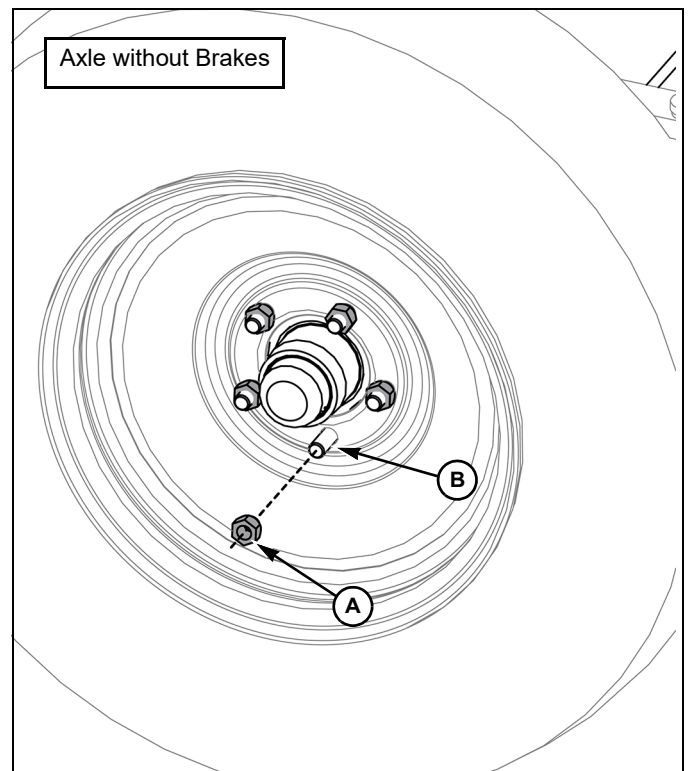
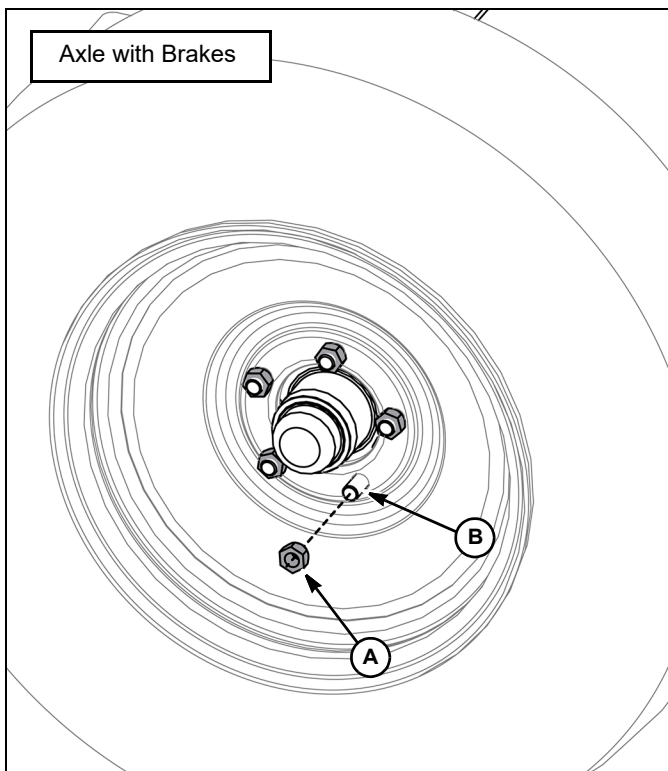

5. Remove and retain wheel and rim (C).

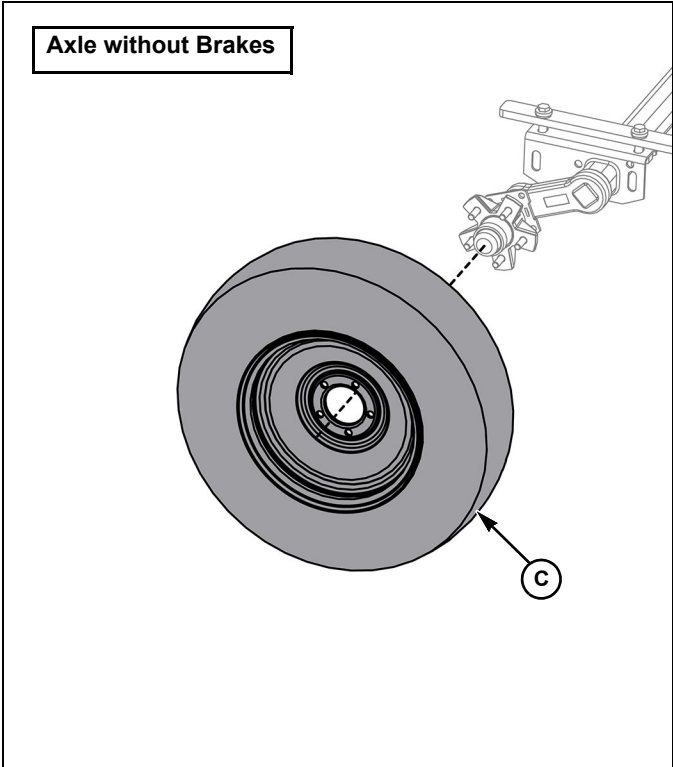
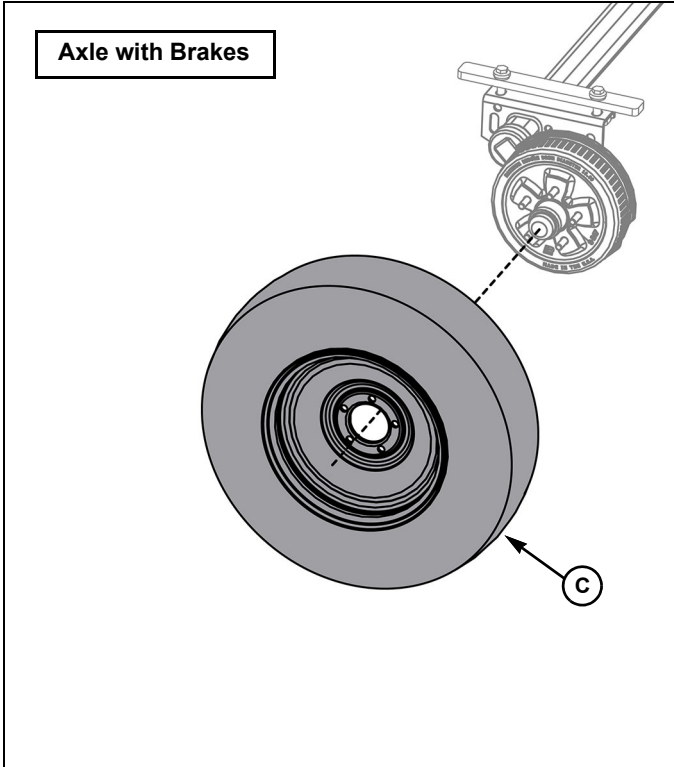

6. Remove grease cap (D), nut retainer (E), spindle nut (F), washer (G), and outer bearing (H).

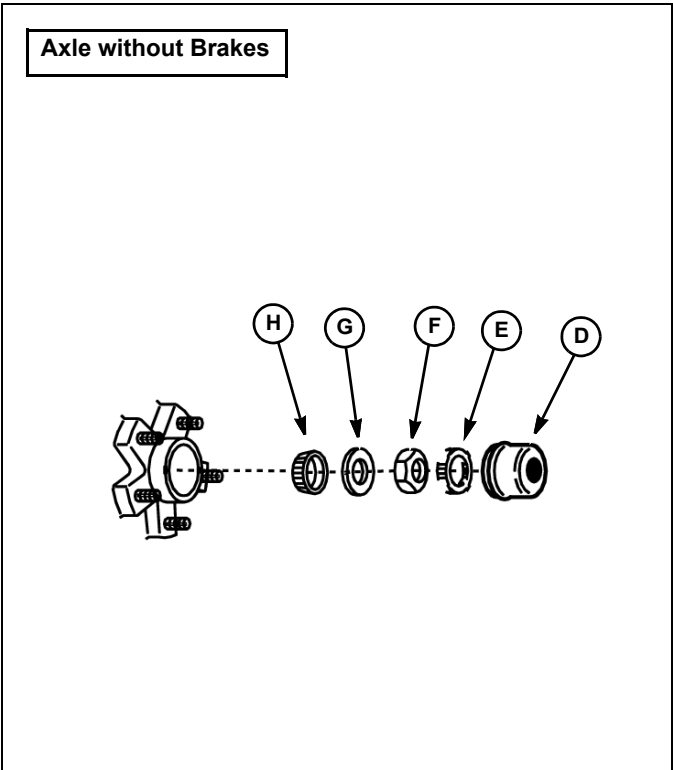
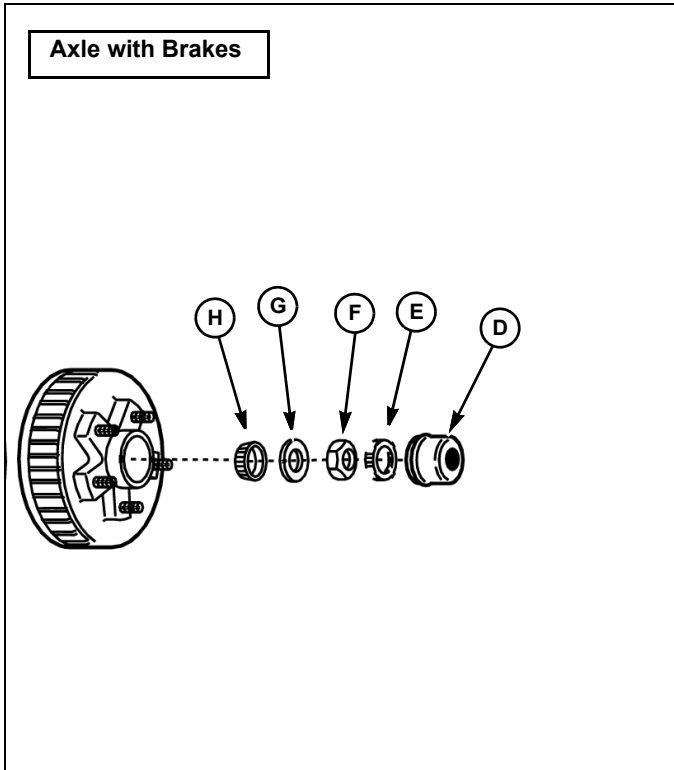

7. Remove and retain hub (I) if hub is tight, use wheel puller.

8. Remove and discard five studs (J) from wheel hub (I).

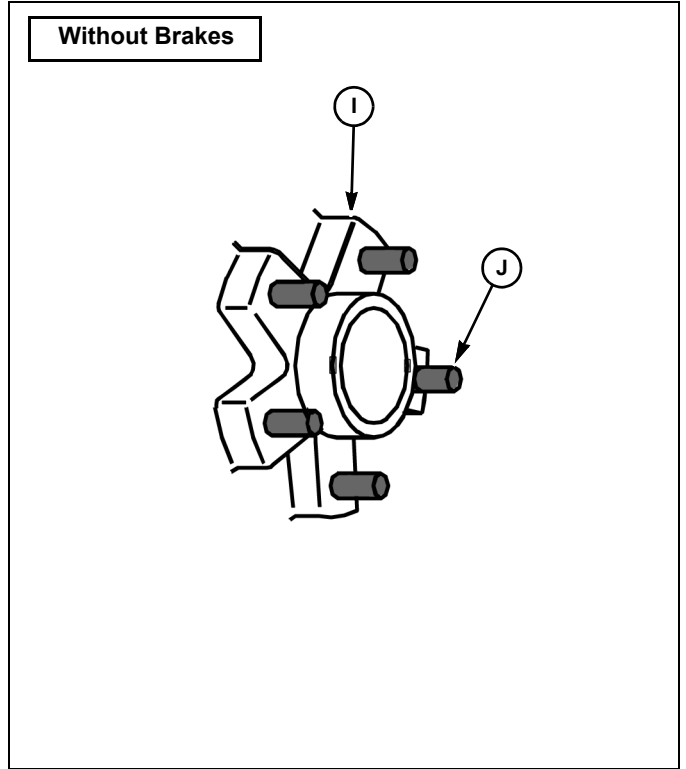
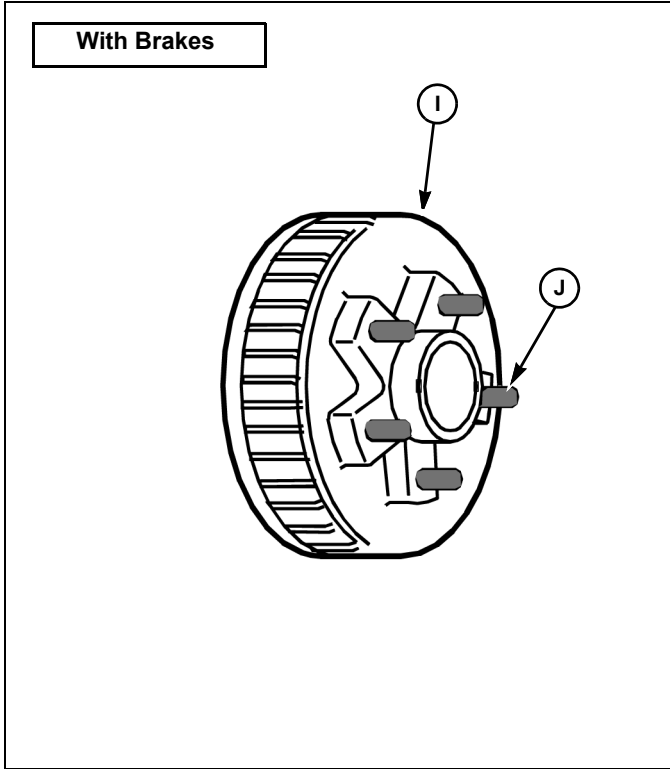

9. Push five new studs (3) into hub (1).

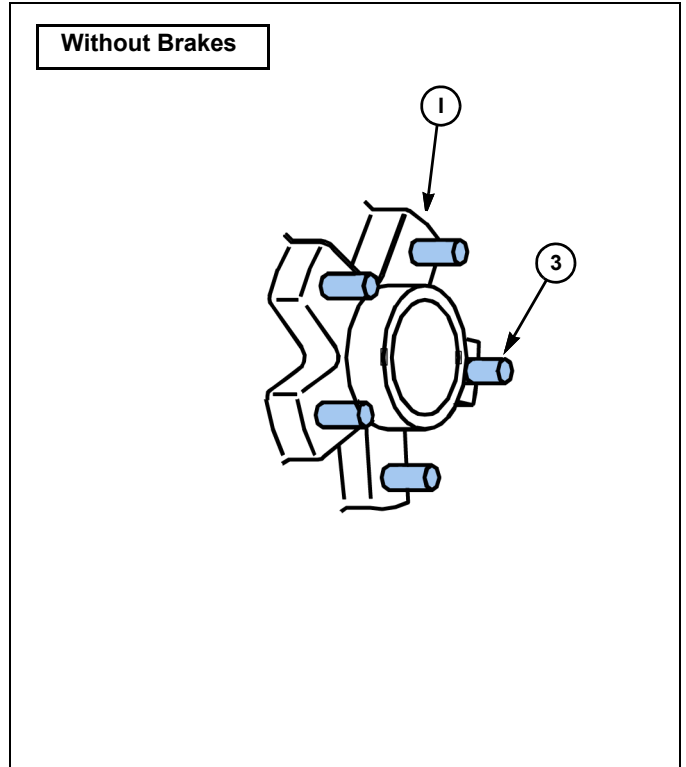
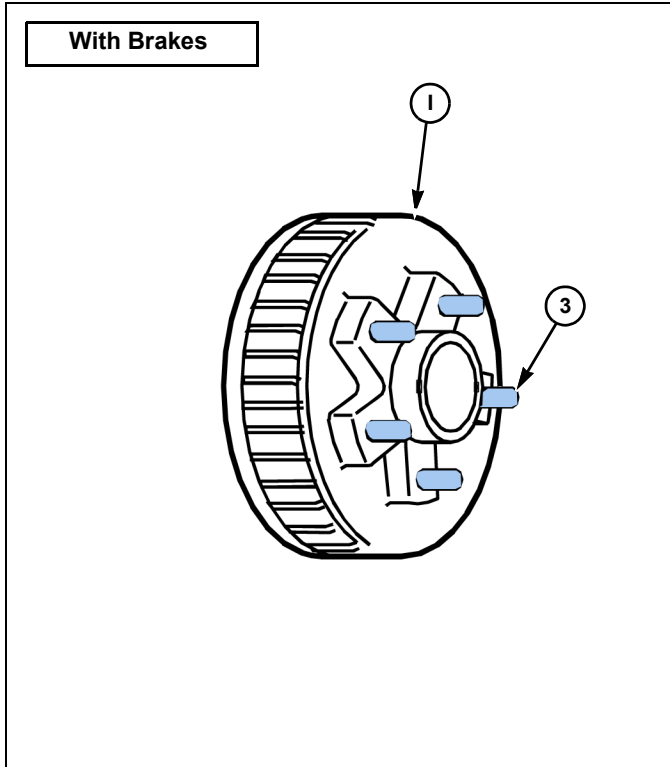

10. Reinstall hub (1) to axle (B).

11. Reinstall outer bearing (H), align washer (G), and thread on spindle nut (F).

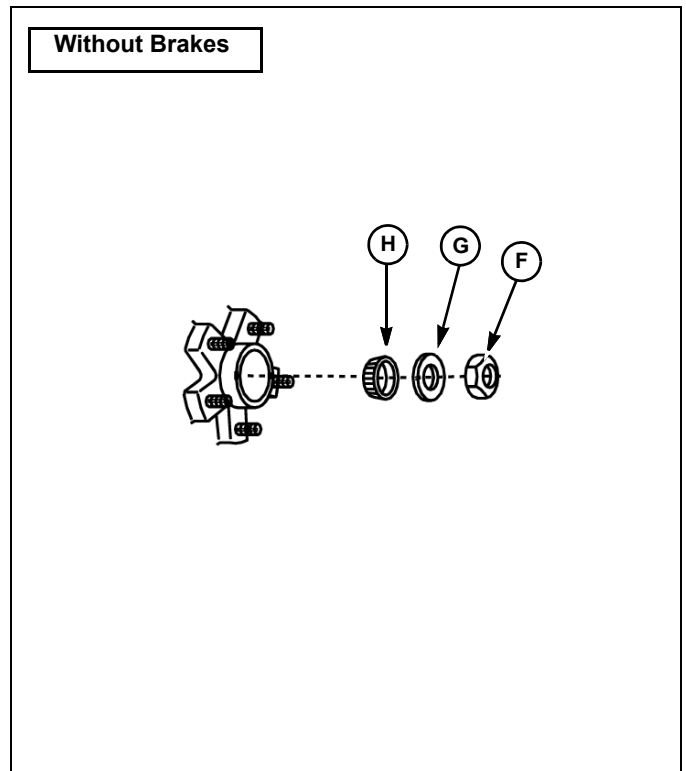
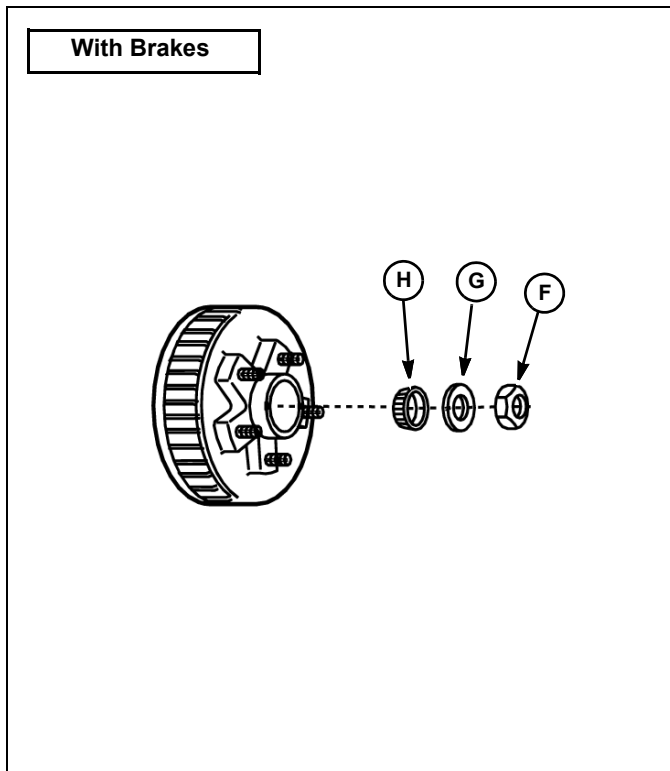

12. Rotate hub assembly slowly while tightening the spindle nut to approximately 50 ft-lbs (68 Nm).

13. Loosen the spindle nut to remove torque, finger tighten nut until just snug.

14. Align the nut retainer (E) to spindle flat and snap into place.

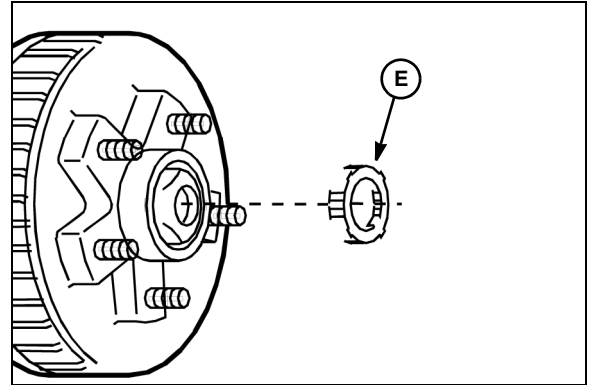

15. Reinstall grease cap (D).

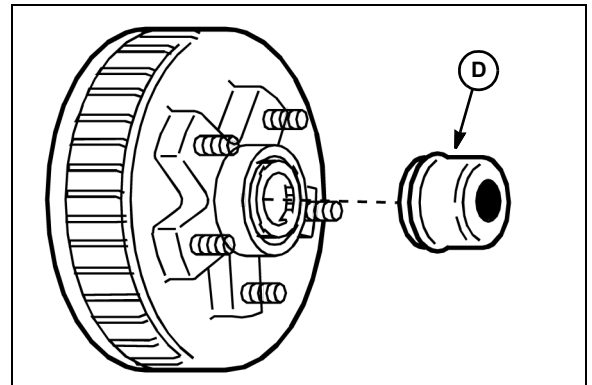

16. Remove rubber plug (K) from end of grease cap (D).

17. With standard grease gun, finish filling the hub with grease while rotating hub/drum until grease expels from outer bearing inside of grease cap (D).

NOTICE: It is not recommended to use pneumatic powered (air) grease guns, this could damage seal or push seal out of hub and brakes could become unstable.

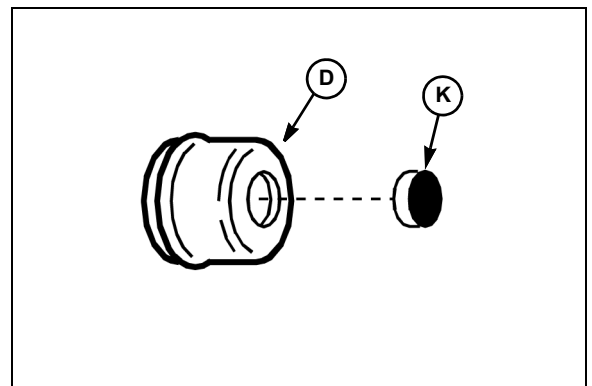

18. Reinstall rubber plug (K).

19. Mount retained wheel and rim (C).

20. Install five new lug nuts (4) to studs (3) and torque each to 95 ft-lbs (129 Nm).

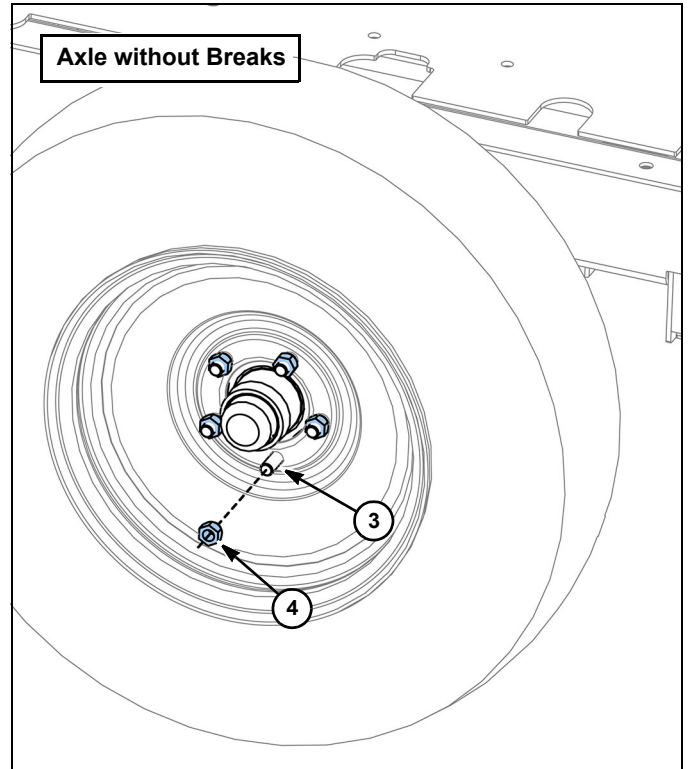
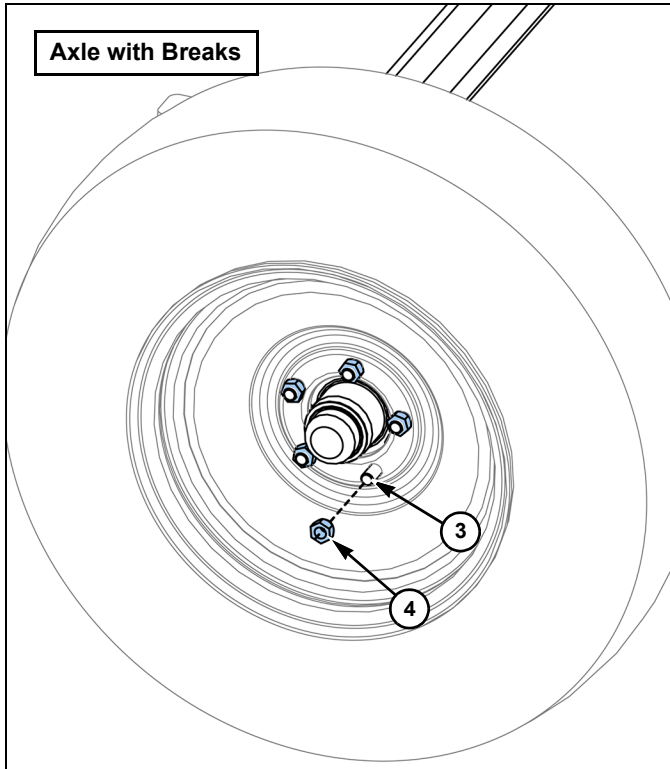

21. Repeat steps 4 – 20 to other wheel.

22. Remove jackstands or blocks and lower jack.

23. Remove Figure 1 and attach to the invoice or place in the manual storage box so unit owner can place with existing Parts Manual.

IK04 Lug Nut Inspection Procedure:

1. Follow shutdown procedure.
2. Remove lug nut.

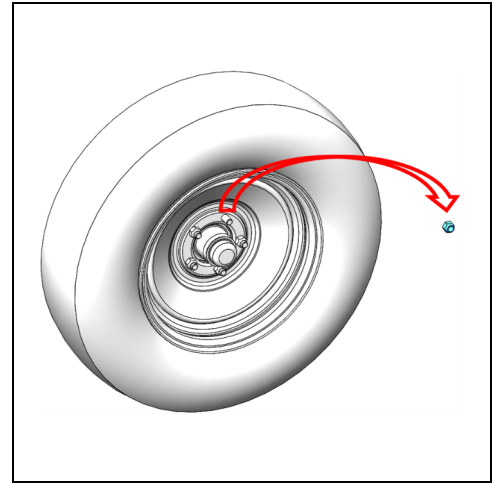

3. Re-install lug nut.

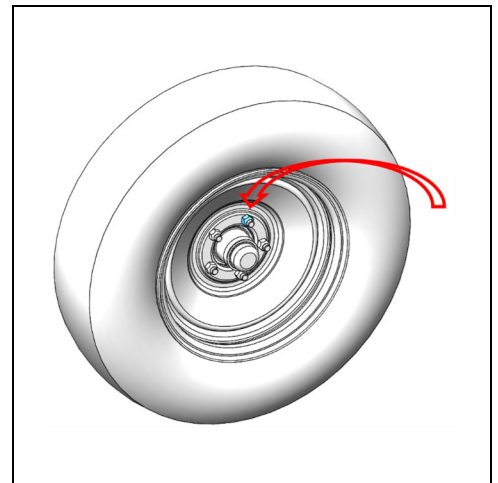

4. Torque to 95 ft-lbs (129 Nm).
5. Repeat for all lug nuts.
6. If all lug nuts torque to 95 ft-lbs (129 Nm), **no action is needed.**
 - Email completed lug nut inspection form to safetyforms@vermeer.com to receive \$50.00 parts credit certificate, and for Vermeer to update records.

7. If any lug nuts are stripped, broken, or unable to maintain 95 ft-lbs (129 Nm) torque, **further actions are required.**
- Contact your local Vermeer dealer immediately to make arrangements to get IK034561 installed.
 - Email completed lug nut inspection form to safetyforms@vermeer.com to receive \$50.00 parts credit certificate, and for Vermeer to update records.

UNIT OWNER COPY
 Insert into parts manual
 for future reference.

Figure 1

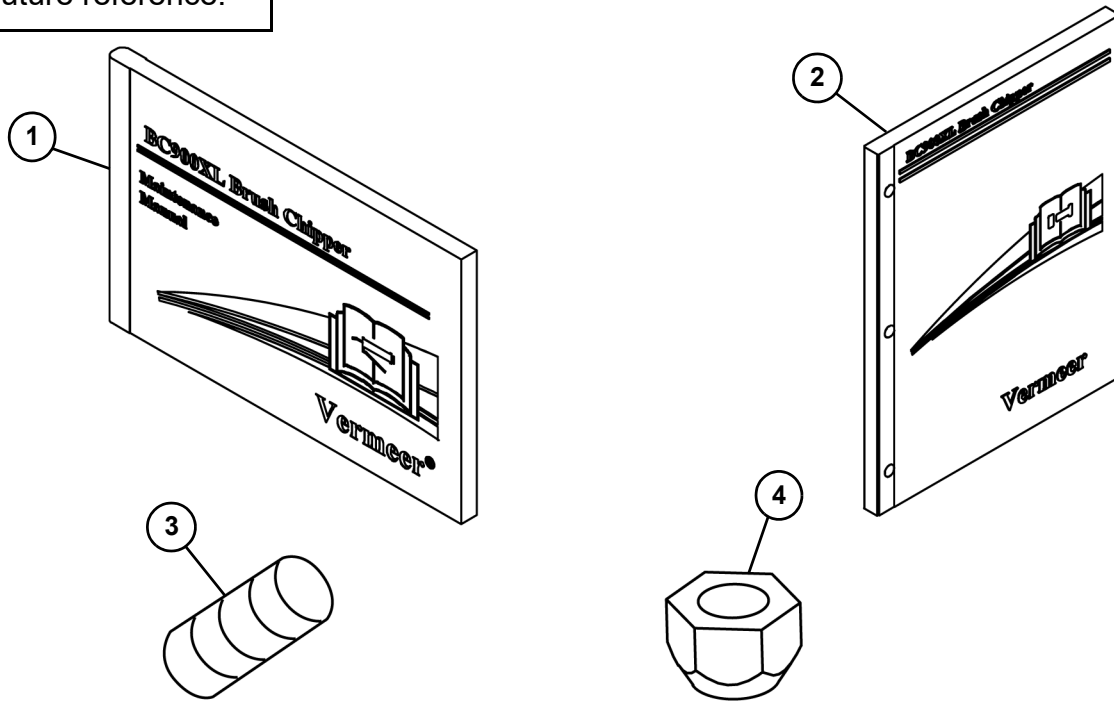

Figure 1 Parts List						
<u>REF. NO.</u>	<u>PART NO.</u>	<u>DESCRIPTION</u>	<u>IK01 QTY.</u>	<u>IK02 QTY.</u>	<u>IK03 QTY.</u>	<u>IK04 QTY.</u>
1	105400DN6	MM-BC900XL (EN) 2ND ED	1	0	0	0
2	105400DP8	BC900XL BRUSH CHIPPER (SM) 2ND ED.	0	1	0	0
3	131334017	STUD-WHEEL (1/2" - 20 X 1.99")	0	0	10	0
4	131334019	NUT WHEEL	0	0	10	0
		Kit includes all items in Figure 1 parts list.				