

SAFETY RECALL

SR23-86A

Date	Expiration	Group	No.	Page
11.2023	NA			1(6)

Revision: A

New vehicles added – VIN list modified

01-16-2024

LOOSE POWER CABLE CONNECTIONS 9700
9700 (B13R)

MODEL YEAR(S) AND VEHICLE SERIAL NUMBERS (VIN) INVOLVED

NOTICE TO SERVICE CENTERS <i>Verify vehicle eligibility by checking recall status with SAP or via ONLINE WARRANTY SYSTEM available on Service / Warranty tab of Prevost website.</i>	
Model	VIN
Volvo 9700 us/can Model Year : 2023	
This recall does not necessarily apply to all the above-mentioned vehicles, some vehicles may have been modified before delivery. The owners of the vehicles affected by this recall will be advised by a letter indicating the Vehicle Identification Number (VIN) of each vehicle concerned.	

DESCRIPTION

On the vehicles affected by this recall, certain fasteners securing power cable connections may not have been adequately torqued at the Volvo factory.

MATERIAL

Special equipment required:

Part No.	Description	Qty
N/A	3/8" Torque Wrench (Nm and ft-in units)	1

PROCEDURE

Writer: oel

<QF7720963 rev4>



DANGER

Park vehicle safely, apply parking brake, stop the engine. In the battery box, set the battery cut-off switch to the OFF position prior to working on the vehicle.

Lockout & Tag out (LOTO) must be performed during set-up, maintenance or repair activities. Refer to your local procedure for detailed information regarding the control of hazardous energy.

Loose Power Connection

1. Locate the vehicle batteries compartment.

Note: The batteries compartment is located at the right (curb) side over the drive wheels.

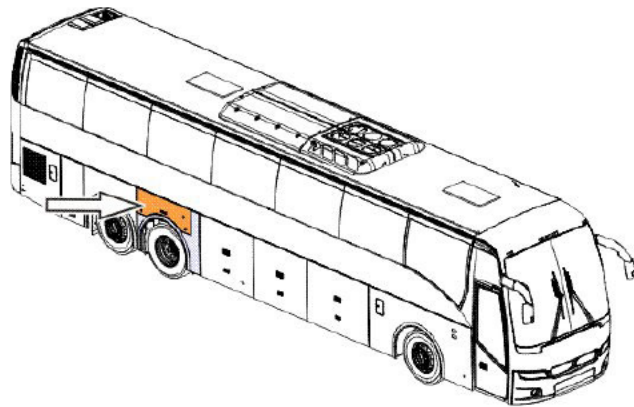

FIGURE 1

2. Open the batteries hatch.

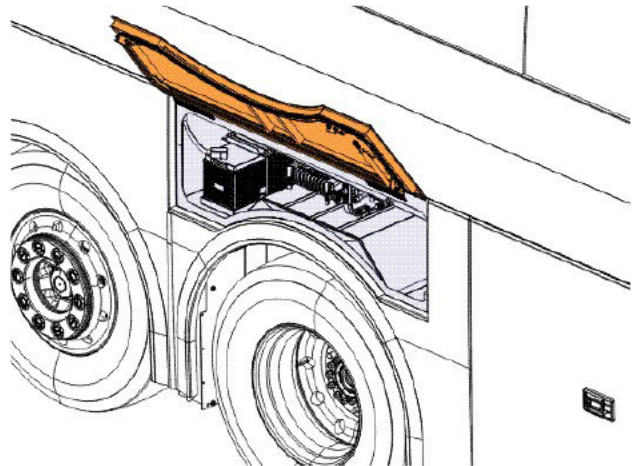

FIGURE 2

3. Turn off the battery switch.

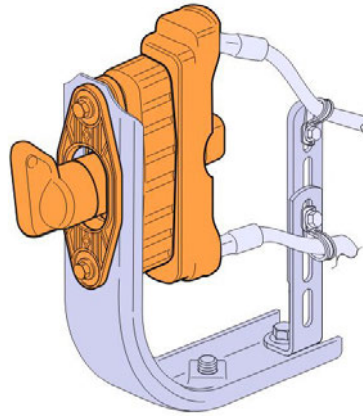

FIGURE 3

4. Remove the protective covers from the batteries and the electrical terminal block.

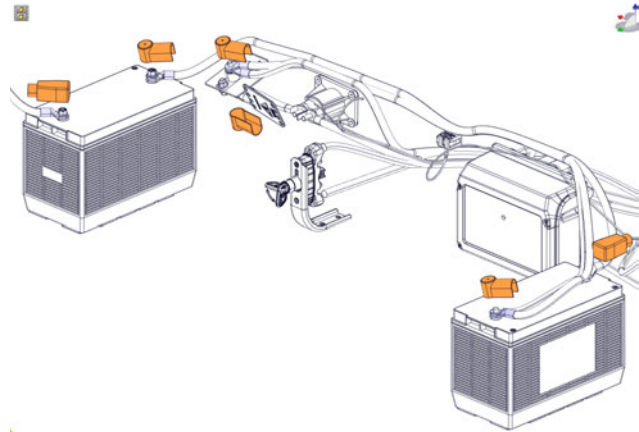

FIGURE 4

5. Tighten firmly both battery nuts on each battery.

Torque: 4–6 ft-lb (5.4–8.1 Nm)

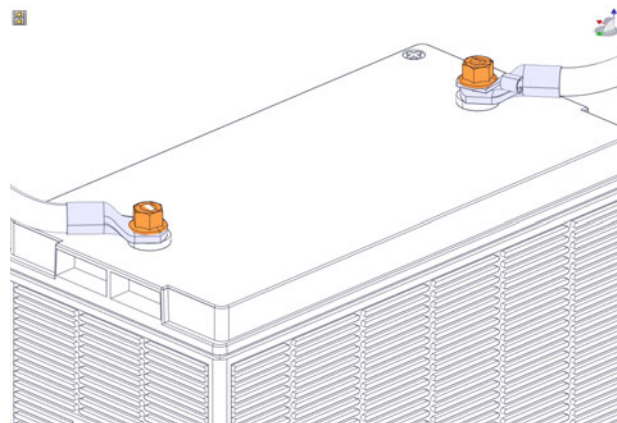

FIGURE 5

6. Tighten the electrical terminal block nuts (top and underside).

Torque: 10–15 ft-lb (13.5–20.3 Nm)

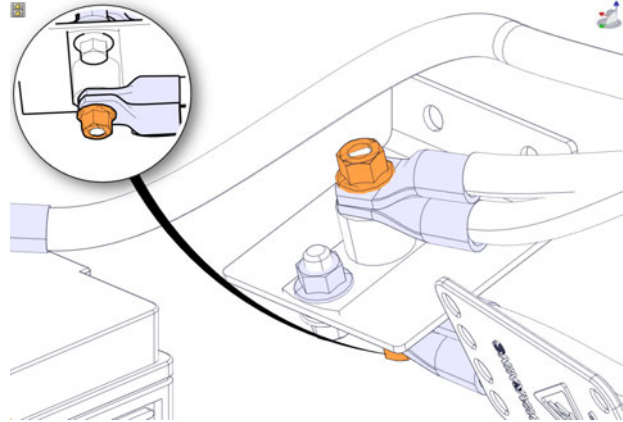

FIGURE 6

7. Tighten the underside terminal with the screw and nut.

Torque: 10–15 ft-lb (13.5–20.3 Nm)

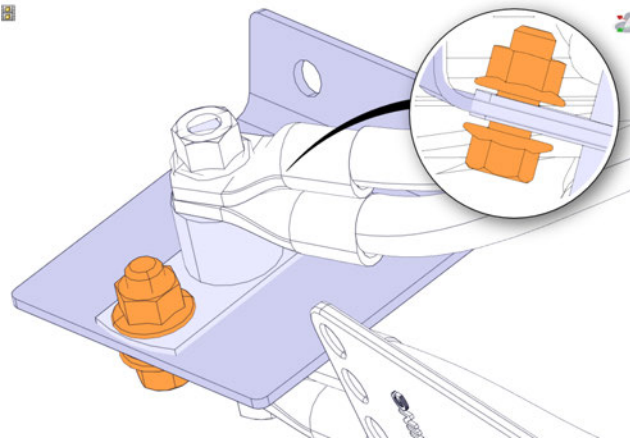

FIGURE 7

8. Install the protective cover over the batteries and the electrical terminal block.

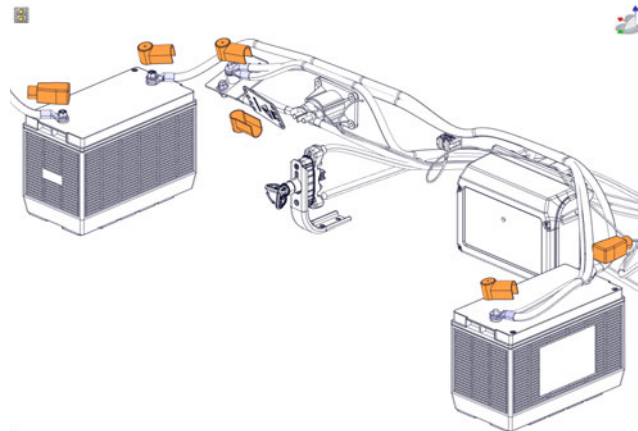

FIGURE 8

9. Turn on the battery switch.

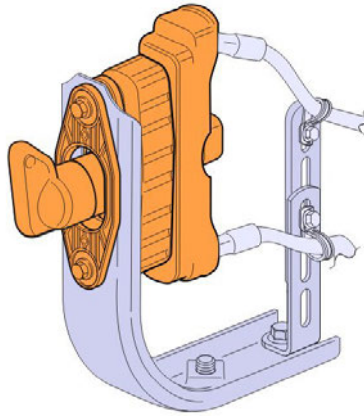

FIGURE 9

10. Close the batteries compartment.

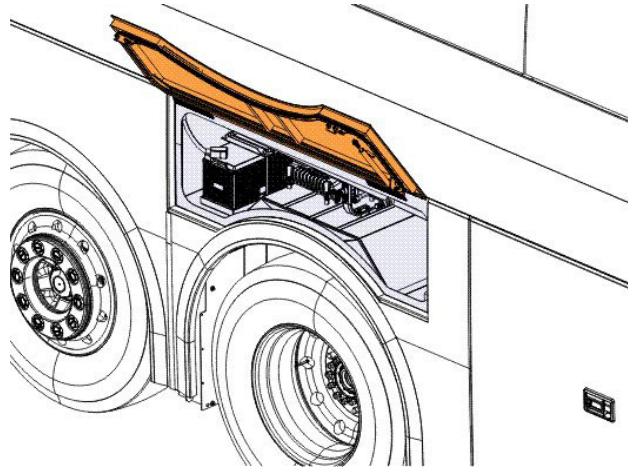

FIGURE 10

WARRANTY

This modification is covered by Prevost's normal warranty. We will reimburse you the parts and 1/2 hour (0.5) of labor upon receipt of a completed A.F.A. Please submit claim via our Online Warranty System, available at www.prevostcar.com (under Service \ Warranty section). Use Claim Type: "Bulletin/Recall" and select "Safety Recall SR23-86".

SAFETY RECALL

SR23-86A

Date Expiration Group No. Page
11.2023 NA 6(6)

OTHER

VBC Bulletin	C0832
Fail Code	06.11
Defect Code	09
Syst.Cond.	R
Causal Part	21258363

Access all our Service Bulletins on
<http://prevostparts.volvo.com/technicalpublications/en/publications.asp> or scan the QR-Code with your smart phone.

E-mail us at technicalpublications_prev@volvo.com
and type "ADD" in the subject to receive our warranty
bulletins by e-mail.



Prevost engages in a continuous program of testing and evaluating to provide the best possible product. Volvo Bus, however, is not committed to, or liable for updating existing products.