

REFERENCE:	Nova Bus Manuals
SECTION:	04: Air Spring and Front Suspension
RS N°:	MQR 7621-2754
EFFECTIVE IN PROD.:	LE90 (2023JL)
TC RECALL N°:	2023-682
NHTSA RECALL N°:	23V866

APPLICATION DEADLINES: N/A CLAIM  
REFERENCE NUMBER: SR5537

SUBJECT:	Front air springs anchor plate
JUSTIFICATION:	The affected vehicles may have the front air spring hardware attachment points that may fail due to an improper anchor plate. The air spring hardware may dislodge from the anchor plate which in turn may result in the sudden loss of suspension resulting in an increased risk of a crash.

LEVEL	DESCRIPTION	DIRECT CHARGES		TIME
		LABOUR	MATERIAL	
1	Replace the air spring anchor with new N57071 anchor plate.	Nova Bus	Nova Bus	3h
2	–	–	–	–

#### MATERIAL REQUIRED PER VEHICLE

QTY	PART N°	REV.	DESCRIPTION
<b>LEVEL 1</b>			
4	N57071	B	Air Spring Anchor Plate
<b>LEVEL 2</b>			
–	–	–	–

Materials will be available within 47 days once your order has been placed.

To order, please contact [novabus.parts@volvo.com](mailto:novabus.parts@volvo.com)

Or by phone for CANADA 1-800-771-6682, for USA 1-877-999-8808

Specify document number, quantity of parts required and shipping address.

#### DISPOSAL OF PARTS

REMOVED PARTS ARE:	DISCARDED *	RETAINED	* Dispose of the unused parts and the defective parts in accordance with local environmental standards in effect.
	Yes	–	

#### REVISION HISTORY

REV.	DATE	CHANGE DESCRIPTION	WRITTEN BY
NR	2024JA31	Initial release	Luc Carignan

APPROVED BY:

NQF705003 VERSION 5

Irina

Negoescu

Signature  
numérique de  
Irina Negoescu  
Date : 2024.01.31  
13:55:46 -05'00'

PAGE 1 OF 7

CLIENT	ORDER	ROAD NUMBER		VIN (2NVY/4RKY...)		QTY
		FROM	TO	FROM	TO	
Burlington - Ontario - Metrolinx	LF32	7-2306	7-2309	L82J9P3	[REDACTED]	4
Hamilton - Ontario - Metrolinx	LF27	2252	2256	L82K0P3	[REDACTED]	5
Hamilton - Ontario - Metrolinx	LF27	2258	2261	L82K6P3	[REDACTED]	4
Hamilton - Ontario - Metrolinx	LF27	2263	2269	L82KXP3	[REDACTED]	7
Hamilton - Ontario - Metrolinx	LF27	2275	2275	L82K3P3	[REDACTED]	1
Hamilton - Ontario - Metrolinx	LF27	2277	2283	L82K7P3	[REDACTED]	7
Moncton (Codiac) - New Brunswick	LF47	—	—	L82J7P3	[REDACTED]	1
Moose Jaw - Saskatchewan	LF44	18	18	L82J3P3	[REDACTED]	1
Toronto Transit Commission - TTC - Ontario	LE65	7118	7118	L82LXP3	[REDACTED]	1
Toronto Transit Commission - TTC - Ontario	LE65	7121	7123	L82L5P3	[REDACTED]	3
University of Alabama - Alabama	LF40	7040	7048	L82J0P3	[REDACTED]	9

**WARNING**

FOLLOW YOUR INTERNAL SAFETY PROCEDURES.

## PROCEDURE

- 1.1. Park the vehicle on an even surface with the transmission on neutral.
- 1.2. Apply the parking brake and set the master control switch to the **stop** position.
- 1.3. Set the battery disconnect switches in the battery compartment to the **off** position.
- 1.4. Raise the vehicle in a way to have the front axle free for tire removal.

**CAUTION**

For information on hoisting and towing of the vehicle, see section 18: *hoisting and towing* in the Nova Bus maintenance manual. Use appropriate hoisting equipment for your protection and to prevent damage to the vehicle.

- 1.5. Install jack stands under the front axle. See Figure 1.

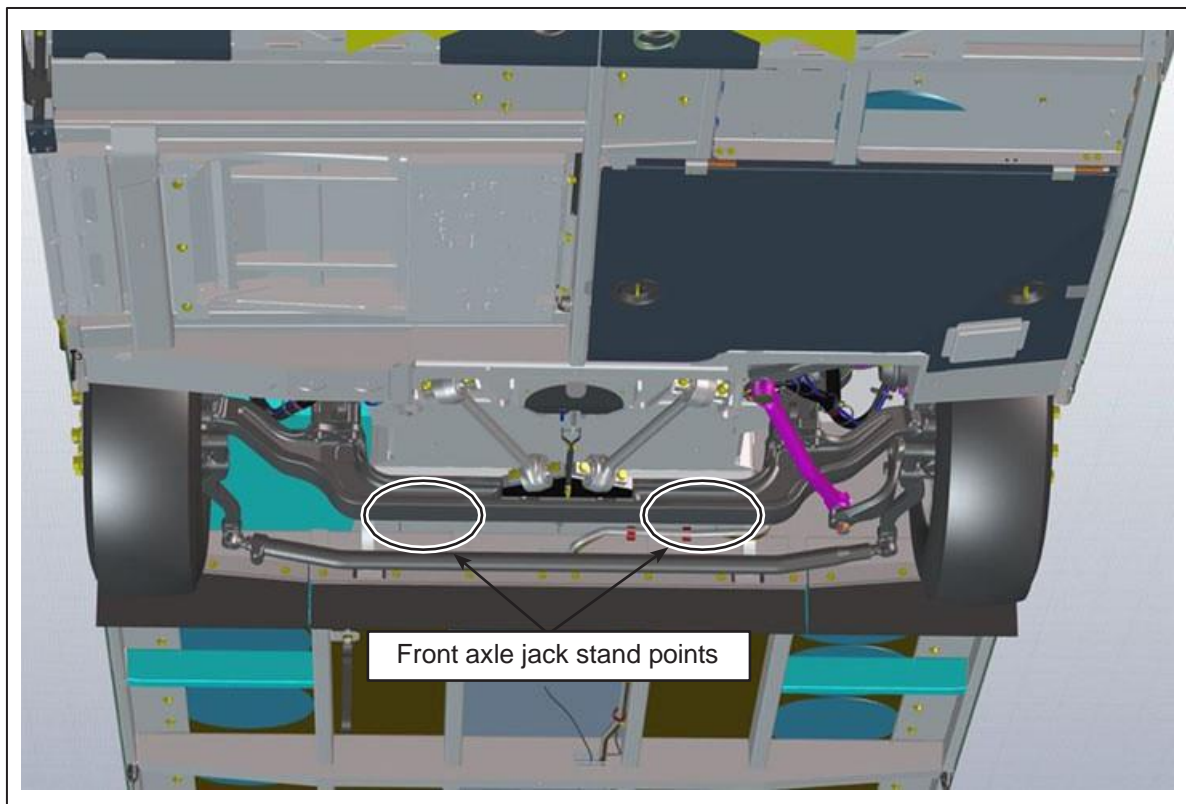

Figure 1 - Front Axle Jack Stand Points

- 1.6. Remove the front wheels. Retain the wheels and nuts. See Figure 2.

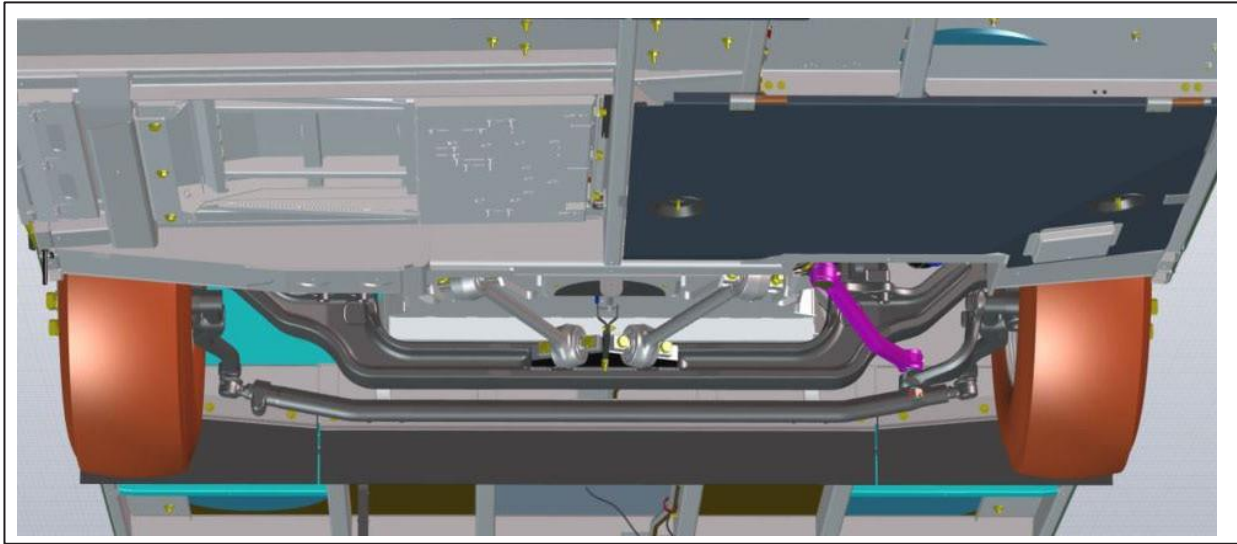

Figure 2 - Front Wheels

- 1.7. Remove the two anchor bolts fixing the air spring plate to the vehicle frame on the street side and curbside. Retain the bolt and washer. See Figure 3.
- 1.8. Lower the air springs top plate in a way to have access to the screws fixing the air spring anchor plate. See Figure 3.

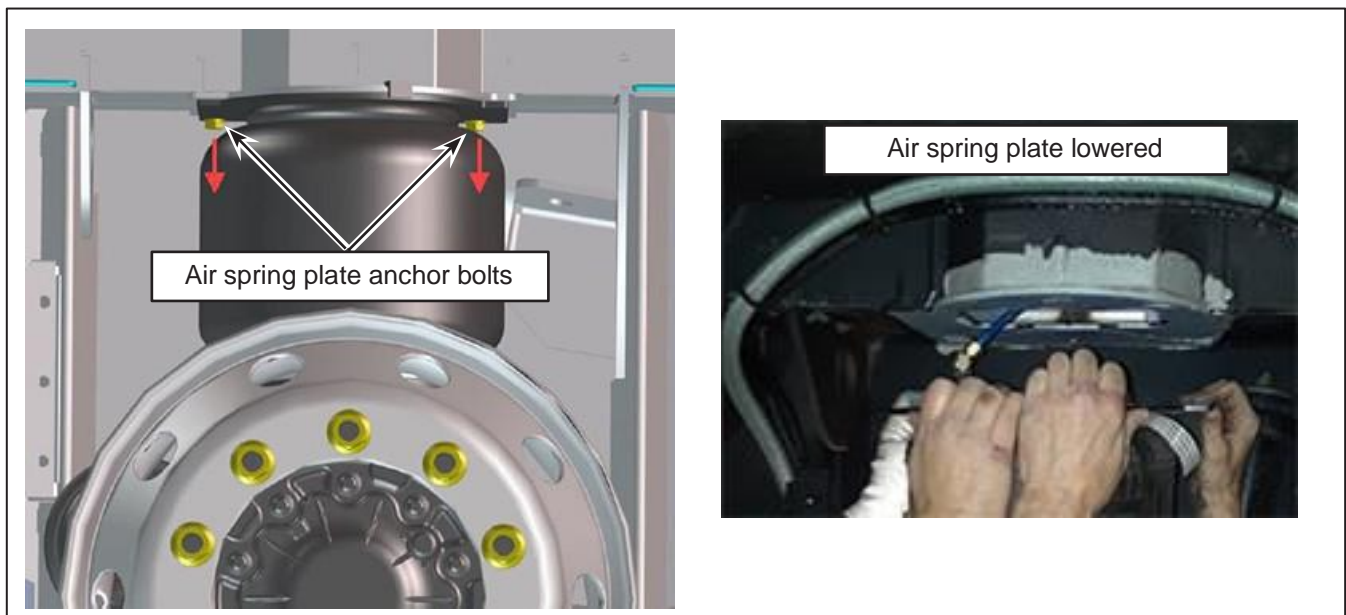
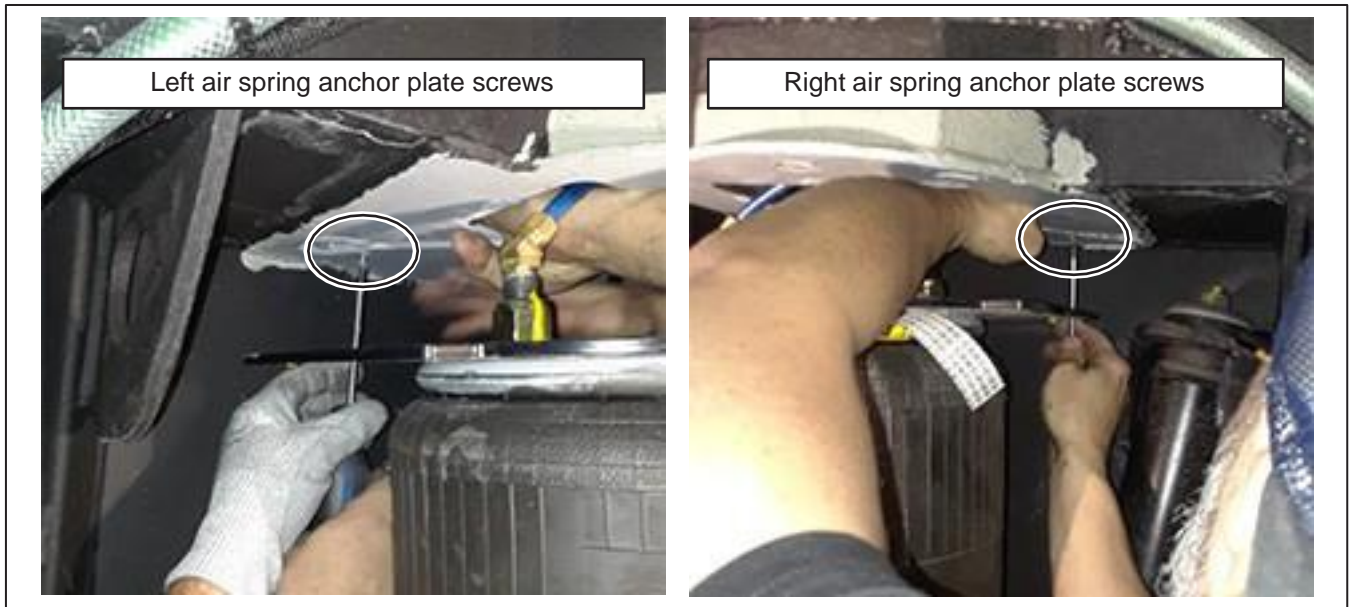

Figure 3 - Air Spring Plate Bolts

- 1.9. Remove the screws fixing the air spring anchor plates on the street side and curbside. Retain the screws. See Figure 4.



*Figure 4 - Air Spring Anchor Plate Screws*

- 1.10. Partially install the retained bolts and washers on the new N57071 air springs anchor plates. See Figure 5.
- 1.11. Fix the new N57071 air spring anchor plates to vehicle frame (street side and curbside) using the retained screws. See Figure 5.
- 1.12. Remove the bolts and washer from the new N57071 air springs anchor plates. Retain the bolts and washers. See Figure 5.

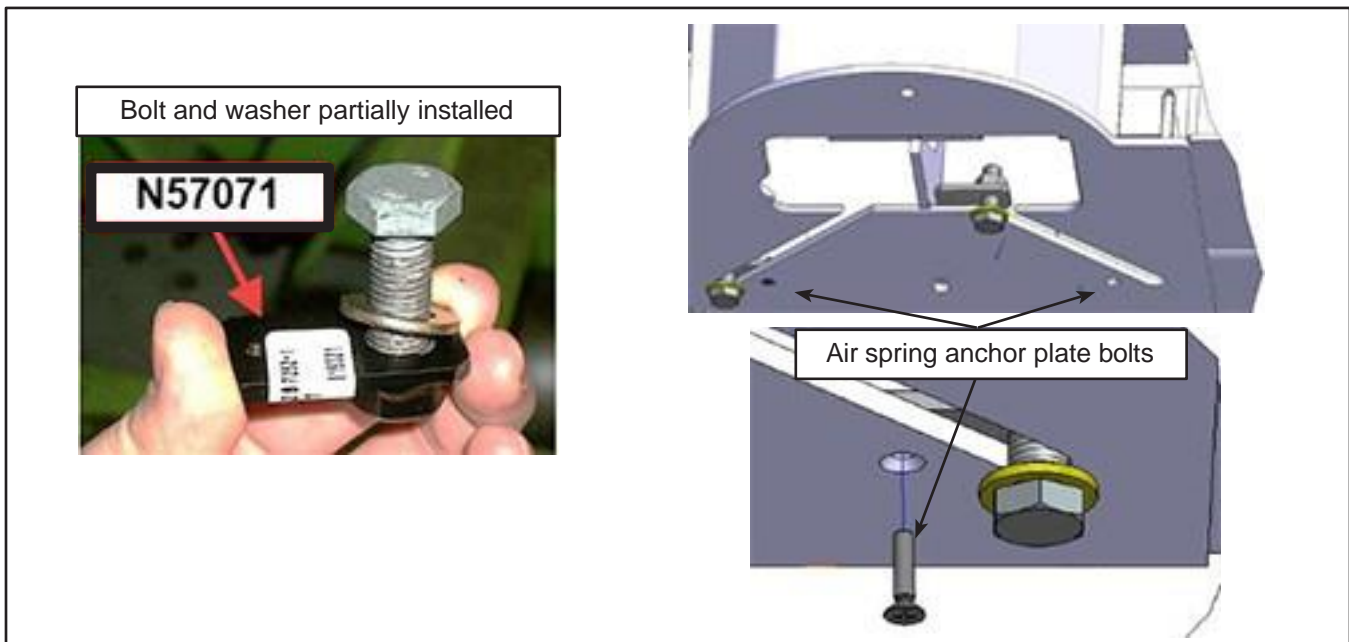

*Figure 5 - Air Spring Anchor Plate Installation*

- 1.13. Apply a thin coat of anti-seize compound on the retained bolts.
- 1.14. Position the air spring plate block on the frame plate as indicated in Figure 6.
- 1.15. Hand tighten the retained bolts and washer in the new N57071 anchor plate. See Figure 6.
- 1.16. Torque the bolts and washers. See Figure 6 for torque value.

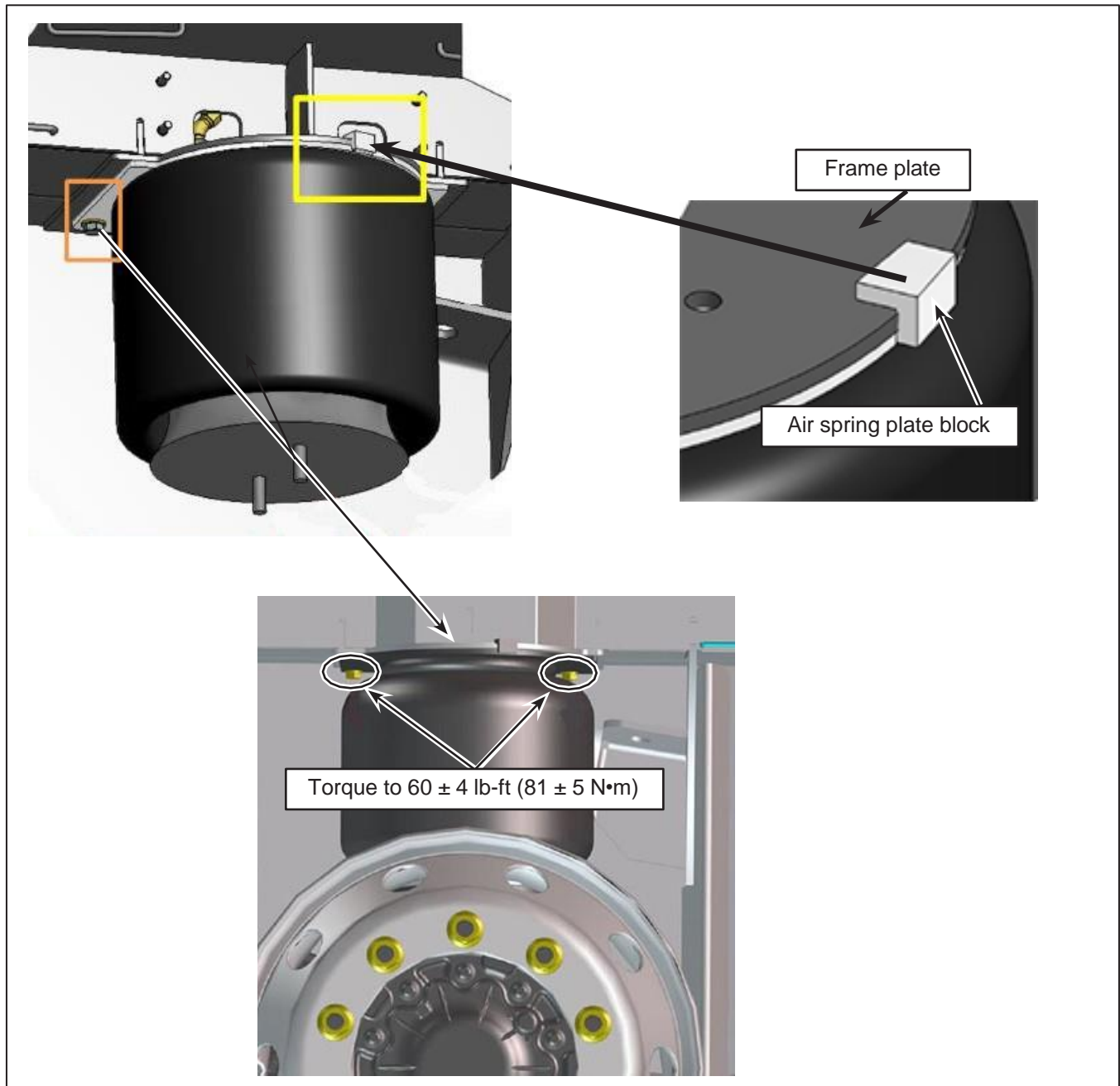

- 1.17. Apply a thin film of non-water-based lubricants to the inner hub bore of the wheels and to the hub pilots.
- 1.18. Install the retained wheels to the front axle using the retained nuts.
- 1.19. Lightly tighten the nuts so that the wheels are concentric with the hubs. See Figure 7 for the torque sequence.
- 1.20. Tighten the nuts progressively in the order shown in Figure 7 until the recommended torque is reached. See Figure 7 for torque value.

**CAUTION**

For the detail wheels installation procedure, see section 06: *Wheels and tires* in the Nova Bus maintenance manual.

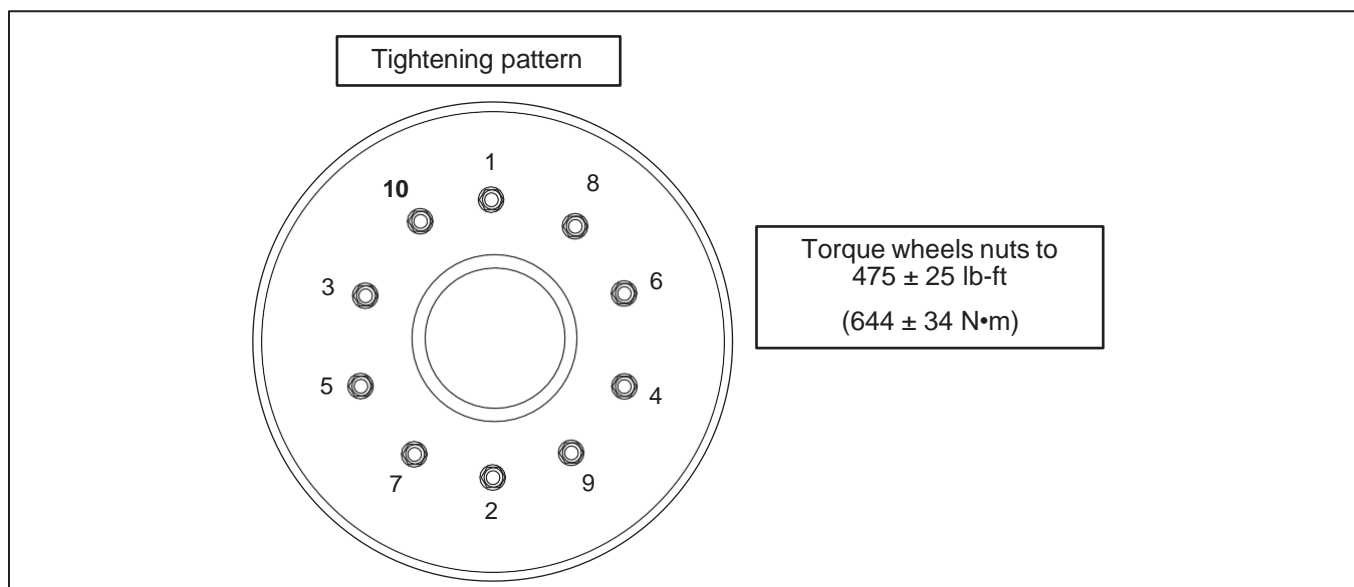

Figure 7 - Wheels Tightening Pattern and Torque Value

- 1.21. Remove the jack stand installed under the front axle.
- 1.22. Lower the vehicle.

