

Safety Recall: 2013-16 CR-V Fuel Pump Module Set/Assembly Replacement

AFFECTED VEHICLES

Year	Model	Trim Level	VIN Range
2013–16	CR-V	ALL	Check the iN vin status for eligibility

BACKGROUND

A certain number of 2013-16 CR-V units may have received a **fuel pump assembly service part** with defective impellers. Due to swelling of the fuel pump motor impeller, the fuel pump may seize and stop working. A defective impeller may cause the fuel pump to become inoperative, which could prevent an engine from functioning as intended. This limitation may cause a loss of motive power or a stall while driving increasing the risk of a crash or injury, creating a safety hazard. If this bulletin appears during an iN VIN status inquiry, the vehicle is subject to a safety recall. Any affected vehicles in your dealer inventory are on STOP SALE until further notice. Refrain from calling Tech Line for updates.

CUSTOMER NOTIFICATION

Owners of the affected vehicles will be sent a notification of this campaign. They will be informed that due to a limited supply of parts (at this time) Honda is prioritizing the repair of customer vehicles experiencing symptoms related to this recall.

When adequate replacement parts become available, Honda will send a follow-up letter to customers instructing them to schedule an appointment for all vehicles affected by this recall. If a customer experiences the known symptoms associated with this safety recall (see CORRECTIVE ACTION), they are instructed to contact their local Honda dealer for the repair.

For any questions or concerns customers may have, you may have them contact American Honda Customer Support & Campaign Center at **1-888-234-2138**.

The following suggested text should be included on any repair order for an already sold affected vehicle that comes in for service. This information should be printed out completely any time service is conducted on an affected vehicle, and the recall repair has not yet been completed. Depending on parts availability, the normal procedures under SOM 7.2.1 will apply for this recall.

Suggested Verbiage to be Included on the Repair Order

Customer was advised that:

The vehicle is subject to a recall affecting the fuel pump motor. The parts necessary to complete the recall repair are currently limited. Vehicles with eligible VINs and the following symptoms: difficulty starting, engine hesitation while driving, are eligible for immediate repair. Once parts repair kits are available, if the vehicle has not been repaired, the registered owner of the vehicle will receive a notice to bring the vehicle in for a replacement of the components, regardless of symptom.

CORRECTIVE ACTION

Replace the fuel pump module set.

CUSTOMER INFORMATION: The information in this bulletin is intended for use only by skilled technicians who have the proper tools, equipment, and training to correctly and safely maintain your vehicle. These procedures should not be attempted by "do-it-yourselfers," and you should not assume this bulletin applies to your vehicle, or that your vehicle has the condition described. To determine whether this information applies, contact an authorized Honda automobile dealer.

PARTS INFORMATION

Part Name	Part Number	Quantity
Fuel Pump Module Set (2013–14 models)	17045-T0A-020	1
Fuel Pump Module Set (2015–16 models)	17045-T1W-A01	1
Fuel Feed Quick-Connect Retainer	17711-SDC-L01	1

For dealers experiencing a strong fuel smell from storing a fuel pump motor replaced under this service bulletin, the fuel pump motor may be disposed of immediately in accordance with local regulations. This only applies to the fuel pump motor replaced under this service bulletin. The published retention policy remains in effect for all other parts.

If you have any questions about this exception or other parts retention issues, contact the WPI Administrative Office at **937-642-2737**.

TOOL INFORMATION

Tool Name	Part Number	Quantity
Fuel Pump Locknut Wrench (2013–14 CR-V)	07AAA-T0A0100	1
Fuel Pump Locknut Wrench (2013–16 CR-V)	070AA-T0AA100	1

WARRANTY CLAIM INFORMATION

Operation Number	Description	Flat Rate Time	Defect Code	Symptom Code	Template ID	Failed Part Number
3101EH	2013–14: Replace the fuel pump module set.	0.3 hr	6FE00	EIL00	A24073A	17045-T0A-020
3101EH	2015–16: Replace the fuel pump module set.	0.3 hr	6FE00	EIL00	A24073B	17045-T0A-010

Skill Level: Repair Technician

REPAIR PROCEDURE

1. Relieve the fuel pressure.
 - 2013–2014 Steps 1–3, *Fuel Pressure Relieving Procedure*, ([CLICK HERE](#)).
 - 2015–2016 Steps 1–2, *Fuel Pressure Relieving Procedure*, ([CLICK HERE](#)).
2. Do the battery terminal disconnection procedure.
 - 2013–2014 *Battery Terminal Disconnection and Reconnection*, ([CLICK HERE](#)).
 - 2015–2016 *Battery Terminal Disconnection and Reconnection*, ([CLICK HERE](#)).

3. Pull the release strap, then flip the rear seat cushion forward to gain access to the fuel tank unit access panel.

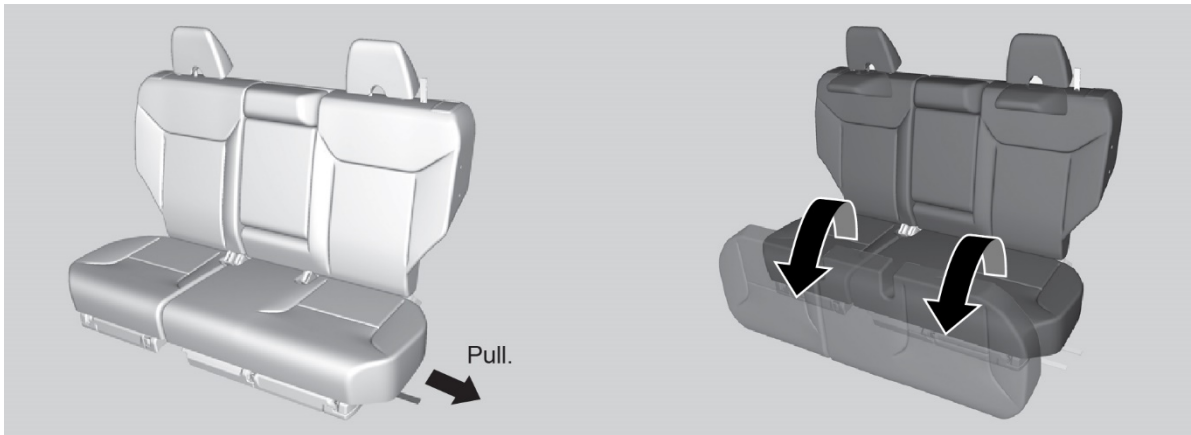

4. Remove the fuel unit and replace it with the new one.
- 2013–2014 Removal steps 5–7 and Installation steps 1–6, *Fuel Tank Unit Removal and Installation*, [CLICK HERE](#)
 - 2015–2016 Removal steps 2–5 and Installation steps 1–5, *Fuel Tank Unit Removal and Installation*, [CLICK HERE](#)
5. Install all remaining parts in the reverse order of removal.
6. *California residents only:* Fill out a Vehicle Emissions Recall – Proof of Correction certificate and use **EIL** as the recall number. Have the service advisor give the certificate to your customer and advise him or her to keep it as proof that the recall was completed. Your customer will need to submit this certificate to the DMV only if the DMV requests it. If you need more certificates, use reorder number **Y0657**.

Vehicle Emission Recall - Proof of Correction				
License Number	Make	Year Model	Body Type	Vehicle Identification Number
				<input type="text"/>
Manufacturer _____			Recall Number EIL	
The above described vehicle has been repaired, modified and/or equipped with new emission control devices to meet applicable California Emission Control Laws.				
Dealer's Name		Address, City, State and Zip		
Date	Dealership's Authorized Signature			
	X			
Return this certificate to DMV only when required - otherwise retain for your records.				

Y0657 ACL 24832 (0212)