



Technical Service Bulletin

GROUP	NUMBER
RECALL	23-01-083G
DATE	MODEL(S)
OCTOBER 2023	GV70 (JK1) GV80 (JX1) G80 (RG3)

SUBJECT: LOW PRESSURE FUEL PUMP REPLACEMENT (RECALL 016G)

★ IMPORTANT

Vehicle repairs related to safety recalls are critically important and must be performed properly in accordance with TSB procedures. Review this bulletin in its entirety prior to beginning any repair work.

As required by federal law, dealers must not deliver new vehicles for sale or for lease to customers until all open recalls have been performed. Dealers must also perform all open recalls on used vehicles, demo, and rental vehicles prior to placing them into customer use and whenever an affected vehicle is in the shop for any maintenance or repair.

Access the "Vehicle Information" screen via WEBDCS to identify open recalls.

Description: The Low-Pressure Fuel Pump assemblies in certain GV70 (JK1), GV80 (JX1), and G80 (RG3) models equipped with 2.5T and 3.5T engines may contain impellers that do not meet current material characteristic specifications, potentially leading to deformation under certain environmental conditions, such as high ambient temperature. Deformation of the impeller could cause the impeller to interfere with the fuel pump housing, resulting in a mechanical resistance that could lead to a shutdown of the fuel pump. A shutdown of the fuel pump could restrict fuel flow to the engine, resulting in a sudden reduction or loss of motive power, increasing the risk of a crash.

Follow the Service Procedure outlined in this bulletin to replace the Low-Pressure Fuel Pump using the service kit.

Applicable Vehicles (Certain):

- 2022MY GV70 (JK1) produced from 06/01/2021 - 01/19/2022
- 2021-2022MY GV80 (JX1) produced from 06/09/2021 - 12/03/2021
- 2021-2022MY G80 (RG3) produced from 06/01/2021 - 12/29/2021

SST Information:



Tool Name	Tool #	Figure	Remarks
Lock Ring Wrench	J-45722		This tool is for removing/installing the fuel pump lock ring.

NOTE 1: J-45722 previously shipped to all dealers as an essential tool.

NOTE 2: Additional Lock Ring Wrenches can be ordered through BOSCH at 1-866-539-4248.

NOTE 3: If further assistance is required, please contact Genesisistools@gma.com.

Parts Information:

Model	Part Name	Part Number	Figure	Remarks
GV70 (JK1)	Low-Pressure Fuel Pump Kit	31133-AR000QQH		<ul style="list-style-type: none"> Kit includes Low Pressure Fuel Pump Assembly with Fuel Level Sending Unit.
GV80 (JX1)		31133-T6000QQH		<ul style="list-style-type: none"> Kit Does Not include the Fuel Tank Pressure Sensor (FTPS) or Fuel Pressure Sensor (FPS), must be transferred from the Old Fuel Pump.
G80 (RG3)		31133-T1000QQH (2.5T)		<ul style="list-style-type: none"> Kit includes Low Pressure Fuel Pump Assembly with Fuel Level Sending Unit.
	31133-T1050QQH (3.5T)	<ul style="list-style-type: none"> Kit Does Not include the Fuel Pressure Sensor (FPS), must be transferred from the Old Fuel Pump. 		

Warranty Information:

Model	Op. Code	Operation	Op. Time	Causal Part	Nature Code	Cause Code
GV70 (JK1)	31D108R0	Low-Pressure Fuel Pump Kit Replacement	0.8 M/H	31133-AR000QQH	D82	ZZ4
GV80 (JX1)	31D108R1		0.7 M/H	31133-T6000QQH		
G80 (RG3)	31D108R2		0.7 M/H	31133-T1000QQH		

NOTE 1: Submit claim on Claim Entry Screen as “Campaign” type.

NOTE 2: If a part is found in need of replacement while performing this recall and the affected part is still under warranty, submit a separate claim using the same repair order. If the affected part is out of warranty, submit a Prior Approval request for goodwill consideration prior to performing the work.

NOTE 3: This TSB includes Repair validation photos. Op times include VIN, Mileage, and Repair validation photos as outlined in the Digital Documentation Policy.

NOTE 4: The incident parts are subject to callback through the normal Warranty Technical Center (WTC) parts return process. **Claim is subject to debit if the part is not returned.**

Video Procedure:

Click on the link below for video information on the procedure in this Campaign.

Genesis Service Learning – Recall 016G Service Procedure

<https://vimeo.com/871318718/6e313e021a>

Service Procedure:

STUI



This TSB includes Repair validation photos. Refer to the latest Warranty Digital Documentation Policy for requirements.

1. Remove the Low-Pressure Fuel Pump Assembly (A).

Refer to Shop Manual:

- **Engine Control/Fuel System > Fuel Delivery System > Low Pressure Fuel Pump or Fuel Pump > Repair Procedures or Removal and Installation**

NOTICE

Using an Air Nozzle, remove the excess dust and debris to prevent damage to the O-Ring. Clean the sealing surface on the Fuel Tank and position the O-Ring as needed prior to installation.



- 2a. For GV70 (JK1) and GV80 (JX1):

- Remove the Fuel Pressure Sensor (B) and Fuel Tank Pressure Sensor (C) and reinstall to the **New** Fuel Pump Kit.

NOTICE

For this Recall **ONLY**, O-Rings are to be re-used for this TSB, unless they are missing, damaged, or contaminated with foreign substances. If so, they should be replaced.

In all other cases, please refer to the Shop Manual for usage of any other consumable items (including O-Rings).

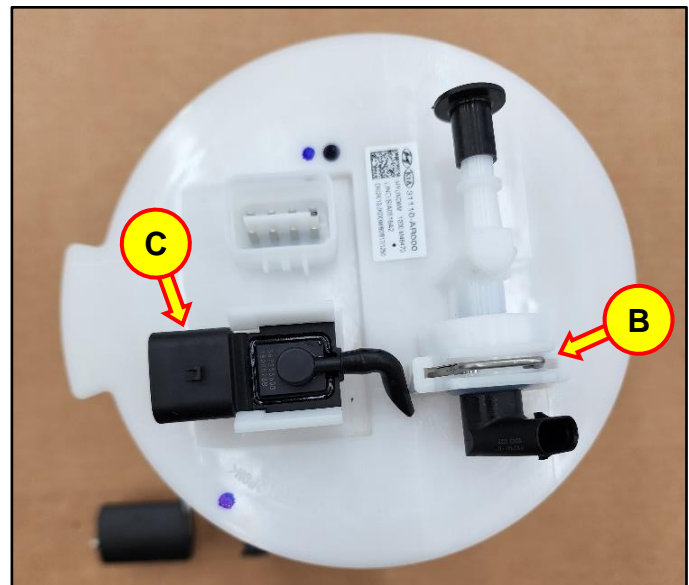

2b. For G80 (RG3):

- Remove the Fuel Pressure Sensor (D) and reinstall to the **New** Fuel Pump Kit.

**Information**

On G80 (RG3) vehicles, the Fuel Tank Pressure Sensor (FTPS) is mounted on the fuel tank, so removal of the FTPS is not required.

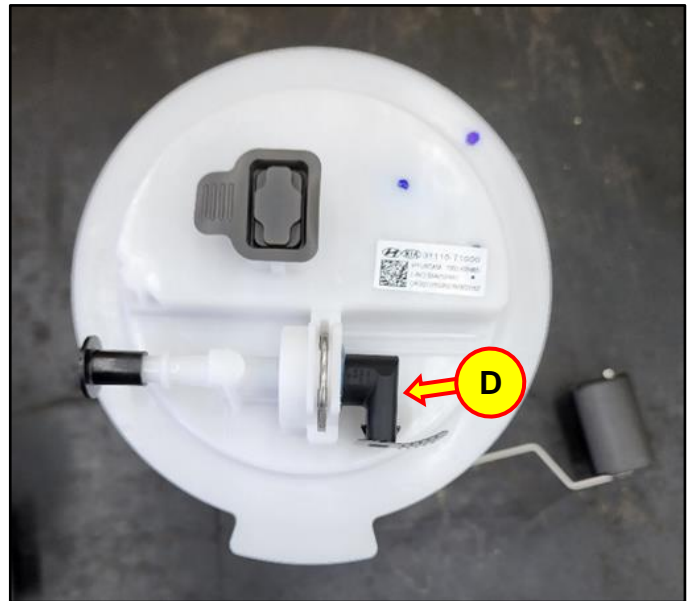

3.

STUI

Using STUI, take a photo of the New Low Pressure Fuel Pump installed on the fuel tank clearly showing the "QQH" label of the pump and a piece of paper with the last 6 digits of the VIN and date of the repair.

Upload the photo to STUI.



- Reinstall and reconnect all components in reverse order of removal.
- Start engine and confirm proper operation, ensuring there are no fuel leaks.
- After completing, clear DTC(s) using diagnostic tool scan tool (the procedure described above may cause DTC to set).
- The service procedure is now complete.