

 **HYUNDAI**
Technical Service Bulletin

| | |
|----------------------------|---|
| GROUP RECALL | NUMBER 23-01-070H |
| DATE AUGUST 2023 | MODEL(S) ELANTRA HYBRID (CN7 HEV) |

SUBJECT: MOTOR CONTROL UNIT (MCU) SOFTWARE UPDATE (RECALL CAMPAIGN 248)

*** IMPORTANT**

Vehicle repairs related to safety recalls are critically important and must be performed properly in accordance with TSB procedures. Review this bulletin in its entirety prior to beginning any repair work.

As required by federal law, dealers must not deliver new vehicles for sale or for lease to customers until all open recalls have been performed. Dealers must also perform all open recalls on used vehicles, demo, and rental vehicles prior to placing them into customer use and whenever an affected vehicle is in the shop for any maintenance or repair.

Access the “Vehicle Information” screen via WEBDCS to identify open recalls.

Description: This bulletin provides information related to a Motor Control Unit (MCU) software update for Elantra Hybrid (CN7 HEV) vehicles. The MCU software may detect a transmission / drive motor synchronization fault triggering a “fail-safe” condition that temporarily results in slow, unintended acceleration following brake pedal release while driving. Brake operation is not affected and remains fully operational and effective to slow the vehicle. Unintended acceleration could increase the risk of a crash.

Applicable Vehicles:

- 2021-2023MY Elantra Hybrid (CN7 HEV) equipped with 1.6L GDI engine produced 12/15/2020-07/29/2023

GDS Information:

System Selection: MCU

| *Event # | Description |
|----------|--|
| 1025 | CN7 HEV WARNING LIGHTS AND SLOW ACCELERATION IMPROVING UPGRADE |

* or use a later available event as listed in the GDS update screen, if one is available.

Warranty Information:

| MODEL | OP CODE | OPERATION | OP TIME | CAUSAL PART | NATURE CODE | CAUSE CODE |
|--------------------------|----------|-------------|---------|-------------|-------------|------------|
| Elantra Hybrid (CN7 HEV) | 31D097R0 | MCU Upgrade | 0.3 M/H | 36600-2BBB0 | I14 | ZZ3 |

NOTE 1: Submit claim on Claim Entry Screen as “Campaign” type.

NOTE 2: If a part is found in need of replacement while performing this recall and the affected part is still under warranty, submit a separate claim using the same repair order. If the affected part is out of warranty, submit a Prior Approval request for goodwill consideration prior to performing the work.

NOTE 3: This TSB includes Repair validation photos. Op times include VIN, Mileage and Repair validation photos as outlined in the Digital Documentation Policy.

Service Procedure:**STUI**

This TSB includes Repair validation photos. Refer to the latest Warranty Digital Documentation Policy for requirements.

MCU Update and ROM Information Table:

| EVENT | MODEL | ENGINE | MCU P/N | ROM ID | |
|-------|--------------------------|---------------|----------------------------|------------------|------------------|
| | | | | OLD | NEW |
| #1025 | Elantra Hybrid (CN7 HEV) | Gamma 1.6 GDI | 36600-2BBB0 36600-2BBB1 | GCNDH21ABMS0-000 | GCNDH23NBMS1-000 |

i Information

You must initially perform GDS MCU Updates #1025 in Auto Mode.

If the MCU Update starts but then fails in Auto Mode, perform the update in Manual Mode to recover.

i Information

1. Verify the vehicle battery has reasonable charge.
2. Turn off all lamps (Do not leave head lamp switch in auto mode.), and all accessories.
3. Perform update with the ignition switch in the **ON** position.
4. Do not disconnect any cables connected to the vehicle or scan tool during update.
5. Do not start the engine during update.
6. Do not turn off the ignition switch during update.

NOTICE

GDS-M Vehicle Battery Low Voltage Warning:

When the vehicle battery is lower than 12 volts, the GDS-M will trigger a Low Battery Voltage Warning. If this Warning occurs,

A. Connect the battery to a fully charged battery jump pack or GR8 charger using “Power Supply Mode” to continue the software update.

OR
B. Select “BACK” to exit the SW update. Then, start the engine and idle with the headlights on for 20 minutes. Return to the SW update after charging the battery.

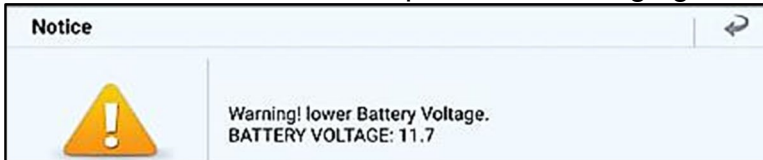

Failure to do either one of these steps can cause the vehicle battery to die during the update, causing the vehicle to become inoperable.

STUI



Take a screenshot of the MCU Update Complete screen using your particular tablet’s screenshot save method and upload to STUI.

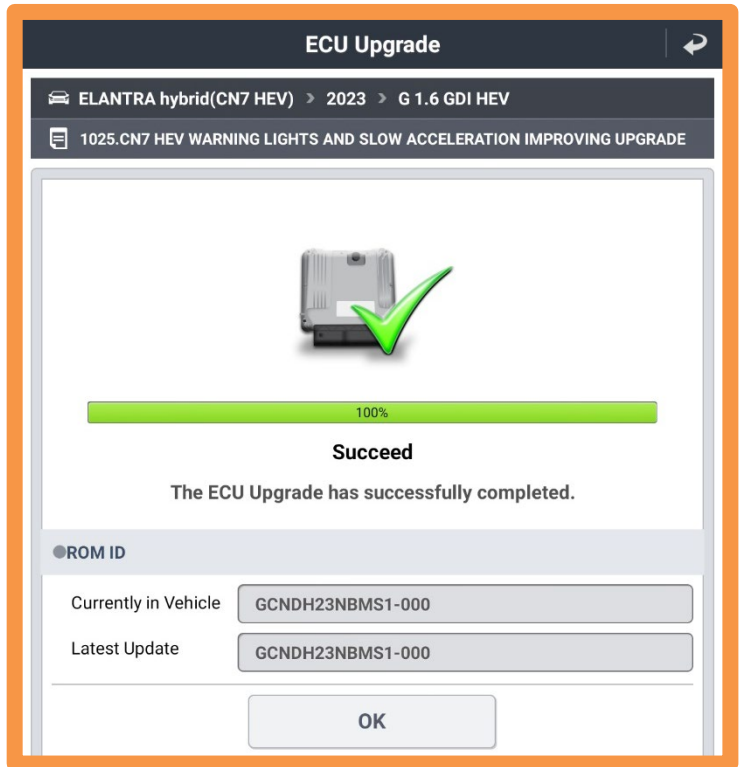

Manual Update: If the MCU Update starts but then fails in auto mode, perform the update in Manual Mode to recover.

| *Event # | MENU | Password |
|----------|--|----------|
| 1025 | CN7 HEV WARNING LIGHTS AND SLOW ACCELERATION IMPROVING UPGRADE | 3660 |