

GLOBAL ENTRY DOOR LATCH INSPECTION/ REPLACEMENT INSTRUCTIONS *MOTORIZED UNITS ONLY

Recall Number:	23E-008		
Product:	Global Latch		
Date:	02.23.2023	Labor Rate:	Inspection Only - 0.3 Hour/Inspect & Replace - 0.7 Hour

Purpose

This document refers to the replacement of the door lock assembly with latch on certain motorized entry doors. A portion of the latch is breaking off when attempting to exit the coach. The complete door lock assembly with latch, PN 2021097898, will be replaced with a redesigned part, if needed.

NOTE: Check first for an "INSPECTED LATCH" sticker on the inside of the door frame between the hinges (Fig. 12). If it is present, report back to the OEM that the VIN has already been addressed.

Safety

This document provides general instructions. Many variables can change the circumstances of any procedure, i.e. the degree of difficulty involved in the service operation and the ability level of the individual performing the operation. This document cannot begin to plot out procedures for every possibility, but will provide the general instructions for effectively installing, removing or servicing the system. In the event the skill level required is too advanced or the procedure too difficult, a certified technician should be consulted before performing the necessary operation. Failure to correctly install, remove or service the system may result in voiding the warranty, inflicting injury or even death.

Resources Required

- Two people
- Cordless or electric drill or screwgun
- Appropriate drive bit
- 7/16" nut driver
- 1/4" screwgun bit
- Replacement complete latch assembly, PN 2021097898, if needed



Inside Latch Assembly



Outside Latch Assembly

GLOBAL ENTRY DOOR LATCH INSPECTION/ REPLACEMENT INSTRUCTIONS *MOTORIZED UNITS ONLY

Recall Number:	23E-008		
Product:	Global Latch		
Date:	02.23.2023	Labor Rate:	Inspection Only - 0.3 Hour/Inspect & Replace - 0.7 Hour

Procedure

Disassemble Latch

1. Open entry door so it is perpendicular to the coach.
2. Peel off adhesive patch covering the access port for the latch fastening nut (Fig. 1).
3. Use 7/16" nut driver to remove threaded nut (Figs. 2 and 3) and set aside.

NOTE: Be careful not to let the nut fall out of the nut driver and down into the door while removing.

Fig. 1

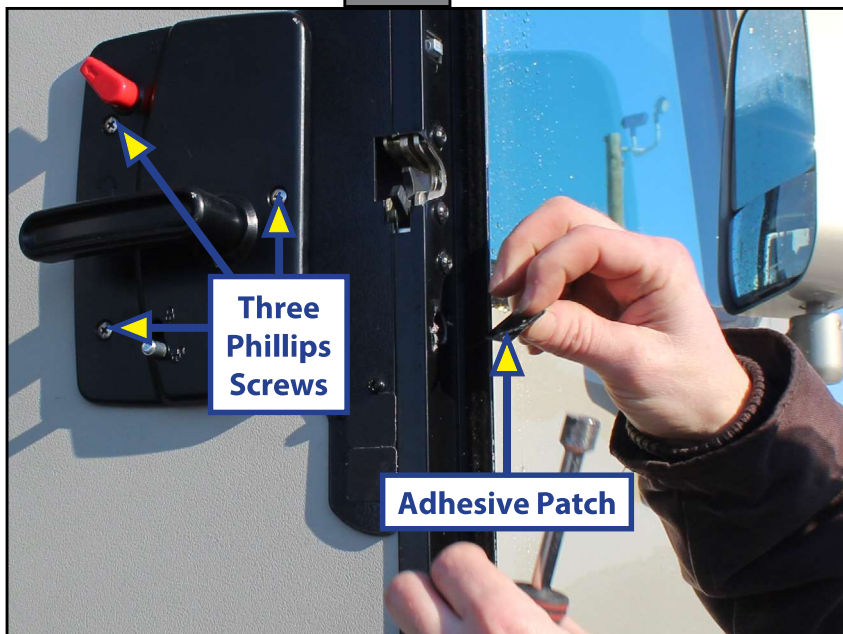

Fig. 2

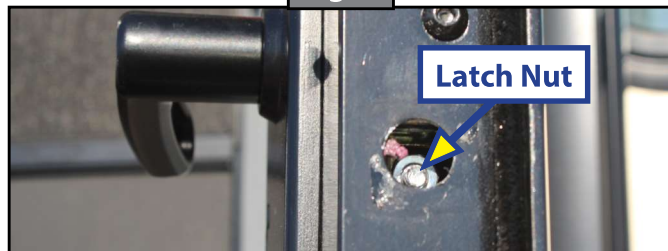
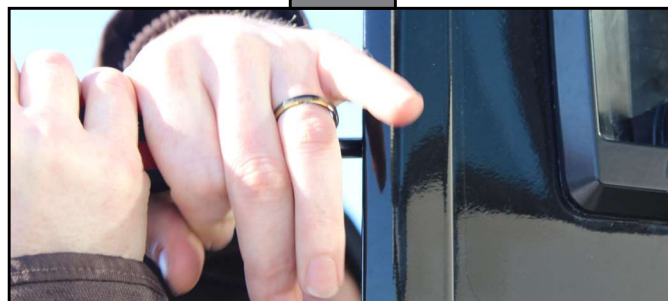

Fig. 3



4. While another person supports the outside latch assembly, remove the three Phillips head screws on the inside of the assembly (Fig. 4) and set aside.
5. Remove both sides of latch assembly.

Fig. 4



GLOBAL ENTRY DOOR LATCH INSPECTION/ REPLACEMENT INSTRUCTIONS *MOTORIZED UNITS ONLY

Recall Number:	23E-008		
Product:	Global Latch		
Date:	02.23.2023	Labor Rate:	Inspection Only - 0.3 Hour/Inspect & Replace - 0.7 Hour

Inspection

NOTE: Check first for an "INSPECTED LATCH" sticker on the inside of the door frame between the hinges (Fig. 12). If it is present, report back to the OEM that the VIN has already been addressed. If not inspected, proceed with inspection.

1. Using a 1/4" screwgun bit, try to insert the bit into the spun rivet of the inside latch assembly (Fig. 5).
2. If bit fits into rivet opening, replace the complete latch assembly including both inside and outside latch assemblies.
3. If the bit does not fit, no action is required. Proceed to latch reassembly instructions.

Fig. 5

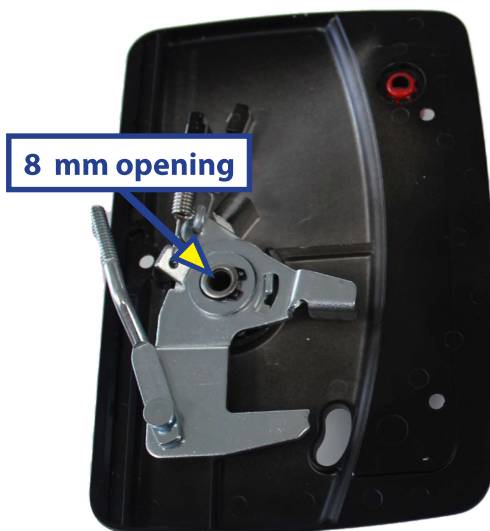
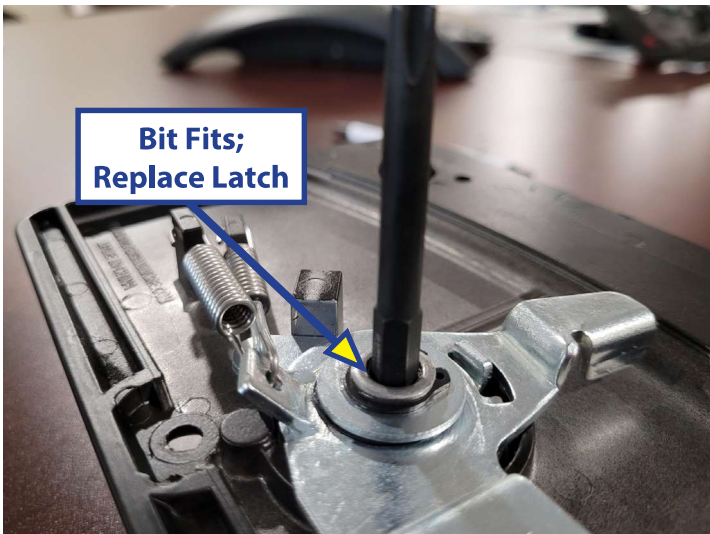

Replace Complete Latch Assembly



Replacement Not Needed

GLOBAL ENTRY DOOR LATCH INSPECTION/ REPLACEMENT INSTRUCTIONS *MOTORIZED UNITS ONLY

Recall Number:	23E-008		
Product:	Global Latch		
Date:	02.23.2023	Labor Rate:	Inspection Only - 0.3 Hour/Inspect & Replace - 0.7 Hour

Reassemble Latch

- Slide inside latch assembly into place. Keep deadbolt handle in the 10 o'clock position (Fig. 6).

NOTE: Do NOT let deadbolt pop out of place. It may be difficult to reinstall.

- While another person holds the inside latch assembly in place, reinstall the latch nut and tighten slowly with nut driver until a few threads of the bolt are visible (Fig. 7).

NOTE: Do NOT tighten nut completely. The latch will not operate correctly if the nut is too tight.

Fig. 6



Fig. 7

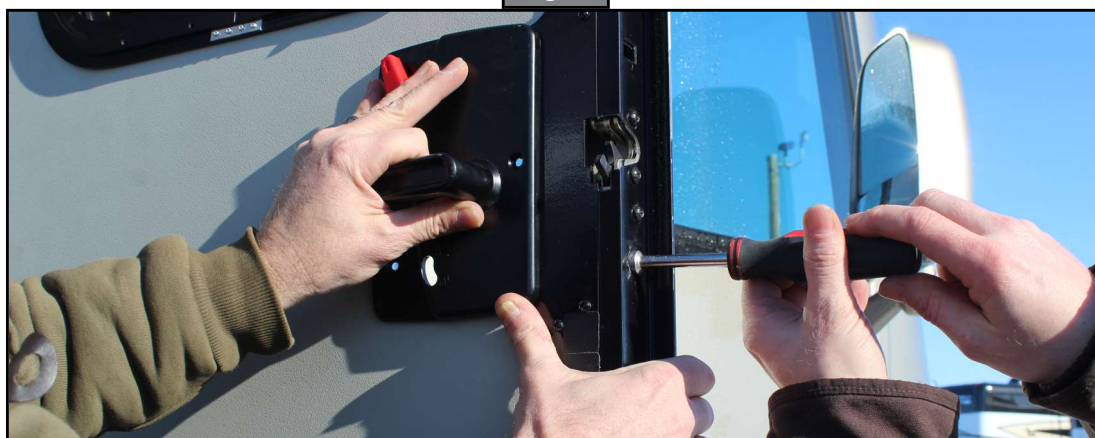

- While another person holds the outside assembly, loosely reinstall the three Phillips head screws (Fig. 8).
- Align deadbolt and then extend the deadbolt so it appears on the outside of the door frame (Fig. 9).
- When deadbolt is extended, firmly tighten the three Phillips head screws (Fig. 10).

Fig. 8

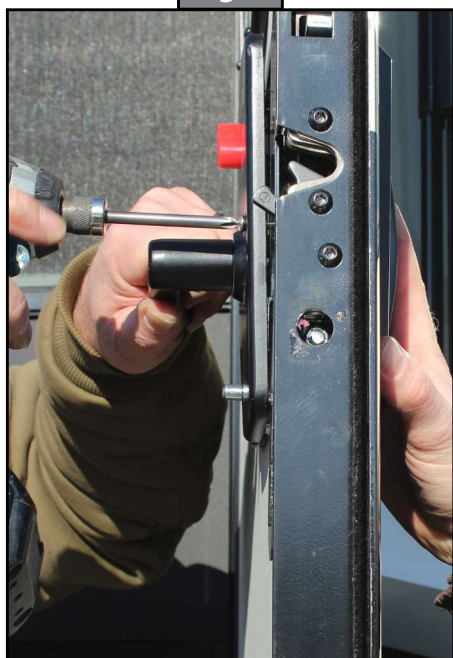

Fig. 9

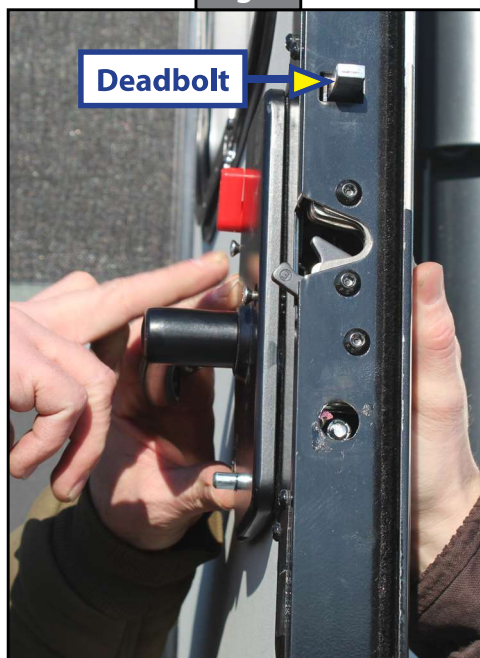
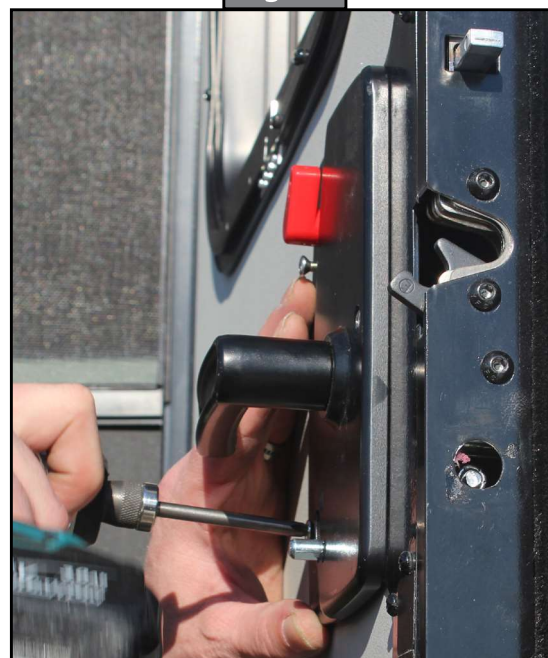

Fig. 10



GLOBAL ENTRY DOOR LATCH INSPECTION/ REPLACEMENT INSTRUCTIONS *MOTORIZED UNITS ONLY

Recall Number:	23E-008		
Product:	Global Latch		
Date:	02.23.2023	Labor Rate:	Inspection Only - 0.3 Hour/Inspection & Replace - 0.7 Hour

6. Replace adhesive patch over nut access port (Fig. 11).
7. Place an "INSPECTED LATCH" sticker indicating the assembly has been replaced on the inside of the door frame between the hinges (Fig. 12).

Fig. 11



Fig. 12

