

Compliance Recall

Code: 72M6



Subject	Center Rear Seat Belt Wiring Harness																			
Release Date	March 04, 2022																			
Affected Vehicles	<table border="1"> <thead> <tr> <th>Country</th> <th>Beginning Model Year</th> <th>Ending Model Year</th> <th>Vehicle</th> <th>Vehicle Count</th> </tr> </thead> <tbody> <tr> <td>USA</td> <td>2022</td> <td>2022</td> <td>E-TRON GT</td> <td>693</td> </tr> <tr> <td>CAN</td> <td>2022</td> <td>2022</td> <td>E-TRON GT</td> <td>159</td> </tr> </tbody> </table>					Country	Beginning Model Year	Ending Model Year	Vehicle	Vehicle Count	USA	2022	2022	E-TRON GT	693	CAN	2022	2022	E-TRON GT	159
Country	Beginning Model Year	Ending Model Year	Vehicle	Vehicle Count																
USA	2022	2022	E-TRON GT	693																
CAN	2022	2022	E-TRON GT	159																
	<p>Check Campaigns/Actions screen in Elsa on the day of repair to verify that a VIN qualifies for repair under this action. Elsa is the <u>only</u> valid campaign inquiry & verification source.</p> <ul style="list-style-type: none"> ✓ Campaign status must show "open." ✓ If Elsa shows other open action(s), inform your customer so that the work can also be completed at the same time the vehicle is in the workshop for this campaign. 																			
Problem Description	The wiring harness for the center rear seat belt buckle may be routed incorrectly and interfere with the inner lower LATCH anchor of the right rear seat. This may obstruct the accessibility of the lower child seat anchors and inhibit the child seat from being properly secured. Due to one of the lower child seat anchors not being accessible, a child seat on the right rear seat may not be properly secured increasing the risk of injury in case of a crash.																			
Corrective Action	Inspect the wiring harness for the center rear seat belt buckle for damage and correctly route and secure it on the affected vehicles if necessary.																			
Code Visibility	On or about March 04, 2022, the campaign code will be applied to affected vehicles.																			
Owner Notification	Owner notification will take place in March, 2022. Owner letter examples are included in this bulletin for your reference.																			
Additional Information	<p>Please alert everyone in your dealership about this action, including Sales, Service, Parts and Accounting personnel. Contact Warranty if you have any questions.</p> <p>IMPORTANT REMINDER ON VEHICLES AFFECTED BY SAFETY & COMPLIANCE RECALLS</p> <p><u>New Vehicles in Dealer Inventory:</u> It is a violation of federal law for a dealer to deliver a new motor vehicle or any new or used item of motor vehicle equipment (including a tire) covered by this notification under a sale or lease until the defect or noncompliance is remedied. By law, dealers must correct, prior to delivery for sale or lease, any vehicle that fails to comply with an applicable Federal Motor Vehicle Safety Standard or that contains a defect relating to motor vehicle safety.</p> <p><u>Pre-Owned Vehicles in Dealer Inventory:</u> Dealers should not deliver any pre-owned vehicles in their inventory which are involved in a safety or compliance recall until the defect has been remedied.</p> <p>Dealers must ensure that every affected inventory vehicle has this campaign completed <u>before</u> delivery to consumers.</p>																			

Parts Information

CRITICAL PARTS INFORMATION (9J1-857-740-B)



STOP!



Do not order 9J1-857-740-B unless it is absolutely needed! The expected need for the following parts is less than 0.1%. Ordering parts unnecessarily will cause delays.

Parts Control Type:
9J1-857-740-B
e-mail Parts Specialist

If parts are needed to support a vehicle repair:

- Email VWoAPartsSpecialists@vw.com with VIN and Picture of a NOT OK Buckle to order.

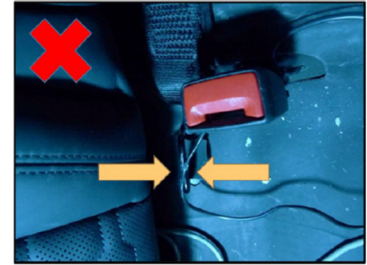

Parts Control Type:
D -437-S40-A2
Free Order

Parts will be managed by Free Order

Initial Allocation:
NO

There will be no parts allocation. Please reference the Repair Projection Tool (below) to view your potential VIN population.

Repair Projection Tool:
(right click to open)



Criteria	Quantity	Part Number	P.O.C. Part Description	Ordering Method (see description above)
01	80mm	D -437-S40-A2	TAPE	Free Order
	1	9J1-857-740-B	BUCKLE (only if necessary)	e-mail Parts Specialist

NOTE

The specified part numbers reflect the status at the start of this action. Interim updates made in ETKA can cause a listed part number to become unavailable. In this case, the new part number specified in ETKA should be used.

Claim Entry Instructions

The labor times listed here may differ from the labor operations and labor times listed in ELSA.

After campaign has been completed, enter claim as soon as possible to help prevent work from being duplicated elsewhere. Attach the Elsa screen print showing action open on the day of repair to the repair order.

If customer refused campaign work:

- ✓ U.S. dealers: Submit the request through Audi Warranty Online under the Campaigns/Update option.
- ✓ Canada dealers: Upload the repair order [signed by customer] to Audi WIN/Operations/Campaign Closure.

Service Number	72M6		
Damage Code	0099		
Parts Vendor Code	002		
Claim Type	Sold vehicle: 7 10 Unsold vehicle: 7 90		
Causal Indicator	Mark labor as causal part if buckle is NOT replaced Mark BUCKLE* as causal part if buckle IS replaced		
Vehicle Wash/Loaner	Do not claim wash/loaner under this action		
Criteria I.D.	01		
	Inspect rear center seat belt buckle wiring harness. Wiring harness is not damaged. Reroute harness and secure with tape.		
	LABOR		
	Labor Op	Time Units	Description
	6925 55 99	30	Inspect seat belt buckle harness and apply tape
	PARTS		
	Quantity	Part Number	Description
	0.01	D 437S40A2	TAPE
-OR-	Inspect rear center seat belt buckle wiring harness. Wiring harness is damaged. Replace rear center seat belt buckle. Reroute harness and secure with tape.		
	LABOR		
	Labor Op	Time Units	Description
	6925 56 99	50	Inspect seat belt buckle harness, replace seat belt buckle and apply tape
	PARTS		
	Quantity	Part Number	Description
	1.00	9J1857740B	BUCKLE*
	0.01	D 437S40A2	TAPE

Customer Letter Example (USA)

<MONTH YEAR>

<CUSTOMER NAME>

<CUSTOMER ADDRESS>

<CUSTOMER CITY STATE ZIPCODE>

This notice applies to your vehicle: <MODEL YEAR> <BRAND> <CARLINE>, <VIN>

NHTSA: 22V084

Subject: Compliance Recall 72M6 - Center Rear Seat Belt Wiring Harness

Dear Audi Owner,

This notice is sent to you in accordance with the National Traffic and Motor Vehicle Safety Act. Audi has decided that certain 2022 model year Audi vehicles fail to conform to Federal Motor Vehicle Safety Standard No. 225, Child Restraint Anchorage Systems. Our records show that you are the owner of a vehicle affected by this action.

What is the issue? The wiring harness for the center rear seat belt buckle may be routed incorrectly and interfere with the inner lower LATCH anchor of the right rear seat. This may obstruct the accessibility of the lower child seat anchors and inhibit the child seat from being properly secured. Due to one of the lower child seat anchors not being accessible, a child seat on the right rear seat may not be properly secured increasing the risk of injury in case of a crash.

What will we do? To correct this noncompliance, your authorized Audi dealer will inspect the wiring harness for the center rear seat belt buckle for damage and correctly route and secure it on the affected vehicles if necessary. This work will take about an hour to complete and will be performed for you free of charge. Please keep in mind that your dealer may need additional time for the preparation of the repair, as well as to accommodate their daily workshop schedule.

What should you do? Please contact your authorized Audi dealer without delay to schedule this recall repair. For your convenience, you can also visit www.audiusa.com and click on the "Find a Dealer" link to locate a dealer near you and schedule this service.

Lease vehicles and address changes If you are the lessor and registered owner of the vehicle identified in this action, the law requires you to forward this letter immediately via first-class mail to the lessee within ten (10) days of receipt. If you have changed your address or sold the vehicle, please fill out the enclosed prepaid Owner Reply card and mail it to us so we can update our records.

Can we assist you further? If your authorized Audi dealer fails or is unable to complete this work free of charge within a reasonable time, please contact Audi Customer Experience at 1-800-253-2834 or via our "Contact Us" page at www.audiusa.com.

Checking your vehicle for open Recalls and Service Campaigns To check your vehicle's eligibility for repair under this or any other recall/service campaign, please visit the **Recall/Service Campaign Lookup** tool at www.audiusa.com and enter your Vehicle Identification Number (VIN).

If you still cannot obtain satisfaction, you may file a complaint with: The Administrator, National Highway Traffic Safety Administration, 1200 New Jersey Avenue, SE., Washington, DC 20590; or call the toll-free Vehicle Safety Hotline at 1-888-327-4236 (TTY: 1-800-424-9153); or go to <http://www.safercar.gov>.

We apologize for any inconvenience this matter may cause; however we are taking this action to help ensure your safety and continued satisfaction with your vehicle.

Sincerely,

Audi Customer Protection

Customer Letter Example (Canada)

<MONTH YEAR>

<CUSTOMER NAME>

<CUSTOMER ADDRESS>

<CUSTOMER CITY STATE ZIPCODE>

This notice applies to your vehicle: <MODEL YEAR> <BRAND> <CARLINE>, <VIN>

Transport Canada Recall: 2022-067

Subject: Compliance Recall 72M6 - Center Rear Seat Belt Wiring Harness

Dear Audi Owner,

This notice is sent to you in accordance with the requirements of the *Motor Vehicle Safety Act*. This is to inform you that your vehicle may be non-compliant with the requirements of the *Motor Vehicle Safety Regulations* and that the non-compliance could affect the safety of a person. Our records show that you are the owner of a vehicle affected by this action.

- What is the issue?** The wiring harness for the center rear seat belt buckle may be routed incorrectly and interfere with the inner lower LATCH anchor of the right rear seat. This may obstruct the accessibility of the lower child seat anchors and inhibit the child seat from being properly secured. Due to one of the lower child seat anchors not being accessible, a child seat on the right rear seat may not be properly secured increasing the risk of injury in case of a crash.
- What will we do?** To correct this noncompliance, your authorized Audi dealer will inspect the wiring harness for the center rear seat belt buckle for damage and correctly route and secure it on the affected vehicles if necessary. This work will take about an hour to complete and will be performed for you free of charge. Please keep in mind that your dealer may need additional time for the preparation of the repair, as well as to accommodate their daily workshop schedule.
- What should you do?** Please contact your authorized Audi dealer without delay to schedule this recall repair.
- Lease vehicles and address changes** If you are the lessor and registered owner of the vehicle identified in this letter, you shall forward this letter (and any subsequent notice, if applicable) to the lessee within ten (10) days of receipt. If you have changed your address or sold the vehicle identified in this letter, please fill out the enclosed prepaid Owner Reply Card and mail it to us so we can update our records.
- Can we assist you further?** If your authorized Audi dealer fails or is unable to complete this work free of charge within a reasonable time, please contact Audi Customer Relations Monday through Friday from 8AM to 8PM EST at 1-800-822-2834 or via our "Contact Audi Canada" page at www.audi.ca.

We apologize for any inconvenience this matter may cause; however we are taking this action to help ensure your safety and continued satisfaction with your vehicle.

Sincerely,

Audi Customer Protection

Repair Overview



- Inspect rear center seat belt buckle wiring harness.
- Reroute and secure wiring harness.
- Replace rear center seat belt buckle, if necessary.

NOTE

- These repair instructions may differ from the labor operations and labor times listed in ELSA.
- Damages resulting from improper repair or failure to follow these work instructions are the dealer's responsibility and are not eligible for reimbursement under this action.
- This procedure must be read in its entirety prior to performing the repair.
- Due to variations in vehicle equipment and options, the steps/illustrations in this work procedure may not identically match all affected vehicles.
- Diagnosis and repair of pre-existing conditions in the vehicle are not covered under this action.
- When working during extreme temperatures, it is recommended that the vehicle be allowed to acclimate inside the shop to avoid temperature-related component damage/breakage.

Repair Instruction

Section A - Check for Previous Repair

Applicable criteria ID(s)	Campaign/Action Status
01 ← 2	Open ← 1

EXAMPLE

Campaign/Action	Start	Designation
← 3	2015-11-10	W-SERV_ACT -
	2018-12-13	RECALL -
	2017-05-16	A-RECALL -

EXAMPLE

- Enter the VIN in Elsa and proceed to the “Campaign/Action” screen.

TIP

On the date of repair, print this screen and keep a copy with the repair order.

- Confirm the Campaign/Action is open <arrow 1>. If the status is closed, no further work is required.
- Note the Applicable Criteria ID <arrow 2> for use in determining the correct work to be done and corresponding parts associated.

CRITICAL REPAIR STEP

 **STOP!** 

If multiple software update Campaign/Actions are open, they must be performed in order of the Start date <arrow 3>. The oldest should be performed first.

- **All Safety Recalls must be completed prior to completing this campaign.**
- **Proceed to Section B.**

Section B – Rear Center Seat Belt Buckle Harness Inspection

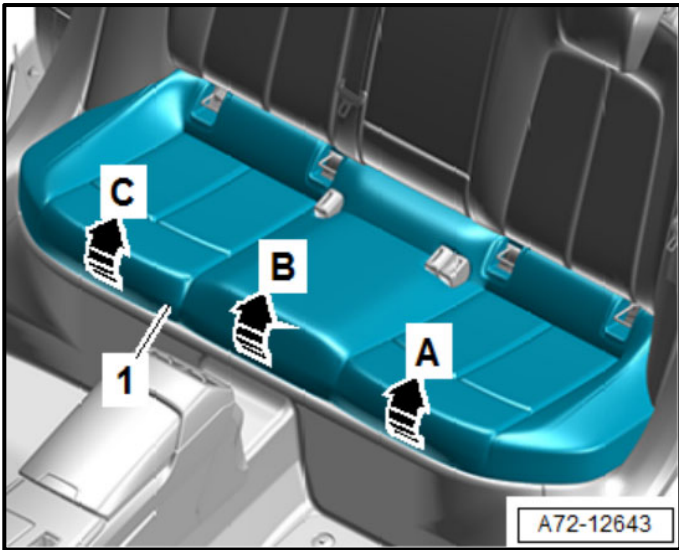

Remove rear bench seat:

- Move the front seats all the way forward.
- Pull the rear bench seat <1> one after the other with both hands using force upward, out of the mounts in direction of <arrows A, B and C>.
- Equipped on some models: disconnect the left and right connector for seat heating.
- Guide out the seat belt latch and remove the rear bench seat.



Inspect rear center seat belt buckle wiring harness:

- Inspect the rear center seat belt buckle wiring harness in the area shown <arrow>.

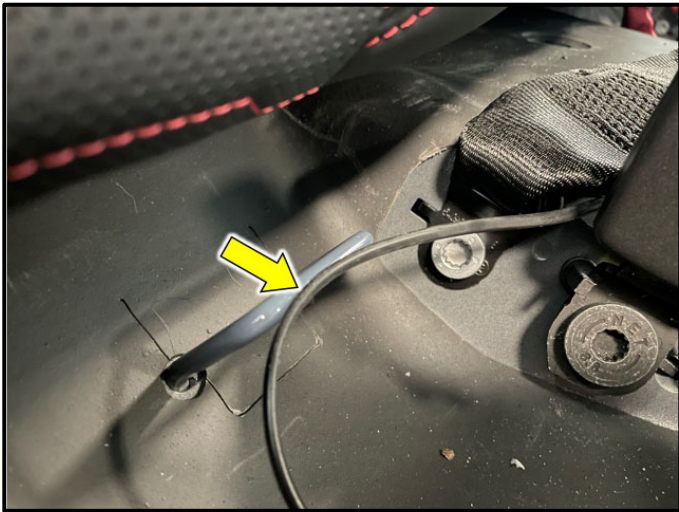

- If the wiring harness <arrow> has not been damaged:
 - The wiring harness must be rerouted and secured.
 - See Section D
- If the wiring harness <arrow> has been damaged:
 - The center seat belt buckle must be replaced.
 - See Section C
 - The wiring harness must be rerouted and secured after replacing center seat belt buckle.
 - See Section D

Section C – Replacing Rear Center Seat Belt Buckle

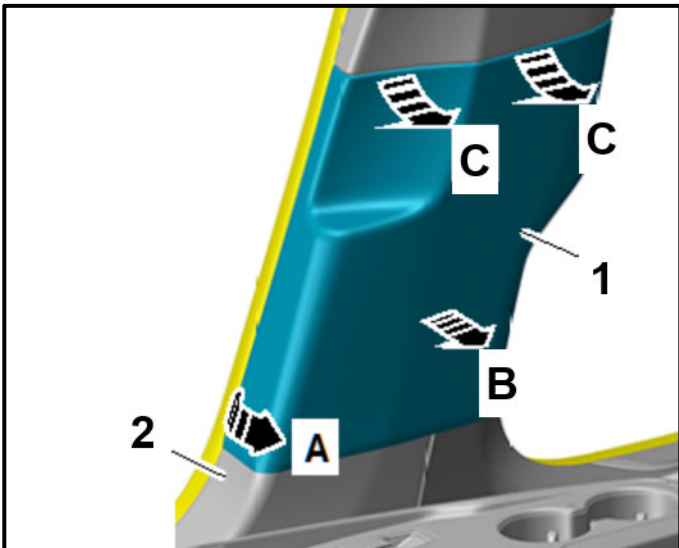

Loosen passenger side lower B-pillar trim:

- Free up the B-pillar trim panel near the door seals.
- Disengage the B-pillar trim panel <1> from the A-pillar trim panel <2> starting at the bottom in the direction of <arrow A>.
- Unclip the B-pillar trim panel from the B-pillar in the direction of <arrow B> using the trim removal wedge no. 7 from the Scraper Set -VAS6845-.
- Unclip the B-pillar trim panel downward from the B-pillar upper trim panel in the direction of <arrows C> and remove downward.

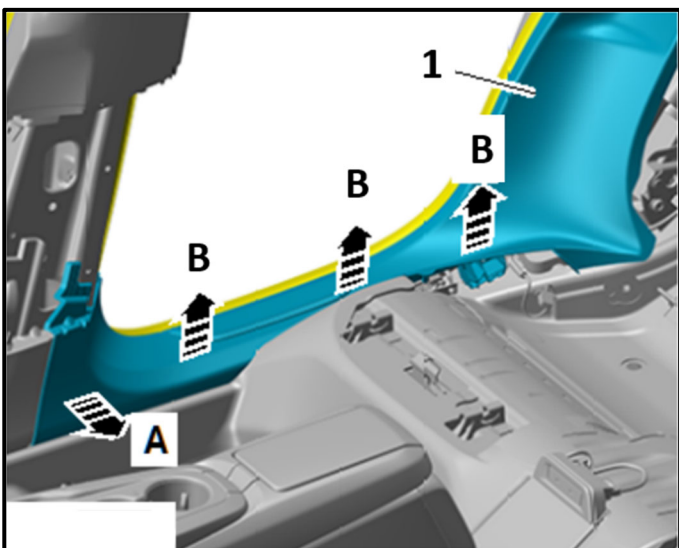

Loosen passenger sill trim:

- Free up the lower C-pillar trim panel in the door seal area.
- Unclip the C-pillar trim panel <1> from the B-pillar in the direction of <arrow A> using the trim removal wedge no. 7 from the Scraper Set -VAS6845-.
- Unclip the C-pillar trim panel from the side sill in the direction of <arrows B> and press to the side.

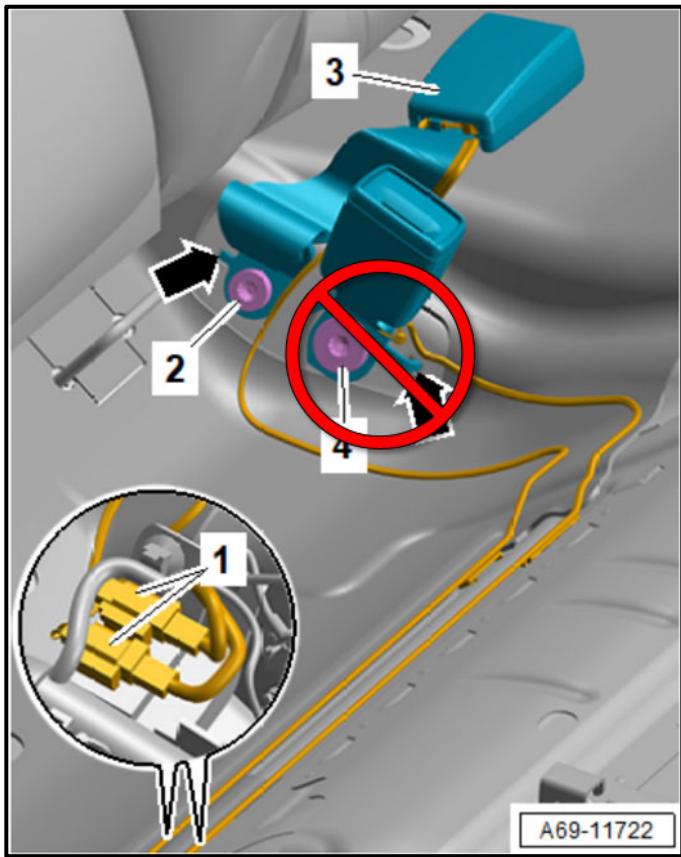

Replacing rear center seat belt buckle:

Part Number	Part Description
9J1-857-740-B	Buckle

- Disconnect the connector <1> for the seat belt switch, as shown in this example.
- Free up the wire for the seat belt switch.
- Remove the bolt <2> and remove the seat belt buckle <3>.
- When installing the new seat belt buckle, position the seat belt buckle so that the anti-twist mechanism <arrow> engages in the cut-out.
- Torque bolt <2> to 40 Nm.
- Install trim panels in the reverse order of removal.
- The seat belt buckle harness must be rerouted and secured.

Proceed to Section D

Section D – Securing Rear Center Seat Belt Buckle Wiring Harness

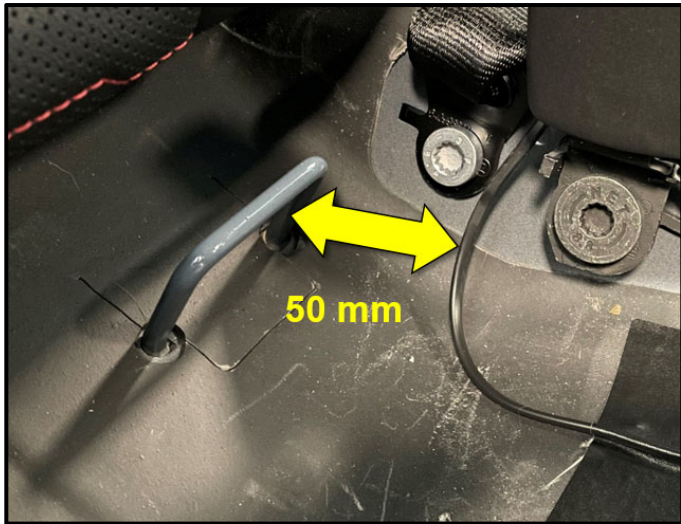

- The distance from the wiring harness to the Isofix anchorage should be 50 mm.

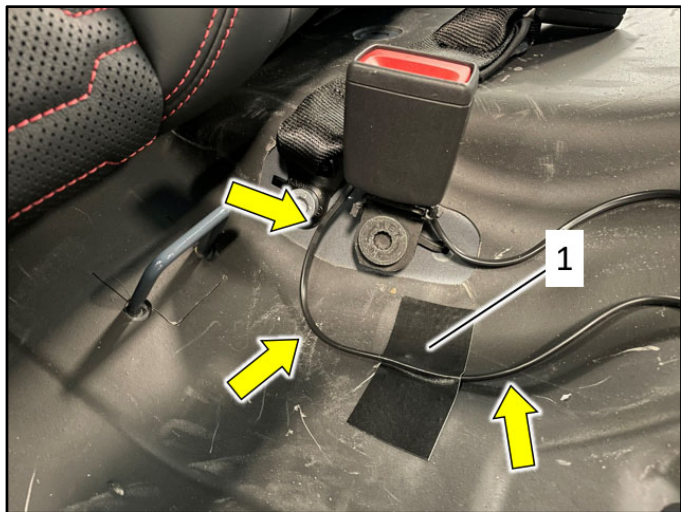

- Route the wiring harness <arrows> as shown.
- Clean the surface of the floor with isopropyl alcohol or equivalent cleaning spray.
- Secure wiring harness with an 80 mm long piece of fabric tape <1>.

Part Number	Part Description
D -437-S40-A2	Tape (80 mm section)

- Reinstall seat bench in the reverse order of removal.
 - Ensure seat heater connectors are reconnected, if equipped.

Proceed to Section E

Section E – Campaign Completion Stamp

I certify that this campaign
has been performed in strict
accordance with the applicable
Audi repair procedure.

SAGA Code: _____
Technician: _____
Date: _____

Item#: AUD4927ENG

-OR-

Je certifie que cette
campagne de rappel a été
exécutée suivant les strictes
directives de réparation
d'Audi

Code de SAGA: _____
Technicien: _____
Date: _____

Item # AUD4927FRE

- Once the campaign has been completed, the technician should stamp the repair order.
- Stamps are available for ordering through the Compliance Label Ordering Portal.

Proceed to Section F

Section F - Parts Return/Disposal

Properly store (retain), destroy or dispose of removed parts in accordance with all state/province and local requirements, unless otherwise indicated and/or requested through the Warranty Parts Portal (WPP) for U.S. and the Part Destruction and Core Disposition Report for Canada.