



# SAFETY RECALL BULLETIN

SUBJECT: <b>FUEL PUMP SAFETY RECALL CAMPAIGN</b>			No: <b>SR-22-001</b>
			DATE: <b>February 2022</b>
			MODEL: <b>2022 Outlander</b>
<b>CIRCULATE TO:</b>	<input checked="" type="checkbox"/> GENERAL MANAGER	<input checked="" type="checkbox"/> PARTS MANAGER	<input checked="" type="checkbox"/> TECHNICIAN
<input checked="" type="checkbox"/> SERVICE ADVISOR	<input checked="" type="checkbox"/> SERVICE MANAGER	<input checked="" type="checkbox"/> WARRANTY PROCESSOR	<input checked="" type="checkbox"/> SALES MANAGER

## **PURPOSE**

This campaign bulletin instructs dealers to replace the fuel pump with a countermeasure part.

## **BACKGROUND**

The commutator and wires in the fuel pump may not have been fused together correctly during production, resulting in poor continuity. As a result, the commutator and the brushes in the fuel pump could wear abnormally in use, causing the fuel pump to be inoperative. If the fuel pump does not operate, the engine may stall while driving, which increases risk of a crash.

## **AFFECTED VEHICLES**

Certain 2022 Outlander vehicles

## **IMPORTANT**

Affected new or used inventory vehicles must be repaired before the vehicle is sold/ delivered. Dealers must check their inventory vehicles' VINs on the Warranty Superscreen to verify whether the vehicle is involved in this recall campaign. It is a violation of Federal law for a dealer to sell/deliver a new motor vehicle or any new or used item of motor vehicle equipment (including a tire) covered by the notification under a sale or lease until the defect or noncompliance is remedied.

## **CUSTOMER NOTIFICATION**

A letter will be sent to all owners of affected vehicles telling them to visit their local Authorized Mitsubishi Motors dealer to have the fuel pump replaced. A copy of the customer notification letter appears at the end of this bulletin.

Copyright 2022, Mitsubishi Motors North America, Inc.

The information contained in this bulletin is subject to change. For the latest version of this document, go to the Mitsubishi Dealer Link, MEDIC, or the Mitsubishi Service Information website ([www.mitsubishitechinfo.com](http://www.mitsubishitechinfo.com)).

## **WORK FLOW**

### **!! IMPORTANT !!**

- Prior to repair work, fuel level must be under  $\frac{1}{2}$  of a full tank to avoid potentially dangerous fuel spills.
- Check for DTCs. If DTC's are present that are unrelated to the fuel pump, please trouble-shoot them as specified in the service manual.

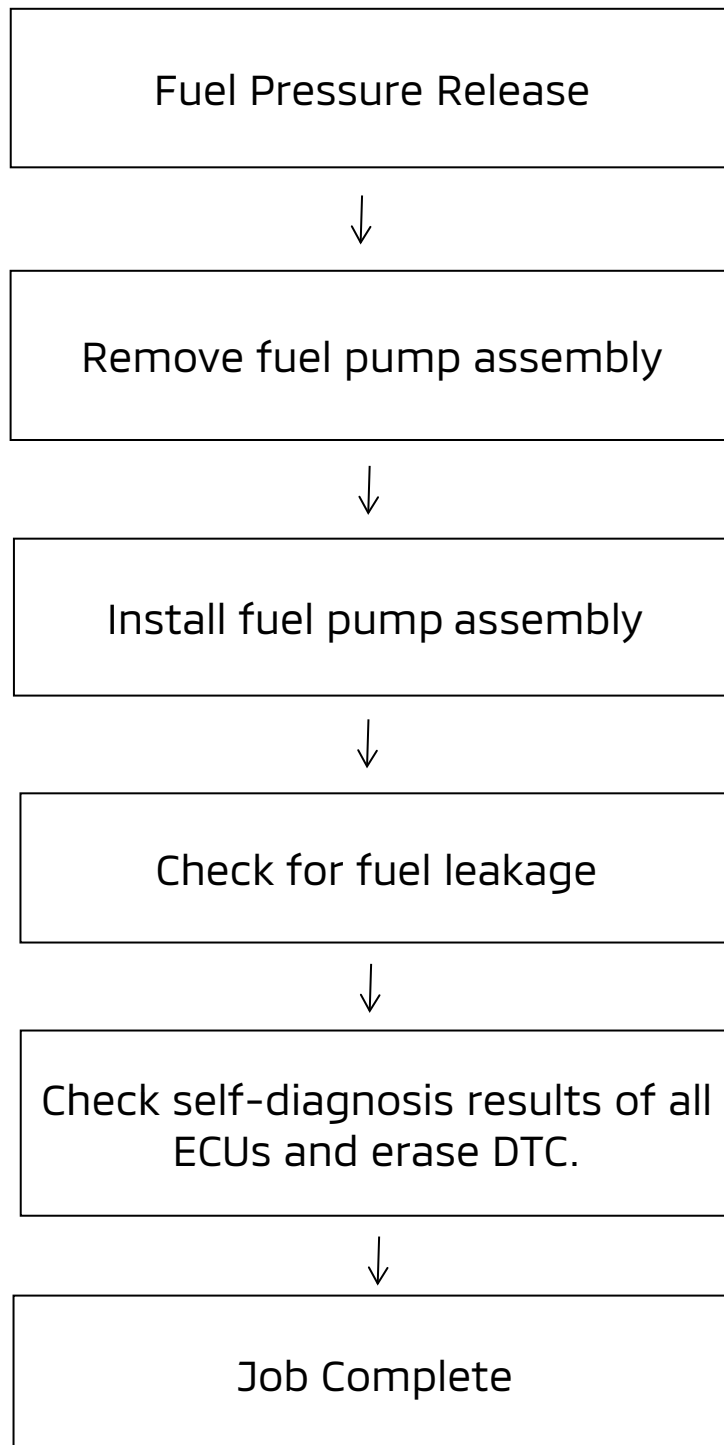

Fuel Pump Assembly



2WD Fuel Pump  
(MW400307)  
**(Not Shown in photo)** does  
not have the cable with the  
red connector on the end.

AWD Fuel Pump (MW400308) Shown in Photo Above

**TOOLS**

1. General tools
2. Shop cloth
3. MUT-III
4. Lock ring wrench (SST: J-45747)



SST: J-45747

## **PRECAUTIONS**



When replacing fuel line parts, be sure to observe the following.

- Put a "CAUTION: FLAMMABLE" sign in the workshop.
- Be sure to work in a well-ventilated area and furnish the workshop with a CO<sub>2</sub> fire extinguisher.
- Never smoke while servicing the fuel system. Keep open flames and sparks away from the work area.



- Use gasoline required by the regulations for octane numbers.
- Before removing fuel line parts, perform the following procedures:
  - ① Put drained fuel in an explosion-proof container and put the lid on securely. Keep the container in a safe area.
  - ② Release fuel pressure from the fuel lines. Refer to Repair Procedure.
  - ③ Disconnect the battery cable from the negative terminal.
- Always replace O-ring and clamps with new ones.
- Never bend or twist tubes when they are being installed.
- Never tighten hose clamps excessively to avoid damaging hoses.
- After installing tubes, check that there is no fuel leakage at connections in the following steps.
  - ① Apply fuel pressure to fuel lines by turning the ignition switch "ON" (with the engine stopped). Then check for fuel leakage at connections.
  - ② Start the engine and rev it up and check for fuel leakage at connections.

## **REPAIR PROCEDURE**

1. Release fuel pressure
  - a. Release fuel pressure from the fuel lines.
    - 1) Remove fuel pump fuse inside the engine compartment (Fuse No. 85).
    - 2) Start the engine.
    - 3) After engine stalls, crank two or three times to release all fuel pressure.
    - 4) Turn ignition switch OFF



- DO NOT reinstall the fuel pump fuse until after the fuel pump is installed.

IPDM inside the engine room



Fuel pump fuse  
(No.85)  
Yellow fuse : 20A

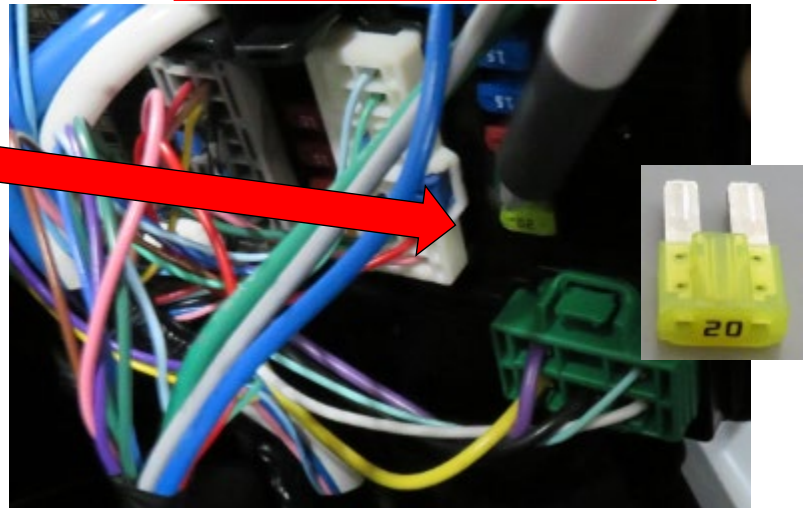

- b. Preparation before disconnecting the battery cable from the negative terminal.
- 1) To make room for the repair work, slide the front seat forward.
  - 2) Open the liftgate for gas smell ventilation.
  - 3) Insert a fuel filler funnel in the fuel filler cap and release the pressure inside the fuel tank. A fuel filler funnel can be found inside the Cargo floor are (see below).
  - 4) After using the fuel filler funnel return it to its storage area (see below).

Inside Cargo floor box  
Fuel filler funnel



View of fuel filler funnel being inserted.



c. Disconnect battery negative terminal.

**! WARNING**

- **With the adoption of the Auto ACC function, ACC power is automatically supplied by operating the Intelligent Key or remote keyless entry or by opening/closing the driver side door.**
  - **In addition, ACC power is supplied even after the ignition switch is turned to the OFF position, i.e. ACC power is supplied for a certain fixed time.**
  - **When disconnecting the 12V battery terminal, turn off the ACC power before disconnecting the 12V battery terminal, observing "How to disconnect 12V battery terminal" described below.**
- ① Turn the ignition switch to the ON position.
  - ② Turn the ignition switch to the OFF position with the driver's side door opened.
  - ③ Get out of the vehicle and close the driver's side door.
  - ④ Wait at least 3 minutes. (This avoids activating the security alarm.)

**! CAUTION**

- **While waiting, never operate the vehicle such as locking, opening, and closing doors. Violation of this caution results in the activation of the ACC power supply according to the Auto ACC function.**
- ⑤ Remove the battery negative terminal and apply tape to the battery terminal to avoid connection until the repair is complete.

**! CAUTION**

- **When re-installing the battery terminal at the completion of the repair, always check the self-diagnosis results of all ECUs and erase DTCs.**

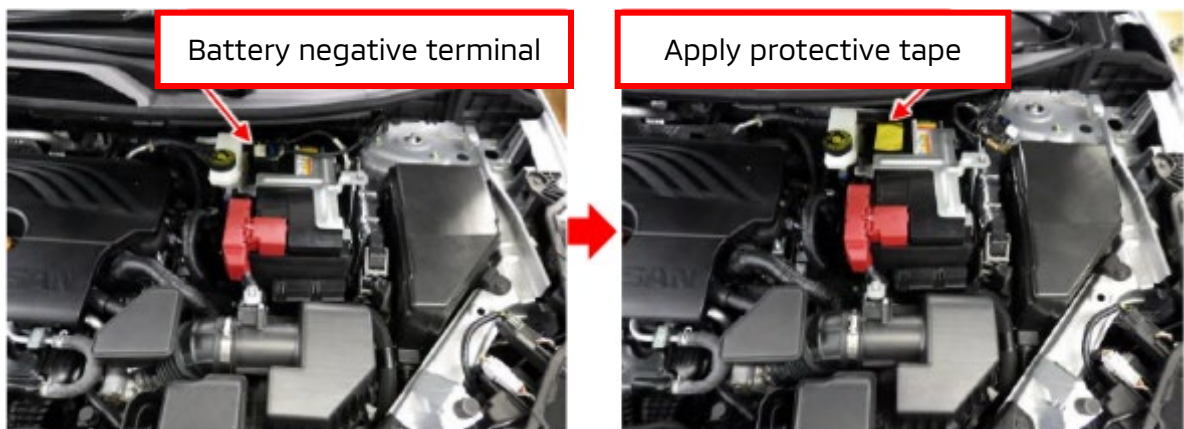



- d. Pull the second row seats up.
- 1) Remove the head rest of the second row seats.
  - 2) Remove rear scuff plate (LH/RH)
  - 3) Protect seat back of the front seat, console, center pillar, quarter trim, and front adjuster rail cover with cardboard or cloth for preventing scratches.

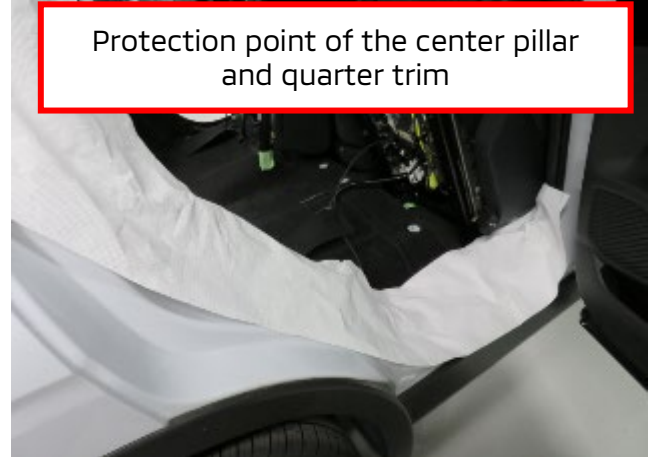

- e. Remove second seat bolts (LH/RH) and pull second row seat up.
- 1) Remove second row seat mounting bolts (LH) and pull the seat up and forward.
  - 2) Remove second row seat mounting bolts (RH) and pull the seat up and forward.

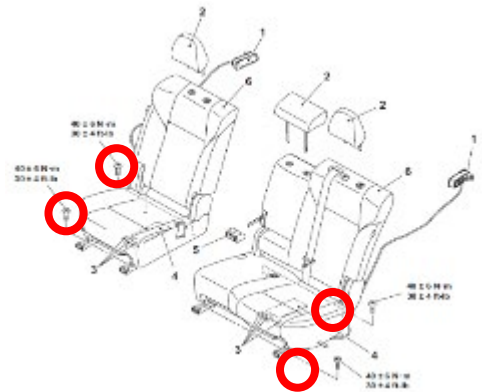
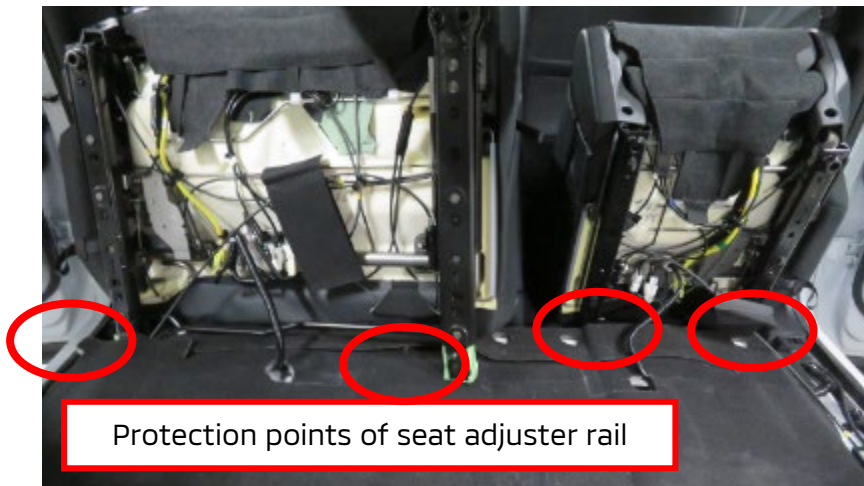

- f. Pull up the rear floor carpet.
- 1) Pull up the rear floor carpet with careful attention to the wiring harness and seat release cable protector.

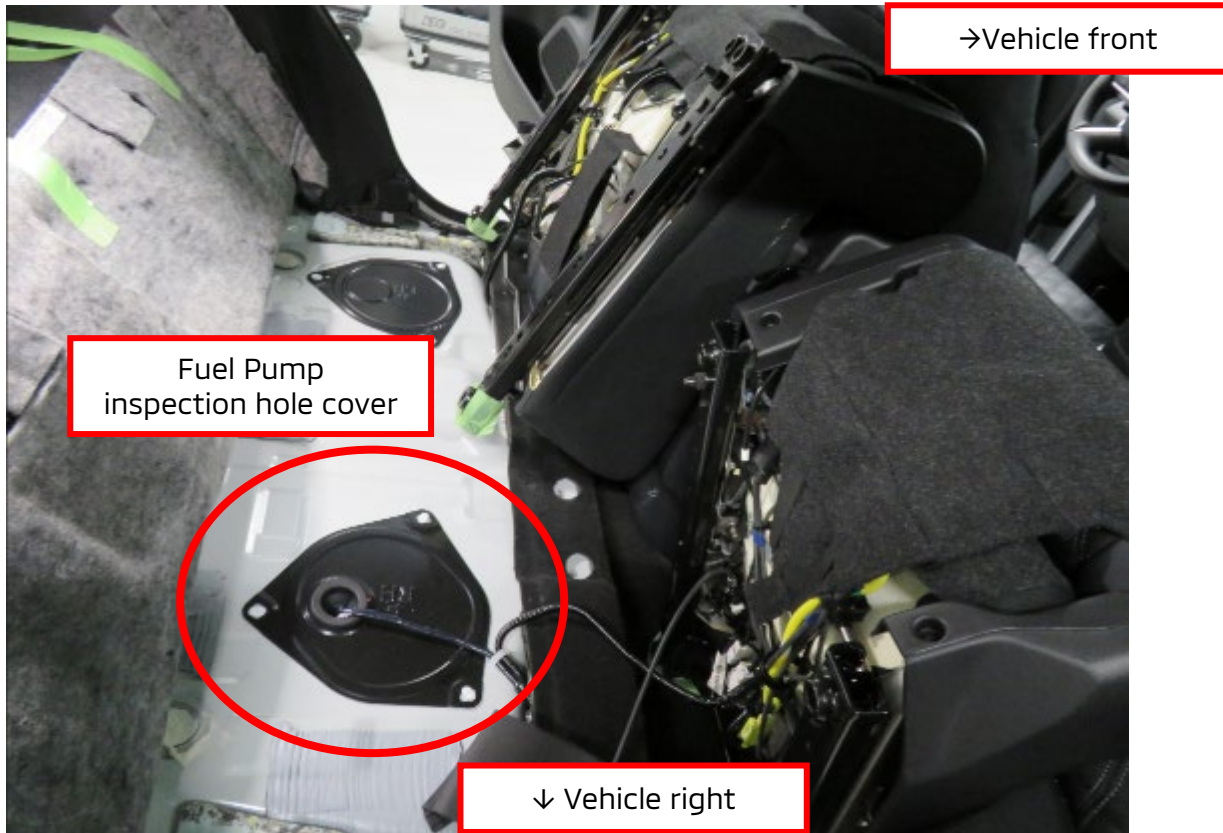

2. Remove fuel pump assembly
  - a. Rotate inspection hole cover clips with a hand tool clockwise until they align with the holes in the metal plate.

 **WARNING**

- **DO NOT USE POWER TOOLS**

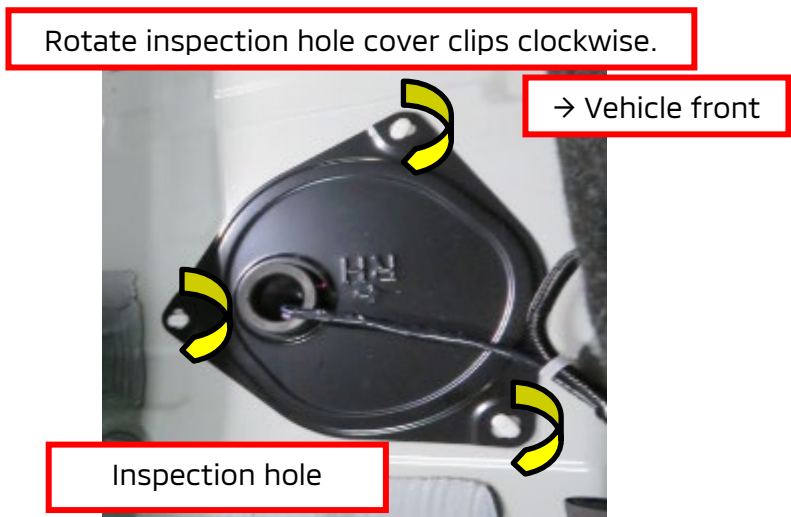



b. Disconnect fuel pump harness connector and then remove inspection hole cover.

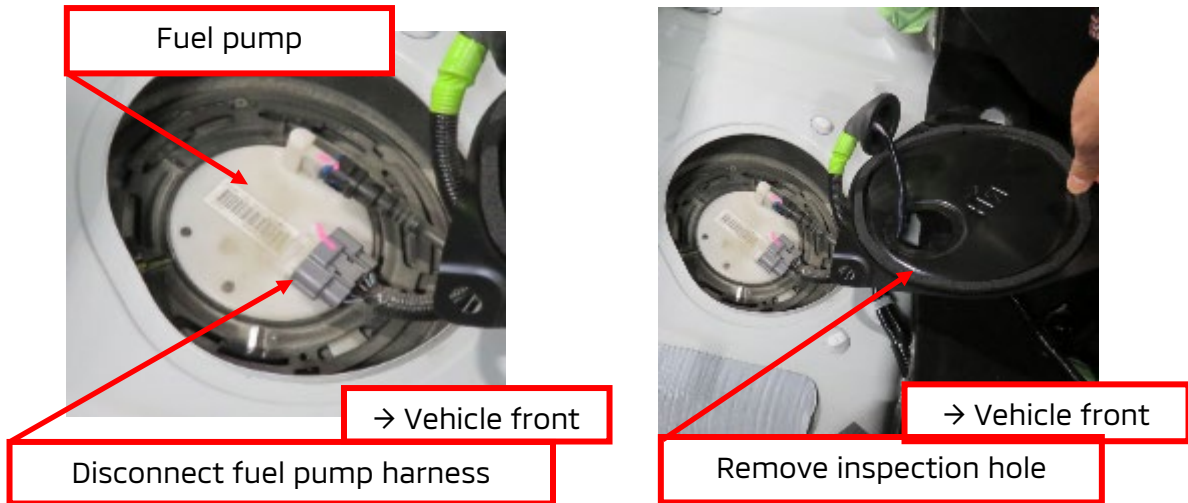

c. Disconnect the quick connector.

1) Cover near the floor of fuel pump assembly with a shop towel.

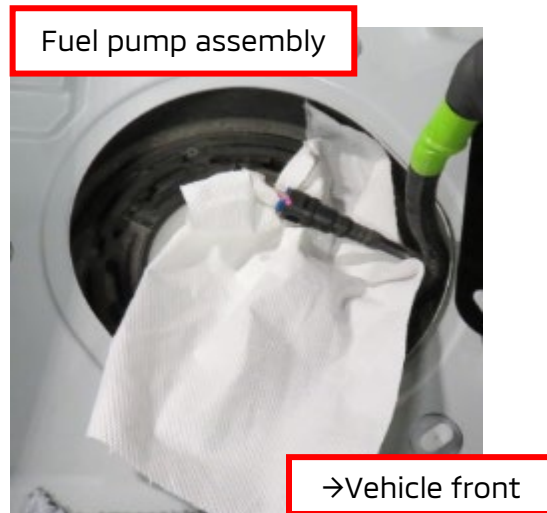

d. Hold the sides of the connector, push in tabs and pull out the fuel feed tube.

**Summary of the quick connector**

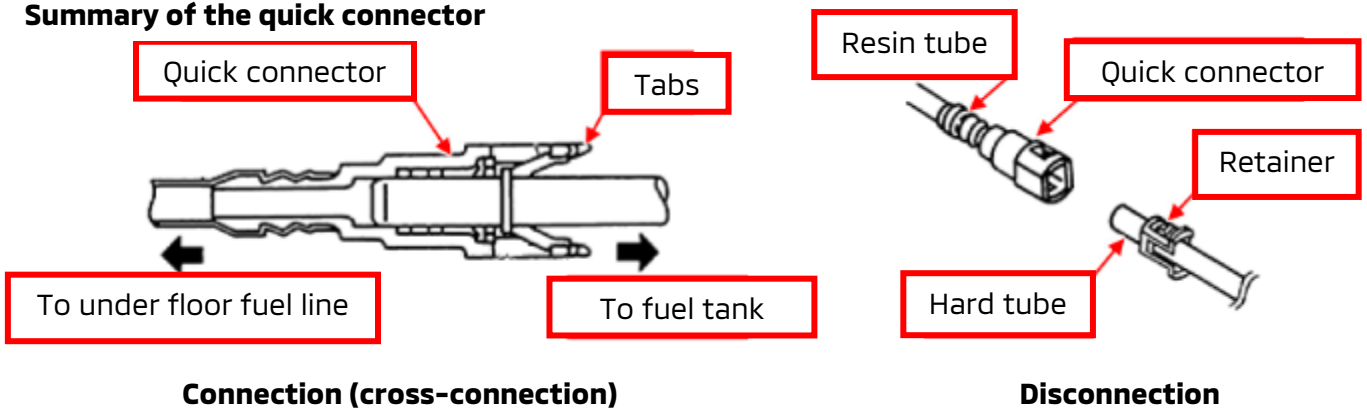

**⚠ CAUTION**

- ① **Quick connector can be disconnected when the tabs are completely depressed.**
- ② **Never twist it more than necessary.**
- ③ **Never use any tools to disconnect quick connector.**
- ④ **Never bend or twist resin tubes during installation and disconnection.**

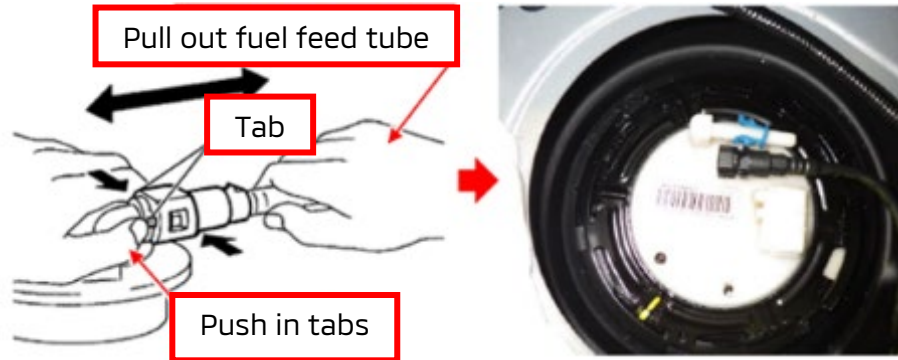

**» NOTE «**

- If quick connector sticks to the tube of the fuel pump assembly, push and pull the Quick connector several times until they start to move.
- e. Cover quick connector completely with plastic bags or something similar then move quick connector with fuel pump harness to the floor.

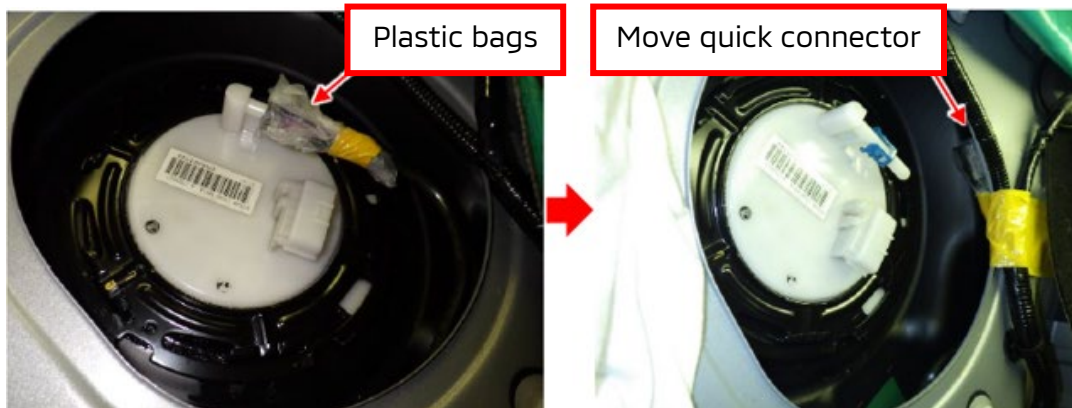

- f. Remove the lock ring of the fuel pump assembly.  
1) Install lock ring wrench (SST: J-45747) to the position shown in the figure.



g. Place the lock ring wrench on to lock ring.

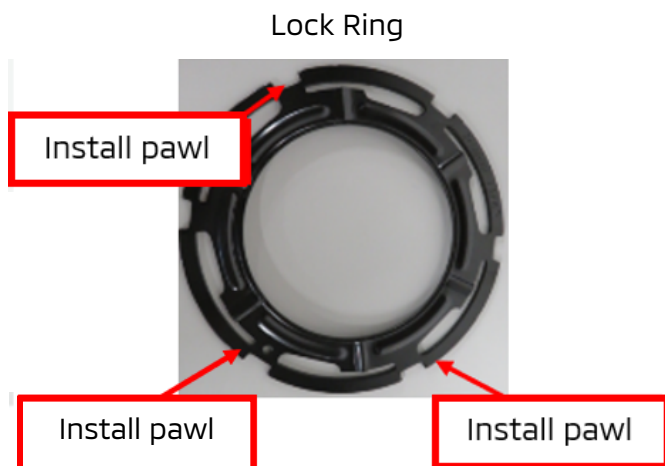

h. To reduce the impact caused by removal operation, use a long spinner handle [handle length: 60cm (23.62 in) or more] with an extension and slowly turn it counterclockwise.

**⚠ CAUTION**

- **To prevent the lock ring wrench from detaching, securely hold down the spinner handle by hand.**

extension  
[handle length: 35cm ]

long spinner handle  
[handle length: 60cm]



i. Remove the old lock ring.

**⚠ CAUTION**

- **Do not reuse the lock ring.**

j. Remove fuel pump assembly.

**⚠ CAUTION**

- **Never bend float arm during removal.**
- **Do not allow residue to contaminate the fuel. Use a shop towel to keep the area clean.**
- **Do not drop or mishandle components.**

- 1) For 2WD:
  - Remove fuel pump assembly.
- 2) For AWD:
  - Lift the fuel pump assembly, and then disconnect the harness connector.

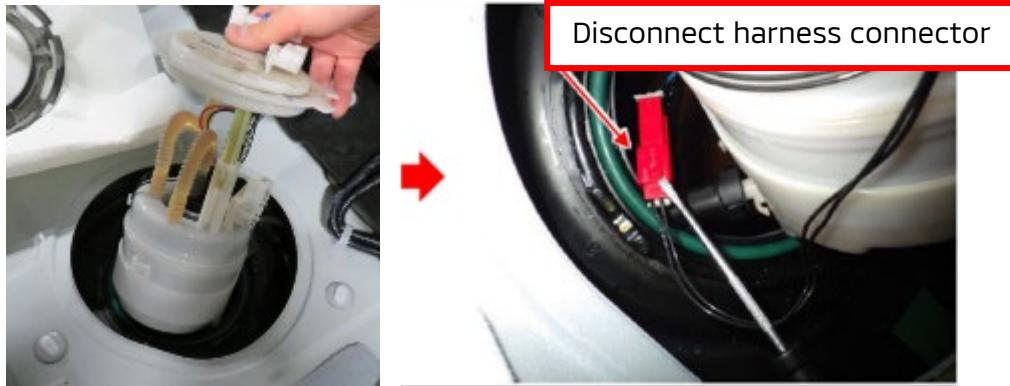

- 3) Pinch quick connector square-part with your fingers and pull out the quick connector by hand. Then remove fuel pump assembly.

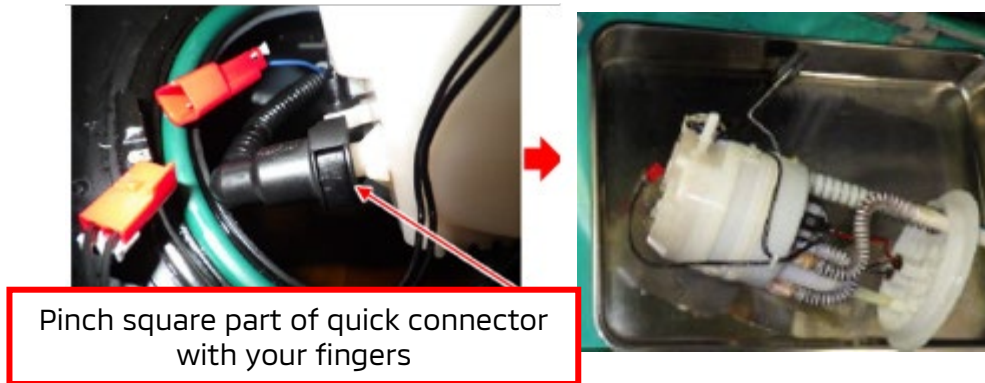

- k. Remove old O-ring, and clean up fuel tank position shown in the figure with parts cleaner

**CAUTION**

- **Do not reuse O-ring.**



3. Install new fuel pump assembly.



- **Never bend float arm during installing.**
- **Never cause impacts by dropping when handling components.**

a. Install new O-ring (MW400309) to fuel tank without any twist.

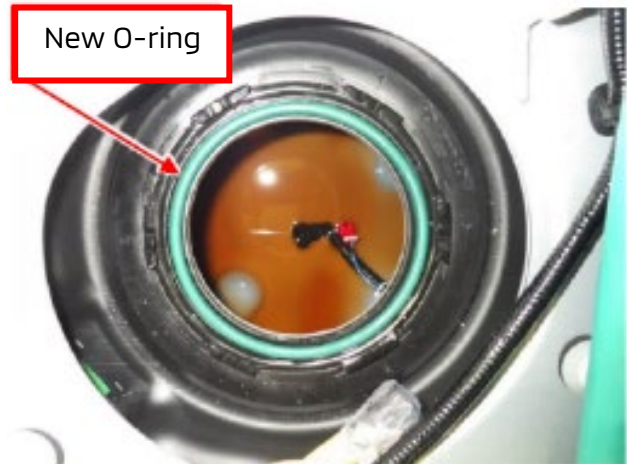

b. For 2WD Vehicles Only:

1) Put the fuel pump (MW400307) with its section (A) facing toward the vehicle's front direction.

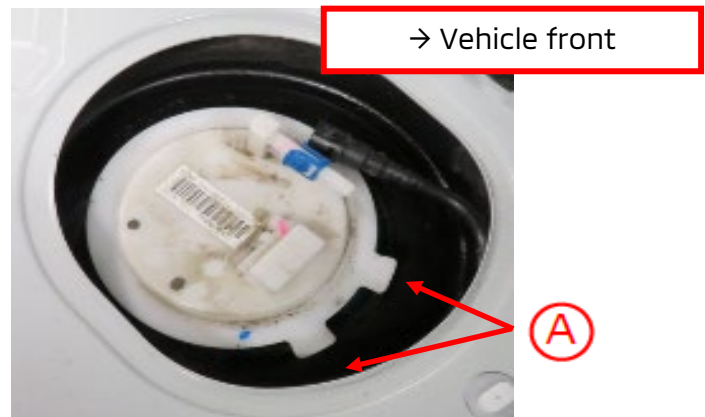

2) To set the fuel pump assembly (A), align with E-ring groove and turn it clockwise until it hits the stopper. (This is due to the fuel gauge float being close to the fuel tank.)





c. For AWD Vehicles Only:

1) Insert the quick connector straight to the fuel pump assembly (MW400308).

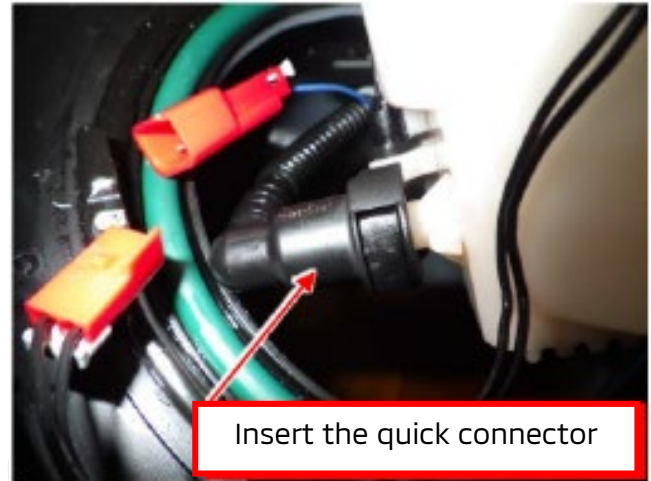

- 2) Judge a good fit from connecting sound and tactile feedback.  
3) Pull the fuel tube by hand to check a secure fit.  
4) Connect harness connector.



5) Place the fuel pump with its (A) section facing toward the vehicle's front direction.

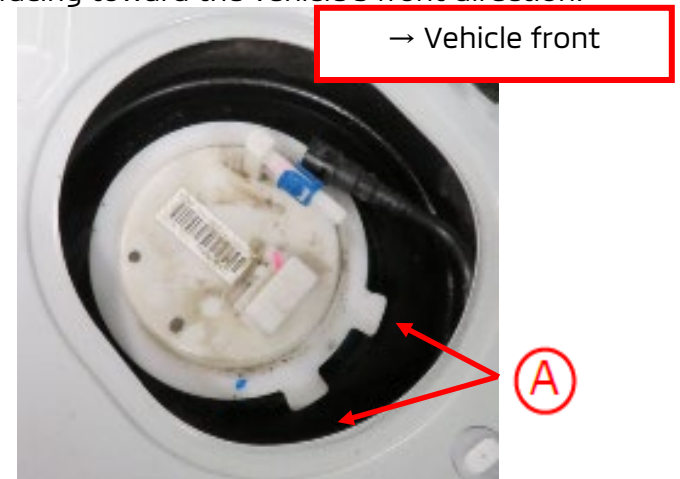

d. Install a new lock ring (MW400310).



Applies to both 2WD (step b) and AWD (step c)

- 1) Install a new lock ring for fuel pump assembly with the lock ring wrench by turning clockwise.

**⚠ CAUTION**

- **Install lock ring horizontally.**
- **Turn the lock ring until it is engaged in the fuel tank side as shown in the figure.**

Turn the lock ring until it is engaged

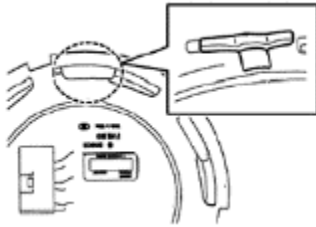

- f. Connect the quick connector of the fuel feed tube.
  - 1) Align the connector with the tube, then insert the connector straight into the tube until a "click" sound is heard.

**⚠ CAUTION**

- **Check the connection for damage or any foreign materials.**
- **Make sure the retainer does not have a crack.**

**» NOTE «**

- Remove the retainer from the old fuel pump and reuse it on the new fuel pump.

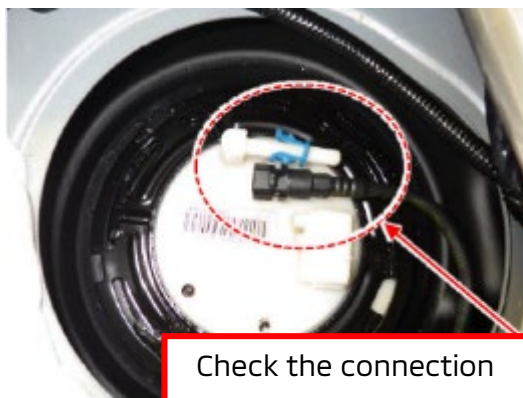

Check the connection

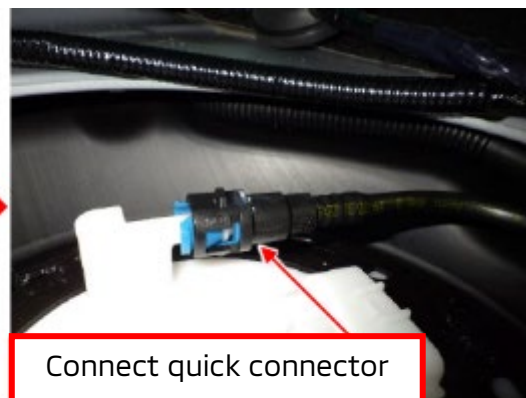

Connect quick connector

- 2) After connecting, check that the connection is secured with the following procedures.
  - Visually confirm that the two tabs are connected to the connector

- Pull the tube and the connector to check that they are securely connected.

Pull the tube and the connector

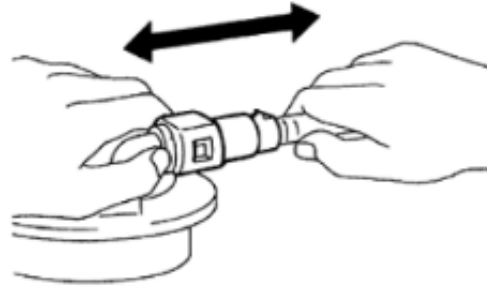

- g. Connect harness connector.



- **Before installing the inspection hole cover, check that the connecting part has no fuel leakage.**

- h. Temporarily install the inspection hole cover, then connect the harness connector.

Connect harness connector



Inspection hole cover

Battery negative terminal

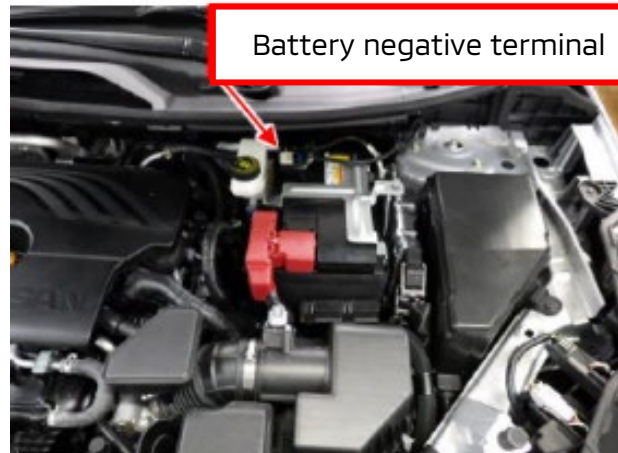

- i. Connect battery negative terminal.  
1) Re-Install fuel pump fuse inside the engine compartment (Fuse No. 85).

- j. Check that the connecting part has no fuel leakage with the following procedures:
- 1) Turn the ignition ON and check for fuel leakage.
  - 2) Start the engine and check for fuel leakage.
  - 3) Turn the ignition OFF.
  - 4) Wait at least 3 minutes.
  - 5) Remove the battery negative terminal and apply electrical tape to prevent sparks.



- k. Install the inspection hole cover with the front mark (arrow) facing the front of the vehicle. Lock clips by turning counterclockwise.

Rotate inspection hole cover clips to counterclockwise.

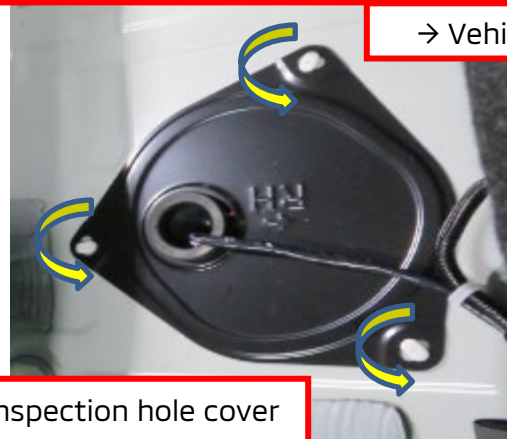



4. Install second row seat assembly.
  - a. Turn rear seat carpet back to the original position.
  - b. Align the floor harness with the split of carpet. (Green circle points)

**NOTE**

- Make sure carpet is properly tucked beneath the luggage side lower finisher (RH/LH).
- c. Attach the seat release cable protector onto the carpet surrounded by the red dotted line in the picture below.

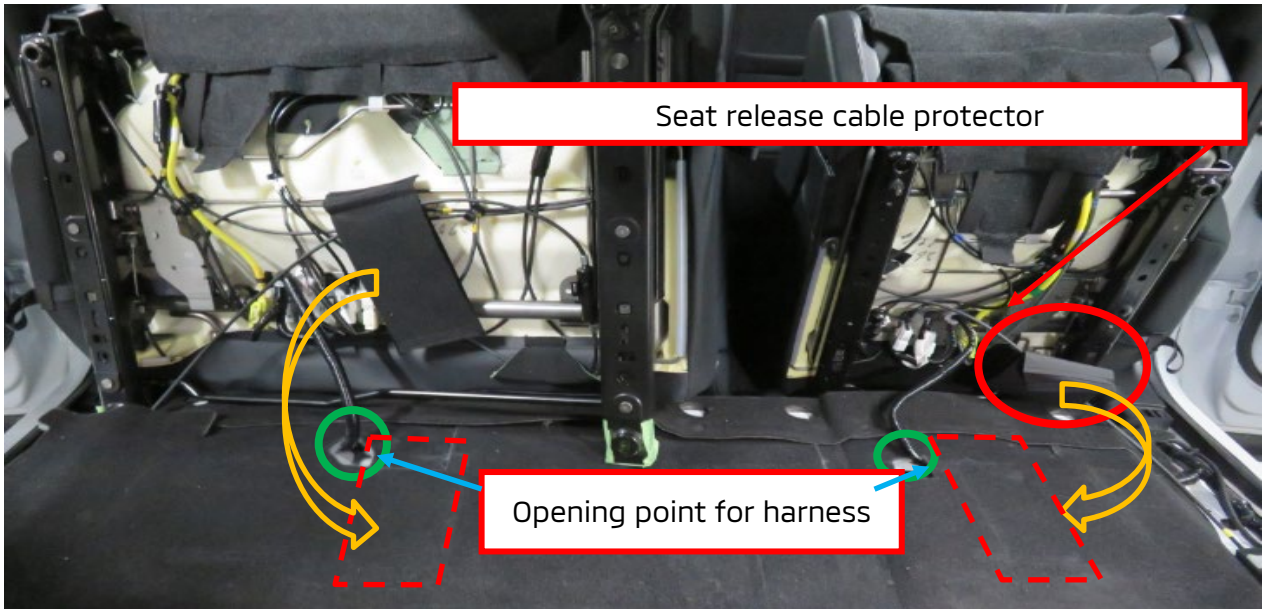

- 1) Tighten the second seat mounting bolts. **< 40±6N · m / 5 bolts >**
- 2) When re-installing the seat, be careful not to pinch the harness and cable.  
(Do a visual check underneath the seats.)

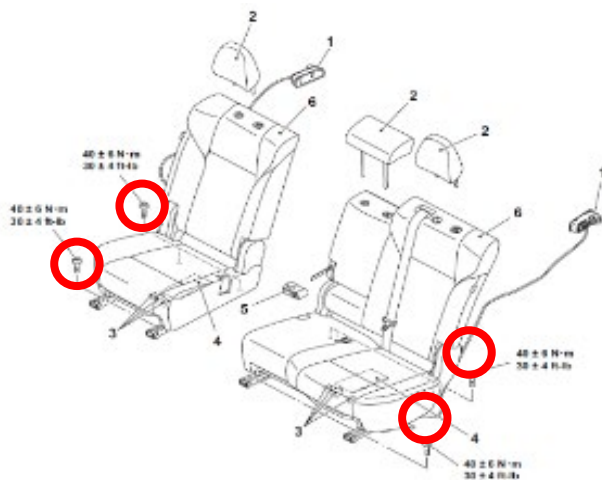

5. Connect the battery negative terminal.
6. Check the self-diagnosis results of all ECUs.

**!! IMPORTANT !!**

**CHECK AND CLEAR ALL DTCs**



## **PARTS INFORMATION**

Use the genuine Mitsubishi Part listed below:

<b>PART DESCRIPTION</b>	<b>PART NUMBER</b>	<b>QTY.</b>	<b>REMARKS</b>
FUEL PUMP ASSEMBLY (2WD)	MW400307	1	
FUEL PUMP ASSEMBLY (AWD)	MW400308	1	
O-RING	MW400309	1	2WD/AWD Common part. <b>Always replace after every disassembly</b>
Lock Ring	MW400310	1	2WD/AWD Common part. <b>Always replace after every disassembly</b>

## **WARRANTY INFORMATION**

<b>VEHICLE</b>	<b>CAMPAIGN LABOR OPERATION</b>	<b>LABOR TIME (HRS)</b>	<b>REPAIR DESCRIPTION</b>
2022 OUTLANDER	C2201R01	1.1	REPLACE 2WD FUEL PUMP
	C2201R02	1.1	REPLACE AWD FUEL PUMP

### **IMPORTANT**

Affected new or used inventory vehicles must be repaired before the vehicle is sold/ delivered. Dealers must check their inventory vehicles' VINs on the Warranty Superscreen to verify whether the vehicle is involved in this recall campaign. It is a violation of Federal law for a dealer to sell/deliver a new motor vehicle or any new or used item of motor vehicle equipment (including a tire) covered by the notification under a sale or lease until the defect or noncompliance is remedied.

## **WARRANTY / RECALL CAMPAIGN CLAIM INFORMATION**

Enter all claims as claim type 'C' - Recall/Campaign Claims.

Please follow the campaign instructions when entering each claim. See the claim example provided below.

Certain 2022 MY Outlander

### **RECALL CLAIM HEADER SECTION**

The screenshot shows the 'Service Warranty Warranty Claim' form in the Mitsubishi Dealer Link system. The form is titled 'Claim Entry' and 'Vehicle Information'. The 'Campaign Information' section includes the following fields:

Campaign Operation No	C2201R	Enter As	<input type="checkbox"/>	TCP
Miles/Km	64500			
VIN	JA.....			
Service Technician	Emp No	Service Advisor	Emp No	
Spec Value *		Duplicate Recall *	<input type="checkbox"/>	

At the bottom of the form, there are fields for Dealer (99320), Ref No, VIN, Claim No, Adj, Claim Status (Incomplete), and Model and Year. Two buttons are visible: 'Save & Continue' and 'Main Menu'.

Callout boxes provide additional instructions:

- Enter in the first 6 characters of the campaign number: **C2201R**
- Check the Open Campaign area of the Superscreen each time to be certain of a vehicle's eligibility. Only VINs showing **C2201R** as open are involved.

After entering the required customer data, vehicle information, selecting the applicable repair campaign and scenario performed (**please note there are only 2 possible repair scenarios for this campaign**), and then clicking the "Save and Continue" button, the system will automatically fill-in several fields

MITSUBISHI MOTORS NORTH AMERICA, INC.  
PO Box 689040  
Franklin, TN 37068



## IMPORTANT SAFETY RECALL

This notice applies to your vehicle, \_\_\_\_\_.

Date: March 2022

Dear FIRSTNAME LASTNAME,

This notice is sent to you in accordance with the National Traffic and Motor Vehicle Safety Act.

**Reason for notice:** Mitsubishi Motors North America, Inc. (MMNA) has decided that a defect which relates to motor vehicle safety exists in certain 2022 Outlander vehicles. The commutator and wires in the fuel pump may not have been fused together correctly during production, resulting in poor continuity. As a result, the commutator and the brushes in the fuel pump could wear abnormally in use, causing the fuel pump to be inoperative. If the fuel pump does not operate, the engine may stall while driving, which increases risk of a crash.

**What you should do:** Please contact your local Mitsubishi Motors dealer and schedule an appointment to have the affected fuel pump replaced, free of charge. When you bring your vehicle in, please show the dealer this letter. If you misplace this letter, the dealer will still perform this repair for your vehicle, free of charge.

**What your dealer will do:** The dealership will replace the fuel pump with a countermeasure unit.

**How long will it take?** The time needed for fuel pump replacement is approximately **1 hour and 6 minutes**. The dealer may need your vehicle for a longer period of time, but every effort will be made to minimize your inconvenience.

If you experience any problem having your vehicle repaired promptly and/or at no charge, please inform us by calling the Mitsubishi Customer Relations Department at **888-648-7820**. Hours: Monday through Friday 7 a.m. to 4 p.m. (Central Time)

If, after contacting Mitsubishi Customer Relations, you still have a problem getting this repair made promptly and/or without charge, you may submit a complaint to the Administrator, National Highway Traffic Safety Administration, 1200 New Jersey Avenue SE, Washington, D.C. 20590, or call the toll-free Vehicle Safety Hotline at 1-888-327-4236 (TTY: 1-800-424-9153), or go to <http://www.safercar.gov>.

If you have already encountered a problem with the fuel pump and had it replaced as a result of this specific condition and have paid for the repair, you may send your original repair order or invoice, **and** original receipt/proof of payment to the following address for reimbursement consideration:

Mitsubishi Motors North America Inc., Customer Relations, P.O. Box 689040, Franklin, TN 37068

**If you are the lessor of this vehicle**, please forward a copy of this notice to the lessee within ten days to comply with federal regulations.

We appreciate your prompt attention to this matter.

Sincerely,

Mitsubishi Motors North America, Inc.

C2201R