

TECHNICAL INSTRUCTIONS

SAFETY RECALL 21TA08

SECOND-ROW OUTBOARD SEAT BELT COULD TEAR IN A CRASH

CERTAIN 2022 MODEL YEAR SIENNA VEHICLES

The repair quality of covered vehicles is extremely important to Toyota. All dealership technicians performing this repair are required to successfully complete the most current version of the E-Learning course "Safety Recall and Service Campaign Essentials". To ensure that all vehicles have the repair performed correctly; technicians performing this recall repair are required to currently have completed all of the following courses:

T623 - Toyota Electrical Circuit Diagnosis

It is the dealership's responsibility to select technicians with the above certification level or greater to perform this recall repair. Carefully review your resources, the technician skill level, and ability before assigning technicians to this repair. It is important to consider technician days off and vacation schedules to ensure there are properly trained technicians available to perform this repair at all times.

I. OPERATION FLOW CHART

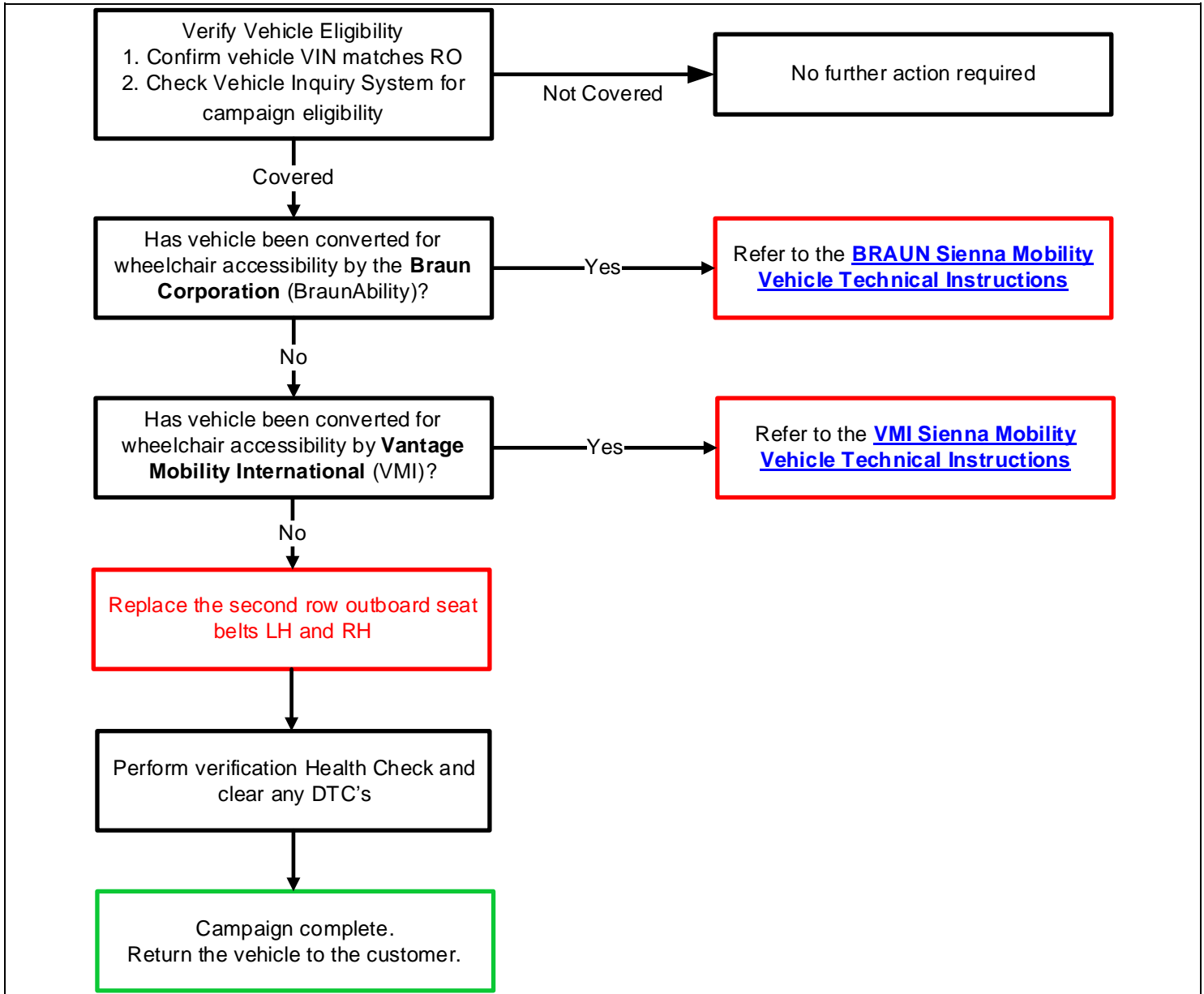

II. IDENTIFICATION OF AFFECTED VEHICLES

- Check the TIS Vehicle Inquiry System to confirm that each VIN is eligible for this Special Service Campaign, and that it has not already been completed prior to dealer shipment or by another dealer.

Note: TMNA warranty will not reimburse dealers for repairs completed on vehicles that are not affected or were completed by another dealer.

III. PREPARATION

A. PARTS

For Gray Trim (most common):

Part Number	Part Description	Quantity
73370-08150-B0	BELT ASSY, REAR SEAT 3 POINT TYPE, OUTER LH	1
73360-08160-B0	BELT ASSY, REAR SEAT 3 POINT TYPE, OUTER RH	1

For Ivory Trim:

Part Number	Part Description	Quantity
73370-08150-A0	BELT ASSY, REAR SEAT 3 POINT TYPE, OUTER LH	1
73360-08160-A0	BELT ASSY, REAR SEAT 3 POINT TYPE, OUTER RH	1

B. TOOLS, SUPPLIES & EQUIPMENT

- Techstream
- Standard Hand Tools
- Torque Wrench

IV. CHECK IF VEHICLE HAS BEEN CONVERTED FOR WHEELCHAIR ACCESSIBILITY

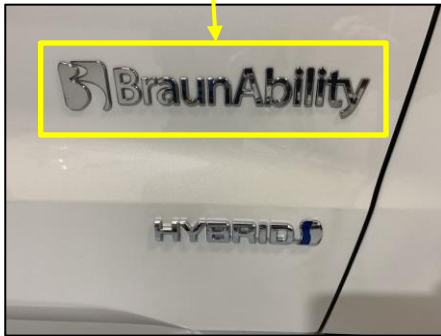

1. CHECK IF VEHICLE BEEN CONVERTED FOR WHEELCHAIR ACCESSIBILITY BY THE BRAUN CORPORATION (BRAUNABILITY).

- a) Refer to graphics on the left to check if vehicle was converted by the Braun Corporation.

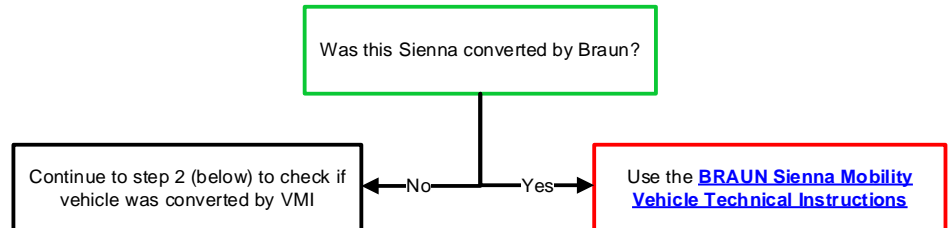

2. CHECK IF VEHICLE BEEN CONVERTED FOR WHEELCHAIR ACCESSIBILITY BY VANTAGE MOBILITY INTERNATIONAL (VMI).

- a) Refer to graphics on the left to check if vehicle was converted by the VMI.

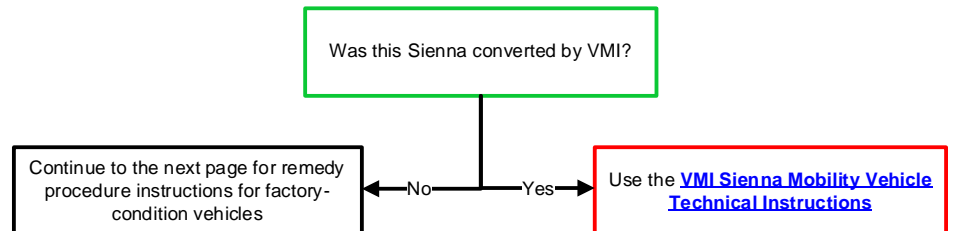

V. REMOVE SECOND ROW OUTBOARD SEAT BELT ASSEMBLY (LH / RH)

1. RECORD SETTINGS OF THE AUDIO SYSTEM, AIR CONDITIONER, ETC.
2. CHECK FOR DTCs
3. MAKE SPACE FOR WORK
4. RECLINE THE SECOND-ROW SEATBACK AND MOVE THE SECOND-ROW SEATS TO THE FRONTMOST POSITION.
5. PULL THE STRAP AND LOCK THE THIRD-ROW SEATBACKS INTO THE UPRIGHT POSITION.
6. DISCONNECT THE NEGATIVE BATTERY CABLE



- Wait at least 90 seconds after disconnecting the cable from the negative battery terminal to prevent airbag and seat belt pretension deployment.
- Follow all precautions as outlined on TIS before servicing the SRS system.

7. REMOVE THE SECOND ROW OUTBOARD SEAT BELT ASSEMBLIES (LH and RH)

[Refer to TIS for instructions on SEAT BELT / REAR NO. 1 SEAT OUTER BELT ASSEMBLY \(for 60/40 Split Seat Type\) / REMOVAL \(Doc ID: RM100000001NT97\).](#)

NOTE:

Reference and perform the following procedures on TIS repair manual until the step “n”

- a) Remove the rear door scuff plate.
- b) Disconnect the rear door opening trim weatherstrip.
- c) Remove the quarter trim front lower cover.
- d) Disconnect the No. 2 rear door wire.
- e) Disconnect rear seat 3 point type outer belt assembly (remove floor anchor bolt)
- f) Remove the rear seat outer belt cover.
- g) Disconnect rear No. 2 seat outer belt assembly (remove c-pillar anchor bolt)
- h) Remove the luggage hold belt striker assembly.
- i) Remove the back door scuff plate.
- j) Remove the spare wheel cover assembly (w/ spare tire).
- k) Remove the quarter trim front panel assembly LH.
- l) Remove the quarter trim front panel assembly RH.
- m) Remove the rear window side garnish assembly.

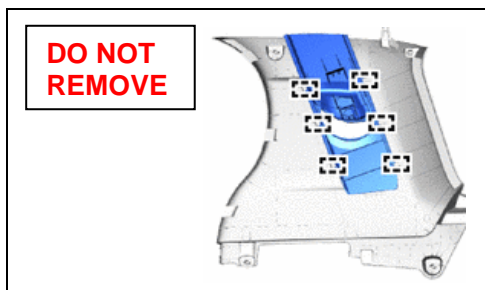

- n) **DO NOT REMOVE** the rear shoulder belt anchor plate sub-assembly

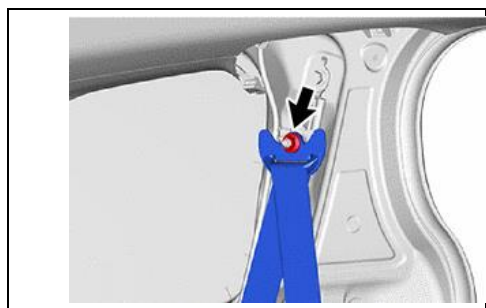

- o) Remove the nut to disconnect the shoulder anchor of the rear 3 point type outer belt assembly.

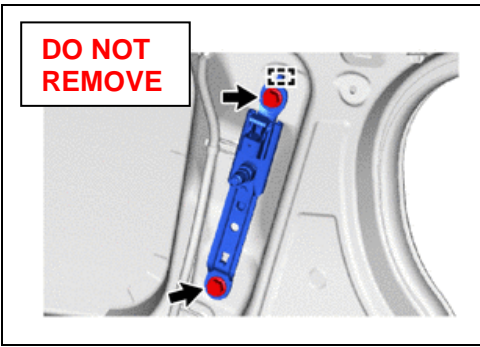

p) **DO NOT REMOVE** the rear shoulder belt anchor adjuster assembly.

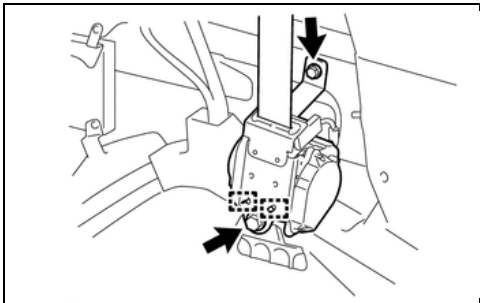

q) Remove the 2 bolts.
Disengage the 2 guides to separate the rear 3 point type outer belt assembly.

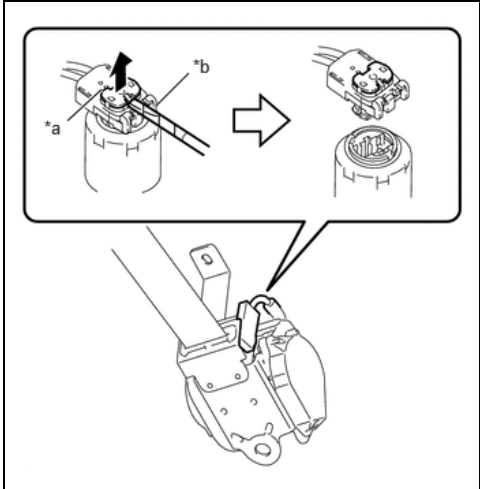

r) Using a screwdriver with its tip wrapped in protective tape, pull out the locking button to release the lock to disconnect the pretensioner connector as shown in the illustration.

*a	Locking Button
*b	Protective Tape

NOTE:
Use the same procedure for LH side and RH side.

VI. INSTALL **NEW** SECOND ROW OUTBOARD SEAT BELT ASSEMBLY (LH / RH)



1. CONFIRM THE “L” OR “R” MARK ON **NEW** SEAT BELT



DO NOT install seat belt on incorrect side

2. INSTALL **NEW** REAR SEAT 3 POINT TYPE OUTER BELT ASSEMBLY LH AND RH

[Refer to TIS for instructions on SEAT BELT / REAR NO. 1 SEAT OUTER BELT ASSEMBLY \(for 60/40 Split Seat Type\) / INSTALLATION \(Doc ID: RM100000001NT99\).](#)

NOTE:

Reference and perform the following procedures on in this document until the step “f” (switch to TIS repair manual).

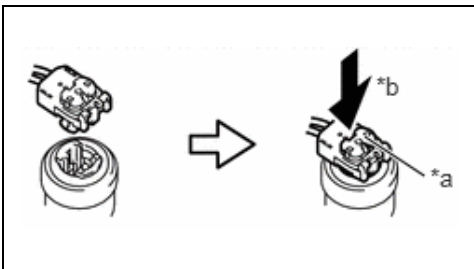

- a) Connect the pretensioner connector and lock the locking button as shown in the illustration.

*a	Locking Button
*b	Lock

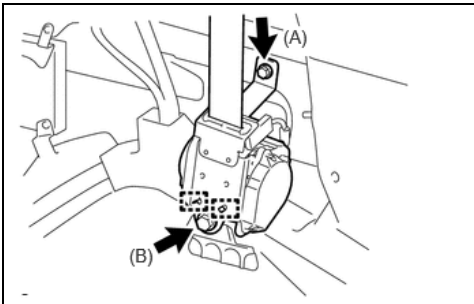

- b) Engage the 2 guides to temporarily install the rear 3 point type outer belt assembly.
 c) Temporarily install the 2 bolts.
 d) Tighten the bolt (A) and then the bolt (B).

Torque:

Bolt (A) 12.5 N*m (127 kgf*cm, 9 ft.*lbf)

Bolt (B) 42 N*m (428 kgf*cm, 31 ft.*lbf)

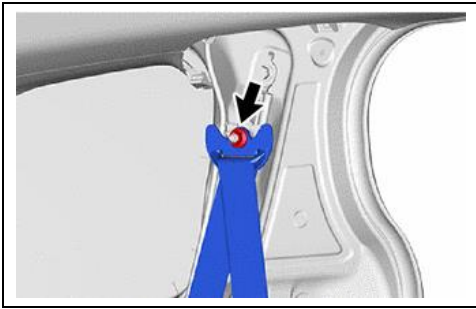

- e) Install the shoulder anchor of the rear 3 point type outer belt assembly with the bolt.

Torque: 42 N*m (428 kgf*cm, 31 ft.*lbf)

- f) Install the rear window side garnish assembly.
 g) Install the quarter trim front panel assembly LH.
 h) Install the quarter trim front panel assembly RH.
 i) Install the spare wheel cover assembly (w/ spare tire).
 j) Install back door scuff plate.
 k) Install luggage hold belt striker assembly.
 l) Connect the rear No. 2 seat outer belt assembly with the bolt

Torque:

42 Nm (428 kgf cm, 31 ft lbs)

- m) Install the rear seat outer belt cover.
 n) Connect rear seat 3-point type outer belt assembly (install floor anchor bolt)

Torque:

42 Nm (428 kgf cm, 31 ft lbs)

- o) Connect the No. 2 rear door wire.

Torque:

11 Nm (112 kgf cm, 8 ft lbs)

- p) Install the quarter trim front lower cover.
 q) Connect the rear door opening trim weatherstrip.
 r) Install quarter trim front lower cover
 s) Connect rear door opening trim weather strip
 t) Install the rear door scuff plate

NOTE:

Use the same procedure for LH side and RH side.

3. RECONNECT THE NEGATIVE BATTERY CABLE

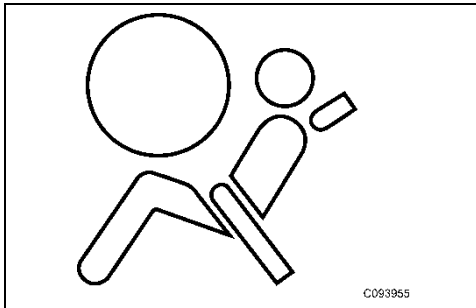

4. INSPECT SRS WARNING LIGHT

- f) Check that the airbag warning light lights when the power switch is turned on.
 g) Check that the airbag warning light goes off approximately 6 seconds after turning on of the ignition switch.

NOTE:

If the airbag warning light remains on, it is likely to be caused by connection failure of the pretensioner connector.

5. CHECK FOR DTCs

6. Refer to TIS for instructions on General / SETUP / WHEN DISCONNECTING OR RECONNECTING BATTERY TERMINAL / WORK PROCEDURE (Doc ID: RM1000000103VN)

7. RETURN THE VEHICLE TO THE ORIGINAL STATE

◀ VERIFY REPAIR QUALITY ▶

- Confirm applicable initializations have been performed.
- Confirm there are no DTC's after the replacement

VII. APPENDIX

A. PARTS DISPOSAL

In accordance with Federal law, please make sure all recalled parts (original parts) removed from the vehicle are disposed of in a manner in which they will not be reused, ***unless requested for parts recovery return.***

Campaign Designation / Phase Decoder

