



June 2022

Dealer Service Instructions for:

Safety Recall Y92 / NHTSA 21V-878

Fuel Delivery Module

Remedy Available

2019 (BA) Fiat 124 Spider

NOTE: Some vehicles above may have been identified as not involved in this recall and therefore have been excluded from this recall.

IMPORTANT: Some of the involved vehicles may be in dealer used vehicle inventory. Dealers should complete this recall service on these vehicles before retail delivery. Dealers should also perform this recall on vehicles in for service. Involved vehicles can be determined by using the VIP inquiry process.

Subject

The Fuel Delivery Module (FDM) on about 1,620 of the above vehicles may have been built with impellers that could deform. A FDM with a deformed impeller may interfere with other fuel pump components which can inhibit the operation of the fuel pump, potentially causing fuel starvation. Fuel starvation may result in an unexpected loss of motive power, which increases the risk of a vehicle crash without prior warning.

Repair

Replace the fuel pump within the fuel delivery module.

Service Procedure

A. Remove Fuel Delivery Module

1. Open the engine compartment hood.

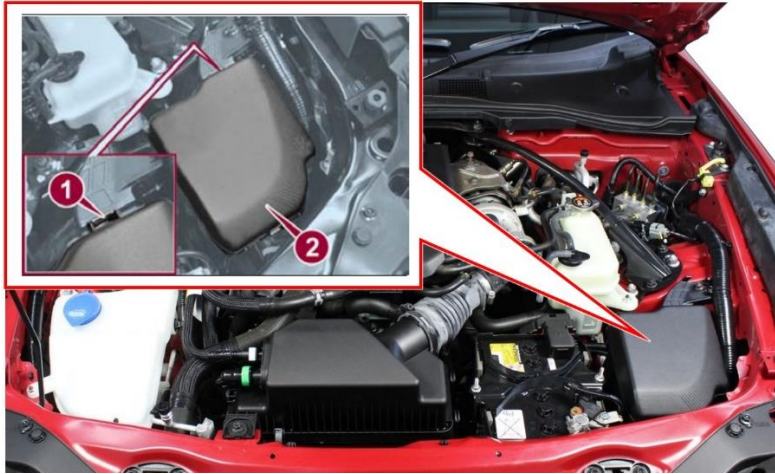

Figure 1 – Fuse Box

2. Release the fuse box latch (1) then open the cover (2) (Figure 1).

3. Remove fuel system fuse F34 (15A) (Figure 2).

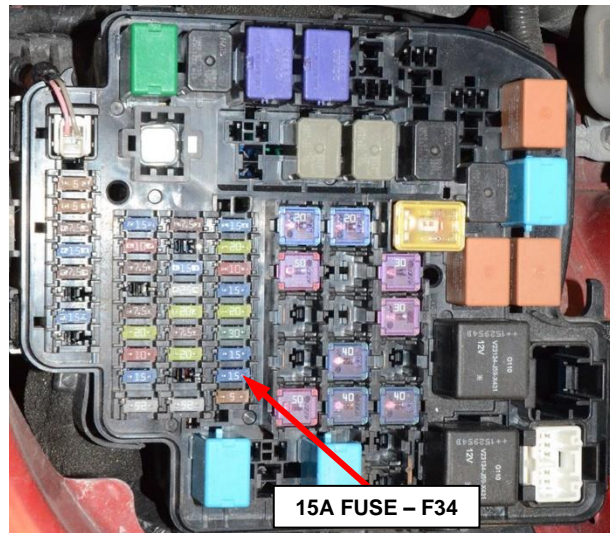

Figure 2 – Fuel System Fuse

4. Start the engine several times until the fuel pressure in the distribution manifold is expended.

5. Place the ignition switch in the "OFF" position.

Service Procedure [Continued]

6. Loosen the nut (1) then disconnect and isolate the battery negative cable terminal (2) (Figure 3).

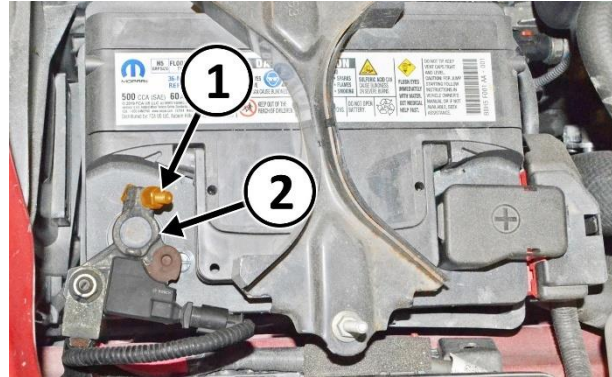

Figure 3 – Battery Negative Terminal

7. Install the F34 fuse removed previously then close the fuse box cover (Figures 2 and 1).

NOTE: lowering the convertible top may provide more working space for many of the following steps.

8. **If vehicle is equipped with an automatic transmission,** remove the gear shift knob trim cover (1) from the gear shift knob. Using a pick tool, release the retaining clip (2) from the front side of the knob, then remove the gear shift knob from the shift lever (Figure 4).

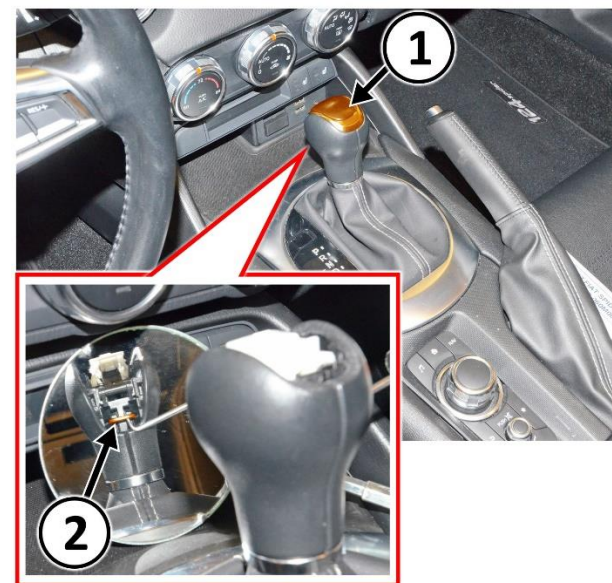

Figure 4 – Automatic Shift Knob

9. **If vehicle is equipped with a manual transmission,** remove the gear shifter knob trim cover (1). Remove the gear shifter knob (2) from the shift lever (Figure 5).



Figure 5 – Manual Shift Knob

Service Procedure [Continued]

- Using a trim stick or equivalent, lift the shifter bezel (1) releasing the retaining clips (Figure 6).



- If vehicle is equipped with an automatic transmission, disconnect the wire harness connector (3) from the shift indicator (Figure 6).



- Remove the mat (2) and the shifter bezel (1) together (Figure 6).



Figure 6 – Shifter Bezel

- Lift the center console armrest.

Service Procedure [Continued]

14. Using a trim stick, lift the center console radio control switch bezel (1) while releasing the retaining clips (2) (Figure 7).

15. Disconnect the electrical connector (3) then remove the center console radio control switch and bezel assembly (Figure 7).

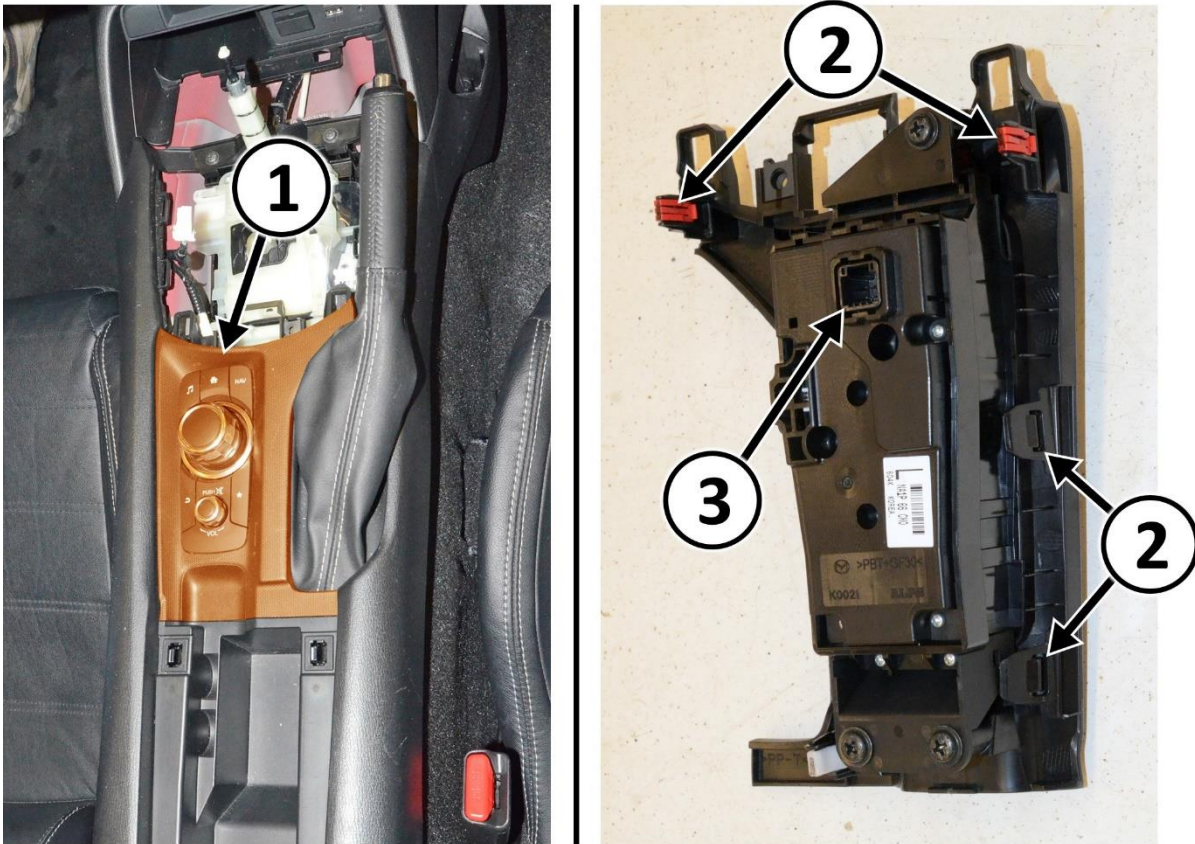

Figure 7 – Center Console Radio Control Switch and Bezel Assembly

Service Procedure [Continued]

16. Remove the screws (1) at the front of the center console top bezel (Figure 8).

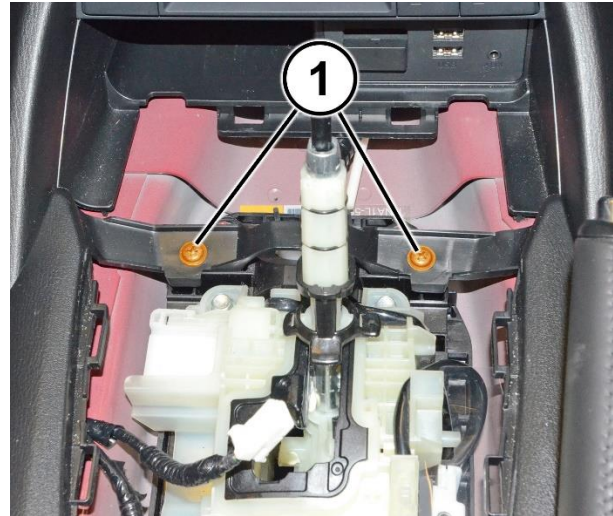
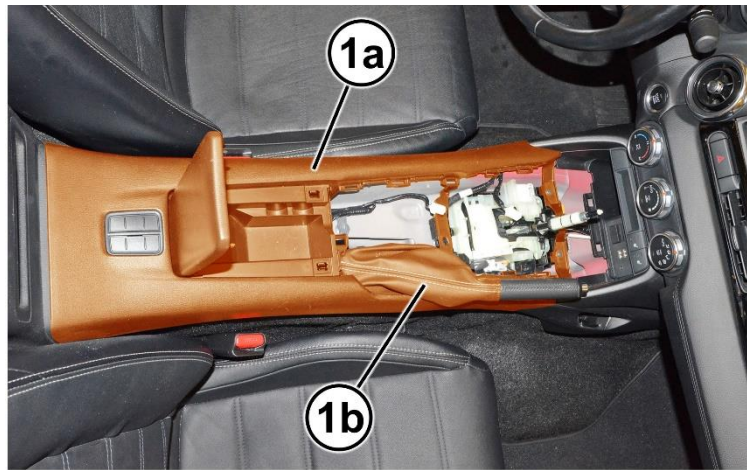

Figure 8 – Console Top Bezel Screws

17. Raise the parking brake lever fully.

18. Lift at the rear of the center console top bezel (1a) to release the retainers (1c) (Figure 9).



19. Pull the center console top bezel (1a) slightly rearward to disengage the bezel from the instrument panel (Figure 9).

20. Raise the center console top bezel (1a) up while sliding the parking brake lever sleeve (1b) off the parking brake lever, then remove the bezel (1a) with sleeve (1b) from the vehicle (Figure 9).

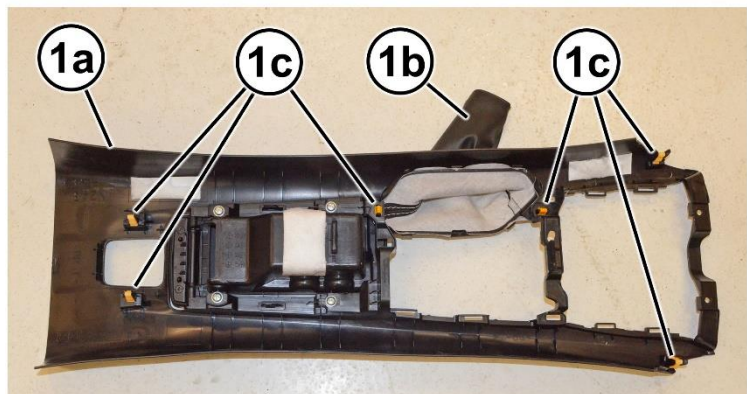

Figure 9 – Center Console Top Bezel

Service Procedure [Continued]

21. Using a suitable trim stick tool, remove the door sill scuff plate (1a) from both sides of the vehicle by disengaging the retainers (1b) (Figure 10).

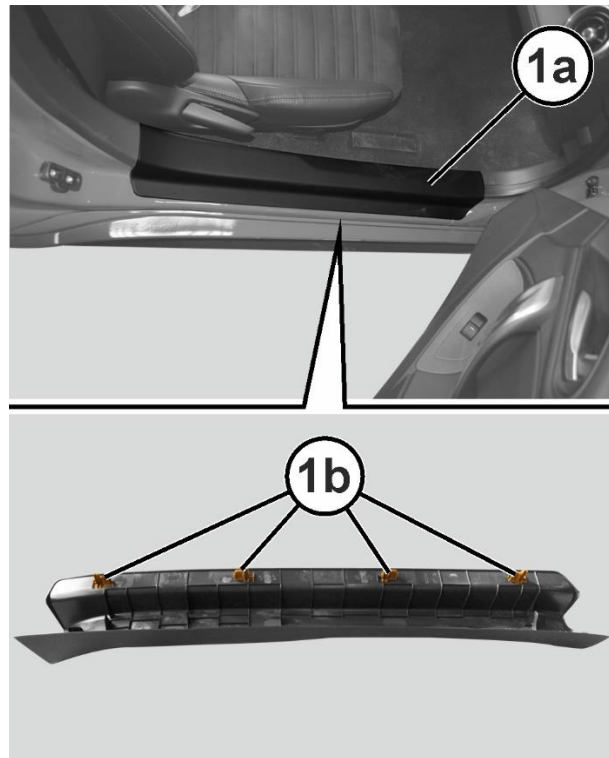

Figure 10 – Door Sill Scuff Plate

22. Position both seats fully forward.



Figure 11 – Both Seats Full Forward

Service Procedure [Continued]

23. Using a suitable trim tool, remove the roll bar trim (1a) from both sides of the vehicle by disengaging the retainers (1b) (Figure 12).



Figure 12 – Roll Bar Trim

Service Procedure [Continued]

24. Remove the seat belt trim fastener (1a) (Figure 13).
25. Slide the seat belt (1b) through the slot in the seat belt trim (2) (Figure 13).
26. Remove the seat belt trim (2) from both sides of the vehicle (Figure 13).

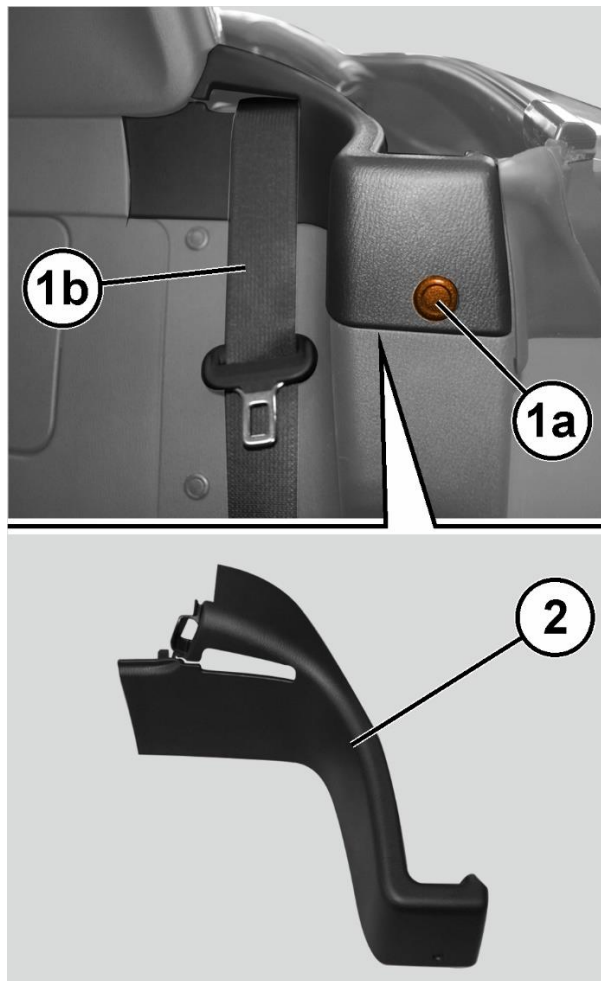

Figure 13 – Seat Belt Trim

Service Procedure [Continued]

27. Remove the fasteners (1a) of the B-pillar trim (1b) (Figure 14).
28. Remove the B-pillar trim (1b) from both sides of the vehicle (Figure 14).

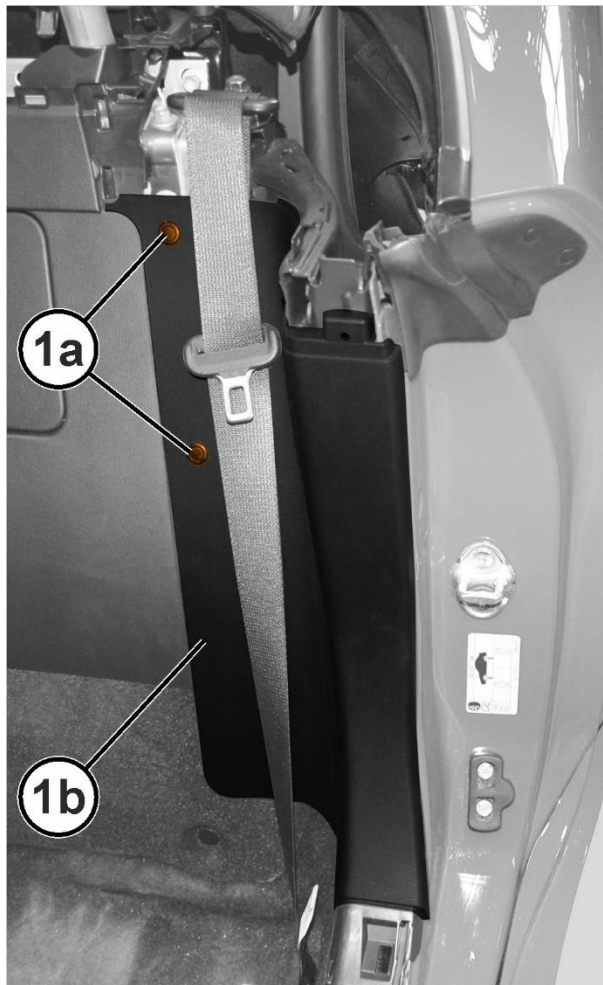

Figure 14 – B-Pillar Trim

Service Procedure [Continued]

29. Remove the convertible top release lever handle (1) from the release lever (1a) (Figure 15).
30. Remove the four fasteners (2) from the rollbar trim and storage bins panel (Figure 15).
31. Disengage the retaining clips then remove the rollbar trim and storage bins panel from the vehicle (Figure 15).

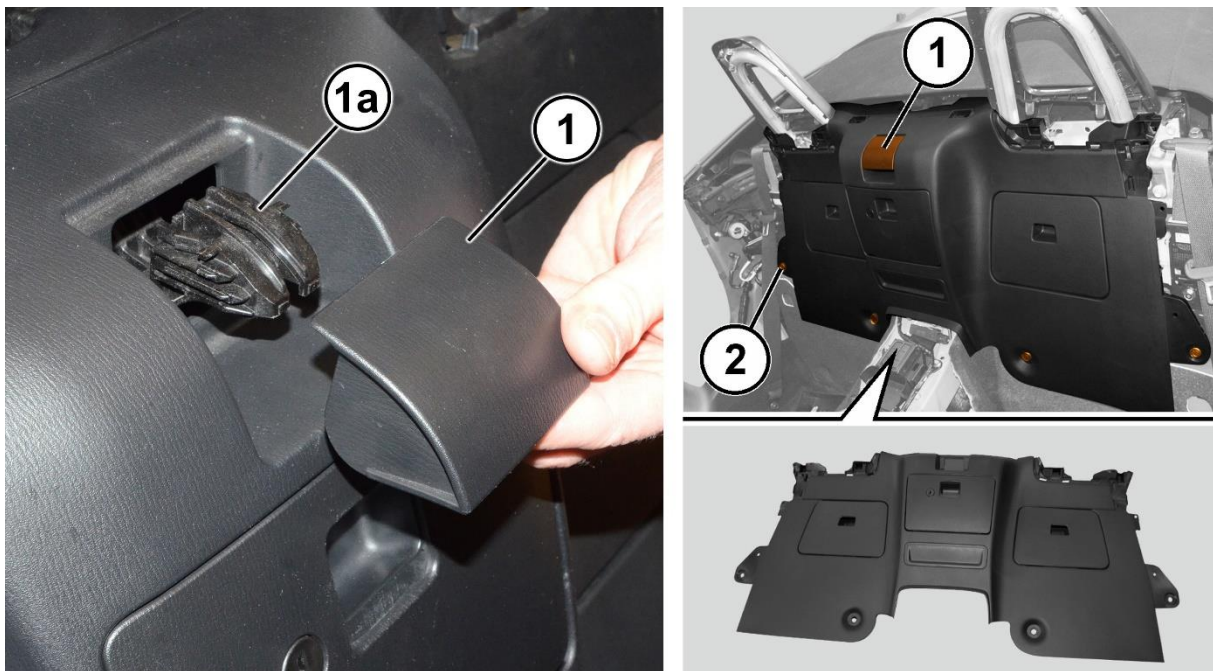

Figure 15 – Convertible Top Handle / Rollbar Trim and Storage Bins Panel

Service Procedure [Continued]

WARNING: The vehicle battery must be disconnected as instructed to do so in Step 6 of this procedure and at least 1 minute has passed since disconnecting the battery before disconnecting the seat belt retractor electrical connector.

32. Disconnect the electrical connector (1) from the seat belt retractor (Figure 16).
33. Unscrew the seat belt turning loop bolt (2) and position it aside (Figure 16).
34. Remove the seat belt retractor lower bolt (3) (Figure 16).
35. Remove the seat belt retractor upper bolt (4) (Figure 16).
36. Remove the seat belt retractor (5) from both sides of the vehicle and position aside out of the work area (Figure 16).

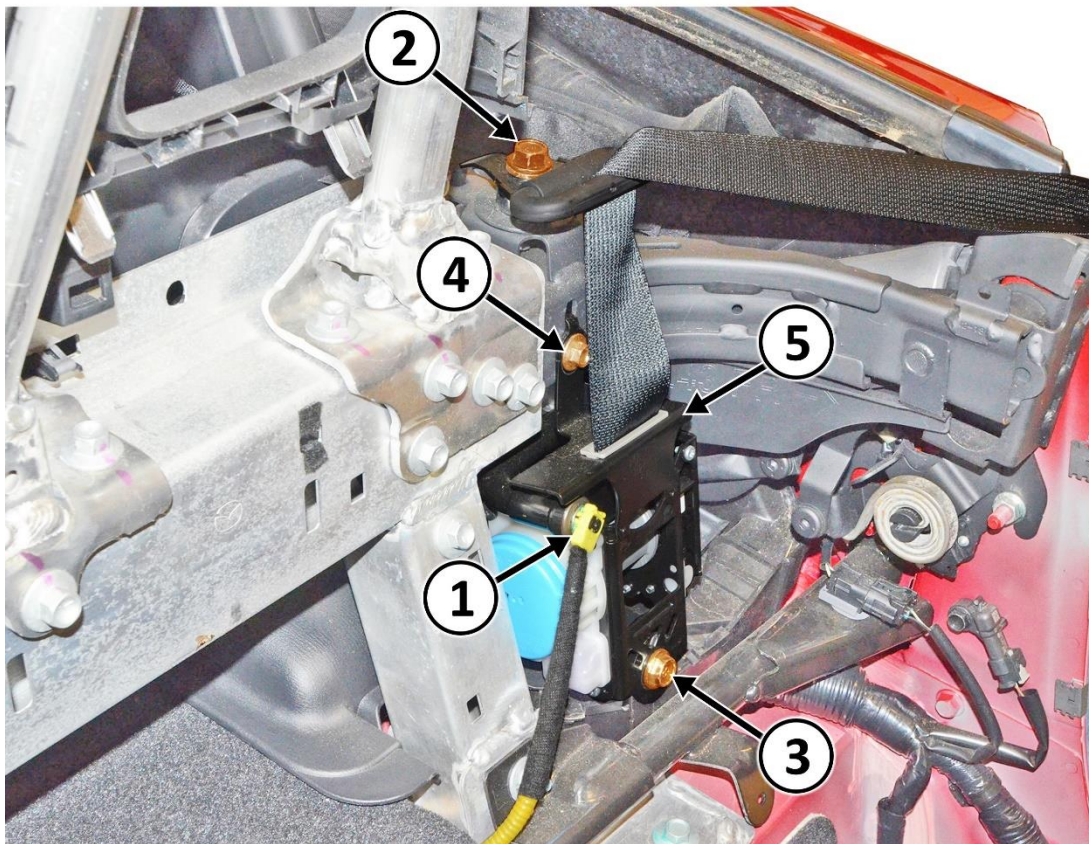
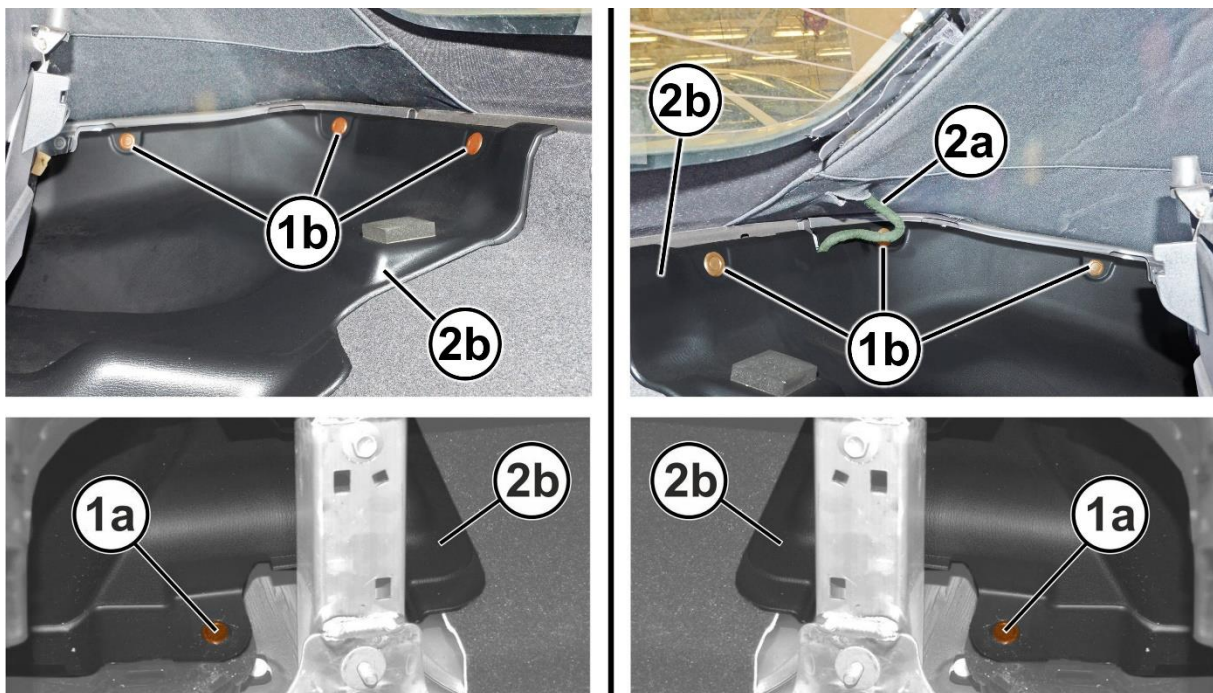

Figure 16 – Seat Belt Retractor and Turning Loop

Service Procedure [Continued]

NOTE: The convertible top will need to be in the raised position for many of the following steps.

37. Using a suitable trim tool remove the lower fastener (1a) and the upper fasteners (1b) from the convertible top compartment side trim panels (Figure 17).
38. Release the rear window heater grid wiring (2a) from the slot in the left side trim panel (2b) (Figure 17).
39. Remove both convertible top compartment side trim panels (2b) from the vehicle (Figure 17).



Right Side

Left Side

Figure 17 – Convertible Top Compartment Trim Panels

Service Procedure [Continued]

40. Remove the lower fasteners (1a) and upper fasteners (1b) securing the convertible top compartment carpet (Figure 18).

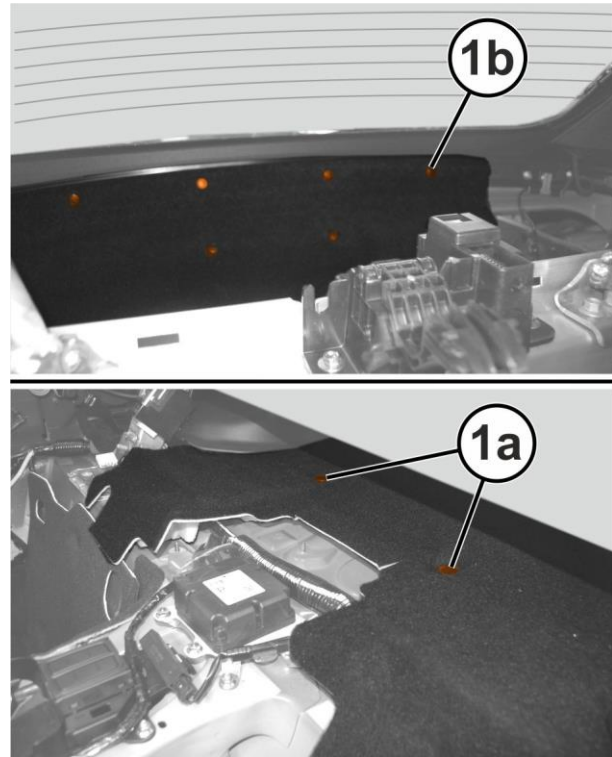

Figure 18 – Compartment Carpet

41. Remove the convertible top compartment carpet (1) from the vehicle (Figure 19).

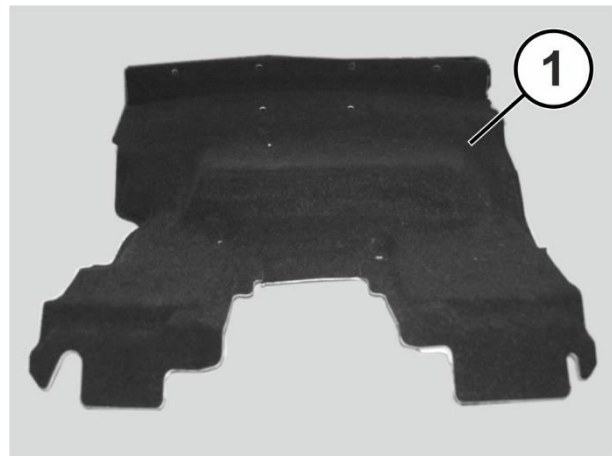

Figure 19 – Compartment Carpet

Service Procedure [Continued]

- 42. Release the wire harness retainer (1) from the fuel delivery module cover (2b) (Figure 20).
- 43. Remove the screws (2a) then remove the fuel pump module cover (2b) (Figure 20).
- 44. Clean any dust or debris from the fuel pump module area prior to working on any fuel pump module components (Figure 21).

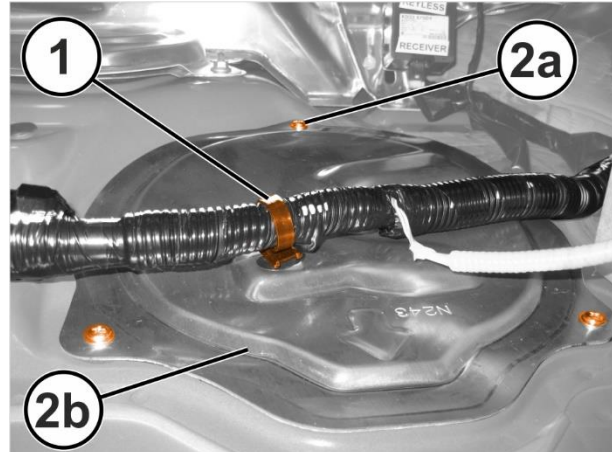

Figure 20 – Fuel Module Cover

CAUTION: Protect the vehicle interior from fuel spillage. The fuel module will contain fuel during removal which may spill.

- 45. Disconnect the electrical connector (1a) from the fuel delivery module (Figure 21).
- 46. Release the quick coupling and disconnect the fuel pipe (1b) from the fuel delivery module (Figure 21).
- 47. Remove the screws (2a) and the retaining ring (2b) (Figure 21).

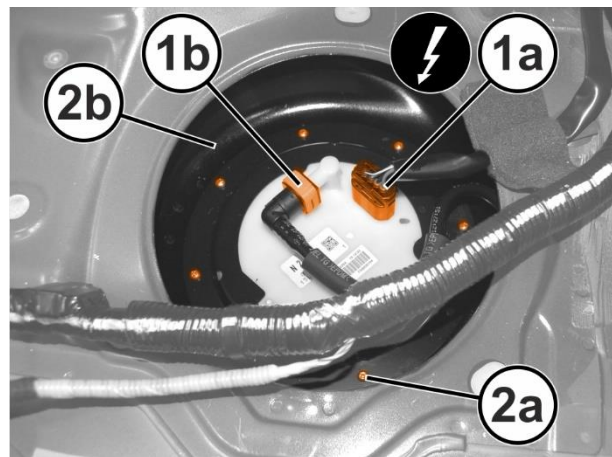

Figure 21 – Fuel Module Connections

- 48. Remove the fuel delivery module (1a) from the fuel tank (Figure 22).
- 49. Remove and **DISCARD** the module gasket (1b) (Figure 22).

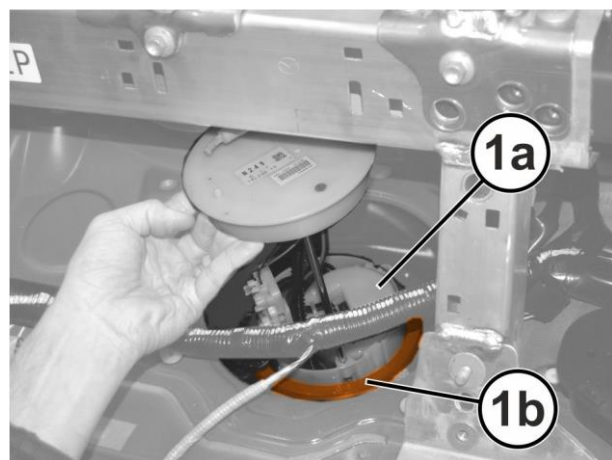

Figure 22 – Fuel Delivery Module

Service Procedure [Continued]

NOTE: Prepare a clean work surface for fuel delivery module disassembly and reassembly to avoid possibility of contamination.

50. Disconnect electrical connectors for fuel pump (1a) and fuel level sender (1b) then release the wires from the fuel delivery module cover wire retainer hook (2) (Figure 23).

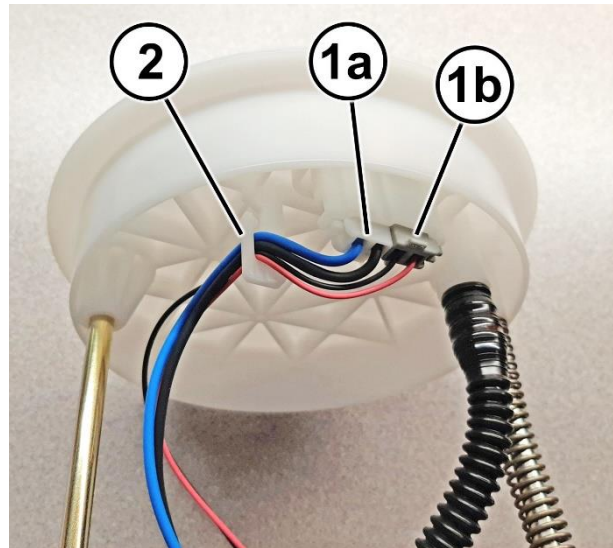

Figure 23 – Electrical Connectors

51. Release the locking tab (1a) then slide the fuel level sending unit with float (1b) up to release and remove it from the fuel delivery module (Figure 24).

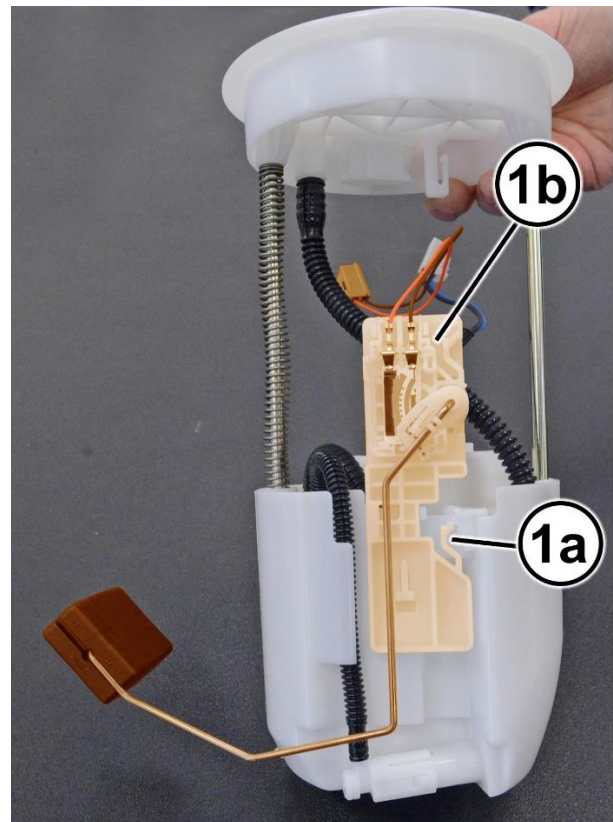

Figure 24 – Fuel Level Sending Unit

Service Procedure [Continued]

CAUTION: During the following steps, do NOT attempt to disconnect any fuel pump module assembly hoses. There is enough hose length to perform all the following steps without disconnecting any hoses. Use care to not kink or damage the hoses while disassembling and reassembling the fuel pump module.

52. Remove the clip (1a) to release the tie rod (1b) and cover (1c) from the fuel delivery module lower housing (Figure 25).

NOTE: The retaining clip (1a) may be discarded, a new clip will be provided with the new fuel pump.

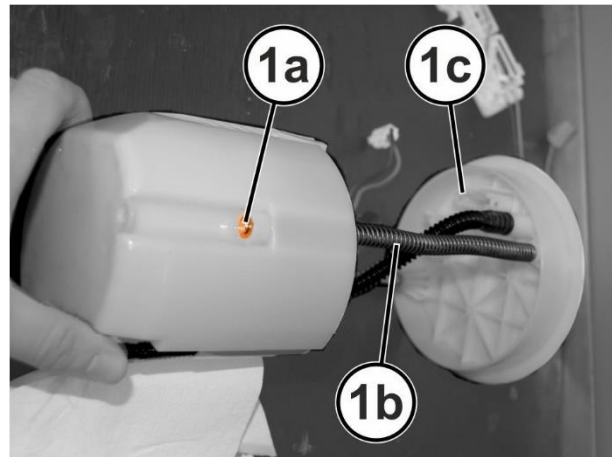

Figure 25 – Tie Rod Clip

53. The cover (1c) and tie rods (1b) may now be separated from the fuel delivery module lower housing. (Figure 25). Use care to not stress or kink the hose.

54. Release the fuel pump wire harness (1a) from under the retainer (2) (Figure 26).

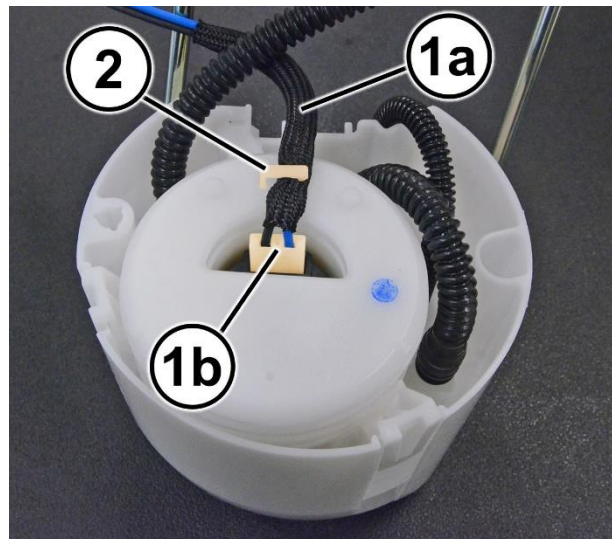
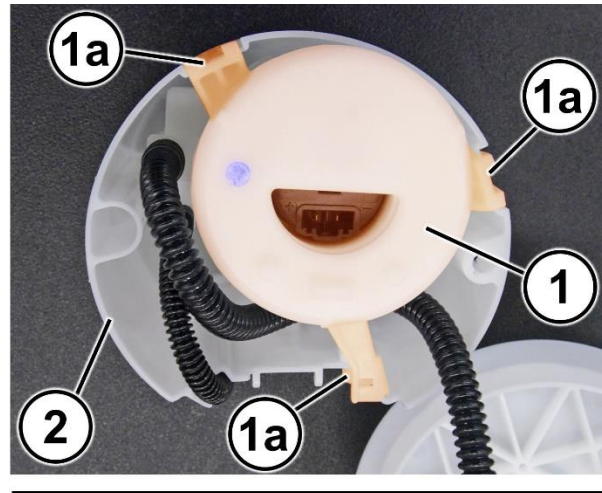

Figure 26 – Fuel Pump Wire Harness

55. Disconnect the fuel pump wire harness connector (1b) from the fuel pump motor then remove the wire harness (1a) (Figure 26).

Service Procedure [Continued]

56. Lift the three tabs (1a) releasing the fuel delivery module upper housing (1) from the fuel delivery module lower housing (2) (Figure 27).



57. Separate the upper module housing assembly (1) from the lower module housing (2) (Figure 27).

NOTE: There is a hose attached between the upper housing (1) and lower housing (2). Do NOT attempt to disconnect this hose and use care to not kink the hose.

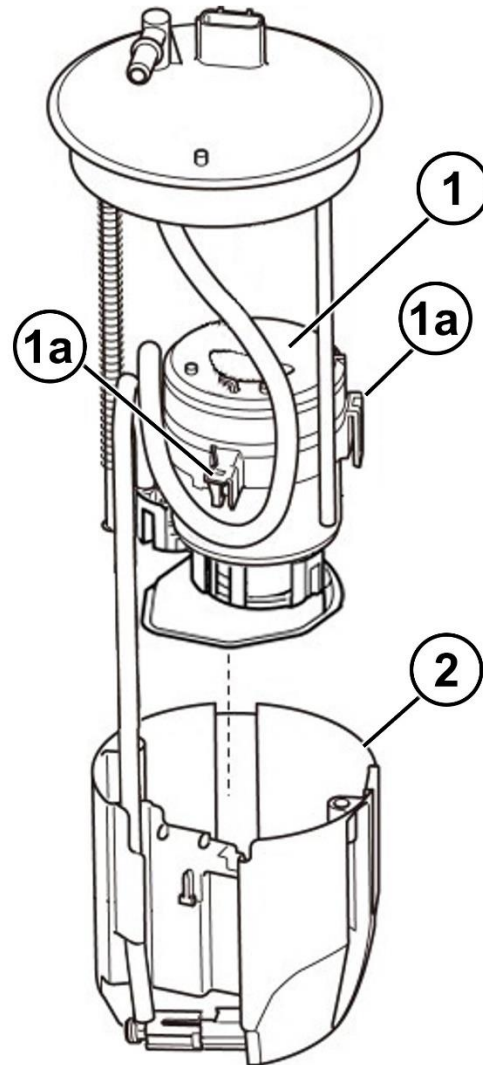

Figure 27 – Module Housing Retainers

Service Procedure [Continued]

- 58. Lift the five tabs (1a) releasing the fuel filter (1) from the fuel delivery module upper housing (2) (Figure 28).

- 59. Separate the fuel filter (1) from the fuel delivery module upper housing (2) (Figure 28).

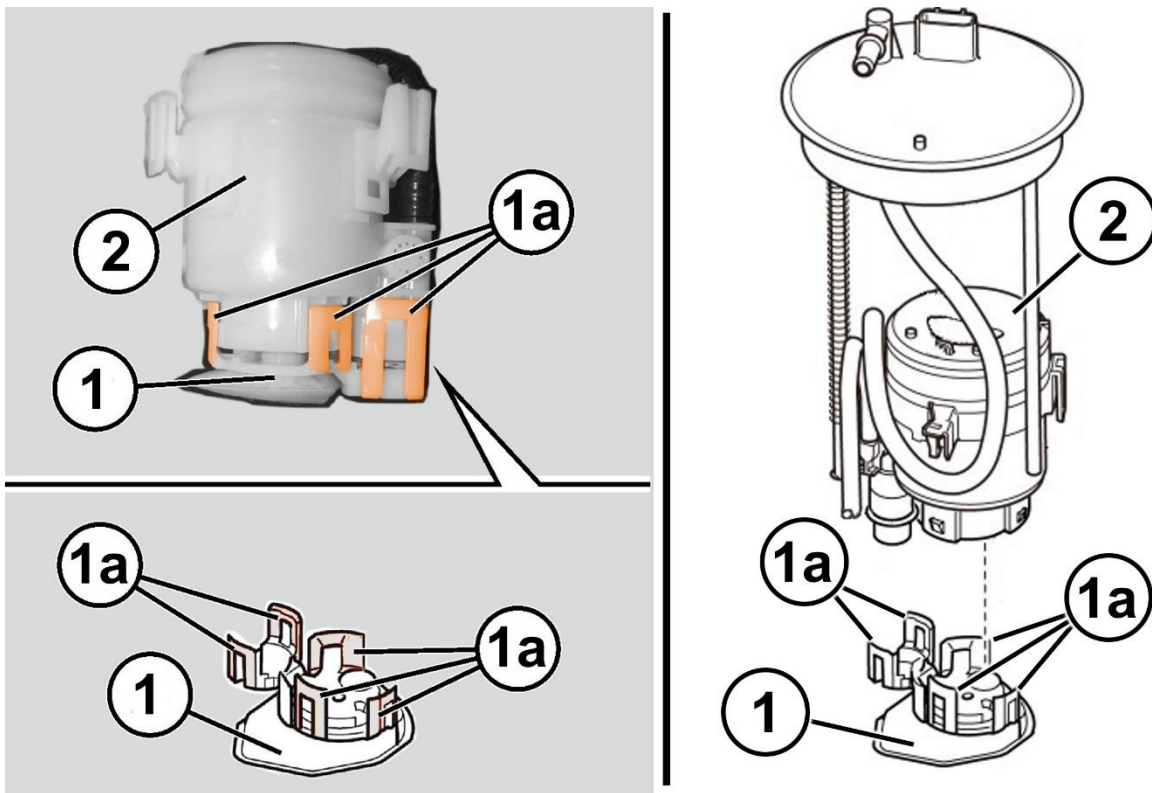

Figure 28 – Fuel Module Filter

Service Procedure [Continued]

NOTE: Do NOT attempt to remove the fuel pressure regulator (5) (Figure 29).

60. Remove the fuel pump (1), spacer (3), and seal (2) from the fuel delivery module upper housing (4) (Figure 29).

61. **DISCARD** the fuel pump (1), spacer (3), and seal (2) (Figure 29).

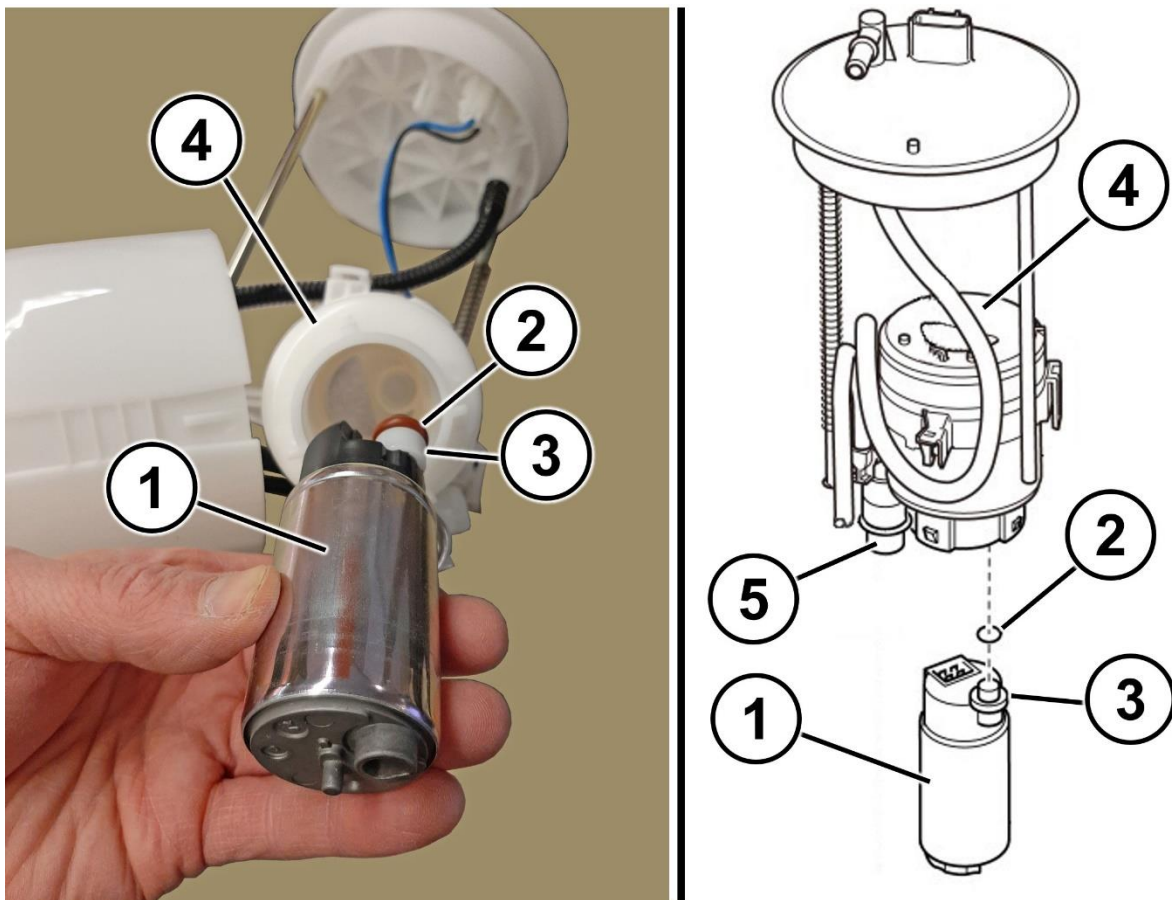
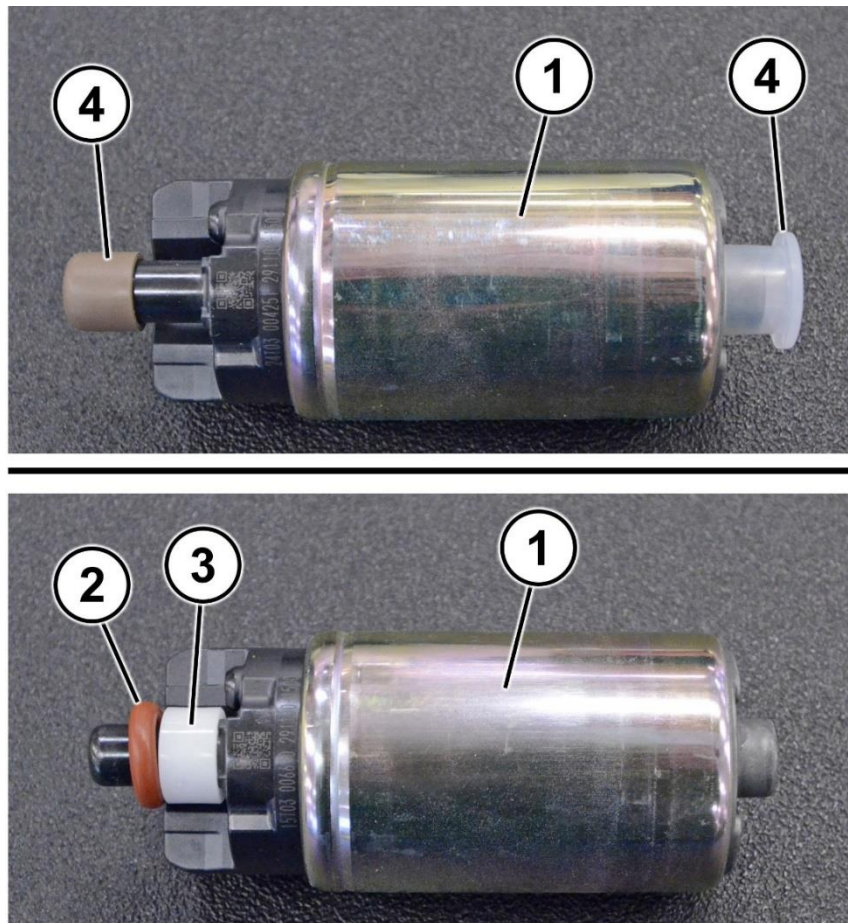

Figure 29 – Fuel Pump

Service Procedure [Continued]**B. Install Fuel Delivery Module**

1. Obtain the **NEW** fuel pump (1), then discard the shipping caps (4) (Figure 30).
2. Assemble the **NEW** fuel pump (1), **NEW** spacer (3), and **NEW** seal (2) (Figure 30).

**Figure 30 – Fuel Pump**

3. Install the **NEW** fuel pump (1), **NEW** spacer (3), and **NEW** seal (2) into the fuel delivery module upper housing (4) (Figure 29).
4. Position the fuel filter (1) to the fuel delivery module upper housing (2) and secure the five retaining clips (Figure 28).

Service Procedure [Continued]

NOTE: Pay attention to the fuel delivery module hose routing during reassembly. Hose (3) must pass under retainer (1a) (Figure 31).

5. Assemble the fuel delivery module upper housing (1) to the fuel delivery module lower housing (2) then secure with the tabs (1a) (Figure 27).

6. Connect the fuel pump wire harness electrical connector (1b) to the fuel pump motor (Figure 26).

7. Secure the fuel pump wire harness (1a) under the retainer (2) (Figure 26).

8. Insert the module cover (1c) with tie rods (1b) and spring assembly into the fuel delivery module assembly lower housing, then install the retaining clip (1a) to the tie rod (1b) (Figure 25).

9. Install the fuel level sending unit with float (1b) and secure the tab (1a) (Figure 24).

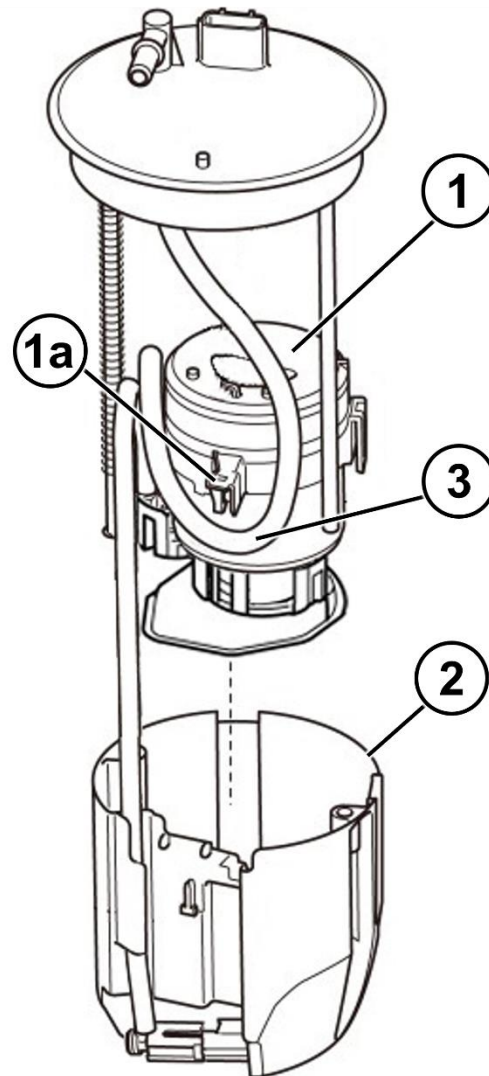
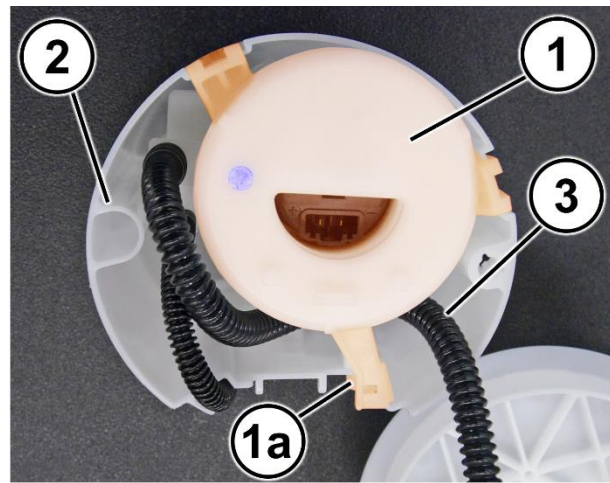

Figure 31 – Module Hose Routing

Service Procedure [Continued]

10. Connect the electrical connectors for fuel pump (1a) and fuel level sender (1b) to the fuel delivery module cover then secure the wires with the retainer (2) (Figure 23).
11. Ensure the fuel delivery module gasket seating area on the fuel tank is clean and free of debris.
12. Position the **NEW** fuel delivery module gasket (1b) on the fuel tank then insert the fuel delivery module (1a) into the fuel tank (Figure 22).
13. Place the retaining ring (2b) in position then secure it using the screws (2a) (Figure 21).
14. Connect the fuel pipe quick coupling (1b) to the fuel delivery module (Figure 21).
15. Connect the electrical connector (1a) to the fuel delivery module (Figure 21).
16. Place the fuel delivery module cover (2b) in position then tighten the screws (2a) (Figure 20).
17. Attach the wiring retainer (1) to the fuel delivery module cover (Figure 20).
18. Install the convertible top compartment carpet (1) in the vehicle (Figure 19).
19. Secure the convertible top compartment carpet with lower fasteners (1a) and upper fasteners (1b) (Figure 18).

Service Procedure [Continued]

20. Install both convertible top compartment side trim panels (2b) in the vehicle and insert the rear window heater grid wiring (2a) in the slot of the left side trim panel (2b) (Figure 17).
21. Secure both convertible top compartment side trim panels with lower fastener (1a) and the upper fasteners (1b) (Figure 17).

NOTE: Ensure the seat belts lay properly and are not twisted before installing the seat belt retractors.

22. Position the seat belt retractor (5) then install the upper bolt (4) and tighten to 9 N·m (80 in. lbs.) (Figure 16).
23. Install the seat belt retractor lower bolt (3) and tighten to 59 N·m (44 ft. lbs.) (Figure 16).
24. Position the seat belt turning loop (2) then tighten the turning loop bolt to 67 N·m (49 ft. lbs.) (Figure 16).
25. Connect the electrical connector (1) to the seat belt retractor (Figure 16).
26. Position the rollbar trim and storage bins panel then secure with the four fasteners (2) (Figure 15).
27. Install the convertible top release lever handle (1) to the release lever (1a) (Figure 15).

Service Procedure [Continued]

28. Position the B-pillar trim (1b) and secure using the fasteners (1a) (Figure 14).
29. Slide the seat belt (1b) through the slot in the seat belt trim (2) (Figure 13).
30. Position the seat belt trim (2) then secure with fastener (1a) (Figure 13).
31. Position the roll bar trim (1a) and secure its retainers (1b) (Figure 12).
32. Slide seats rearward with the seat backs reclined in their original up position.
33. Install the door sill scuff plate (1a) by engaging the retainers (1b) (Figure 10).
34. Lower the center console top bezel (1a) while sliding the parking brake lever sleeve (1b) over the parking brake lever (Figure 9).
35. Position the center console top bezel (1a) and engage the retainers (1c) (Figure 9).
36. Install and tighten the screws (1) at the front of the center console (Figure 8).
37. Connect the electrical connector (3) to the center console radio control switch and bezel assembly (1) then install it into the center console while engaging the retaining clips (2) (Figure 7).
38. Lower the center console armrest.

Service Procedure [Continued]

39. Position the mat (2) and the shifter bezel (1) assembly to the center console and over the shift lever handle (Figure 6).
40. If vehicle is equipped with an automatic transmission, connect the wire harness connector (3) to the shift indicator (Figure 6).
41. Install the shifter bezel by engaging the retaining clips (Figure 6).
42. If vehicle is equipped with a manual transmission, install the gear shifter knob (2) to the shift lever then install the gear shifter knob trim cover (1) (Figure 5).
43. If vehicle is equipped with an automatic transmission, (while the shift knob is off the shift lever) push the retaining clip (2) into position and install the shift knob trim cover (1). Then install the gear shift knob onto the shift lever and push down to engage the retaining clip to the shift lever (Figure 4).
44. Connect the battery negative terminal (2) to the battery then tighten the nut (1) to 5 N·m (44 in. lbs.) (Figure 3).
45. Start and run the engine briefly to ensure fuel pump is working as it should.
46. Close the engine compartment hood.
47. Lower the parking brake lever if not already done so.
48. Complete Proof of Correction Form for California Residents.
49. Return the vehicle to customer or inventory.

Complete Proof of Correction Form for California Residents

This recall is subject to the **State of California Registration Renewal/Emissions Recall Enforcement Program**. Complete a Vehicle Emission Recall Proof of Correction Form (**Form No. 81-016-1053**) and **supply it to vehicle owners residing in the state of California** for proof that this recall has been performed when they renew the vehicle registration.

Process Steps to obtain the California Proof of Correction form:

- a. Access the “**DealerCONNECT**” website.
- b. Select the “**Service**” tab.
- c. Under the “**Publications**” heading, select the “**ePublishing**” link.
- d. Sign in using your **Dealer Code** and **Password**.
- e. Select the “**Proof of Correction form**”.

Completion Reporting and Reimbursement

Claims for vehicles that have been serviced must be submitted on the DealerCONNECT Claim Entry Screen located on the Service tab. Claims paid will be used by FCA to record recall service completions and provide dealer payments.

Use the following labor operation number and time allowance:

	Labor Operation Number	Time Allowance
Remove Fuel Module and Replace Fuel Pump	14-Y9-21-82	1.6 hours

Add the cost of the recall parts plus applicable dealer allowance to your claim.

NOTE: See the Warranty Administration Manual, Recall Claim Processing Section, for complete recall claim processing instructions.

Dealer Notification

To view this notification on DealerCONNECT, select “Global Recall System” on the Service tab, then click on the description of this notification.

Owner Notification and Service Scheduling

All involved vehicle owners known to FCA are being notified of the service requirement by first class mail. They are requested to schedule appointments for this service with their dealers. A generic copy of the owner letter is attached.

Vehicle Lists, Global Recall System, VIP and Dealer Follow Up

All involved vehicles have been entered into the DealerCONNECT Global Recall System (GRS) and Vehicle Information Plus (VIP) for dealer inquiry as needed.

GRS provides involved dealers with an updated VIN list of their incomplete vehicles. The owner's name, address and phone number are listed if known. Completed vehicles are removed from GRS within several days of repair claim submission.

To use this system, click on the “**Service**” tab and then click on “**Global Recall System.**” Your dealer's VIN list for each recall displayed can be sorted by: those vehicles that were unsold at recall launch, those with a phone number, city, zip code, or VIN sequence.

Dealers must perform this repair on all unsold vehicles before retail delivery. Dealers should also use the VIN list to follow up with all owners to schedule appointments for this repair.

Recall VIN lists may contain confidential, restricted owner name and address information that was obtained from the Department of Motor Vehicles of various states. Use of this information is permitted for this recall only and is strictly prohibited from all other use.

Additional Information

If you have any questions or need assistance in completing this action, please contact your Service and Parts District Manager.

Customer Services / Field Operations
FCA US LLC

This notice applies to your vehicle,

[Model Year and Model]

VIN XXXXXXXXXXXXXXXXXXXX

Y92/NHTSA 21V-879

LOGO

VEHICLE PICTURE

YOUR SCHEDULING OPTIONS

1. RECOMMENDED OPTION

Call your authorized FIAT Studio

2. Call the FCA Recall Assistance

Center at 1-800-853-1403. An agent can confirm part availability and help schedule an appointment

3. Visit recalls.mopar.com, scan the

QR code below, or download the Mopar Owner's Companion App.

QR Code

Get access to recall notifications, locate your FIAT Studio, and more through this website or Mopar Owner's Companion App. You will be asked to provide your Vehicle Identification Number (VIN) to protect and verify your identity. The last eight characters of your VIN are provided above.

DEALERSHIP INSTRUCTIONS

Please reference Safety Recall Y92.

IMPORTANT SAFETY RECALL

Fuel Delivery Module

Dear [Name],

This notice is sent to you in accordance with the National Traffic and Motor Vehicle Safety Act. FCA has decided that a defect, which relates to motor vehicle safety, exists in certain [2019 Model Year (BA) Fiat 124 Spider] vehicles.

It is extremely important to take steps now to repair your vehicle to ensure the safety of you and your passengers.

WHY DOES MY VEHICLE NEED REPAIRS?

The Fuel Delivery Module (FDM) on your vehicle ^[1] may have been built with impellers that could deform. A FDM with a deformed impeller may interfere with other fuel pump components which can inhibit the operation of the fuel pump, potentially causing fuel starvation. **Fuel starvation may result in an unexpected loss of motive power, which increases the risk of a vehicle crash without prior warning.**

HOW DO I RESOLVE THIS IMPORTANT SAFETY ISSUE?

FCA will repair your vehicle ^[2] free of charge (parts and labor). To do this, your FIAT Studio will replace the FDM. The estimated repair time is two hours. In addition, your FIAT Studio will require your vehicle for proper check-in, preparation, and check-out during your visit, which require more time. Your time is important to us, so we recommend that you schedule a service appointment to minimize your inconvenience. Please bring this letter with you to your FIAT Studio.

**TO SCHEDULE YOUR FREE REPAIR,
CALL YOUR FIAT STUDIO TODAY**

CALIFORNIA RESIDENTS

The State of California requires the completion of emission recall repairs prior to vehicle registration renewal. Your FIAT Studio will provide you with a Vehicle Emission Recall Proof of Correction Form after the recall service is performed. Be sure to save this form since the California Department of Motor Vehicles may require that you supply it as proof that the recall has been performed.

In order to ensure your full protection under the emissions warranty provisions, it is recommended that you have your vehicle serviced as soon as possible. Failure to do so could be determined as lack of proper maintenance of your vehicle.

WHAT IF I ALREADY PAID TO HAVE THIS REPAIR COMPLETED?

If you have already experienced this specific condition and have paid to have it repaired, you may visit www.fcarecallreimbursement.com to submit your reimbursement request online. ^[3] Once we receive and verify the required documents, reimbursement will be sent to you within 60 days. If you have had previous repairs performed and/or already received reimbursement, you may still need to have the recall repair performed.

We apologize for any inconvenience, but are sincerely concerned about your safety. Thank you for your attention to this important matter.

Customer Assistance/Field Operations
Fiat Chrysler Automobiles US LLC



Mr. Mrs. Customer
1234 Main Street
Hometown, MI 48371

[1] If you no longer own this vehicle, please help us update our records. Call the FCA Recall Assistance Center at 1-800-853-1403 to update your information.

[2] If your dealer fails or is unable to remedy this defect without charge and within a reasonable time, you may submit a written complaint to the Administrator, National Highway Traffic Safety Administration, 1200 New Jersey Ave., S.E., Washington, DC 20590, or you can call the toll-free Vehicle Safety Hotline at 1-888-327-4236 (TTY 1-800-424-9153), or go to safercar.gov.

[3] You can also mail in your original receipts and proof of payment to the following address for reimbursement consideration: FCA Customer Assistance, P.O. Box 21-8004, Auburn Hills, MI 48321-8007, Attention: Recall Reimbursement.

Note to lessors receiving this recall notice: Federal regulation requires that you forward this recall notice to the lessee within 10 days.