



FIELD KIT

Vac-Tron Equipment, LLC

Trenchless
Okahumpka, FL 34762 USA

FIELD CAMPAIGN KIT # VVK0000009

DATE
:

30 June 2020

For Dealer Reference: Service Bulletin # SVV2020-011

Light Relocation, Reflector and Conspicuity Tape Installation Kit

CAMPAIGN TYPE:	Mandatory-Product Safety
CAMPAIGN CATEGORY:	Kit and Bulletin

MACHINE / ATTACHMENT MODEL (S) :	Serial Numbers		Kit Version
	Included	Excluded	
CSGT	See attached listing on page 17 of this Kit Instructions for specific VIN and Serial/Unit numbers.	N/A	VVK01
CV1273SGT			
CVGT			
CVSGT			
LP1273XDT			



PURPOSE: INADEQUATE LIGHTING, REFLECTORS AND CONSPICUTITY TAPE

The lighting, side and rear reflectors and conspicuity tape do not meet US or Canada Federal Motor Vehicle Safety Standard (FMVSS/CMVSS) governmental regulation 108 for the United States, Canada and Mexico. When towing or parking the vacuum excavator on public roadways, a crash may occur resulting in death **or serious injury** resulting from a driver(s) of other vehicle(s) not seeing the vacuum excavator at night or during limited sunlight and strike the vacuum excavator. To reduce the potential of

this occurring, vehicle lights will be relocated, additional reflectors and conspicuity tape are being added. Property or equipment damage may also occur.



WARNING: Failure to use shutdown procedure can result in unexpected hazard(s). Death or serious injury could result due to entanglement, crushing, cutting, or other hazardous contact. Follow Shutdown Procedure after operating, before performing any service or maintenance, and before transporting.

Shutdown Procedure

STOPPING THE MACHINE

For your safety and the safety of others, follow shutdown procedure before working on the machine for any reason, including servicing, maintaining, cleaning, inspecting, unclogging or transporting machine, or as otherwise directed in Operator's manual.

Step 1: Make sure end of vacuum hose is clear of all spoils, debris, and other materials.

Step 2: Push *Throttle Control* left several times to slow engine. Idle engine five minutes to allow vacuum pump (with *Reverse Flow Lever* – Neutral) to cool down. This helps to prevent the buildup of condensation.

Step 3: Turn *Key Switch* OFF to shut down engine.

Step 4: Drain *Filter Housing*.



WARNING: Do not point high pressure water tool in the direction of people when relieving the pressure.

PROCEDURE 1:

1. Align the bracket with the edge of the curb side I-beam as shown below. Ref. 1, Fig 1.

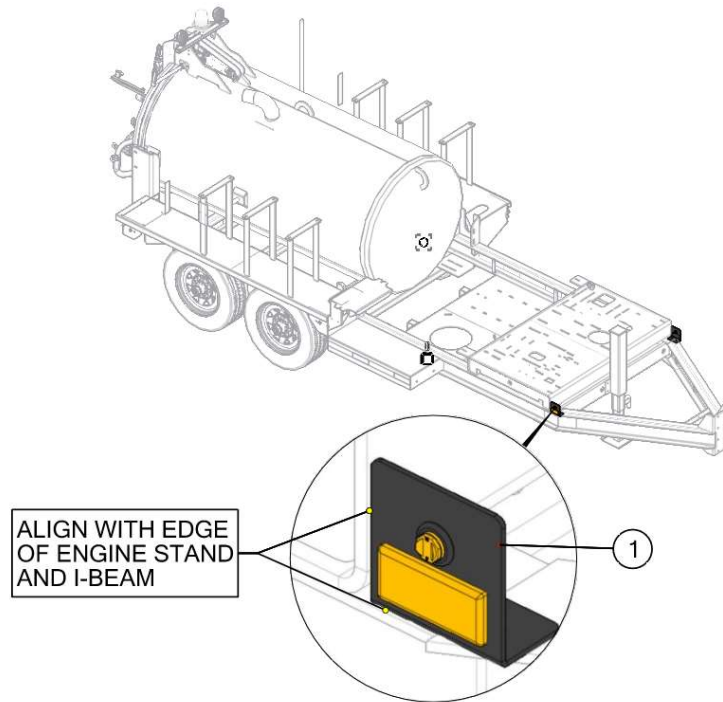

2. Mark the light bracket hole locations onto the I-beam and drill (2) $\text{Ø}9/32''$ (7.15 mm) holes through the I-beam.

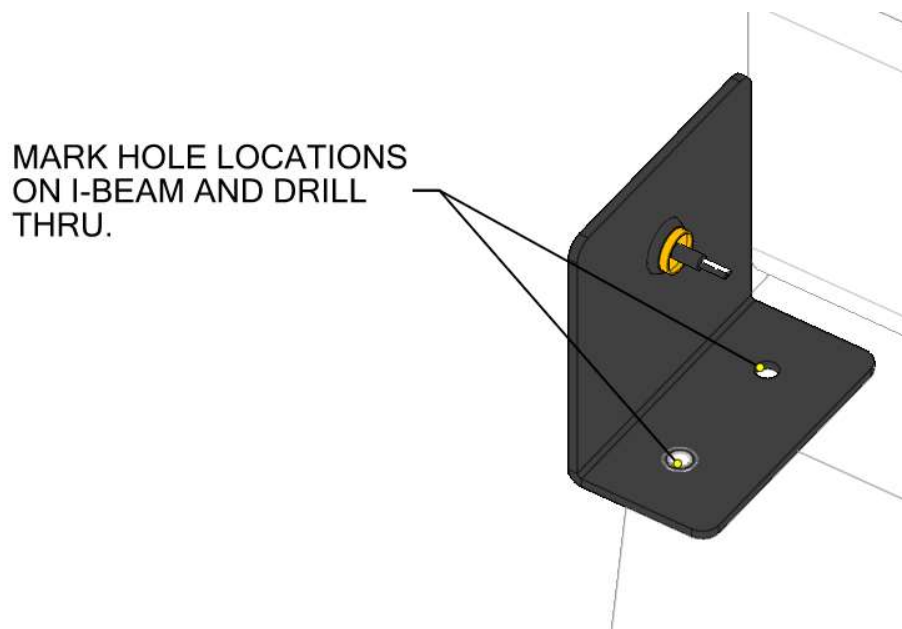

3. Attach the marker light bracket with the supplied hardware. Ref. 1, 2, 3, and 4, Fig. 1.

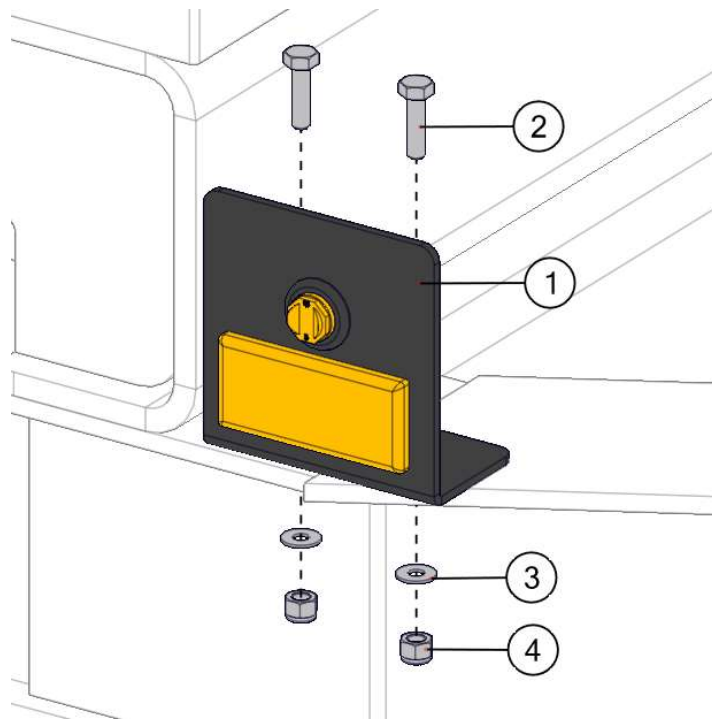

4. Connect one end of the 100" (2.54 m) length of dual core wire to the front side marker lamp using the butt connectors. Ref. 5 and 6, Fig. 1.

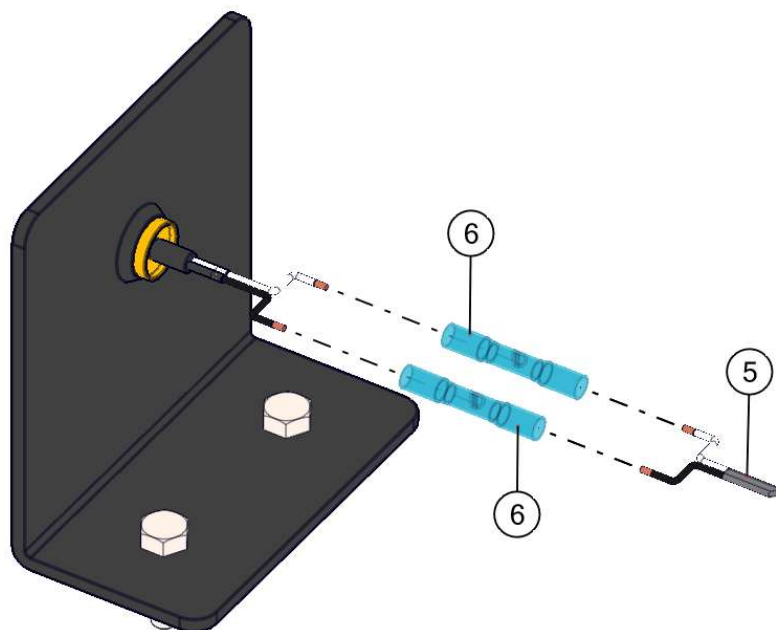

5. Place loom over wires for protection. Ref. 8, Fig. 1.
6. Run the wire through the cross member and inside of the I-Beam to connect with the front clearance marker lamp. Reference step 3, Procedure 2 for connecting the front side marker lamp and front clearance marker lamp.

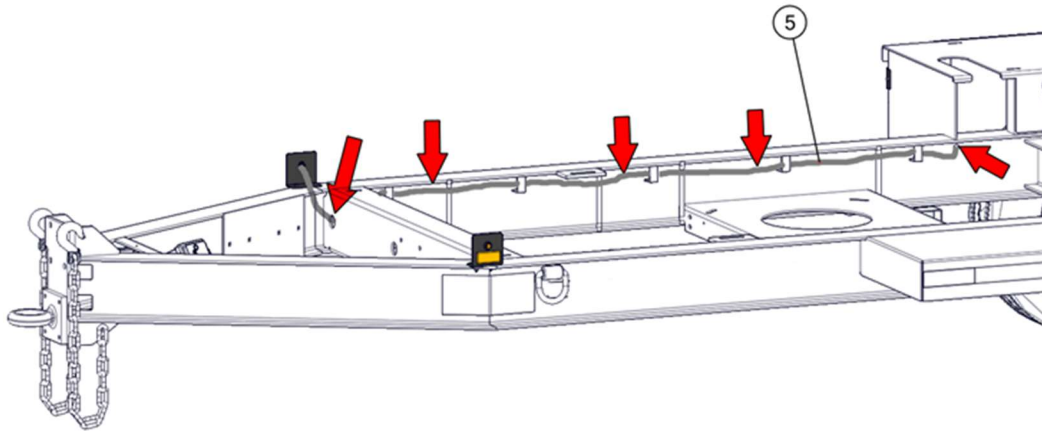

7. Use supplied zip ties to fasten wire harness to trailer frame.
8. Complete all steps for the street side of the trailer.

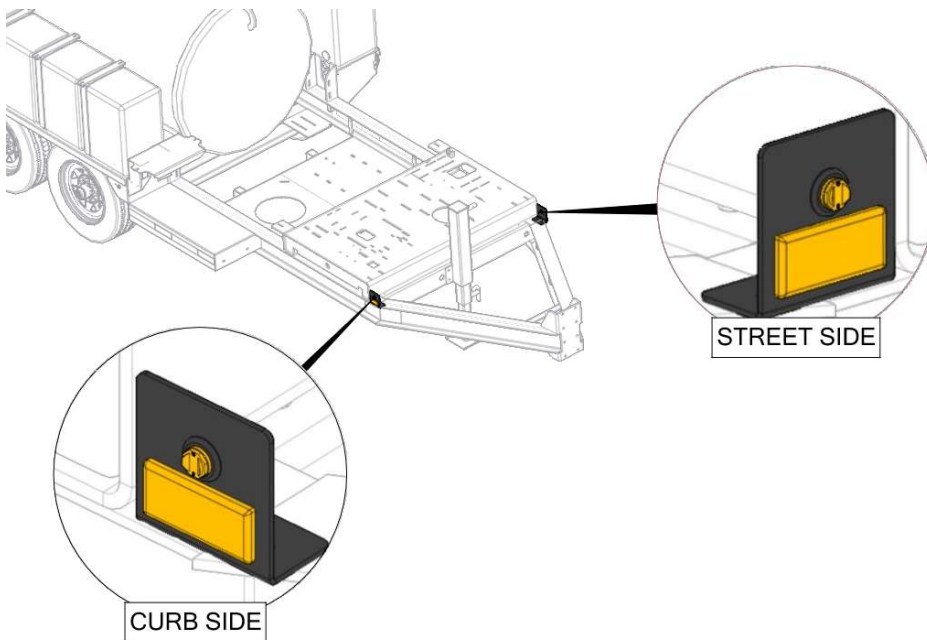

PROCEDURE 2:

1. Remove the curb side marker light from the platform gusset and disconnect the wires. Retain the marker light for future installation.

Figure A

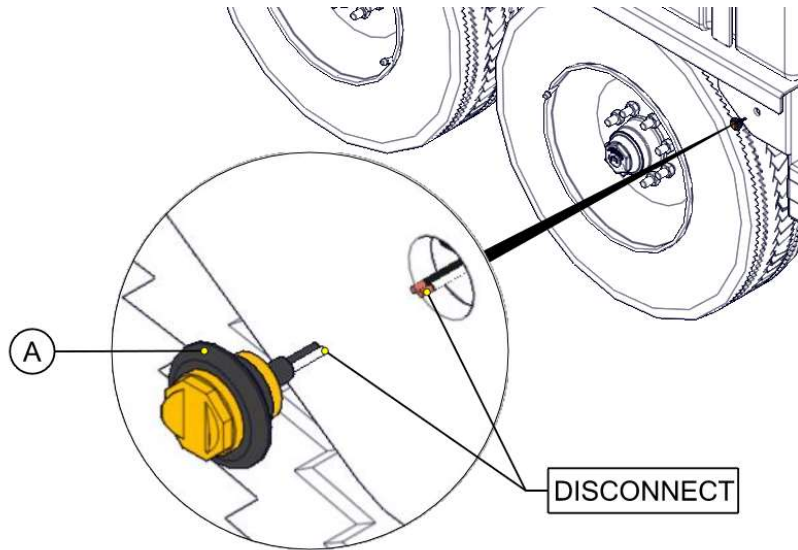

2. Place the front clearance marker bracket on the gusset approximately 1-1/2" (3.81 cm) from the bottom as shown in Figure C. If the location of the antifreeze tank stand interferes with positioning the bracket properly, position the marker bracket just below the antifreeze tank stand as shown in Figure D. Mark the bolt locations on the gusset and drill (2) Ø9/32" (Ø7.15 mm) holes. (Curb side shown). Ref. 1

Figure C

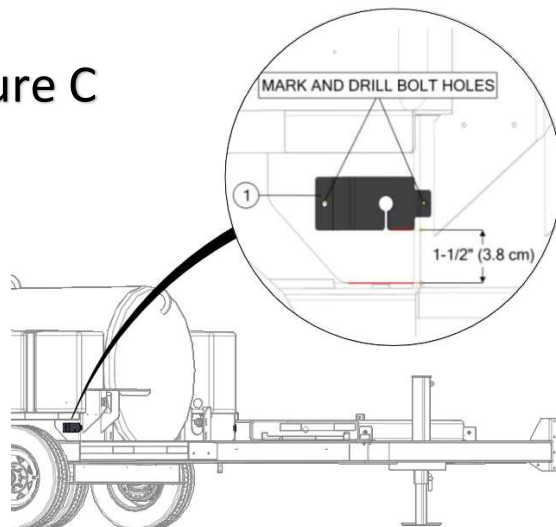
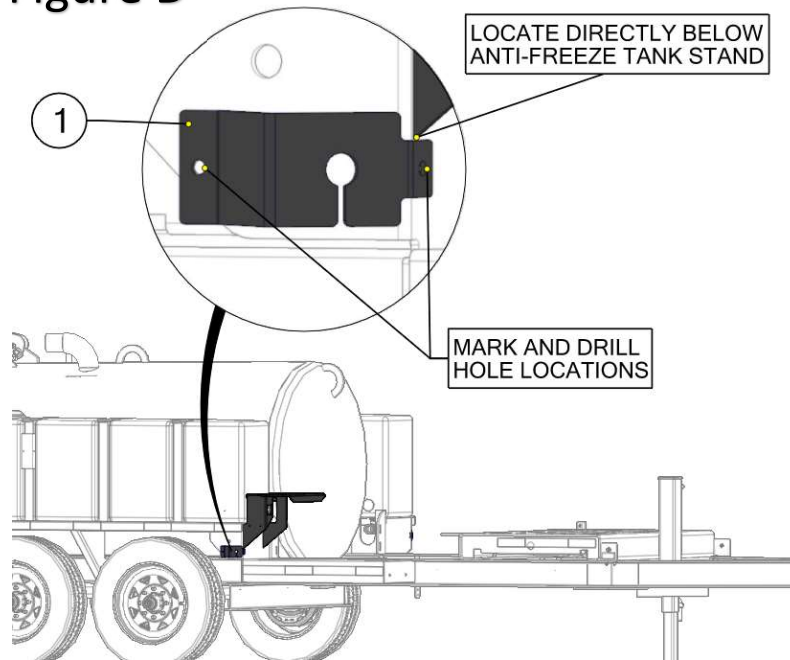
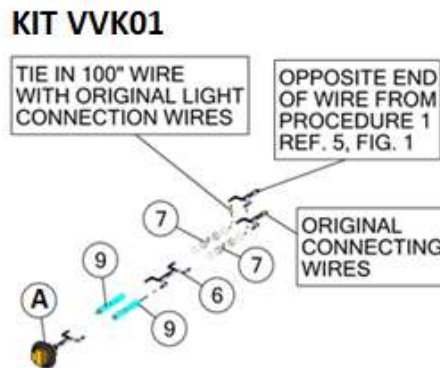

Figure D



3. Use the 1 ft (30.48 cm) length of dual core conductor wire to reconnect the front clearance marker lamp and tie in with the 100" (2.54 m) length wire from the front side marker lamp. Use the 12-10 (yellow) and 16-14 (blue) heat seal butt connectors to connect all wires according to diagram below.



4. Insert the front clearance marker lamp into the front clearance marker bracket as shown. Ref A, Fig. 2 for VVK01. Ref 2, Fig 2 for VVK02. Refer to the illustration below for proper lamp orientation.
5. Attach the front clearance marker bracket with the hardware Ref. 3, 4, and 5 Fig. 2.
6. Loom all exposed wires. Ref. 8 Fig. 2.

7. Repeat all steps to connect the front clearance marker lamp on the street side of the trailer.

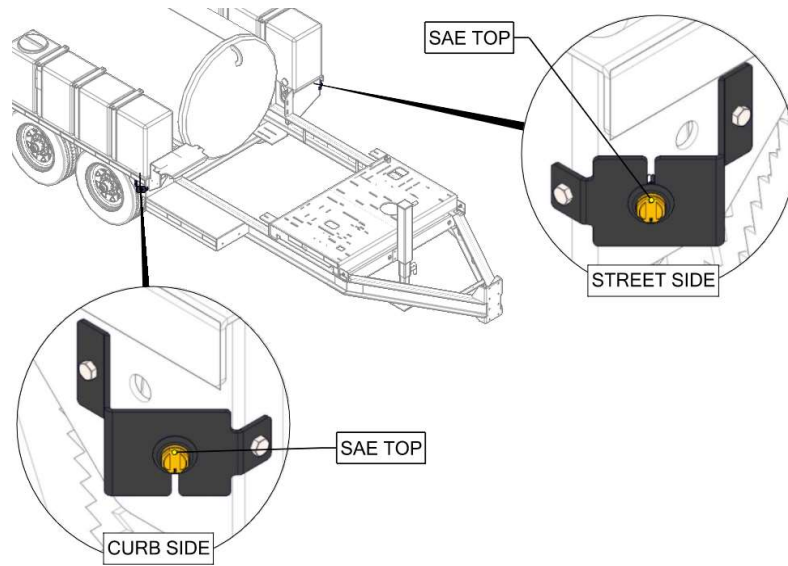

PROCEDURE 3:

1. Clean area where the conspicuity tape will be installed with light soap and water. Areas with damaged paint or heavy corrosion should be prepped, painted, and thoroughly dry before applying conspicuity tape.
2. Refer to the illustration and install the conspicuity tape in the locations shown. Ref. 1 and 2, Fig. 3.
3. Repeat for the opposite side of the trailer.

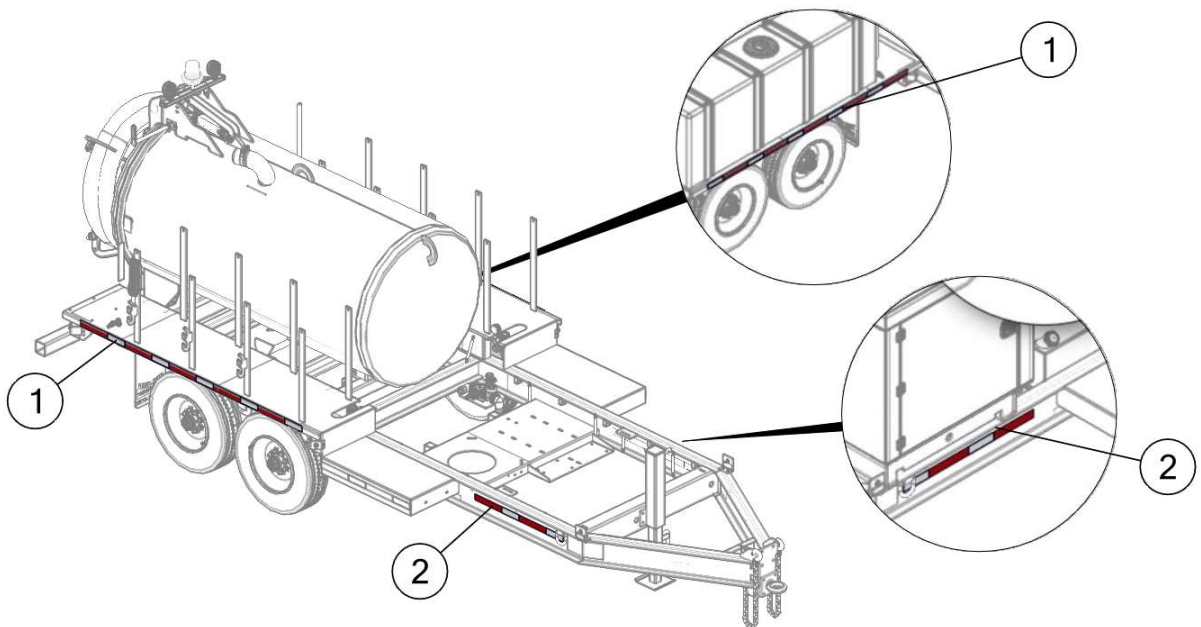

PROCEDURE 4:

1. Remove the existing rear corner/side clearance marker lamp from the gusset and disconnect the wires. Retain the light for future installation.

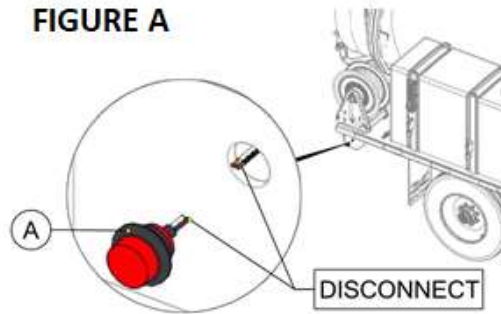

2. Place the rear corner/side clearance marker bracket on the support approximately 1-1/2" (3.81 cm) from the bottom as indicated in the illustration below. Mark the bolt locations on the support and drill (2) Ø9/32" (Ø7.15 mm) holes.
3. Use the 1 ft (30.48 cm) length of dual core conductor wire to reconnect the rear corner/side clearance marker lamp using 16-14 butt connectors. Ref A, 7 and 8, Fig 4 for VVK01.

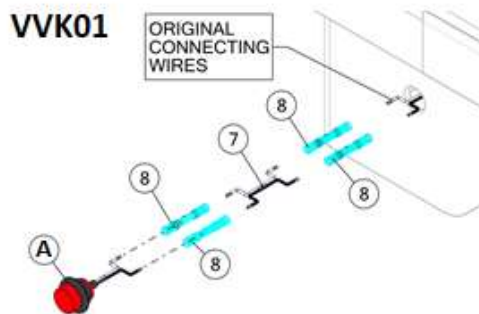

4. Attach the rear corner/side clearance marker bracket to the fender support with the hardware as shown Ref. 3, 4, and 5 Fig. 4.
5. Loom all exposed wires. Ref. 9 Fig. 4.
6. Insert the rear corner/side clearance marker lamp into the bracket as shown Ref 1 and A, Fig. 4.
7. Clean area where the rear side marker reflectors will be installed with light soap and water. Areas with damaged paint or heavy corrosion should be prepped, painted, and thoroughly dry before applying the reflectors as shown.

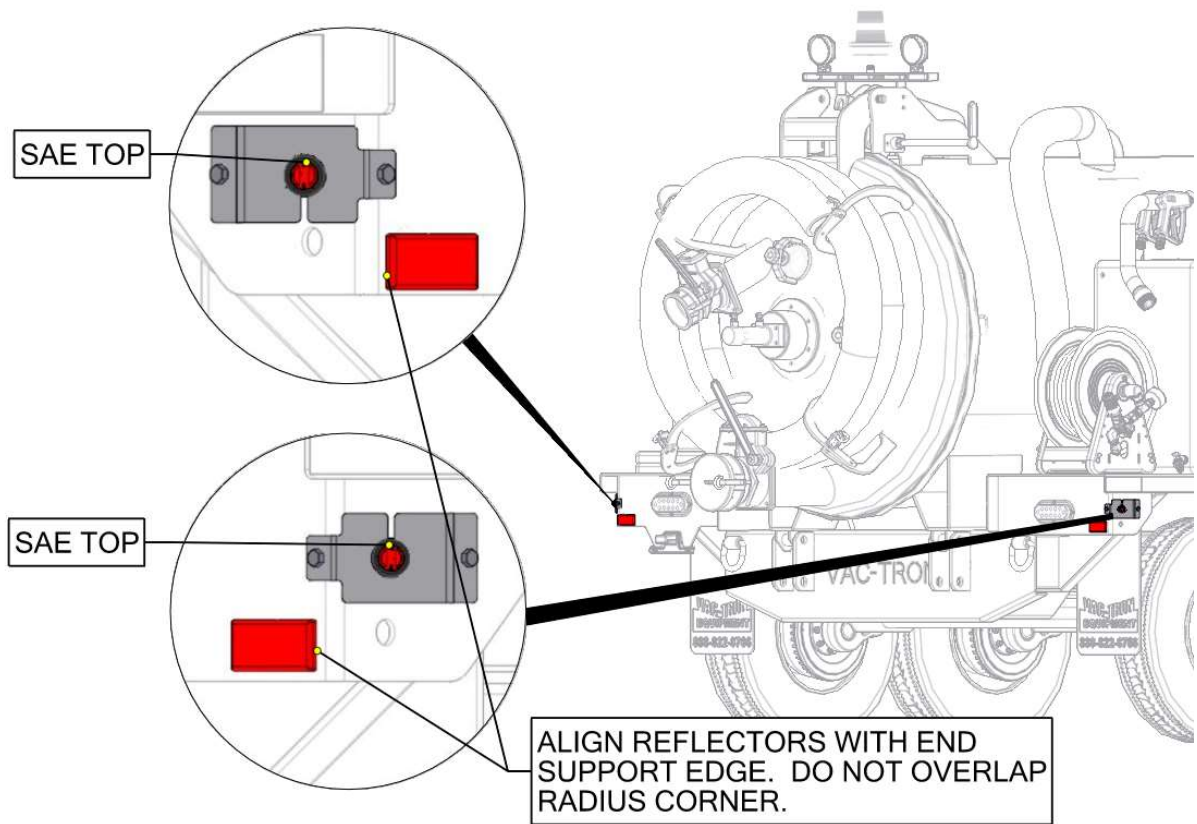

8. Install the rear side marker reflector below the side marker bracket as shown.
9. Repeat all steps for the opposite side of the trailer.

PROCEDURE 5:

1. Clean area where the conspicuity tape will be installed with light soap and water. Areas with damaged paint or heavy corrosion should be prepped, painted, and thoroughly dry before applying the conspicuity tape.
2. Refer to the illustration and install each of the white conspicuity tape on the debris tank door and water tanks as shown Ref 1, Fig. 5.

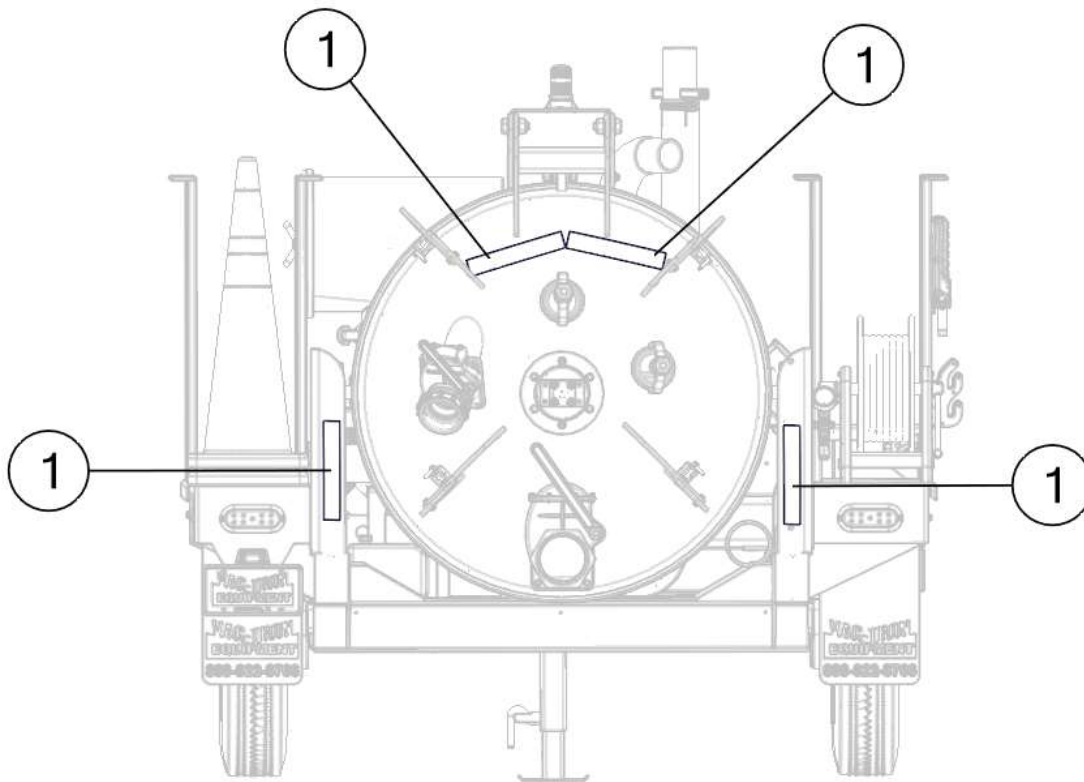

PROCEDURE 6:

WN 286 RAISED LOAD CAN FALL



WARNING: Raised load can shift or fall. Death or serious injury could be possible if struck or crushed by falling load. Never allow anyone under a raised load unless load is securely supported to prevent it from shifting or falling.

1. Ensure the debris tank is empty. Using suitable blocking, block debris tank to prevent shifting. Debris tank weighs approximately 1,000 lb (455 kg).
2. Remove the cotter pin on both sides.



3. Push the headed pins out to be flush with the inner side of the tank hinges. Be careful not to push the pin through the hinge.

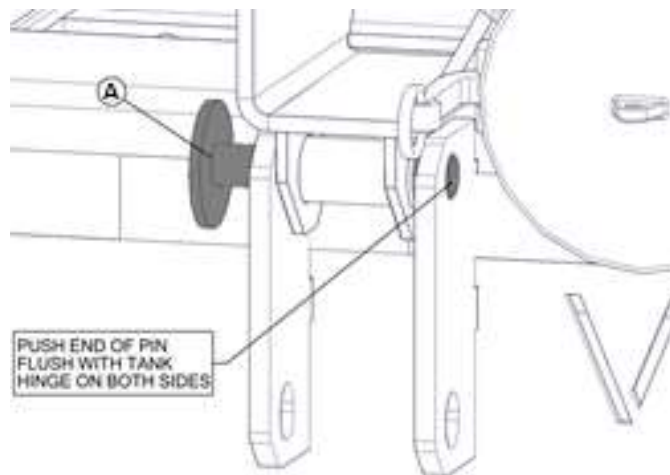

4. Push the headed pins out to be flush with the inner side of the tank hinges. Be careful not to push the pin through the hinge.
5. Use a suitable lifting device when installing the bumper. Bumper weight is approximately 120 lb (55 kg).

6. Inspect the tank hinges connected to the bumper. Hinges with the single hole configuration shown must be replaced. If the hinges have a 2-hole configuration, skip to step 9.

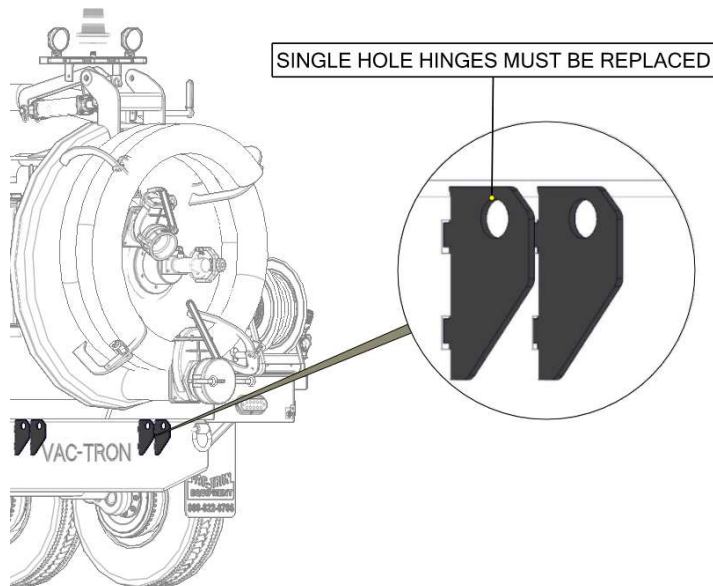

7. Use a cutting torch to remove the (4) tank hinges from the bumper. Grind away residual slag.

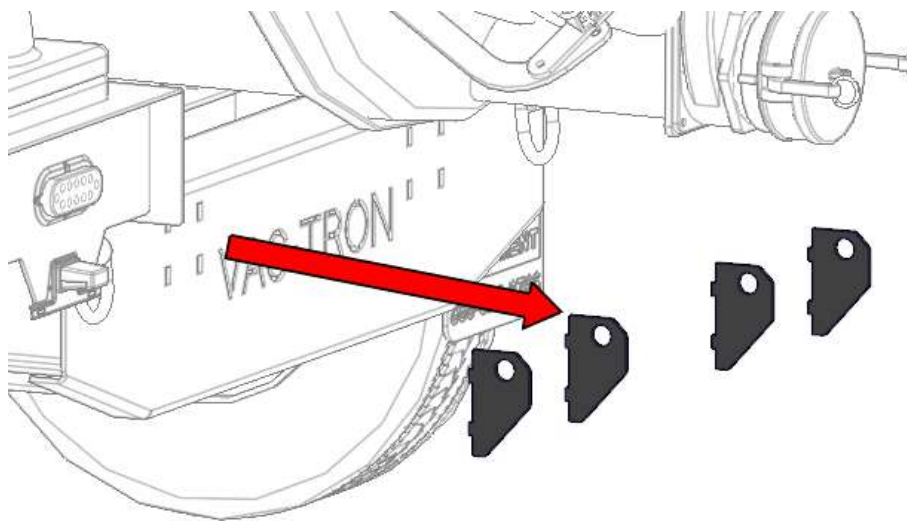

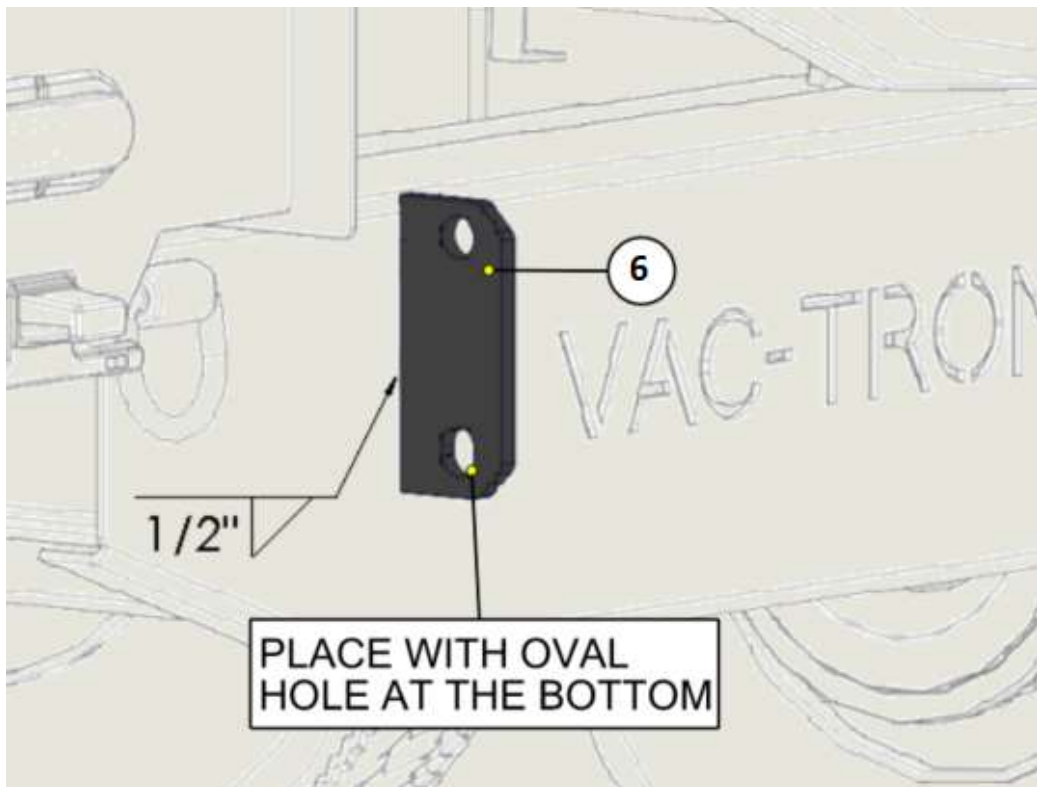
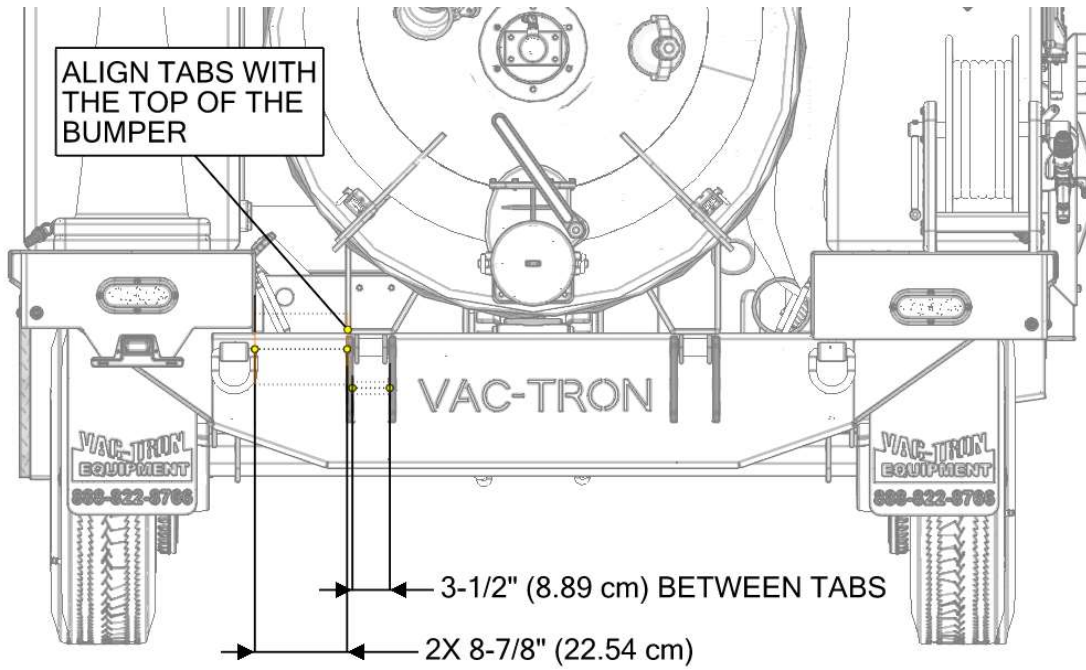

8. Remove all damaged paint down to bare metal. Repaint all affected areas.
9. Install the bumper and align the bolt holes with the tank hinges.

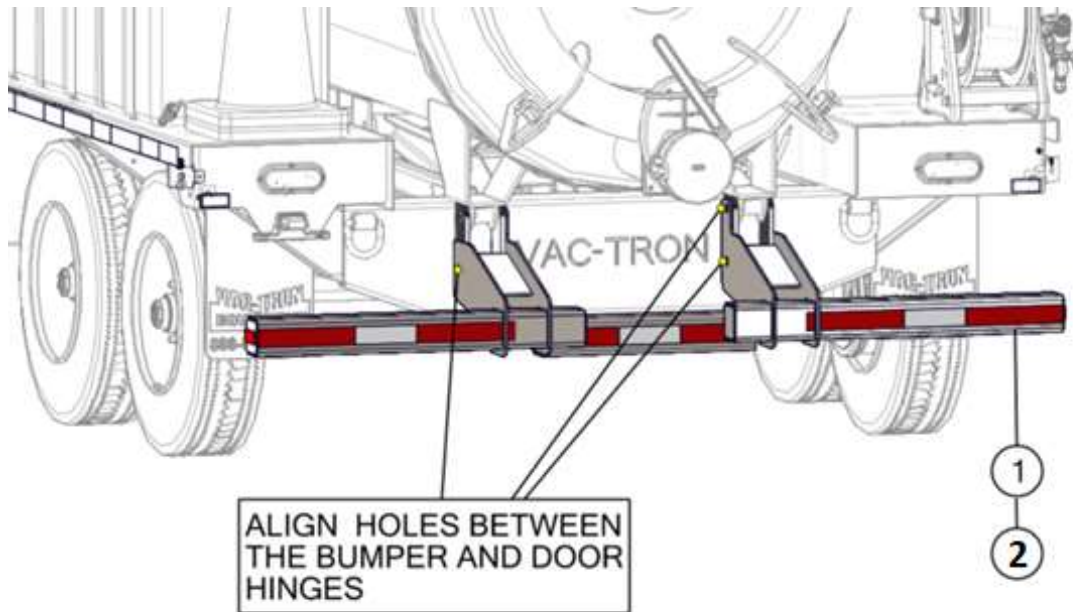

10. Push the headed pins back into position and replace the cotter pins on both sides.
11. Install the hardware Ref. 3, 4, and 5 Figure 6. Tighten the bolts to 644 ft-lb (873 Nm).

AFFECTED MACHINES - VVK01-0009

MODEL	VIN	SERIAL/UNIT	MODEL	VIN	SERIAL/UNIT
CSGT	5HQB192W5LK002039	191830	CVGT	5HQB192X5LK002099	200111
CSGT	5HQB192W0LK002045	200131	CVGT	5HQB192X4LK002126	200291
CSGT	5HQB192W7LK002060	200269	CVSGT	5HQB192Y1LK002064	191708
CV1273SGT	5HQB192W4LK002052	181524	CVSGT	5HQB192Y2LK002073	191769
CVGT	5HQB192X0KK002008	191289	CVSGT	5HQB192Y9LK002085	191831
CVGT	5HQB192X9KK002055	191643	CVSGT	5HQB192Y3LK002101	200029
CVGT	5HQB192X0KK002056	191644	CVSGT	5HQB192Y6LK002125	200155
CVGT	5HQB192X2KK002057	191645	CVSGT	5HQB192Y6LK002139	200230
CVGT	5HQB192XXLK002096	200070	CVSGT	5HQB192Y7LK002148	200297
CVGT	5HQB192X1LK002097	200072	LP1273XDT	5HQB192W2121KLCK8100	191178
CVGT	5HQB192X3LK002098	200110			

Figure 1

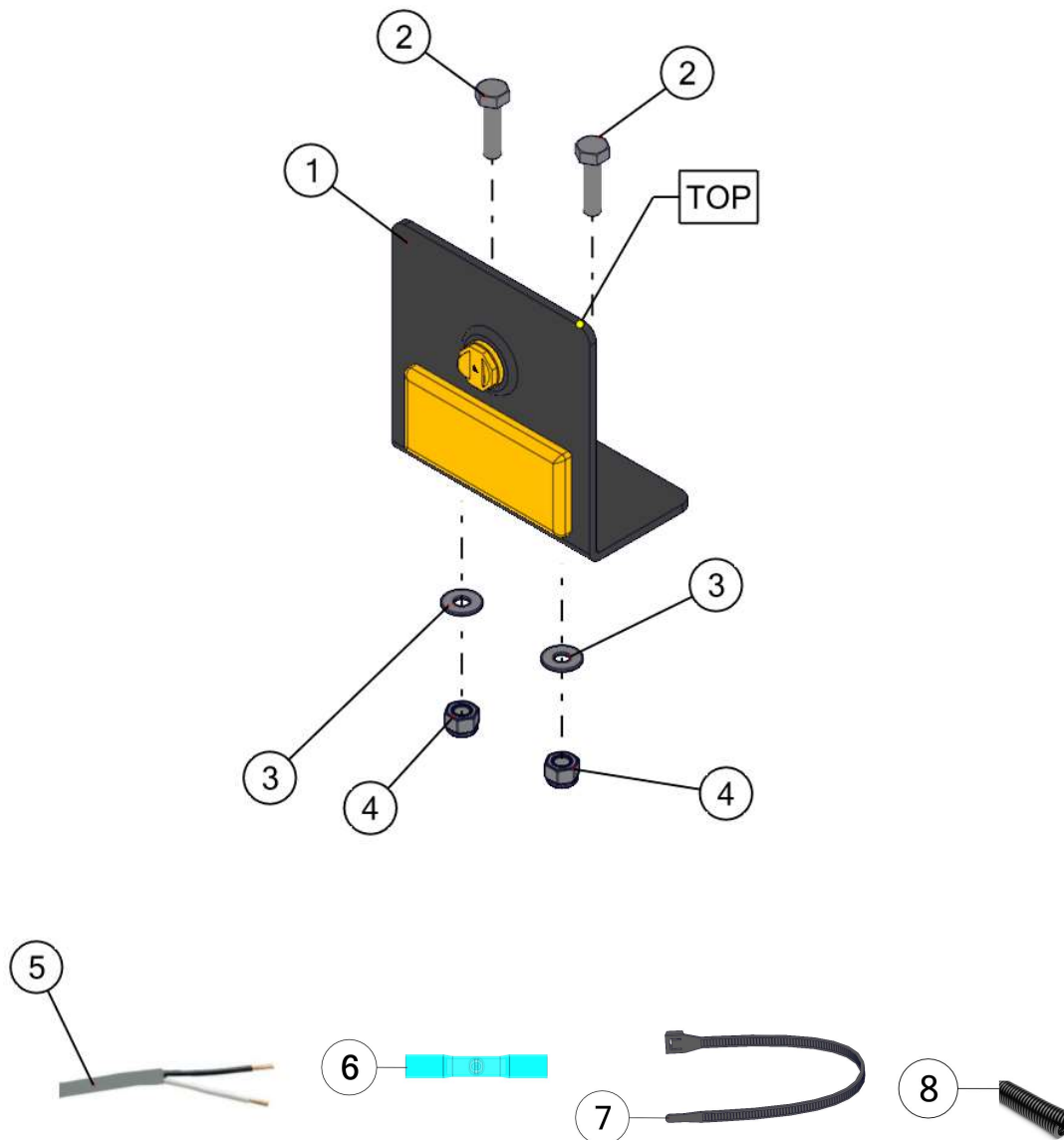

FIGURE 1 Parts List

REF. NO.	PART NO.	DESCRIPTION	VVK01 QTY.
1	B134-5749	FRONT SIDE MARKER LAMP BRACKET WITH REFLECTOR	2
2	P-1473	1/4-20 X 1 HEX HEAD BOLT	4
3	P-1472	1/4 ID FLAT WASHER	4
4	P-2782	1/4-20 NYLON LOCKNUT	4
5	P-1054	100" (2.54 m) LENGTH DUAL CORE CONDUCTOR WIRE	2
6	P-2369	16-14 HEAT SEAL BUTT CONNECTOR BLUE	4

7	P-1301	ZIP TIE	15
8	P-2762	1/2" SPLIT WIRE LOOM, 100" (2.54 m) LENGTH	2

Figure 2

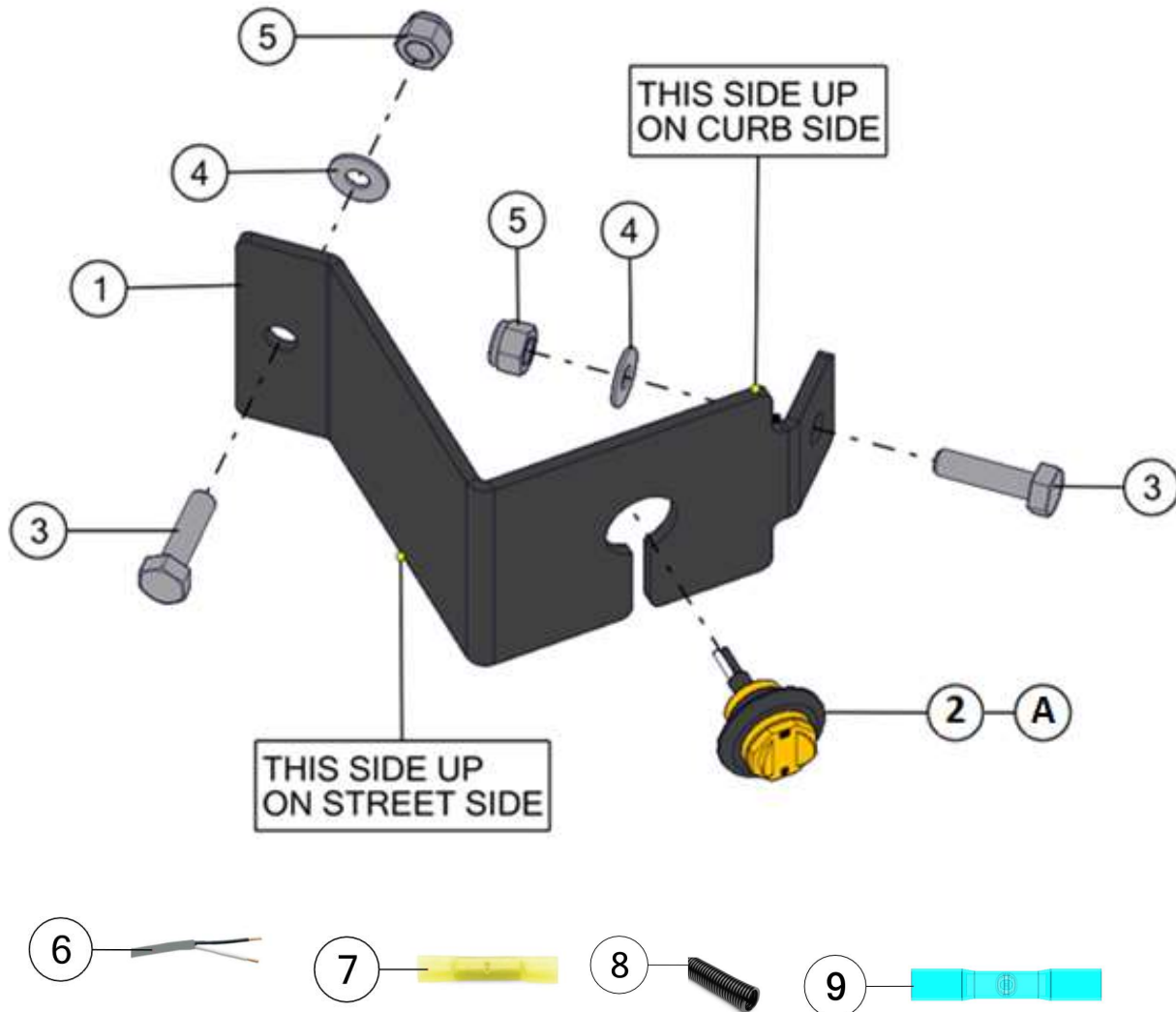

FIGURE 2 Parts List			
REF. NO.	PART NO.	DESCRIPTION	VVK01 QTY.
1	B134-5748	FRONT CLEARANCE MARKER LAMP BRACKET	2
A	P-4190	FRONT CLEARANCE MARKER LAMP (EXISTING ON TRAILER)	2
3	P-1473	1/4-20 X 1 HEX HEAD BOLT	4
4	P-1472	1/4 ID FLAT WASHER	4
5	P-2782	1/4-20 NYLON LOCKNUT	4
6	P-1054	1' (30.48 cm) LENGTH DUAL CORE CONDUCTOR WIRE	2
7	P-1611	12-10 HEAT SEAL BUTT CONNECTOR	4
8	P-2762	1/2" SPLIT WIRE LOOM, 1' (30.48 cm) LENGTH	2

9	P-2369	16-14 HEAT SEAL BUTT CONNECTOR BLUE	4
---	--------	-------------------------------------	---

Figure 3

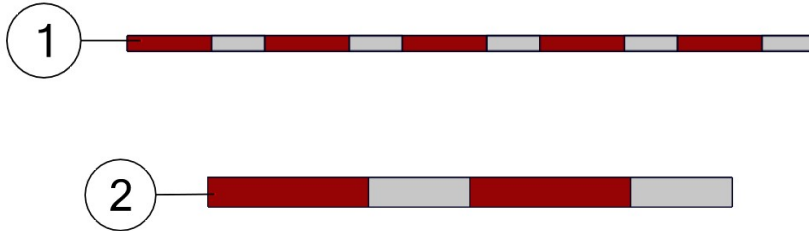

FIGURE 3 Parts List			
REF. NO.	PART NO.	DESCRIPTION	VVK01 QTY.
1	P-1426	2" (2.5 cm) WIDE, 101" (256.5 cm) LONG CONSPICUITY TAPE	2
2	P-1426	2" (2.54 cm) WIDE, 25" (63.5 cm) LONG CONSPICUITY TAPE	2

Figure 4

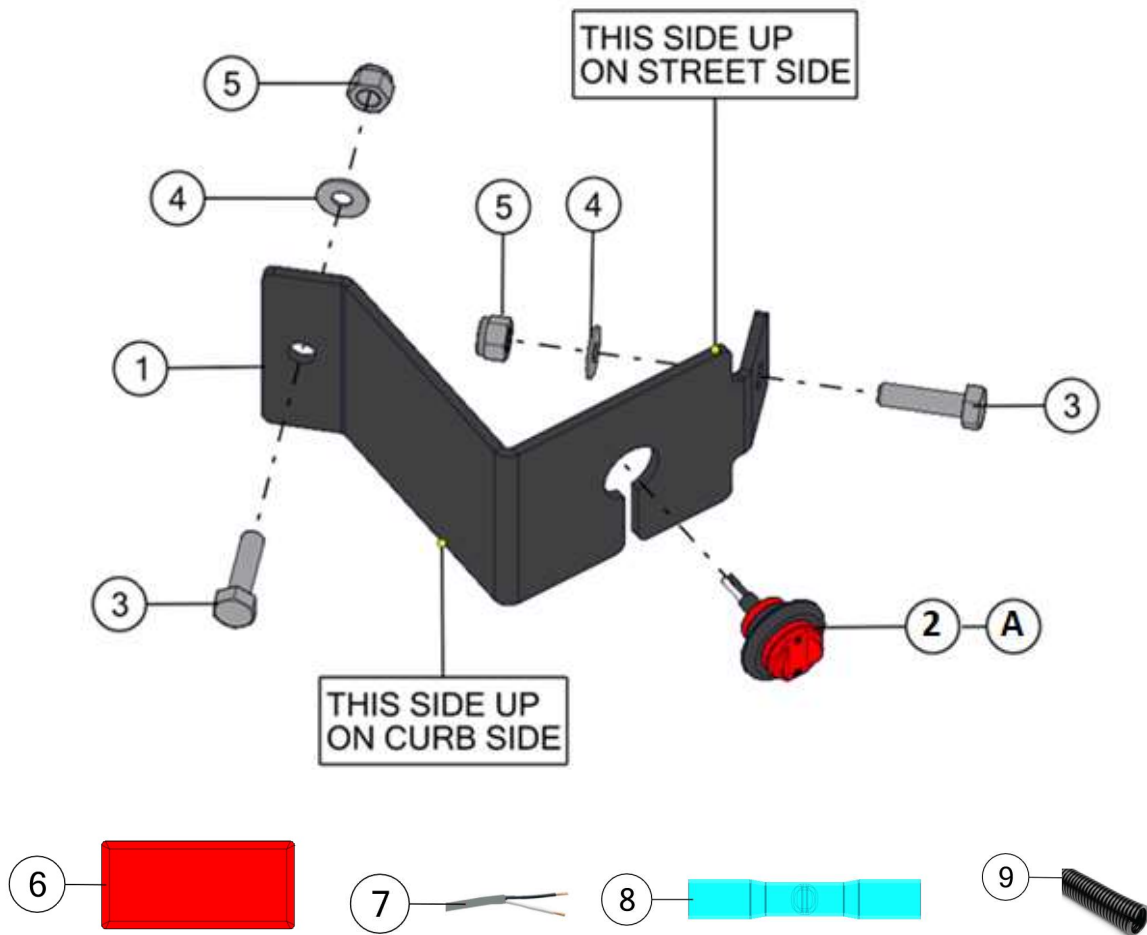

FIGURE 4 Parts List			
REF. NO.	PART NO.	DESCRIPTION	VVK01 QTY.
1	B134-5748	REAR CORNER/SIDE CLEARANCE MARKER LAMP BRACKET	2
A	P-4189	REAR CORNER/SIDE CLEARANCE MARKER LAMP (EXISTING ON TRAILER)	2
2	P-4189	REAR CORNER/SIDE CLEARANCE MARKER LAMP	0
3	P-1473	1/4-20 X 1 HEX HEAD BOLT	4
4	P-1472	1/4 ID FLAT WASHER	4
5	P-2782	1/4-20 NYLON LOCKNUT	4
6	P-5730	REAR SIDE MARKER REFLECTOR	4
7	P-1054	1' (30.48 cm) LENGTH DUAL CORE CONDUCTOR WIRE	2
8	P-2369	16-14 HEAT SEAL BUTT CONNECTOR BLUE	8
9	P-2762	1/2" SPLIT WIRE LOOM, 1' (30.48 cm) LENGTH	2

Figure 5



FIGURE 5 Parts List			
REF. NO.	PART NO.	DESCRIPTION	VVK01 QTY.
1	P-5783	WHITE CONSPICUITY TAPE	4

Figure 6

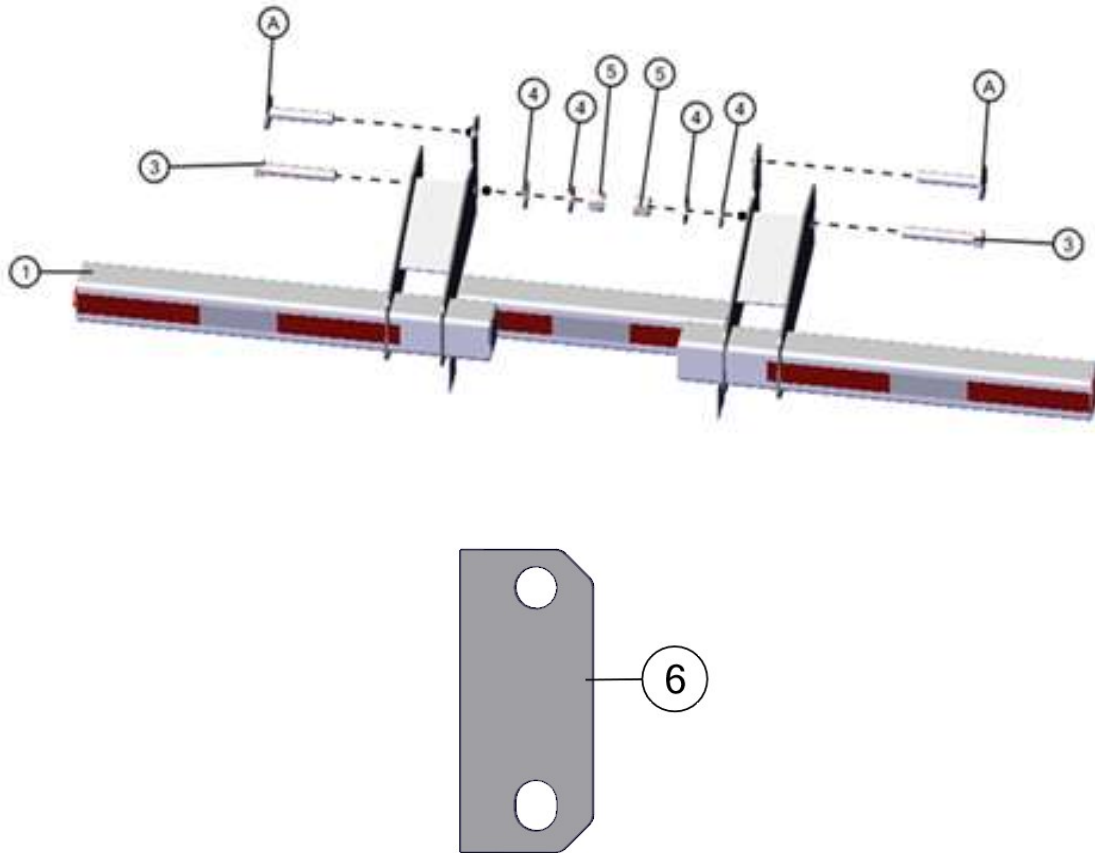

FIGURE 8 Parts List			
REF. NO.	PART NO.	DESCRIPTION	VVK01 QTY.
1	135500258	REAR EXTENSION	1
A	SA-4471	HEADED PIN (EXISTING ON TRAILER)	2
3	135500218	1-8 X 6-1/2 HEX BOLT	2
4	P-3827	1 ID FLAT WASHER	4
5	P-2626	1-8 PREVAILING TORQUE NUT	2
6	135500216	TANK HINGE BRACKET	4