



FIELD KIT

Vac-Tron Equipment, LLC

Trenchless
Okahumpka, FL 34762 USA

FIELD CAMPAIGN KIT # VVK00-0005

DATE
:

DRAFT

For Dealer Reference: Service Bulletin # SVV2020007

Light Relocation, Reflector and Conspicuity Tape Installation Kit

CAMPAIGN TYPE:

Mandatory-Product Safety

CAMPAIGN CATEGORY:

Kit and Bulletin

MACHINE / ATTACHMENT MODEL (S):	Serial Numbers		Kit Version
	Included	Excluded	
MC533SDT	See attached listing on page 15 of this kit instructions for specific VIN and Serial/Unit numbers	N/A	VVK01
MC535SDT			
MC555SDT			
MC573SDT			
MINICOMBO			



PRODUCT SAFETY ALERT

PURPOSE: INADEQUATE LIGHTING, REFLECTORS AND CONSPICUTITY TAPE

The lighting, side and rear reflectors and conspicuity tape do not meet US or Canada Federal Motor Vehicle Safety Standard (FMVSS/CMVSS) governmental regulation 108 for the United States, Canada and Mexico. When towing or parking the vacuum excavator on public roadways, a crash may occur resulting in **death or serious injury** resulting from a driver(s) of other vehicle(s) not seeing the vacuum excavator at night or during limited sunlight and strike the vacuum excavator. To reduce the potential of

this occurring, vehicle lights will be relocated, additional reflectors and conspicuity tape are being added. Property or equipment damage may also occur.

VVK00-0005 has been created to provide the necessary parts and instructions to relocate vehicle lights, add reflectors and conspicuity tape to the sides and rear of the vacuum excavator.



WARNING: Failure to use shutdown procedure can result in unexpected hazard(s). Death or serious injury could result due to entanglement, crushing, cutting, or other hazardous contact. Follow Shutdown Procedure after operating, before performing any service or maintenance, and before transporting.

Shutdown Procedure

STOPPING THE MACHINE

For your safety and the safety of others, follow shutdown procedure before working on the machine for any reason, including servicing, maintaining, cleaning, inspecting, unclogging or transporting machine, or as otherwise directed in Operator's manual.

Step 1: Make sure end of vacuum hose is clear of all spoils, debris, and other materials.

Step 2: Turn *Water Pump Switch* to OFF.

Step 3: Push *Throttle Switch* to SLOW. Idle engine five minutes to allow vacuum pump to cool down. This helps to prevent the buildup of condensation.

Step 4: Turn *Keyswitch* to OFF to shut off engine. Remove the key.

Step 5: Pull trigger on any high-pressure water tool to relieve line pressure.

Step 6: Disassemble all water line connections, vacuum hoses, and tools. Stow properly on machine.

Step 7: Drain CVS Filter Housing / Cyclone.



WARNING: Do not point high pressure water tool in the direction of people when relieving the pressure.

PROCEDURE 1:

1. Align the bracket with the edge of the curb side I-beam as shown below. Ref. 1, Fig 1.

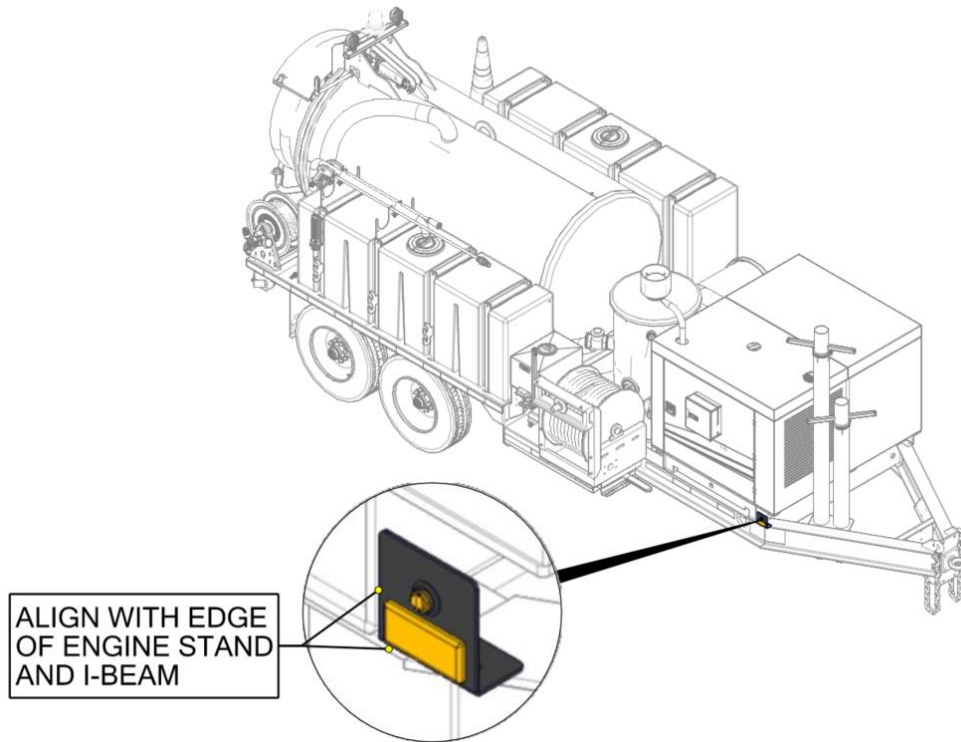

2. Mark the light bracket hole locations onto the I-beam and drill (2) $\text{Ø}9/32''$ (7.15 mm) holes through the I-beam.

MARK HOLE LOCATIONS
ON I-BEAM AND DRILL
THRU.

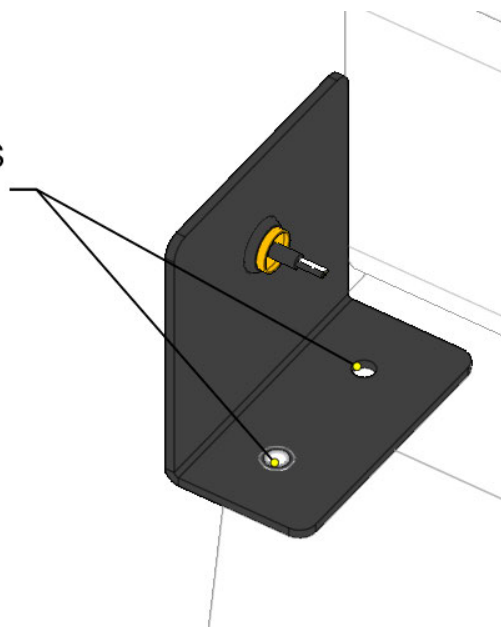

3. Attach the marker light bracket with the supplied hardware. Ref. 1, 2, 3, and 4, Fig. 1.

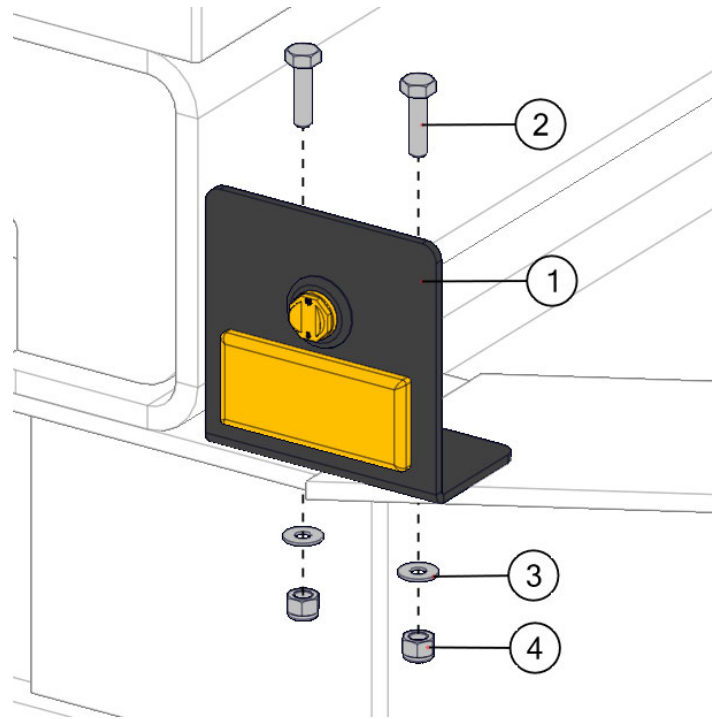

4. Connect one end of the 100" (254 cm) length of dual core wire to the front side marker lamp using the butt connectors. Ref. 5 and 6, Fig. 1.

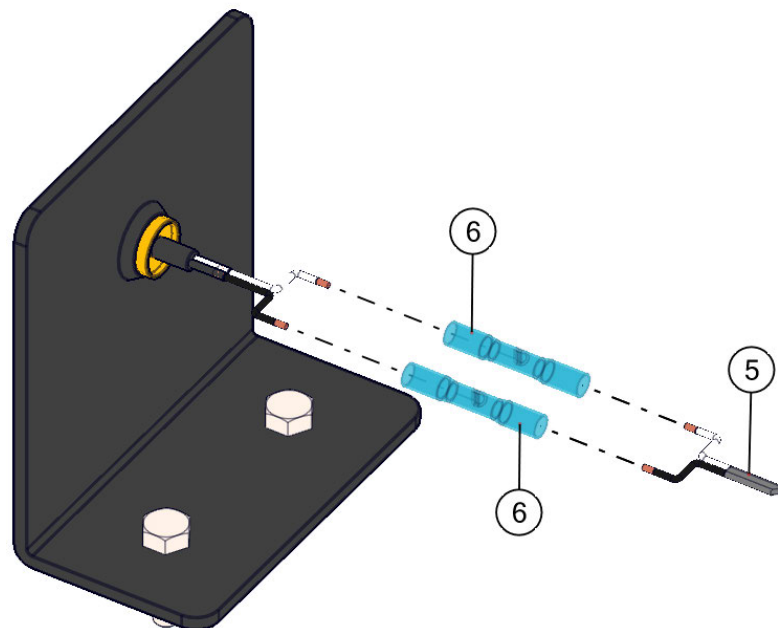

5. Place loom over wires for protection. Ref. 8, Fig. 1.
6. Run the wire through the cross member and inside of the I-Beam to connect with the front clearance marker lamp. Reference step 3, Procedure 2 for connecting the front side marker lamp and front clearance marker lamp.

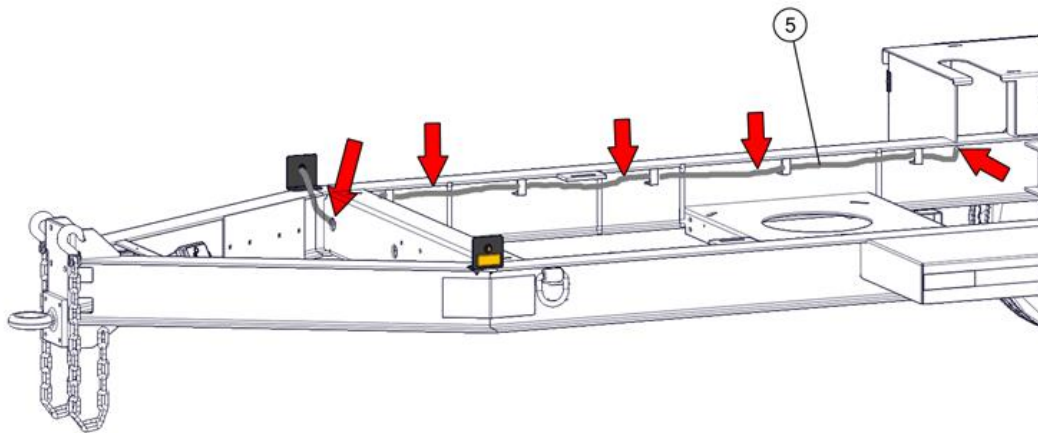

7. Use supplied zip ties to fasten wire harness to trailer frame.
8. Complete all steps for the street side of the trailer.

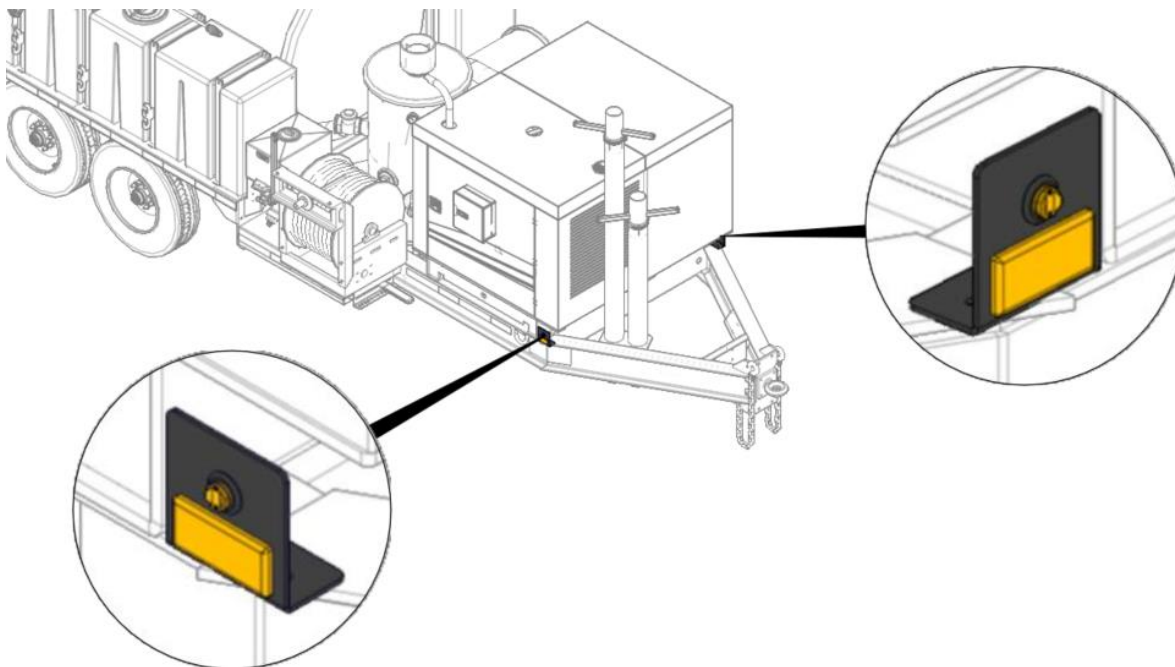

PROCEDURE 2:

1. Remove the existing street side marker lamp from the gusset and disconnect the wires.

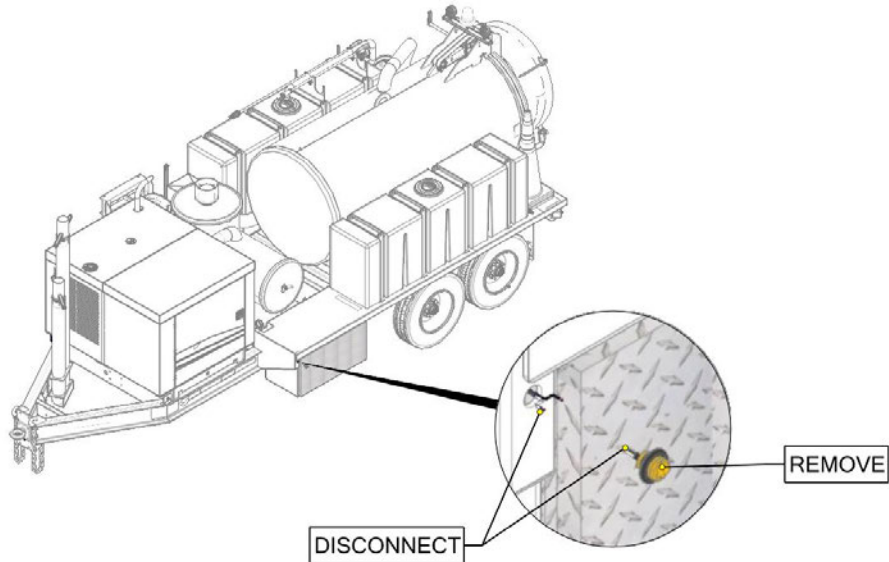

2. Place the side marker light bracket on the gusset approximately 1" (2.54 cm) from the bottom as shown. Mark the bolt locations on the gusset and drill (2) $\text{Ø}9/32"$ ($\text{Ø}7.15 \text{ mm}$) holes. (Street side shown). Ref. 1, Fig. 2.

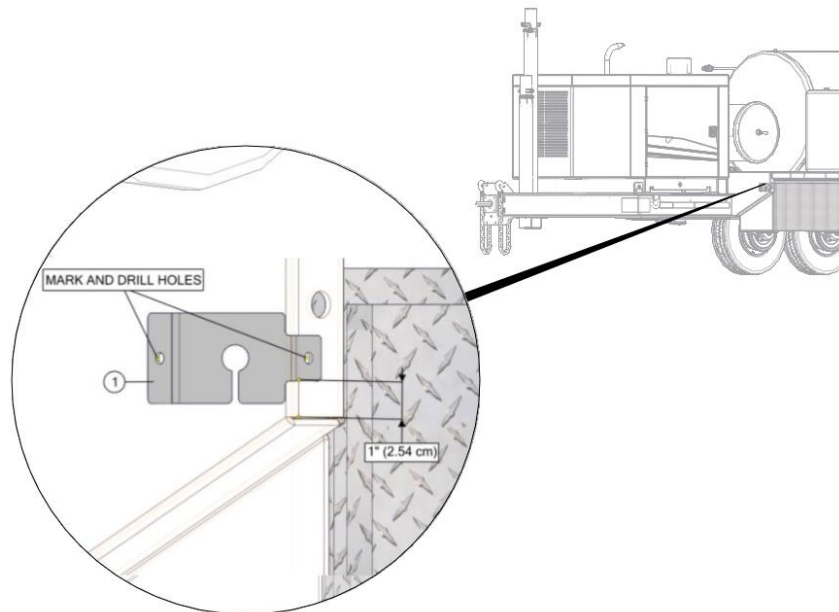

Z

- Use the 1 ft (30.48 cm) length of dual core conductor wire to connect the front clearance marker lamp and tie in with the 100" (254 cm) length wire from the front side marker lamp. Use the 12-10 (yellow) and 16-14 (blue) heat seal butt connectors to connect all wires according to diagram below. Ref. 2, 6, 7 and 9 Fig. 2.

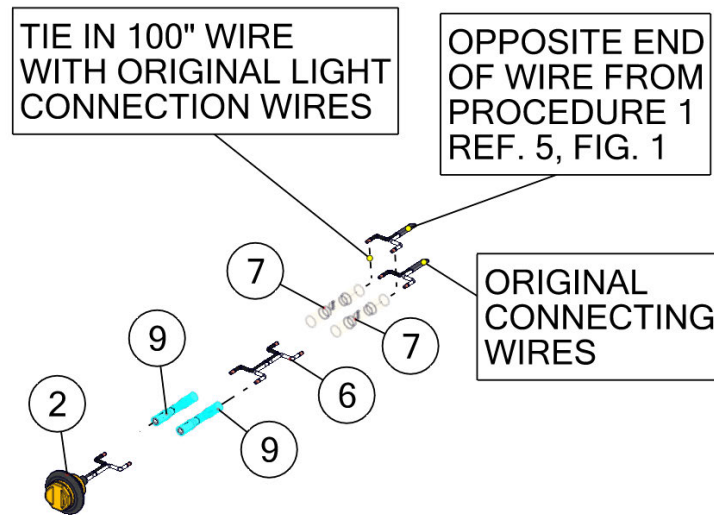

- Insert the front clearance marker lamp into the front clearance marker bracket as shown Ref 1 and 2, Fig. 2. Refer to the illustration below for proper lamp orientation.
- Attach the front clearance marker bracket with the hardware Ref. 3, 4, and 5 Fig. 2.
- Loom all exposed wires. Ref. 8 Fig. 2.

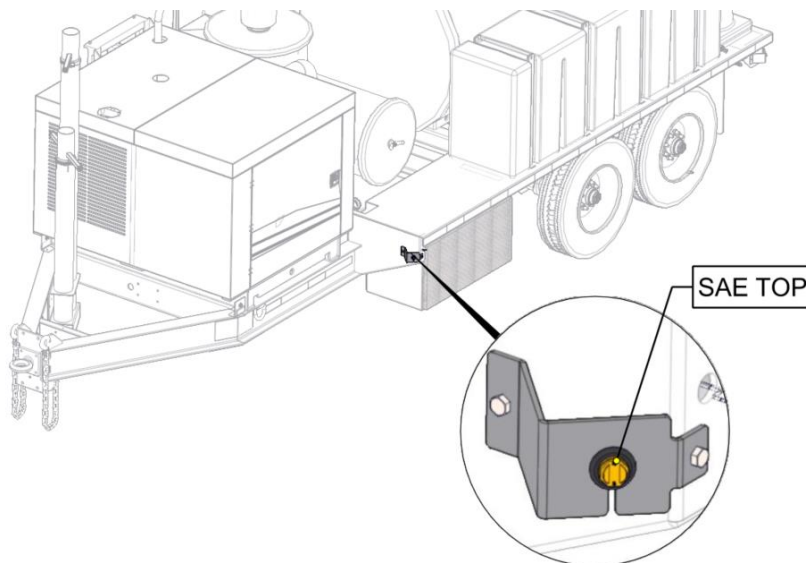

PROCEDURE 3:

1. Remove the curb side marker light from the platform gusset and disconnect the wires (some units will have an incandescent light instead of the LED light shown).

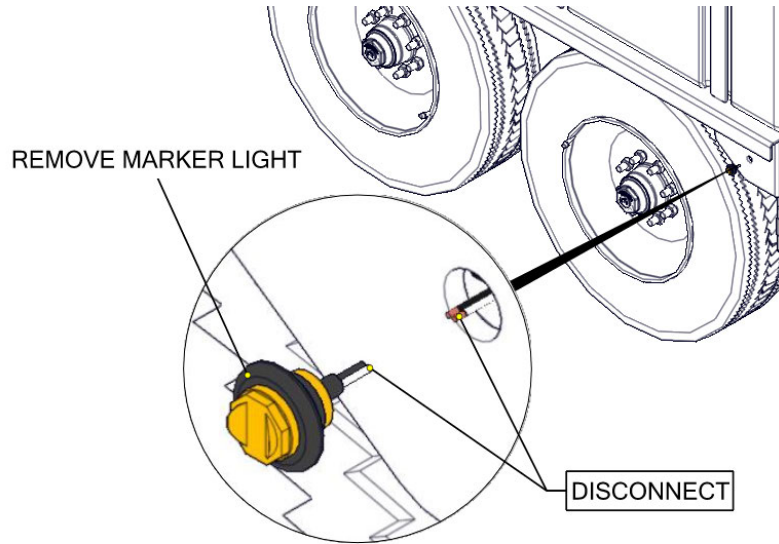

2. Use 12-10 heat seal butt connectors to tie in the 100" (254 cm) curb side wire with the original curb side marker light wire. Ref. 5, Fig 1 and Ref 7, Fig 3.

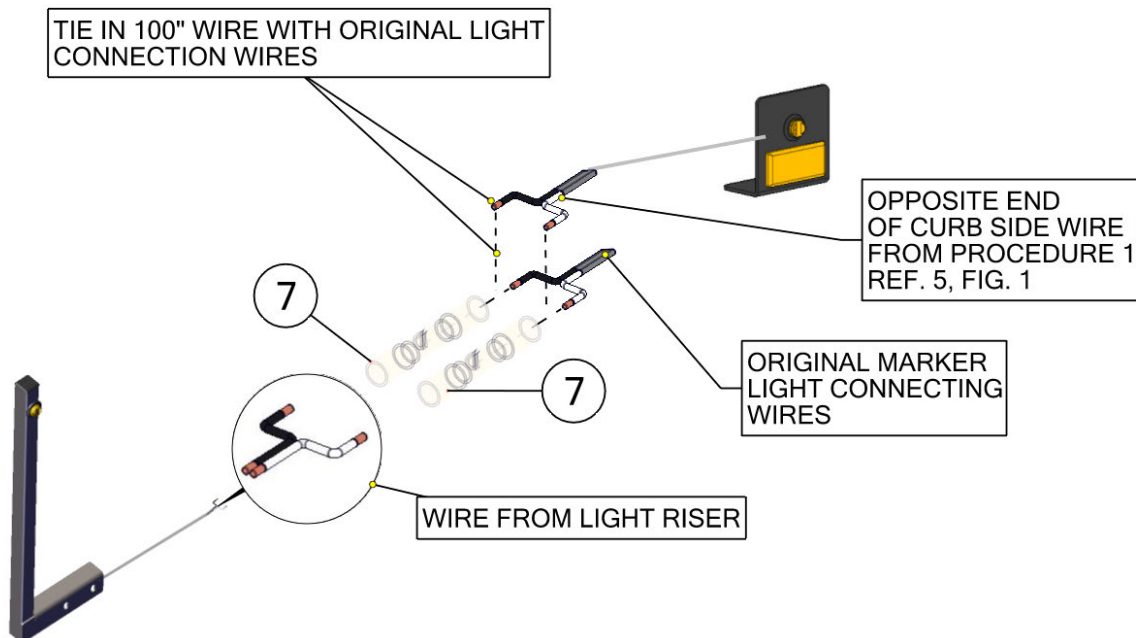

3. Remove the fastening hardware from the jetter reel and retain for future installation. Move the jetter reel as needed to drill the holes in Step 4.

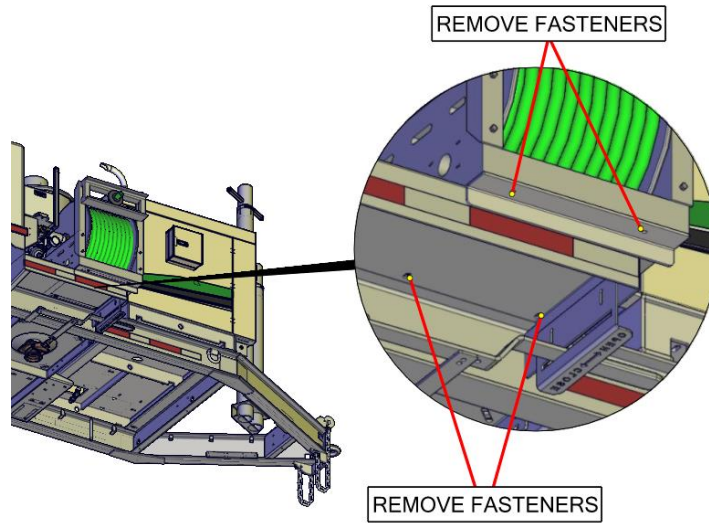

4. Drill 2 - $\text{Ø}5/16''$ holes in the tank plate in the positions shown.

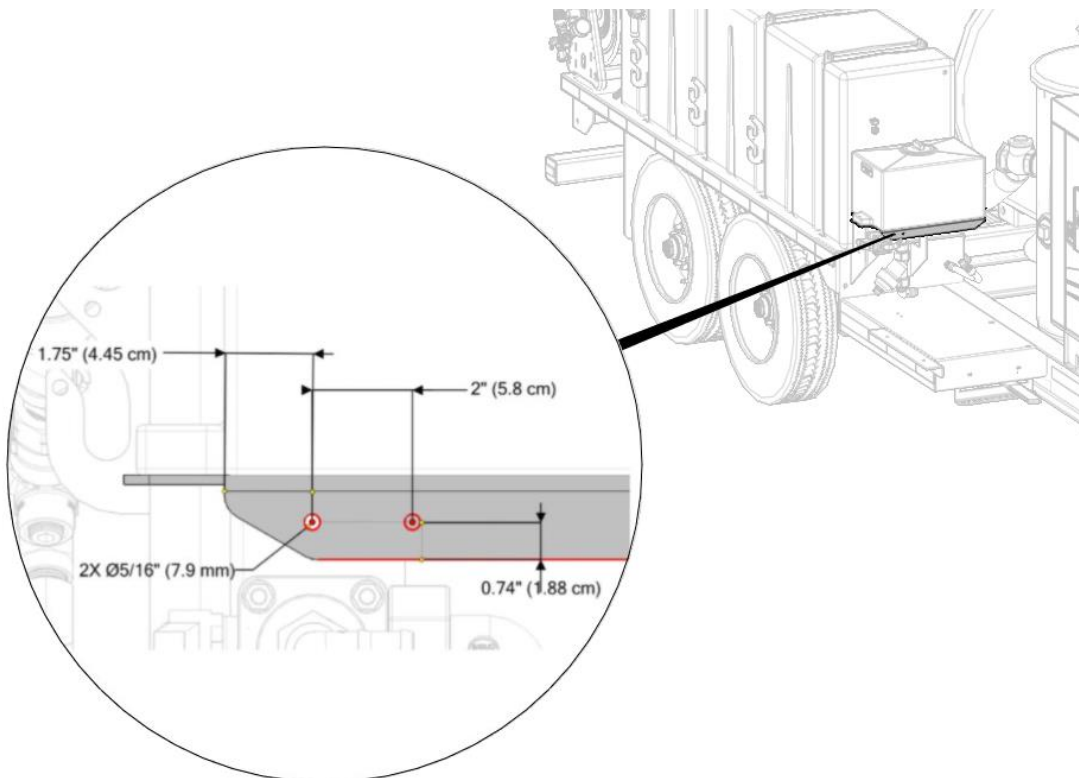

5. Connect the marker light riser to the tank plate. Ref. 1, 3, and 4, Fig. 3.

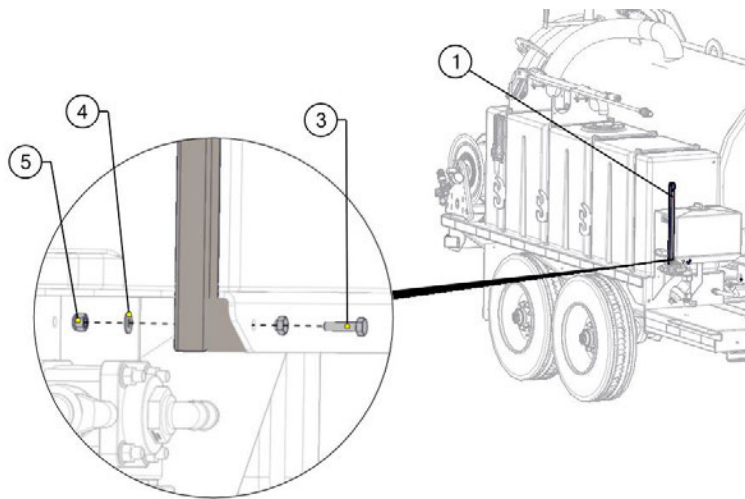

6. Reconnect the jetter real with the hardware retained.

PROCEDURE 4:

1. Clean area where the conspicuity tape will be installed with light soap and water. Areas with damaged paint or heavy corrosion should be prepped, painted, and thoroughly dry before applying conspicuity tape.
2. Refer to the illustration and install the conspicuity tape in the locations shown. Ref. 1, 2, and 3 Fig. 4.
3. Repeat for the opposite side of the trailer.

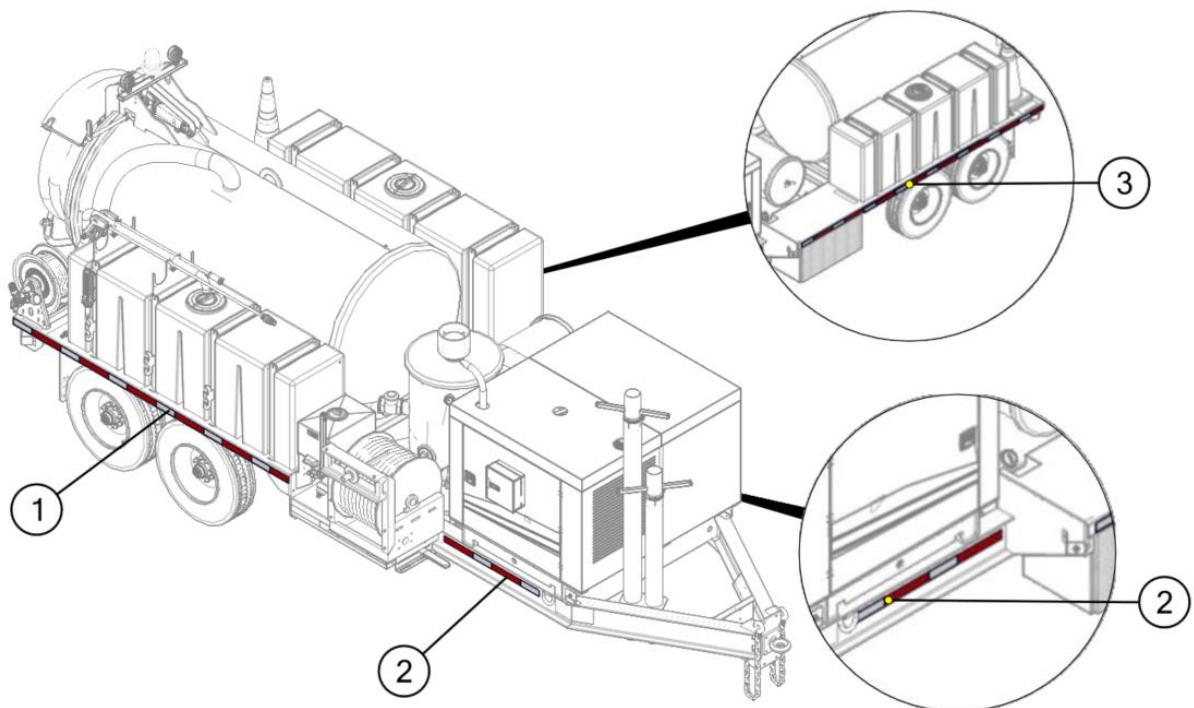

PROCEDURE 5:

1. Remove the existing rear corner/side clearance marker lamp Ref. A from the gusset (retain for future installation) and disconnect the wires.

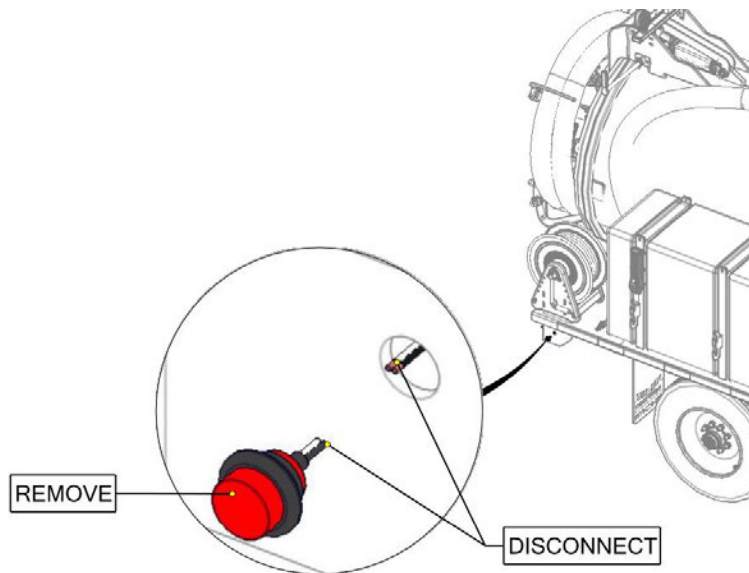

2. Place the rear corner/side clearance marker bracket on the support approximately 1-1/2" (3.81 cm) from the bottom as indicated in the illustration below. Mark the bolt locations on the support and drill (2) Ø9/32" (Ø7.15 mm) holes.

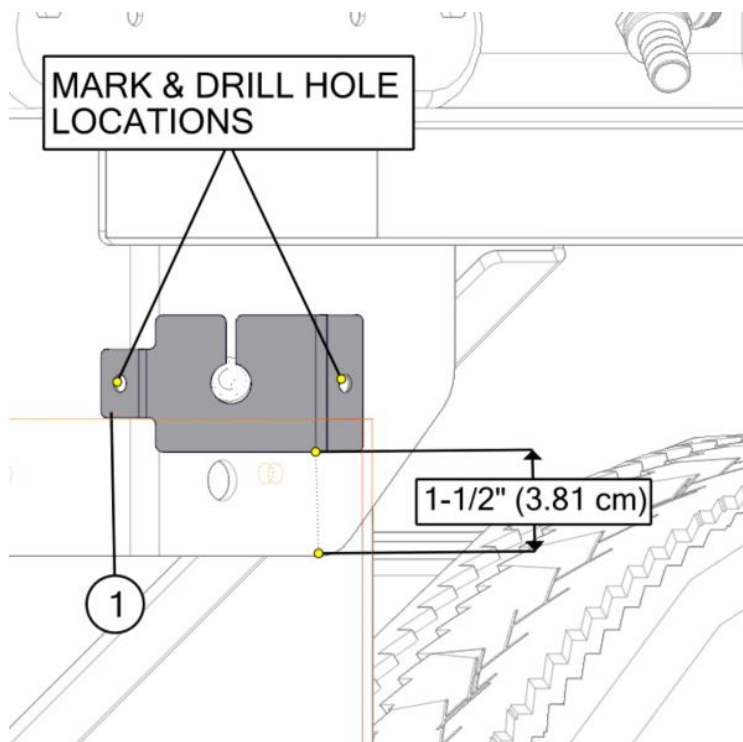

- Use the 1 ft (30.48 cm) length of dual core conductor wire to reconnect the rear corner/side clearance marker lamp using 16-14 butt connectors. Ref 2, 7 and 8, Fig 5.

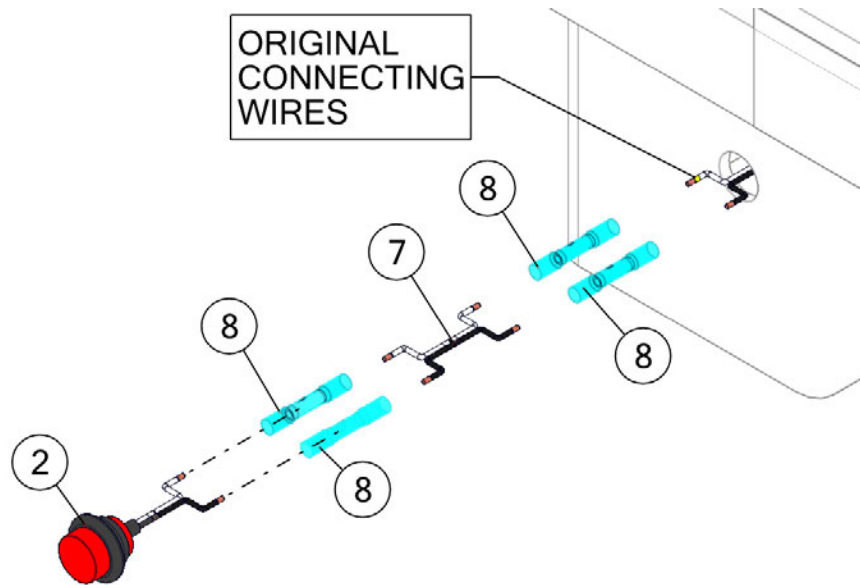

- Attach the rear corner/side clearance marker bracket to the fender support with the hardware as shown Ref. 3, 4, and 5 Fig. 5.
- Loom all exposed wires. Ref. 9 Fig. 5.
- Insert the rear corner/side clearance marker lamp into the bracket as shown Ref 1 and 2, Fig. 5.
- Clean area where the rear side marker reflectors will be installed with light soap and water. Areas with damaged paint or heavy corrosion should be prepped, painted, and thoroughly dry before applying the reflectors as shown.

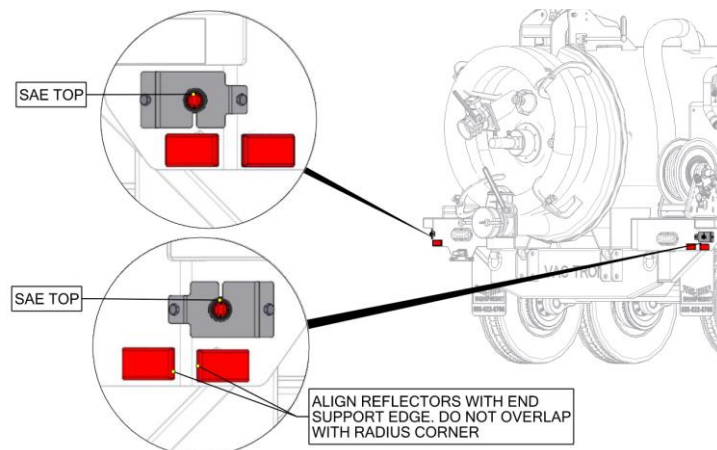

8. Install the rear side marker reflectors below the side marker bracket as shown.
9. Repeat all steps for the opposite side of the trailer.

PROCEDURE 6:

1. Clean area where the conspicuity tape will be installed with light soap and water. Areas with damaged paint or heavy corrosion should be prepped, painted, and thoroughly dry before applying the conspicuity tape.
2. Refer to the illustration and install each of the white conspicuity tape on the debris tank door and water tanks as shown Ref 1, Fig. 6.

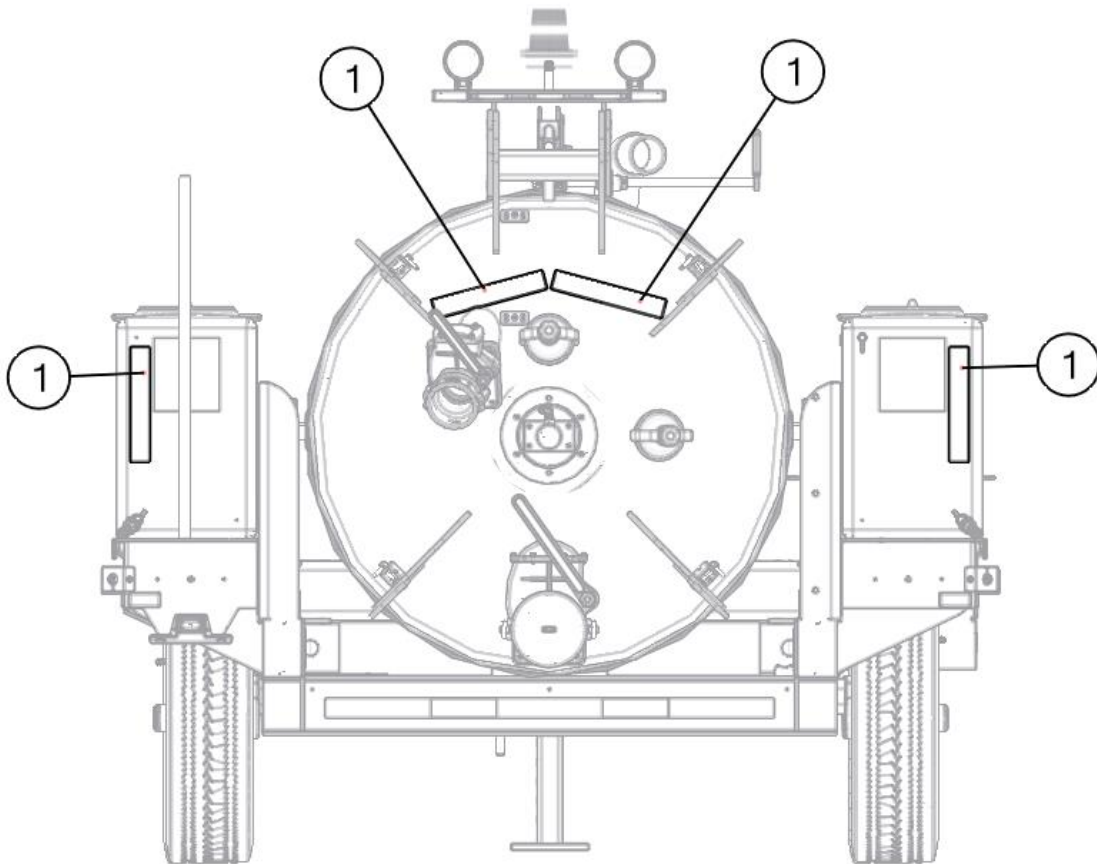

Figure 1

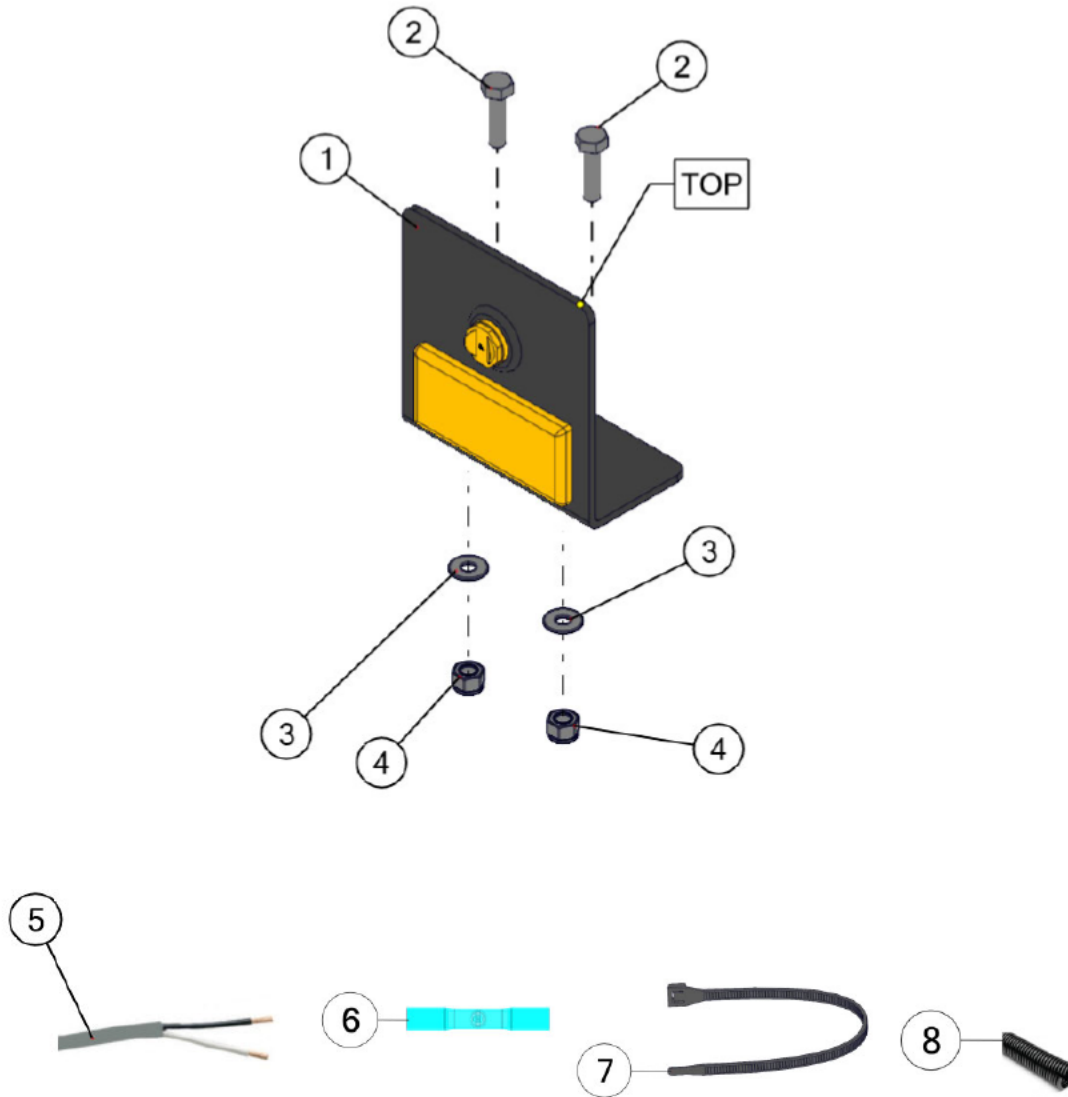

FIGURE 1 Parts List

REF. NO.	PART NO.	DESCRIPTION	VVK01 QTY.
1	B125-5749	FRONT SIDE MARKER LAMP BRACKET WITH REFLECTOR	2
2	P-1473	1/4-20 X 1 HEX HEAD BOLT	4
3	P-1472	1/4 ID FLAT WASHER	4
4	P-2782	1/4-20 NYLON LOCKNUT	4
5	P-1054-0	100" (2.54 m) LENGTH DUAL CORE CONDUCTOR WIRE	2
6	P-2369-0	16-14 HEAT SEAL BUTT CONNECTOR BLUE	4
7	P-1301-1	ZIP TIE	10
8	P-2762-0	1/2" SPLIT WIRE LOOM, 100" (2.54 m) LENGTH	2

Figure 2

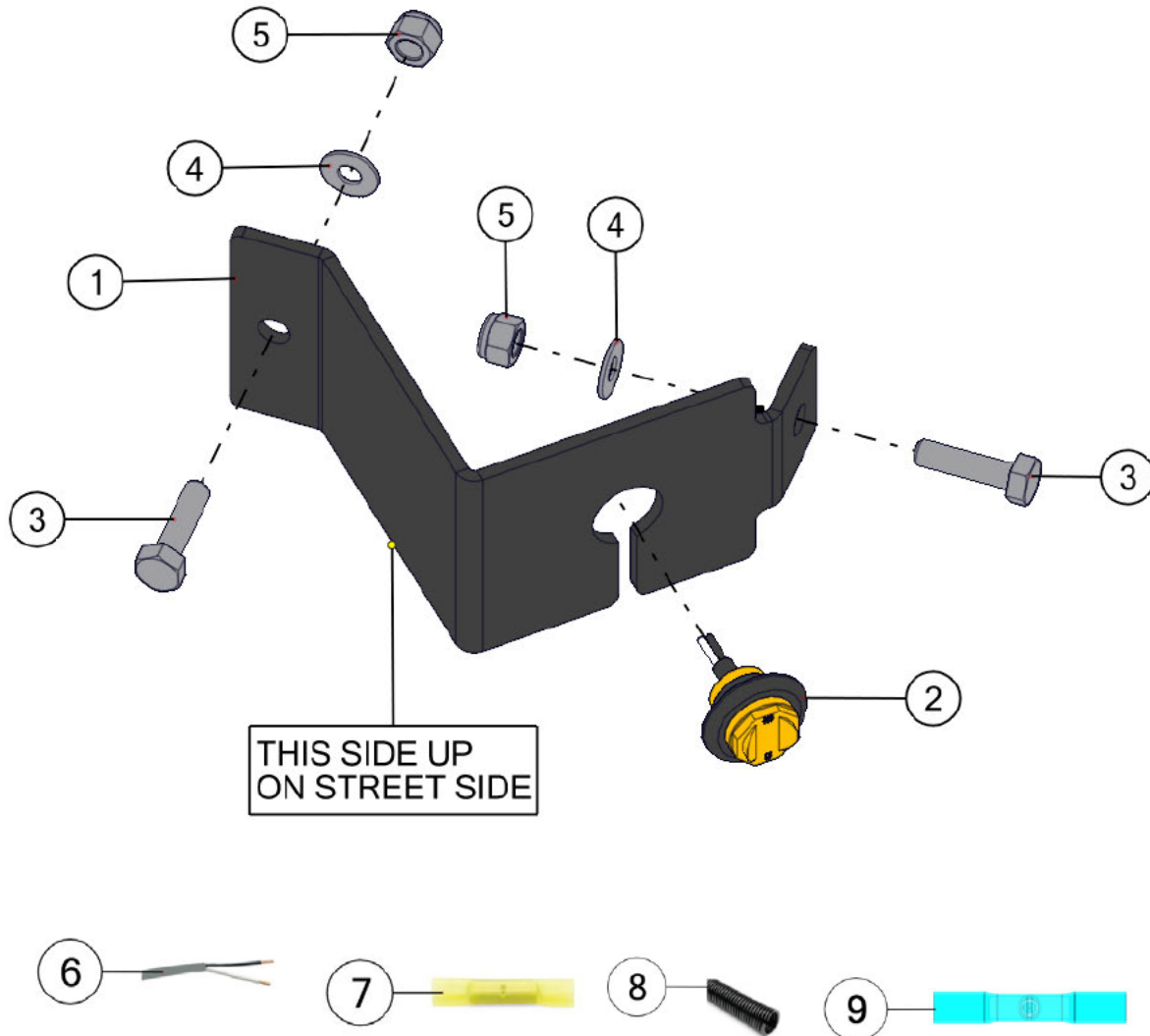

FIGURE 2 Parts List			
REF. NO.	PART NO.	DESCRIPTION	VVK01 QTY.
1	B125-5748	FRONT CLEARANCE MARKER LAMP BRACKET	1
2	P-4190	FRONT CLEARANCE MARKER LAMP (EXISTING ON TRAILER)	1
3	P-1473	1/4-20 X 1 HEX HEAD BOLT	2
4	P-1472	1/4 ID FLAT WASHER	2
5	P-2782	1/4-20 NYLON LOCKNUT	2
6	P-1054-0	1' (30.48 cm) LENGTH DUAL CORE CONDUCTOR WIRE	1
7	135500217	12-10 HEAT SEAL BUTT CONNECTOR	2
8	P-2762-0	1/2" SPLIT WIRE LOOM, 1' (30.48 cm) LENGTH	1
9	P-2369-0	16-14 HEAT SEAL BUTT CONNECTOR BLUE	2

Figure 3

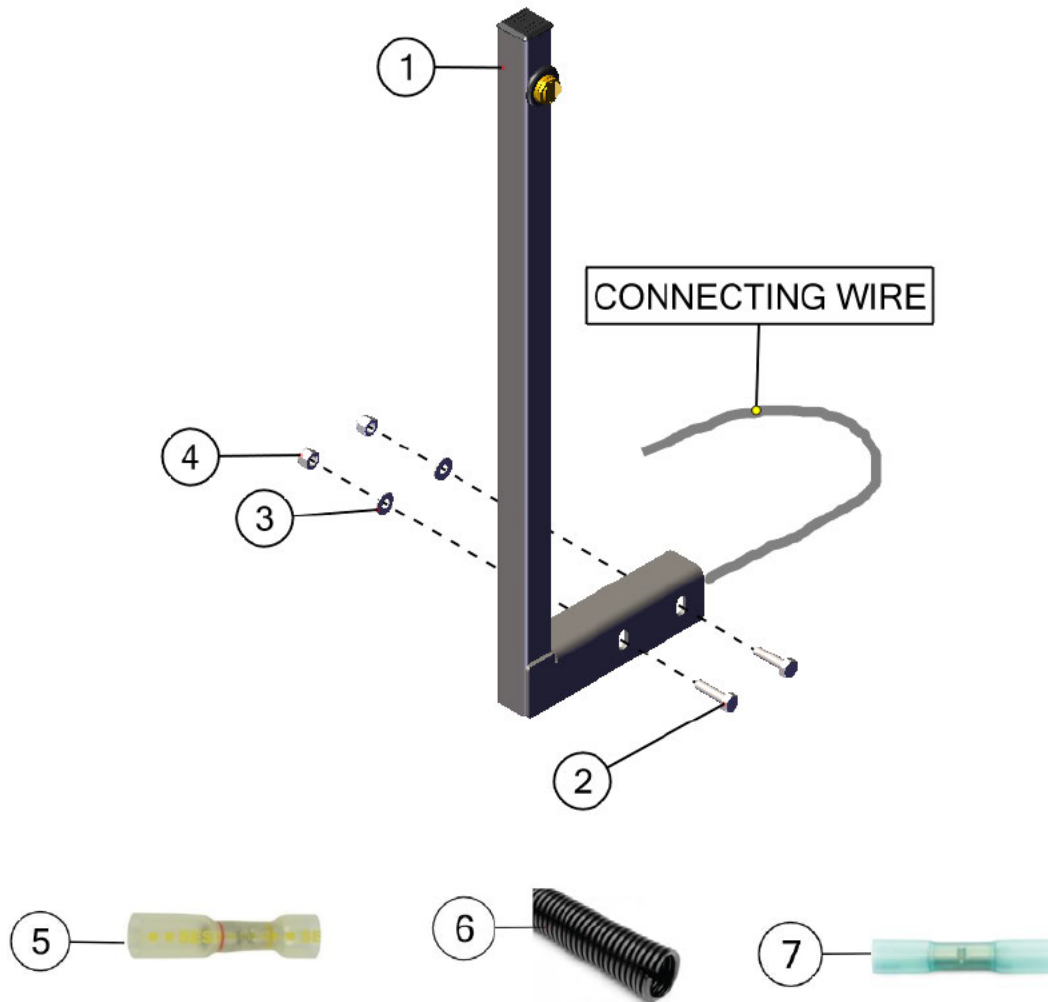

FIGURE 3 Parts List			
REF. NO.	PART NO.	DESCRIPTION	VVK01 QTY.
1	135500175	FRONT CLEARANCE MARKER LAMP BRACKET (ASSEMBLED)	1
2	P-1473	1/4-20 X 1 HEX HEAD BOLT	2
3	P-1472	1/4 ID FLAT WASHER	2
4	P-2782	1/4-20 NYLON LOCKNUT	2
5	135500217	12-10 HEAT SEAL BUTT CONNECTOR	2
6	P-2762	1/2" SPLIT WIRE LOOM, 36" (91.4 cm) LENGTH	1
7	P-2369	16-14 HEAT SEAL BUTT CONNECTOR BLUE	2

Figure 4

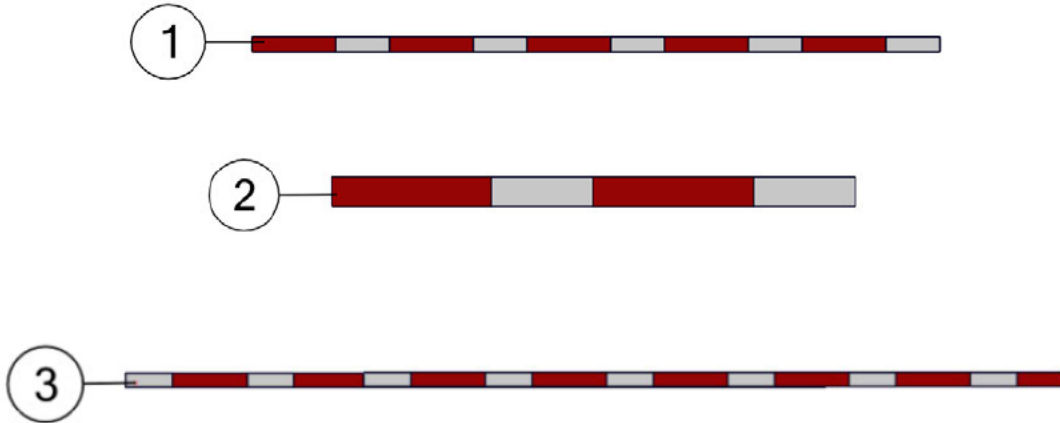

FIGURE 4 Parts List			
REF. NO.	PART NO.	DESCRIPTION	VVK01 QTY.
1	P-0485	2" (2.54 cm) WIDE, 25" (63.5 cm) LONG CONSPICUITY TAPE	2
2	P-0485	2" (2.5 cm) WIDE, 101 "(256.5 cm) LONG CONSPICUITY TAPE	1
3	P-0485	2" (2.54 cm) WIDE, 142.5" (362 cm) LONG CONSPICUITY TAPE	1

Figure 5

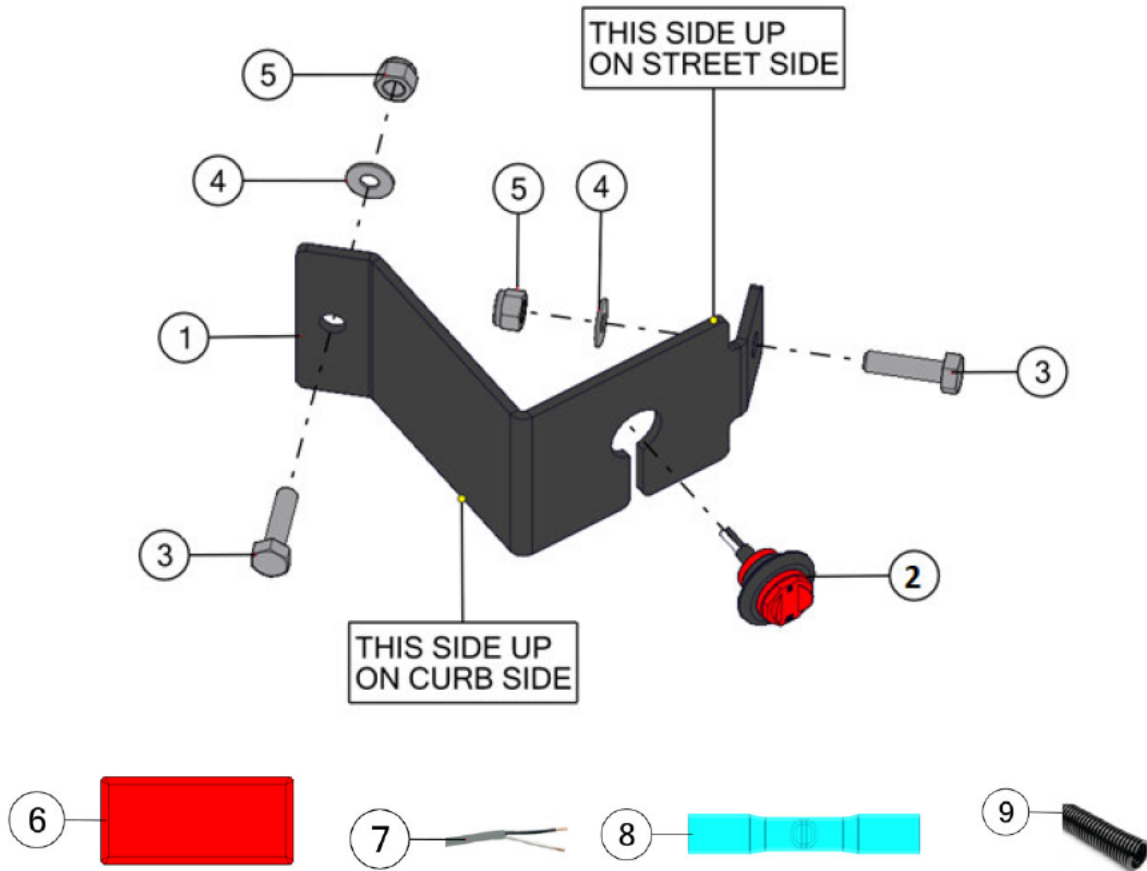

FIGURE 5 Parts List			
REF. NO.	PART NO.	DESCRIPTION	VVK01 QTY.
1	B125-5748	REAR CORNER/SIDE CLEARANCE MARKER LAMP BRACKET	2
2	P-4189	REAR CORNER/SIDE CLEARANCE MARKER LAMP (EXISTING ON TRAILER)	2
3	P-1473	1/4-20 X 1 HEX HEAD BOLT	4
4	P-1472	1/4 ID FLAT WASHER	4
5	P-2782	1/4-20 NYLON LOCKNUT	4
6	P-5730	REAR SIDE MARKER REFLECTOR	4
7	P-1054-0	1' (30.48 cm) LENGTH DUAL CORE CONDUCTOR WIRE	2
8	P-2369-0	16-14 HEAT SEAL BUTT CONNECTOR BLUE	8

Figure 6

2



FIGURE 6 Parts List			
REF. NO.	PART NO.	DESCRIPTION	VVK01 QTY.
1	P-5783	WHITE CONSPICUITY TAPE, 12" LENGTH	4