



FIELD KIT

Vermeer Corporation

Environmental
Pella, IA 50219 USA

FIELD CAMPAIGN KIT#	IK003942	DATE:	16 July 2020
<i>For Dealer Reference: Service Bulletin #SVC2020-096</i>			
BC1800XL Wheel and Tire Assembly Replacement Kit			

CAMPAIGN TYPE:	Mandatory Product Safety DEALER INSTALLATION ONLY
CAMPAIGN CATEGORY:	Kit and Bulletin

MACHINE/ ATTACHMENT MODEL(S):	Serial Numbers		
	Included	Excluded	Kit Version
BC1800XL	2381, 2382, 2409, 2801, 2839, 2842, 2978, 3217 - 3219 (Only Units with JSK01472)	All units without JSK01472 installed.	IK01: Solid Steel Wheels 8 on 6½", 5/8" studs; Heavy Duty Tires 235/75R17.5 LRJ 18 ply; safety sign; tire specification placard; and English supplemental manual
BC1800XL	2381, 2382, 2409, 2801, 2839, 2842, 2978, 3217 - 3219 (Only Units with JSK01472)	All units without JSK01472 installed. 2381, 2382, 2409, 2801, 2839, 2842, 2978, 3217 - 3219	IK02: Solid Steel Wheels 8 on 6½", 5/8" studs; Heavy Duty Tires 235/75R17.5 LRJ 18 ply; safety sign; tire specification placard; and English + Translated Supplemental Manual



PURPOSE: Specific wheels (steel rim) with bolt pattern 8 on 6 1/2" (165 mm) circle to be used with 5/8" studs provided by a supplier:

- have an incorrect lug nut contact area causing wheel lug nuts to loosen; and/or
- can develop possible cracks causing the tire to loose air pressure

Both conditions may increase the risk of wheel loss and the risk of a crash. **Death or serious injury is possible.** Property damage may also occur.

This kit has been created to provide the necessary parts and instructions to replace the wheel and tire assembly, install a new safety sign, install a new wheel/tire specification placard decal and provide a Supplemental Operator's and Maintenance Manual.

SPECIAL TOOLS AND CONDITIONS:

- None

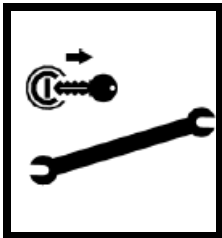

WARNING: Failure to use shutdown procedure can result in unexpected hazard(s). Death or serious injury could result due to entanglement, crushing, cutting, or other hazardous contact. Follow Shutdown Procedure after operating, before performing any service or maintenance, and before transporting.



WARNING: Raised load can shift or fall. Death or serious injury could be possible if struck or crushed by falling load. Never allow anyone under a raised load unless load is securely supported to prevent it from shifting or falling.

BC1800XL SHUTDOWN PROCEDURE

STOPPING THE MACHINE

NOTICE: For your safety and safety of others, use shutdown procedure before servicing, cleaning, unclogging, or transporting the chipper. A variation of this procedure may be used if so instructed within this manual or if an emergency requires it.

1. Return *Upper Feed Control Bar* to center STOP position.
2. Place *Throttle Switch* in LOW RPM.

NOTICE: Whenever practical and safe, allow engine to idle for 1–5 minutes before shutting down after operating at full power. Please consult machine's engine manual for details.

3. Wait for cutter drum to slow.
4. Disengage clutch.
5. Shut off remote control if in use.
6. Shut off engine and remove key.
7. Wait for the cutter drum and belts to stop.

NOTICE: Check that cutter drum rotation has stopped by looking to see if the drive belt (1) behind shield has stopped. The cutter drum will continue to turn for a short time after the engine has stopped.

8. Close and latch feed table.

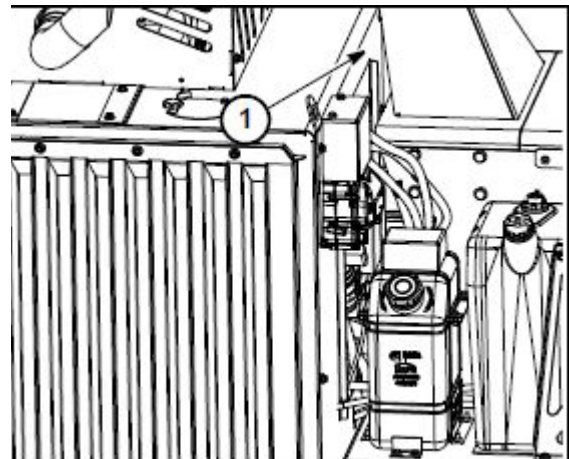
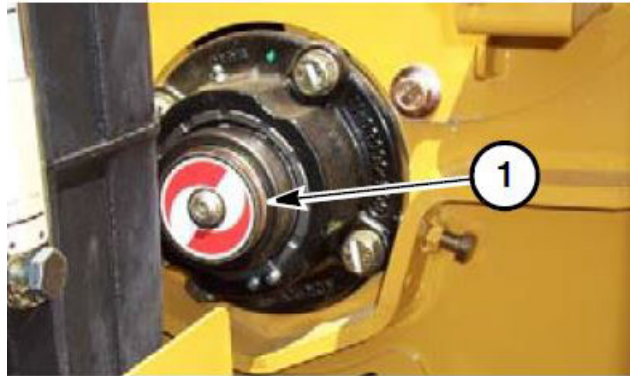

PROCEDURE: WHEELS, AXLES, AND SUSPENSION MAINTENANCE

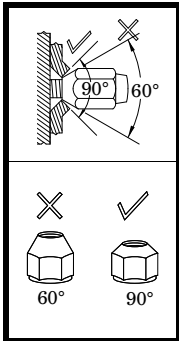

WARNING: Incompatible lug nuts may loosen and cause wheel loss.

Use only 5/8-18 lug nuts with a 90° conical taper.

NOTICE: Improper or mismatched lug nuts and wheels can cause wheel loss leading to a crash. The conical taper of the lug nuts must properly engage the wheel lug nut seats.

The wheels and axle hubs on this trailer use special 5/8"-18 lug nuts with a 90° conical taper.

Never use incompatible lug nuts, such as those with a 60° taper or a flat face.

Never use wheels intended for a 9/16" wheel lugs.

Never use wheels that do not utilize a 90° conical lug nut seat taper.

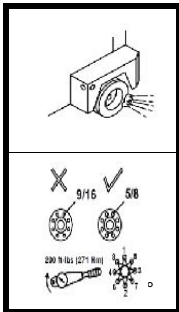

WARNING: Incompatible wheels or loose lug nuts can cause wheel loss and machine damage.

Use only wheels that are compatible with 5/8 lug studs and 90° conical nuts. Check lug nut torque regularly.

Properly tighten lug nuts in a star pattern using only hand tools. DO NOT use impact wrenches which can damage the lug nuts, lug nut seats, and hub studs. Torque and recheck every 500 miles (800km).

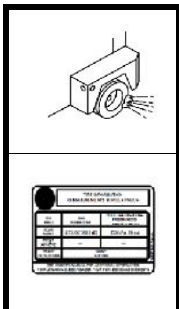

WARNING: Improper tire pressure can cause a blowout.

Set cold tire pressure according to tire placard. Check pressure monthly.

NOTICE: Under-inflation causes tire damage and can lead to a blowout.

Set the tire air pressure to the value listed on the machine's tire placard, NOT the pressure printed on the sidewall of the tire. Recheck monthly. Tires normally lose 1–2 psi (6.9–13.8 kPa) per month.

Tire pressure can also drop if the temperature outside has dropped significantly, so check more often in cold weather.

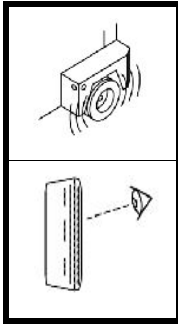

WARNING: Worn or damaged suspension can cause premature tire wear and machine damage.

Uneven wear on tires can be an indication of worn suspension or poor alignment.

NOTICE: Axle or suspension damage can cause premature tire wear and tire failure, or axle failure.

Have your trailer checked if you suspect misalignment, if your tires have suffered any type of impact, or if you observe uneven tire wear.



Unless indicated, new parts from kit have callouts with numbers. Callouts with letters indicate existing parts or general items.

PROCEDURE: WHEEL AND TIRE ASSEMBLY 17.5 IK01

1. Using a suitable lifting device capable of lifting approximately 12,885 lb (5850 kg), raise machine off ground to allow adequate room to remove tire.
2. Place suitable blocking under trailer frame and remove lifting device.
3. Remove wheels, and wheel nuts, from each side of machine. Weight of each wheel is approximately 91 lb (42 kg).
4. Deflate tire or remove tire from wheel.
5. The removed used tires may be retained in your **used** tire inventory or disposed of. Cost of tire removal is included in labor hours.
6. Discard wheel nuts so they can no longer be used or sold for any purpose.
7. Torch cut the wheels across the lug nut area.
8. Take a photo(s) of destroyed wheels and attach to campaign warranty claim.
9. Place four new wheels (1) on axles. Slide one retainer ring (2) on each side of both axles. Attach each wheel using eight wheel nuts (3). Weight of each wheel is approximately 91 lb (42 kg). Torque wheel nuts in a star pattern to 200 ft-lb (271 Nm).

10. Check tire pressure to be at 85 psi (590 kPa).

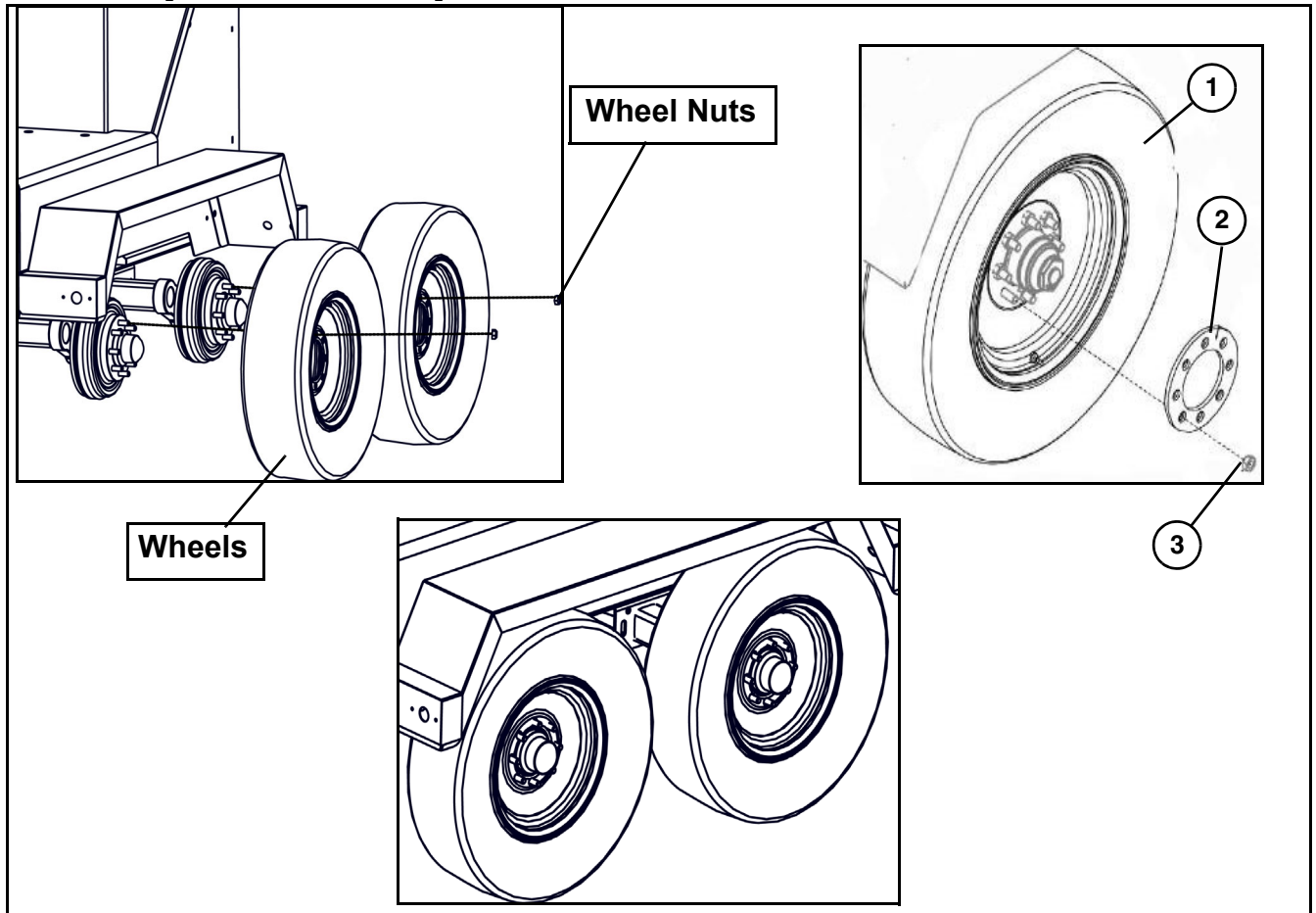

11. Attach one new wheel and tire warning decal (4) on left and right side of infeed housing.

12. Attach one new tire information decal (5) on front of machine.

13. Provide additional Supplemental Manual to owner.

14. Install Operator's Manual with ring in manual storage box.

TIRE INFORMATION
RENSEIGNEMENTS SUR LES PNEUS

TIRE PNEU	SIZE DIMENSIONS	COLD TIRE PRESSURE PRESSION DES PNEUS A FROID
REAR AVANT	235/75R17.5 H/J	586 kPa, 85 psi
FRONT ARRIÈRE	-	-
SPARE DE SECOURS	NONE AUCUNE	

SEE OWNER'S MANUAL FOR ADDITIONAL INFORMATION
VOIR LE MANUAEL DE L'USAGER POUR PLUS DE RENSEIGNEMENTS

7000J032 Rev A

⚠ WARNING

1000J038 Rev A

Wheel loss, tire blowout, and loss of vehicle control can occur causing death or serious injury.

Incompatible lug nuts may loosen and cause wheel loss.

Incompatible lug nuts may loosen and cause wheel loss.

Incompatible wheels or loose lug nuts can cause wheel loss.

Incompatible wheels or loose lug nuts can cause wheel loss.

Use only 5/8-18 nuts with a 90° conical taper.

Use only 5/8-18 nuts with a 90° conical taper.

Use only proper wheels. Check torque regularly.

Use only proper wheels. Check torque regularly.

Improper tire pressure can cause a blowout.

Improper tire pressure can cause a blowout.

Worn or damaged suspension can cause premature tire wear and machine damage.

Worn or damaged suspension can cause premature tire wear and machine damage.

Avoid overloading or excess speed.

Avoid overloading or excess speed.

Set cold tire pressure according to the placard (NOT maximum pressure printed on sidewall).

Set cold tire pressure according to the placard (NOT maximum pressure printed on sidewall).

Uneven wear on tires is an indication of worn suspension or poor alignment.

Uneven wear on tires is an indication of worn suspension or poor alignment.

Always follow manufacturer's load and speed ratings.

Always follow manufacturer's load and speed ratings.

ALWAYS use Vermeer authorized wheels, lug nuts, tires, and suspension components.

PROCEDURE: WHEEL AND TIRE ASSEMBLY 17.5 IK02

1. Using a suitable lifting device capable of lifting approximately 12,885 lb (5850 kg), raise machine off ground to allow adequate room to remove tire.
2. Place suitable blocking under trailer frame and remove lifting device.
3. Remove wheels, and wheel nuts, from each side of machine. Weight of each wheel is approximately 91 lb (42 kg).
4. Deflate tire or remove tire from wheel.
5. The removed used tires may be retained in your **used** tire inventory or disposed of. Cost of tire removal is included in labor hours.
6. Discard wheel nuts so they can no longer be used or sold for any purpose.
7. Torch cut the wheels across the lug nut area.
8. Take a photo(s) of destroyed wheels and attach to campaign warranty claim.
9. Place four new wheels (1) on axles. Slide one retainer ring (2) on each side of both axles. Attach each wheel using eight wheel nuts (3). Weight of each wheel is approximately 91 lb (42 kg). Torque wheel nuts in a star pattern to 200 ft-lb (271 Nm).
10. Check tire pressure to be at 85 psi (590 kPa).

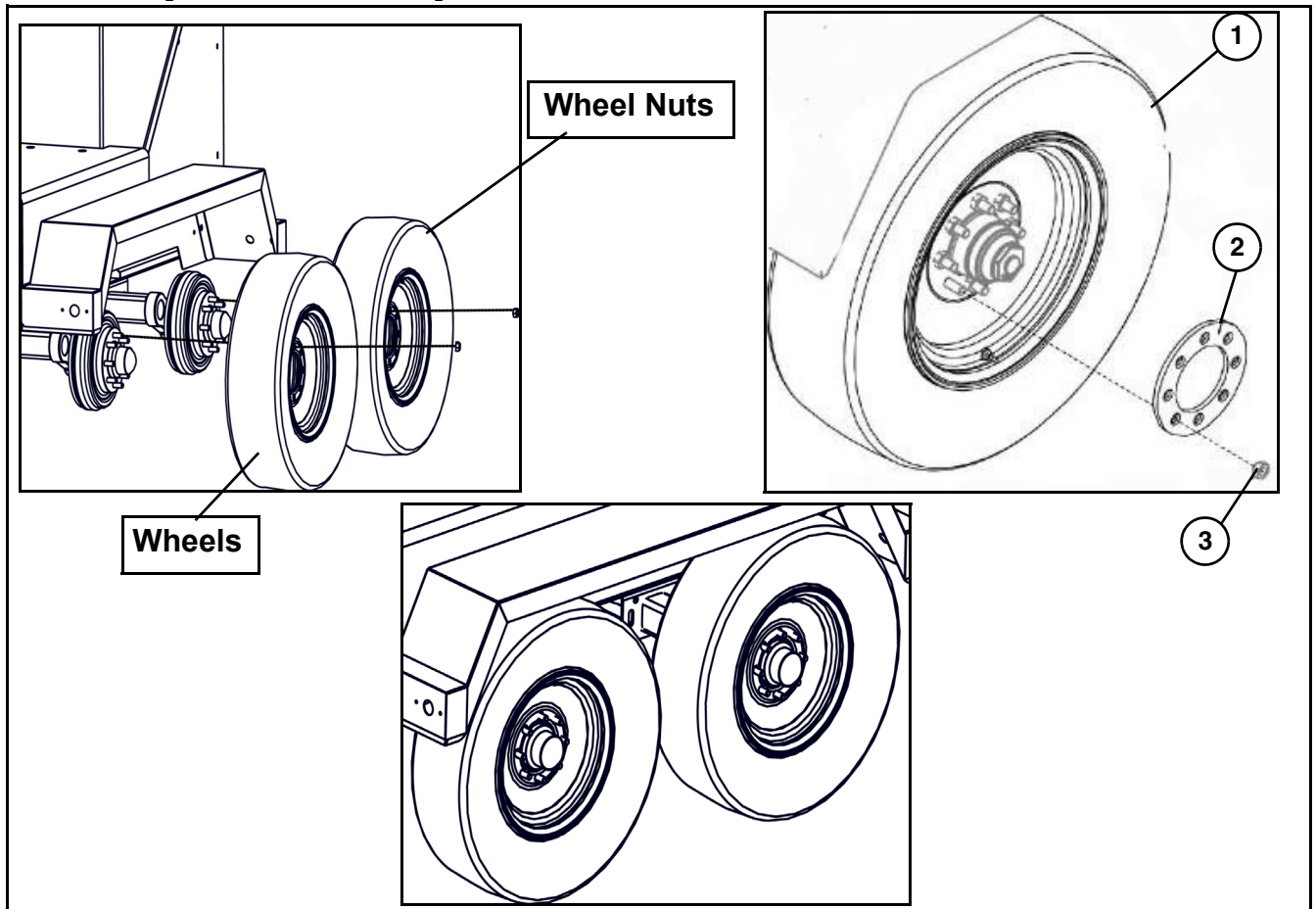

11. Attach one new wheel and tire warning decal (6) on left and right side of infeed housing.
12. Attach one new tire information decal (5) on front of machine.
13. Provide additional Supplemental Manual to owner.
14. Install Operator's Manual with ring in manual storage box..

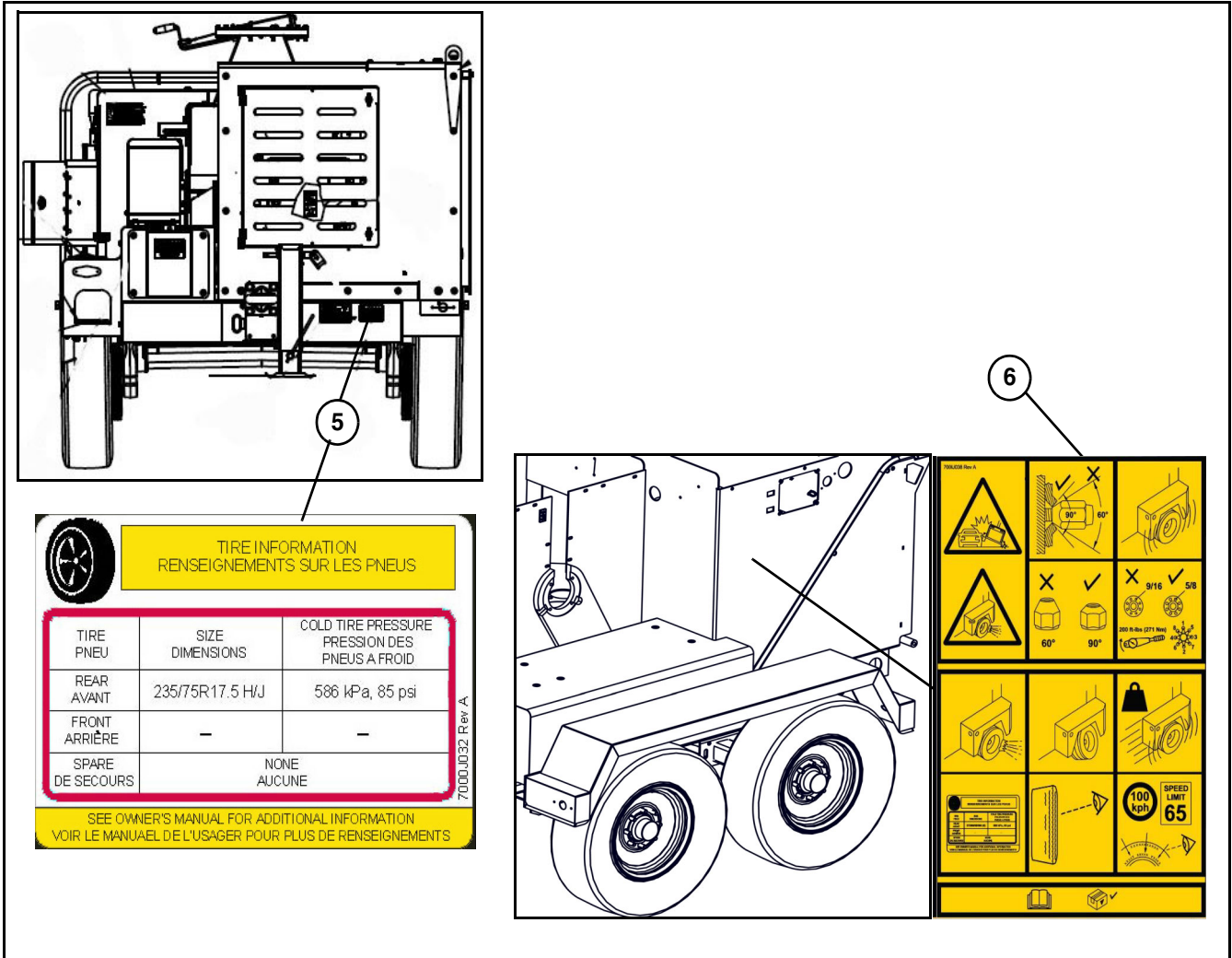

Figure 1

UNIT OWNER COPY:
Insert into Parts Manual
for future reference

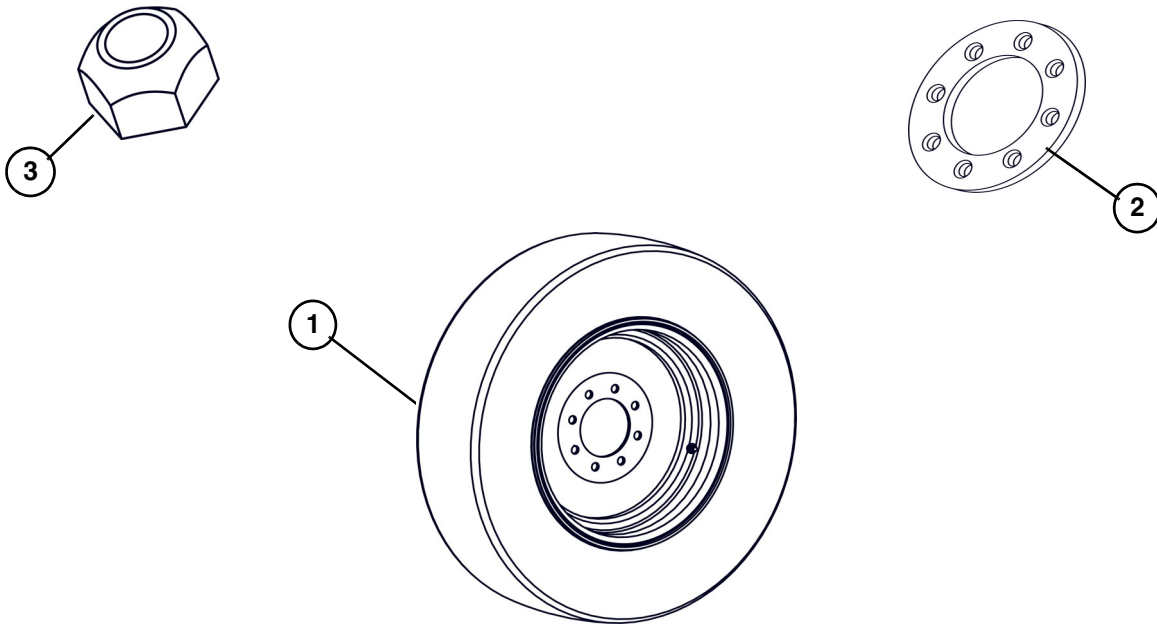



FIGURE 1 Parts List

<u>REF. NO.</u>	<u>PART NO.</u>	<u>DESCRIPTION</u>	<u>IK01 QTY.</u>	<u>IK02 QTY.</u>
1	163713905	HEAVY DUTY - WHEEL ASSY - 235/75R17.5 H/J; 5/8 S	4	4
2	215490049	CLAMP RING	4	4
3	116621009	WHEEL NUT 5/8in 18 CONE 90°	32	32
		Kit includes all items in Figure 1 Parts List.		

Figure 2

UNIT OWNER COPY:
Insert into Parts Manual
for future reference



TIRE INFORMATION
RENSEIGNEMENTS SUR LES PNEUS

TIRE PNEU	SIZE DIMENSIONS	COLD TIRE PRESSURE PRESSION DES PNEUS A FROID
REAR AVANT	235/75R17.5 H/J	586 kPa, 85 psi
FRONT ARRIÈRE	—	—
SPARE DE SECOURS	NONE AUCUNE	

SEE OWNER'S MANUAL FOR ADDITIONAL INFORMATION
VOIR LE MANUEL DE L'USAGER POUR PLUS DE RENSEIGNEMENTS

7000J032 Rev A

▲ **WARNING**

7000J038 Rev A



Incompatible lug nuts may loosen and cause wheel loss.

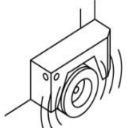

Incompatible wheels or loose lug nuts can cause wheel loss.

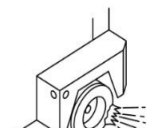

Wheel loss, tire blowout, and loss of vehicle control can occur, causing death or serious injury.

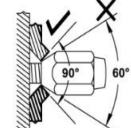

Use only 5/8-18 nuts with a 90° conical taper.

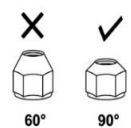

Use only proper wheels. Check torque regularly.

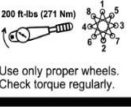

200 ft-lbs (271 Nm)

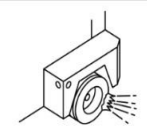

Improper tire pressure can cause a blowout.

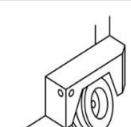

Worn or damaged suspension can cause premature tire wear and machine damage.

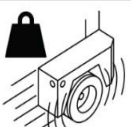

Avoid overloading or excess speed.



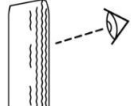

Set cold tire pressure according to tire placard, NOT maximum pressure printed on sidewall.



Uneven wear on tires is an indication of worn suspension or poor alignment.



Always follow manufacturer's load and speed ratings.



ALWAYS use Vermeer authorized wheels, lug nuts, tires, and suspension components.













200 ft-lbs (271 Nm)















5

4

6

FIGURE 2 Parts List

REF. NO.	PART NO.	DESCRIPTION	IK01 QTY.	IK02 QTY.
4	7000J038	DECAL-WARNING, WHEEL & TIRE	2	-
5	7000J032	DECAL- TIRE INFORMATION	1	1
6	700IJ038	Decal – Warning, Wheel & Tire	-	2
		Kit includes all items in Figure 2 Parts List.		

UNIT OWNER COPY:
Insert into Parts Manual
for future reference

Figure 3

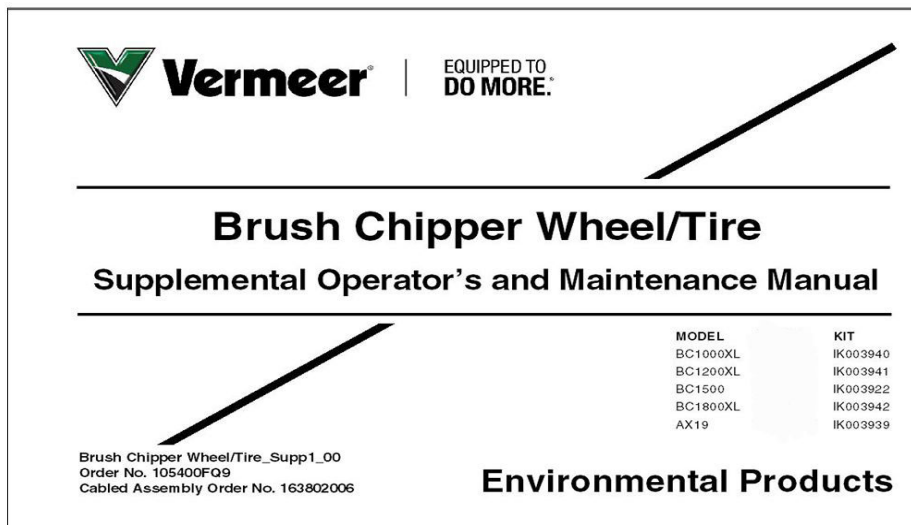
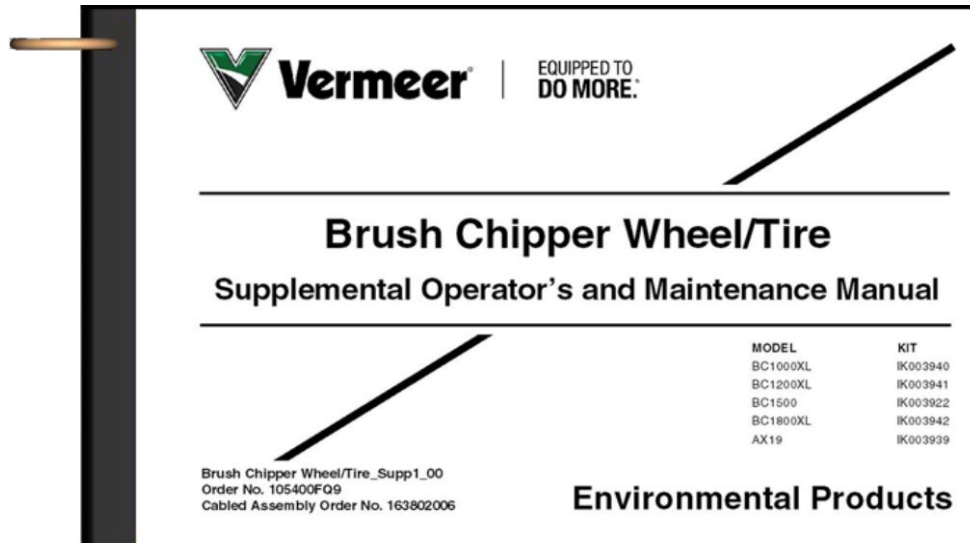

FIGURE 3 Parts List

<u>REF. NO.</u>	<u>PART NO.</u>	<u>DESCRIPTION</u>	<u>IK01 QTY.</u>	<u>IK02 QTY.</u>
1	163802006	BRUSH CHIPPER WHL/TIR SUPPLEMENTAL MANUAL CABLED	1	1
2	105400FQ9	BRUSH CHIPPER WHEEL/TIRE SUPPLEMENTAL MANUAL	1	1
		Kit includes all items in Figure 3 Parts List.		