



# FIELD KIT

## Vermeer Corporation

Environmental  
Pella, IA 50219 USA

<b>FIELD CAMPAIGN KIT#</b>	<b>IK003939</b>	<b>DATE:</b>	<b>16 July 2020</b>
<i>For Dealer Reference: Service Bulletin #SVC2020-094</i>			
<b>AX19 Wheel and Tire Assembly Replacement Kit</b>			

<b>CAMPAIGN TYPE:</b>	Mandatory-Product Safety <b>Dealer Installation Only</b>
<b>CAMPAIGN CATEGORY:</b>	Kit and Bulletin

MACHINE/ ATTACHMENT MODEL(S):	Serial Numbers		Kit Version
	Included	Excluded	
AX19	101, 103–105, 107–112, 114–119, 121–156, 158–173, 175–177, 179–234, 236–241, 243–261, 263–272, 274–282, 284–288, 290–294, 296, 297, 299, 300, 301, 303–316, 318–322, 324–342	Units in IK02, IK03, IK04	<b>IK01: Solid Steel Wheels</b> 8 on 6 1/2", 5/8" studs; <b>Heavy Duty Tires</b> 235/ 75R17.5 LRJ 18 ply; safety sign (English text); tire placard; and <b>English supplemental manual.</b>

<p style="text-align: center;"><b>AX19</b></p>	<p style="text-align: center;"><b>242</b></p>	<p style="text-align: center;"><b>Units in IK01, IK03, IK04</b></p>	<p><b>IK02: Solid Steel Wheels</b> 8 on 6 1/2", 5/8" studs; <b>Heavy Duty Tires</b> 235/75R17.5 LRJ 18 ply; safety sign (no text); tire placard; and <b>English + translated supplemental manual.</b></p>
<p><b>AX19</b> Temporary wheel/tire assembly solution (Assembly PN 163769457) previously installed</p>	<p style="text-align: center;"><b>157, 174, 178, 235, 262, 273, 283, 289, 295, 298, 302, 317, 323</b></p>	<p style="text-align: center;"><b>Units in IK01, IK02, IK04</b></p>	<p><b>IK03:</b> Safety sign, tire specification placard, decal; and <b>English</b> supplemental manual.</p>
<p><b>AX19</b> Temporary wheel/tire assembly solution (Assembly PN 163769457) previously installed</p>	<p style="text-align: center;"><b>NONE (Current location of machines indicate IK04 is not required.)</b></p>	<p style="text-align: center;"><b>Units in IK01, IK02, IK03</b></p>	<p><b>IK04:</b> Safety sign, tire specification placard, decal; and <b>English + Translated</b> supplemental manual.</p>



**PURPOSE: POSSIBLE LOSS OF WHEEL AND RISK OF CRASH.**

Specific wheels (steel rim) with bolt pattern 8 on 6½ inch (165 mm) circle to be used with 5/8” studs provided by a supplier:

- have an incorrect lug nut contact area causing wheel lug nuts to loosen; and/or
- can develop possible cracks causing the tire to lose air pressure.

Both conditions may increase the risk of wheel loss and the risk of a crash. **Death or serious injury** is possible. Property damage may also occur.

This kit has been created to provide the necessary parts and instructions to replace the wheel and tire assembly, install a new safety sign, install a new wheel/tire specification placard decal and provide a Supplemental Operator’s and Maintenance Manual.

**SPECIAL TOOLS AND CONDITIONS:**

- None



**WARNING:** Raised load can shift or fall. Death or serious injury could be possible if struck or crushed by falling load. Never allow anyone under a raised load unless load is securely supported to prevent it from shifting or falling.

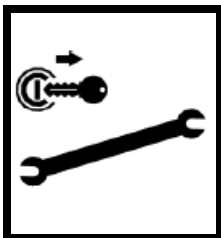

**WARNING:** Failure to use shutdown procedure can result in unexpected hazard(s). Death or serious injury could result due to entanglement, crushing, cutting, or other hazardous contact. Follow Shutdown Procedure after operating, before performing any service or maintenance, and before transporting.

# AX19 SHUTDOWN PROCEDURE

## STOPPING THE MACHINE

**NOTICE:** For your safety and safety of others, use the shutdown procedure before servicing, cleaning, unclogging, inspecting, or transporting the chipper. A variation of this procedure may be used if so instructed within this manual or if an emergency requires it.

Step 1: Move *Feed Control Bar* to NEUTRAL position.

Step 2: Reduce engine speed to LOW PRM.

**NOTICE:** Whenever practical and safe allow engine to idle for 1 to 5 minutes before shutting down after operating at full power. Please consult machine's engine manual for details.

Step 3: Wait for cutter drum to slow.

Step 4: Place *Cutter Drum (Clutch) Lever* in the DISENGAGED position.

Step 5: Shut off remote control if in use.

Step 6: Shut off engine and remove key.

Step 7: Wait for the cutter drum and belt to stop.

**NOTICE:** The cutter drum will continue to turn for a short time after disengagement. Check that cutter drum rotation has stopped by viewing drive sheave through screen (A) on drive belt shield.

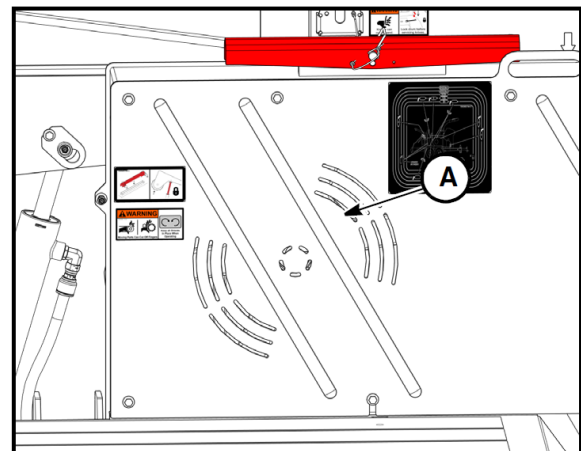
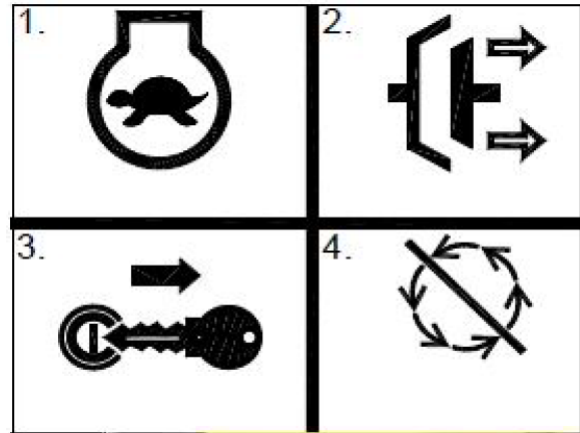

## Procedure: WHEELS, AXLES, AND SUSPENSION MAINTENANCE

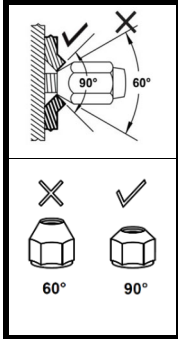

**WARNING:** Incompatible lug nuts may loosen and cause wheel loss.

Use only 5/8-18 lug nuts with a 90° conical taper.

**NOTICE:** Improper or mismatched lug nuts and wheels can cause wheel loss leading to a crash. The conical taper of the lug nuts must properly engage the wheel lug nut seats.

The wheels and axle hubs on this trailer use special 5/8"-18 lug nuts with a 90° conical taper.

Never use incompatible lug nuts, such as those with a 60° taper or a flat face.

Never use wheels intended for 9/16" wheel lugs.

Never use wheels that do not utilize a 90° conical lug nut seat taper.

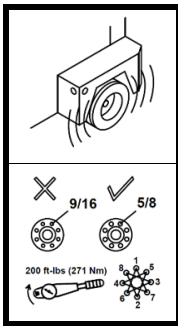

**WARNING:** Incompatible wheels or loose lug nuts can cause wheel loss and machine damage.

Use only wheels that are compatible with 5/8 lug studs and 90° conical nuts. Check lug nut torque regularly.

Properly tighten lug nuts in a star pattern using only hand tools. **DO NOT** use impact wrenches which can damage the lug nuts, lug nut seats, and hub studs. Torque and re-check every 500 miles (800 km). Refer to "Specifications" in the [Maintenance Manual](#).

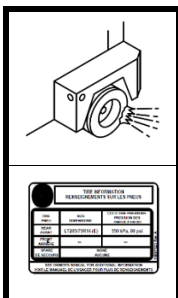

**WARNING:** Improper tire pressure can cause a blowout.

Set cold tire pressure according to tire placard. Check pressure monthly.

**NOTICE:** Under-inflation causes tire damage and can lead to a blowout.

Set the tire air pressure to the value listed on the machine's tire placard, NOT the pressure printed on the sidewall of the tire. Recheck monthly. Tires normally lose 1–2 psi (6.9–13.8 kPa) per month.

Tire pressure can also drop if the temperature outside has dropped significantly, so check more often in cold weather.

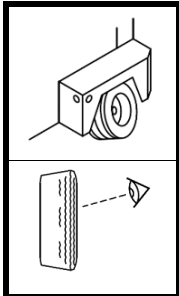

**WARNING:** Worn or damaged suspension can cause premature tire wear and machine damage.

Uneven wear on tires can be an indication of worn suspension or poor alignment.

**NOTICE:** Axle or suspension damage can cause premature tire wear and tire failure, or axle failure.

Have your trailer checked if you suspect misalignment, if your tires have suffered any type of impact, or if you observe uneven tire wear.

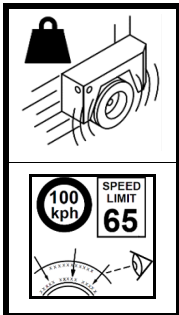

**WARNING:** Avoid overloading or excess speed.

Follow manufacturer's load and speed ratings.

**NOTICE:** High speed and overloading cause tire, axle, and suspension failure.

DO NOT exceed the speed rating of the tires.

DO NOT exceed the load rating of the tires, axles, and suspension.

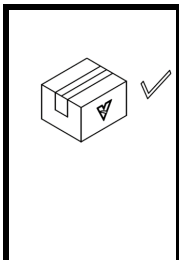

**WARNING:** Always use Vermeer authorized wheels, lug nuts, tires, and suspension components.

Improper or mismatched parts can lead to component failure, resulting in a crash.

## PROCEDURE: WHEEL AND TIRE ASSEMBLY IK01

1. Using a suitable lifting device capable of lifting approximately 13,200 lb (6000 kg), raise machine off ground to allow adequate room to remove tire.
2. Place suitable blocking under trailer frame and remove lifting device.
3. Remove wheel, and 8 wheel nuts from each side of machine. Weight of each wheel is approximately 91 lb (42 kg).
4. Deflate tire or remove tire from wheel.
5. The removed used tires may be retained in your **used** tire inventory or disposed of. Cost of tire removal and disposal is included in labor hours.
6. Discard wheel nuts so they can never be used or sold for any purpose.
7. Torch cut wheels across lug nut area.
8. Take photo(s) of the destroyed wheels and attach to campaign warranty claim.
9. Install supplied wheel assemblies **(1)** and clamp rings **(2)** on axle using 32 wheel nuts **(3)**. Weight of each wheel is approximately 91 lb (42 kg). Torque wheel nuts in a star pattern to 200 ft-lb (271 Nm).
10. Check tire pressure to be at 85 psi (590 kPa).

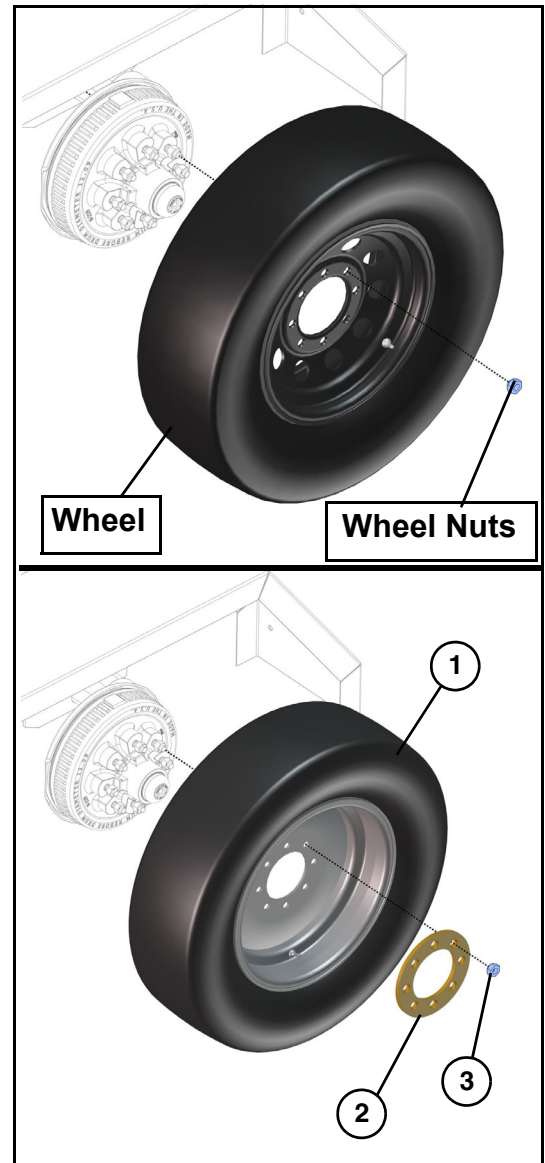

11. On left side of the machine, apply new supplied wheel and tire warning decal (4) to the side of the hydraulic tank and tire information decal (5) to front, left frame, next to serial tag.
12. On right side of the machine, apply new supplied wheel and tire warning decal (4) to side of belt guard.
13. Provide additional Supplemental Manual to owner.
14. Install operator's manual with ring in manual storage box.

**4**

**WARNING**

IK00339 Rev A

Wheel loss, tire blowout, and loss of vehicle control can occur, causing death or serious injury.

Incompatible lug nuts may loosen and cause wheel loss.

Incompatible wheels or loose lug nuts can cause wheel loss.

Use only 5/8-18 nuts with a 90° conical taper.

Use only proper wheels. Check torque regularly.

60° 90°

208 R-80 (211 mm)

9/16 5/8

Proper tire pressure can cause a blowout.

Worn or damaged suspension can cause premature tire wear and machine damage.

Avoid overloading or excess speed.

Set cold tire pressure according to the placard. NOT maximum pressure printed on sidewall.

Uneven wear on tires is an indication of worn suspension or poor alignment.

Always follow manufacturer's load and speed ratings.

100 kph 65

ALWAYS use Vermeer authorized wheels, lug nuts, tires, and suspension components.

**5**

**TIRE INFORMATION**  
RENSEIGNEMENTS SUR LES PNEUS

TIRE PNEU	SIZE DIMENSIONS	COLD TIRE PRESSURE PRESSION DES PNEUS A FROID
REAR AVANT	235/75R17.5 HJ	586 kPa, 85 psi
FRONT ARRIÈRE	-	-
SPARE DE SECOURS	NONE AUCUNE	-

SEE OWNER'S MANUAL FOR ADDITIONAL INFORMATION  
VOIR LE MANUEL DE L'USAGER POUR PLUS DE RENSEIGNEMENTS

IK00339 Rev A



## PROCEDURE: WHEEL AND TIRE ASSEMBLY IK02

1. Using a suitable lifting device capable of lifting approximately 13,200 lb (6000 kg), raise machine off ground to allow adequate room to remove tire.
2. Place suitable blocking under trailer frame and remove lifting device.
3. Remove wheel, and 8 wheel nuts from each side of machine. Weight of each wheel is approximately 91 lb (42 kg).
4. Deflate tire or remove tire from wheel.
5. The removed used tires may be retained in your **used** tire inventory or disposed of. Cost of tire removal and disposal is included in labor hours.
6. Discard wheel nuts so they can never be used or sold for any purpose.
7. Torch cut wheels across lug nut area.
8. Take photo(s) of the destroyed wheels and attach to campaign warranty claim.
9. Install supplied wheel assemblies **(1)** and clamp rings **(2)** on axle using 32 wheel nuts **(3)**. Weight of each wheel is approximately 91 lb (42 kg). Torque wheel nuts in a star pattern to 200 ft-lb (271 Nm).
10. Check tire pressure to be at 85 psi (590 kPa).

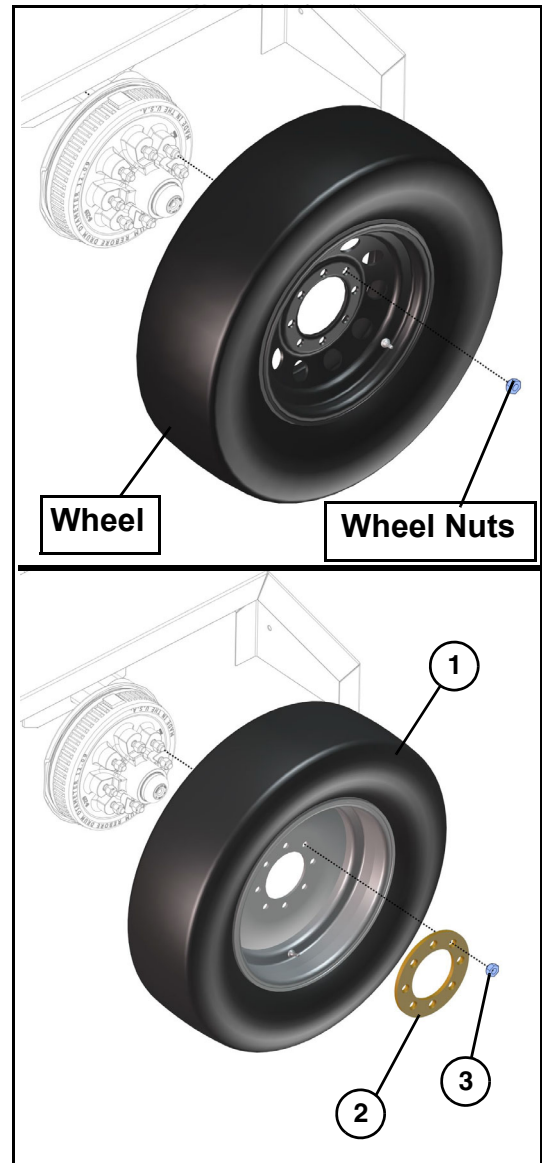

11. On left side of the machine, apply new supplied wheel and tire warning decal (4) to the side of the hydraulic tank and tire information decal (5) to front, left frame, next to serial tag.
12. On right side of the machine, apply new supplied wheel and tire warning decal (4) to side of belt guard.
13. Provide additional Supplemental Manual to owner.
14. Install operator's manual with ring in manual storage box.

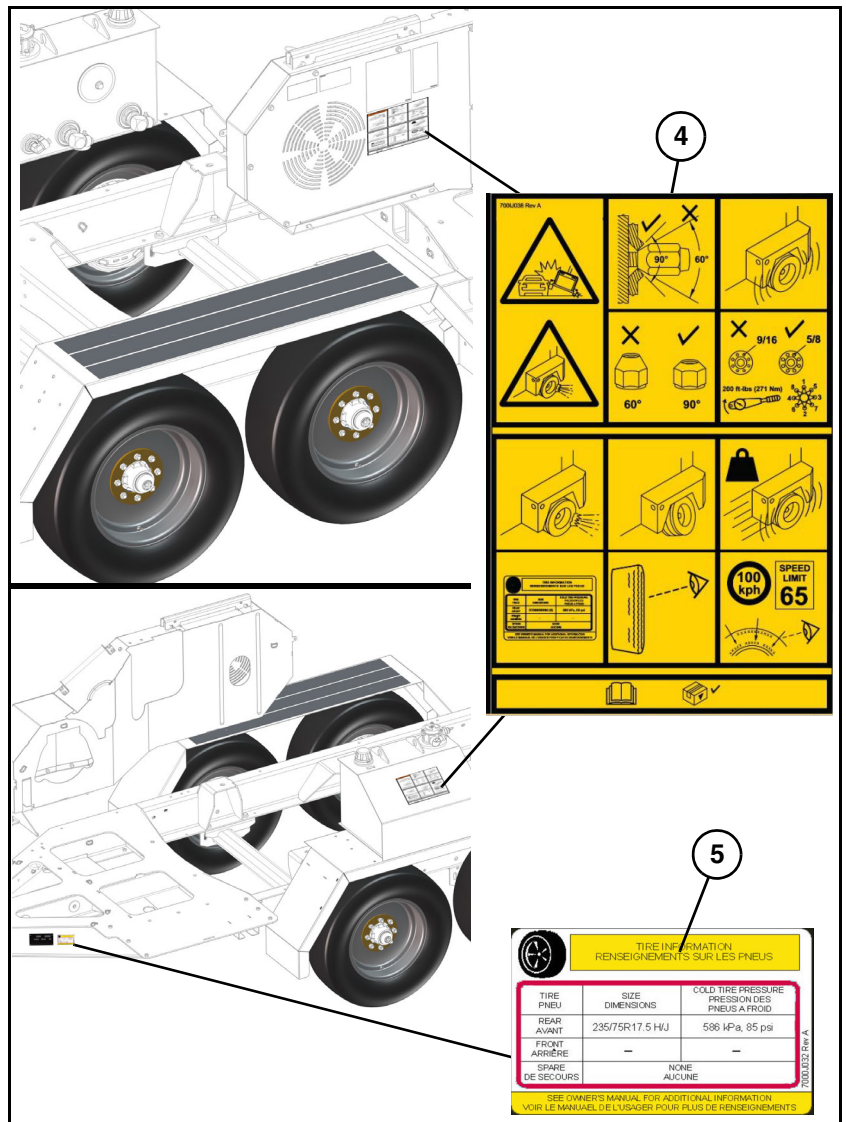

# PROCEDURE: SAFETY SIGN, TIRE SPECIFICATION PLACARD, MANUAL INSTALLATION IK03

1. Machines with wheel and tire assembly (PN 163759457), previously installed must have new decals installed. On the left side of the machine, apply new supplied wheel and tire warning decal (1) to the side of the hydraulic tank and tire information decal (2) to front, left frame, next to serial tag.
2. On the right side of the machine, apply new supplied wheel and tire warning decal (1) to the side of the belt guard.
3. Provide additional Supplemental Manual to owner.
4. Installed operator's manual with ring in manual storage box.

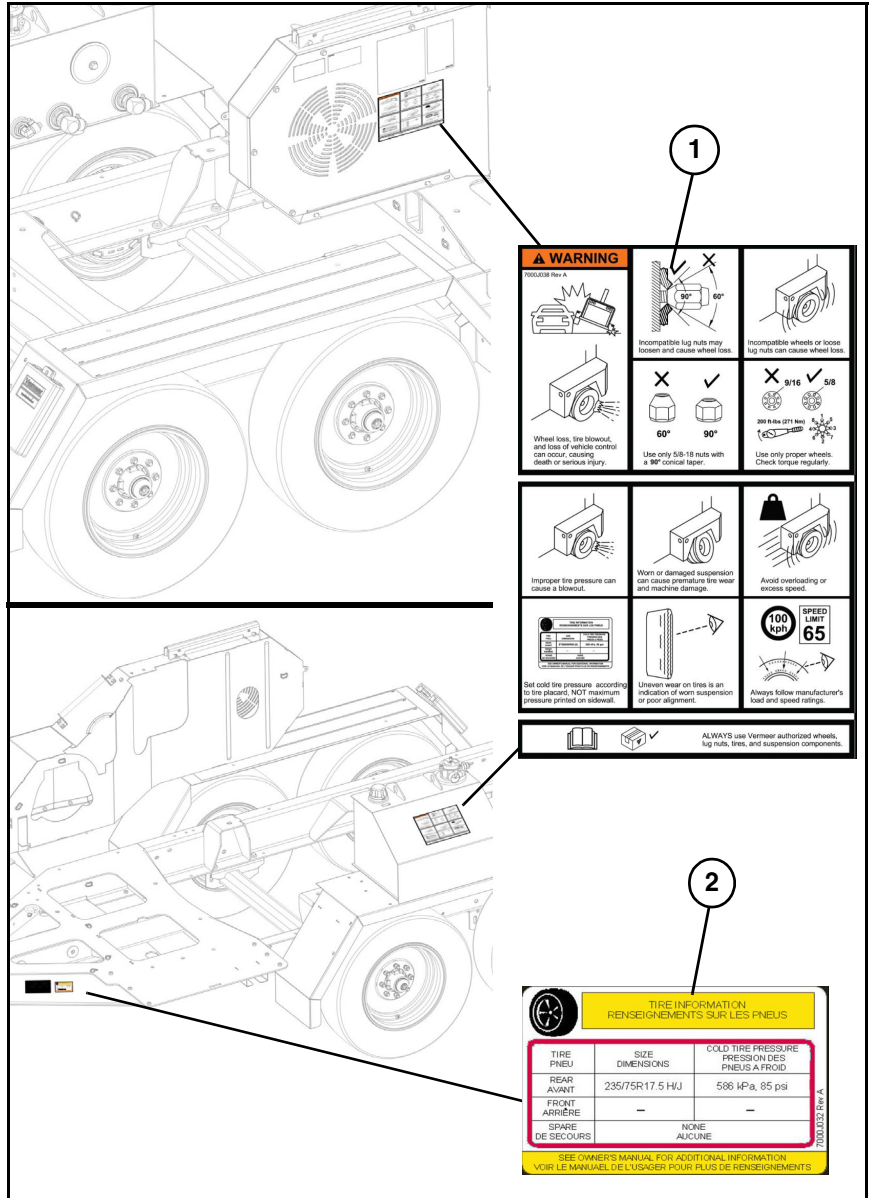

# PROCEDURE: SAFETY SIGN, TIRE SPECIFICATION PLACARD, MANUAL INSTALLATION IK04

1. Machines with wheel and tire assembly (PN 163759457), previously installed must have new decals installed. On the left side of the machine, apply new supplied wheel and tire warning decal (1) to the side of the hydraulic tank and tire information decal (2) to front, left frame, next to serial tag.
2. On the right side of the machine, apply new supplied wheel and tire warning decal (1) to the side of the belt guard.
3. Provide additional Supplemental Manual to owner.
4. Installed operator's manual with ring in manual storage box.

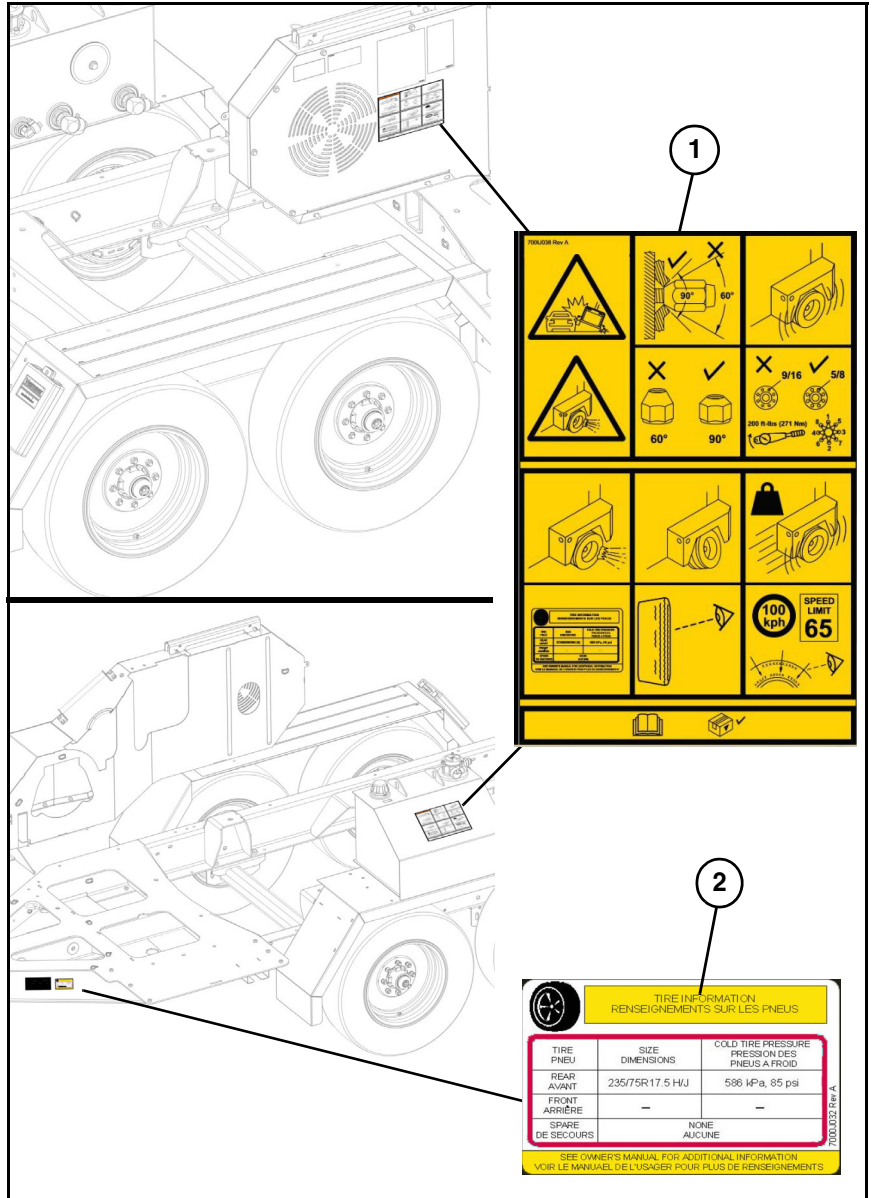

**Figure 1**

UNIT OWNER COPY:  
Insert into Parts Manual  
for future reference

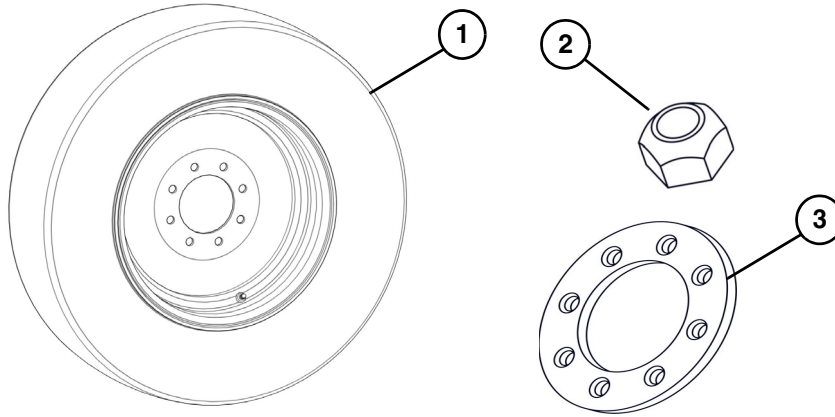

**FIGURE 1 Parts List**

<b>REF. NO.</b>	<b>PARTNO.</b>	<b>DESCRIPTION</b>	<b>IK01 QTY.</b>	<b>IK02 QTY.</b>	<b>IK03 QTY.</b>	<b>IK04 QTY.</b>
1	163713905	HEAVY DUTY - WHEEL ASSEMBLY 235/75R17.5 H/J; 5/8 S	4	4		
2	116621009	WHEEL NUT 5/8in 18 CONE 90°	32	32		
3	215490049	CLAMP RING	4	4		
		Kit includes all items in Figure 1 Parts List.				

UNIT OWNER COPY:  
Insert into Parts Manual  
for future reference

Figure 2

**WARNING**  
7000J038 Rev A

Incompatible lug nuts may loosen and cause wheel loss.

Incompatible wheels or loose lug nuts can cause wheel loss.

Wheel loss, tire blowout, and loss of vehicle control can occur, causing death or serious injury.

Use only 5/8-18 nuts with a 90° conical taper.

Use only proper wheels. Check torque regularly.

200 ft-lbs (271 Nm)

100 kph SPEED LIMIT 65

**TIRE INFORMATION**  
RENSEIGNEMENTS SUR LES PNEUS

TIRE PNEU	SIZE DIMENSIONS	COLD TIRE PRESSURE PRESSION DES PNEUS A FROID
REAR AVANT	235/75R17.5 H/J	586 kPa, 85 psi
FRONT ARRIERE	-	-
SPARE DE SECOURS	NONE AUCUNE	

SEE OWNER'S MANUAL FOR ADDITIONAL INFORMATION  
VOIR LE MANUAEL DE L'USAGER POUR PLUS DE RENSEIGNEMENTS

ALWAYS use Vermeer authorized wheels, lug nuts, tires, and suspension components.

FIGURE 2 Parts List

REF. NO.	PART NO.	DESCRIPTION	IK01 QTY.	IK02 QTY.	IK03 QTY.	IK04 QTY.
1	7000J038	DECAL-WARNING, WHEEL & TIRE	2		2	
2	7001J038	DECAL-WARNING, WHEEL & TIRE		2		2
3	7000J032	DECAL-TIRE INFORMATION	1	1	1	1
Kit includes all items in Figure 2 Parts List.						

**Figure 3**

**UNIT OWNER COPY:**  
Install manual with ring as described in procedures above. Provide additional supplemental manual to owner for future reference.

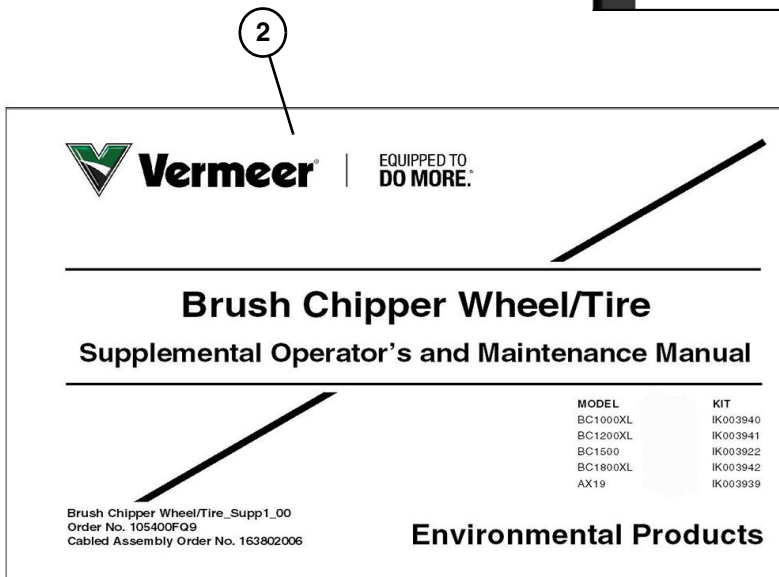
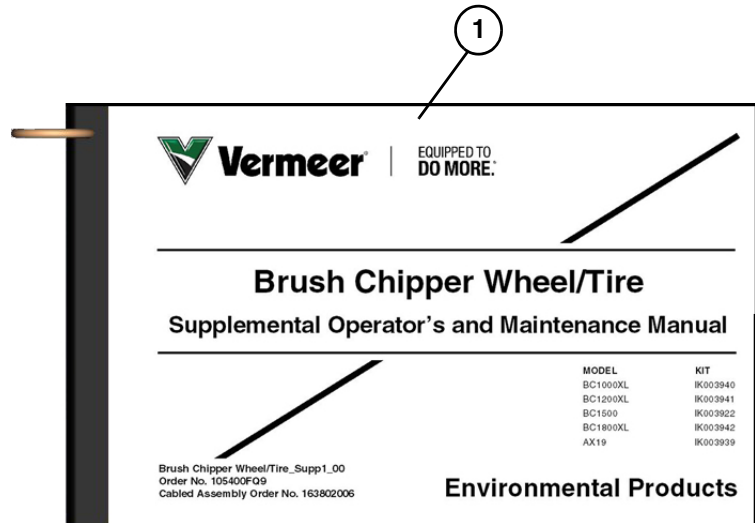

FIGURE 3 Parts List						
REF. NO.	PART NO.	DESCRIPTION	IK01 QTY.	IK02 QTY.	IK03 QTY.	IK04 QTY.
1	163802006	BRUSH CHIPPER WHL/TIR SUPPLEMENTAL MANUAL CABLED	1	1	1	1
2	105400FQ9	BRUSH CHIPPER WHEEL/TIRE SUPPLEMENTAL MANUAL	1	1	1	1
Kit includes all items in Figure 3 Parts List.						