

ALA2 Delivery Stop/Recall Campaign - Reworking/replacing service cover of fuel pump

Vehicle type: **Macan/Macan S/Macan GTS/Macan Turbo**

Model Year: **As of 2014 up to 2019**

Subject: **Service cover of fuel pump**

Situation: **Due to unfavourable tolerances and exertion of an external force, there is a possibility that contact could occur between the underside of the service cover and the fuel supply port at the filter flange of the fuel pump on the affected vehicles.**

If the above-mentioned conditions occur and if an external force is applied (e.g. through use of the rear seat system), the fuel supply port can become damaged over the service life of the vehicle resulting in a fuel leak. In such cases, customers could perceive the odour of fuel.

Remedial action:

- Remove the service cover of the fuel pump. Depending on the parts availability of the service cover, either rework the service cover or replace the service cover to avoid possible contact between the underside of the service cover and the fuel supply port.

- Before fitting the service cover again, check the fuel supply port at the filter flange of the fuel pump for damage (cracks):

- If the fuel supply port is **damaged**: replace the filter flange of the fuel pump and affix a protective film to the replacement piece.

- If the fuel supply port is **not damaged**: check whether a protective film is already affixed to the filter flange of the fuel pump. If there is no protective film, affix it later.

Affected Vehicles: Only vehicles assigned to the campaign (see also PCSS Vehicle Information).

Installation
position:

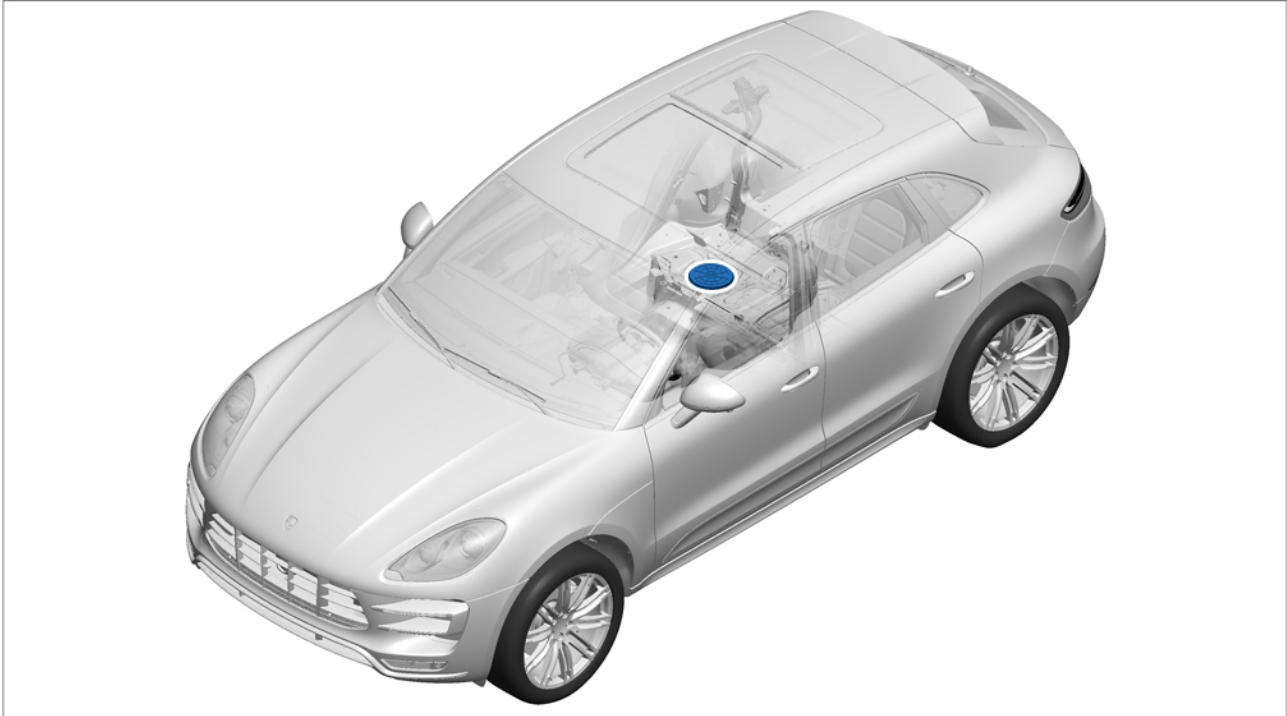

Installation position of service cover of fuel pump

Required parts and materials



Information

Before ordering the necessary parts, **note the following points:**

- Depending on part availability, the service cover of the fuel pump must be either reworked or replaced during the campaign. In the case of restricted availability of the new service cover, the service cover installed in the vehicle must be reworked. In this case, no new service cover is required. The resulting scopes are described in the section Warranty processing ⇒ *Technical Information 'Warranty processing'*.
- The protective film is only required if no protective film has been affixed to the filter flange of the fuel pump or if the filter flange is being replaced.

Part No.:

Part No.	Designation – Use	Qty.
V04015005A	⇒ Service cover – filter flange of fuel pump	1 ea.

Additional parts required only in certain cases:

00004330404	⇒ Protective film – Filter flange of fuel pump	1 ea. (only if required)
9A791913340	⇒ Seal - Filter flange of fuel pump	1 ea. (only if required)
8R0919679E	⇒ Flange with fuel filter – Vehicles without auxiliary heater (I-no. 9M0)	1 ea. (only if required)
or		
8R0919679D	⇒ Flange with fuel filter – Vehicles with auxiliary heater (I-no. 9M1/9M9)	1 ea. (only if required)

Materials: Plastic cleaner

Required tools

Tools:

- Plastic wedge
- Torch
- inset

Tools required for reworking the service cover:

- **Hot-Air Blower**
- Commercially available grinder or cutting tool
- Commercially available scribe

Additional tools required - **only** required if the filter flange of the fuel pump must be replaced:

- **9705/3 - Connecting line**
- **Fuel extractor**
- **T10202 - Wrench**
- **9900 - PIWIS Tester 3**
- Battery charger (current rating of at least 40 A), e.g. **battery charger 45A**

Preparatory work

Procedure:

- 1 Switch off ignition and remove ignition key.
- 2 Remove rear seat ⇒ *Workshop Manual '724819 Removing and installing rear seat'*.
- 3 Fold protective mat ⇒ *Service cover of fuel pump -1-* aside and open service cover ⇒ *Service cover of fuel pump -2-*.

To do this, carefully unclip the cover \Rightarrow *Service cover of fuel pump -2-* in the area with recessed circles \Rightarrow *Service cover of fuel pump -3-* one after the other using a plastic wedge \Rightarrow *Service cover of fuel pump -4-*.

- 4 Depending on whether the service cover is reworked or replaced, go to the next step as described below.

- If the service cover is **reworked**, continue with \Rightarrow *Technical Information '724819 Reworking service cover of fuel pump'*.
- If the service cover is **replaced**, continue with \Rightarrow *Technical Information '724819 Checking filter flange of fuel pump'*.

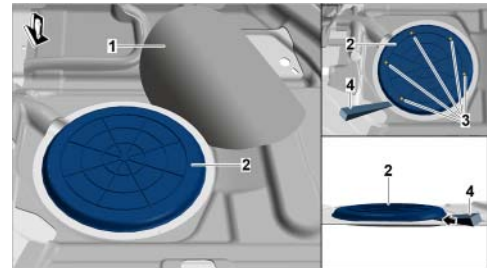

Service cover of fuel pump

Reworking service cover of fuel pump

- Procedure:
- 1 Use a hot-air blower to heat a commercially available scribe and use it to carefully invalidate the existing position marking (Δ) on the top of the service cover \Rightarrow *Service cover marking -1-* with an "X".
Make sure that the marking depth created with the warm scribe is **max. 1 mm**.
 - 2 Carefully place a new position marking (Δ) \Rightarrow *Service cover marking -2-* on the top of the service cover using the warm scribe.
Position of the new marking: 90 mm or 60° away from the old marking anti-clockwise \Rightarrow *Service cover marking -1-*.

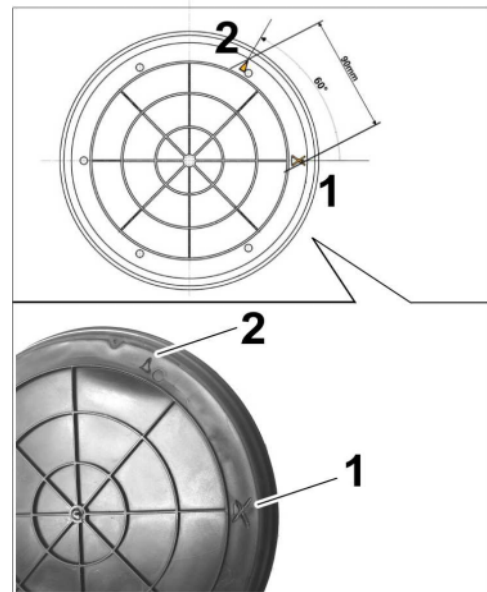

Service cover marking

WARNING

Foreign bodies flying around and arising from dust during grinding, drilling and milling

- Risk of eye injuries
- Irritation to respiratory system

\Rightarrow Wear personal protective equipment consisting of protective goggles, breathing mask and protective gloves.

NOTICE

Reworking service cover

- **Damage to service cover and sealing lip**
- ⇒ **Do not remove rib with positioning lug completely**
- ⇒ **Do not damage sealing lip during grinding**

- 3 On the underside of the service cover, use a commercially available grinder ⇒ *Underside of service cover -1-* to take the rib with the positioning lug ⇒ *Underside of service cover -arrow-* down to **approx. 1 mm in height**. Make sure not to take down the rib completely and do not damage the sealing lip ⇒ *Underside of service cover -2-*.



Underside of service cover

Then, continue with ⇒ *Technical Information '724819 Checking filter flange of fuel pump'*.

Checking filter flange of fuel pump

- Procedure: 1 Expose filter flange of the fuel pump.

While doing this, move the lines aside as far as possible **without** disconnecting the electric plug connections.

- If **a protective film** is already applied to the filter flange of the fuel pump ⇒ *Fuel filter flange with protective film*, continue with **Step 6**.
- If there is **no** protective film applied to the filter flange of the fuel pump, continue with **Step 2**.

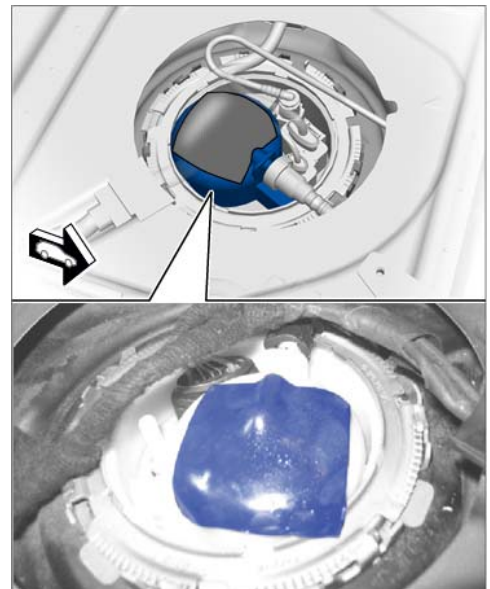

Fuel filter flange with protective film

- 2 Clean the top of the filter flange of the fuel pump using a cleaning cloth and a suitable plastic cleaner ⇒ *Cleaning top of filter flange of fuel pump.*



Information

Do **not** spray plastic cleaner directly on the filter flange, but only on the cleaning cloth you are using.

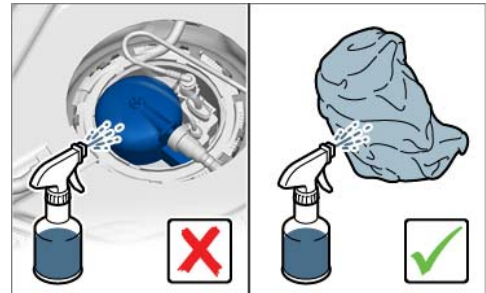

Cleaning top of filter flange of fuel pump

- 3 Check the **top of the filter flange** of the fuel pump ⇒ *Checking filter flange of fuel pump -A-* as well as the **fuel supply port** ⇒ *Checking filter flange of fuel pump -B-* for **cracks** ⇒ *Checking filter flange of fuel pump -Arrows-* or **distinct yellow discolouration** using a commercially available magnifying glass and a torch or hand lamp.

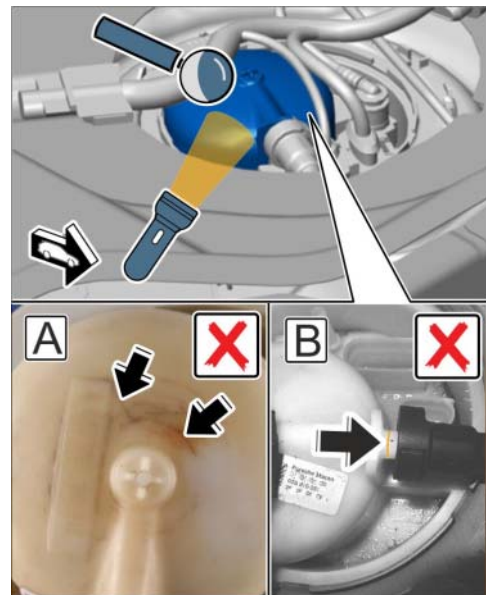

Checking filter flange of fuel pump

Actual condition	Next steps
No cracks and no yellow discolouration found	Continue with Step 5 – Affix protective film.
Cracks or yellow discolouration present on the top of the filter flange or on the fuel supply port	Continue with Step 4 – Replace flange with integrated fuel filter and then affix protective film.

- 4 Replace flange of the fuel pump with integrated fuel filter ⇒ *Workshop Manual '724819 Removing and installing fine fuel filter'*.



Information

The protective film must be affixed to the top of the flange **only when the fuel pump is installed and the locking ring is fitted** in order to ensure that no protective film gets between the filter flange of the fuel pump and the locking ring.

- 5 Affix protective film to the top of the filter flange of the fuel pump as shown in the illustration ⇒ *Affix protective film -marked area-* and remove any bubbles.

Continue with ⇒ *Technical Information '724819 Concluding work'*.

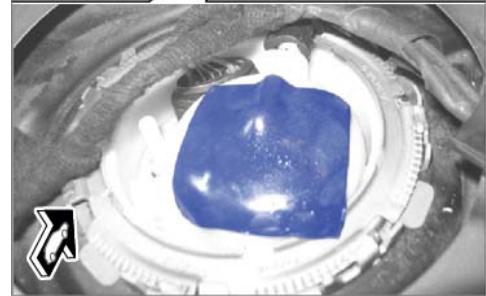
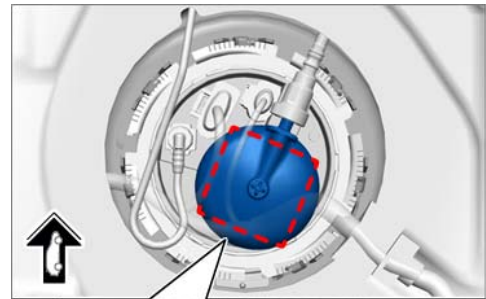

Affix protective film

- 6 Clean the area of the fuel supply port on the filter flange of the fuel pump ⇒ *Area of fuel supply port -circle-* using a cleaning cloth and a suitable plastic cleaner.

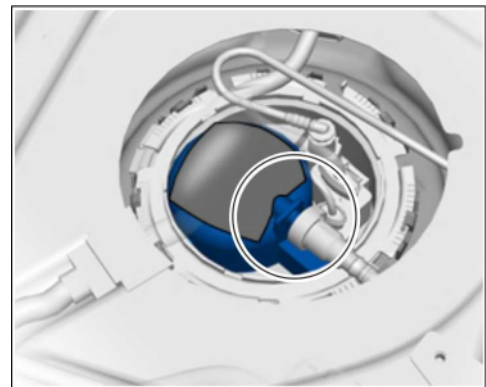

Area of fuel supply port

- 7 Check the area of the fuel supply port for **cracks**
⇒ *Checking supply port of fuel pump -arrow-*
using a commercially available magnifying glass
and a pocket or hand lamp.

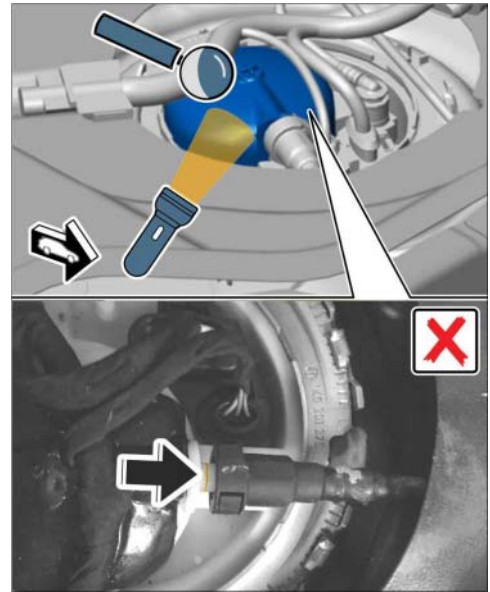

Checking supply port of fuel pump

Actual condition	Next steps
No cracks present	Continue with ⇒ <i>Technical Information '724819 Concluding work'</i>
Cracks present	Continue with Step 8 – Replace flange with integrated fuel filter and then affix protective film.

- 8 Replace flange of the fuel pump with integrated fuel filter ⇒ *Workshop Manual '724819 Removing and installing fine fuel filter'*.



Information

The protective film must be affixed to the top of the flange **only when the fuel pump is installed and the locking ring is fitted** in order to ensure that no protective film gets between the filter flange of the fuel pump and the locking ring.

- 9 Affix protective film to the top of the filter flange of the fuel pump as shown in the illustration ⇒ *Affix protective film -marked area-* and remove any bubbles.

Continue with ⇒ *Technical Information '724819 Concluding work'*.

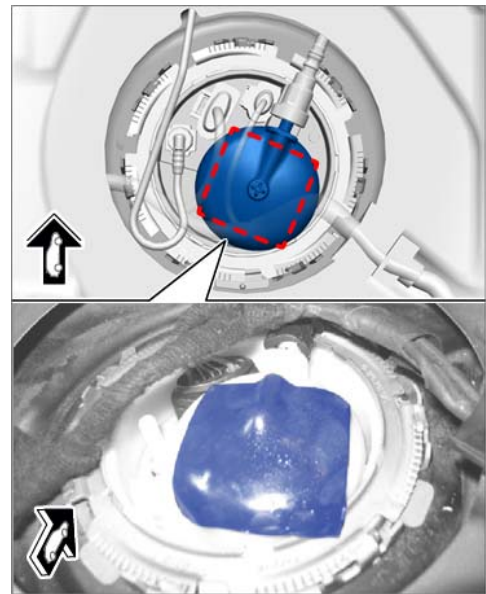

Affix protective film

Concluding work

- Procedure:
- 1 Install the service cover ⇒ *Installing service cover of fuel pump -1-*.
When doing so, make sure that the position marking on the service cover is at the same position as the marking on the body panel of the vehicle. In the case of a reworked service cover, position the previously re-affixed marking at the correct position ⇒ *Installing service cover of fuel pump -arrow-*.
Then fold up the protective mat ⇒ *Installing service cover of fuel pump -2-*.
 - 2 Install rear seat ⇒ *Workshop Manual '724819 Removing and installing rear seat'*.
 - 3 Enter the campaign in the Warranty and Maintenance booklet.

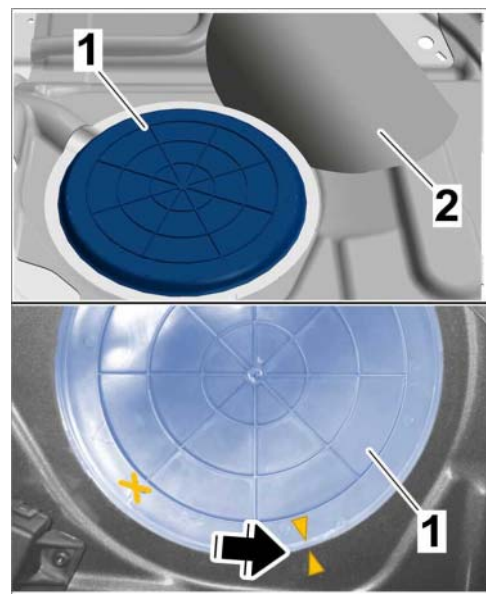

Installing service cover of fuel pump

Warranty processing



Information

The specified working times were determined specifically for carrying out this campaign and include all necessary preliminary and subsequent work.
The working times may differ from the working times published in the Labour Operation List in PCSS.

Scope 1: **Replacing** service cover of fuel pump

- The fuel supply port on the filter flange of the fuel pump has no damage and does not have to be replaced.

Working time:

Replacing service cover of fuel pump

Labor time: **64 TU**

Includes: Removing and installing rear seat
Detaching carpet
Removing and installing cover of fuel pump
Cleaning and checking filter flange of fuel pump
Affixing protective film to filter flange of fuel pump (if required)

Parts required:

V04015005A	Service cover	1 ea.
00004330404	Protective film	1 ea. (only if required)

Invoicing: ⇒ Damage Code ALA2 99 000, Repair Code 2

Scope 2: **Reworking** service cover of fuel pump

- The fuel supply port on the filter flange of the fuel pump has no damage and does not have to be replaced.

Working time:

Reworking service cover of fuel pump

Labor time: **71 TU**

Includes: Removing and installing rear seat
Detaching carpet
Removing and installing cover of fuel pump
Cleaning and checking filter flange of fuel pump
Affixing protective film to filter flange of fuel pump (if required)

Parts required:

00004330404	Protective film	1 ea. (only if required)
-------------	-----------------	-----------------------------

Invoicing: ⇒ Damage Code ALA2 99 000, Repair Code 1

Scope 3: **Replacing** service cover and **replacing filter flange of fuel pump**

- Vehicles without auxiliary heater (I-no. 9M0)

Working time:

Replacing service cover and replacing filter flange of fuel pump

Labor time: **136 TU**

Includes: Removing and installing rear seat
 Detaching carpet
 Removing and installing cover of fuel pump
 Cleaning and checking filter flange of fuel pump
 Disconnecting and connecting battery
 Draining and filling fuel
 Removing and installing fuel pump
 Affixing protective film to filter flange of fuel pump

Parts required:

V04015005A	Service cover	1 ea.
00004330404	Protective film	1 ea.
9A791913340	Seal	1 ea.
8R0919679E	Flange with fuel filter	1 ea.

Invoicing: ⇒ Damage Code ALA2 99 000, Repair Code 2

Scope 4:

**Replacing service cover and replacing filter flange of fuel pump
 - Vehicles with auxiliary heater (I-no. 9M1 / 9M9)**

Working time:

Replacing service cover and replacing filter flange of fuel pump

Labor time: **136 TU**

Includes: Removing and installing rear seat
 Detaching carpet
 Removing and installing cover of fuel pump
 Cleaning and checking filter flange of fuel pump
 Disconnecting and connecting battery
 Draining and filling fuel
 Removing and installing fuel pump
 Affixing protective film to filter flange of fuel pump

Parts required:

V04015005A	Service cover	1 ea.
00004330404	Protective film	1 ea.
9A791913340	Seal	1 ea.
8R0919679D	Flange with fuel filter	1 ea.

Invoicing: ⇒ Damage Code ALA2 99 000, Repair Code 2

Scope 5:

**Reworking service cover and replacing filter flange of fuel pump
– Vehicles without auxiliary heater (I-no. 9M0)**

Working time:

Reworking service cover and replacing filter flange of fuel pump

Labor time: **143 TU**

Includes: Removing and installing rear seat
Detaching carpet
Removing and installing cover of fuel pump
Cleaning and checking filter flange of fuel pump
Disconnecting and connecting battery
Draining and filling fuel
Removing and installing fuel pump
Affixing protective film to filter flange of fuel pump

Parts required:

00004330404	Protective film	1 ea.
9A791913340	Seal	1 ea.
8R0919679E	Flange with fuel filter	1 ea.

Invoicing: ⇒ Damage Code ALA2 99 000, Repair Code 2

Scope 6:

**Reworking service cover and replacing filter flange of fuel pump
– Vehicles with auxiliary heater (I-no. 9M1 / 9M9)**

Working time:

Reworking service cover and replacing filter flange of fuel pump

Labor time: **143 TU**

Includes: Removing and installing rear seat
Detaching carpet
Removing and installing cover of fuel pump
Cleaning and checking filter flange of fuel pump
Disconnecting and connecting battery
Draining and filling fuel
Removing and installing fuel pump
Affixing protective film to filter flange of fuel pump

Parts required:

00004330404	Protective film	1 ea.
-------------	-----------------	-------

9A791913340	Seal	1 ea.
8R0919679D	Flange with fuel filter	1 ea.

Invoicing: ⇒ Damage Code ALA2 99 000, Repair Code 2

Information: **Scopes 7 to 9 only valid for USA market:**

Scope 7: **Replacing** service cover of fuel pump

- The fuel supply port on the filter flange of the fuel pump has no damage and does not have to be replaced.

Working time:		
Replacing service cover of fuel pump		Labor time: 64 TU
Includes:	Removing and installing rear seat Detaching carpet Removing and installing cover of fuel pump Cleaning and checking filter flange of fuel pump Affixing protective film to filter flange of fuel pump (if required)	
Parts required:		
V04015005B	Service cover	1 ea.
00004330404	Protective film	1 ea. (only if required)
Invoicing: ⇒ Damage Code ALA2 99 000, Repair Code 2		

Scope 8: **Replacing** service cover and **replacing filter flange of fuel pump**
– Vehicles without auxiliary heater (I-no. 9M0)

Working time:		
Replacing service cover and replacing filter flange of fuel pump		Labor time: 136 TU
Includes:	Removing and installing rear seat Detaching carpet Removing and installing cover of fuel pump Cleaning and checking filter flange of fuel pump Disconnecting and connecting battery Draining and filling fuel Removing and installing fuel pump Affixing protective film to filter flange of fuel pump	

Parts required:

V04015005B	Service cover	1 ea.
00004330404	Protective film	1 ea.
9A791913340	Seal	1 ea.
8R0919679E	Flange with fuel filter	1 ea.

Invoicing: ⇒ Damage Code ALA2 99 000, Repair Code 2

Scope 9:

**Replacing service cover and replacing filter flange of fuel pump
– Vehicles with auxiliary heater (I-no. 9M1 / 9M9)**

Working time:

Replacing service cover and replacing filter flange of fuel pump

Labor time: **136 TU**

Includes:

- Removing and installing rear seat
- Detaching carpet
- Removing and installing cover of fuel pump
- Cleaning and checking filter flange of fuel pump
- Disconnecting and connecting battery
- Draining and filling fuel
- Removing and installing fuel pump
- Affixing protective film to filter flange of fuel pump

Parts required:

V04015005B	Service cover	1 ea.
00004330404	Protective film	1 ea.
9A791913340	Seal	1 ea.
8R0919679D	Flange with fuel filter	1 ea.

Invoicing: ⇒ Damage Code ALA2 99 000, Repair Code 2