

Subject: Replacement of the Side Windows
Emergency Exit Labels on TS35 Vehicles

Bulletin Type: Service Campaign Recall

Bulletin No: TS35-SR-1901

PQR No:

Rev No:

Ref. No: 700003687

Vehicle Model: TS35

Flat Rate Time / Code: 15 min

Date of issue: 10.10.2019

Modify Before: 10.10.2020

What to do with off coming parts:

- Scrap
- Return
- Use with additional parts
- On consignment
- No off coming parts

**What to do with outstanding parts of
previous revision:**

- Scrap
- Return
- Use with additional parts
- On consignment
- No outstanding parts

Description of the modification:

This bulletin explains the steps of replacement of
emergency exit window instruction labels.

Bulletin Responsible: Turan Diril

Published & Approved By: Sibel Perçin

SAFETY INSTRUCTIONS

1. Mechanical Requested Dress Code



WARNING:

- Dress properly to avoid personal injury and damage to the vehicle

- ✓ Always wear protective clothing
- ✓ Do not wear any worn or loose-fitting clothing
- ✓ Remove jewelry before starting to work
- ✓ In case of long hair, use hairnet
- ✓ The illustration on the left shows some of the correct and incorrect clothing
- ✓ Sharp edged items should be avoided in order not to scratch vehicle (i.e. belts, watches, necklace)

2. Protect Seats when Mechanic Starts Working



- ✓ Seats, trimming, upholstery stuff and carpeting should be protected with appropriate coverings.

3. Welding on the Chassis

- a. Always disconnect the batteries (starting with the negative lead).
- b. Disconnect the connectors of electrical and electronic equipment (electronic control units, sensors and actuators) if they are less than 2 meters away from the chassis part to be welded or the earth terminal of the welding equipment.
- c. The earth terminal should never be attached to vehicle components such as engine, axles and springs. Arcing on these parts is not permitted, because of the risk of damage to bearings, springs, etc.
- d. The earth terminal must make good contact and be placed as close as possible to the part to be welded.
- e. Plastic pipes, rubber parts and parabolic springs should be well protected against welding spatter and temperatures higher than 70°.
- f. The contact switch must not be in the accessory or contact position. The contact key should be removed.
- g. Reconnect in reversed order of disconnecting. Ensure that a good earth connection is made between chassis, engine and cab.

INCLUDED PARTS LIST

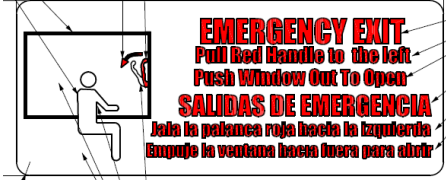
No	Part No	Part Name	Picture	Qty	Unit of Measure
1	9050-706Y	LABEL, EMERGENCY EXIT WINDOW (ENG-ISP)	 <p>EMERGENCY EXIT Pull Red Handle to the left Push Window Out To Open SALIDAS DE EMERGENCIA Jala la palanca roja hacia la izquierda Empuje la ventana hacia fuera para abrir</p>	6	Pieces

EXCLUDED PARTS LIST

No	Part No	Part Name	Picture	Qty	Unit of Measure
1	RP350191Y	LABEL, EMERGENCY EXIT	 <p>Emergency Exit Issue de secours Salida de emergencia</p>	6	Pieces

TECHNICAL INSTRUCTIONS

1. There are 3 emergency exit windows on each side of the vehicle and each emergency exit has one handle to open the window. The label must be changed which is located by the window as shown in the below picture (See Figure-1)

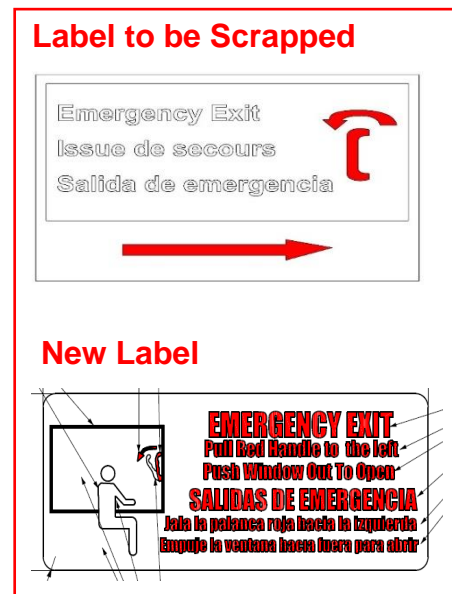

Figure-1

2. Remove all labels and stick new labels by means of the given dimensions in the picture below (See Figure-2)

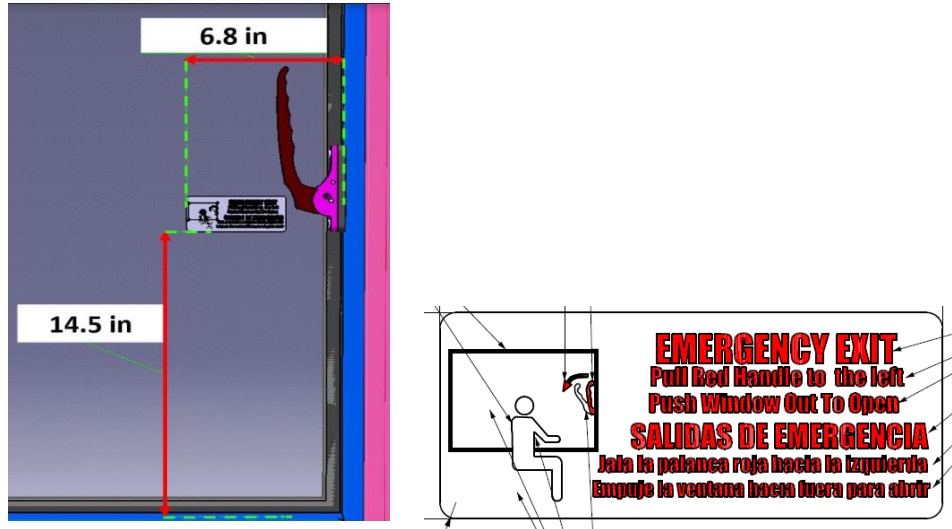

Figure-2

LABOUR RATE BREAKDOWN

Application	Time
Tool preparations	5 min
Removing and Sticking Process of the Label	10 min
Total	15 min