



## Safety Recall Action Notice SB567 Issue 1 - 11.2019

Subject: Gear Linkage Clamp Assembly Replace				
Notice Number	Models Affected	VIN Range		Markets Affected
567	Speed Triple RS	From	898139	US and Canada Markets Only
		Up to	970149	

### Background Information

Internal investigations have identified a need to replace the gear linkage clamp assembly on the above model.

Dealers are required to replace the gear linkage clamp assembly as described in the procedure below.

### Customer Contact Instructions

#### Notice

STOP DELIVERY OF AFFECTED MOTORCYCLES IMMEDIATELY.

DO NOT deliver a motorcycle affected by this Safety Recall Action Notice to a customer until you have completed, or confirmed completion of, the procedures described in this Safety Recall Action Notice.

Delivering a motorcycle subject to an outstanding Safety Recall Action Notice may contravene local or national laws in your market, territory or country.

Triumph Motorcycles America Ltd must instigate a Safety Recall Action in accordance with the national recall code of practice. For vehicles in dealer stock, the safety recall MUST be actioned before delivery to the customer.

Dealers are to prioritise repair of customer owned motorcycles before any unsold motorcycles.

### Identification of Affected Motorcycles

Speed Triple RS models listed in the VIN range above.

---

## Identification of Recalled and Remedy Parts

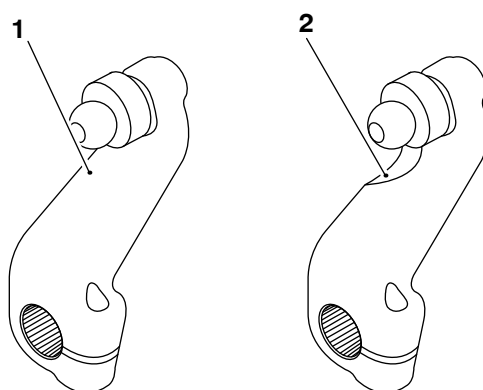

1. **Recalled part - Linkage clamp assembly, T2085085 (without scallop) - Referred to throughout as Gear Linkage Clamp Assembly**
2. **Remedy part - Linkage clamp assembly, T2085100 (with scallop) - Referred to throughout as Gear Linkage Clamp Assembly**

### Warranty Claim Instructions

Notice Number	Fault Code	Repair Code	Description	Repair Allowance	Time
567	011932991	99567	SB567 - Remove and replace clamp	0.08 hours	

### Genuine Parts Information

Notice Number	Part Number	Parts Kit Description	Quantity
567	T2085100	Linkage Clamp Assembly	1

### Parts Ordering Instructions

**Triumph Motorcycles America Ltd:** Order all repair parts by submitting a New Prior through the Warranty On-Line system. Entering the above repair code in a New Prior will automatically add the parts required and labour times for this Safety Recall Action Notice.

### Genuine Parts Return

Dealer to retain parts for 90 days. All parts must be stored in a secure, non-public accessed area and correctly identified with a completed warranty label. Thereafter the parts must be rendered unusable prior to scrapping.

## Gear Linkage Clamp Assembly - Removal

### **Warning**

Make sure the motorcycle is stabilised and adequately supported.  
A correctly supported motorcycle will help prevent it from falling.  
An unstable motorcycle may fall, causing injury to the operator or damage to the motorcycle.

1. Remove the wire clip retaining the TSA shift force sensor front ball joint. Retain the wire clip for reuse.

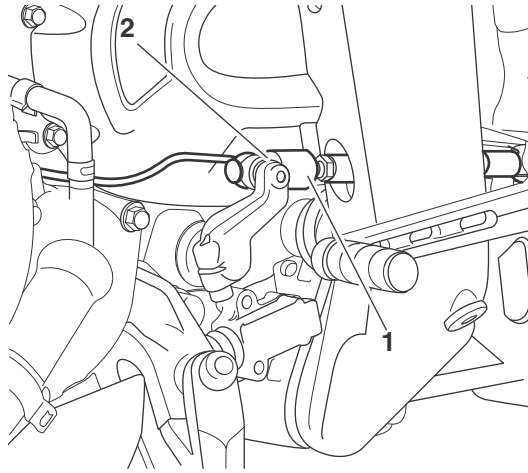

1. **TSA shift force sensor**
2. **Front wire clip position**

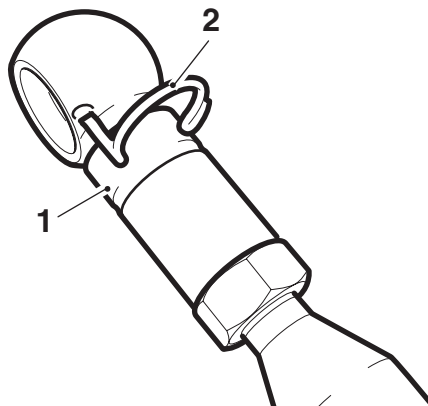

1. **TSA shift force sensor**
  2. **Wire clip**
2. Release the TSA shift force sensor from the gear linkage clamp assembly and allow the TSA shift force sensor to move rearwards and rest inside the frame.

- 
3. Remove and retain the gear linkage clamp assembly fixing. Remove the gear linkage clamp assembly (T2085085).

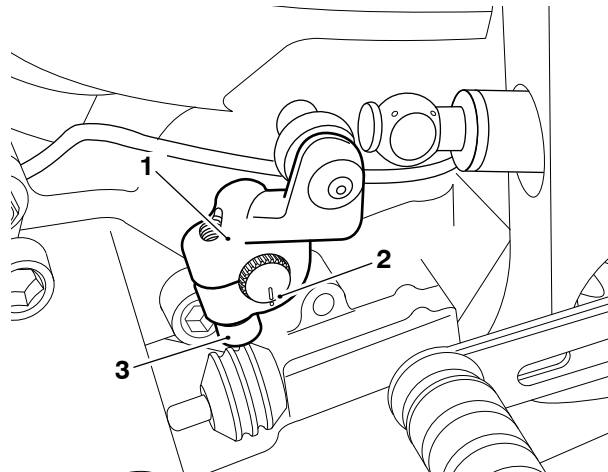

1. Gear linkage clamp assembly (T2085085)
2. Alignment marks
3. Fixing

#### Gear Linkage Clamp Assembly - Installation

1. Make sure the alignment mark on the gear shaft assembly aligns with the alignment mark on the gear linkage clamp assembly (T2085100) and install the clamp to the shaft.

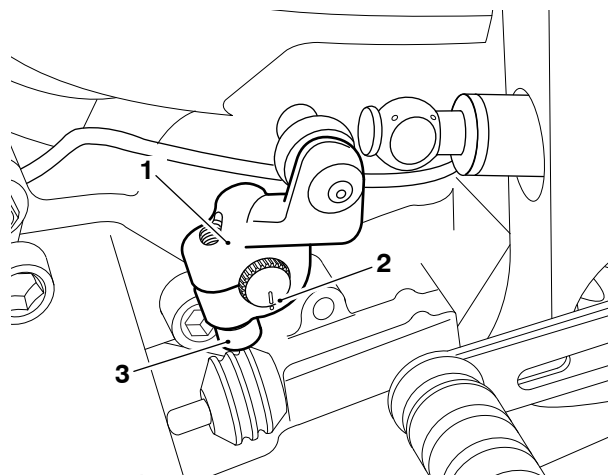

1. Gear linkage clamp assembly (T2085100)
  2. Alignment marks
  3. Fixing
2. Install the clamp fixing and tighten to **8 Nm**.

3. Make sure the ball joint is clean and free from debris and attach the TSA shift force sensor front ball joint to the gear linkage clamp assembly.

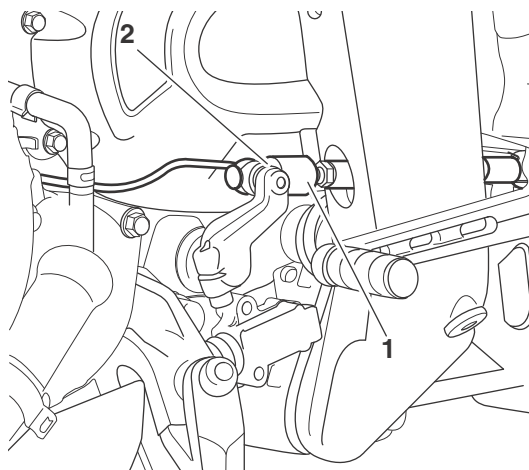

1. **TSA shift force sensor**
2. **Front wire clip position**

4. Refit the wire clip to retain the front ball joint. Make sure the wire clip locates correctly in the ball joint before rotating the clip to lock in place.

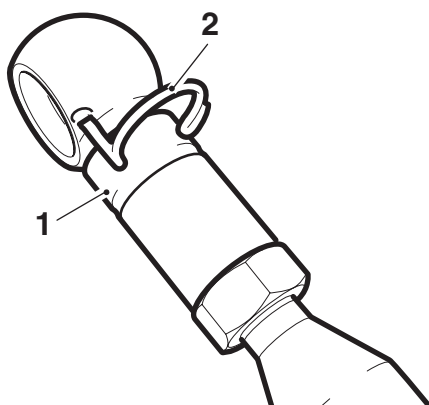

1. **TSA shift force sensor**
2. **Wire clip**

5. Make sure the gear change mechanism operates smoothly.

### Other Instructions

Once completed, please mark the Service Record Book that the requirements of this Safety Recall Action Notice have been complied with.

Before returning the motorcycle to the customer, download the latest calibration to the engine electronic control module, keyless electronic control module and instruments using the current version of the Triumph diagnostic software.

### Circulation

Initial and date when read and return to central file holder

Service Manager	Parts Manager	Sales Manager	Workshop Supervisor	Technician 1	Technician 2