



Compliance Recall

Code: 37M2

Subject Shift Lever Micro Switch

Release Date November 19, 2019

Affected Vehicles

Country	Beginning Model Year	Ending Model Year	Vehicle
USA	2012	2019	BEETLE
USA	2012	2019	BEETLE CONVERTIBLE
USA	2015	2019	GOLF
USA	2017	2019	GOLF SPORTWAGEN
USA	2015	2019	GTI
USA	2011	2018	JETTA
CAN	2012	2018	BEETLE
CAN	2012	2018	BEETLE CONVERTIBLE
CAN	2015	2019	GOLF
CAN	2015	2019	GOLF SPORTWAGEN
CAN	2015	2019	GTI
CAN	2011	2017	JETTA

Check Campaigns/Actions screen in Elsa on the day of repair to verify that a VIN qualifies for repair under this action. Elsa is the only valid campaign inquiry & verification source.

- ✓ Campaign status must show "open."
- ✓ If Elsa shows other open action(s), inform your customer so that the work can also be completed at the same time the vehicle is in the workshop for this campaign.

Problem Description

Over time, a build-up of silicate on the shift lever micro switch contacts can result in an isolation-like layer that may be interpreted as an open micro switch. This open switch normally indicates that the shift lever is in "P" park position. If the build-up happens, it may be possible to remove the key from the ignition switch without the shift lever being in the "P" park position because the system is unable to recognize that the vehicle is not in "P" park. This makes the vehicle noncompliant with FMVSS and CMVSS 114; *Theft protection and rollaway prevention*.

If the ignition key is removed without the shift lever being in "P" Park position, there is a risk that the vehicle may roll away, resulting in a crash that could injure people and damage property.

Corrective Action

Install an additional switch and circuit board.

Precautions

If this condition is present in the vehicle, an audible warning sound and failure message may appear in instrument cluster while the vehicle is in motion, due to the micro switch failure (a non-existent "P" Park shift lever position is incorrectly detected). If this happens, owners are advised to contact an authorized Volkswagen dealer immediately and make arrangements to have the vehicle inspected.

Owners are advised to always set the parking brake and follow the parking instructions as described in the vehicle owner's manual before removing the ignition key.

Parts Information

Parts Control Type: Allocation	Parts allocation will occur once a week for the part numbers below with planned delivery on Thursday's. Please review your UOL value in POC to see what your weekly allocation amount will be.
---	--

Initial Allocation: YES	Dealers will be sent an initial allocation prior to customer notification. If no initial allocation was received, please reference the Repair Projection Tool (below) to view your potential VIN population.
--	--

Criteria	Part Number	Description	Qty. per Vehicle	Ordering Method
01,02,03	5Q0-713-128-A	Kit	1	Allocation

Repair Projection Tool (right click to open): 

Code Visibility

Since August 27, 2019, affected vehicles were listed on the Inventory Vehicle Open Campaign Action report under My Dealership Reports (found on www.vw.com & OMD Web). A list was not posted for dealers who did not have any affected vehicles.

Since August 27, 2019, this campaign code showed open on affected vehicles in Elsa.

Since August 27, 2019, affected vehicles were identified with this campaign code in the VIN Lookup tool at www.vw.com and on the NHTSA VIN lookup tool at www.safercar.gov.

Owner Notification

Owner notification will take place in November 2019. Owner letter examples are included in this bulletin for your reference.

Additional Information

Please alert everyone in your dealership about this action, including Sales, Service, Parts and Accounting personnel. Contact Warranty if you have any questions.

IMPORTANT REMINDER ON VEHICLES AFFECTED BY SAFETY & COMPLIANCE RECALLS

New Vehicles in Dealer Inventory: It is a violation of federal law for a dealer to deliver a new motor vehicle or any new or used item of motor vehicle equipment (including a tire) covered by this notification under a sale or lease until the defect or noncompliance is remedied. By law, dealers must correct, prior to delivery for sale or lease, any vehicle that fails to comply with an applicable Federal Motor Vehicle Safety Standard or that contains a defect relating to motor vehicle safety.

Pre-Owned Vehicles in Dealer Inventory: Dealers should not deliver any pre-owned vehicles in their inventory which are involved in a safety or compliance recall until the defect has been remedied.

Dealers must ensure that every affected inventory vehicle has this campaign completed before delivery to consumers.

Fill out and affix Campaign Completion Label (CAMP 010 000) after work is complete. Labels can be ordered at no cost via the Compliance Label Ordering portal at www.vw.com.

Claim Entry Instructions

The labor times listed here may differ from the labor operations and labor times listed in ELSA.

After campaign has been completed, enter claim as soon as possible to help prevent work from being duplicated elsewhere. Attach the Elsa screen print showing action open on the day of repair to the repair order.

If customer refused campaign work:

- ✓ U.S. dealers: Submit request via WISE under the *Campaigns/Update/Recall Closure* option.
- ✓ Canada dealers: Upload the repair order [signed by customer] to Volkswagen WIN/Operations/Campaign Closure.

Service Number	37M2						
Damage Code	0099						
Parts Vendor Code	WVO						
Claim Type	Sold vehicle: 7 10 Unsold vehicle: 7 90						
Causal Indicator	Mark micro switch repair kit as causal part*						
Vehicle Wash/Loaner	Do not claim wash/loaner under this action U.S.A.: Loaner/rental coverage cannot be claimed under this action. However, loaner/rental may be covered under the mobility program. Please refer to the Volkswagen Warranty Policy and Procedures Manual for loaner claims information and reimbursement details. Canada: Loaner/rental coverage cannot be claimed under this action. Please refer to Volkswagen Service Loaner Program to determine loaner eligibility.						
Criteria I.D.	01						
	Install micro switch repair kit Labor operation: 3710 49 99 60 T.U. <table border="1"><thead><tr><th>Quantity</th><th>Part Number</th><th>Description</th></tr></thead><tbody><tr><td>1.00</td><td>5Q0713128A</td><td>Micro switch repair kit*</td></tr></tbody></table>	Quantity	Part Number	Description	1.00	5Q0713128A	Micro switch repair kit*
Quantity	Part Number	Description					
1.00	5Q0713128A	Micro switch repair kit*					
Criteria I.D.	02						
	Install micro switch repair kit Labor operation: 3710 50 99 30 T.U. <table border="1"><thead><tr><th>Quantity</th><th>Part Number</th><th>Description</th></tr></thead><tbody><tr><td>1.00</td><td>5Q0713128A</td><td>Micro switch repair kit*</td></tr></tbody></table>	Quantity	Part Number	Description	1.00	5Q0713128A	Micro switch repair kit*
Quantity	Part Number	Description					
1.00	5Q0713128A	Micro switch repair kit*					
Criteria I.D.	03						
	Install micro switch repair kit Labor operation: 3710 50 99 30 T.U. <table border="1"><thead><tr><th>Quantity</th><th>Part Number</th><th>Description</th></tr></thead><tbody><tr><td>1.00</td><td>5Q0713128A</td><td>Micro switch repair kit*</td></tr></tbody></table>	Quantity	Part Number	Description	1.00	5Q0713128A	Micro switch repair kit*
Quantity	Part Number	Description					
1.00	5Q0713128A	Micro switch repair kit*					

Customer Letter Example (USA)

This notice applies to your vehicle: <VIN>

NHTSA: 19V615

**Subject: Compliance Recall 37M2 – Shift Lever Micro Switch
Certain 2011-2019 Model Year Volkswagen Vehicles**

Dear Volkswagen Owner,

This notice is sent to you in accordance with the National Traffic and Motor Vehicle Safety Act. Volkswagen has decided that certain 2011-2019 model year Volkswagen vehicles fail to conform to 49 CFR § 571.114 - Standard No. 114; *Theft protection and rollaway prevention*. Our records show that you are the owner of a vehicle affected by this action.

- What is the issue?** Over time, a build-up of silicate on the shift lever micro switch contacts can result in an isolation-like layer that may be interpreted as an open micro switch. This open switch normally indicates that the shift lever is in "P" park position. If the build-up happens, it may be possible to remove the key from the ignition switch without the shift lever being in the "P" park position because the system is unable to recognize that the vehicle is not in "P" park. This makes the vehicle noncompliant with regulatory requirements.
- If the ignition key is removed without the shift lever being in "P" Park position, there is a risk that the vehicle may roll away, resulting in a crash that could injure people and damage property.
- What will we do?** To correct this noncompliance, your authorized Volkswagen dealer will install an additional switch and circuit board. This work will take about an hour to complete and will be performed for you free of charge. Please keep in mind that your dealer may need additional time for the preparation of the repair, as well as to accommodate their daily workshop schedule.
- What should you do?** Please contact your authorized Volkswagen dealer without delay to schedule this recall repair. To set up an appointment online, please visit www.vw.com/find-a-dealer.
- Precautions you should take** If this condition is present in the vehicle, an audible warning sound and failure message may appear in instrument cluster while the vehicle is in motion, due to the micro switch failure (a non-existent "P" Park shift lever position is incorrectly detected). If this happens, owners are advised to contact an authorized Volkswagen dealer immediately and make arrangements to have the vehicle inspected.
- Owners are advised to always set the parking brake and follow the parking instructions as described in the vehicle owner's manual before removing the ignition key.
- Lease vehicles and address changes** If you are the lessor and registered owner of the vehicle identified in this action, the law requires you to forward this letter immediately via first-class mail to the lessee within ten (10) days of receipt. If you have changed your address or sold the vehicle, please fill out the enclosed prepaid Owner Reply card and mail it to us so we can update our records.
- Reimbursement of Expenses** If you have previously paid for repairs relating to the condition described in this letter, please refer to the enclosed form that explains how to request reimbursement.
- Can we assist you further?** If your authorized Volkswagen dealer fails or is unable to complete this work free of charge within a reasonable time, or if you should have any questions about this communication, please reach out to us using your preferred method of communication at www.vw.com/contact or by calling us at 800-893-5298.
- Checking your vehicle for open Recalls and Service Campaigns** To check your vehicle's eligibility for repair under this or any other recall/service campaign, please visit www.vw.com/owners/recalls and enter your Vehicle Identification Number (VIN) into the Recall/Service Campaign Lookup tool.

If you still cannot obtain satisfaction, you may file a complaint with: The Administrator, National Highway Traffic Safety Administration, 1200 New Jersey Avenue, SE., Washington, DC 20590; or call the toll-free Vehicle Safety Hotline at 1-888-327-4236 (TTY: 1-800-424-9153); or go to <http://www.safercar.gov>.

We apologize for any inconvenience this matter may cause; however we are taking this action to help ensure your safety and continued satisfaction with your vehicle.

Sincerely,

Volkswagen Customer Protection

The repair information in this document is intended for use only by skilled technicians who have the proper tools, equipment and training to correctly and safely maintain your vehicle. These procedures are not intended to be attempted by "do-it-yourselfers," and you should not assume this document applies to your vehicle, or that your vehicle has the condition described. To determine whether this information applies, contact an authorized Volkswagen dealer. ©2019 Volkswagen Group of America, Inc. and Volkswagen Canada. All Rights Reserved.

Customer Letter Example (CANADA)

This notice applies to your vehicle: <MODEL YEAR> <BRAND> <CARLINE>, <VIN>

Transport Canada Recall: 2019-423

**Subject: Compliance Recall 37M2 – Shift Lever Micro Switch
Certain 2011-2019 Model Year Volkswagen Vehicles**

Dear Volkswagen Owner,

This notice is sent to you in accordance with the requirements of the *Motor Vehicle Safety Act*. This is to inform you that your vehicle may be non-compliant with the requirements of the *Motor Vehicle Safety Regulations* and that the non-compliance could affect the safety of a person. Our records show that you are the owner of a vehicle affected by this action.

What is the issue? Over time, a build-up of silicate on the shift lever micro switch contacts can result in an isolation-like layer that may be interpreted as an open micro switch. This open switch normally indicates that the shift lever is in “P” park position. If the build-up happens, it may be possible to remove the key from the ignition switch without the shift lever being in the “P” park position because the system is unable to recognize that the vehicle is not in “P” park. This makes the vehicle noncompliant with regulatory requirements.

If the ignition key is removed without the shift lever being in "P" Park position, there is a risk that the vehicle may roll away, resulting in a crash that could injure people and damage property.

What will we do? To correct this noncompliance, your authorized Volkswagen dealer will install an additional switch and circuit board. This work will take about an hour to complete and will be performed for you free of charge. Please keep in mind that your dealer may need additional time for the preparation of the repair, as well as to accommodate their daily workshop schedule.

What should you do? Please contact your authorized Volkswagen dealer without delay to schedule this recall repair.

Precautions you should take If this condition is present in the vehicle, an audible warning sound and failure message may appear in instrument cluster while the vehicle is in motion, due to the micro switch failure (a non-existent "P" Park shift lever position is incorrectly detected). If this happens, owners are advised to contact an authorized Volkswagen dealer immediately and make arrangements to have the vehicle inspected.

Owners are advised to always set the parking brake and follow the parking instructions as described in the vehicle owner's manual before removing the ignition key.

Lease vehicles and address changes If you are the lessor and registered owner of the vehicle identified in this action, the law requires you to forward this letter immediately via first-class mail to the lessee within ten (10) days of receipt. If you have changed your address or sold the vehicle, please fill out the enclosed prepaid Owner Reply card and mail it to us so we can update our records.

Reimbursement of Expenses If you have previously paid for repairs relating to the condition described in this letter, please refer to the enclosed form that explains how to request reimbursement.

Can we assist you further? If your authorized Volkswagen dealer fails or is unable to complete this work free of charge within a reasonable time, please contact Customer Relations, Monday through Friday from 8AM to 8PM EST by phone at 1-800-822-8987 or via our “Contact Us” page at www.vw.ca.

We apologize for any inconvenience this matter may cause; however we are taking this action to help ensure your safety and continued satisfaction with your vehicle.

Sincerely,

Volkswagen Customer Protection

NOTE

- These repair instructions may differ from the labor operations and labor times listed in ELSA.
- Damages resulting from improper repair or failure to follow these work instructions are the dealer's responsibility and are not eligible for reimbursement under this action.
- This procedure must be read in its entirety prior to performing the repair.
- Due to variations in vehicle equipment and options, the steps/illustrations in this work procedure may not identically match all affected vehicles.
- Diagnosis and repair of pre-existing conditions in the vehicle are not covered under this action.
- When working during extreme temperatures, it is recommended that the vehicle be allowed to acclimate inside the shop to avoid temperature-related component damage/breakage.

Repair Overview

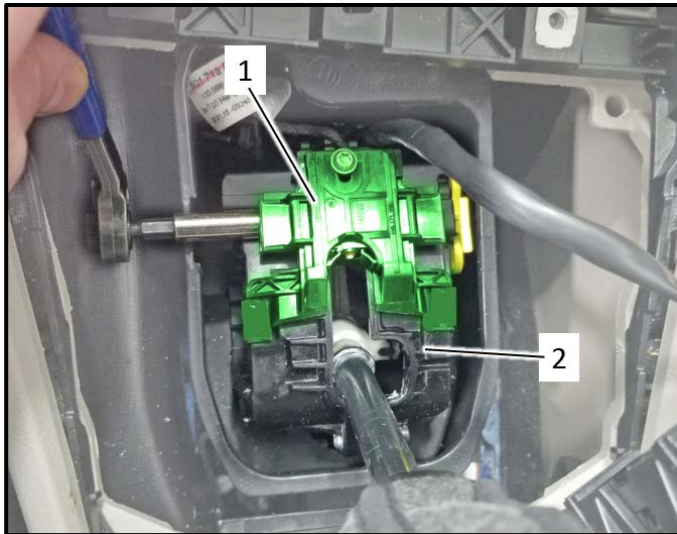

- Install an external micro switch <1> to the selector mechanism <2>.

- Section A – Check for Previous Repair
- Section B – Gearshift Trim Removal (Golf models)
- Section C – Gearshift Trim Removal (Jetta models)
- Section D – Gearshift Trim Removal (Beetle models)
- Section E – Micro Switch Installation
- Section F – Vehicle Reassembly (Golf)
- Section G – Vehicle Reassembly (Jetta)
- Section H – Vehicle Reassembly (Beetle)
- Section I – Campaign Completion Label

Required Parts

<u>Criteria</u>	<u>Quantity</u>	<u>Part Number</u>	<u>Part Description</u>
ALL	1	5Q0.713.128.A	Micro switch repair kit

NOTE

The specified part numbers reflect the status at the start of this recall. Interim updates made in ETKA can cause a listed part number to become unavailable. In this case, the new part number specified in ETKA should be used.

Required Tools

 <p>Trim Removal Wedge -3409- (or equivalent)</p>	 <p>Torque Wrench 1783 2-10Nm -VAG1783- (or equivalent)</p>
 <p>Back probe leads (2) -VAG1594/12- from the VAG1594C Connector test set (or an equivalent thin back probe lead)</p>	 <p>Digital Multimeter or Voltage Tester</p>

Repair Instruction

Section A - Check for Previous Repair

TIP

If Campaign Completion label is present, no further work is required.

Applicable criteria ID(s)	Campaign/Action Status
01 ← 2	Open ← 1

EXAMPLE

- Enter the VIN in Elsa and proceed to the “Campaign/Action” screen.

TIP

On the date of repair, print this screen and keep a copy with the repair order.

- Confirm the Campaign/Action is open <arrow 1>. If the status is closed, no further work is required.
- Note the Applicable Criteria ID <arrow 2> for use in determining the correct work to be done and corresponding parts associated.

Golf Models: Proceed to Section B

Jetta Models: Proceed to Section C

Beetle Models: Proceed to Section D

Section B – Gearshift Trim Removal and Disassembly (Golf Models)

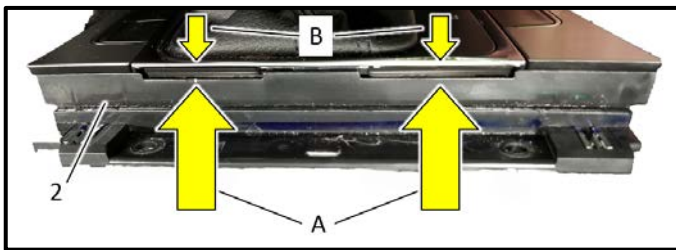

Removing gearshift boot trim:

⚠ WARNING

If the parking brake is not set, the vehicle could roll away and cause damage or injury.

- Set parking brake.
- Turn ignition off and remove key from ignition.
- Open the center storage compartment.
- Pull up the trim at the recesses <arrows A> in the gearshift cover <2>.

! NOTE

If the trim is pulled up at the surface edge of the trim <arrows B>, the laminate covering on the gearshift boot trim may be damaged. Damage to the trim is not covered under this campaign.



Push emergency release handle:

- Push down on emergency release handle in direction of <arrow>.
- Shift vehicle into Drive/Sport.

i TIP

Engaging the emergency release allows the gearshift to be moved and testing performed without turning on the ignition.

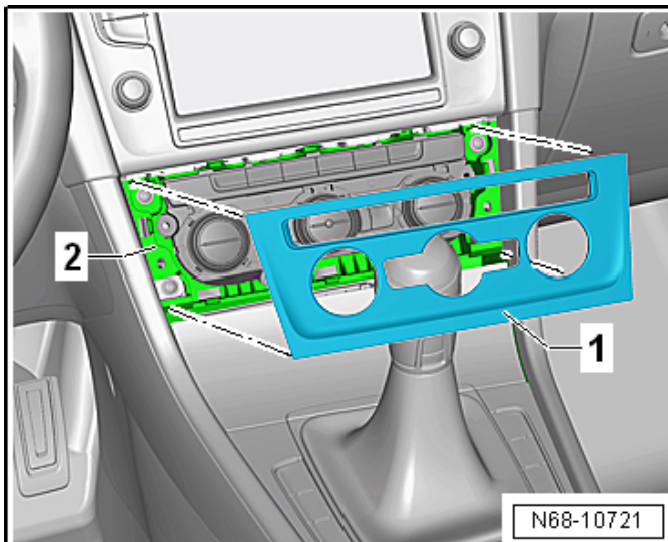

Remove climate control trim:

- Carefully unclip climate control trim <1> from instrument panel <2>.

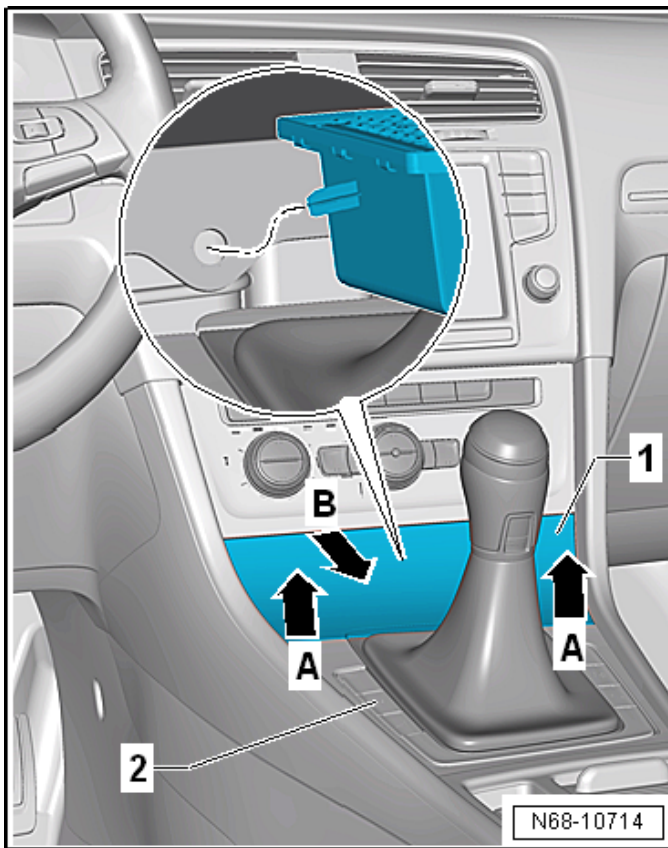

Remove center storage compartment:

- Unclip the front storage compartment <1> from the center console <2> in direction of <arrows A>.
- Remove the front storage compartment <1> from the center console <2> toward the rear <arrow B>.
- If equipped, disconnect the connectors from the front storage compartment.

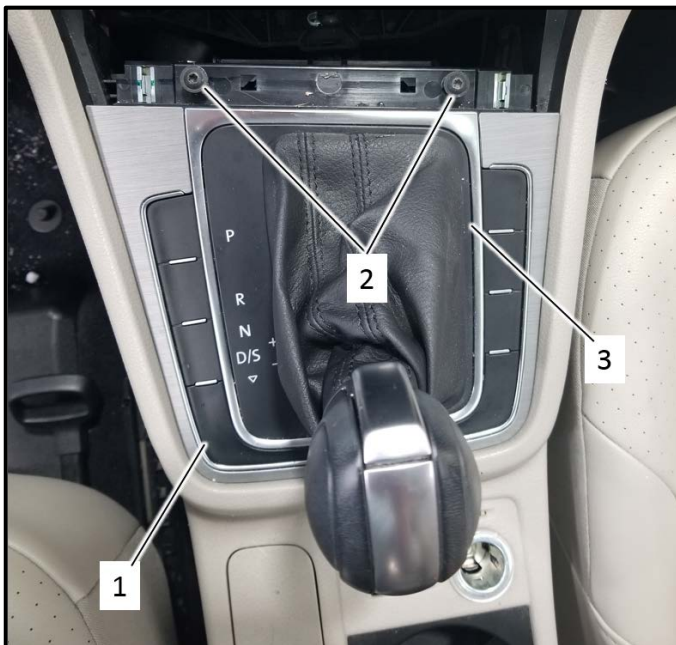

Loosen gearshift lever cover trim:

- Remove bolts <2>.
- Lift gearshift cover <1> over the gearshift.

NOTE

The gearshift boot trim <3> does not need to be completely removed from the gearshift.

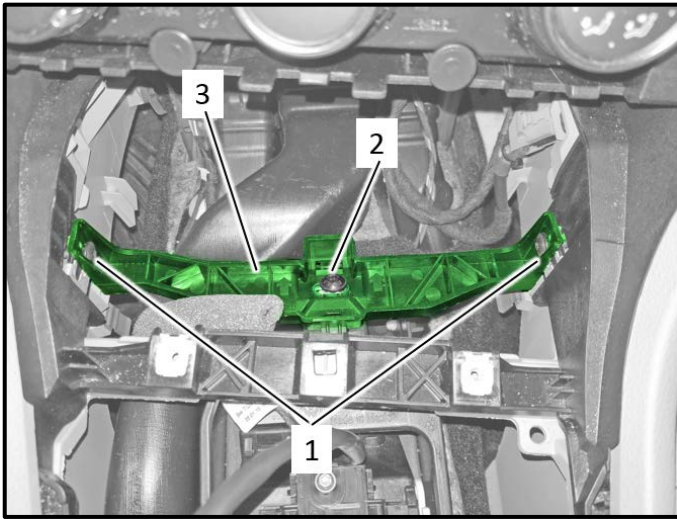

Remove center console bracket:

- Remove bolts <1> and <2>.
- Remove center console bracket <3>.

Proceed to Section E.

Section C – Gearshift Cover Removal and Disassembly (Jetta Models)

Version 1



Version 2



NOTE

There are two versions of gearshift cover depending on model generation.

- Version 1 = Jetta, MY 2011-2014
- Version 2 = Jetta, MY 2015-2018

These instructions illustrate removing Version 2. Removal of Version 1 is similar.

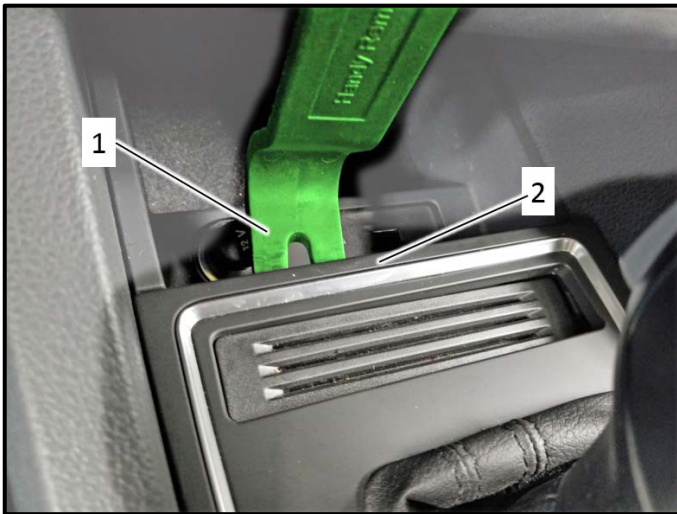
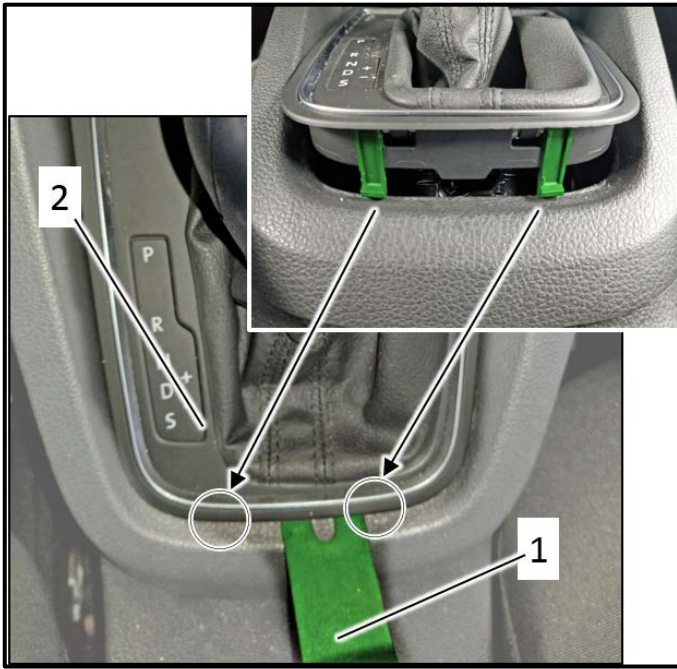

Remove gearshift cover:

⚠ WARNING

If the parking brake is not set, the vehicle could roll away and cause damage or injury.

- Set parking brake.
- Turn ignition off and remove key from ignition.
- Unclip cover <2> using trim removal wedge <1>.
 - For Version 2 only: Note the position of the securing tabs as the cover <2> may have to be pressed slightly forward at these points.

- Unclip the front of the gearshift cover <2> using an angled trim removal wedge <1>.

! NOTE

This will not be necessary for vehicles with gearshift cover Version 1.

- Lift gearshift cover <2> over the gearshift.

! NOTE

The gearshift cover <2> does not need to be completely removed from the gearshift.



Push emergency release handle:

- Push down on emergency release handle in direction of <arrow>.
- Shift vehicle into Drive/Sport.

i TIP

Engaging the emergency release allows the gearshift to be moved and testing performed without turning on the ignition.

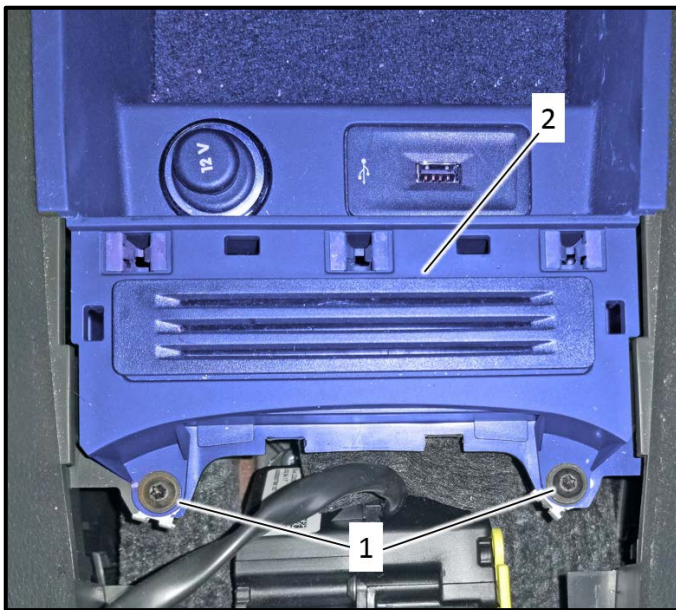

Remove storage compartment:

- Remove bolts <1>.
- Lift up on the storage compartment <2> and disconnect electrical connectors (the number of connectors vary based on vehicle equipment).
- Remove storage compartment <2>.

Proceed to Section E.

Section D – Gearshift Trim Removal and Disassembly (Beetle Models)

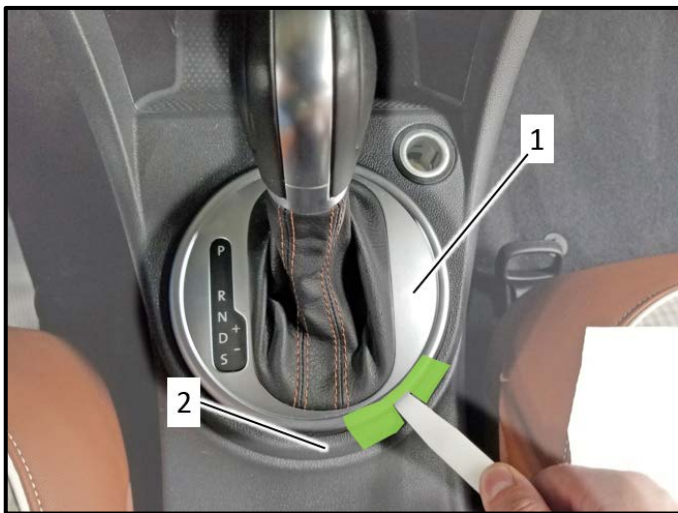

Remove gearshift cover trim:

⚠ WARNING

If the parking brake is not set, the vehicle could roll away and cause damage or injury.

- Set parking brake.
- Turn ignition off and remove key from ignition.
- Tape off the gearshift cover <1> and console trim <2> to avoid damaging the cover and console trim.

! NOTE

Multiple layers of tape are recommended for vehicles with painted console trim.

- Carefully pry off gearshift cover <1> using a trim removal wedge.

i TIP

Pulling up carefully on the gearshift boot will help create a gap for the trim removal wedge. Take care that the boot is not damaged.



Remove console trim bolts:

- Remove bolts <1>.



Remove climate control trim:

- Pull out climate control trim <1> slightly in a lower corner <arrow>.
- Continue removing trim <1> using a trim removal wedge.
- Disconnect electrical connectors (the number of connectors vary based on vehicle equipment).



Remove console trim:

- Lift up on console trim <1> at arrow <A>.
- Pull console trim <1> away from instrument panel at arrows .
- Disconnect electrical connectors (the number of connectors vary based on vehicle equipment).
- Pay attention to which opening the electrical connectors pass through.



Position console trim:

- Rotate and position console trim <1> as shown.

! NOTE

The console trim <1> does not need to be completely removed from the vehicle.

Proceed to Section E.

Section E – Micro Switch Installation

! NOTE

The following steps illustrate the micro switch installation on Golf/GTI models. Installation on Jetta and Beetle models is similar.



Remove sticker:

- Carefully remove sticker <1> from selector mechanism housing.

! NOTE

Some models may have another sticker under the sticker shown. In these cases, remove the other sticker as well and wrap it around the gearshift cover wiring harness as described in the next step.

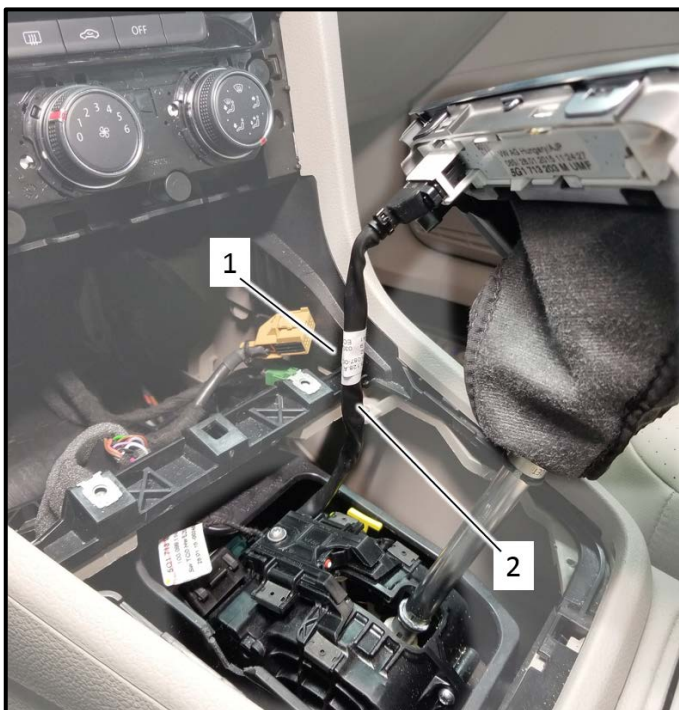

Install sticker:

- Wrap removed sticker <1> around gearshift cover wiring harness <2>.



Cover the opening on the selector mechanism (Golf/GTI models only):

- Cover the opening on the selector mechanism with a clean shop rag <1>.
- This will prevent debris from entering the selector mechanism during the next step.

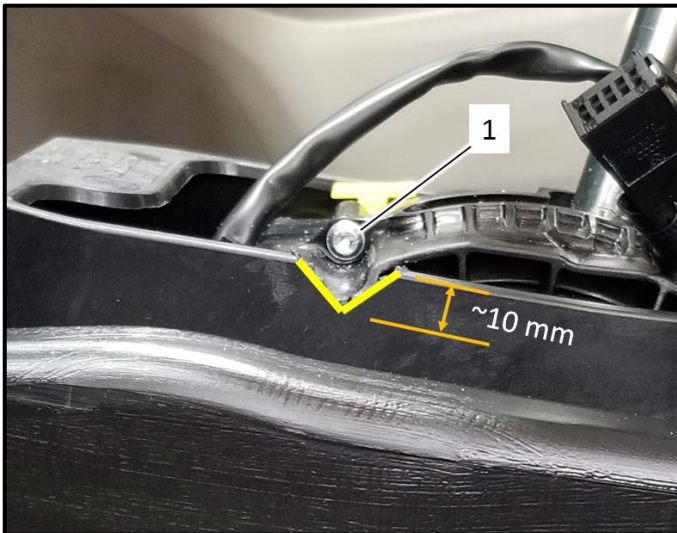

Notch the selector mechanism housing (Golf/GTI models only):

- Using a suitable cutting tool (i.e. side cutting pliers), cut a notch in the selector mechanism housing.
- The notch is necessary to allow access for removing the gearshift housing bolt <1>.
- The center of the notch should be aligned with bolt <1> with a max depth of 10 mm from the top edge of the selector mechanism housing.

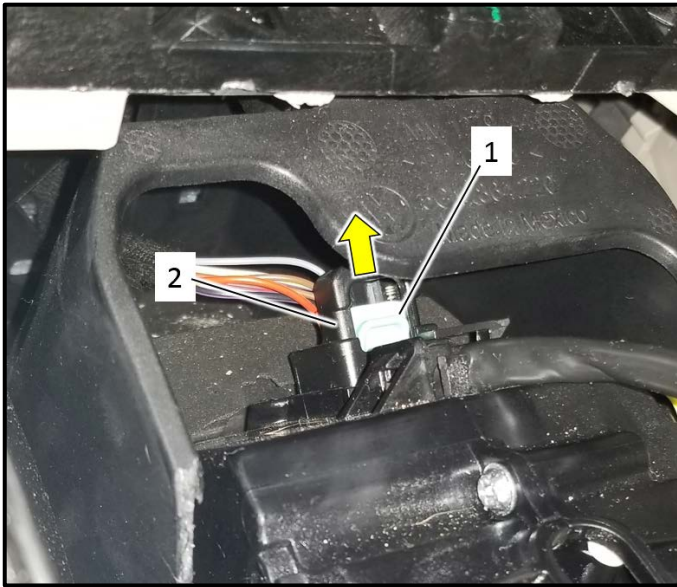

Disconnect selector mechanism housing connector:

- Slide connector lock <1> in direction of <arrow> until connector <2> disengages from selector mechanism.

TIP

Due to the lack of space, a screwdriver or trim tool may make removing the connector <2> easier. If a screwdriver or trim tool is used, take care that the connector and/or wiring is not damaged.

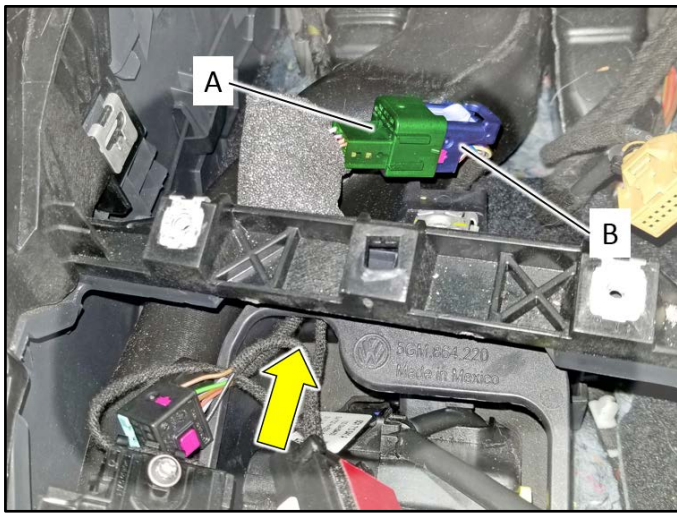

Connect micro switch harness:

- Golf/GTI models only: Feed the disconnected harness connector towards the front of the vehicle through the opening in the selector mechanism housing <arrow>.
- Golf/GTI models only: Feed the new micro switch harness connector <A> through the opening in the selector mechanism housing <arrow>.
- Connect micro switch harness connector <A> to original harness .
- Do not cover the harness connectors with the foam sleeve at this time.

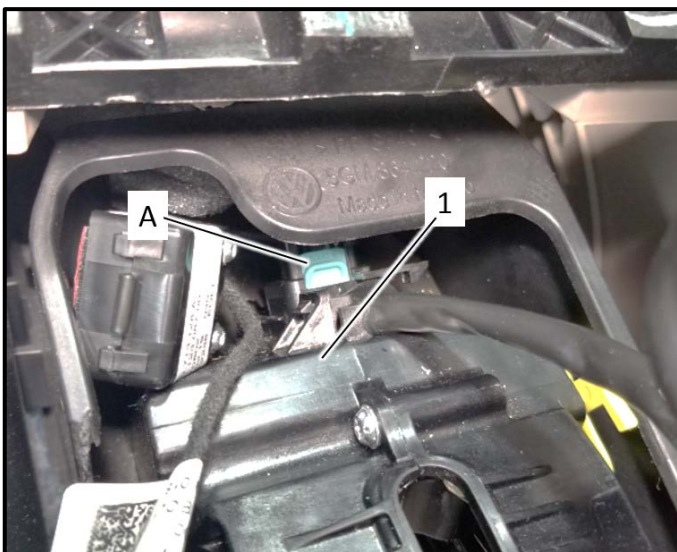

Connect selector mechanism housing connector:

- Connect new micro switch connector <A> to selector mechanism <1> until connector lock audibly engages.

TIP

Due to the lack of space, a screwdriver or trim tool may make positioning and installing the connector <A> easier. If a screwdriver or trim tool is used, take care that the connector and/or wiring is not damaged.



Secure micro switch module:

- Clean mounting area for micro switch module With cleaning solution D 009.401.04 (shop supply).
- Ensure no adhesive residue from the sticker remains.
- Wait for cleaned area to completely dry.
- Remove protective backing from Velcro pad and install micro switch module <1> to selector mechanism <2>.

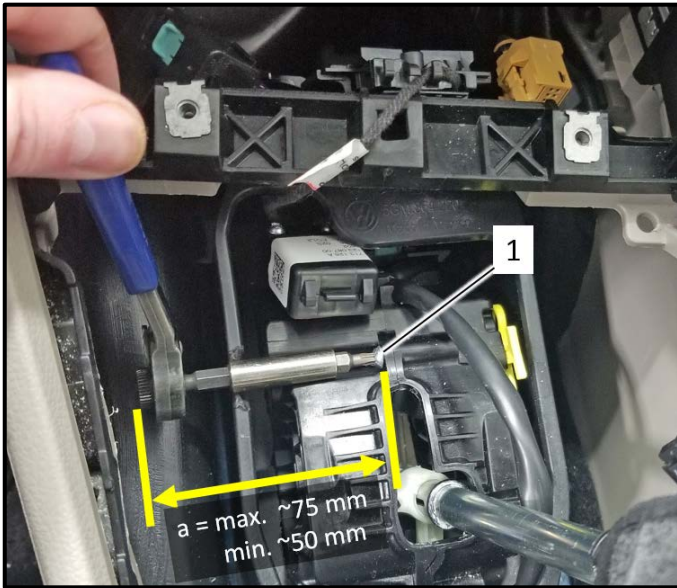

Remove selector mechanism housing bolt:

- Remove bolt <1>.
- Max tool dimension <a> = approx. 75 mm.
- Min tool dimension <a> = approx. 50 mm.

! NOTE

- For Beetle models, there is more room to operate so the tool dimensions are not as critical.
- For Jetta models, the tool will have to be placed under the center console support bracket.

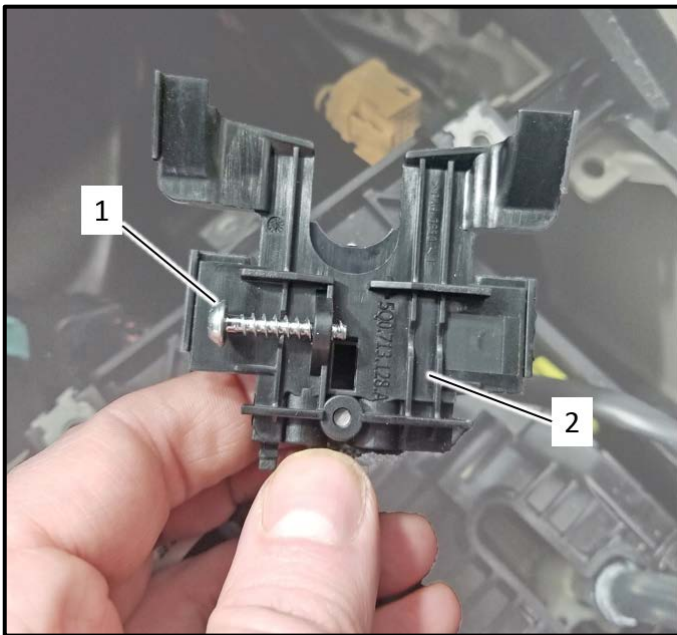

Pre-install removed bolt into new micro switch:

- Install bolt <1> a few turns by hand into the new micro switch <2>.

! NOTE

The bolt <1> should be pre-installed only a few turns. If the bolt is screwed in too far, the new micro switch will be difficult to align properly.

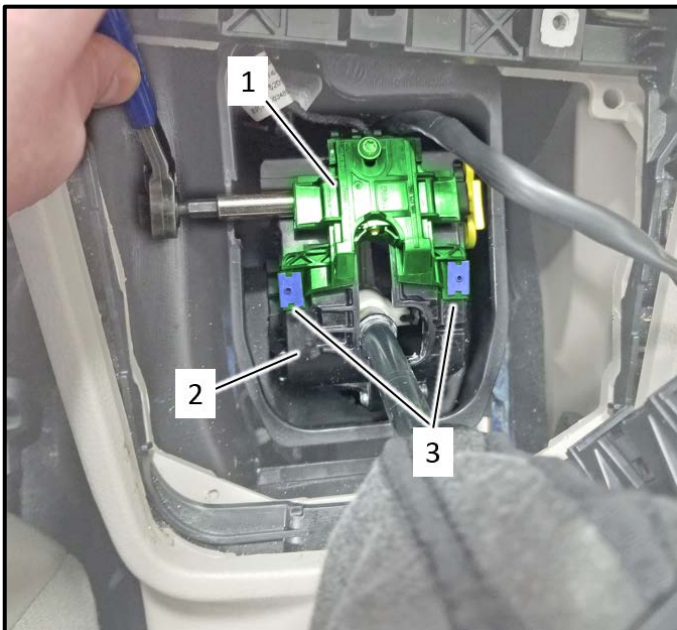

Install micro switch:

- Install micro switch <1> onto selector mechanism <2>.
- Tighten bolt and torque to 2 Nm.
- Secure micro switch to selector mechanism with clips <3>.

! NOTE

Make sure the harness to the gearshift cover is not pinched under the micro switch.

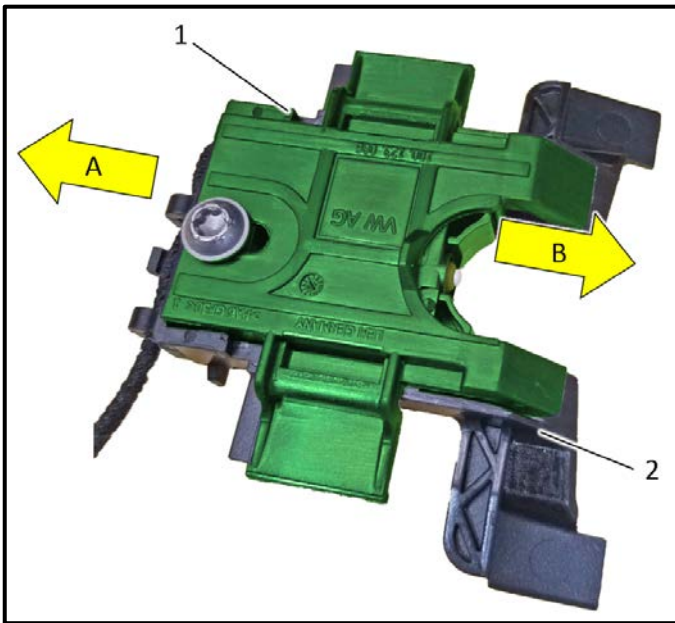

NOTE

- The micro switch assembly is made up of the micro switch guide <1> and the base <2>.
- The guide <1> can be moved independently of the base <2> in direction of <arrow A>.
- Spring tension allows the micro switch guide to move in direction of <arrow B>.

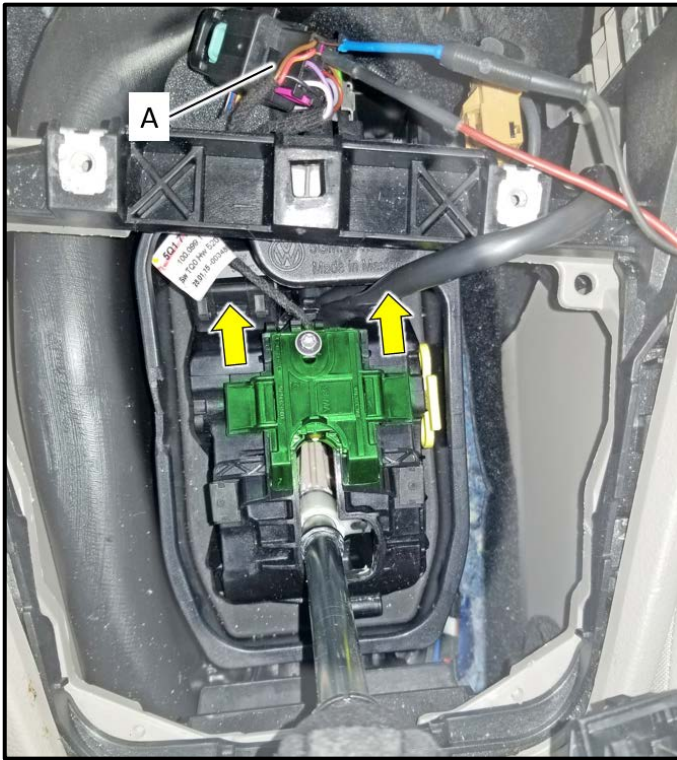

Adjust micro switch:

- Connect back probe leads to multimeter/voltmeter.

NOTE

Back probe leads must be thin enough so damage to the connector housing and terminals does not occur.

- Insert back probe leads into terminal openings 1 and 2 on the back of connector <A>.
- Slide micro switch guide toward the front of vehicle in direction of <arrows> and hold in position.
- Voltage reading should = 0.0 volts.

NOTE

The back probe leads must be inserted in the open cavities <arrows> of the connector housing.

Ground – terminal 1

Power – terminal 2

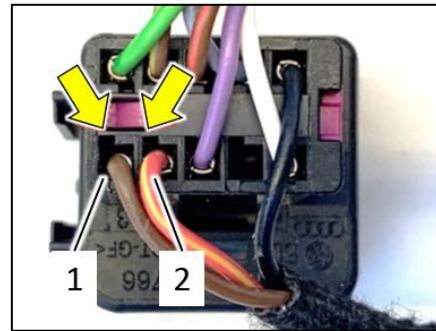



- While holding micro switch guide in the forward position, put gearshift into Park.
- Slowly allow the micro switch guide to completely release against the spring tension until the micro switch guide rests against the gearshift shaft.
- Torque bolt <A> to 2 Nm.
- Verify voltage reading = battery voltage.

Micro Switch Adjustment Chart

Step	Gearshift Position	Correct Voltage Reading	Is Battery Voltage Present?	
1	Resting in park	Battery voltage	Yes = no adjustment needed	No = adjustment needed
2	Pressed slightly forward in direction of vehicle travel.	Battery voltage	Yes = no adjustment needed	No = adjustment needed
3	Pulled slightly back in direction of reverse.	Battery voltage	Yes = no adjustment needed	No = adjustment needed
4	Pulled back in direction of reverse with slightly more force that it takes to shift gears in Tiptronic mode (approximately 6.75 – 13.5 pounds/3 – 6 kg.)	NO voltage	NO = no adjustment needed	YES = adjustment needed

NOTE

- The pull test in step 4 is done to ensure the micro switch is not engaged too early when shifting into Park.
- It takes approximately 4.5 pounds (2 kg.) of force to shift gears in Tiptronic mode.



Verify micro switch installation position:

- DO NOT push gearshift button.
- DO NOT push brake pedal
- Perform the four steps in the chart listed above while monitoring battery voltage.
- If adjustment is required, loosen the top screw on the micro switch, reposition the micro switch as needed and retighten the screw to 2 Nm.
- If no adjustment is required, proceed to final switch assembly.

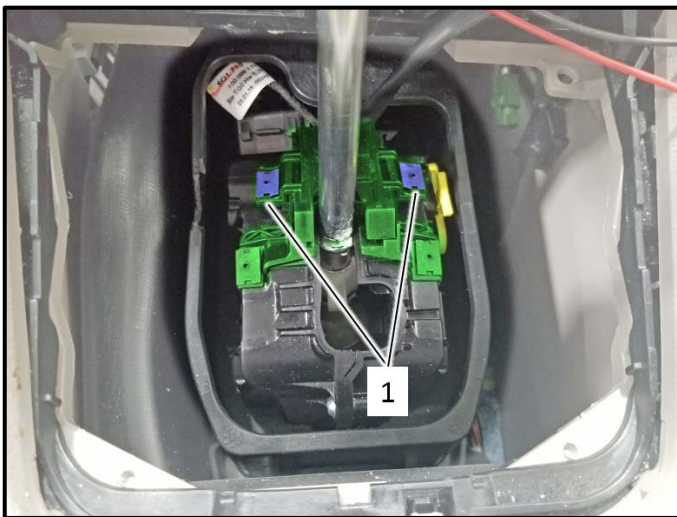

Final switch assembly:

- Install retaining clips <1> to secure micro switch guide to the micro switch base.



Perform a final test of the micro switch positioning:

- The final test is the same as the previous test.
- Refer to previous “**Micro Switch Adjustment Chart**”.

Proceed to appropriate section for vehicle reassembly:

Section F – Golf

Section G – Jetta

Section H - Beetle

Section F – Vehicle Reassembly (Golf Models)

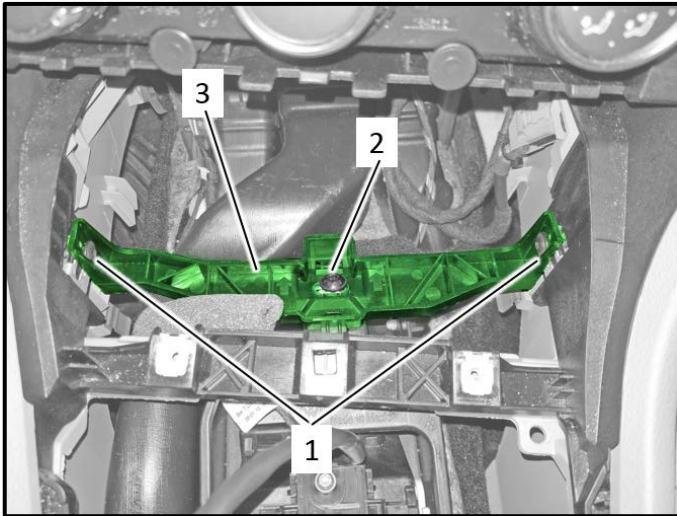

Install center console bracket:

- Install center console bracket <3>.
- Install bolts <1 and 2> a few turns.
- Torque bolt <2> to 6 Nm first.
- Torque bolts <1> to 1.5 Nm.



Install gearshift cover:

- Connect electrical connector (if disconnected).
- Insert rear of gearshift cover <1> into center console first.
- Torque bolts <2> to 1.5 Nm.
- Install gearshift boot trim <3>.

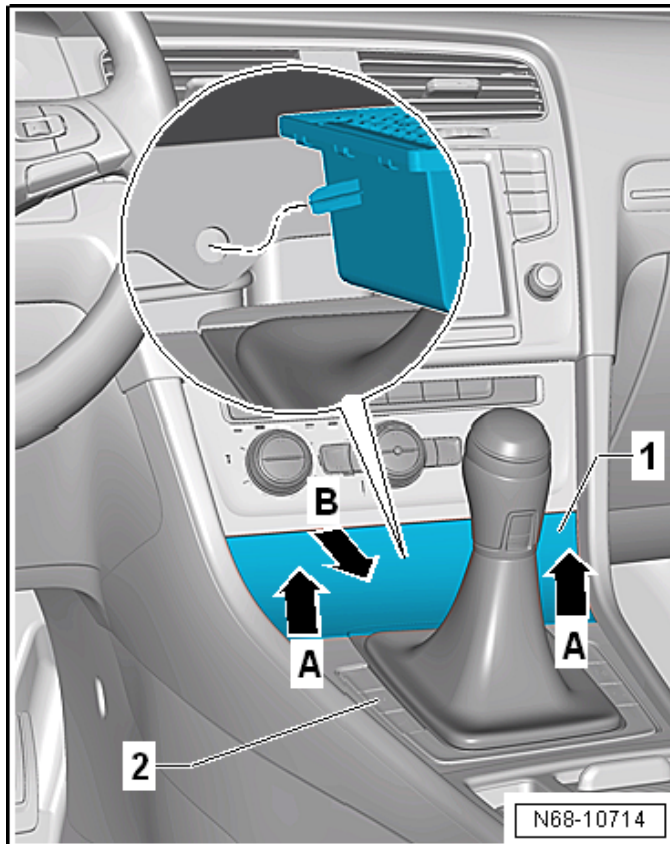

Reinstall center storage compartment:

- Installation is the reverse of removal.
- Connect the connectors.
- Ensure the tab on the front storage compartment is seated correctly in the center console hole.
- Position the storage compartment at a slight angle in order to insert it into the rear guide. Then press the storage compartment downward and lock in place.

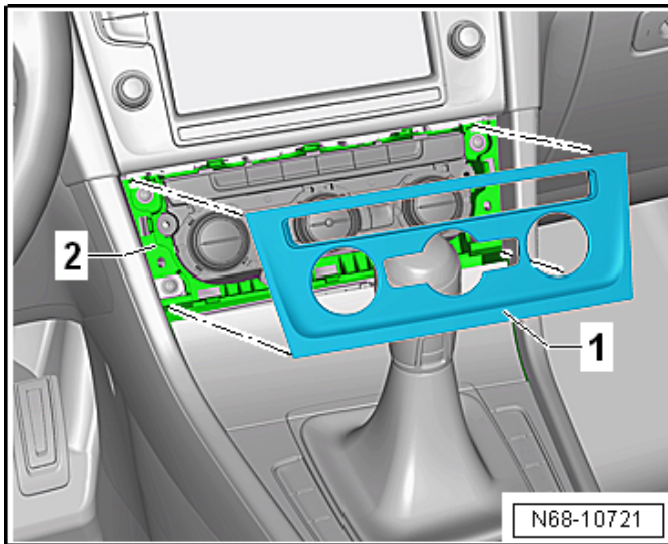

Install climate control trim:

- Clip climate control trim <1> into instrument panel <2>.
- Ensure trim around radio is clipped into place.

Repair is complete - Proceed to Section I.

Section G – Vehicle Reassembly (Jetta Models)

Version 1



Version 2



- Installation for both versions is the reverse order of removal.
- Connect electrical connectors.
- Torque fasteners to 1.5 Nm.

Repair is complete - Proceed to Section I.

Section H – Vehicle Reassembly (Beetle Models)



- Installation is the reverse order of removal.
- Connect electrical connectors.
- Torque fasteners to 1.5 Nm.

Repair is complete - Proceed to Section I.

Section I – Campaign Completion Label

Install Campaign Completion Label

- Fill out and affix Campaign Completion Label, part number CAMP 010 000, next to the vehicle emission control information label.

 **TIP**

Ensure Campaign Completion Label does not cover any existing label(s).