

GO-ES Foldaway Service Instructions

FREEDMAN
SEATING COMPANY



Table of Contents

Seat Preparation.....Page 3

Spacer Installation.....Page 4-8

Stop Block Installation.....Page 9-13

Warning Label Application.....Page 14

Seat Preparation

Step 1

- Set the seat to the in-use position. Carefully remove cushion inserts by pulling them up to access seat frame. See Video.

Step 2 **SKIP THIS STEP IF INDEX PIN IS NOT BENT**

- Remove back-frame dump handle.
- 🔑 One screw holds the handle on the spindle. **Use manual tool only. Screw prone to break.**

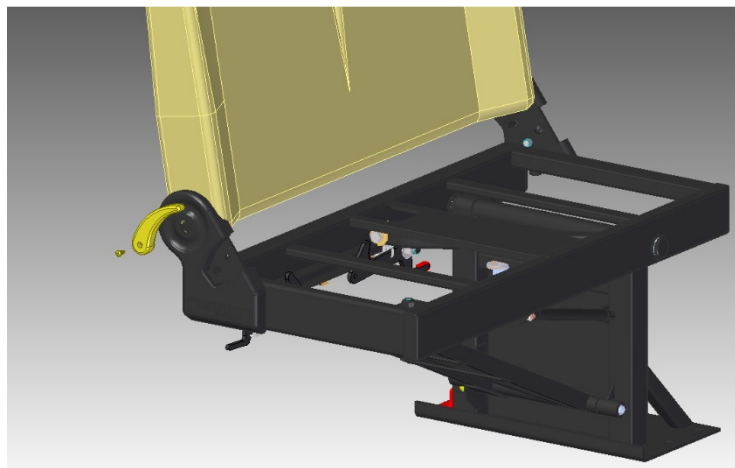

Step 3 **SKIP THIS STEP IF INDEX PIN IS NOT BENT**

- Remove side cover.
- 🔑 Three screws and the dump handle hold the side cover in place.

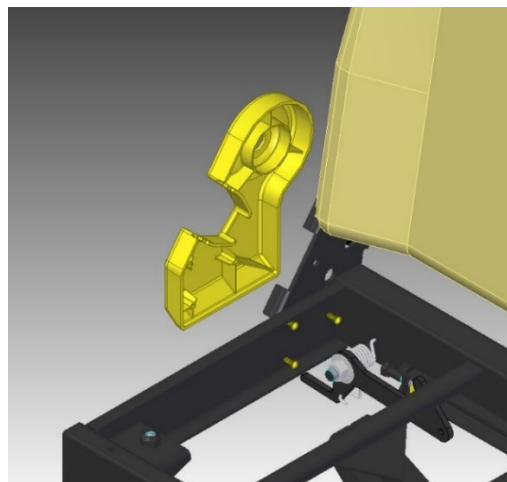

Spacer Installation

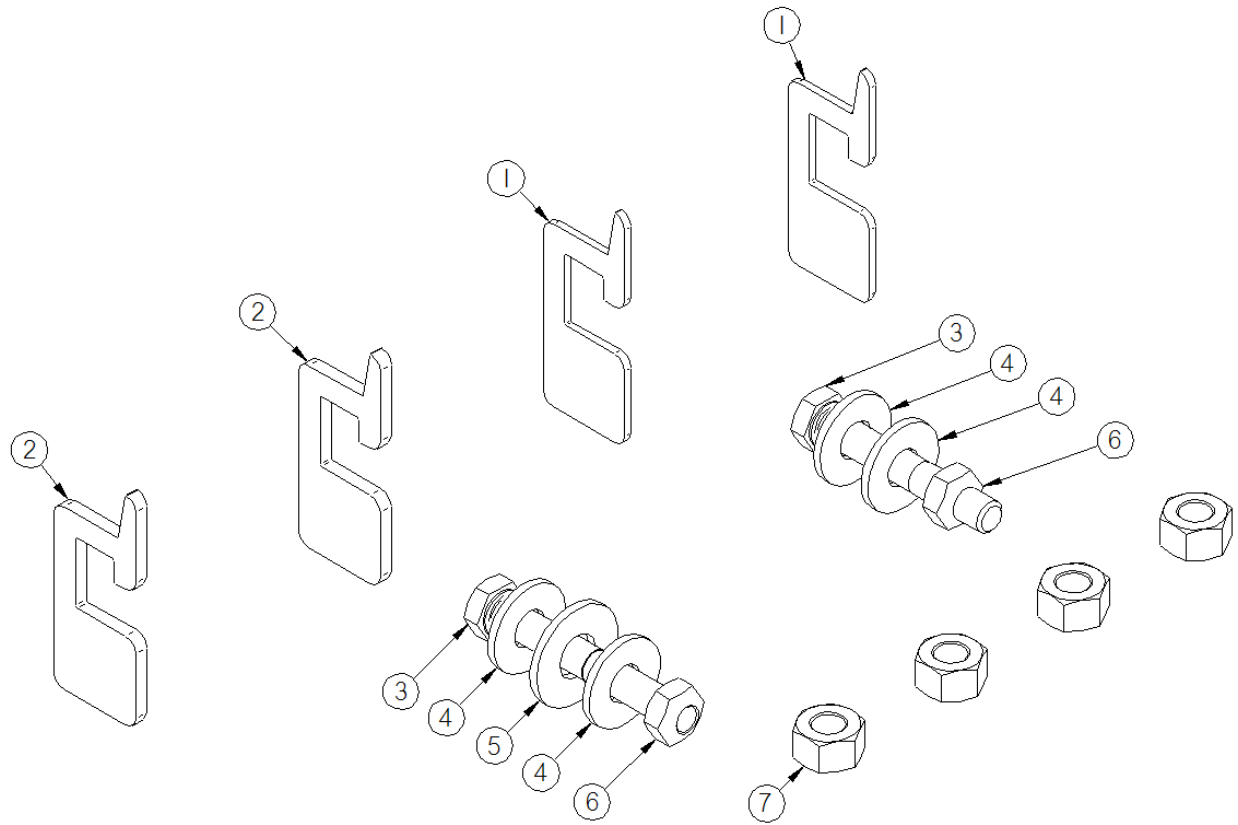

PARTS LIST SPACER KIT 94209			
ITEM	QTY	PART #	DESCRIPTION
7	4	9422298	3/8-24UNF,PREV TORQ LOCKNUT,G8,ZP
6	2	9422297	5/16-18UNC PREV TORQUE, LOCK NUT, G8, ZP
5	1	99157	3/8, WASHER, FLAT, USS, G8, ZP,YEL
4	4	99643	5/16" WASHER, FLAT, USS, G8, ZP
3	2	9906-000001-00 7	5/16-18UNC x 2" HHCS,G8,ZP,YEL
2	2	94208-IN	PLATE, GO-ES, FOLDAWAY, BACK FRAME SHIM, 10GA
1	2	94205-IN	PLATE, GO-ES, FOLDAWAY, BACK FRAME SHIM, 14GA

Spacer Installation

Step 4

- Partially undo back cover to expose 6 bolts used to connect seatback to seatbase.

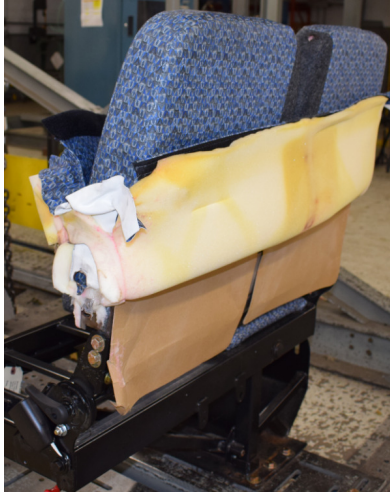

Step 5

- Do not remove bolts. Replace nuts and lock washers on top bolts with prevailing torque nuts (included in Kit). Hand tighten nut. Do not torque yet.
- 🔑 Prevailing torque nut Qty:4 PN: 9422298. No washer required here.

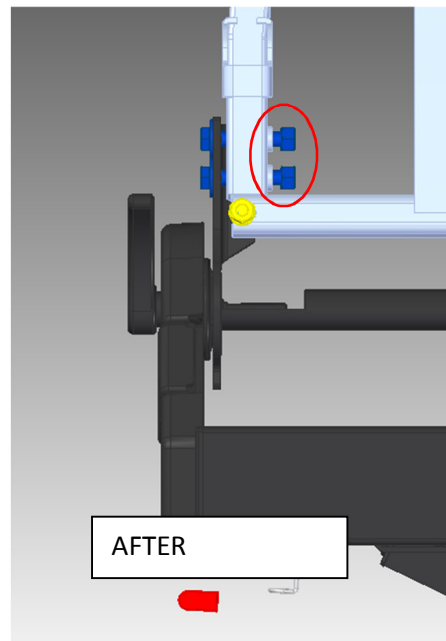
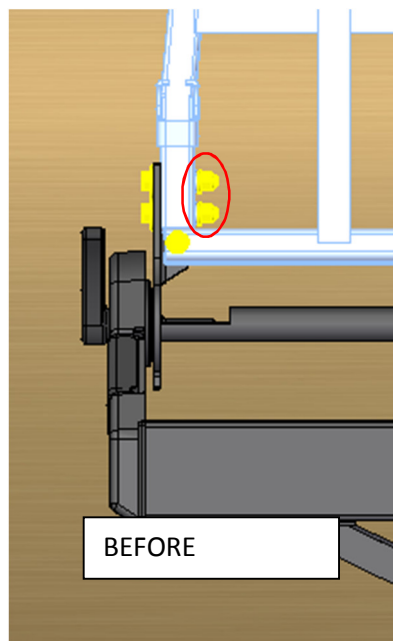

Spacer Installation

Step 6

- Replace bottom 3/8 bolts with 5/16-18 bolt, washer, and nut included in the kit. Add a 3/8 washer-spacer between the frames on the **WALL SIDE ONLY**. Hand tighten nut.

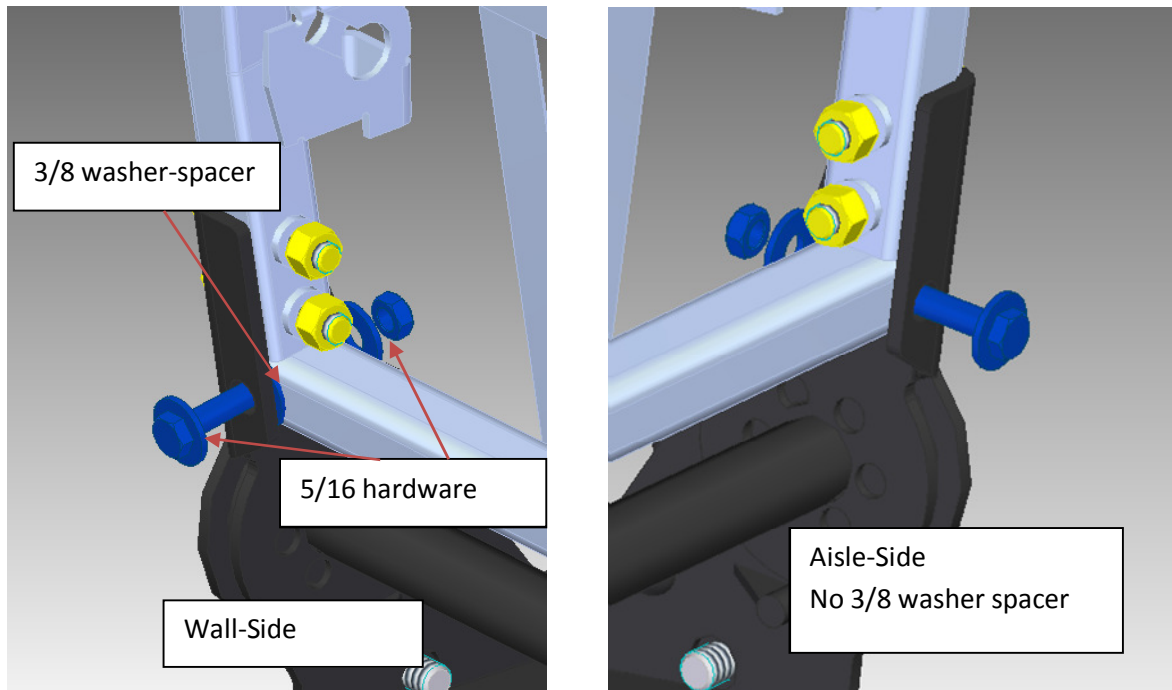

Step 7

- Use handle to unlock seatback and move it halfway between in-use and closed positions. Release handle.

Step 8

- With handle released move seatback up until recliners on both sides lock completely. NOTE: For this step you may need to wiggle seatback near in-use position to make sure both recliner mechanisms lock.

Spacer Installation

Step 9

- Fill gap between seat base and back frame using included spacers in the kit.

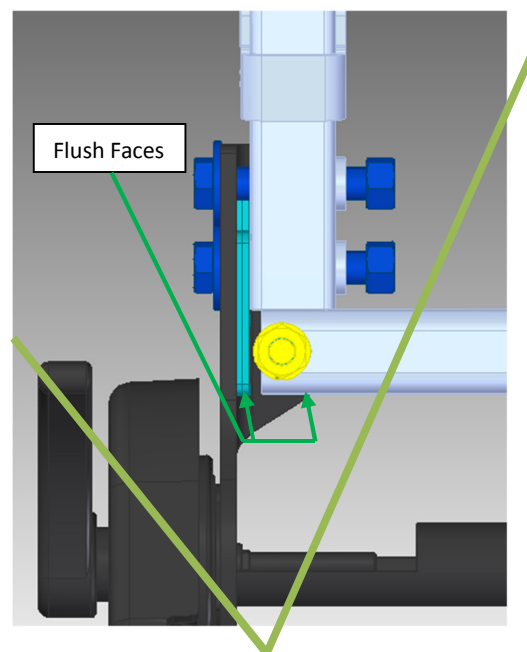
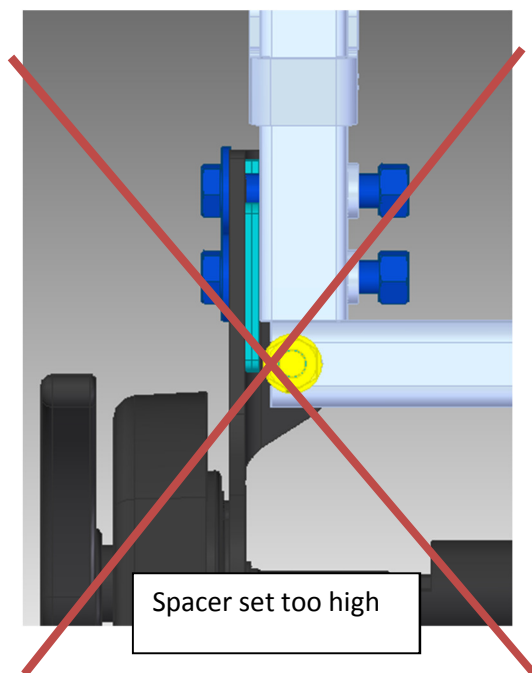
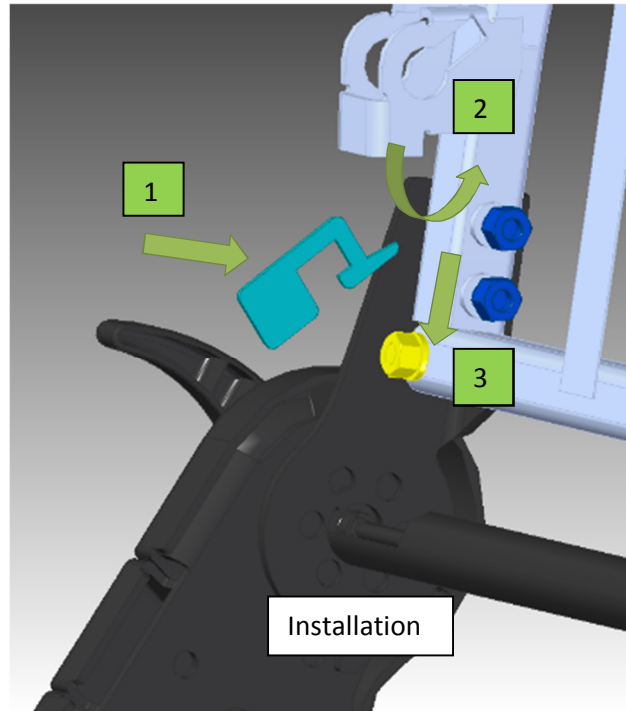

Spacer Installation

Step 10

- Torque bottom bolts until snug + 1 turn.

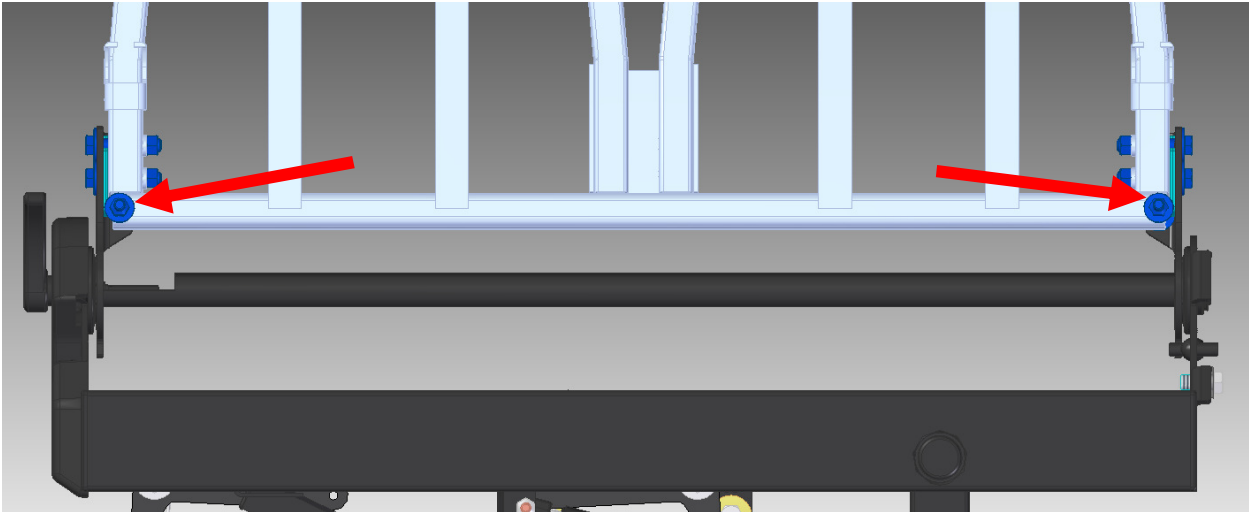

Step 11

- Check if seatback locks freely and pivots with relatively low effort. If seatback function is good, continue to step 13. Otherwise see **Step 12**.

Step 12 Do this only if seatback does not function after step 11.

- Remove 3/8 washer-spacer from step 6. Retighten bolts and test seat again.
- If seatback still does not function place the washer-spacer on the aisle side of the frame. Retighten bolts and test seat again.

Step 13

- Torque side facing bolts to 44 ft-lbs.

Stop Block Installation

DO NOT INSTALL STOP BLOCK IF INDEX PIN IS NOT BENT

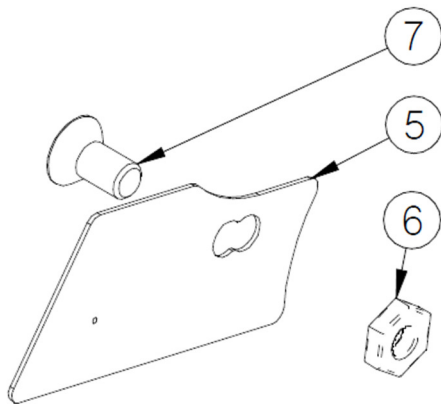
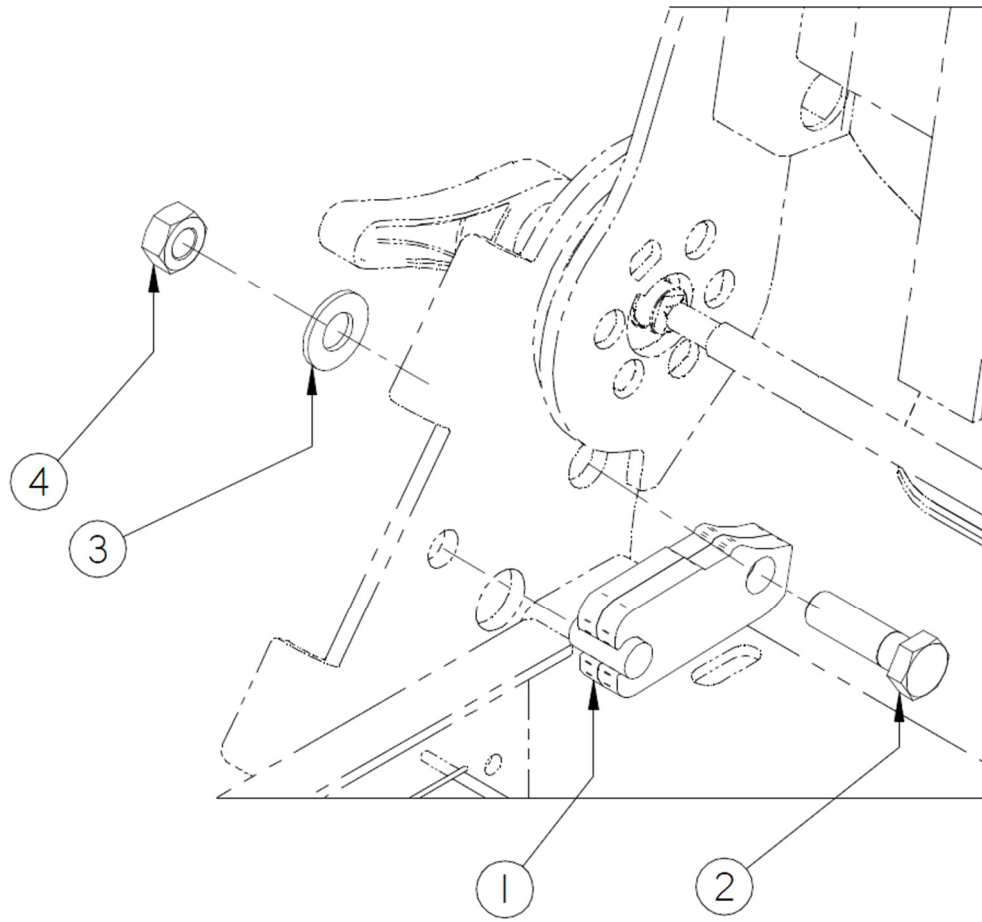

PARTS LIST BLOCK KIT 44198			
ITEM	QTY	PART #	DESCRIPTION
1	1	44197-IX	WELDMENT STOP RETROFIT
2	1	9906-000042-001	3/8-16UNC x 1-1/4 HHCS,G8,ZP,YEL
3	1	120394	3/8" ID, 13/16" OD FLAT WASHER, SAE, ZP
4	1	9422277	3/8-16UNC, PREV TORQUE, G5, ZP
5	1	44217-IN	PLATE, DRILL LOCATOR GO-ES RETROFIT
6	1	9906-000057-000	3/8-16 HEX JAM NUT, G5, ZP
7	1	99443	3-8-16 X 3/4 FLAT HEAD SOCKET

*Stop Block Installation***Step 14 SKIP THIS STEP IF INDEX PIN IS NOT BENT**

🔑 Is the pinhole present in the sidebracket?

- Yes: Skip to Step 17.
- No: Proceed to Step 15.

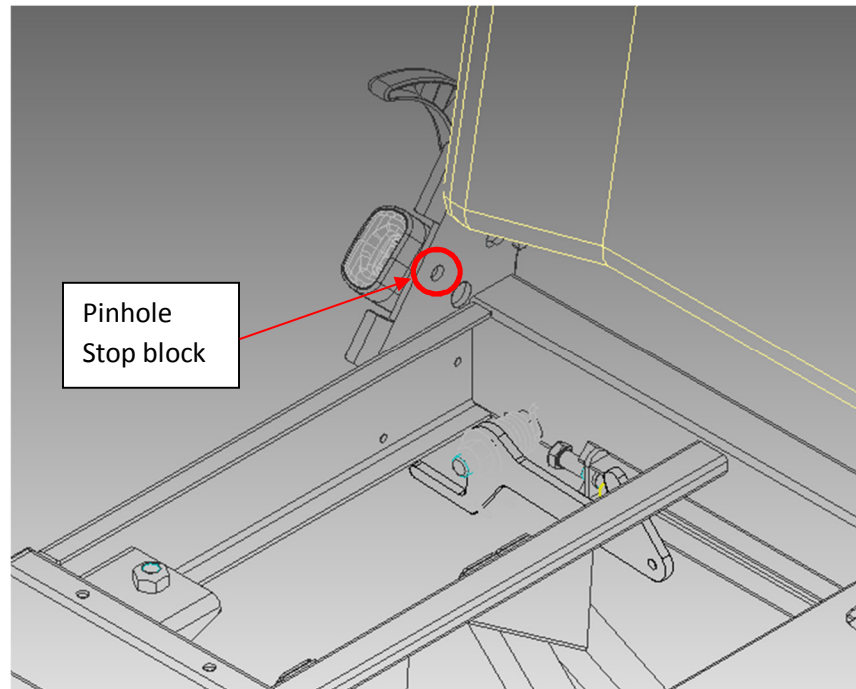
**Step 15 SKIP THIS STEP IF INDEX PIN IS NOT BENT**

➤ Remove aisle side buckle.

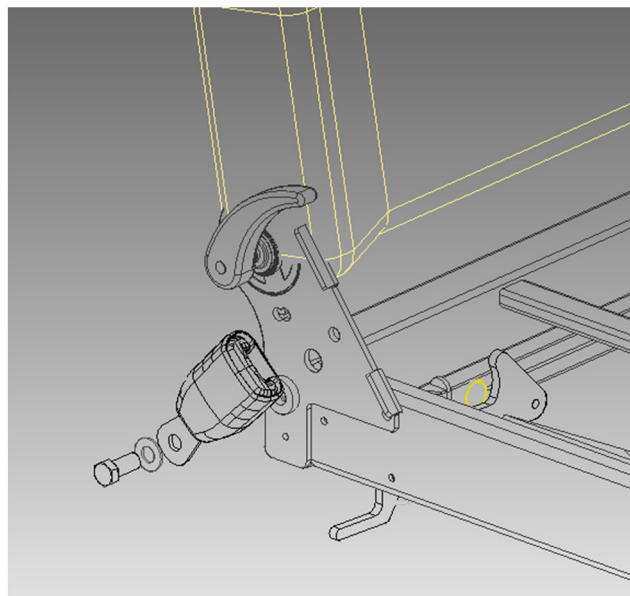

Stop Block Installation

Step 16 **SKIP THIS STEP IF INDEX PIN IS NOT BENT**

- Align drill plate to the seat's side and secure using included hardware. (Items 5, 6, and 7).
- Use a 1/16" drill bit to start hole at appropriate location.
- Remove drill plate.
- Drill 7/16 diameter hole.

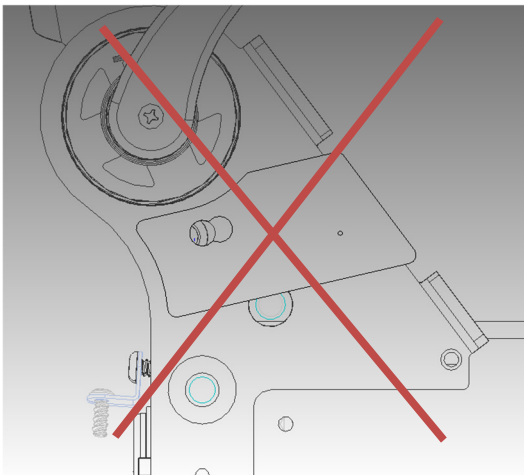
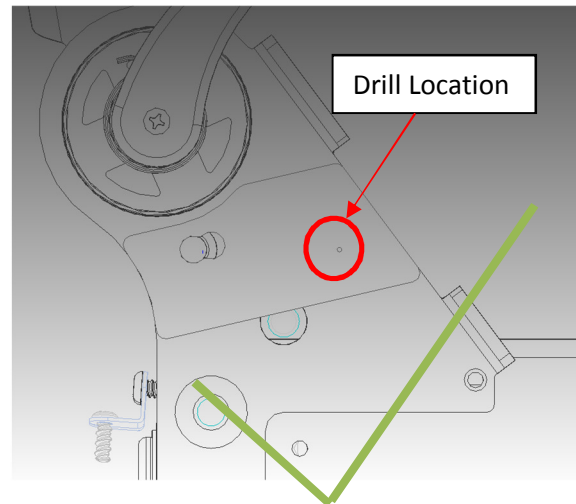
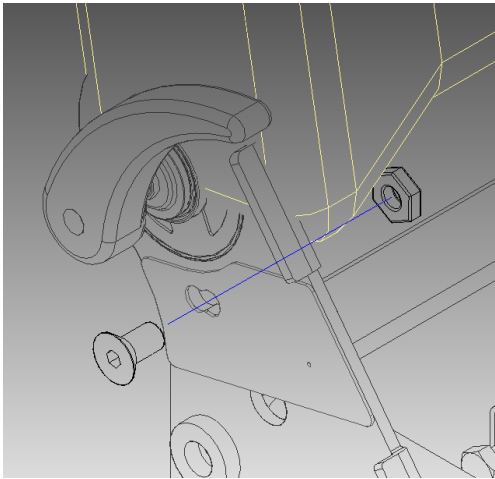

Match edges

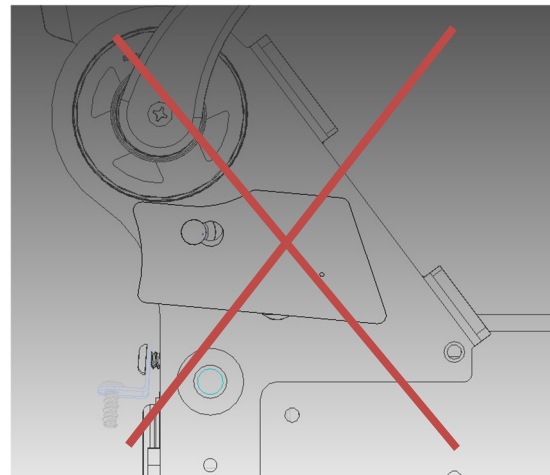

Do not skew

Stop Block Installation

Step 17 **SKIP THIS STEP IF INDEX PIN IS NOT BENT**

- Install stop block using included hardware. (Items 1, 2, 3, and 4) Seatback must be locked and set to in-use position when installing the block.
- Torque to 31 ft-lbs.

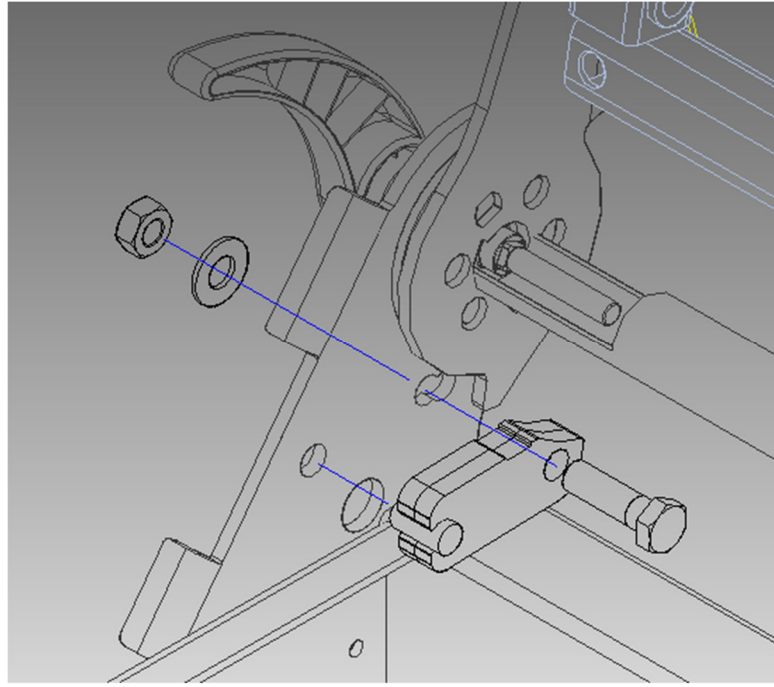

Step 18 **SKIP THIS STEP IF BUCKLE WAS NOT REMOVED**

- Reinstall wall side buckle. **Apply medium strength thread-locking compound to 7/16 bolt.**
- Torque to 60 ft-lbs.

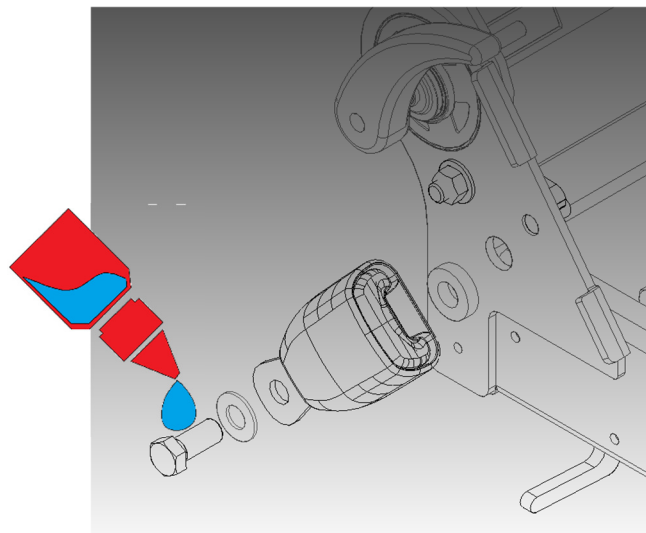

Step 19

➤ Perform seat back lock inspection:

🔑 Video showing inspection: <https://www.freedmanseating.com/instructions/go-es-foldaway>

- A. Rotate seatback to in-use position. Does it take significant effort to rotate? *No = Pass*
- B. Set the seatback between the in-use and locked positions and release handle. Slowly move seatback to in-use position.
 - Does recliner make an audible click noise indicating it is locked? *Yes = Pass*
 - Does recliner handle rotate all the way down in one motion? *Yes = Pass*
- C. Apply forward and backward pressure to seatback. Does seatback remain locked? *Yes=Pass*
- D. Set seatback to in-use position. See video.
 1. While applying forward pressure to back of seatback, lift release handle just enough to disengage seatback. *Do not manually lift handle all the way. The position of disengagement is somewhere between the handle's locked and fully unlocked position.*
 2. Release handle and move seatback back and forth near the in-use position.
 - i. Does it sound/feel like the mechanism is ratcheting? *No = Pass*
 - ii. Does it take significant effort to rotate seatback? *No = Pass*

In the case this procedure does not work please contact Customer Service:

Email: PartsDept@freedmanseating.com

Email Subject Must Contain: _GO-ES Foldaway Seat Recall

Seat Recall Form must be complete and attached

Terry Gogins
Customer Service Department
773-524-2440 EXT 233

Anthony Lee
Customer Service Department
773-524-2440 EXT 311

Find this and related documents here:

<https://www.freedmanseating.com/instructions/go-es-foldaway>

Warning Label Application

Clean seat frame in appropriate location and apply warning label (FSC PN: 94898) to approximate location as shown.

