



Service Bulletin

American Honda Motor Co., Inc.

Monkey 125/A #1
ISSUED: OCTOBER 2019

ACCESSORY SAFETY RECALL

Monkey 125/A - Rear Carrier

BACKGROUND

Honda is launching a SAFETY RECALL on the accessory Rear Carrier for Monkey 125/A motorcycles due to a potential defect that may allow the Rear Carrier to break then fall off the motorcycle while riding. A Rear Carrier that falls into the roadway poses a safety hazard to other roadway users.

A replacement part will not be offered.

A refund will be provided instead of a replacement part.

Honda will notify all owners of Monkey 125/A motorcycles of this Accessory Safety Recall via letter by December 2019. Owners with a genuine Honda Rear Carrier installed on their motorcycle will be instructed to make an appointment with a Honda dealer to have the Rear Carrier removed from their motorcycle in exchange for a refund.

If a customer has a genuine Honda Rear Carrier part not installed on a motorcycle, the customer will be instructed to bring the part to a Honda dealer in exchange for a refund.

AFFECTED PART

DESCRIPTION	P/N
Rear Carrier	08L70-K0F-A00

DEALER INVENTORY

Effective immediately, **YOU MUST NOT SELL** the following Accessory Rear Carrier:

08L70-K0F-A00 - Rear Carrier (Monkey 125/A)

Make sure the above accessory is removed from any advertising by your dealership.

Dealer inventory Rear Carrier parts must be returned on an OAR (reference Parts Division **iN** message for instructions).

A Rear Carrier already installed onto a dealer-owned motorcycle must be removed. See Claim Filing Information section for claim filing instructions.

CUSTOMER OWNED PART AND REFUND INFORMATION

If a customer brings in a Monkey 125/A motorcycle with a genuine Honda Rear Carrier installed (see Part Identification section), inform the customer of the Safety Recall for the Rear Carrier, remove the Rear Carrier from the motorcycle, and issue a refund to the customer in the amount of \$204.00 in exchange for the part. This price reflects MSRP plus 10% sales tax.

If a customer brings in a genuine Honda Rear Carrier part, without a motorcycle, issue a refund to the customer in the amount of \$204.00 in exchange for the part, and **be sure to obtain the motorcycle's VIN from the customer** for warranty claim filing.

If the customer has an original receipt for the purchase of the part, and the amount is more than \$204.00, call Warranty for claim filing assistance.

DEALER REPAIR RESPONSIBILITY

- Repairs must be performed by a qualified technician.
- Performing this repair exactly as shown in Repair Procedure instructions is critical for the remedy to be effective. Carefully follow all instructions.
- Service Management should inspect and confirm the repair.
- Dealer submission of a warranty claim affirms this repair was properly performed.

Monkey 125/A #1
ISSUED: OCTOBER 2019

PARTS INFORMATION

There were two small washers removed during the installation of the Rear Carrier. These small washers **MUST BE** reinstalled onto the motorcycle after removing the Rear Carrier.

The two large washers in the assembly may have been deformed during installation of the Rear Carrier. Replace these large washers **ONLY** if deformed, otherwise reuse.

DESCRIPTION	P/N	QTY
Washer, small	90465-MM9-000	2
Washer, large*	90501-KWW-640	2

*Only replace if deformed, otherwise reuse.

CLAIM FILING INFORMATION

After removing a genuine Honda Rear Carrier from a motorcycle, or upon receipt of a customer-returned genuine Honda Rear Carrier part, immediately submit one template claim using the appropriate template information below (see Template Warranty Claim Filing Instructions for help filing this claim).

NOTE: Dealer inventory parts (never installed) are returned on an OAR. **DO NOT** file a template claim for these parts.

- Submit template claim **KK5A** if your dealership removed the accessory Rear Carrier from a motorcycle (either a customer owned or dealer owned unit).
- Submit template claim **KK5B** if the accessory Rear Carrier part was brought in by a customer, already removed from the motorcycle.

NOTE: Be sure to obtain the motorcycle’s VIN for warranty claim filing.

MODEL	TEMPLATE	FRT	SUBLET
Monkey 125/A	KK5A	0.4	\$204.00
Monkey 125/A	KK5B	0.2	\$204.00

WARRANTY QUESTIONS

If you have any warranty administration questions relating to template claims and claim filing procedures, please contact:

Motorcycle Warranty Online:
iN > Service > Warranty & HondaCare > Warranty Connect

Or call (800) 421-1900, option 7.

TECHNICAL QUESTIONS

If you have any technical questions relating to the repair procedure, please contact:

Motorcycle TechLine Online:
iN > Service > TechLine > TechLine Connect
 Or call (800) 421-1900, option 9.

PART IDENTIFICATION

Before removing any Rear Carrier from a Monkey 125/A motorcycle, inspect the Rear Carrier to ensure the part is a genuine Honda Rear Carrier, not an aftermarket accessory. This Service Bulletin only applies to a genuine Honda Rear Carrier (See image).



PART REMOVAL PROCEDURE

Refer to the instructions below to remove the Rear Carrier from the motorcycle and return the motorcycle to its original condition.

Rear Carrier Removal

1. Remove two socket head bolts. Remove the seat (as shown).

NOTICE: Be careful not to scratch the fuel tank when removing the seat.

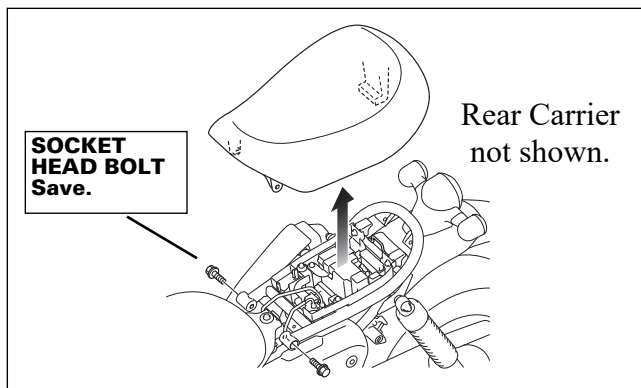

2. Remove two cap nuts, two large washers, and two 8 mm flange bolts (as shown).

NOTE: If the two large washers are deformed, replace them with new washers (see Parts Information). If not deformed, reuse.

NOTE: Discard the two 8 mm flange bolts. Do not reinstall on the motorcycle.

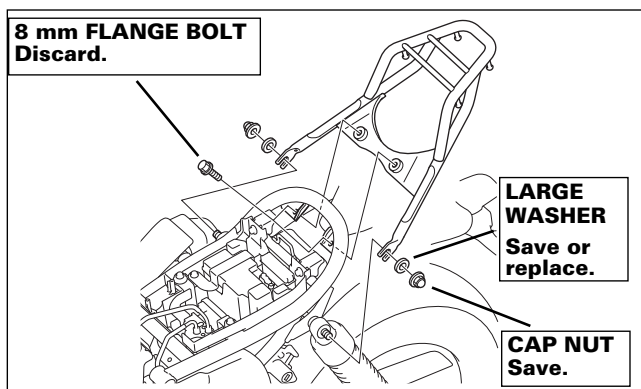

Motorcycle Reassembly

1. Install two large washers, two small washers, and two cap nuts in the order shown. Tighten the cap nuts to the specification shown below.

Torque: 21 lbf·ft (3.0 kgf·m, 29 N·m)

NOTE: The two small washers were removed during installation of the Rear Carrier. These **MUST BE** reinstalled (see Parts Information).

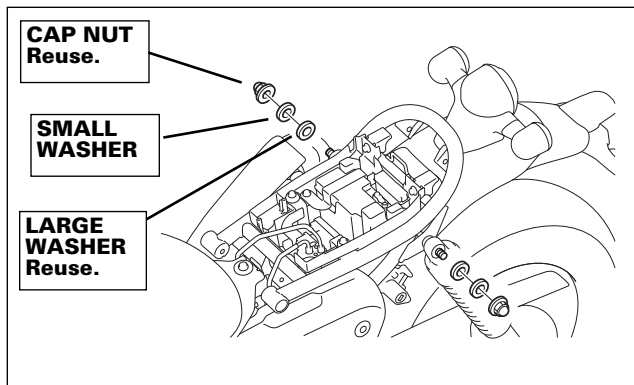

2. Reinstall the seat in the reverse order of removal.

NOTICE: Be careful not to scratch the fuel tank when reinstalling the seat.

TEMPLATE WARRANTY CLAIM FILING INSTRUCTIONS

• = Required

Template Warranty Claim

Template Number•				KK5	
Basic Claim Information (required for all claim types)					
Claim No. •	333333	Repair Order Number •	123456		
VIN •		Repair Order Date (open) •	10	09	2019
Mileage •	1111	Work Completed Date •	10	09	2019
Sublet Involved? •	YES ▾	Sublet Information			
Sublet Description •	OTHERS ▾	Invoice Number •	123456	Amount •	204.00
Submitted Dealer Warranty Claim Calculation					
Parts Cost		Labor Amount			
Parts Allowance	0.00				
Sublet Amount		Submitted Claim Total			

- Enter the required Template Number
- Sublet Involved?, choose YES
- Sublet Description, choose OTHERS
- For Invoice Number, enter the RO number, or sales Receipt/Invoice number
- Enter \$204.00 in the Amount
- Submit claim

NOTE: Do not enter any amounts in the Parts Cost or Labor Amount areas.
These number are calculated by iN after submitting the claim.
Entering amounts here can cause your claim to be rejected.

TEXT OF CUSTOMER LETTER

Text of Customer Letter is forthcoming.