



Procedure for 421220 Control Head Replacement

Scope:

This procedure defines how to replace a control head on a 421220 fire extinguisher.

Tools:

1. Torque Wrench, 135 in-lbs with 1/2" socket
2. Ratchet with 1/2" socket
3. 1/2" Box Wrench
4. 5/8" Box Wrench

Parts:

Description	Part #
Replacement Control Head Kit	477324

PROPRIETARY NOTICE

THIS DOCUMENT IS THE PROPERTY OF UTC AEROSPACE SYSTEMS. YOU MAY NOT POSSESS, USE, COPY OR DISCLOSE THIS DOCUMENT OR ANY INFORMATION IN IT, FOR ANY PURPOSE, INCLUDING WITHOUT LIMITATION, TO DESIGN, MANUFACTURE OR REPAIR PARTS, OR OBTAIN ANY GOVERNMENT APPROVAL TO DO SO, WITHOUT UTC AEROSPCE SYSTEMS' EXPRESS WRITTEN PERMISSION. NEITHER RECEIPT NOR POSSESSION OF THIS DOCUMENT ALONE, FROM ANY SOURCE, CONSTITUTES SUCH PERMISSION. POSSESSION, USE, COPYING OR DISCLOSURE BY ANYONE WITHOUT UTC AEROSPACE SYSTEMS' EXPRESS WRITTEN PERMISSION IS NOT AUTHORIZED AND MAY RESULT IN CRIMINAL AND/OR CIVIL LIABILITY.

EAR NOTICE

SUBJECT TO THE EAR, ECCN [EAR99].

THIS INFORMATION IS SUBJECT TO THE EXPORT CONTROL LAWS OF THE UNITED STATES, SPECIFICALLY INCLUDING THE EXPORT ADMINISTRATION REGULATIONS (EAR), 15 C.F.R. PART 730 ET. SEQ. TRANSFER, RETRANSFER, OR DISCLOSURE OF THIS DATA BY ANY MEANS TO A NON-U.S. PERSON (INDIVIDUAL OR COMPANY), WHETHER IN THE UNITED STATES OR ABROAD, WITHOUT ANY REQUIRED EXPORT LICENSE OR OTHER APPROVAL FROM THE U.S GOVERNMENT IS PROHIBITED, INCLUDING WITHOUT LIMITATION ANY DIVERSION TO A MILITARY END USER OR USE IN A MILITARY END USE APPLICATION.



Procedure:

1. Verify the fire system is **NOT** in a fire alarm condition and the system is indicating an “OK” status.
2. Disconnect the extinguisher’s electrical connection from the fire system.
3. If the distribution piping is disconnected from the extinguisher’s outlet port, install the anti-recoil cap on the outlet port.
4. If necessary, loosen the mounting clamps and remove the extinguisher.

NOTE: Ensure the extinguisher is properly secured before beginning work.



DANGER: Pressing the valve stem may cause an accidental discharge. Avoid pressing the valve stem during the control head removal and reinstallation process.

CAUTION: When the control head is removed from the extinguisher, critical valve components are exposed. Extreme care must be taken to not allow foreign objects to enter the valve assembly.

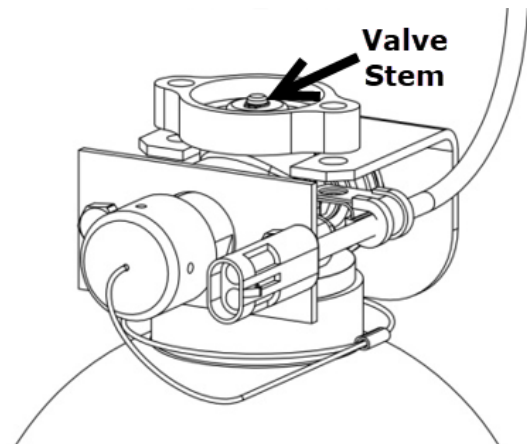



5. Remove the bolts/nuts securing the control head to the valve.
6. Remove the old control head assembly and gauge guard.
7. Set the gauge guard aside for reuse.

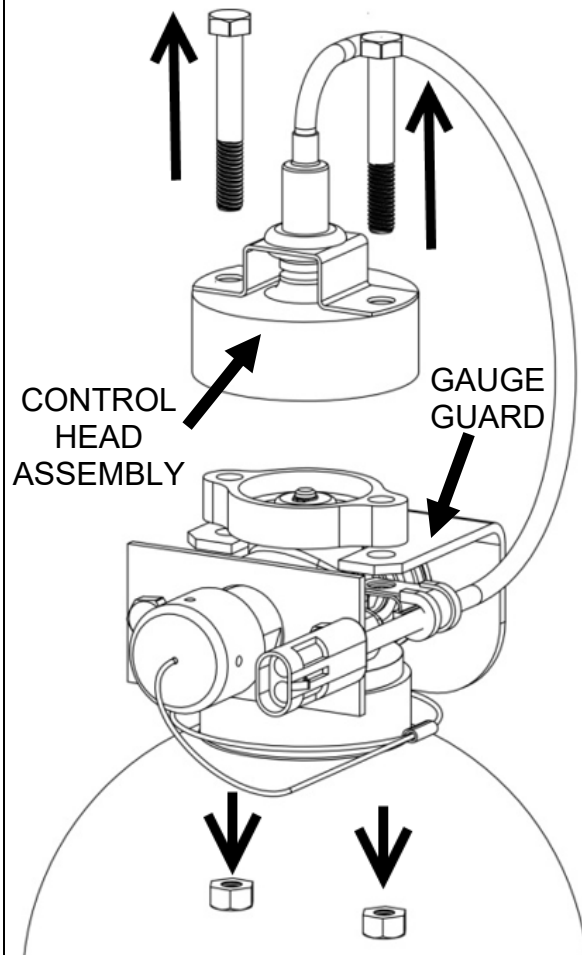



8. Verify the piston on the new control head is **NOT** in the actuated (out) position.
9. Ensure the control head O-ring is in place, and place the control head assembly onto the valve.

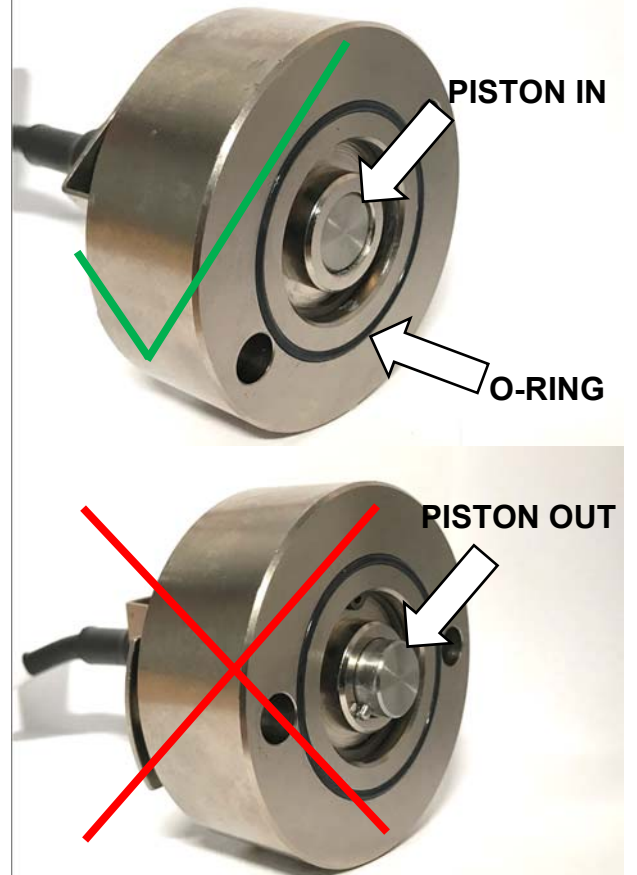



10. Thread the new bolts through the actuator shield, control head, valve and gauge guard. One of the bolts should also be threaded through the actuator cable clamp.
11. Hand tighten the new nuts on the new bolts.
12. Torque the bolts/nuts to 135 in-lbs.

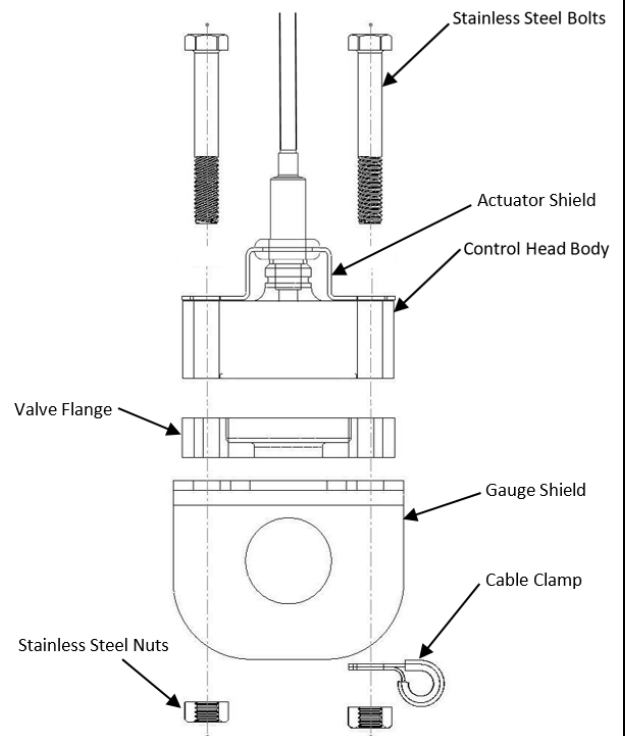
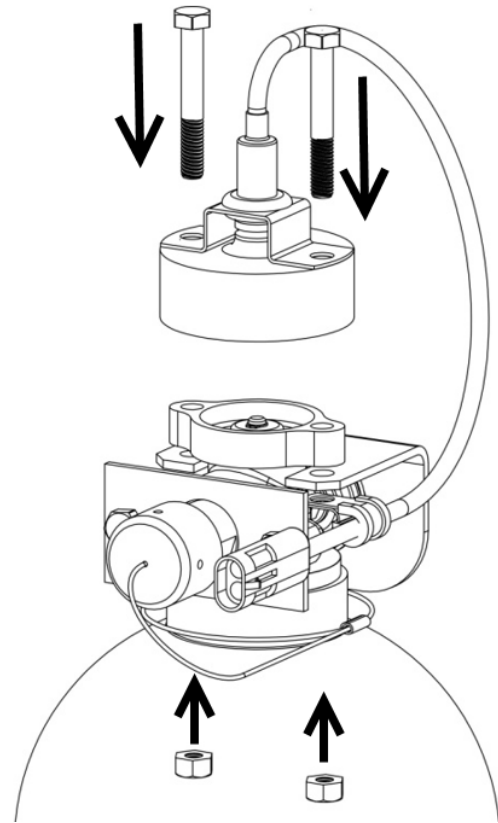



- 13. Verify the fire system is **NOT** in a fire alarm condition.
- 14. If the extinguisher was removed, reinstall the extinguisher in the mounting bracket, orient per the instructions on the extinguisher nameplate, and tighten the two mounting clamps to 20 ft-lbs (nominal).
- 15. If the extinguisher was disconnected from the distribution piping, remove the anti-recoil cap from the extinguisher's outlet port and immediately reconnect the distribution piping.
- 16. Reconnect the extinguisher's electrical connection to the fire system and verify the system is indicating an "OK" status.



Revision History

Revision	Date	Preparer	Comments
A	Dec. 4, 2018	ACR	
B	Dec. 9 2018	ACR	Added anti-recoil cap and extinguisher installation and removal statements