

TECHNICAL INSTRUCTIONS
FOR
SAFETY RECALL J0W
AIRBAG(S) AND SEAT BELT PRETENSIONER(S) INADVERTENTLY DEPLOY
OR MAY BECOME DEACTIVATED
CERTAIN 2004 – 2006 MODEL YEAR SCION xA

The repair quality of covered vehicles is extremely important to Toyota. All dealership technicians performing this recall are required to successfully complete the most current version of the E-Learning course “Safety Recall and Service Campaign Essentials”. To ensure that all vehicles have the repair performed correctly; technicians performing this recall repair are required to currently hold at least one of the following certification levels:

- Certified Technician (Electrical)
- Expert Technician (Electrical)
- Master Technician
- Master Diagnostic Technician

It is the dealership’s responsibility to select technicians with the above certification level or greater to perform this recall repair. Carefully review your resources, the technician skill level, and ability before assigning technicians to this repair. It is important to consider technician days off and vacation schedules to ensure there are properly trained technicians available to perform this repair at all times.

I. OPERATION FLOW CHART

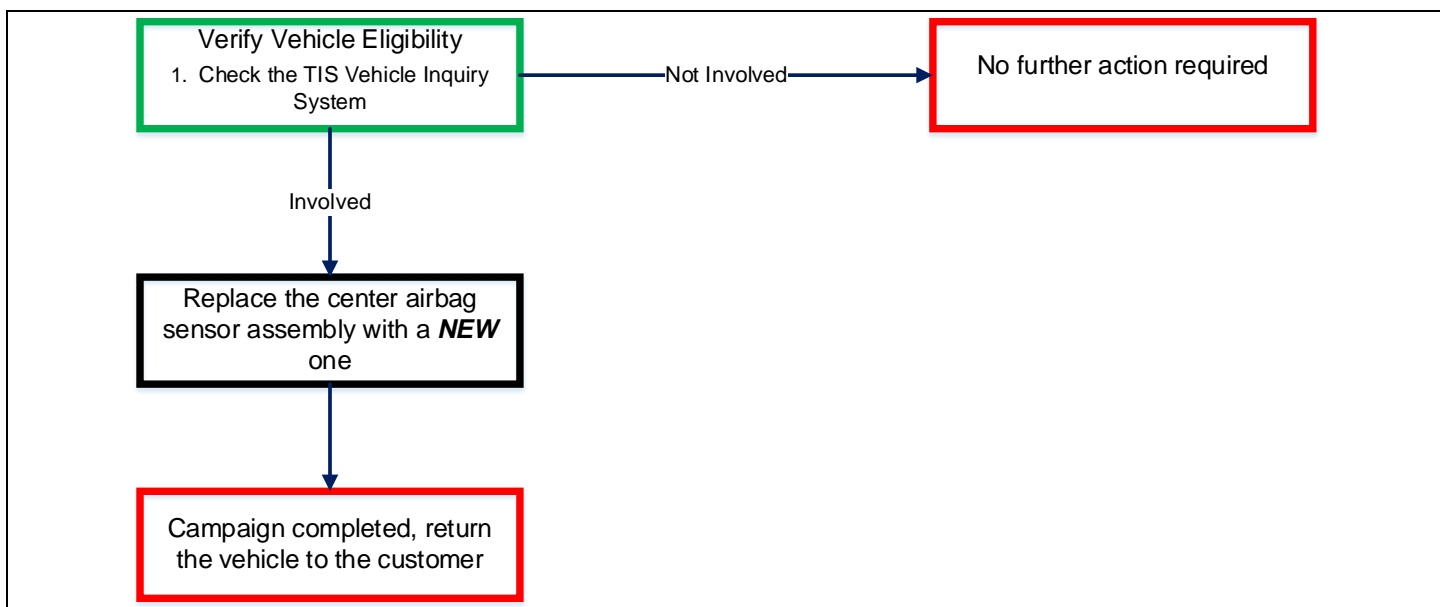

II. IDENTIFICATION OF AFFECTED VEHICLES

- Check the TIS Vehicle Inquiry System to confirm the VIN is involved in this Safety Recall, and that it has not already been completed prior to dealer shipment or by another dealer.
- TMS warranty will not reimburse dealers for repairs completed on vehicles that are not affected or were completed by another dealer.

III. PREPARATION

A. PARTS

Part Number	Part Description	Quantity
04008-29352	Air Bag Sensor Assembly	1

B. TOOLS & EQUIPMENT

- Techstream
- Molding Remover
- Standard Hand Tools
- Torx Socket Wrench (T30)
- Torque Wrench
- Torx Socket Wrench (T40)

SST – These Special Service Tools required for this repair:

Part Number	Tool Name	Quantity
09950-50013	Puller C Set *	1
*The set above includes the following tools:		
Part Number	Part Name	Quantity
09951-05010	Hanger 150	1
09952-05010	Slide Arm	2
09953-05020	Center Bolt 150	1
09954-05021	Claw No.2	2

C. MATERIALS

- Protective Tape
- Marker Pen

IV. BACKGROUND

The airbag system in the subject vehicles could experience electrical shorting that could damage the circuits in the system. This could cause the airbag warning lights to illuminate and the airbag(s) and seat belt pretensioner(s) to become deactivated, or it could cause those systems to inadvertently deploy. These conditions can increase the risk of injury or crash.

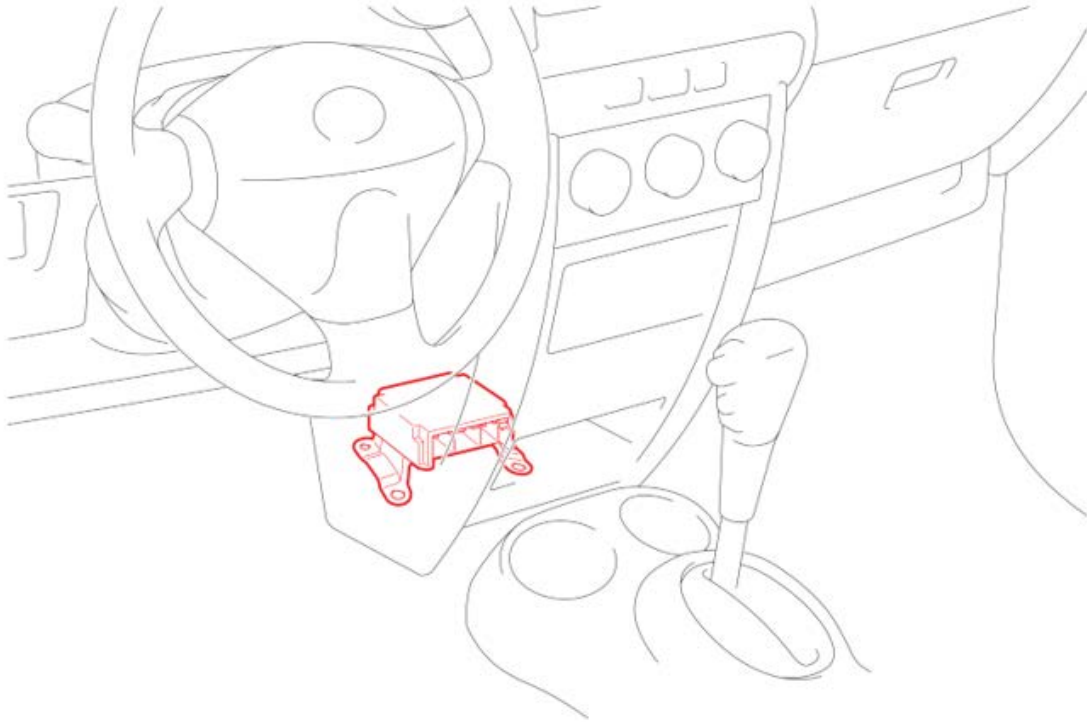

R1810030011

V. CENTER AIRBAG SENSOR ASSEMBLY REPLACEMENT COMPONENTS

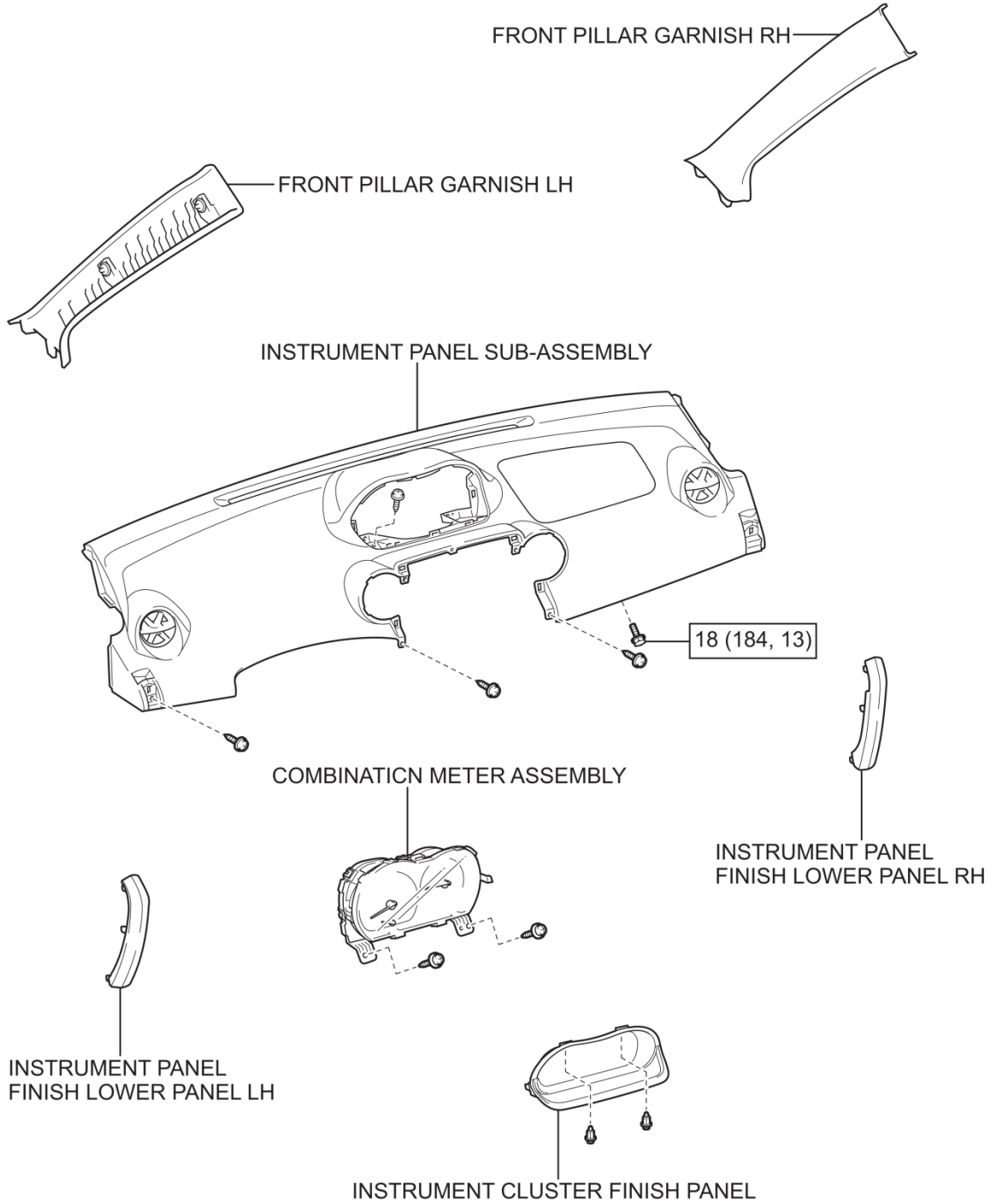

N*m (kgf*cm, ft.*lbf) : Specified torque

R1810030012

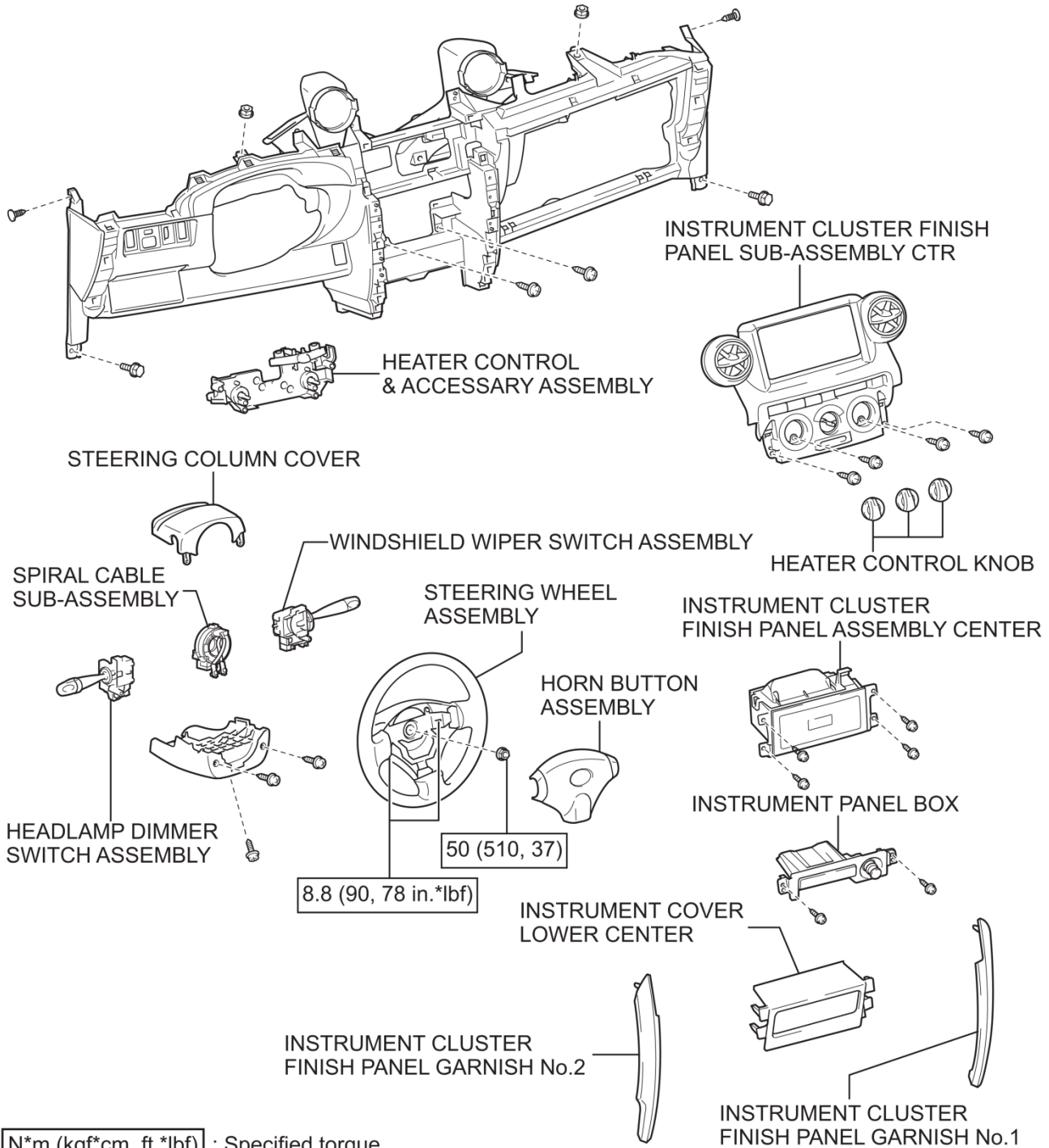
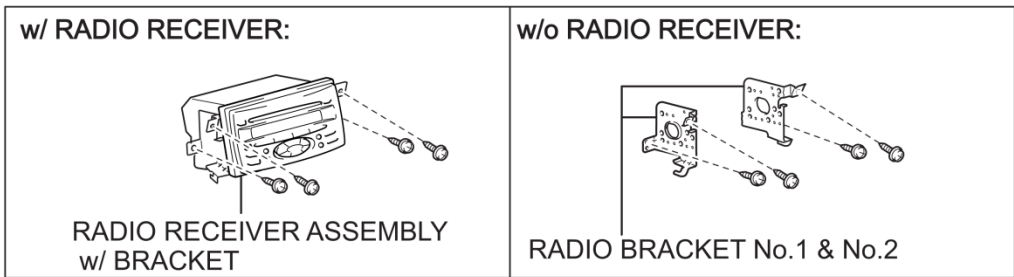

N*m (kgf*cm, ft.*lbf) : Specified torque

R1810030013

INSTRUMENT PANEL SUB-ASSEMBLY LOWER

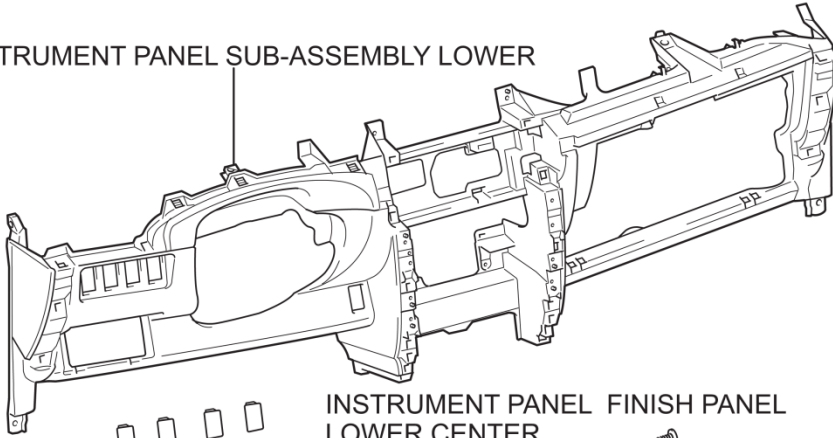

GLOVE COMPARTMENT DOOR ASSEMBLY

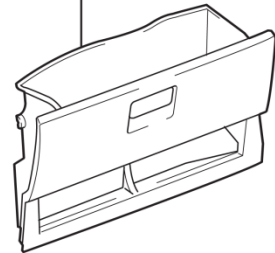

INSTRUMENT PANEL FINISH PANEL LOWER CENTER



FUSE BOX OPENING COVER

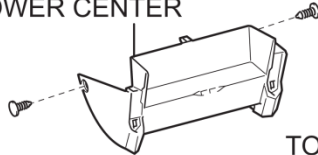

TORX BOLT
20 (204, 15)

TORX BOLT
20 (204, 15)

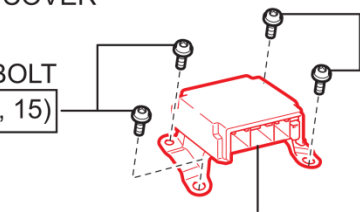

● CENTER AIRBAG SENSOR ASSEMBLY

COWL SIDE TRIM BOARD RH



COWL SIDE TRIM BOARD LH



INSTRUMENT PANEL MOUNTING BRACKET

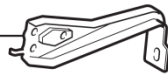

FRONT DOOR SCUFF PLATE RH

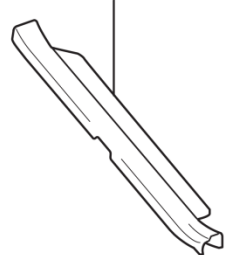

AIR DUCT REAR No.2

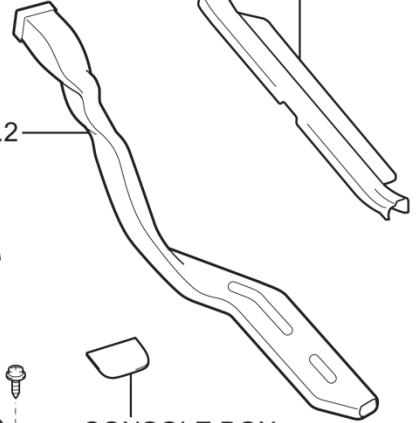

CONSOLE BOX REAR COVER



FRONT DOOR SCUFF PLATE LH

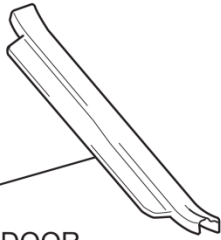

AIR DUCT REAR No.1



CONSOLE BOX ASSY REAR
(Design differ depending on the specification)

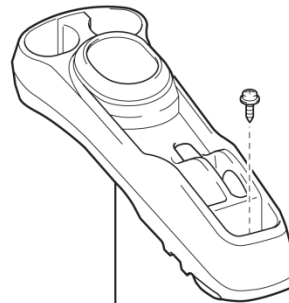

CONSOLE BOX CARPET



M/T TRANSAXLE:



SHIFT LEVER KNOB SUB-ASSEMBLY

● Replacement part

N*m (kgf*cm, ft.*lbf) : Specified torque

R1810030014

VI. WORK PROCEDURE



1. CHECK FOR DTC'S

- a. Using a Techstream, check for Diagnostic Trouble Codes.

Note: *This Safety Recall covers only the air bag ECU replacement, as detailed in these instructions. It does not cover the diagnosis or replacement of any other parts on the vehicle.*

2. DISCONNECT THE NEGATIVE BATTERY CABLE



- Wait at least 90 seconds after disconnecting the cable from the negative battery terminal to prevent airbag and seat belt pretensioner deployment.
- Follow all precautions as outlined on TIS before servicing the SRS system.

3. REMOVE THE CENTER AIRBAG SENSOR ASSEMBLY

[Refer to TIS for SCION xA for instructions on AIR BAG SENSOR ASSY CENTER: REMOVAL](#)

4. INSTALL THE NEW CENTER AIRBAG SENSOR ASSEMBLY

[Refer to TIS for SCION xA for instructions on AIR BAG SENSOR ASSY CENTER: INSTALLATION](#)



5. INSPECT SRS WARNING LIGHT

- a. Check that the airbag warning lamp lights when the power switch is turned on.
- b. Check that the airbag warning lamp goes off approximately 6 seconds after turning on of the ignition switch.

NOTE:

If the airbag warning lamp remains on, it is likely caused by a connection failure of the airbag connector to airbag ECU

◀ VERIFY REPAIR QUALITY ▶

- Check to make sure all trim panels have been installed correctly
- Confirm the SRS warning lamp is off

If you have any questions regarding this update, please contact your regional representative.

VII. APPENDIX

A. PARTS DISPOSAL

As required by Federal Regulations, please make sure all recalled parts (original parts) removed from the vehicle are disposed of in a manner in which they will not be reused, ***unless requested for parts recovery return.***

B. CAMPAIGN DESIGNATION DECORDER

