

September 12, 2018

Version 2

Safety Recall: High Mount Brake Light

Supersedes 18-049, dated September 8, 2018, to include the Repair Procedure, Parts Information, and Warranty Claim Information

AFFECTED VEHICLES

Year	Model	Trim	VIN Range
2017	NSX	ALL	Check the iN VIN status for eligibility.

BACKGROUND

There is an internal issue with the circuit board in the high mount brake light (center high mount brake light). This may cause all the brake lights to stop working, turn on several indicators, and the vehicle may not start. If the brake lights stop working, this may reduce the braking visibility from behind, increasing the potential risk of a collision.

CLIENT NOTIFICATION

Owners of affected vehicles will be sent a notification of this campaign.

Do an iN VIN status inquiry to make sure the vehicle is shown as eligible.

Some vehicles affected by this campaign may be in your new or used vehicle inventory.

Failure to repair a vehicle subject to a recall or campaign may subject your dealership to claims or lawsuits from the client or anyone else harmed as a result of such failure. To see if a vehicle in inventory is affected by this safety recall, do a VIN status inquiry before selling it.

CORRECTIVE ACTION

Replace the high mount brake light.

PARTS INFORMATION

Part Name	Part Number	Quantity
High Mount Brake Light Assembly	34270-T6N-A03	1
High Mount Brake Light Kit (Includes flange nuts, door lining clips, template, and cardboard shims)	06100-T6N-A00	1

CLIENT INFORMATION: The information in this bulletin is intended for use only by skilled technicians who have the proper tools, equipment, and training to correctly and safely maintain your vehicle. These procedures should not be attempted by "do-it-yourselfers," and you should not assume this bulletin applies to your vehicle, or that your vehicle has the condition described. To determine whether this information applies, contact an authorized Acura automobile dealer.

TOOL INFORMATION

Part Name	Part Number	Quantity
14 mm Rotabroach Cutter (included in the Metric Rotabroach Master Hole Cutting Kit)	BLR11201SO	1
3 mm (1/8 in.) Drill Stop Collar (commercially available)	SBS8865A132	1
Hex L-Key 3/32 in. (commercially available)	SBS7122A42	1
3 mm (1/8 in.) Drill Bit (commercially available)	SBS2901A115	1
Rear Fender Cover Set	07AAZ-T6NA200	1

NOTES

- Each dealer should have a Rotabroach kit. If you need additional kits, contact the Honda Tool and Equipment Program at **888-424-6857**.
- Each dealer received at least one 3 mm (1/8 in.) drill bit, one drill stop collar, and one hex L-key free of charge. If you need any additional drill tools, purchase them through your local tool supplier.

WARRANTY CLAIM INFORMATION

Operation Number	Description	Flat Rate Time	Defect Code	Symptom Code	Template ID	Failed Part Number
7141E4	Replace the high mount brake light (no drilling required).	0.3 hr	6SL00	B2B00	B18049A	34270-T6N-A02
7141E5	Replace the high mount brake light (drilling required).	1.2 hrs	6SL00	B2B00	B18049B	34270-T6N-A02

Skill Level: Repair Technician

REPAIR PROCEDURE

1. Open the rear hatch.
2. Disconnect the 12-volt battery using the terminal disconnection procedure. Refer to the service information.
3. Install the NSX fender covers.



4. Install another fender cover over the engine bay area. Secure the cover using automotive masking tape to the top of the rear glass area under the hatch as shown.

NOTES

- The cover prevents any hardware or tools from falling into the engine area.
- This cover is not part of the fender cover set. Use an extra cover to protect the engine area.



5. Remove the four high mount brake light mounting nuts.

- If all 4 nuts come off, go to step 6.
- If any of the nuts do not come off, the captive bolts are spinning. Go to the **High Mount Brake Light Drilling and Removal Procedure** to remove the bolts and the high mount brake light.

NOTICE

- If the nuts spin and do not come off, **stop**. Continuing to spin the nuts may damage the roof.
- **Do not try to pry the high mount brake light or the nuts.** If you try to pry the light, you may damage or bend the aluminum body.

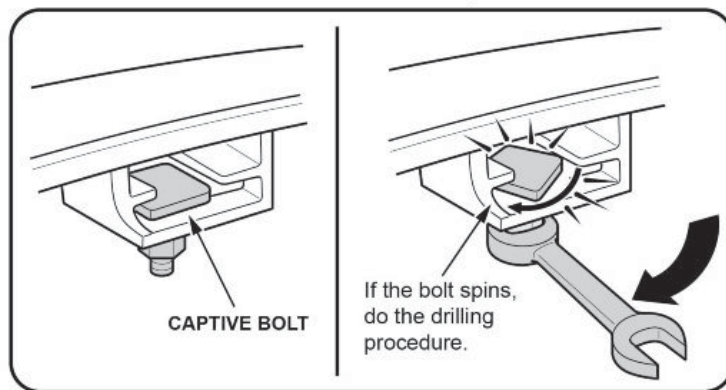
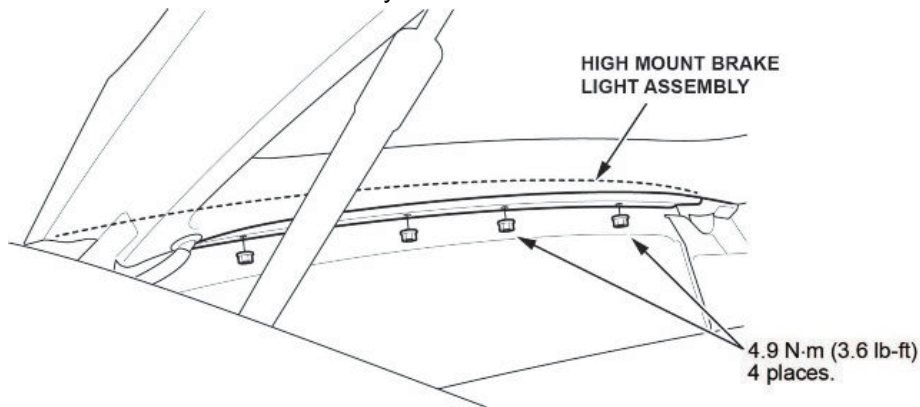

6. Remove the high mount brake light.

6.1. Close the hatch.

6.2. Before removing the high mount brake light, apply masking tape around the edges of the C-pillar and the roof to protect the paint.

Place tape on the roof along the forward edge of the high mount stop light assembly.



Place tape on the roof along the C-pillars.



6.3. Remove the high mount brake light.

NOTICE

Do not pry up on the high mount brake light face. Carefully insert the appropriate trim tool under the high mount brake light.

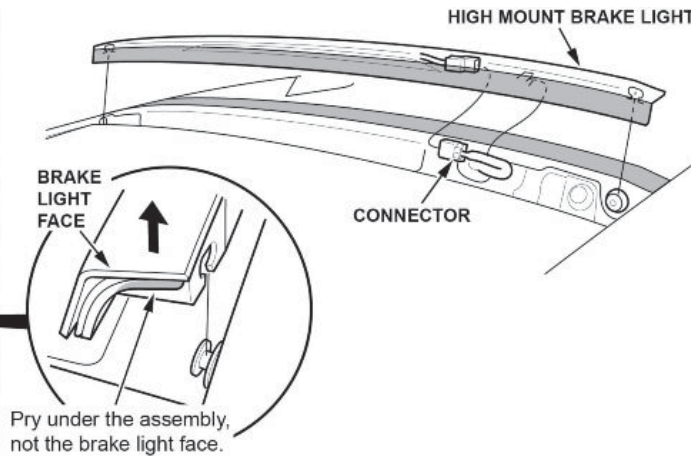

6.4. Disconnect the connector.

7. Replace the two clips indicated below.

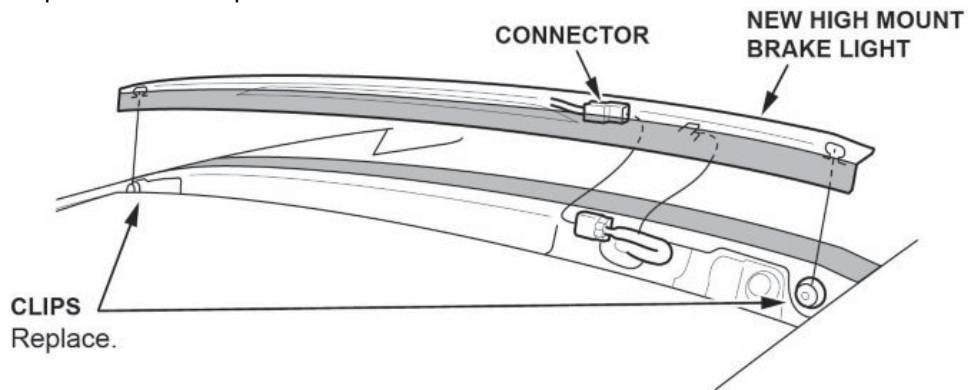

8. Install the new high mount brake light.
 - 8.1. Connect the connector.
 - 8.2. Install the high mount brake light.
 - 8.3. Install, and torque the new mounting nuts to **4.9 N·m (3.6 lb-ft)**.
9. Do the 12-volt battery terminal reconnection procedure.

High Mount Brake Light Drilling and Removal Procedure

NOTE

Use this drilling procedure only on the nuts that you could not remove.

1. Place another fender cover over the roof, and secure it with masking tape. Apply masking tape to the C pillars surrounding the perimeter of the high mount brake light.

NOTE

Make sure the windows are closed and the fender cover fully covers the engine compartment area. The drilling process creates debris that may fall into the interior or the engine compartment.

Place tape on the roof along the forward edge of the high mount brake light assembly.



Place tape on the roof along the C-pillars.

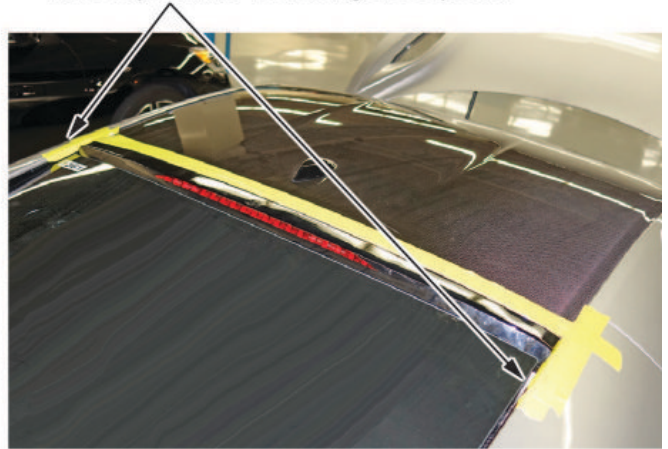

2. Close the hatch, and tape a protective cover to protect the hatch glass.

Tape a protective cover over the hatch glass.

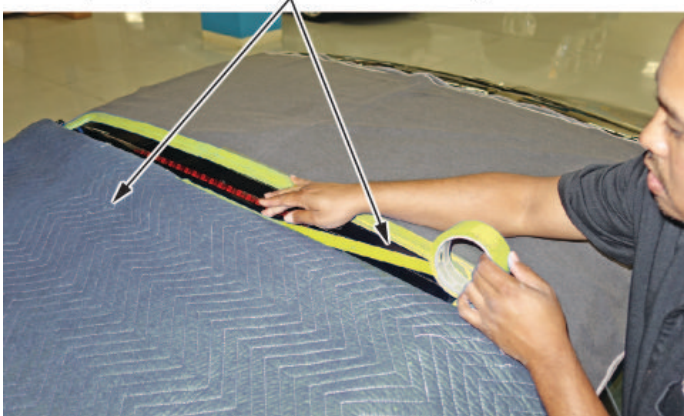

3. Using the template provided in the kit (P/N 06100-T6N-A00), line up the template with the high mount brake light.

- Make sure the edge marked **FR** faces the front of the vehicle.

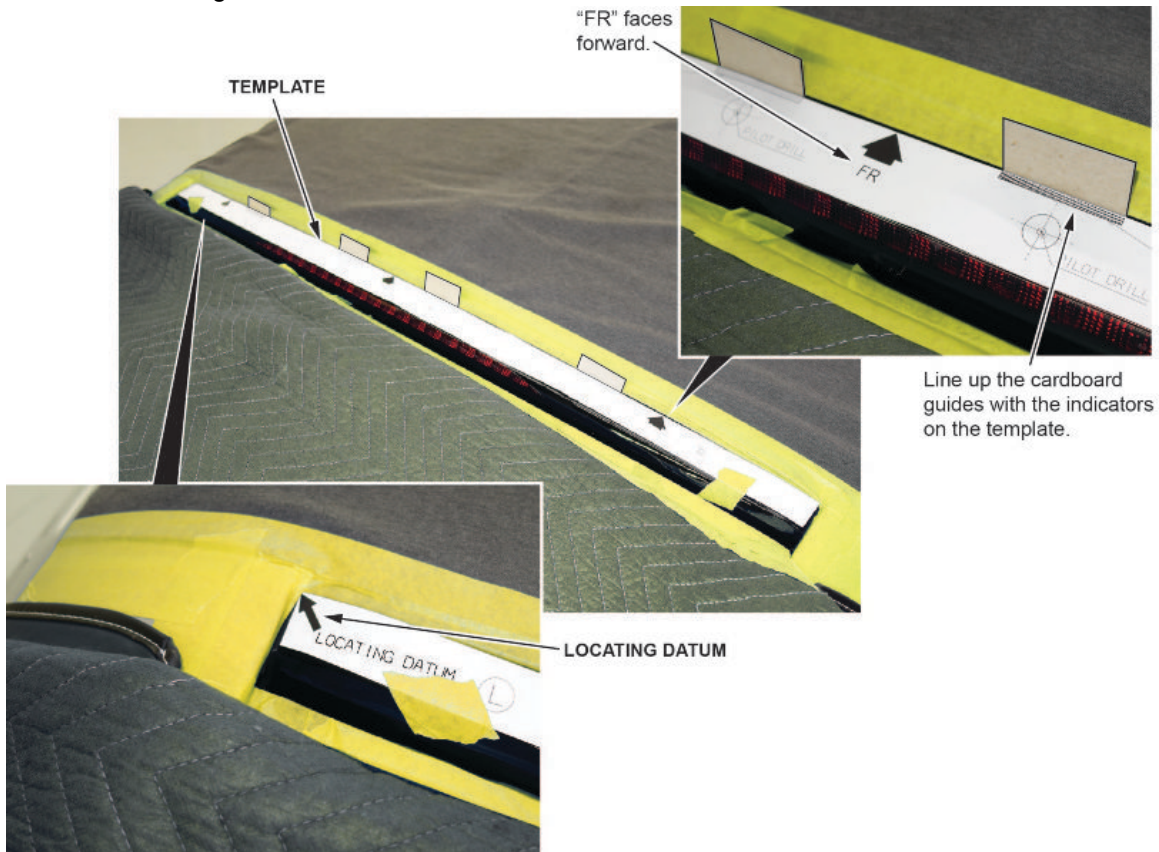

- Line up the **LOCATING DATUM** with the front left corner of the high mount brake light.
4. Insert the four cardboard guides (included in the kit) between the high mount brake light and the template where the mounting bolts are located (as indicated by the shaded parts of the template).
5. Make sure the front edge of the template contacts the cardboard guides, then secure the template with masking tape.

6. Drill the pilot hole(s) in the high mount brake light.

6.1. Place a drill collar(drill stop) on a 3 mm drill bit. Secure the collar **11 mm** from the cutting tip.

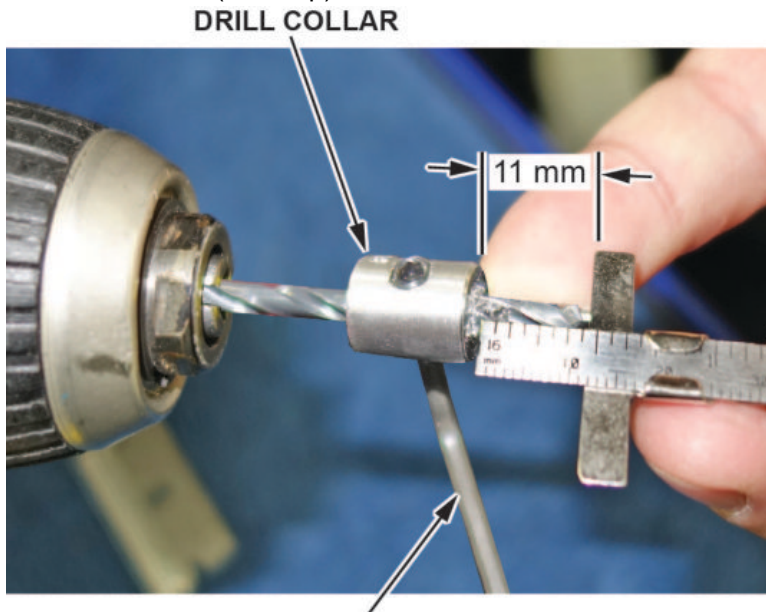

ALLEN WRENCH
Tighten the collar.

6.2. Carefully drill a hole in the center of the applicable holes marked on the template.

NOTES

- Only drill the holes where you could not remove the nut.
- The high mount brake light is made of thin, soft plastic. Do not use a lot of force as the drill bit will cut through the material easily.
- Do not drill deeper than **11 mm** as you may damage the body.

Above each nut that would not loosen,
drill pilot holes at the points marked on the template.

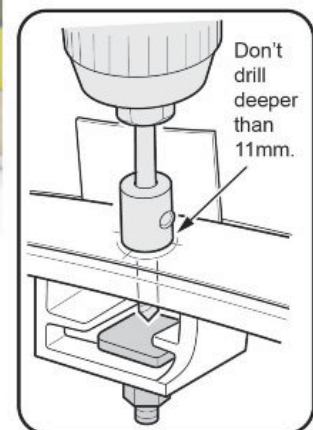
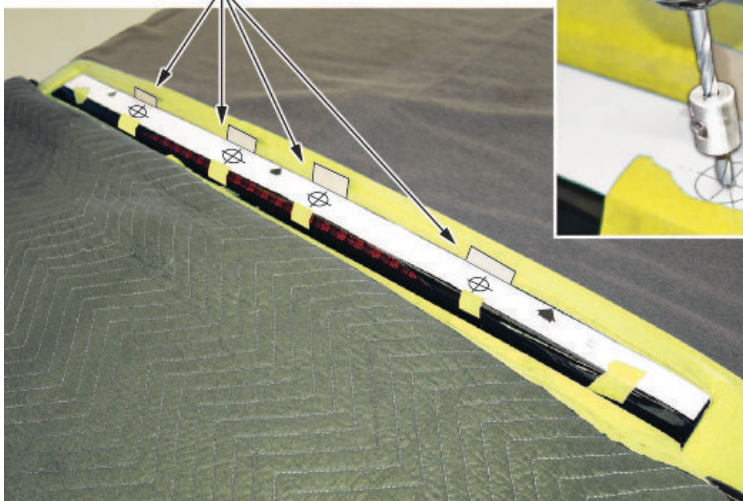

6.3. Remove the template.

- 6.4. If you are drilling either of the **outer nuts** on the high mount brake light (holes closest to the C-pillar) follow these steps:

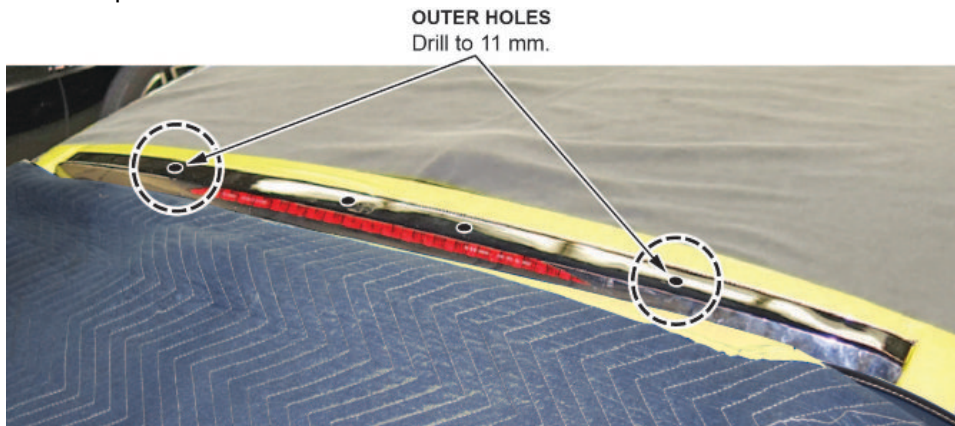

- 6.4.1. Install the two stop washers in the Rotabroach kit. Measure and confirm that the distance between the cutting edge of the Rotabroach bit and washers is **23 mm**.
- 6.4.2. Create a soft depth gauge on the 14 mm Rotabroach bit by wrapping it with tape. Wrap the tape **11 mm** from the cutting edge of the Rotabroach bit.
- 6.4.3. Carefully drill the hole to a depth of **11 mm**.

NOTE

Drilling the outer holes deeper than 11 mm may cause damage to the body.

AT THE OUTER HOLES:

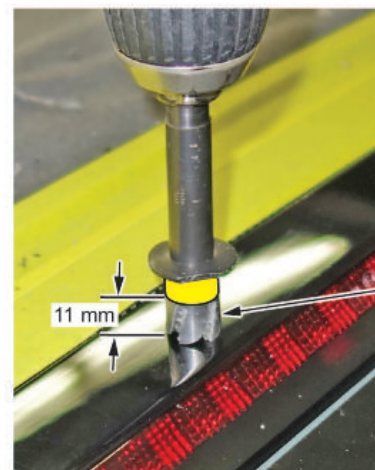
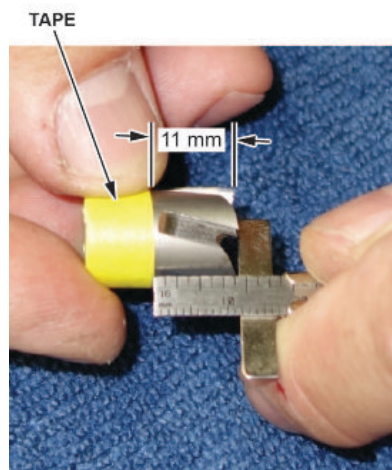

6.5. If you are drilling either of the **inner nuts** on the high mount brake light follow these steps:

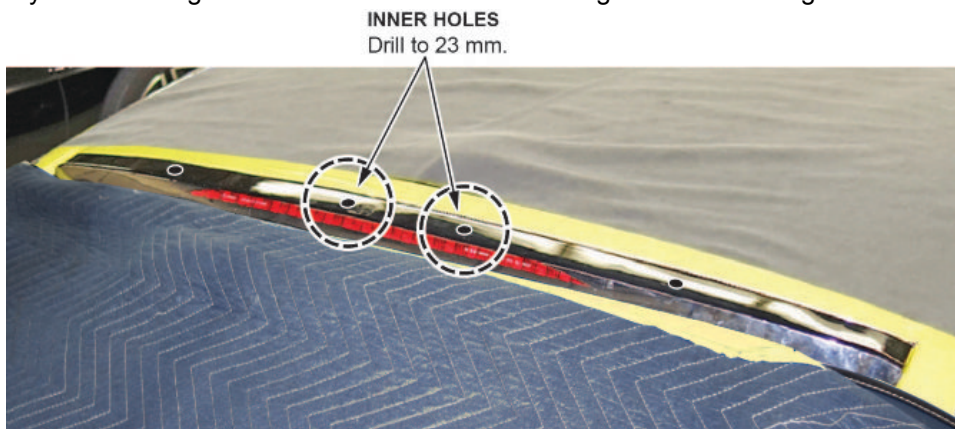

6.5.1. Remove any tape from the 14 mm Rotabroach bit.

NOTES

- The distance from the cutting edge of the Rotabroach bit to the large washer surface should measure **23 mm**.
- **Drilling the inner holes deeper than 23 mm may cause damage to the body.**

AT THE INNER HOLES:

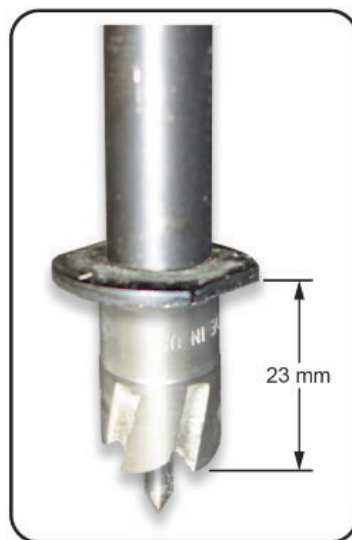

Don't drill deeper than 23 mm.

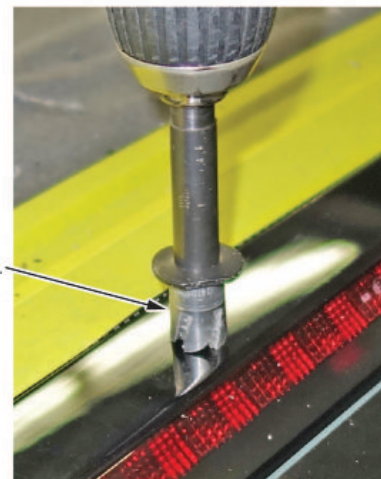

6.5.2. Carefully drill the hole to a depth of **23 mm** (the large washer will meet the high mount brake light surface).

7. Open the hatch.

8. Remove the applicable nut(s) by placing a flat head (flat tip) screwdriver against the edge of the bolt head to hold it in place while removing the nut.

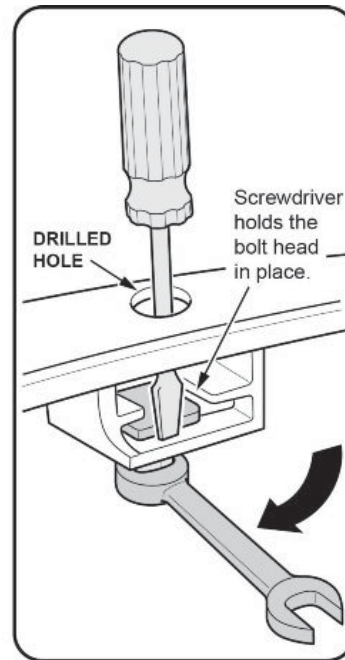
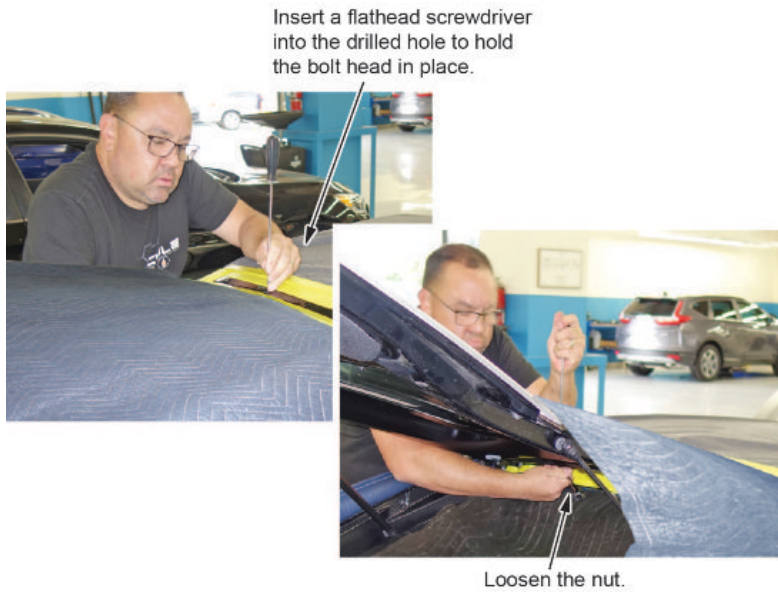

9. Remove the high mount brake light.

NOTE

Do not pry up on the high mount brake light face. Carefully insert the appropriate trim tool under the high mount brake light.

- 9.1. Close the hatch.

- 9.2. Remove the high mount brake light.

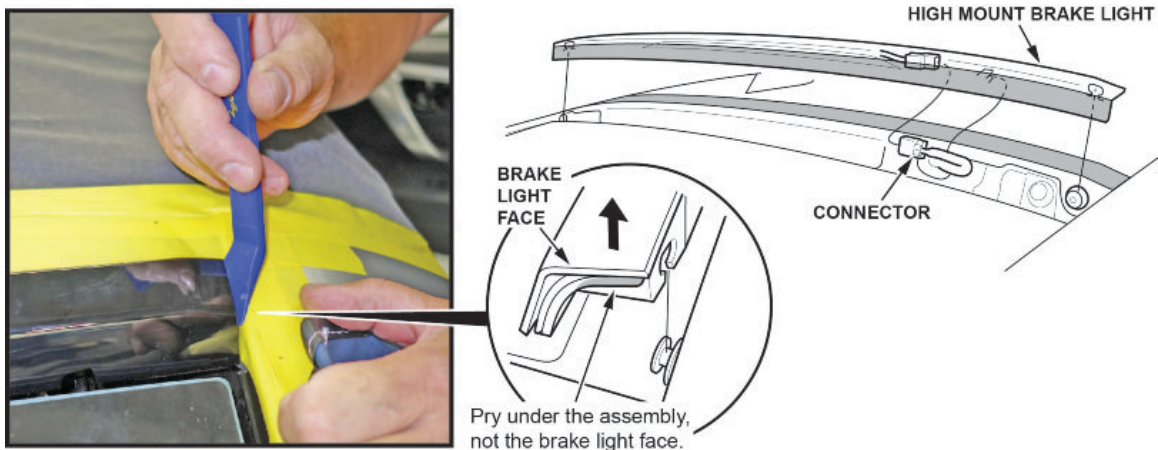

- 9.3. Disconnect the connector.

10. Vacuum any debris present from the drilling, and carefully remove the covers on the roof, the hatch glass, and the engine to prevent any material from falling into the engine area.
11. Replace the two clips indicated below.

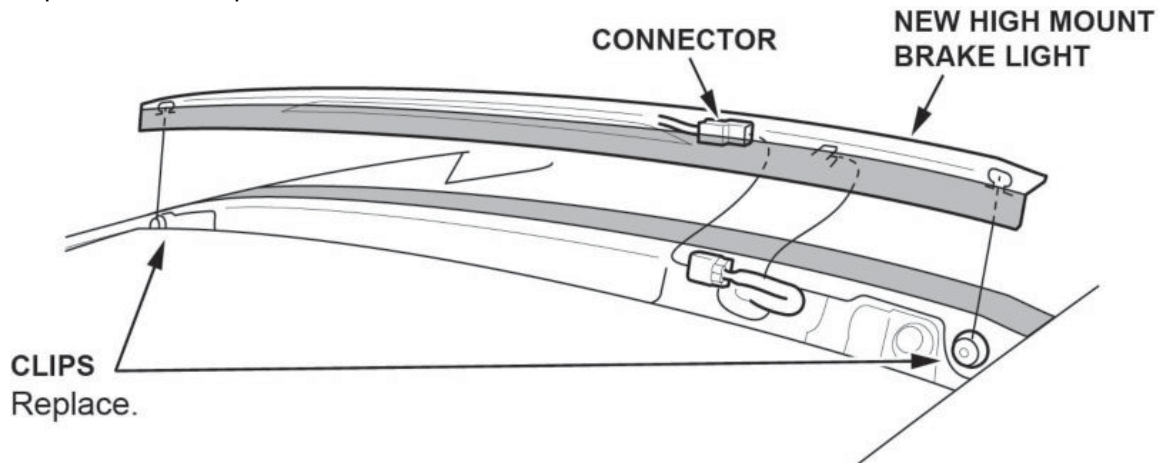

12. Install the new high mount brake light.
 - 12.1. Connect the connector.
 - 12.2. Install the high mount brake light.
 - 12.3. Install, and torque the new mounting nuts to **4.9 N·m (3.6 lb-ft)**.
13. Do the 12-volt battery terminal reconnection procedure.

END