



# SAFETY RECALL BULLETIN

## NHTSA RECALL 18V558, Transport Canada 2018-452

AUTOCAR INDUSTRIES, LLC SAFETY RECALL ACTT-1801

October, 2018

### Attention:

Service Managers/Parts Managers

### Subject:

Autocar has determined that a defect exists in the brake pedal assembly of certain 2016-2018 model year Xspotter vehicles, which could lead to the brake pedal becoming disconnected from the mounting plate.

### Safety Recall Information:

This document provides work instructions to replace the brake pedal floor mounting plate.

### Vehicles Affected:

There are 297 vehicles affected, manufactured after May 2016. To determine if a vehicle is affected by this recall, log in to the Autocar Warranty Management System at [www.autocartruck.com](http://www.autocartruck.com). From the main menu, select "View Recalls/Service Programs" and look for the Autocar recall number above. An Excel file will be accessible with the VIN list of affected vehicles. Alternatively, to determine if a single vehicle is affected, select "VIN Profile" from the main menu. In the "Chassis Number" field, enter the last 6 of the VIN. Once the VIN profile is displayed, scroll down to the "Recall/Service Program Information" section to determine if the recall is open.

### Service Responsibility:

Service sites must perform this recall on affected vehicles at no charge to the owner regardless of vehicle mileage, age or ownership. If a vehicle affected by this recall is taken into or is currently in your vehicle inventory, or at your center for service, you must perform this recall before the vehicle is sold or released to the owner.

### Required Parts:

- (1) S7205000K003 Service kit
  - (1) A7200075-001 Brake pedal mounting plate
  - (1) S7200008K001 Hardware Kit
    - (3) 3083620 Hex flange screw
    - (4) GM410108AD13 Hex flange screw
  - Red Thread locking compound (obtain locally)
  - Lubricant NGLI 1 to 1.5 lithium-based EP (obtain locally)

### To Obtain Parts:

#### DO NOT submit a Solutions ticket.

Send an e-mail to: [warranty@autocartruck.com](mailto:warranty@autocartruck.com)

And include the following:

- VIN(s) (or last 6 digits of VIN(s))
- 'Attention To' name
- 'Ship To' address

### Claims for Reimbursement:

Submit a claim for reimbursement in accordance with Autocar's Warranty Administration Manual.



# SAFETY RECALL BULLETIN

## NHTSA RECALL 18V558, Transport Canada 2018-452

AUTOCAR INDUSTRIES, LLC SAFETY RECALL ACTT-1801

October, 2018

### Claim Coding Information:

Labor Operation Code Number	Time Allowance SRT	Description
13.34.1	1.0 HR	Brake Pedal Mounting Plate Replacement

### Tools Required:

- Standard screw driver
- Needle nose pliers
- 3/8" Drive torque wrench capable of 16 lbs/ft
- 3/8" drive 1/2" socket
- 3/8" drive 12mm socket
- 1/2" Combination wrench

### Safety Notices



## WARNING

To prevent eye injury, always wear eye protection when performing vehicle maintenance, service or inspection.



## WARNING

Before working on a vehicle, set the parking brake, place the transmission in neutral and block the wheels. Failure to do so can result in unexpected vehicle movement and can cause serious personal injury or death.



## WARNING

Autocar natural gas powered vehicles require specific compliance in the service, storage and refueling procedures.

If you store or dispense Compressed Natural Gas (CNG) or Liquid Natural Gas (LNG), or if you work on CNG or LNG trucks, your location must be fully compliant with applicable codes, regulations and standards, including National Fire Protection Association (NFPA) codes, Society of Automotive Engineers (SAE) standards, American National Standards Institute (ANSI), Natural Gas Vehicle (NGV) standards, the United States Code of Federal Regulations (CFR), and your state and local fire and other applicable codes (including the California Code of Regulations and the Texas Administrative Code, as applicable).

Contact your local fire department for guidance and additional compliance information. Technicians working on Autocar trucks with CNG or LNG engines must be trained in the proper repair of CNG and LNG engines and the safe storage and dispensing of CNG and LNG.

# SAFETY RECALL BULLETIN

## NHTSA RECALL 18V558, Transport Canada 2018-452

AUTOCAR INDUSTRIES, LLC SAFETY RECALL ACTT-1801

October, 2018



### CAUTION

#### LOCKOUT/TAGOUT PROCEDURES

Before entering the vehicle or vehicle body, read and follow OSHA regulations concerning entry and working in "CONFINED SPACE" OSHA 1910.146 and "LOCKOUT/TAGOUT" OSHA 1910.147. Follow OSHA regulations while performing any work on the vehicle. The vehicle must be disabled by the following steps before performing any work on the vehicle:

1. Place the transmission in NEUTRAL.
2. Set the parking brake.
3. Shut the engine OFF.
4. Lock cab doors, keep the key in your pocket. Block the wheels before entering the body or performing any work on the vehicle.
5. Turn the battery disconnect switch OFF, if equipped.
6. Completely drain the air from the primary/A system and secondary/B system by opening the drain valves on the air tanks themselves or by using the drain manifold if supplied. When draining the air tanks, do not look into the area where air is draining. Dirt or sludge particles may be expelled in the air stream and can cause eye injury.
7. Place magnetic "DANGER" signs on both cab doors before entering the body or performing any work on the vehicle.
8. Take proper precautions before working under the vehicle. Use ramps approved for the weight of your vehicle, or use floor jacks and stands. Never work under a vehicle supported by jacks alone. Always use jack stands to support the vehicle.

# SAFETY RECALL BULLETIN

## NHTSA RECALL 18V558, Transport Canada 2018-452

AUTOCAR INDUSTRIES, LLC SAFETY RECALL ACTT-1801

October, 2018

### WORK INSTRUCTIONS:

1. Follow all LOCKOUT/TAGOUT procedures.
2. Locate the brake pedal (see *Figure 1*).

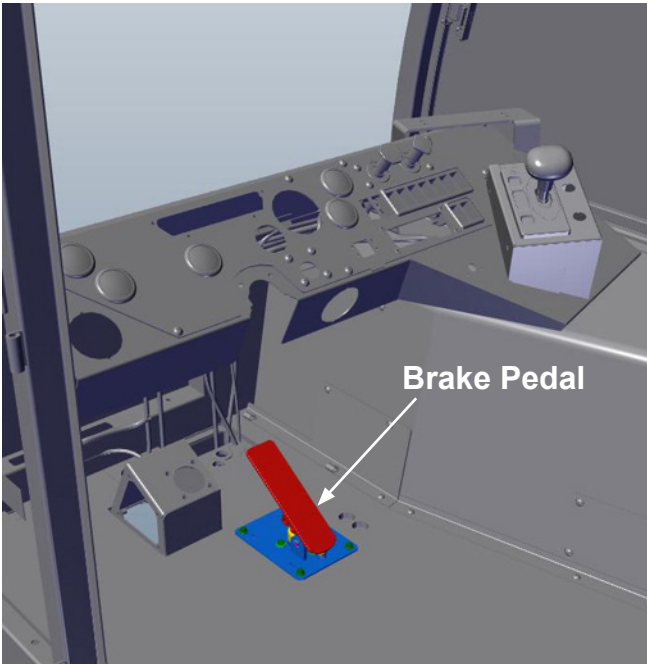

**Figure 1**

3. Remove the E-clip retainer, the clevis pin and the brake pedal and set aside for reinstallation (see *Figure 2*).

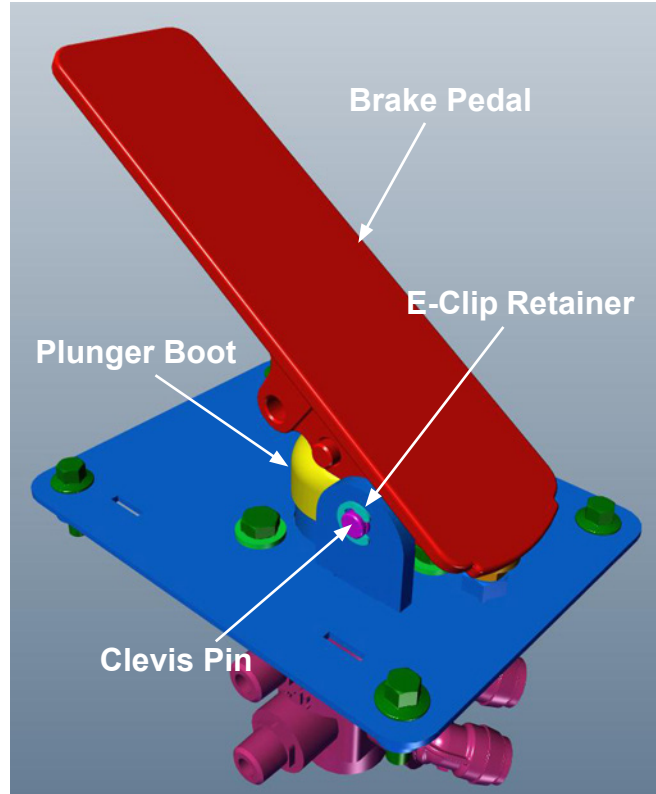

**Figure 2**

**Note:** Certain units may utilize a locking cotter pin and a washer in place of the E-clip retainer, if used, remove the locking cotter pin and washer and set aside for reinstallation (see *Figure 3*).

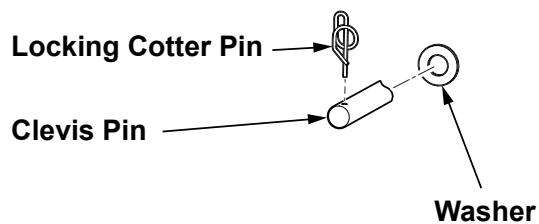

**Figure 3**

# SAFETY RECALL BULLETIN

## NHTSA RECALL 18V558, Transport Canada 2018-452

AUTOCAR INDUSTRIES, LLC SAFETY RECALL ACTT-1801

October, 2018

- Remove the plunger boot and the plunger and set aside for reinstallation (see Figure 4).

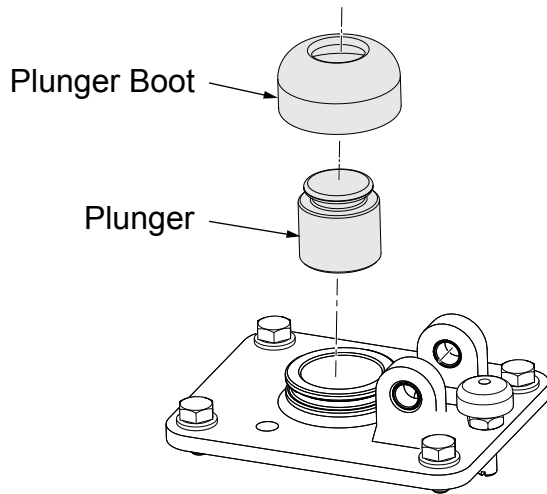

**Figure 4**

- Remove and discard the (3) hex flange screws from the brake pedal mounting plate/air valve (see Figure 6).

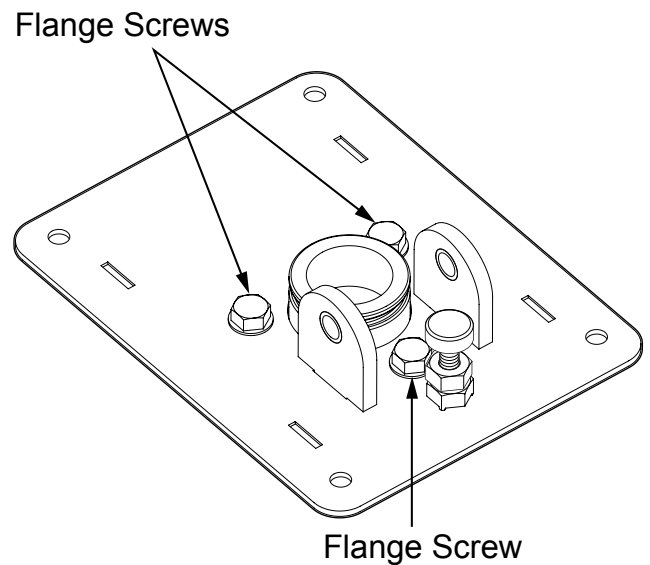

**Figure 6**

- Remove and discard the (4) hex flange screws from the brake pedal mounting plate (see Figure 5).

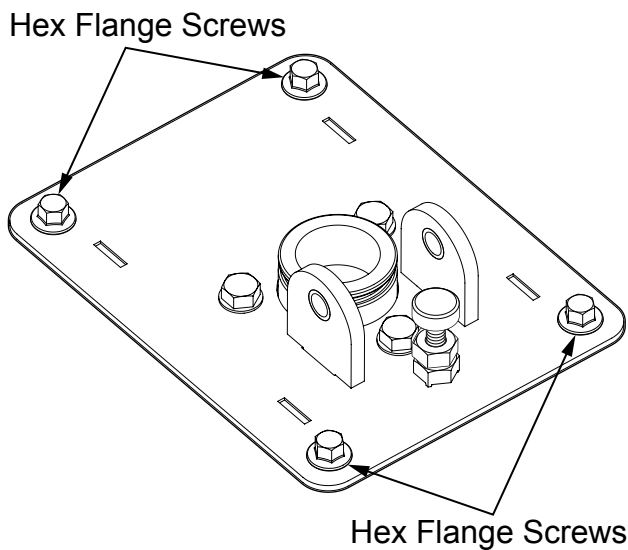

**Figure 5**

- Remove the brake pedal stop bolt and jam nut and set aside for reinstallation (see Figure 7).

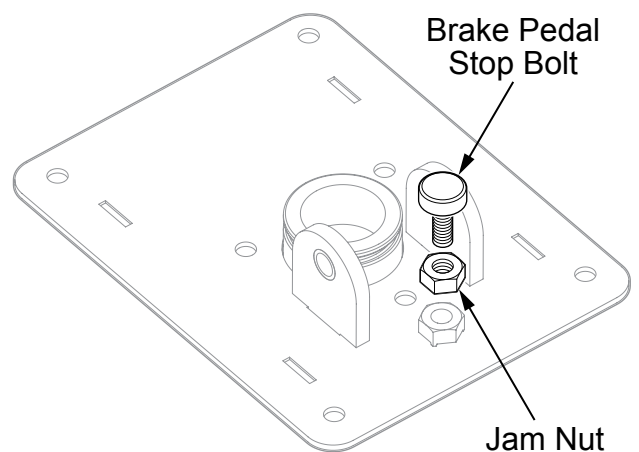

**Figure 7**

# SAFETY RECALL BULLETIN

## NHTSA RECALL 18V558, Transport Canada 2018-452

AUTOCAR INDUSTRIES, LLC SAFETY RECALL ACTT-1801

October, 2018

8. Remove the brake pedal mounting plate and discard.
9. Install (do not tighten) the brake pedal stop bolt and jam nut that were set aside in step 7 into the new brake pedal mounting plate (A7200075-001).
10. Install the new brake pedal mounting plate (A7200075-001).
11. Apply red thread locking compound (obtained locally) to the threads and install (3) new (3083620) hex flange screws and tighten to 10 lbs/ft of torque.
12. Apply red thread locking compound (obtained locally) to the threads and install (4) new (GM410108AD13) hex flange screws and tighten to 16 lbs/ft of torque.
13. Apply lubricant (NGLI 1 to 1.5 lithium-based EP obtained locally) to the brake plunger and Reinstall the plunger that was set aside in step 4 into the brake pedal mounting bracket.
14. Reinstall the plunger boot, the brake pedal, and the clevis pin that were set aside in steps 3 and 4.
15. Reinstall the E-clip retainer or locking cotter pin and washer that was set aside in step 3, making sure that it is fully engaged over the tip of the clevis pin.
16. Adjust the brake pedal stop bolt to allow a slight amount of free travel at the top of the brake pedal stroke and secure the jam nut.
17. Perform a functional test by depressing and releasing the brake pedal several times to verify the plunger is not sticking and is operating correctly.
18. Perform a short test drive to verify the brake pedal function.
19. If no defects are found the brake pedal mounting plate replacement is complete.

**Note:** *If the E-clip retainer or locking cotter pin cannot be fully engaged for any reason such as damage during removal, contact Autocar at: [warranty@autocartruck.com](mailto:warranty@autocartruck.com)*

**Note:** *If the plunger boot or any other component is damaged during removal, contact Autocar at: [warranty@autocartruck.com](mailto:warranty@autocartruck.com)*