



**Recall #** 18V-297 2018-242 Jayco  
 18V-298 2018-241 Entegra

**Date of Publication** June 2018

**Job Code** 9903378 Jayco and Entegra

**Series/Flat Rate** .3 hr

**REQUIRES PARTS ORDER**

**INCIDENT / REMEDY**

Wiper system motor may fail when operating in heavy snow or ice situations, reducing driver visibility  
 Remove and replace the windshield wiper relay harness.

**AFFECTED UNITS**

- 2018 Alante J1AP0074-0146 AR0052-0168 AS0051-0157 AV0086-0189 AX0080-0206
- 2018 Precept J1UL0134-0288 US0108-0154 UT0085-0168 UU0052-0176 UV0052-0146
- 2019 Precept K1UA0051 UK0051 UL0051-0067 UV0051-0064
- 2019 Vision K1AR8051-8056 AS8051-8089 AV8051-8082 AX8051-8080
- 2019 Emblem K1DT8051 DU8051-8059

**PARTS KIT  
 18V-297-298 FOR  
 BOTH RECALLS**

**Note: Kit can only be ordered using the order form included with this bulletin.**

Replacement wiper relay



**Misc. Tools and Supplies Needed**

Screw-gun with a #2 square bit & safety glasses

## 18V-297 18V-298 REPAIR INSTRUCTIONS

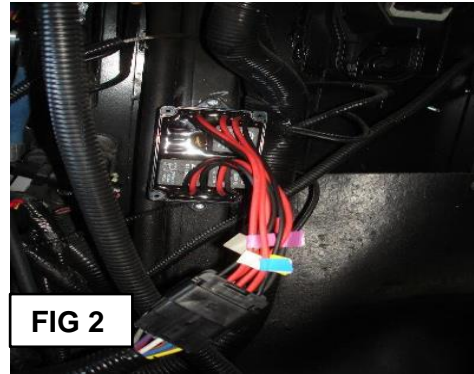
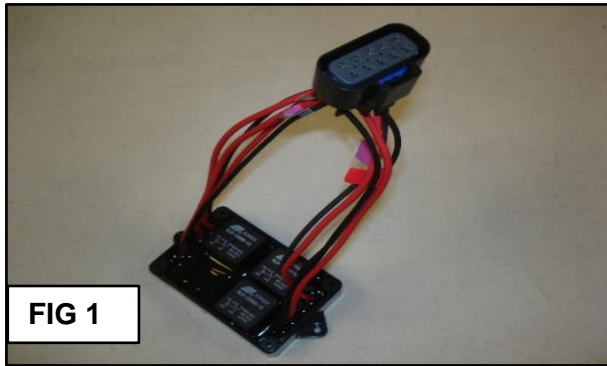

**FIG 1:** Existing wiper relay harness being replaced.

**FIG 2:** Open the hood of the vehicle and locate the wiper relay harness on the driver side of firewall.

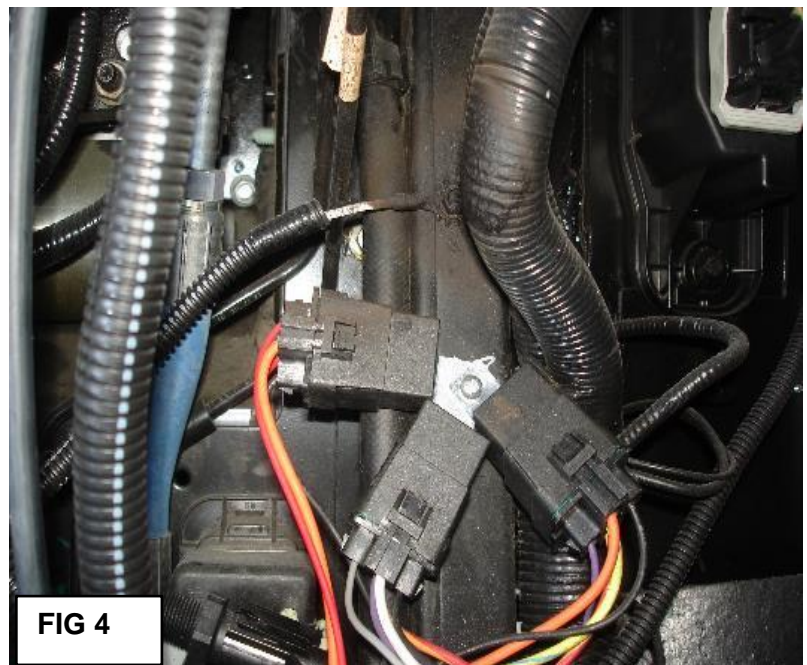
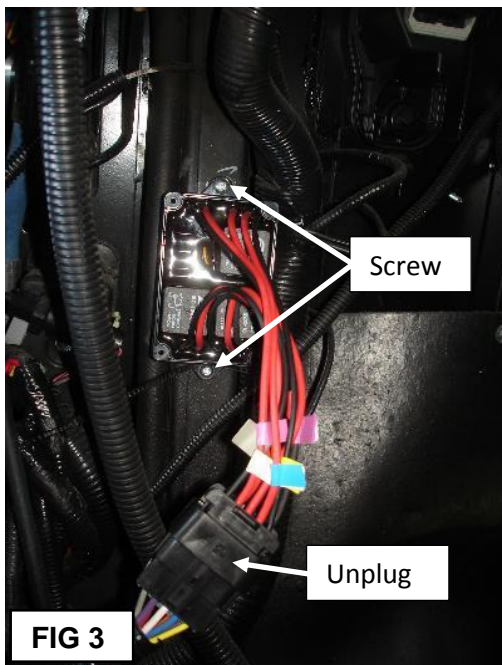

**FIG 3:** Remove the 2 screws holding existing harness to the firewall. Unplug the connector as shown and remove from the vehicle.

**FIG 4:** Take the new wiper relay harness (from the kit), and group the 3-relays as shown. Install the 3-relays using one of the screws from the old harness. Install in one of the holes where the old relay was mounted.

**FIG 5:** After completing step 4, plug the harness connector on the replacement harness into the same connector for the old harness as shown.

Turn ignition to the accessory position and validate the wipers work at all speed setting. Your repair is now complete.

**Caution:** If wipers do not function, check to insure that the relay harness is properly connected. If found properly connected, and wipers still do not work you will need to check the fuse at the location shown in Fig 6.

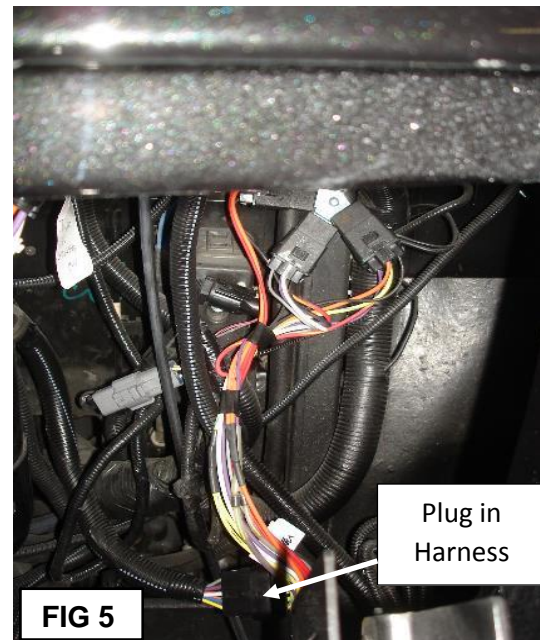

**Caution:** If wipers do not function after confirming connectors are properly connected, you will need to check the 30AMP Fuse in the fuse block located under the dash just left of the driver's position as shown in FIG 6.

If wipers still do not function after these steps contact Customer Service for further assistance on trouble-shooting the situation.

