



NHTSA# 18V-286

Date of Publication: June 2018

TC# 2018-240

Job Code 9901777 Lock out procedure prior to appointment for Recall Remedy .3 hr
9901377 Recall Remedy – Insert metal spacer 1 hr

Incident/ Remedy

Bearing in the MorRyde 16K Orbital Pin box is not properly seated. Over a period of time the spindle could fatigue and break.
Install metal spacer to prevent metal – to metal – contact and allow the bearing to be seated properly.

IMPORTANT:

If pin box is currently in the rotation mode, it must be locked out and the pin box returned to the standard transport mode prior to completion of the Recall Remedy.

If pin box is currently being used as a standard no precautions are required prior to completion of Recall Remedy

AFFECTED UNITS

2018 Eagle HT Fifth Wheels – List of affected serial numbers is available under the Service and Parts Tab.

PARTS KIT

18V-286

Spacer Washer and Cotter Pin

Misc. Tools and Supplies

Please note listing on Moryde's Instructions

Lock out Instructions for Pin Box in Orbital Mode

RECALL 18V-286 2018-240

Lockout Procedure for MORryde Orbital Rotating Rubber Pin Box

Tools Required: 15/16" socket Breaker bar Torque wrench capable of 200ft-lbs

Use the socket and breaker bar to loosen the wedge bolts and the bolts that are in the lockout hardware storage location, removing them and the spacer plates.

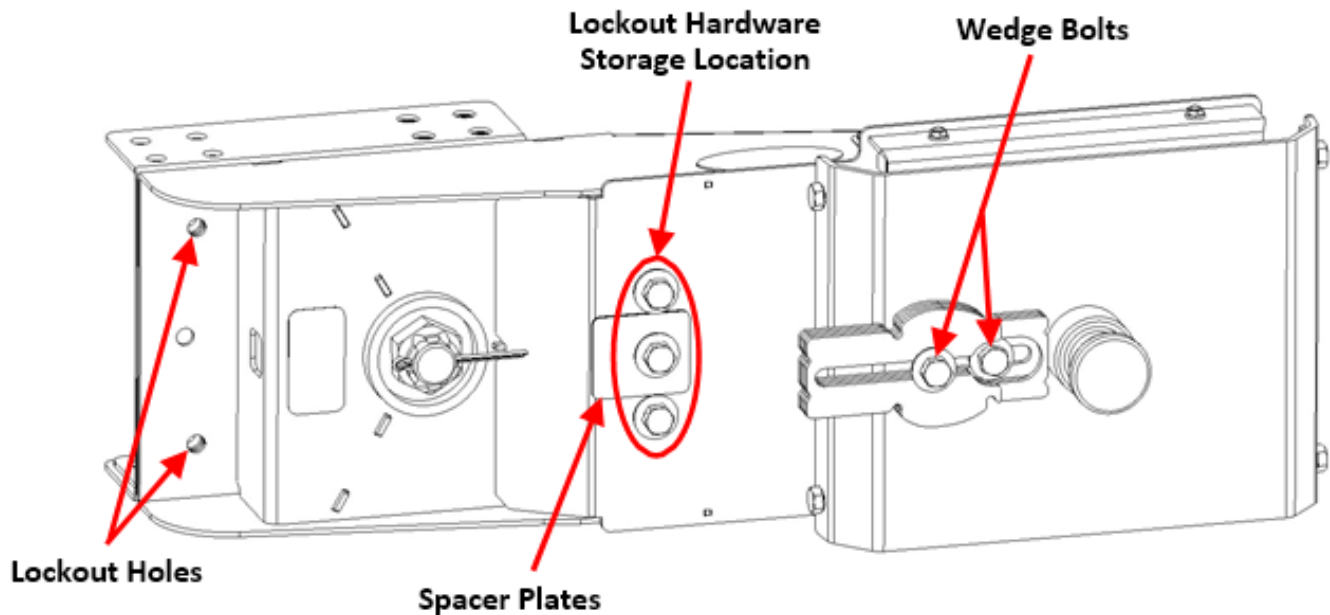

Place the spacer plates between the spindle box and pin box so that the hole lines up with the lockout holes. Use the two 5/8-18 x 1.5" bolts removed from the storage location with the conical lock washers and hand thread them into the lockout holes. Use the remaining bolts and conical lock washers and hand thread them into the storage location to store the wedge. Set the torque wrench to 200ft-lbs and torque all 5 bolts.

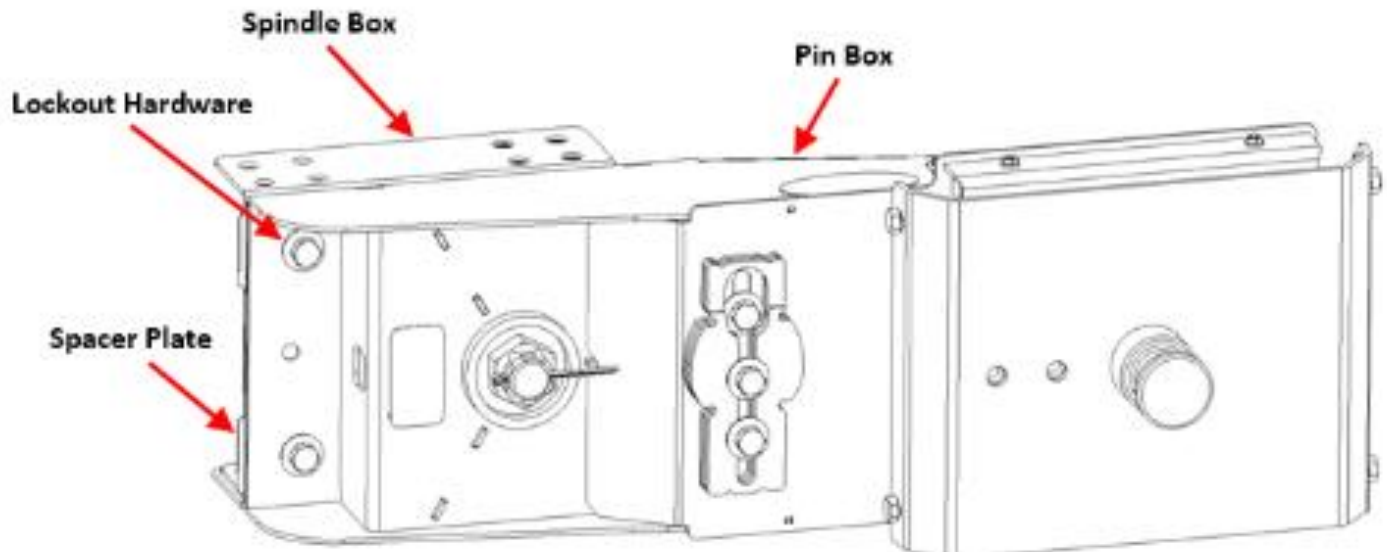



Above. Beyond. Always.

IMPORTANT SAFETY ADVISORY NOTICE

MORryde Orbital Rubber Pin Box

Dear MORryde Owner:

This notice is sent to you in accordance with the requirements of the National Traffic and Motor Vehicle Safety Act.

MORryde has detected a potential safety concern with Jayco 2018 and 2019 vehicles manufactured using a MORryde Orbital Rubber Pin Box. It has been decided that vehicles in this recall population may have been manufactured with a MORryde Orbital Rubber Pin Box whose bearing is not properly seated.

REASON FOR RECALL: Over a period of time, the spindle could fatigue and break. If the pin box is locked out and being used as a standard pin box, it's not likely any effects will be seen, however, if the pin box is being used in rotation mode, this could lead to an increased risk of personal injury.

IMMEDIATE PREVENTATIVE MEASURE: In order to prevent possible damage, return the Orbital Rubber Pin Box to the standard transport mode by removing the wedge from behind the king pin and reinstalling the lockout bolts at the back of the pin box.

If after having attempted to take advantage of this recall you believe you have not been able to have your defective part remedied without charge and within a reasonable amount of time, you may submit a complaint to the Administrator, National Highway Traffic Safety Administration, 1200 New Jersey Ave., S.E., Washington, D.C. 20590 or call the toll-free vehicle safety hotline at 1-888-327-4236 (TTY: 1-800-424-9153); or go to <http://www.safercar.gov>.

We apologize for any inconvenience this safety recall may cause, but your safety is our first concern.

IMPORTANT SAFETY ADVISORY NOTICE

MORryde Orbital Rubber Pin Box

OBJECTIVE: Repair the pin box.

PARTS REQUIRED (Per Unit):

- Spacer Washer
- Cotter Pin
- Bearing Race Puller Tool
(one supplied per dealer)

VIEW THIS SAFETY ADVISORY VIDEO ONLINE:

 https://youtu.be/NQmcuno_EC0

TOOLS REQUIRED:

- Side Cuts
- Needle Nose Pliers
- Hammer
- Ratchet
- Impact Gun
- Breaker Bar
- 7/16" Socket
- 1/2" Socket
- 15/16" Socket
- 2-1/4" Socket *(typically used on axles to remove castle nuts)*
- Magnet *(on a stick)*
- Torque Wrench with at least 200 ft-lbs capacity

STEP 1

First, make sure lockout bolts are in place. Then, remove the cotter pin using the side cuts. Next, straighten the legs of the pin and then use the side cuts to pull the pin out by prying against the side of the castle nut.



STEP 2

Remove the castle nut using the 2-1/4" socket and breaker bar.



Above. Beyond. Always.

574.293.1581 • www.MORryde.com

IMPORTANT SAFETY ADVISORY NOTICE

MORryde Orbital Rubber Pin Box

STEP 3

Use a magnet on a stick to pull the washer out. You may need to move the magnet around the washer several times to break it free or even tap on the washer with a hammer.

NOTE: Washer may be black as shown or silver. Also, removal of the washer may require slightly loosening of the lockout bolts and then shaking the pin box to allow the washer to break free. Before shaking the pin box up and down, thread the castle nut back on the spindle a couple of turns to catch the washer.

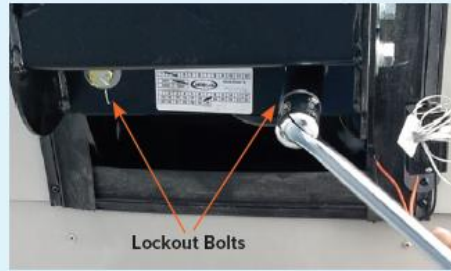

STEP 4

Use needle nose pliers and extract the bearing from the pin box.



STEP 5a

Insert the bearing race puller tool. Use a 7/16" socket to tighten the (3) 1/4" bolts until the jaws have latched onto the bearing race and the tool does not fall out.



STEP 5b

Use a 3/4" socket to tighten the center 1/2" bolt which pulls the bearing race out of the pin box.



STEP 5c

Once the bearing race has been extracted, loosen the (3) 1/4" bolts to remove the bearing race from the tool.



Above. Beyond. Always.

574.293.1581 • www.MORryde.com

IMPORTANT SAFETY ADVISORY NOTICE

MORryde Orbital Rubber Pin Box

STEP 6

Rub the supplied spacer washer against the bearing race to transfer some grease so that you can insert the spacer washer into the pin box and have it stick without falling.



STEP 7

Place the bearing on the washer and then place the bearing race on the bearing.



STEP 8

Place the assembly from Step 7 onto the spindle and then install the castle nut.

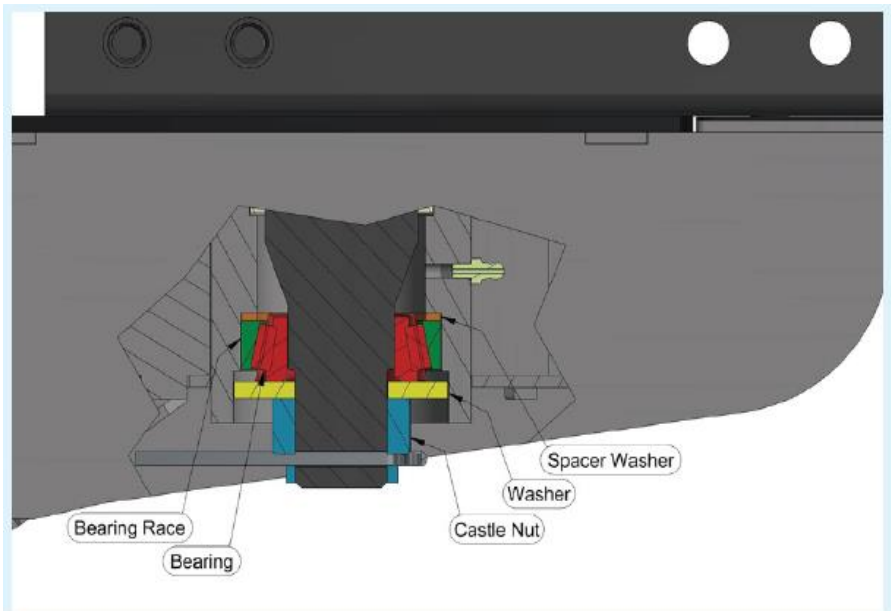

NOTE: The diagram above shows the stack up of parts on the spindle. The spacer washer is shown in orange, the bearing race in green, the bearing in red, the washer in yellow, and the castle nut in blue.



Above. Beyond. Always.

574.293.1581 • www.MORryde.com

IMPORTANT SAFETY ADVISORY NOTICE

MORryde Orbital Rubber Pin Box

STEP 9

Use the 2-1/4" socket and tighten the castle nut to seat the bearing race. If the lockout bolts were loosened, you may need to lift the front of the pin box to get the washer past the lip of the tube on the pin box. Torque the castle nut to 80ft-lbs. If a notch in the castle nut does not align with the hole for the cotter pin, tighten the nut until it aligns.



STEP 10

Install a new cotter pin and bend tabs to hold in place.



STEP 11

Use the 15/16" socket and torque the lockout bolts to 200ft-lbs OR remove the lockout bolts and install the proper wedge per the wedge instructions in the owner's manual to use the pin box in rear rotation mode.



STEP 12

Grease as necessary. The grease zerk can be found in the rectangular hole in the back of the pin box.

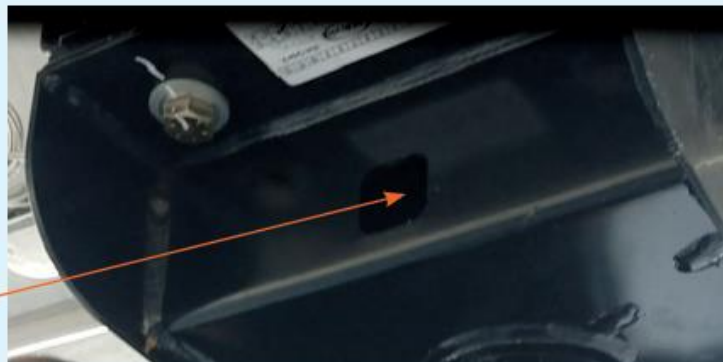

Location of
Grease Zerk



Above. Beyond. Always.

574.293.1581 • www.MORryde.com