

# JLA Quarter Panel Air Bag Sensor Removal and Install

\* Illustrations only show the LH side

## 1. RECORD SETTINGS OF THE AUDIO SYSTEM, AIR CONDITIONER, ETC.

- For devices such as the audio system, air conditioner, etc, record current settings before the negative (-) battery terminal is disconnected.

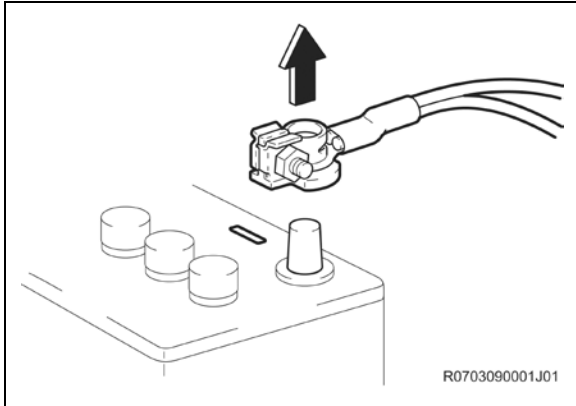

## 2. DISCONNECT NEGATIVE BATTERY CABLE



- Wait at least 90 seconds after disconnecting the cable from the negative battery terminal to prevent airbag and seat belt pretensioner deployment.
- For models with a HDD navigation system, wait at least 6 minutes before disconnecting the battery. It takes approximately 6 minutes for the system to save information and settings after the engine switch is turned off.
- Follow all precautions as outlined on TIS before servicing the SRS system.

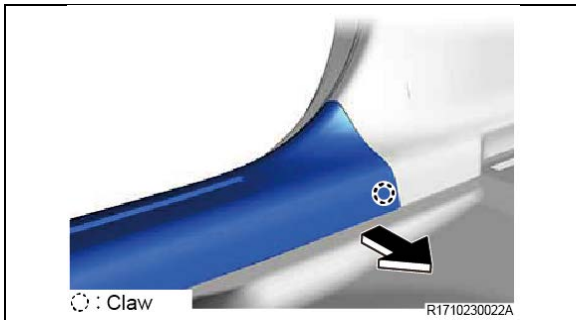

## 3. REMOVE REAR DOOR SCUFF PLATE

- Disengage the claw on the front side of the rear door scuff plate.

### NOTE:

Use the same procedure to remove the claw on the rear side.

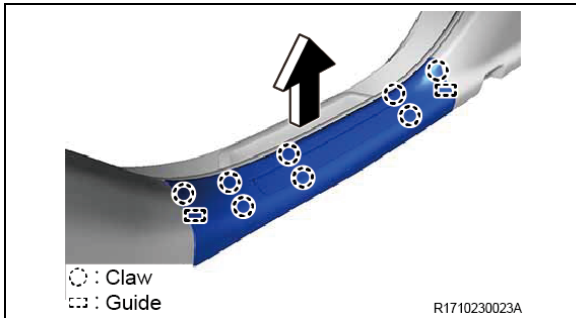

- Disengage the 8 claws and 2 guides to remove the rear door scuff plate.

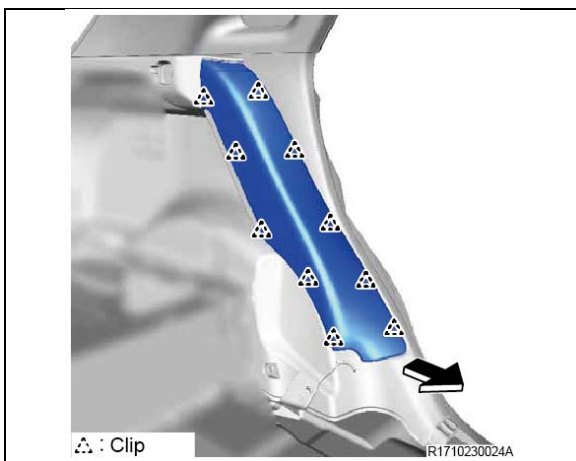

## 4. REMOVE UPPER QUARTER TRIM PAD

- Fold the seatback forward.
- Disengage the 10 clips to remove the upper quarter trim pad.

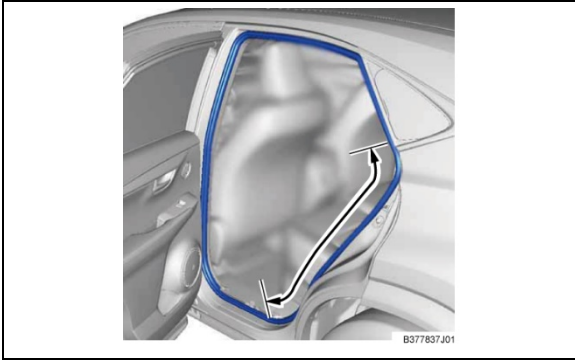

## 5. DISCONNECT REAR DOOR OPENING TRIM WEATHERSTRIP

- a) Disconnect the part of the rear door opening trim weatherstrip shown in the illustration.

## 6. REMOVE QUARTER PANEL AIR BAG SENSOR

- a) Disengages the clips and the two clamps for the rear seat side garnish so that the quarter panel air bag sensor can be removed.

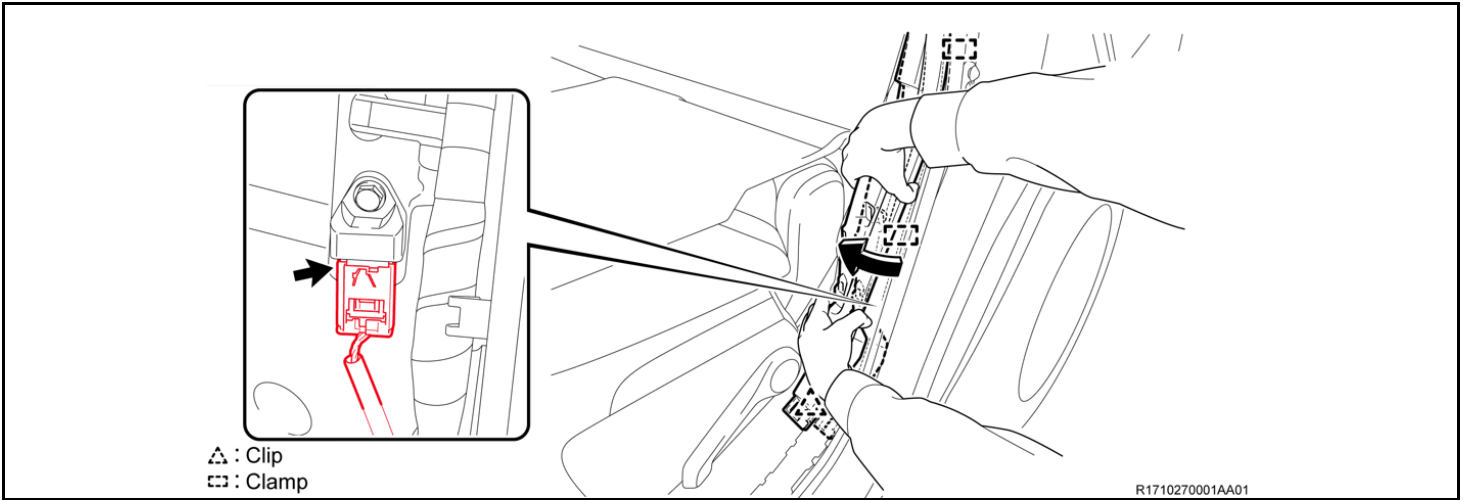

- This special connector has a double locking mechanism and needs to be handled with care.
- DO NOT apply pressure on the wire harness.

- (1) To unlock the first lock, keep pushing down the white housing lock and then slide the yellow CPA towards the wire harness.
- (2) To unlock the second lock, keep pushing down the white housing lock again and disconnect the connector.

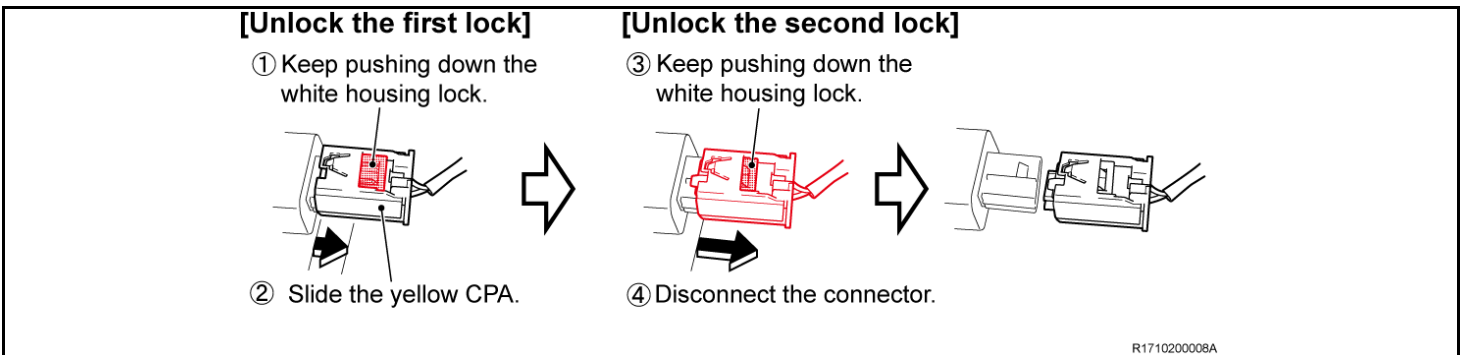

- b) Remove the bolt while holding the quarter panel air bag sensor.
- c) Disengage the guide pin and claw to remove the quarter panel air bag sensor.
- d) Mark and store the removed quarter panel air bag sensor in a separate container so as not to reinstall it in error.



- If you DO NOT hold the sensor, it may be rotated together with the bolt and the guide pin and claw may be broken.

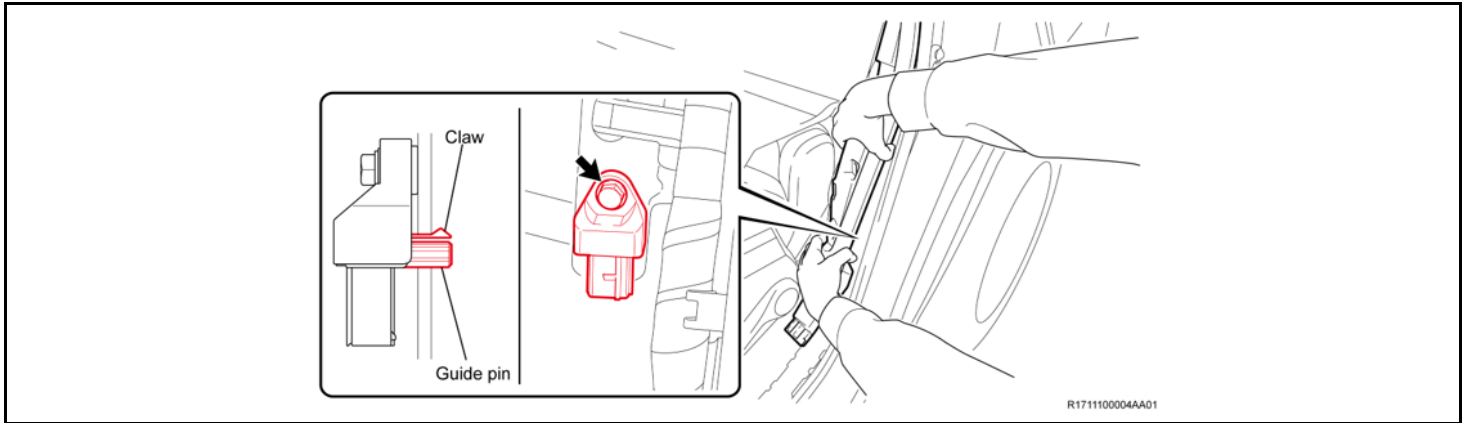

**7. INSTALL A NEW QUARTER PANEL AIR BAG SENSOR**

- a) Engage the guide pin and claw of a **NEW** quarter panel airbag sensor and holds it in place.
- b) Reinstall the bolt.

**Torque: 9.0 N\*m (92 kgf\*cm, 80 in.\*lbf)**



- **DO NOT use a sensor which has been affected by strong shocks such as a drop during work.**
- **If you DO NOT hold the sensor, it may be rotated together with the bolt and the guide pin and claw may be broken.**

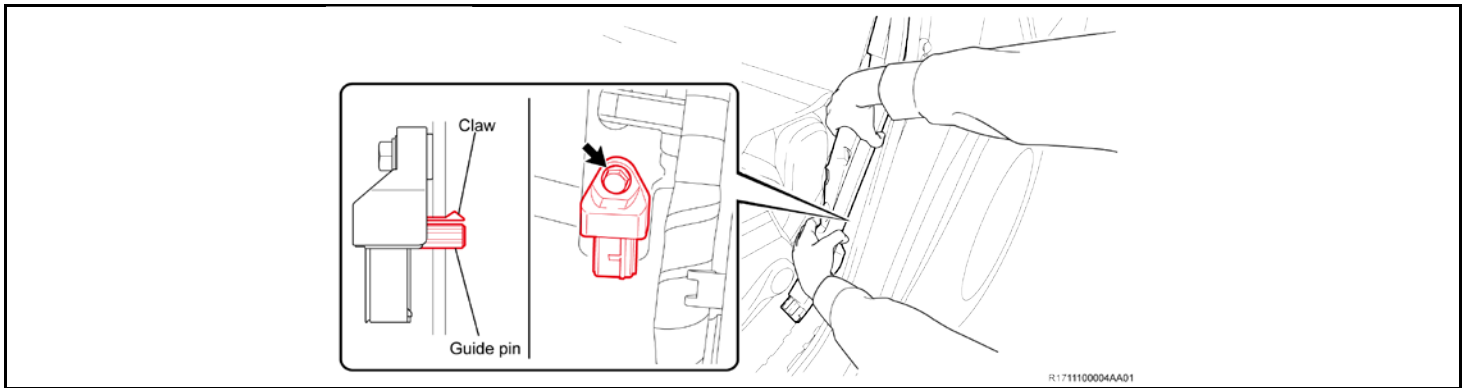

- c) Engage the connector of the **NEW** quarter panel airbag sensor holding the sides of its yellow CPA (a click sound can be heard).

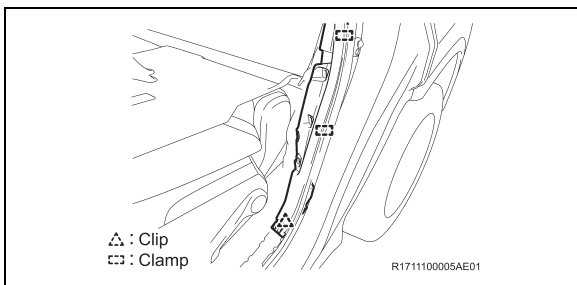
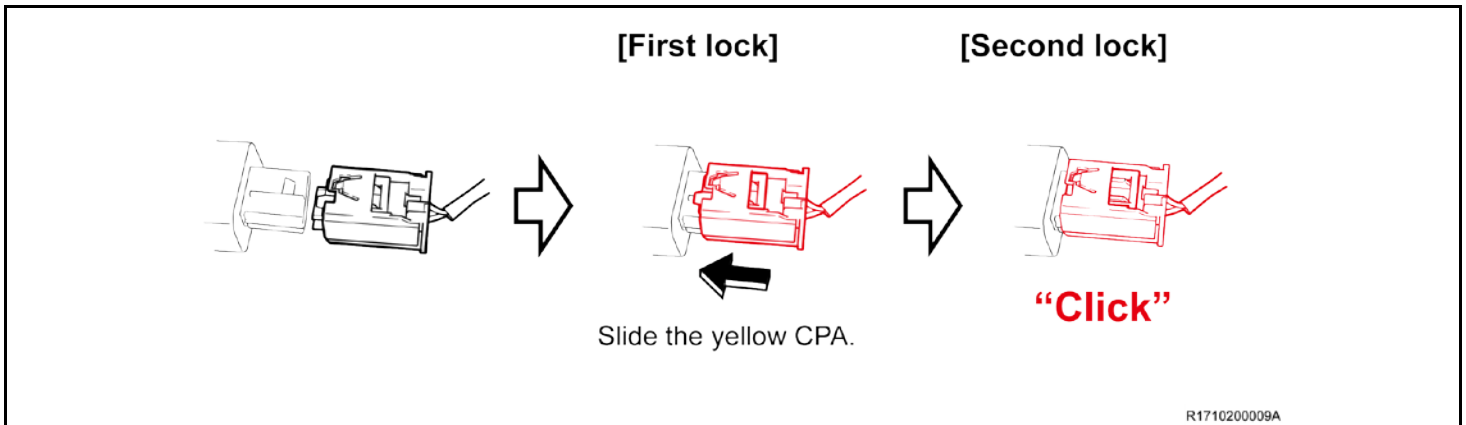

- d) Engage the clips and 2 clamps to reinstall the rear seat side garnish.

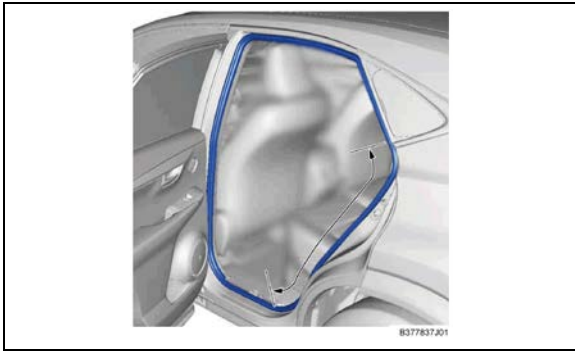

## 8. REINSTALL REAR DOOR OPENING TRIM WEATHERSTRIP

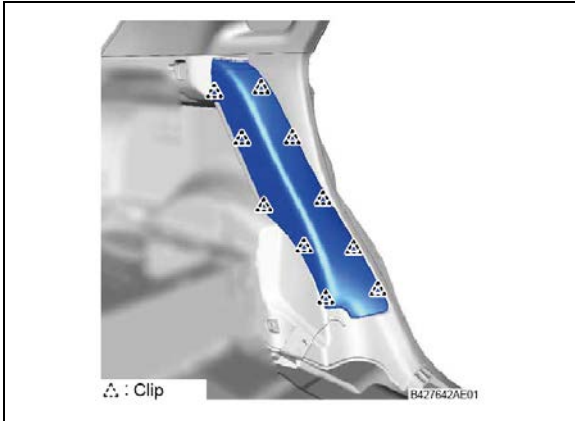

## 9. REINSTALL UPPER QUARTER TRIM PAD

- a) Engage the 10 clips to reinstall the upper quarter trim pad.

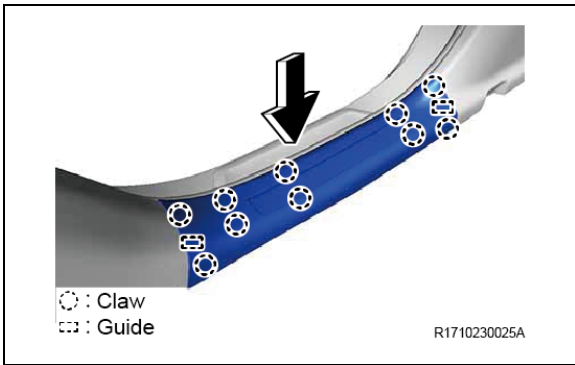

## 10. REINSTALL REAR DOOR SCUFF PLATE

- a) Insert the 2 guides and engage the 10 claws to reinstall the rear door scuff plate.



**Before carrying out the following procedures, replace another sensor if needed.**

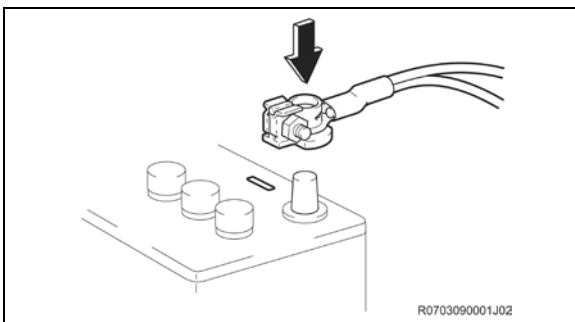

## 11. RECONNECT NEGATIVE BATTERY CABLE

## 12. INSPECT THE AIRBAG SENSORS USING THE JUDGMENT SOFTWARE

## 13. RESTORE VEHICLE

- a) Perform system initializations.