

QAAR 8764

Wonder Fridge Circuit Correction.

People Required: 1
 Time to Complete: 10 min
 Date Created: Sept 26, 2017
 Date Revised: Rev #:
 Created by Initial: GK Verified: AE



- Make sure shore power is disconnected.
- Battery disconnect is OFF
- Inverter is OFF
- Ensure Generator is OFF

1



Locate the breaker/fuse panel.



Remove the cover on the right side of the panel to expose fuses.

2



Use a #6 Robertson (square) head screw to remove the 4 mounting screws. (keep for later)

3



Pull out the breaker/fuse panel to expose the wire connections.

4

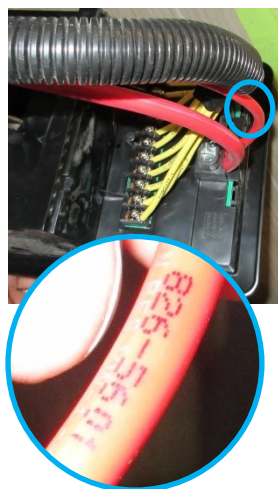

Identify the wire 826-5601

5



Loosen the set screw connecting 826-5601 wire to the breaker/fuse panel

Remove wire 826-5601 from power takeoff.

6



Split the wire strands in two equal parts.

Each half of wire strands will be inserted on either side of the power take off bar screw.

7

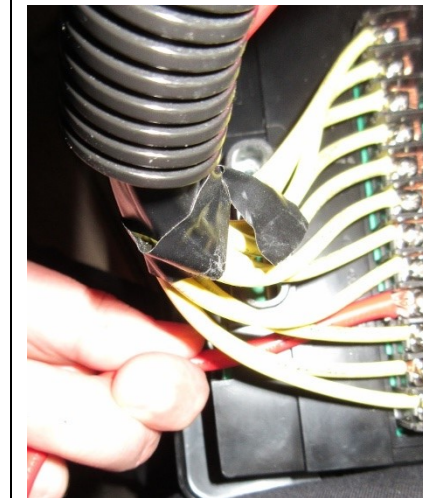

Insert wire into the individual fuse power take off bar location #9.

You may need to loosen the Phillips (star) head screw to get the wire in.

8

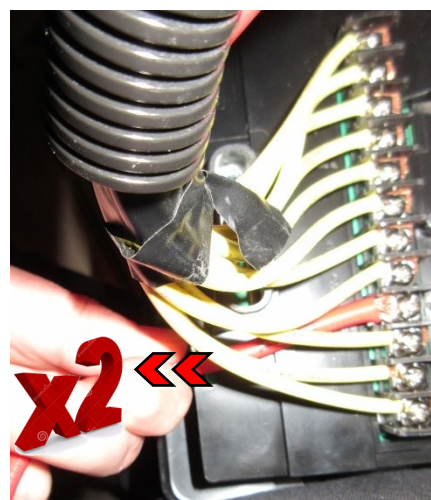

Tighten screw and pull twice on wire to verify that it is solidly connected. All strands must be in wire housing.

9



Reinstall breaker/fuse panel and screws.

Turn on battery disconnect.

10

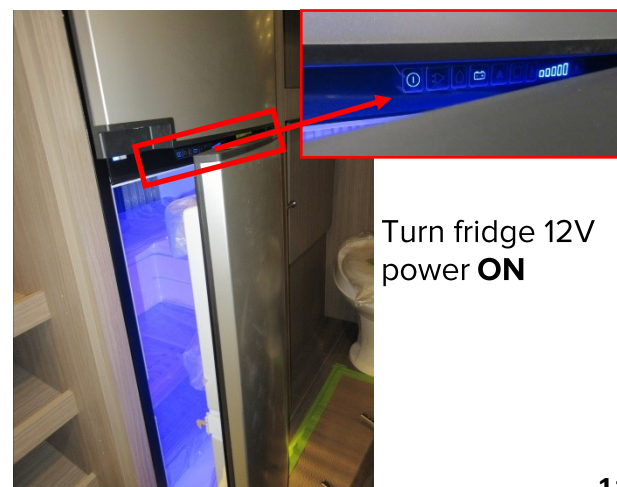

Turn fridge 12V power ON

11

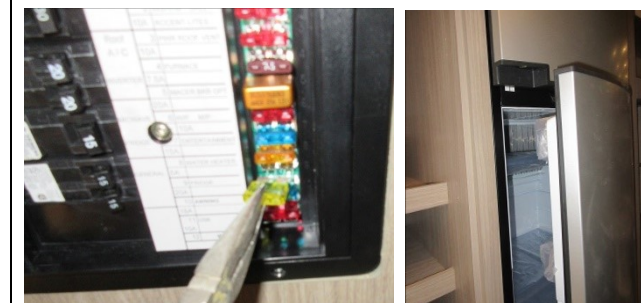

Pull the 20amp fuse from holder #9 and verify the fridge is OFF. Replace Fuse. Reinstall breaker/fuse panel cover.

12