

CONDITION OF CONCERN

On the mechanical (cable) type parking brake, water may enter the brake caliper due to inappropriate sealing performance of the rear brake caliper protective boot, in cold temperatures. As a result, the parking brake actuator shaft, which is a component of the rear brake caliper, may rust. If the vehicle continues to be used with this condition, the rust may progress, increasing the sliding resistance of the actuator shaft. In extreme cases, the rusted actuator shaft may stick in the brake caliper body, resulting in the rear brakes dragging while driving and a decreased parking brake holding force. This could result in unexpected movement of the vehicle if parked on a slope, increasing the risk of a collision. The braking performance by brake pedal operation is not affected.

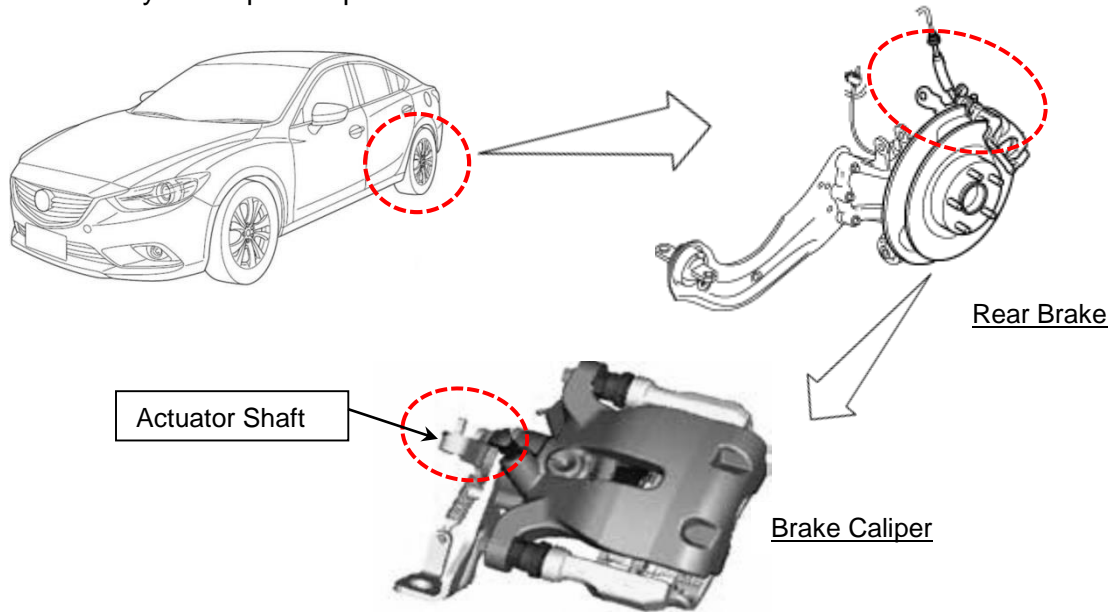

Dealers are instructed to check first if the vehicle is equipped with the subject rear brake calipers or not. If the subject brake caliper(s) is(are) installed, inspect the parking brake actuator shaft(s) inside the brake caliper(s) for any rust on the specific area. If the actuator shaft(s) is(are) found to be rusted on the specific area, replace the brake caliper(s) with modified one(s). If no rust is found on the specific area of the actuator shaft(s), replace the protective boot(s) with modified one(s). The inspection and repair must be performed on all subject vehicles at no charge to the vehicle owners.

Please refer the Repair Procedure document on MGSS for further details.

SUBJECT VEHICLES

Model	VIN Range	Build Date Range
2014-2016 Mazda3	3MZ BM**** EM 100353 – 124127 3MZ BM**** FM 121913 – 237205 3MZ BM**** GM 228021 – 330080	From January 6, 2014 through September 2, 2016
2014-2015 Mazda6	JM1 GJ**** E1 100027 – 162747 JM1 GJ**** F1 162748 – 225009	From October 25, 2012 through December 1, 2014

The asterisk symbol “*” can be any letter or number.

OWNER NOTIFICATION

Mazda will notify U.S. owners by first class mail beginning from August 19, 2017.

PARTS INFORMATION

Description	Part number	Quantity	Applicable Model	Note
Boot Kit (R)	BJY8-26-45Z	1	Mazda3	Will be used for brake caliper (right or left) having no rust
	G4YE-26-45Z	1	Mazda6	
Boot Kit (L)	BJY9-26-45Z	1	Mazda3	
	G4YF-26-45Z	1	Mazda6	
Boots Kit (L & R)	G4YG-26-45Z	1	Mazda6	Will be used when both calipers have no rust
Caliper (R)	BJY7-26-61X	1	Mazda3	Necessary when either brake caliper or both brake calipers are rusted
	GHY2-26-61X	1	Mazda6	
Caliper (L)	BJY7-26-71X	1	Mazda3	
	GHY2-26-71X	1	Mazda6	
Gasket	9956-21-000	2 or 4	Mazda6 & Mazda3	2 gaskets are required per caliper replacement
Campaign Label	9999-95-065A-06	1=50 labels	All	Obtain in Mazda e-Store (no charge)

WARRANTY CLAIM PROCESSING INFORMATION

Note: The following flow shows one side. (Same flow on the opposite side.)

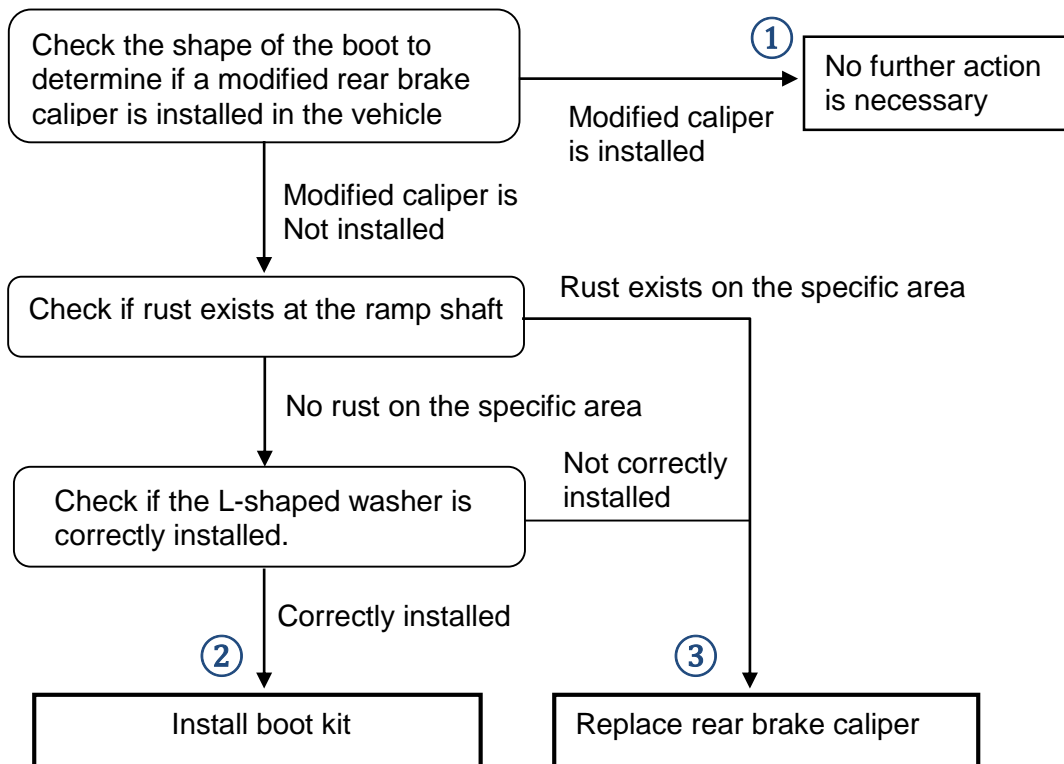

One side

		① Inspection	② Boot R & R	③ Caliper R & R
<u>Other side</u>	① Inspection	① & ① 0.3	① & ② 0.5	① & ③ 0.8
	② Boot R & R		② & ② 0.8	② & ③ 1.0
	③ Caliper R & R			③ & ③ 0.9

For Mazda3 and Mazda6

	① & ① Inspection only (modified calipers are installed on both sides)
Process Number	AH030A
Symptom Code	99
Damage Code	99
Part Number Main Cause	7777-SP-N35
Quantity	0
Labor Operation Number	XXN71XCX
Labor Hours	0.3 hrs.

For Mazda6

Both Boots are replaced, or One Boot is replaced on one side and One Caliper is replaced on the other side:

	② & ② Boots replacement (both sides)	② & ③ Boot replacement (one side) & Caliper replacement (the other side)
Process Number	AH030B	AH030B
Symptom Code	99	99
Damage Code	99	99
Part Number Main Cause & Quantity	G4YG-26-45Z & 1 pc (*1)	G4YE-26-45Z, or G4YF-26-45Z & 1 pc
Related Parts Number & Quantity	--	GHY2-26-61X, or GHY2-26-71X & 1 pc (*2) 9956-21-000 & 2 pcs
Labor Operation Number	XXN73ARX	XXN73BRX
Labor Hours	0.8 hrs.	1.0 hrs.

(*1): If the individual Boot Kit (R) and (L) are used, submit them as Part Number Main Cause (one side) and Related Part (the other side).

(*2): If the caliper is replaced after the boot replacement due to Not OK installation condition of L-shaped washer, submit the applicable boot kit also as a related part.

Note: The most likely cause of this situation is technician error in the repair procedure. Review repair documents.

Both Calipers are replaced:

	③ & ③ Calipers replacement (both sides)
Process Number	AH030C
Symptom Code	99
Damage Code	99
Part Number Main Cause & Quantity	GHY2-26-61X & 1 pc
Related Parts Number & Quantity	GHY2-26-71X & 1 pc (*1) 9956-21-000 & 4 pcs
Labor Operation Number	XXN74XRX
Labor Hours	0.9 hrs.

(*1): If the caliper(s) is(are) replaced after the boot(s) replacement due to Not OK installation condition of L-shaped washer(s), submit the applicable boot kit(s) as related part(s).

Note: The most likely cause of this situation is technician error in the repair procedure. Review repair documents.

Inspection only (No repair is required) on one side & Repair is required on the other side:

	① & ② Inspection only (one side) & Boot replacement (the other side)	① & ③ Inspection only (one side) & Caliper replacement (the other side)
Process Number	AH030B	AH030C
Symptom Code	99	99
Damage Code	99	99
Part Number Main Cause & Quantity	G4YE-26-45Z, or G4YF-26-45Z & 1 pc	GHY2-26-61X, or GHY2-26-71X & 1 pc (*1) 9956-21-000 & 2 pcs
Labor Operation Number	XXN72ARX	XXN72BRX
Labor Hours	0.5 hrs.	0.8 hrs.

(*1): If the caliper is replaced after the boot replacement due to Not OK installation condition of L-shaped washer, submit the applicable boot kit as a related part.

Note: The most likely cause of this situation is technician error in the repair procedure. Review repair documents.

For Mazda3

Both Boots are replaced, or One Boot is replaced on one side and One Caliper is replaced on the other side:

	② & ② Boots replacement (both sides)	② & ③ Boot replacement (one side) & Caliper replacement (the other side)
Process Number	AH030D	AH030D
Symptom Code	99	99
Damage Code	99	99
Part Number Main Cause & Quantity	BJY8-26-45Z, or BJY9-26-45Z & 1 pc	BJY8-26-45Z, or BJY9-26-45Z & 1 pc
Related Parts Number & Quantity	BJY8-26-45Z, or BJY9-26-45Z & 1 pc	BJY7-26-61X, or BJY7-26-71X & 1 pc (*1) 9956-21-000 & 2 pcs
Labor Operation Number	XXN73ARX	XXN73BRX
Labor Hours	0.8 hrs.	1.0 hrs.

(*1): If the caliper is replaced after the boot replacement due to Not OK installation condition of L-shaped washer, submit the applicable boot kit as a related part.

Note: The most likely cause of this situation is technician error in the repair procedure. Review repair documents.

Both Calipers are replaced:

	③ & ③ Calipers replacement (both sides)
Process Number	AH030E
Symptom Code	99
Damage Code	99
Part Number Main Cause & Quantity	BJY7-26-61X & 1 pc
Related Parts Number	BJY7-26-71X & 1 pc (*1) 9956-21-000 & 4 pcs
Labor Operation Number	XXN74XRX
Labor Hours	0.9 hrs.

(*1): If the caliper(s) is(are) replaced after the boot(s) replacement due to Not OK installation condition of L-shaped washer(s), submit the applicable boot kit(s) as related part(s).

Note: The most likely cause of this situation is technician error in the repair procedure. Review repair documents.

No repair is required on one side & Repair is required on the other side:

	① & ② Inspection only (one side) & Boot replacement (the other side)	① & ③ Inspection only (one side) & Caliper replacement (the other side)
Process Number	AH030D	AH030E
Symptom Code	99	99
Damage Code	99	99
Part Number Main Cause & Quantity	BJY8-26-45Z, or BJY9-26-45Z & 1 pc	BJY7-26-61X, or BJY7-26-71X & 1 pc (*1) 9956-21-000 & 2 pcs
Labor Operation Number	XXN72ARX	XXN72BRX
Labor Hours	0.5 hrs.	0.8 hrs.

(*1): If the caliper is replaced after the boot replacement due to Not OK installation condition of L-shaped washer, submit the applicable boot kit as a related part.

Note: The most likely cause of this situation is technician error in the repair procedure. Review repair documents.

RENTAL CAR INFORMATION

Mazda recommends the usage of the MCVP loaner vehicle when available. If all MCVP loaner vehicles are in use and unavailable, and the customer needs a rental car, then use your local rental facility and offer a rental car. Be sure that every effort is made to repair the car within one business day or less in order to allow the next customer the same experience.

Rental Car Warranty Claim Information

	MCVP Vehicle Preferred	Rental Agency Vehicle
Warranty Type Code	N/A MCVP does not require claim submission	A
Symptom Code		99
Damage Code		99
Part Number Main Cause		5555-12-17FR
Part Quantity		0
Labor Operation Code		MM024XRX
Labor Hours		0
Sublet – Rental Car		
Sublet Invoice Number		Number from Rental Invoice or Dealer Purchase Order
Sublet Type Code		Enter "Z9" (other)
Sublet Amount		Up to \$30.00 per day for the number of days customer had rental car
Sublet Text		Number of days rental car was supplied to customer

Rental expenses exceeding the two-day limit will require prior DSM Authorization, as outlined in the Mazda Rental Car Reimbursement Program policy.