

Fuel Tee Leak

Author: Olin Frisvold

5/8/2018

Title	17KWA: Fuel Tee Leak
Search Words	Fuel, tee, leak, recall
Bulletin No.	17KWA
What's New Abstract	Safety Recall - Fuel Tee Leaking on Models K370, T680, and T880 2017 emissions vehicles.
Supplier	VOSS
Description	Fuel Tee Leaking on Models K370, T680, and T880 2017 emissions vehicles
Release Date	03/31/2017
Introduction	Kenworth Truck Company has decided that a defect, which relates to motor vehicle safety, exists in certain model K370, T680, and T880 vehicles manufactured from November 18, 2014 through January 18, 2017.
Situation	The vehicles may have been built with a defective fuel tee fitting that leaks. A manufacturing process control for the fuel tee was out of specification, which may have allowed the part to become porous, allowing a fuel leak during operation.
Resolution	Fuel tees will be replaced on vehicles equipped with suspect fuel tees. Select vehicles require installation of a new bracket. See chassis list below for chassis-specific parts required.

<p>Warranty</p>	<p>DWWC and SIR will indicate chassis involved in this recall with the designator of “17KWA” in the campaign field.</p> <p>There is no time or mileage limit for this recall. Kenworth will pay for parts at dealer net plus applicable mark-up and labor:</p> <ul style="list-style-type: none"> • 0.6 hours labor to replace the fuel tees. (Use Quick Claim Code 17KWAA). • 0.7 hours to replace the fuel tee and bracket. (Use Quick Claim Code 17KWAB). • File a long claim for extraordinary circumstances (which must be explained). <table border="1" data-bbox="451 558 1365 823"> <thead> <tr> <th colspan="4">CLAIM CODING</th> </tr> </thead> <tbody> <tr> <td>Failure Location:</td> <td>044-001-014</td> <td>Work Accomplished:</td> <td>35</td> </tr> <tr> <td>Failure Type:</td> <td>705</td> <td>Responsibility Code:</td> <td>05</td> </tr> <tr> <td>SRT Code:</td> <td>17KWAA 17KWAB</td> <td>Claim Type:</td> <td>C</td> </tr> </tbody> </table>	CLAIM CODING				Failure Location:	044-001-014	Work Accomplished:	35	Failure Type:	705	Responsibility Code:	05	SRT Code:	17KWAA 17KWAB	Claim Type:	C														
CLAIM CODING																															
Failure Location:	044-001-014	Work Accomplished:	35																												
Failure Type:	705	Responsibility Code:	05																												
SRT Code:	17KWAA 17KWAB	Claim Type:	C																												
<p>Parts</p>	<p>Parts are available from PACCAR Parts.</p> <p>Kenworth will reimburse the dealer for parts plus applicable markup.</p> <table border="1" data-bbox="496 1056 1495 1696"> <thead> <tr> <th>Quantity</th> <th>Part #</th> <th>Description</th> </tr> </thead> <tbody> <tr> <td>1</td> <td>K38-1057</td> <td>FTG-SPLY FUEL TEE DUAL DR</td> </tr> <tr> <td>1</td> <td>K38-1058</td> <td>FTG-SPLY FUEL TEE LH DR</td> </tr> <tr> <td>1</td> <td>K38-1059</td> <td>FTG-SPLY FUEL TEE RH DRAW</td> </tr> <tr> <td>1</td> <td>K38-1060</td> <td>FTG-RTN FUEL TEE DUAL DRAW</td> </tr> <tr> <td>1</td> <td>K38-1061</td> <td>FTG-RTN FUEL TEE LH DRAW</td> </tr> <tr> <td>1</td> <td>K38-1062</td> <td>FTG-RTN FUEL TEE RH DRAW</td> </tr> <tr> <td>2</td> <td></td> <td>Cable tie, source locally</td> </tr> <tr> <td>1</td> <td>K11-1291</td> <td>FUEL TEE BRACKET</td> </tr> <tr> <td>2</td> <td>0272563</td> <td>M6 Flange Nuts</td> </tr> </tbody> </table> <p>NOTE: Destroy take-off parts</p>	Quantity	Part #	Description	1	K38-1057	FTG-SPLY FUEL TEE DUAL DR	1	K38-1058	FTG-SPLY FUEL TEE LH DR	1	K38-1059	FTG-SPLY FUEL TEE RH DRAW	1	K38-1060	FTG-RTN FUEL TEE DUAL DRAW	1	K38-1061	FTG-RTN FUEL TEE LH DRAW	1	K38-1062	FTG-RTN FUEL TEE RH DRAW	2		Cable tie, source locally	1	K11-1291	FUEL TEE BRACKET	2	0272563	M6 Flange Nuts
Quantity	Part #	Description																													
1	K38-1057	FTG-SPLY FUEL TEE DUAL DR																													
1	K38-1058	FTG-SPLY FUEL TEE LH DR																													
1	K38-1059	FTG-SPLY FUEL TEE RH DRAW																													
1	K38-1060	FTG-RTN FUEL TEE DUAL DRAW																													
1	K38-1061	FTG-RTN FUEL TEE LH DRAW																													
1	K38-1062	FTG-RTN FUEL TEE RH DRAW																													
2		Cable tie, source locally																													
1	K11-1291	FUEL TEE BRACKET																													
2	0272563	M6 Flange Nuts																													
<p>Procedure</p>	<p><i>Tools</i></p> <ol style="list-style-type: none"> 1. 10 mm 3/8 in. drive socket 																														

2. 10 mm ¼ in. drive socket
3. Batter impact driver
4. Torque wrench with 7.9 N-m (70 in-lb.) capacity
5. Air blow gun
6. Small flat-tip screwdriver
7. Davco or Mity-vac fuel system priming tool

Trucks built before 1 January, 2016

These vehicles require replacement of the mounting bracket, in addition to replacement of the fuel tees. The original bracket does not have holes for the studs on the replacement fuel tees.

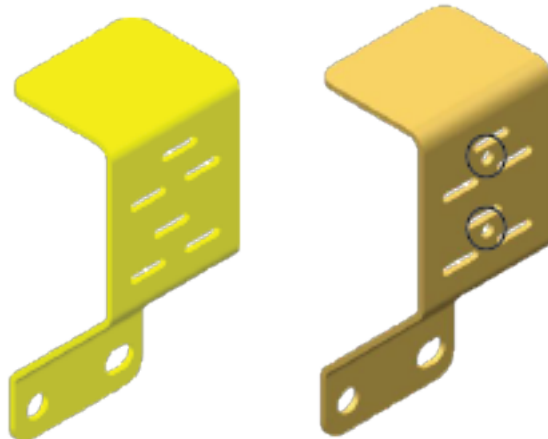

Figure 1 Old bracket on left, new bracket on right

NOTE: New fuel tees have a white dot indicator.



Procedure

1. Install the new fuel tees on the new bracket by aligning the locking tabs and stud to the corresponding slots and hole in the bracket and then pressing the fuel tee firmly into the bracket until the tabs snap into place.

NOTE: Each fuel tee only fits in one set of slots in the bracket.



Figure 2 Fuel Tee mounting slots offset

2. Install new nuts on the studs of the fuel tees. Torque the nuts to 7.9 N-m (70 in-lb.).
3. Depressurize the fuel system.

ADD A CAUTION HERE ABOUT DEPRESSURIZING THE FUEL SYSTEM.

- a. Remove the fuel caps from the fuel tanks.
- b. Disconnect fuel lines that come from the tank from the primary fuel filter
- c. Blow air down the fuel lines to push the fuel into the tanks.
4. Mark one set of the fuel lines that connect to a fuel tee to identify their location as top or bottom fuel tee.
5. Remove the fuel lines from the fuel tees.
6. Remove the nuts from inside the BOC crossmember and then remove the washers and bolts.
7. Remove the bracket and fuel tees.
8. Install the new bracket and fuel tees in place of the original.
9. Install the fuel lines without removing the locking collars. An audible snap is heard/felt when the quick-connect locking collar locks over the retaining rib on the fuel tee.

10. Prime the fuel system. Instructional videos for using the [Davco or Mity-Vac tools](#) are located at: www.bca-training.com, under PACCAR MX ENGINES | Knowledge Minute.

Trucks built 1 January, 2016 and after

These vehicles require only replacement of the fuel tees.

TIP: It is easiest to replace one fuel tee at a time.

NOTE: New fuel tees have a white dot indicator.



Procedure

1. Depressurize the fuel system.

ADD A CAUTION HERE ABOUT DEPRESSURIZING THE FUEL SYSTEM.

- a. Remove the fuel caps from the fuel tanks.
 - b. Disconnect fuel lines that come from the tank from the primary fuel filter.
 - c. Blow air down the fuel lines to push the fuel into the tanks.
2. Mark one set of the fuel lines that connect to a fuel tee to identify their location as top or bottom fuel tee.
 3. Remove the fuel lines from the fuel tees.
 4. Remove the mounting nuts from fuel tees.
 5. Remove the fuel tees from bracket.
 6. Install the new fuel tees on the bracket by aligning the locking tabs and stud to the corresponding slots and hole in the bracket and then pressing the fuel tee firmly into the bracket until the tabs snap into place.

NOTE: Each fuel tee only fits in one set of slots in the bracket. Notice the offset of the mounting slots shown in the figure below.



Figure 3 Fuel Tee mounting slots offset

7. Install new nuts on the studs of the fuel tees. Torque the nuts to 7.9 N-m (70 in-lb.).
8. Install the fuel lines without removing the locking collars. An audible snap is heard/felt when the quick-connect locking collar locks over the retaining rib on the fuel tee.
9. Prime the fuel system. Instructional videos for using the [Davco or Mity-Vac tools](http://www.bca-training.com) are located at: www.bca-training.com, under PACCAR MX ENGINES | Knowledge Minute.

Shipping

Freight

Contact

Attachments	Dealer\Chassis List Customer Letter
--------------------	--