



Technical Service Bulletin

GROUP RECALL	NUMBER 17-01-061
DATE NOVEMBER, 2017	MODEL(S) Sonata (YF) Sonata Hybrid (YF HEV)

SUBJECT: 2011-2014 SONATA (YF) AND 2011-2015 SONATA HYBRID (YF HEV)
ANCHOR PRETENSIONER LABEL INSTALLATION
(RECALL CAMPAIGN 169)

★ IMPORTANT

*** Retail Vehicles ***

Dealers must perform this Recall Campaign whenever an affected vehicle is in the shop for any maintenance or repair.

When a vehicle arrives at the service department, access Hyundai Motor America's "Warranty Vehicle Information" screen via WEBDCS to identify open Campaigns.

Description:

The front seat belt assembly incorporates a seat belt anchor pretensioner fastened to the vehicle's inner sill structure. During vehicle assembly, the anchor pretensioner is fastened to the sill prior to being connected to the seat belt linkage. If, during vehicle assembly, the connector did not fully latch when the linkage was pressed onto the connector, the seat belt can detach from the anchor pretensioner. If the seat belt linkage detaches from the anchor pretensioner in a collision, the risk of injury to the occupant is increased.

This bulletin describes the procedure to install warning labels on the driver's and passenger's seat belt assemblies to prevent potential improper reattachment of the anchor pretensioners.

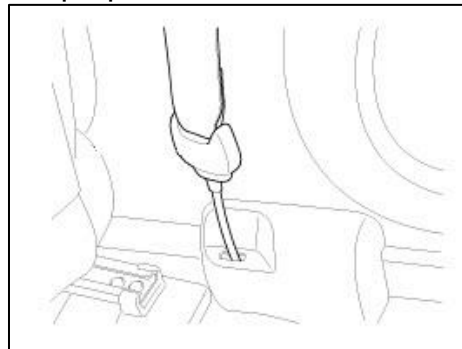

NOTICE

Please note this is a simple installation that can be performed in the dealer's service drive in less than 5 minutes.

Applicable Vehicles:

2011-2014 MY Sonata (YF) vehicles

2011-2015 MY Sonata Hybrid (YF HEV) vehicles

Parts Information:

Part Name	Part Image	Part Number		Remarks
		Previous	New	
Warning Label, Anchor Pre-Tensioner		N/A	20114-1882R	1000 labels per roll (2 labels needed per vehicle)

Note: Each dealer was provided one roll of 1000 labels for Recall 160. Recall 169 uses the same label as Recall 160. Additional labels can be ordered from your facing PDC.

Warranty Information:

Model	Op Code	Operation	Op Time	Causal Part No.	Nature Code	Causal Code
Sonata (YF) Sonata Hybrid (YF HEV)	71C093R0	Anchor Pretensioner Label Installation	0.2 M/H	88841-3Q000	B15	ZZ1

NOTE 1: Submit Claim on Campaign Claim Entry Screen

NOTE 2: If a part is found in need of replacement while performing Recall 169 and the affected part is still under warranty, please submit a separate claim using the same Repair Order. If the affected part is out of warranty, submit a Prior Approval Request for goodwill consideration prior to performing the work.

Service Procedure:

1. Move the passenger seat forward and locate the passenger anchor pretensioner (A) near the lower B pillar trim (B).

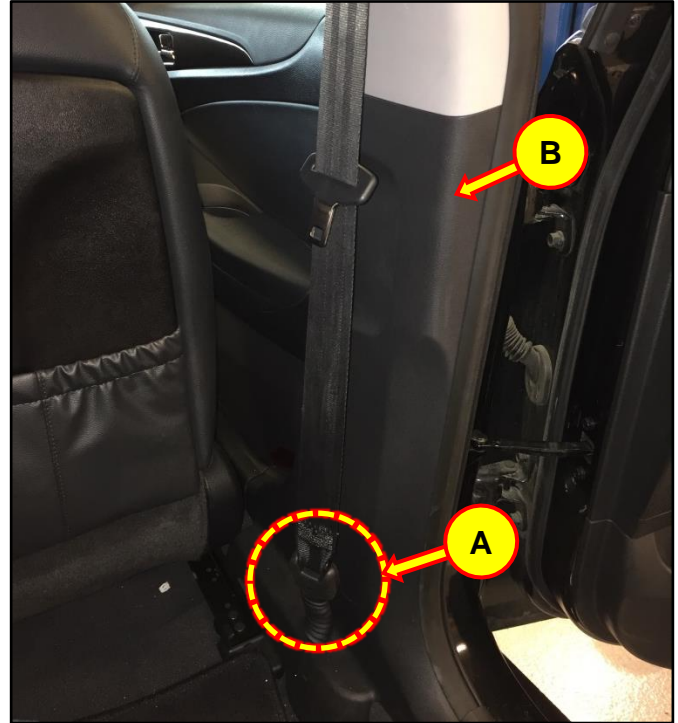

2. Visually inspect the outboard surface of the linkage element (C) and make sure the surface is free from any debris.
Note: if necessary, wipe the surface with a clean dry cloth.



3. Peel off the label (D) and align it with the center hole (E) and top horizontal line (F) of the linkage element.

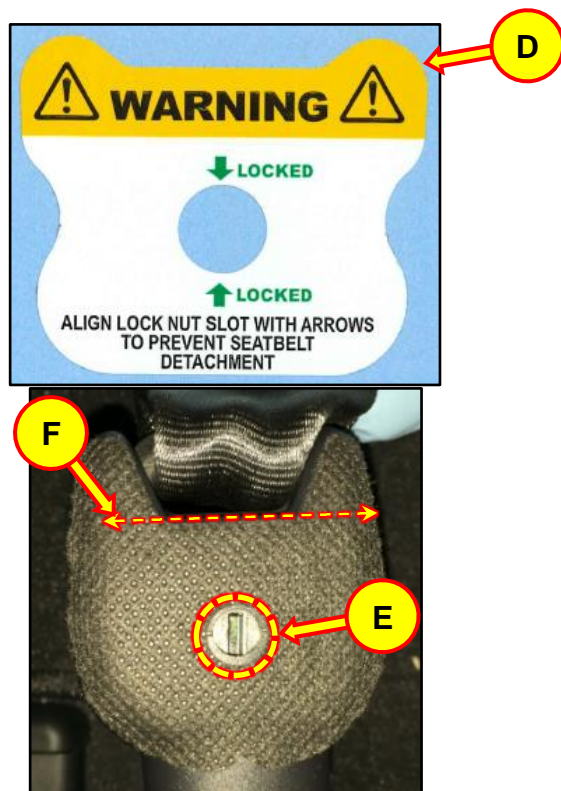

4. Firmly press down on the label to ensure it adheres to the surface of the linkage element.
Note: Green “LOCKED” arrows (G) should align with the latch slot.



5. Move the driver seat forward, locate the driver's anchor pretensioner, and repeat Steps 2 through 4.