

REPAIR PROCEDURE FIT

NOTE:

- If the VIN status inquiry indicates that the vehicle is subject to any open safety recalls, including a driver's airbag inflator campaign/recall, make sure to also complete those recall repairs before returning the vehicle to the customer. If you are unable to complete any open recall, advise the customer of the recall status and when the recall could be completed.
 - Make sure you have the anti-theft code for the audio and navigation system (if applicable), then write down the frequencies for the audio unit's preset buttons.
 - Be careful not to damage any parts when replacing the inflator and **follow the procedure exactly**.
 - If, before removing the airbag, you suspect that it may be the incorrect airbag for the vehicle or a counterfeit, **do not remove the airbag**. Contact your DPSM for assistance.
 - Make sure you have reviewed the SRS Precautions and Procedures in service information before doing the REPAIR PROCEDURE.
1. Turn the ignition to ON and check if the SRS indicator comes on for about 6 seconds, then goes off.
 - If the indicator comes on, then goes off after about 6 seconds, go to step 2.
 - If the indicator does not come on, or if it stays on, contact your DPSM for assistance.
 2. Disconnect the battery negative cable and wait at least 3 minutes before continuing.
 3. Remove the front passenger's airbag by referring to the service information.
 4. Place the airbag, face-down, on a clean shop towel.

NOTE:

- The orientation of the airbag is critical because if the inflator is installed incorrectly, the harness will be too short when you reinstall the airbag.
- The Fit does not have mounting studs. It is secured in the vehicle with bolts, so make sure the mounting bolt holes are facing you.

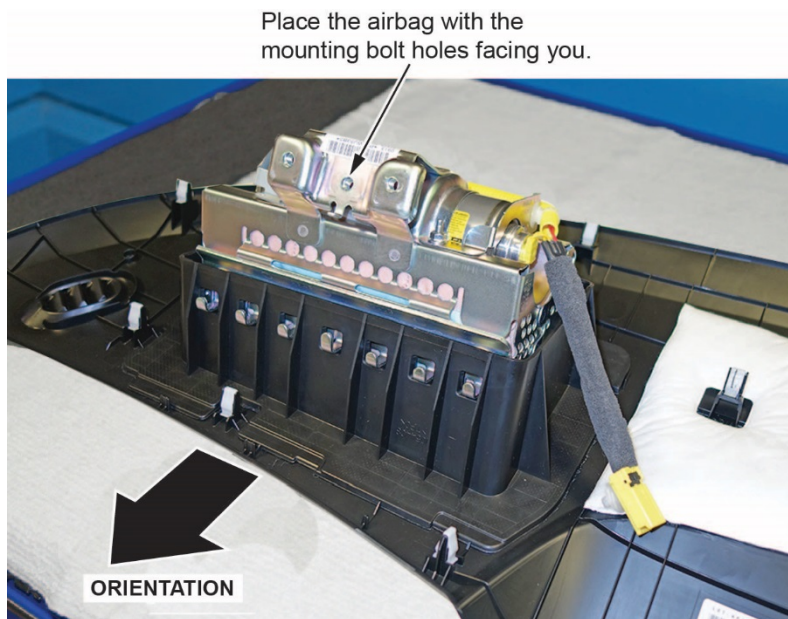

5. Visually inspect the airbag and the inflator for any unusual writing or markings. Refer to IDENTIFYING COUNTERFEIT AIRBAGS.

6. Peel the label located inside the inflator box from its backing and attach it to the RO. For the warranty claim to be paid, the **replacement inflator part number that you received** must be included in the warranty claim.

NOTE:

- The replacement part number is printed on the top part of the label and the serial number is printed on the bottom. **Make sure you attach the label to the RO and give it to the warranty clerk.**
- There may also be a colored sticker located in the kit; ignore it because it is not used.
- Not all inflator kits have a label included. In those cases, write the serial number and part number from the side of the inflator box on the RO. The part number always starts with 047.

PASSENGER INFLATOR PARTS BOX

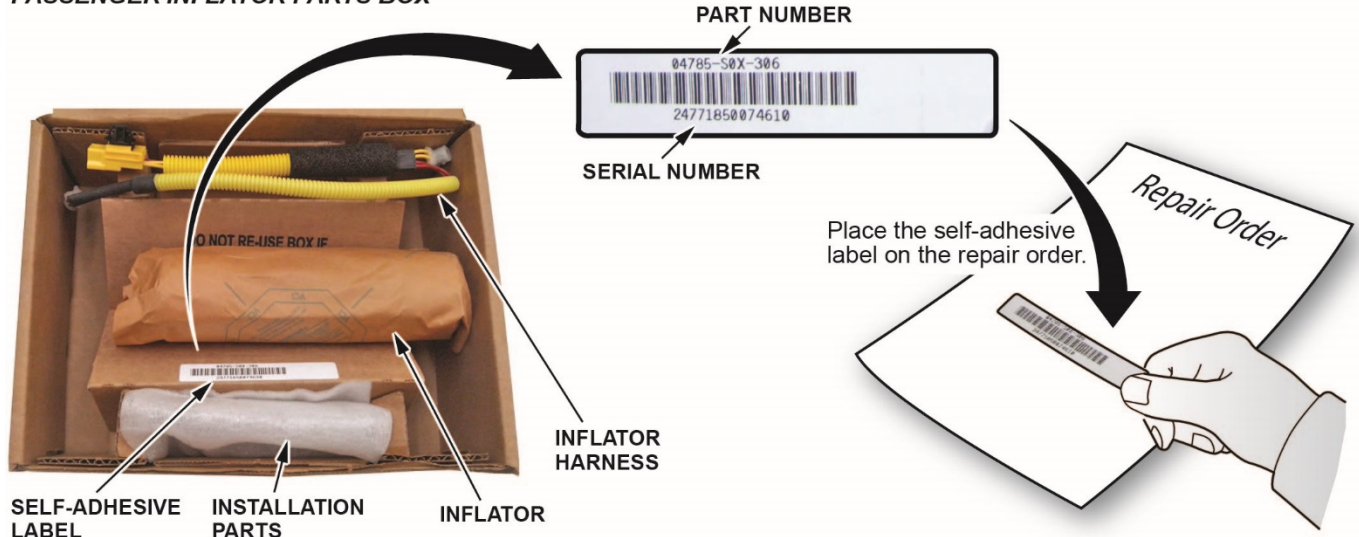

7. Remove the harness from both ends of the inflator bracket.

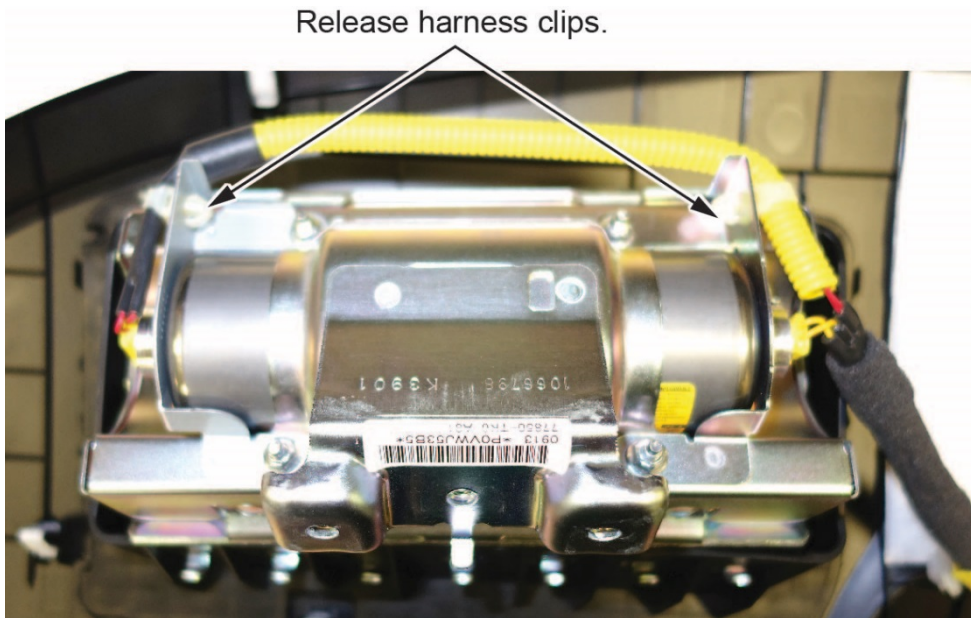

8. Short the yellow wires.

NOTE:

- **You must cut the yellow wires** for inflator removal and short the yellow wires on the inflator side as indicated to prevent accidental deployment.
- **Do not cut the red wires** because the airbag connector shorts these inflator wires.
- **There is glue securing the black insulation to the yellow wires.** Be careful not to cut the wires when removing the insulation.
- Cut 1–2 inches of the corrugated tube to access the yellow wires.
- Cut the yellow wires as shown.

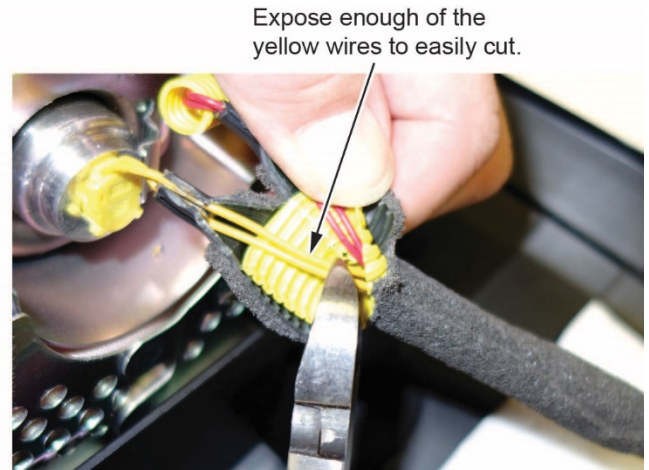

- Strip away about 1 inch of the yellow wire insulation, then twist the wires together.

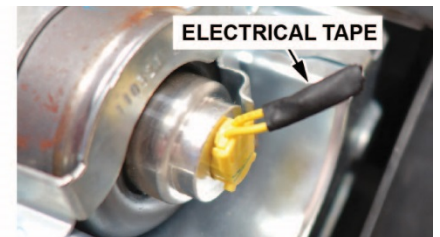
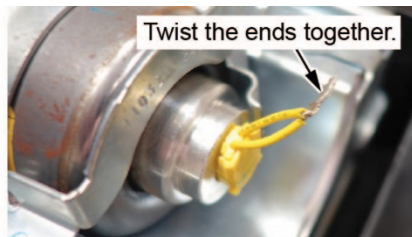

- Tape the twisted ends with electrical tape.

9. Remove the four inflator nuts.

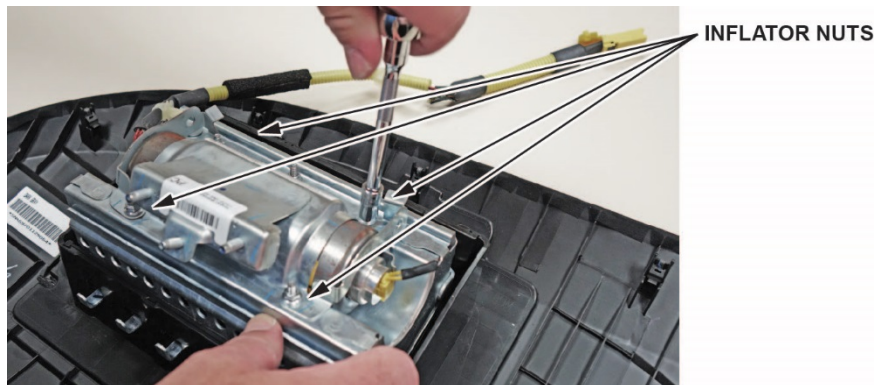

10. Remove the inflator bracket.

NOTE:

- You can only remove one of the brackets, as the other is welded to the airbag housing.
- Do not reuse the bracket; use the new one that came in the inflator kit.

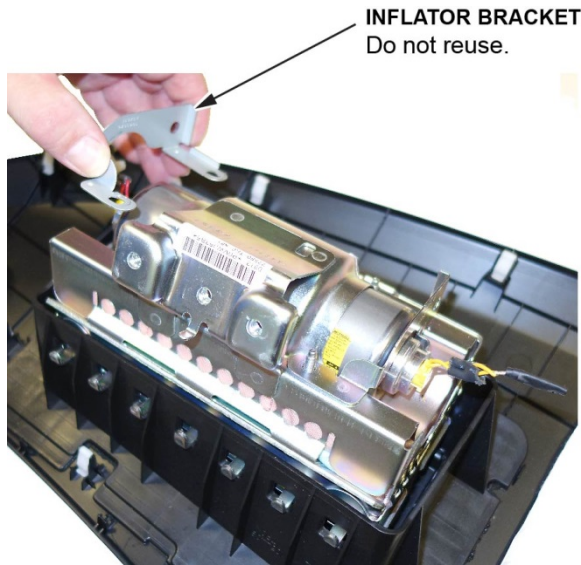

11. Remove the inflator by pulling it out.



12. Install the new inflator.

P/N 04790-TK6-407

- One side of the inflator has a longer collar, a single tab, a plastic cutout, and a small flat spot on the connector. The other side of the inflator has a shorter collar, two tabs, and a red dot. Make sure you insert the end with the shorter collar into the airbag first.

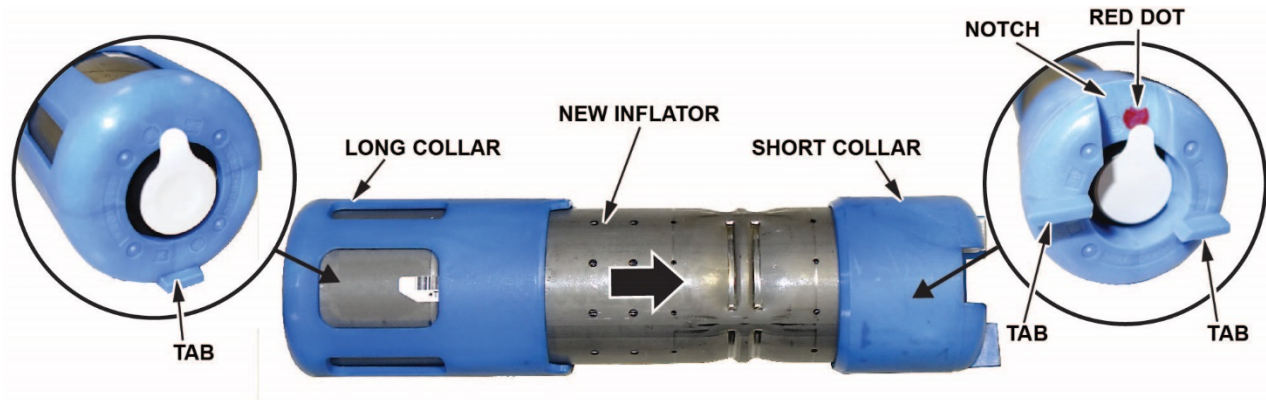

LONG COLLAR The inflator installation is directional.

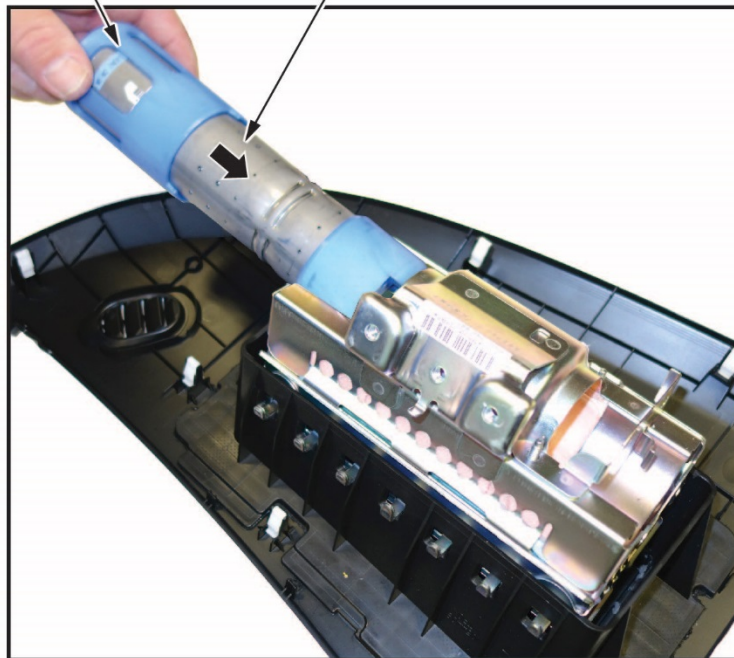

- Slide the inflator in until the plastic collar contacts the bracket. The two tabs should align with the side of the airbag module and the metal tab as shown. There should be no space or gap between the inflator and bracket.

FIXED BRACKET END

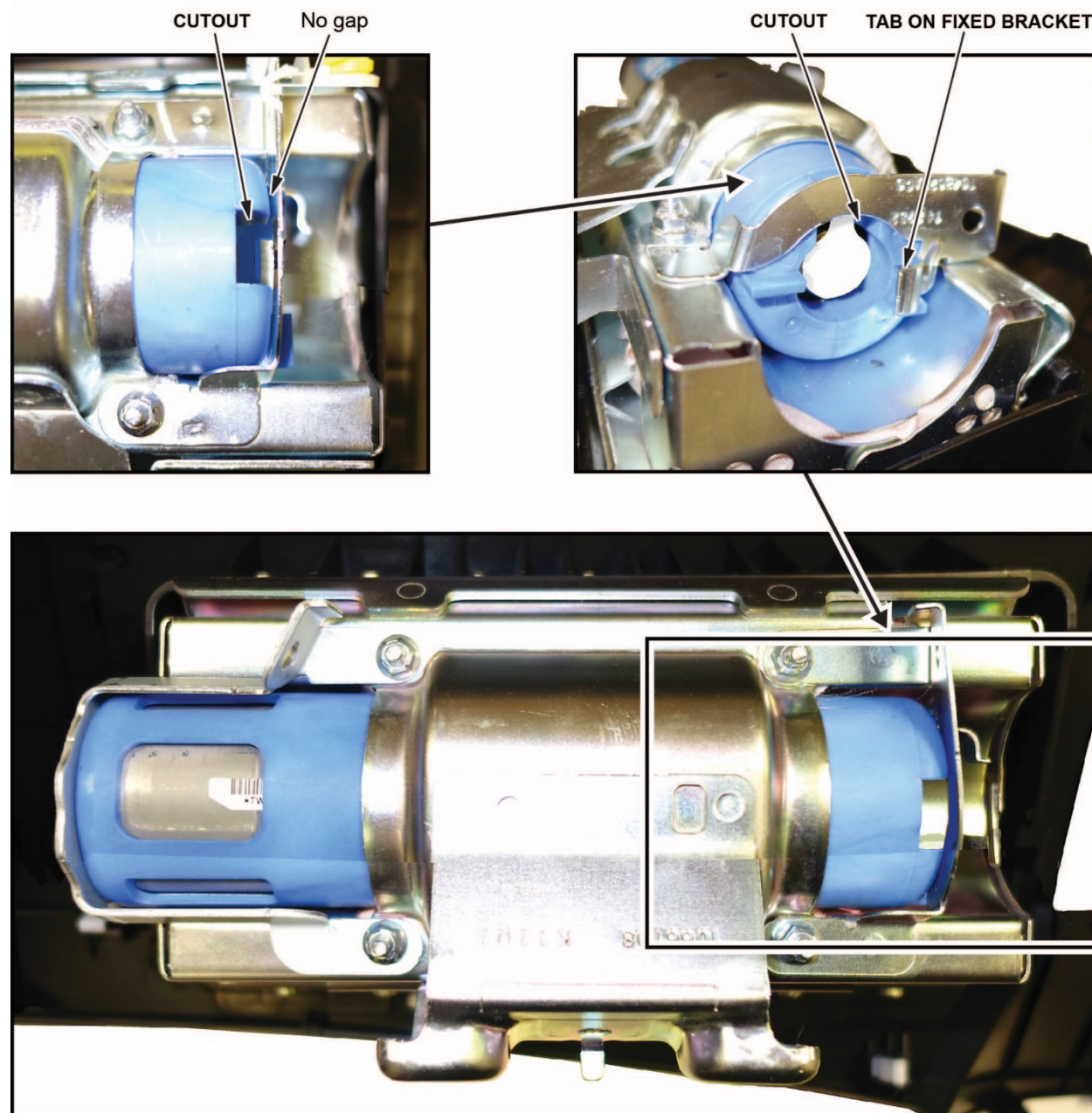

- Install the new bracket included in the kit onto the airbag module. Check there is no space or gap between the inflator and bracket by pushing the bracket against the inflator.

NOTE: The bracket may have a little bit of play before you install the new nuts.

ADJUSTABLE BRACKET END

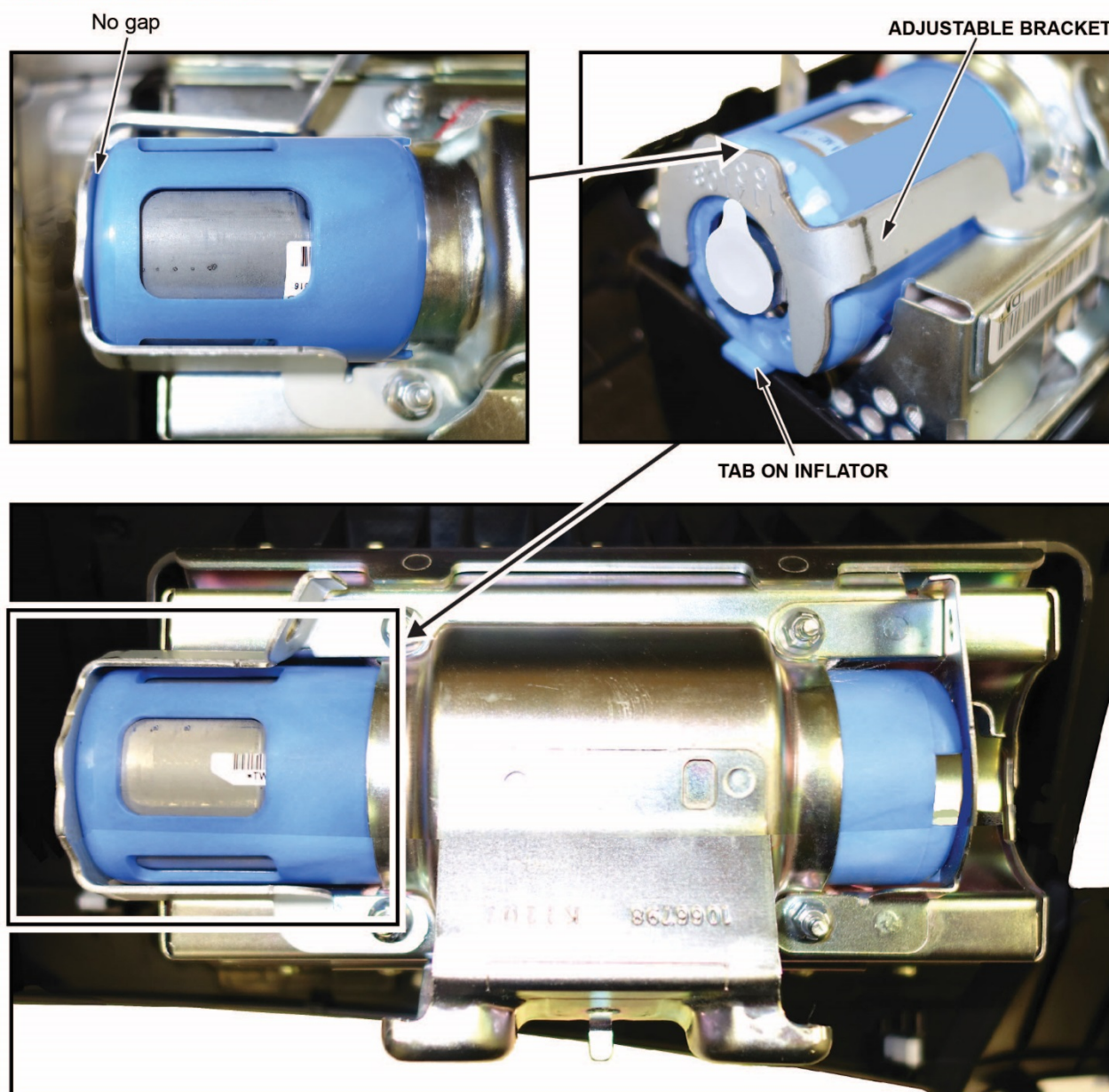

13. Hold the bracket against the inflator, then install the new 5 mm locknuts and torque them in sequence to **4.0 N•m (34 lb-in)**.

NOTE: Make sure you push the bracket against the inflator to ensure there are no gaps between the brackets and inflator when torquing the nuts.

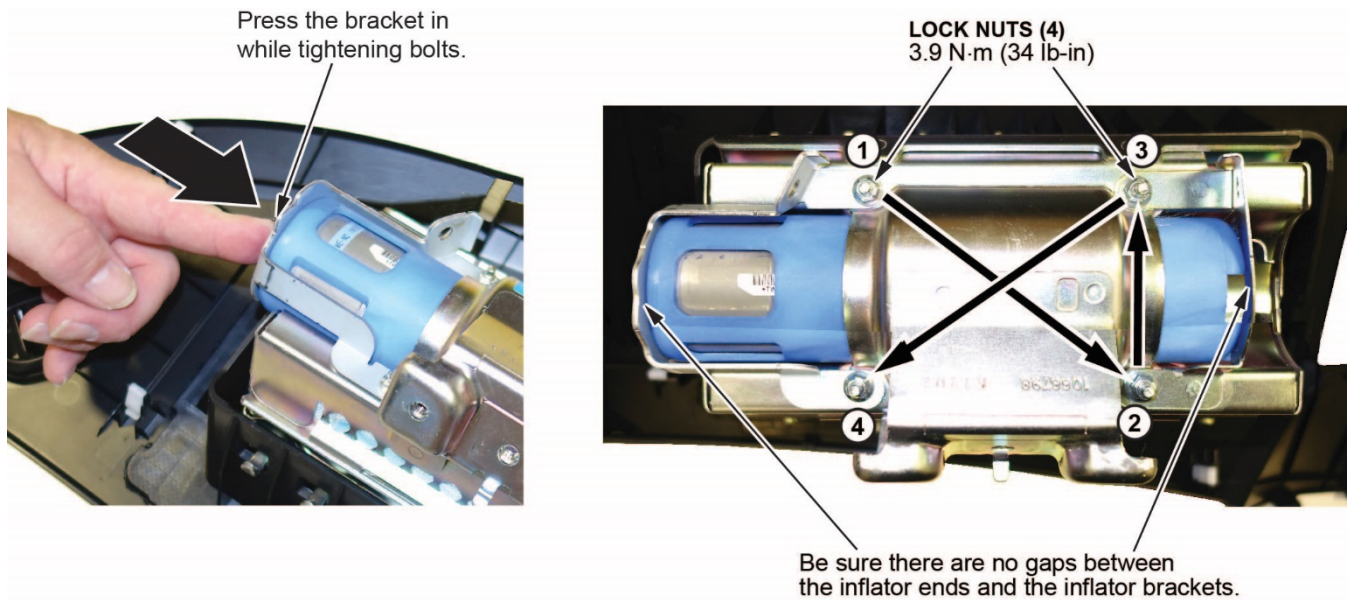

14. Remove the stickers covering the terminals on both sides of the new inflator.

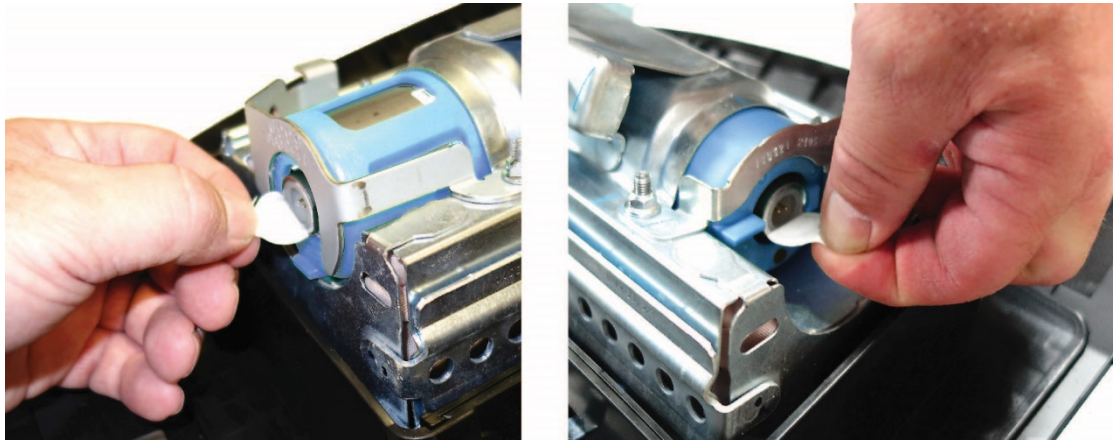

15. Install the new inflator harness.

- Make sure the airbag and harness are aligned as shown.

NOTE:

- **The replacement inflator harnesses have the wire colors in the opposite positions of the original harness.** If you connect the harness incorrectly, the harness cannot be removed, and you will not be able to reinstall the airbag because the harness will be too short.
- Connect the red wire connector to the side of the inflator with the red dot.
- On vehicles with the blue inflator, the red dot is not visible because it is covered by the bracket.

ORIGINAL INFLATOR HARNESS ROUTING

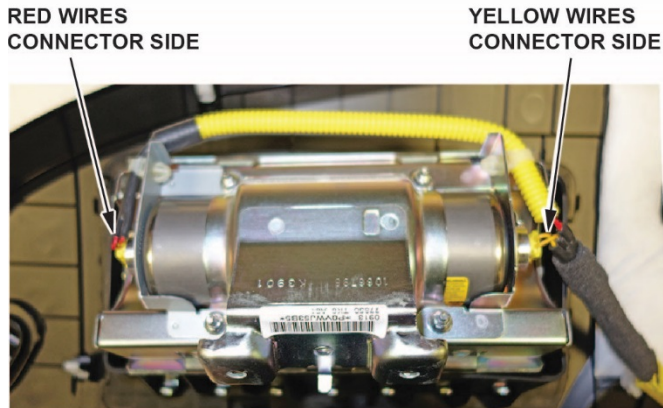

NEW INFLATOR HARNESS ROUTING

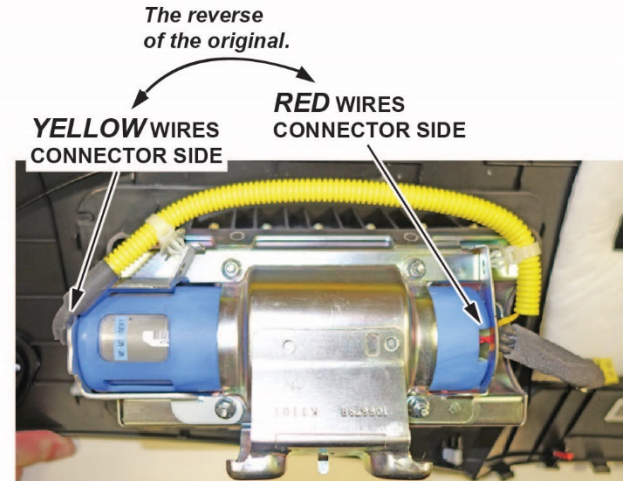

- Connect the red wire connector to the connector on the side with the short plastic cap. Align the "T" shape in the inflator harness connector with the T-shaped inflator connector, then press the connector into place.

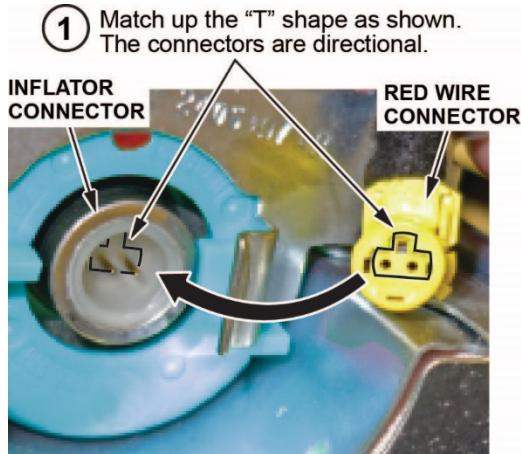

- ② Press the connector into place until it clicks.



- ③ Wiggle the connector to make sure it's secure.



- Connect the yellow wire connector to the connector on the side with the long plastic cap.
- After you hear each connector click, wiggle it to make sure it is secure.

NOTE: If the connector is not properly aligned, it will come out.

16. Make sure the connector is secure and in place by using the gauge tool. (PSPI6 Gauge Tool P/N: 070AJ-TA00A00 or 07AAJ-TA0AA00)

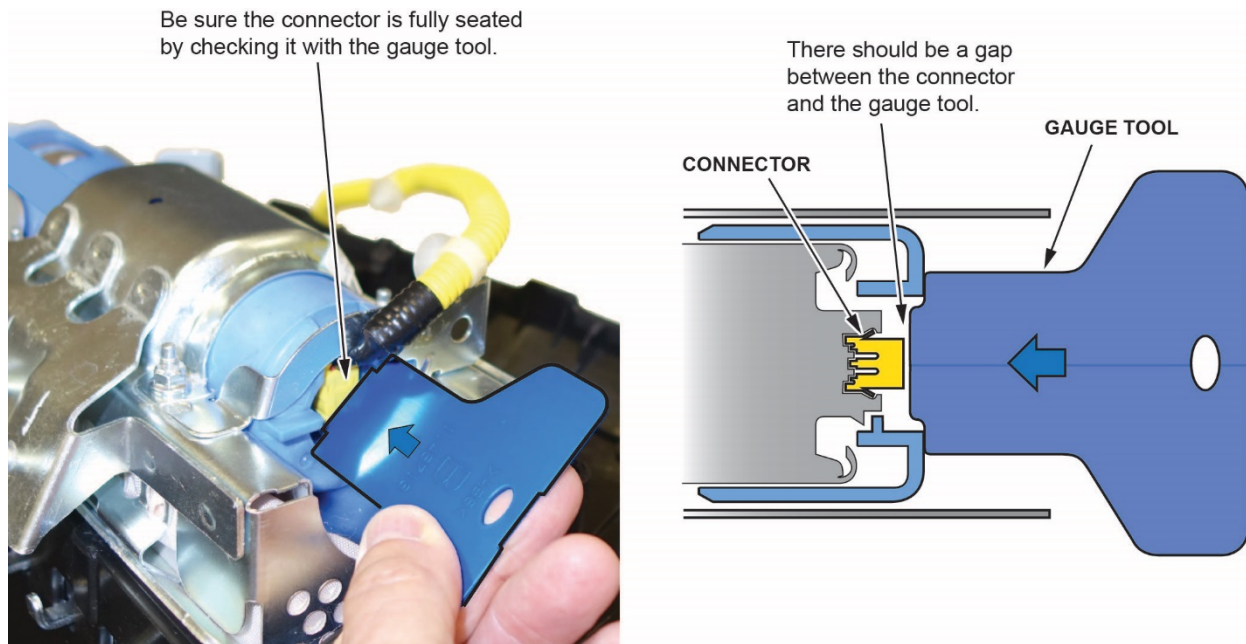

17. Connect the harness to the inflator brackets as shown.

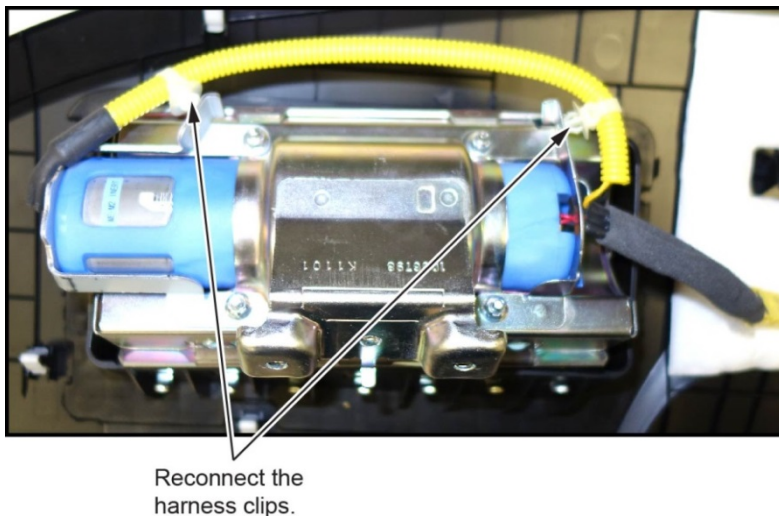

18. Reinstall the passenger's airbag into the vehicle and torque the new locknuts to **9.8 N•m (7.2 lb-ft)**.
19. Reconnect the battery negative cable.
20. Turn the ignition ON and make sure the SRS indicator comes on for about 6 seconds, then goes off.
21. Set the clock (for vehicles without navigation) and enter the anti-theft code for the audio and navigation system (if applicable).
22. Put the original inflator into the box the new one came in. Make sure there is no other hardware in the box because if the package rattles, it will not be accepted by the courier.
23. Follow the shipping instructions outlined in PIB A15-0002 to return the undeployed inflator.
24. Give your warranty clerk the RO that includes the replacement inflator serial number and replacement part number. For the warranty claim to be paid, the **replacement inflator part number** must be included in the warranty claim.

END

REPAIR PROCEDURE PILOT

NOTE:

- If the VIN status inquiry indicates that the vehicle is subject to any open safety recalls, including a driver's airbag inflator campaign/recall, make sure to also complete those recall repairs before returning the vehicle to the customer. If you are unable to complete any open recall, advise the customer of the recall status and when the recall could be completed.
 - Make sure you have the anti-theft code for the audio and navigation system (if applicable), then write down the frequencies for the audio unit's preset buttons.
 - Be careful not to damage any parts when replacing the inflator and **follow the procedure exactly**.
 - If, before removing the airbag, you suspect that it may be the incorrect airbag for the vehicle or a counterfeit, **do not remove the airbag**. Contact your DPSM for assistance.
 - Make sure you have reviewed the SRS Precautions and Procedures in the service information before doing the REPAIR PROCEDURE.
1. Turn the ignition ON and check if the SRS indicator comes on for about 6 seconds, then goes off.
 - If the indicator comes on, then turns off after about 6 seconds, go to step 2.
 - If the indicator does not come on, or if it stays on, contact your DPSM for assistance.
 2. Disconnect the battery negative cable and wait at least 3 minutes before continuing.
 3. Remove the front passenger's dashboard trim by referring to the service information.
 4. Remove the front passenger's airbag.
 - Disconnect the front passenger's airbag 4P connector from the dashboard wire harness.

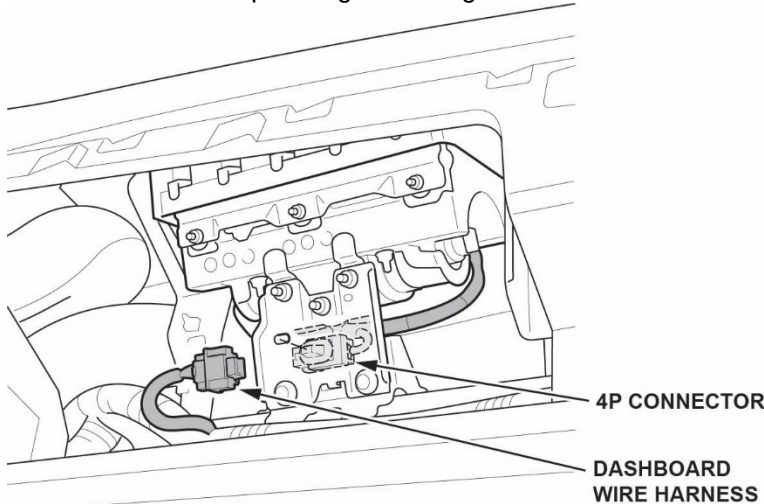

- Remove the mounting nuts and bolts to remove the bracket.

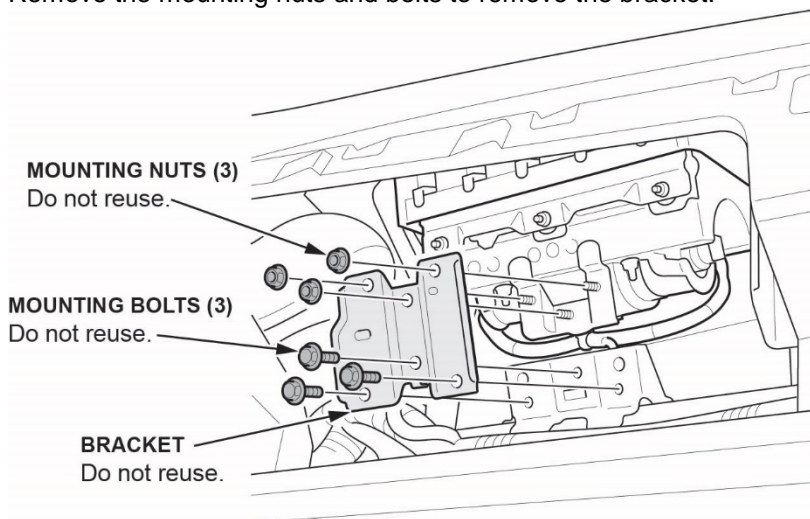

- Remove the mounting nuts from the hook plate.

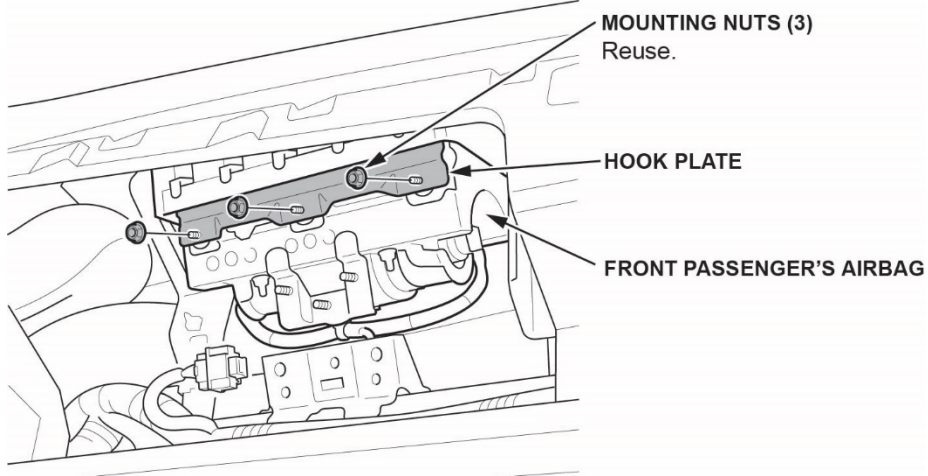

- Release the hooks on the hook plate from the front passenger's airbag housing and remove the hook plate.

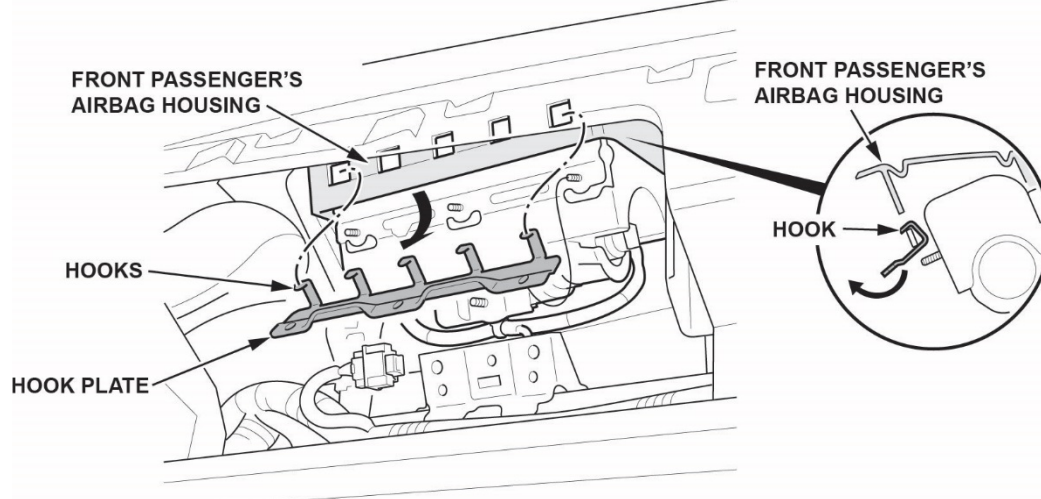

- Remove the front passenger's airbag.

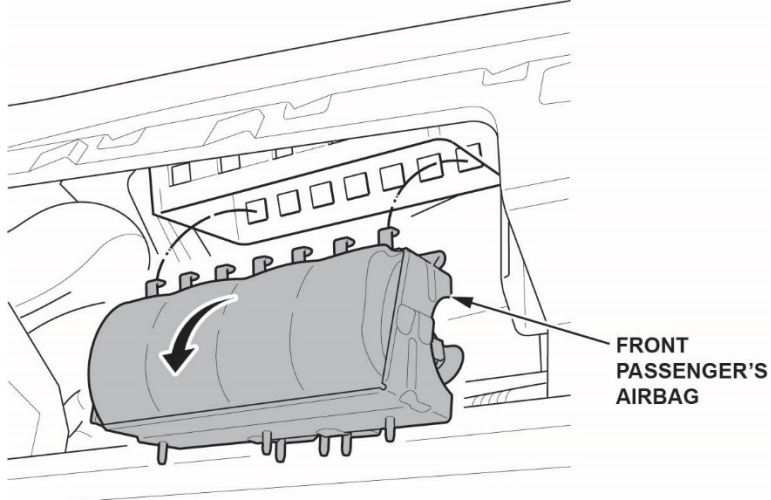

5. Place the airbag, face-down, on a clean shop towel.

NOTE:

- The orientation of the airbag is critical because if the inflator is installed incorrectly, the harness will be too short when you reinstall the airbag.
- The brackets between the various models are similar, but may differ from the example shown.

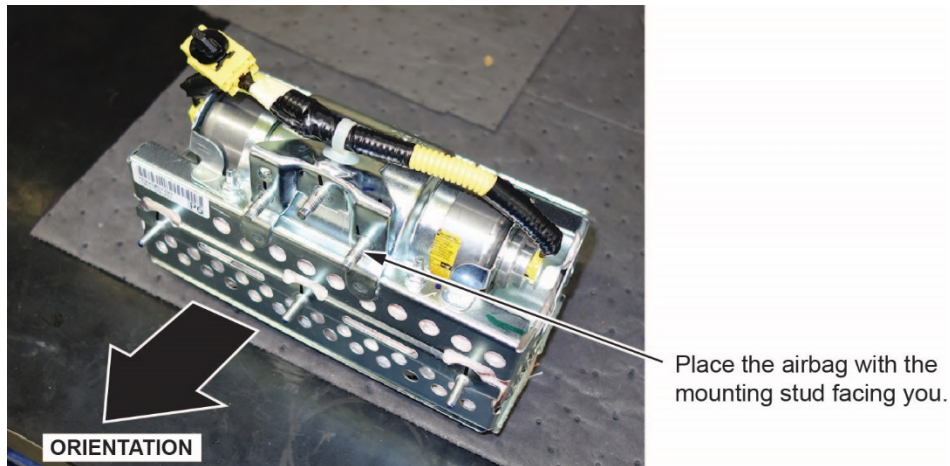

6. Visually inspect the airbag and the inflator for any unusual writing or markings. Refer to IDENTIFYING COUNTERFEIT AIRBAGS.
7. Peel the label located inside the inflator box from its backing and attach it to the RO. For the warranty claim to be paid, the **replacement inflator part number that you received** must be included in the warranty claim.

NOTE:

- The replacement part number is printed on the top part of the label and the serial number is printed on the bottom. **Make sure you attach the label to the RO and give it to the warranty clerk.**
- There may also be a colored sticker located in the kit; ignore it because it is not used.
- Not all inflator kits have a label included. In those cases, write the serial number and part number from the side of the inflator box on the RO. The part number always starts with 047.

PASSENGER INFLATOR PARTS BOX

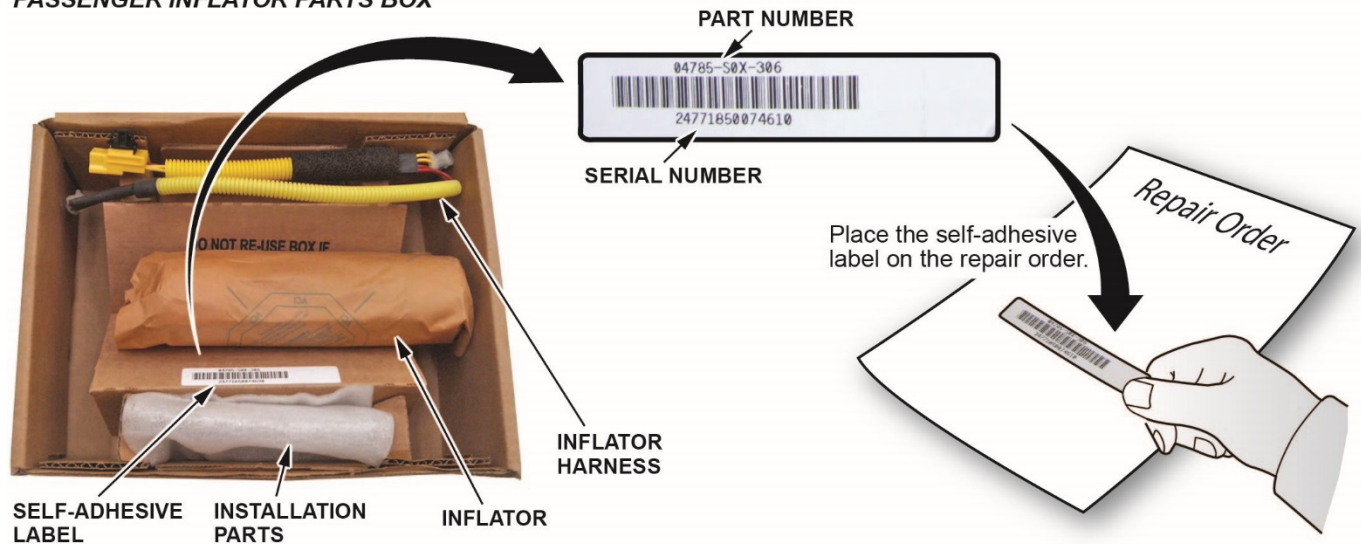

8. Remove the harness from both ends of the inflator bracket.

Release harness clip.

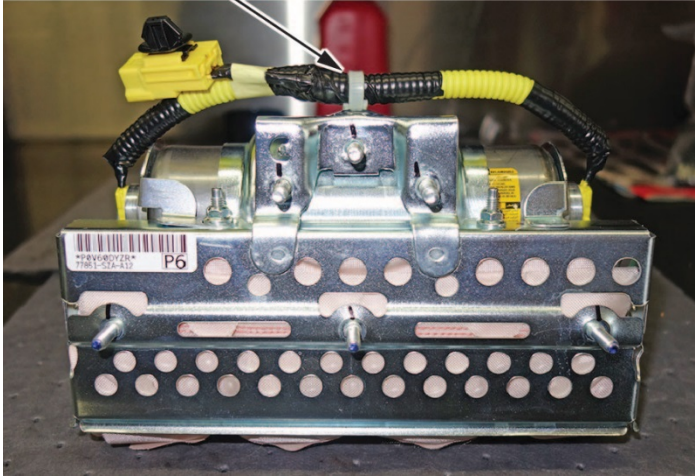

9. Short the yellow wires.

NOTE:

- **You must cut the yellow wires** for inflator removal and short the yellow wires on the inflator side as indicated to prevent accidental deployment.
- **Do not cut the red wires** because the airbag connector shorts these inflator wires.
- Cut the yellow wires as shown.

Cut the harness on this side.

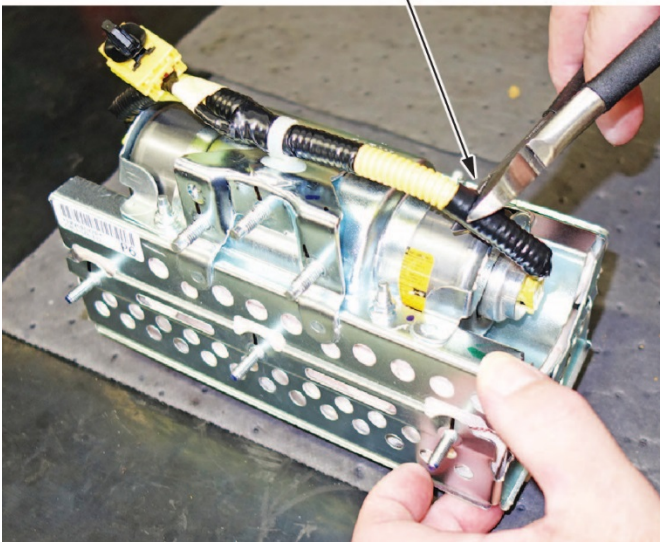

Remove the corrugated tube to expose the yellow wires.



- Strip away about 1 inch of the yellow wire insulation, then twist the wires together.

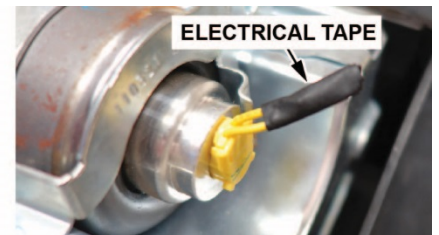
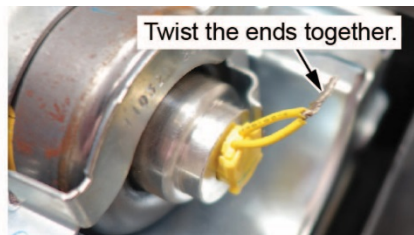

- Tape the twisted ends with electrical tape.

10. Remove the four inflator nuts.

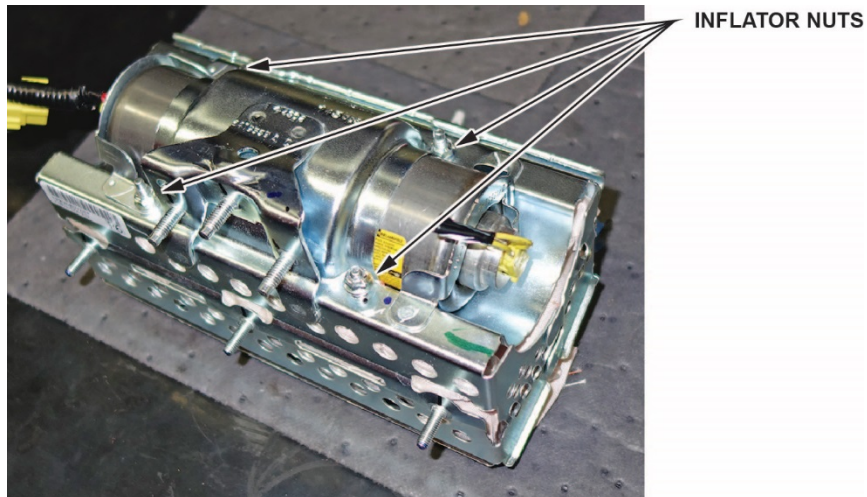

11. Remove the inflator bracket.

NOTE:

- You can only remove one of the brackets, as the other is welded to the airbag housing.
- Do not reuse the bracket, use the new one that came in the inflator kit.

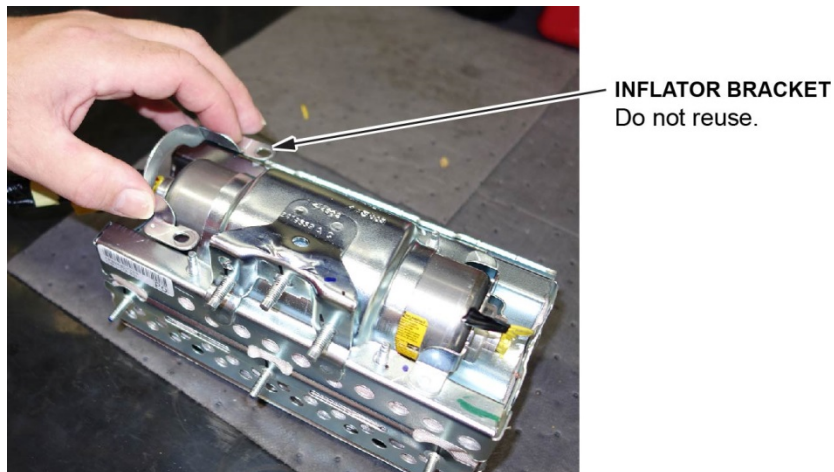

12. Remove the inflator by pulling it out.

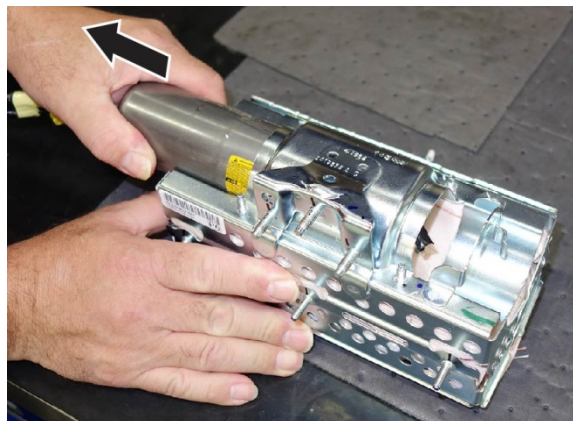

13. Install the new inflator.

P/N 04790-SZA-407

- One side of the inflator has a longer collar, a single tab, a plastic cutout, and a small flat spot on the connector. The other side of the inflator has a shorter collar, two tabs, and a red dot. Make sure you insert the end with the shorter collar into the airbag first.

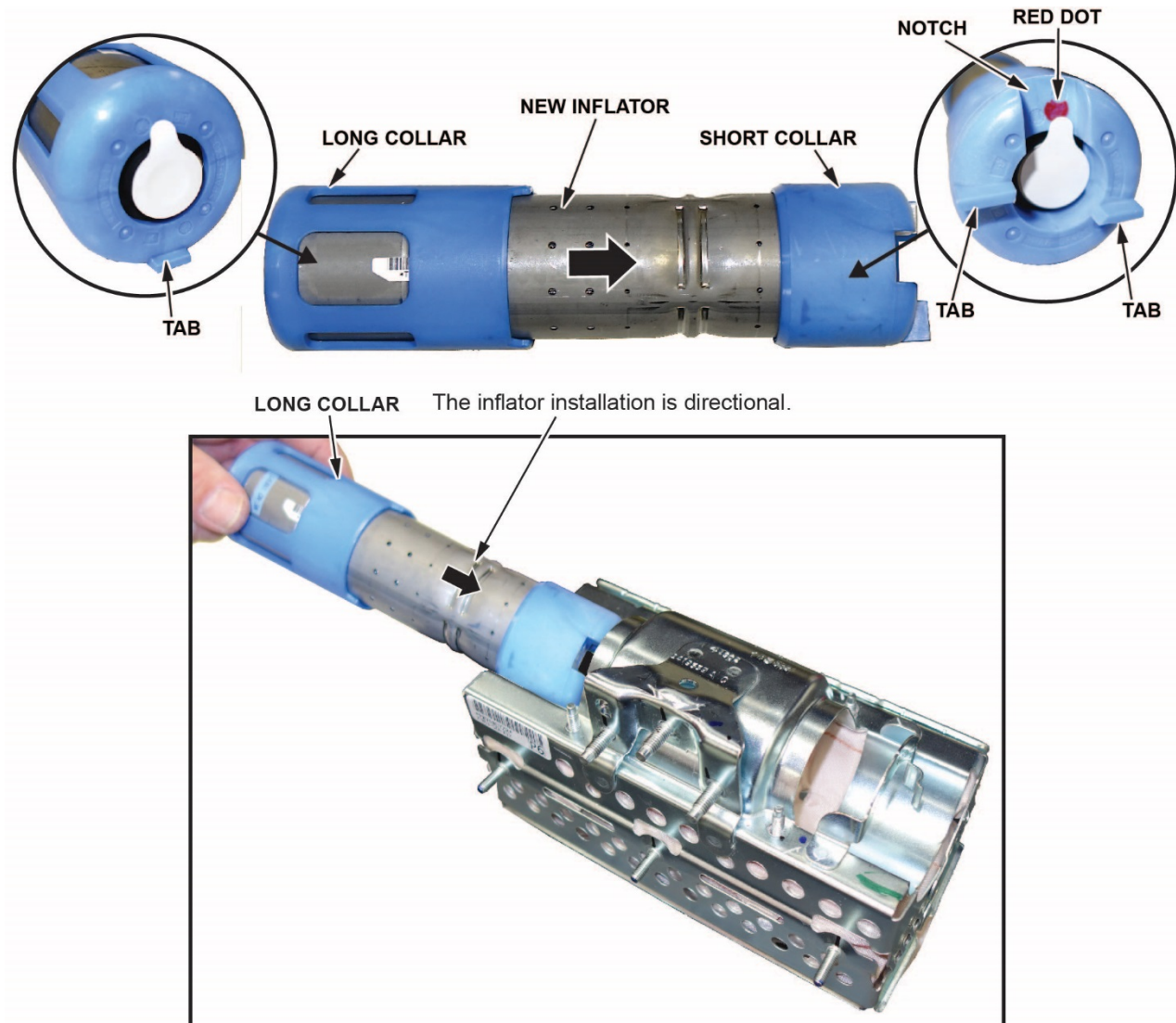

- Slide the inflator in until the plastic collar contacts the bracket. The two tabs should align with the side of the airbag module and the metal tab as shown. There should be no space or gap between the inflator and bracket.

FIXED BRACKET END

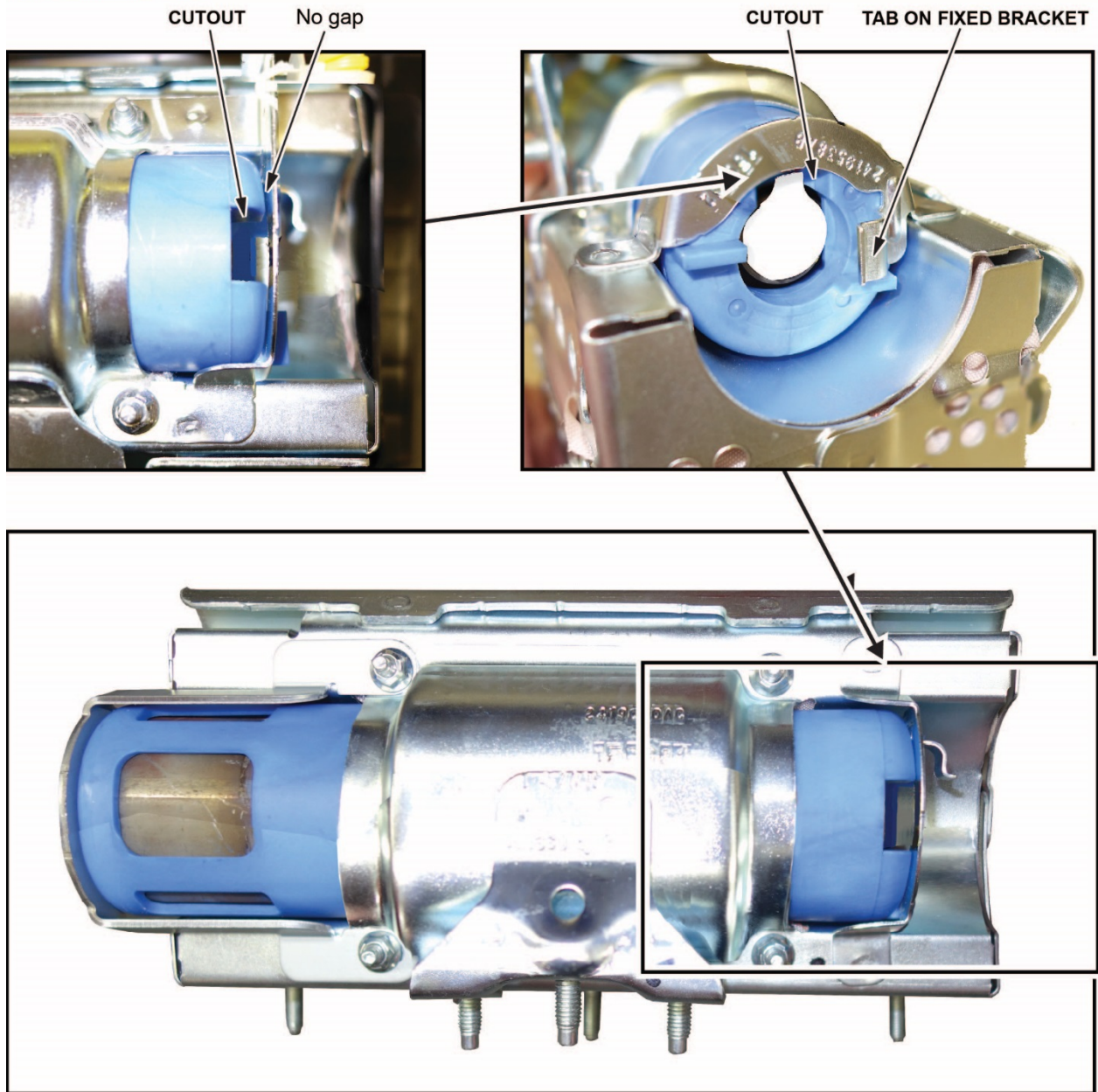

- Install the new bracket included in the kit onto the airbag module. Check there is no space or gap between the inflator and bracket by pushing the bracket against the inflator.

NOTE: The bracket may have a little bit of play before you install the new nuts.

ADJUSTABLE BRACKET END

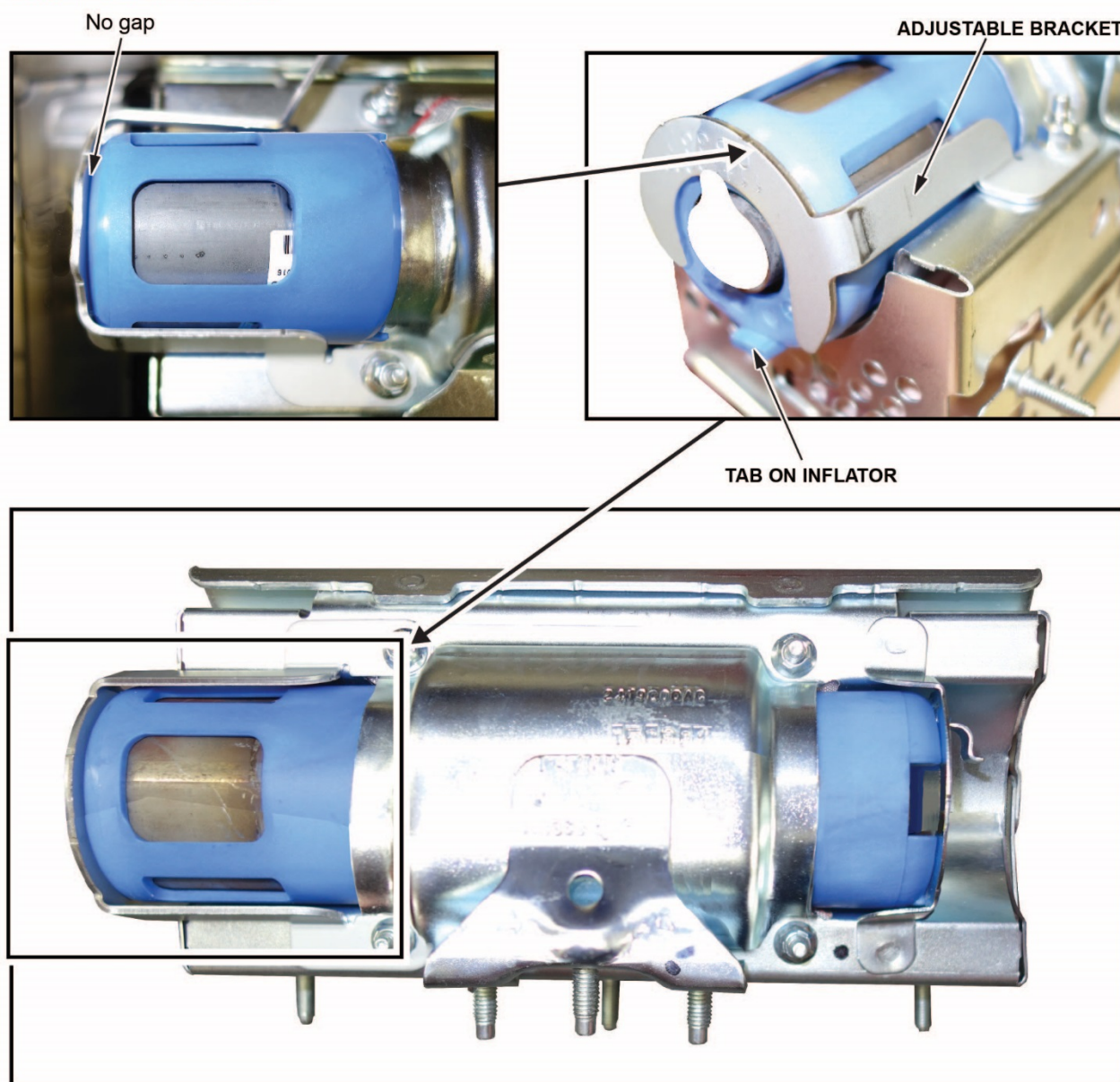

14. Hold the bracket against the inflator, then install the new 5 mm locknuts and torque them in sequence to **4.0 N·m (34 lb-in)**.

NOTE: Make sure you push the bracket against the inflator to ensure there are no gaps between the brackets and inflator when torqueing the nuts.

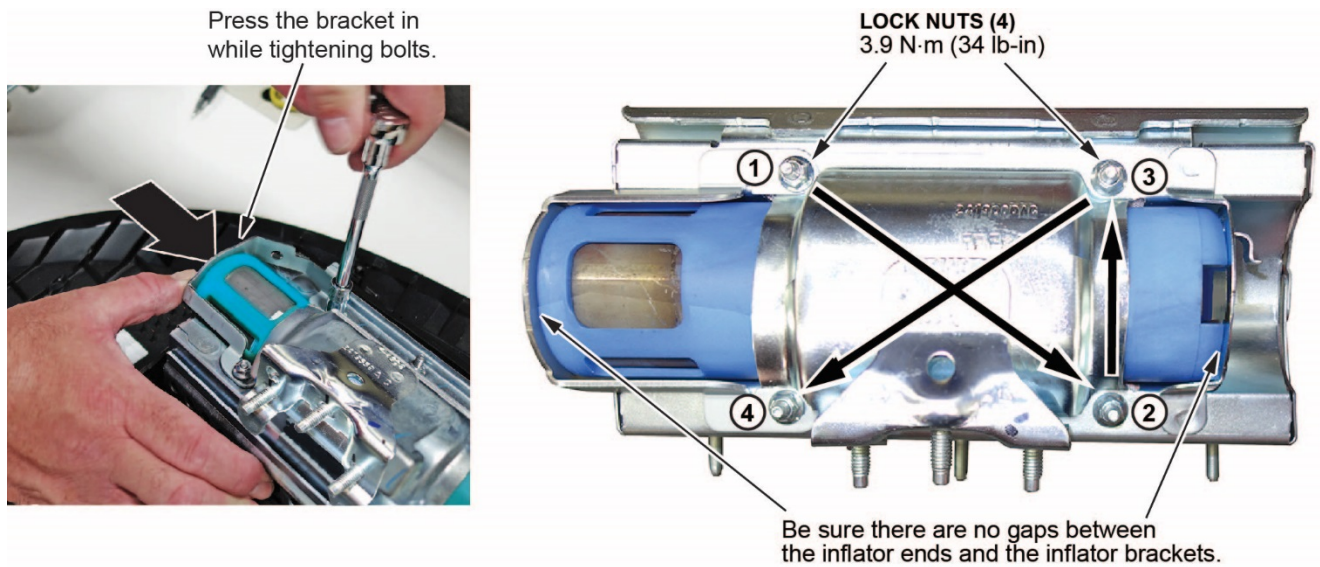

15. Remove the stickers covering the terminals on both sides of the new inflator.



16. Install the new inflator harness.

- Make sure the airbag and harness are aligned as shown.

NOTE:

- **The replacement inflator harnesses have the wire colors in the opposite positions of the original harness.** If you connect the harness incorrectly, the harness cannot be removed and you will not be able to reinstall the airbag because the harness will be too short.
- Connect the red wire connector to the side of the inflator with the red dot.
- On vehicles with the blue inflator, the red dot is not visible because it is covered by the bracket.

ORIGINAL INFLATOR HARNESS ROUTING

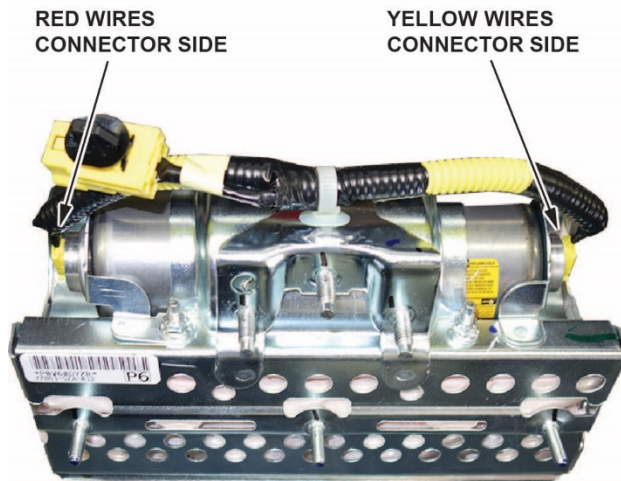

NEW INFLATOR HARNESS ROUTING

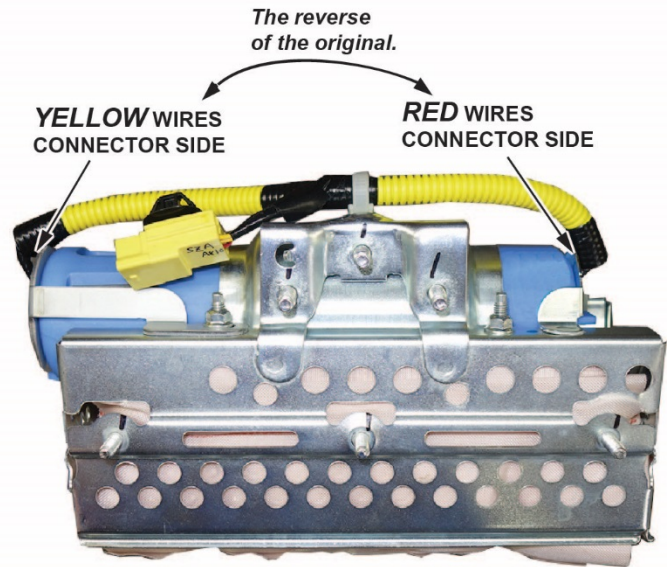

- Connect the red wire connector to the connector on the side with the short plastic cap. Align the "T" shape in the inflator harness connector with the T-shaped inflator connector, then press the connector into place.

- ① Match up the "T" shape as shown. The connectors are directional.

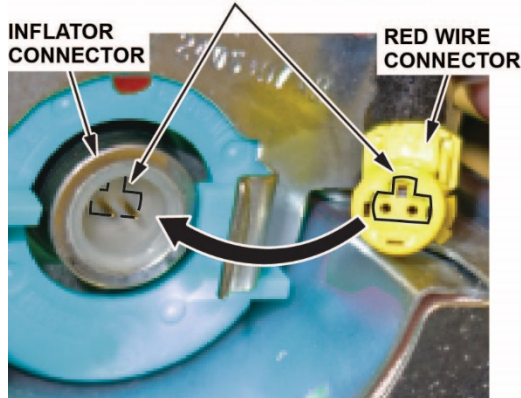

- ② Press the connector into place until it clicks.



- ③ Wiggle the connector to make sure it's secure.



- Connect the yellow wire connector to the connector on the side with the long plastic cap.
- After you hear each connector click, wiggle it to make sure it is secure.

NOTE: If the connector is not properly aligned, it will come out.

17. Make sure the connector is secure and in place by using the gauge tool. (PSPI6 Gauge Tool P/N: 070AJ-TA00A00 or 07AAJ-TA0AA00)

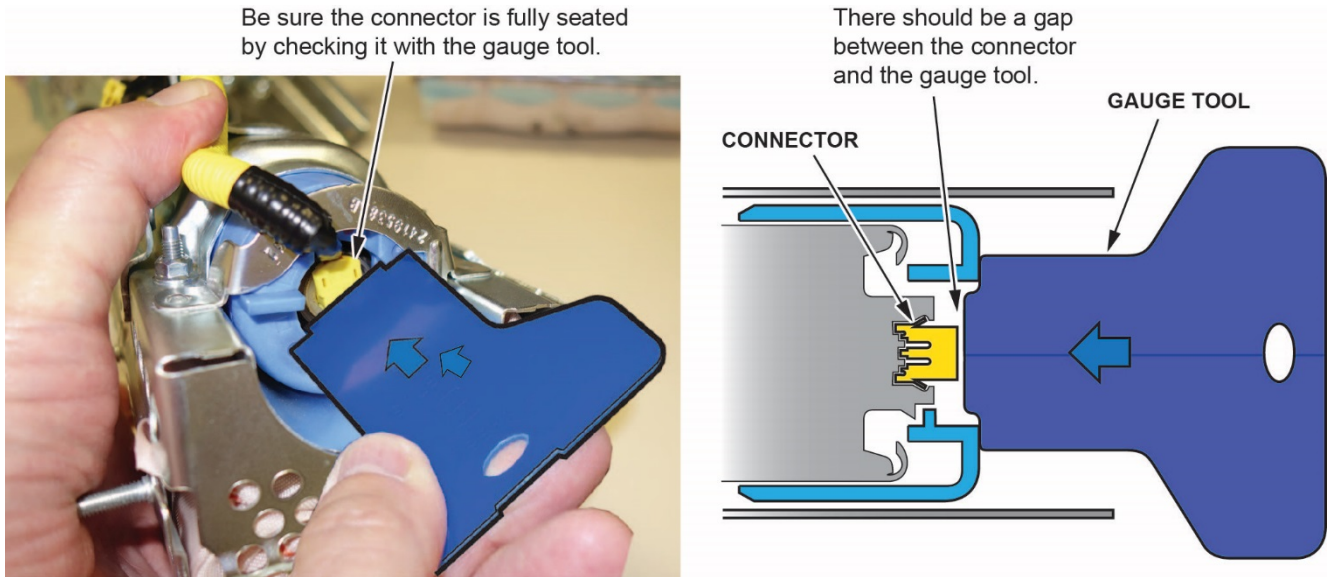

18. Connect the harness to the inflator bracket as shown.

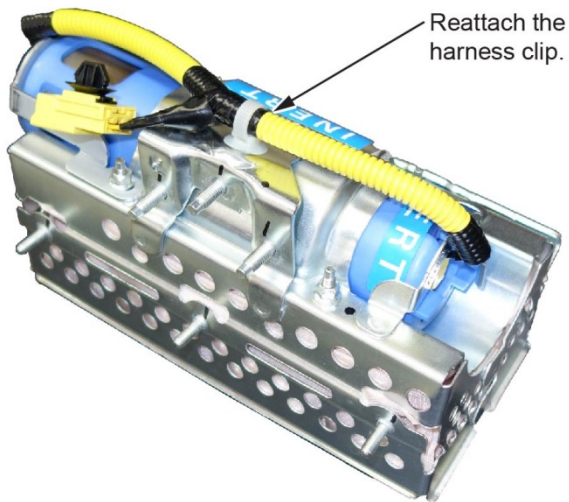

19. Install the front passenger's airbag with the new inflator.

- Install the hooks of the front passenger's airbag into the front passenger's airbag housing.

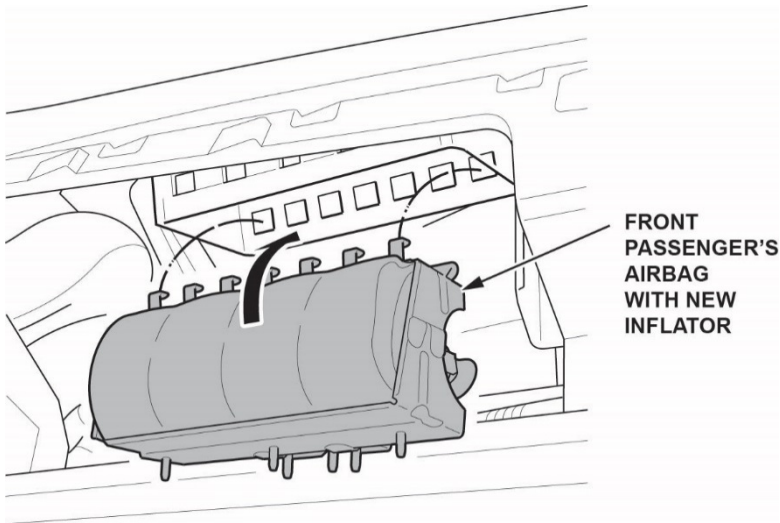

- Insert the hooks of the hook plate into the front passenger's airbag housing.

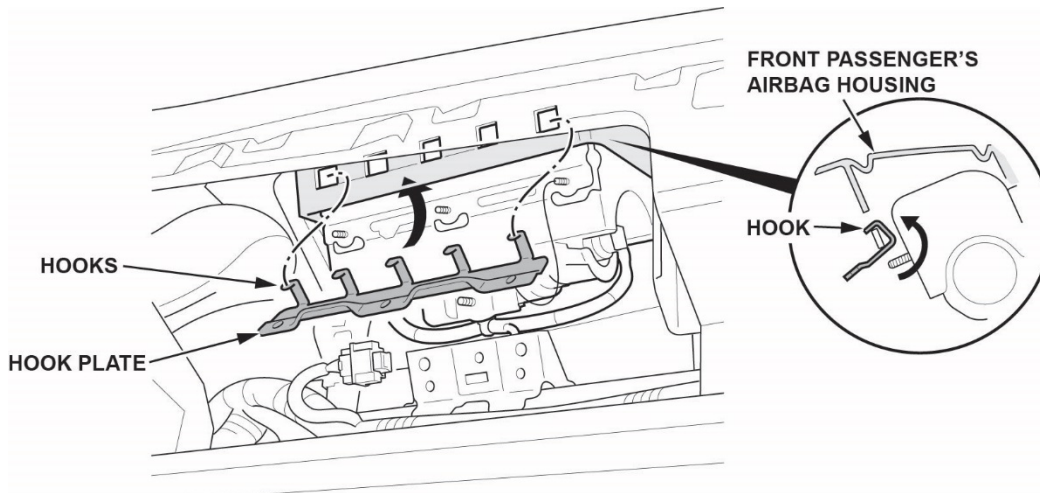

- Install the hook plate with the original mounting nuts.

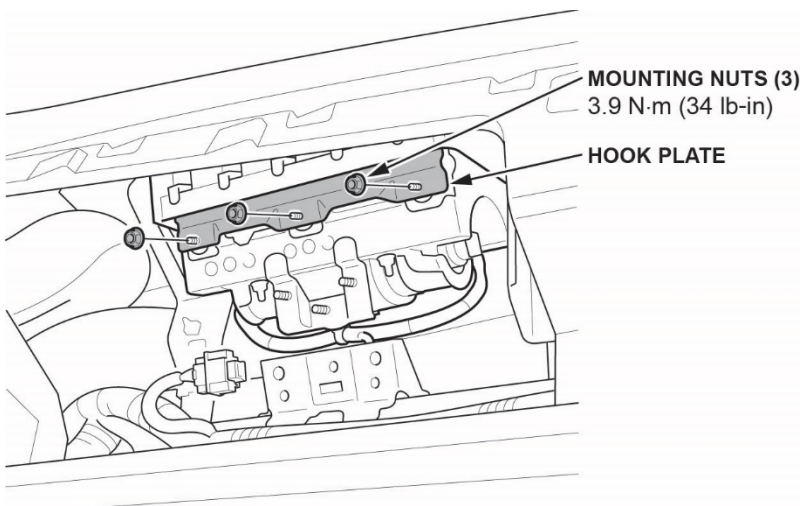

- Install the new support bracket with the new mounting nuts and torque them to **9.4 N·m (6.9 lb-ft)**, then loosely install the new bolts.

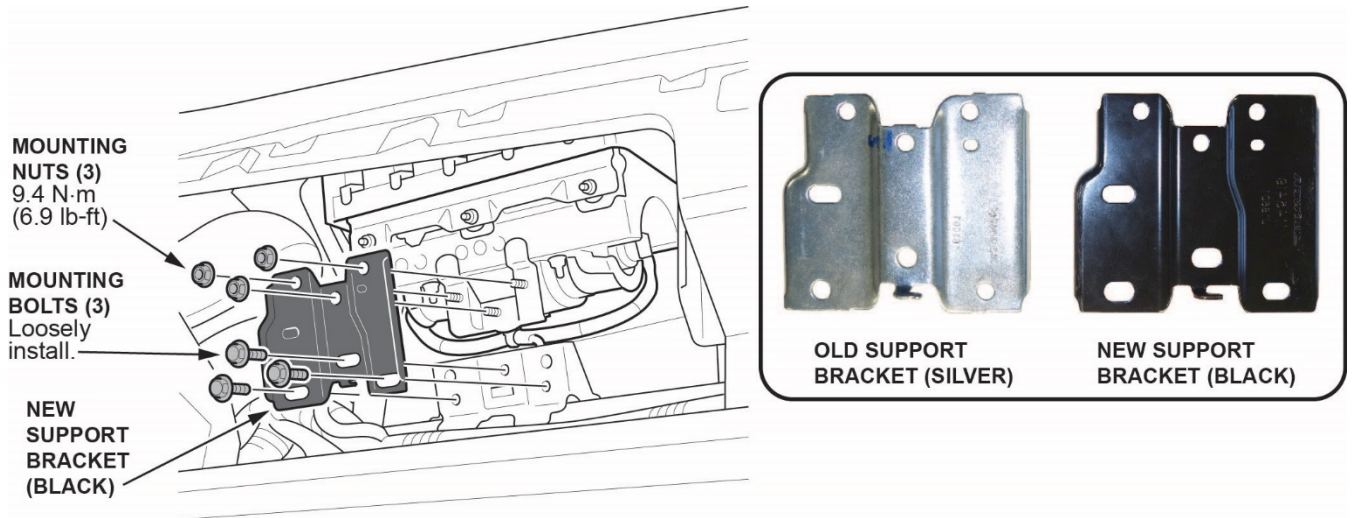

- Push the bracket to the left and hold it while torqueing the mounting bolts to **9.4 N·m (6.9 lb-ft)**.
NOTE: You must keep the bracket pushed to the left to make sure there is more than 5 mm between the inflator connector and the bracket as shown.

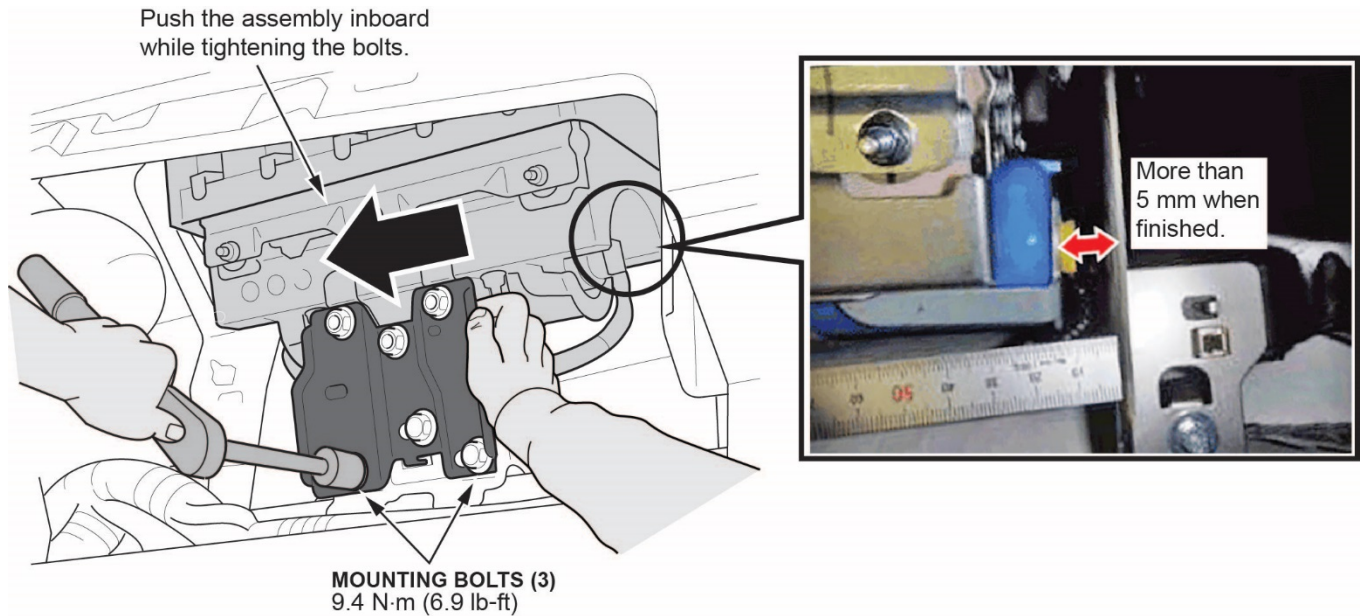

- Connect the dashboard wire harness 4P connector to the front passenger's airbag 4P connector then install the connector clip.

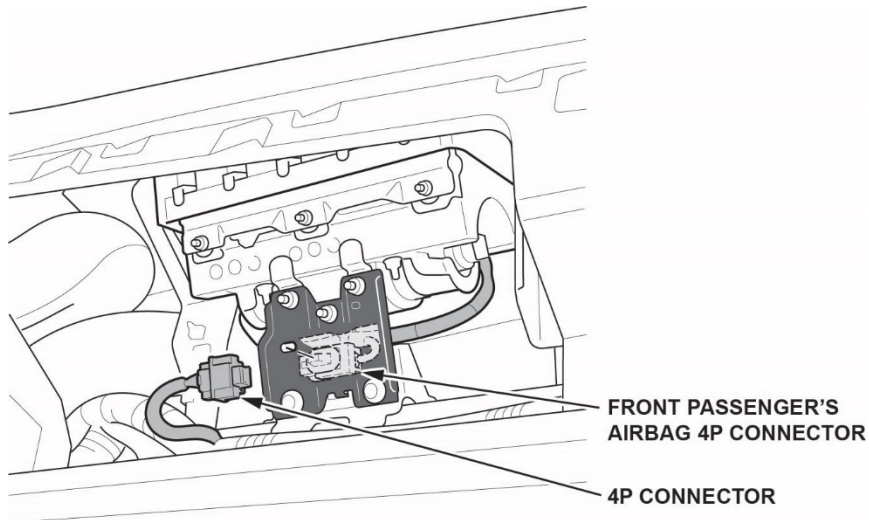

20. Install the passenger's dashboard trim by referring to the service information.
21. Reconnect the battery negative cable.
22. Turn the ignition to ON and make sure the SRS indicator comes on for about 6 seconds, then goes off.
23. Set the clock (for vehicles without navigation) and enter the anti-theft code for the audio and navigation system (if applicable).
24. Put the original inflator into the box the new one came in. Make sure there is no other hardware in the box because if the package rattles, it will not be accepted by the courier.
25. Follow the shipping instructions outlined in PIB A15-0002 to return the undeployed inflator.
26. Give your warranty clerk the RO that includes the replacement inflator serial number and replacement part number. For the warranty claim to be paid, the **replacement inflator part number** must be included in the warranty claim.

END

REPAIR PROCEDURE INSIGHT

NOTE:

- If the VIN status inquiry indicates that the vehicle is subject to any open safety recalls, including a driver's airbag inflator campaign/recall, make sure to also complete those recall repairs before returning the vehicle to the customer. If you are unable to complete any open recall, advise the customer of the recall status and when the recall could be completed.
 - Make sure you have the anti-theft code for the audio and navigation system (if applicable), then write down the frequencies for the audio unit preset buttons.
 - Be careful not to damage any parts when replacing the inflator and **follow the procedure exactly**.
 - If, before removing the airbag, you suspect that it may be the incorrect airbag for the vehicle or a counterfeit, **do not remove the airbag**. Contact your DPSM for assistance.
 - Make sure you have reviewed the SRS Precautions and Procedures in the service information before doing the REPAIR PROCEDURE.
1. Turn the ignition to ON and check if the SRS indicator comes on for about 6 seconds, then goes off.
 - If the indicator comes on, then turns off after about 6 seconds, go to step 2.
 - If the indicator does not come on, or if it stays on, contact your DPSM for assistance.
 2. Disconnect the battery negative cable and wait at least 3 minutes before continuing.
 3. While holding the glove box, release the glove box stops on each side from the dashboard by pushing them in, then lower the glove box.
 4. Disconnect the dashboard wire harness 4P connector from the front passenger's airbag.
 5. Remove the two mounting nuts from the bracket.
 6. Remove the front passenger's airbag assembly from the dashboard.

NOTE:

- The front passenger's lid has pawls on each side that attach it to the dashboard.
 - Take care not to scratch the dashboard or the front passenger's lid.
7. Place the airbag, face-down, on a clean shop towel.

NOTE:

- The orientation of the airbag is critical because if the inflator is installed incorrectly, the harness will be too short when you reinstall the airbag.
- The harness routing for Insight goes under the support bracket.

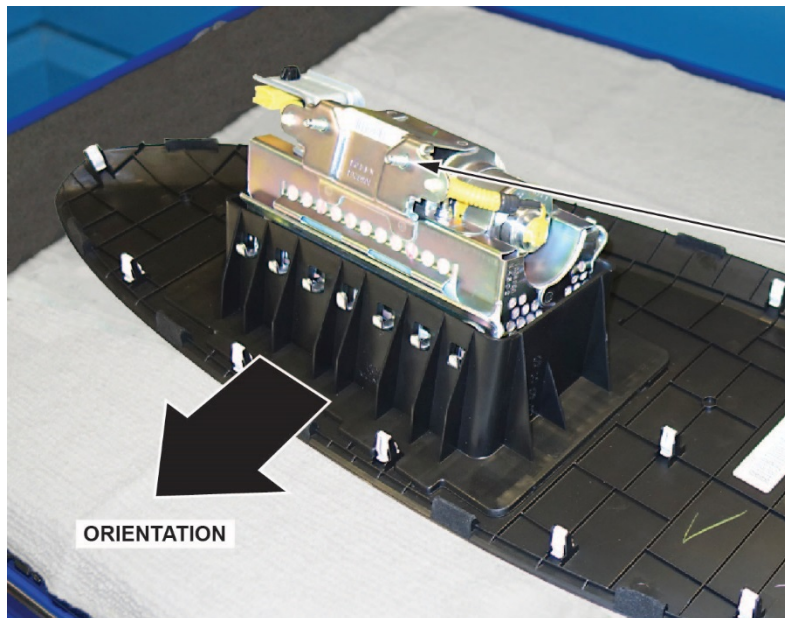

Place the airbag with the mounting studs facing you.

ORIENTATION

8. Visually inspect the airbag and the inflator for any unusual writing or markings. Refer to IDENTIFYING COUNTERFEIT AIRBAGS.
9. Peel the label located inside the inflator box from its backing and attach it to the RO. For the warranty claim to be paid, the **replacement inflator part number that you received** must be included in the warranty claim.

NOTE:

- The replacement part number is printed on the top part of the label and the serial number is printed on the bottom. **Make sure you attach the label to the RO and give it to the warranty clerk.**
- There may also be a colored sticker located in the kit ignore it because it is not used.
- Not all inflator kits have a label included. In those cases, write the serial number and part number from the side of the inflator box on the RO. The part number always starts with 047.

PASSENGER INFLATOR PARTS BOX

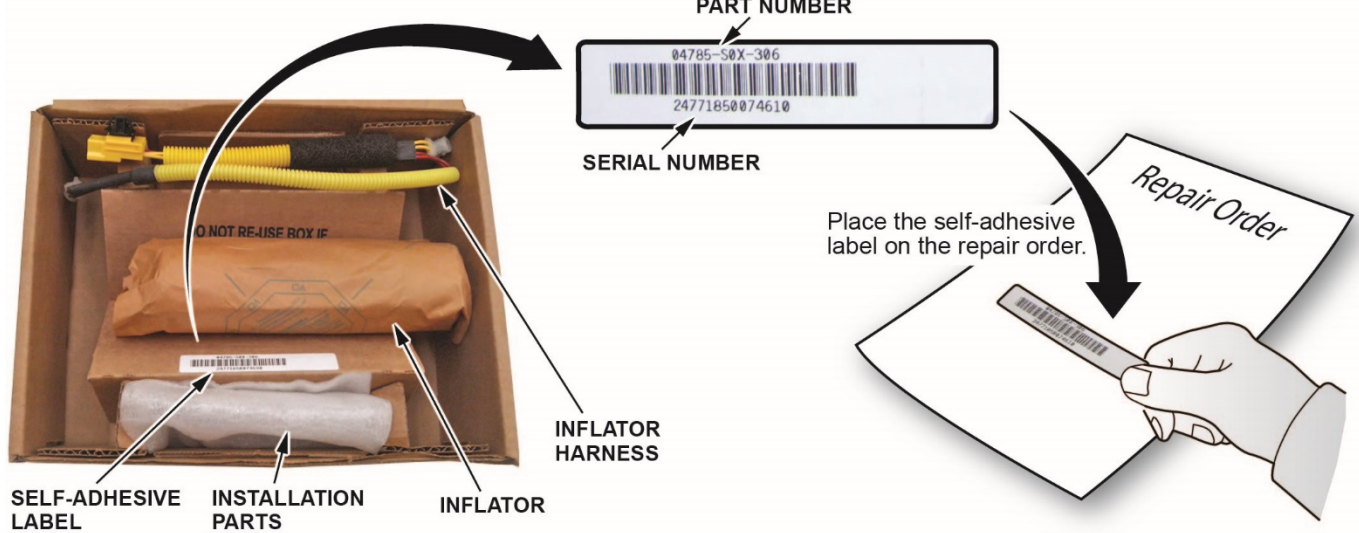

10. Remove the harness from both ends of the inflator bracket.

NOTE: The harness for the Insight goes under the support bracket.

Release connector clip.

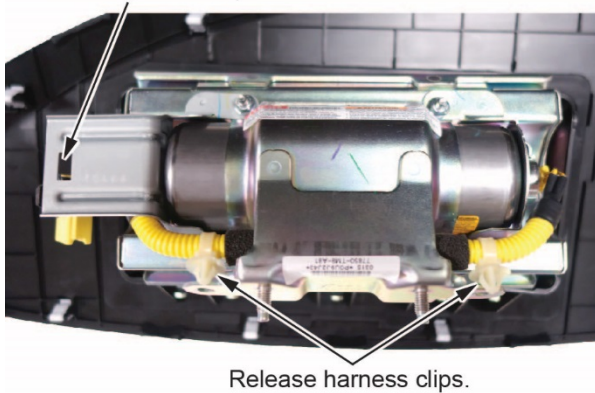

11. Short the yellow wires.

NOTE:

- **You must cut the yellow wires** for inflator removal and short the yellow wires on the inflator side as indicated to prevent accidental deployment.
- **Do not cut the red wires** because the airbag connector shorts these inflator wires.
- Cut the yellow wires next to the white harness clip as shown.

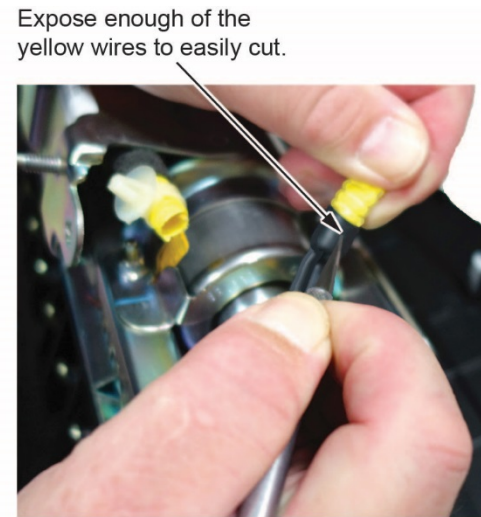

- Strip away about 1 inch of the yellow wire insulation, then twist the wires together.

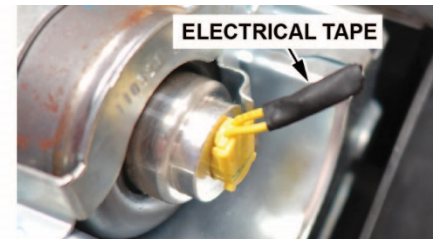
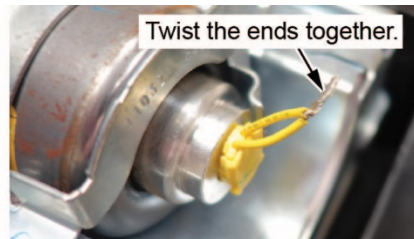

- Tape the twisted ends with electrical tape.

12. Remove the four inflator nuts.

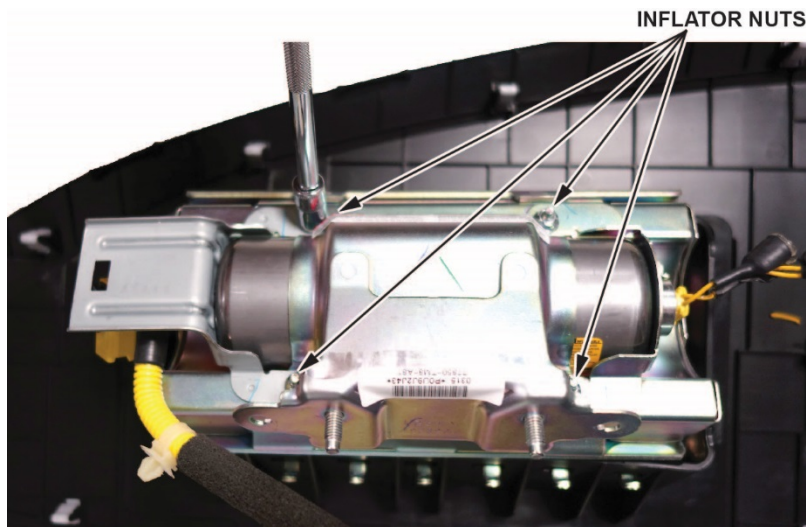

13. Remove the inflator bracket.

NOTE:

- You can only remove one of the brackets, as the other is welded to the airbag housing.
- Do not reuse the bracket; use the new one that came in the inflator kit.

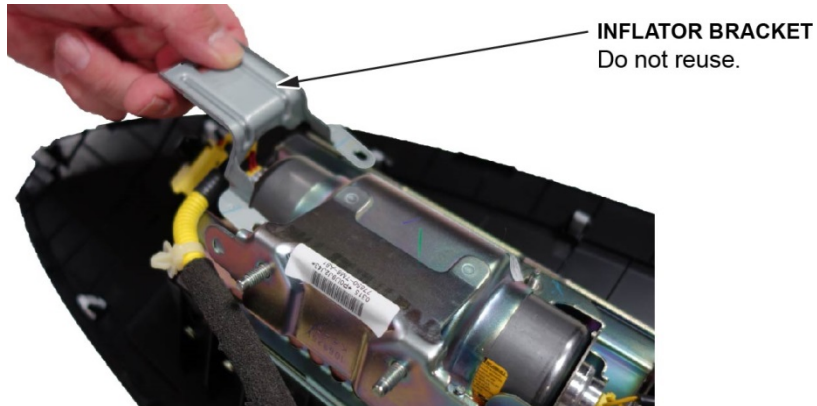

14. Remove the inflator by pulling it out.



15. Install the new inflator.

P/N 04790-TM8-407

- One side of the inflator has a longer collar, a single tab, a plastic cutout, and a small flat spot on the connector. The other side of the inflator has a shorter collar, two tabs, and a red dot. Make sure you insert the end with the shorter collar into the airbag first.

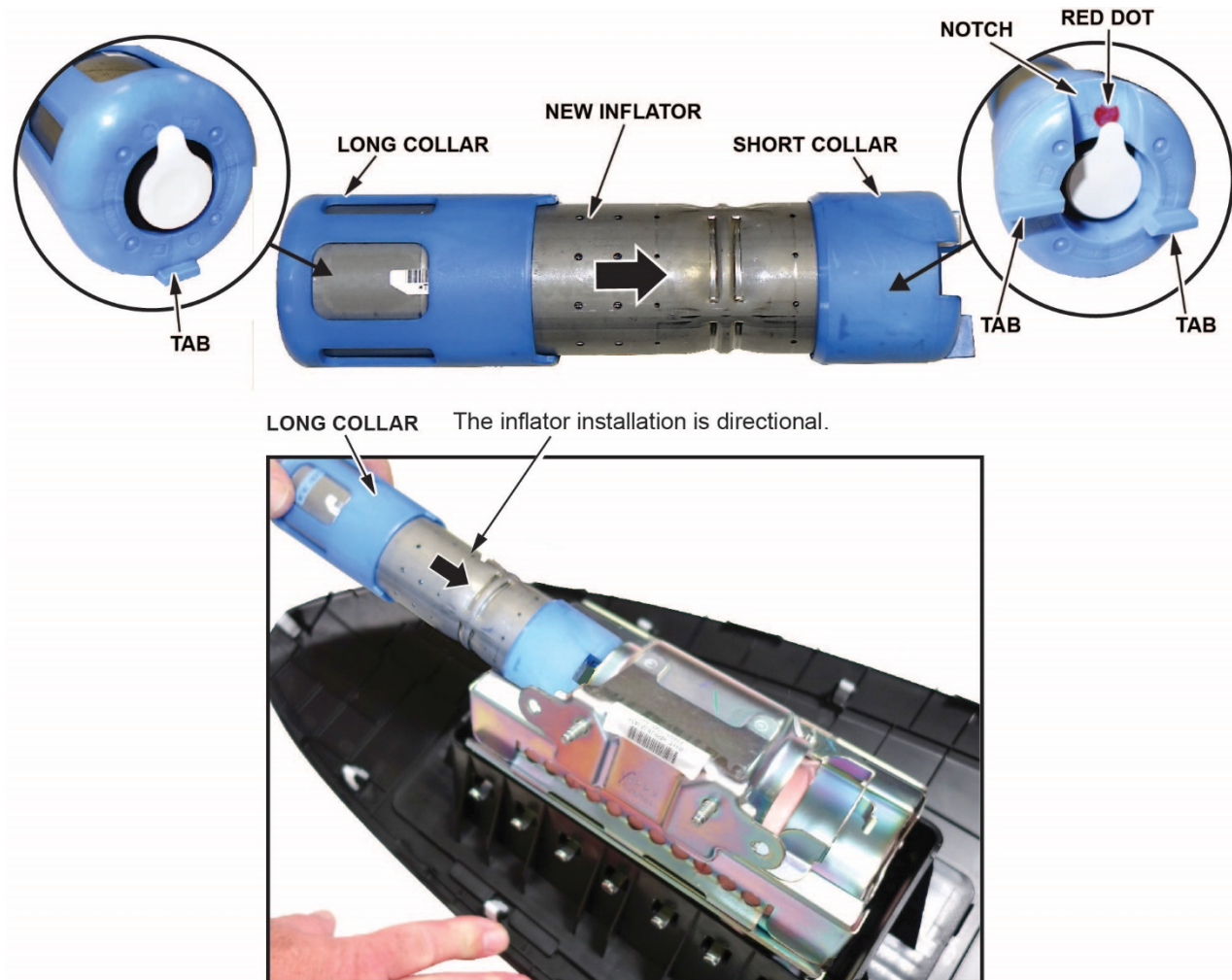

- Slide the inflator in until the plastic collar contacts the bracket. The two tabs should align with the side of the airbag module and the metal tab as shown. There should be no space or gap between the inflator and bracket.

FIXED BRACKET END

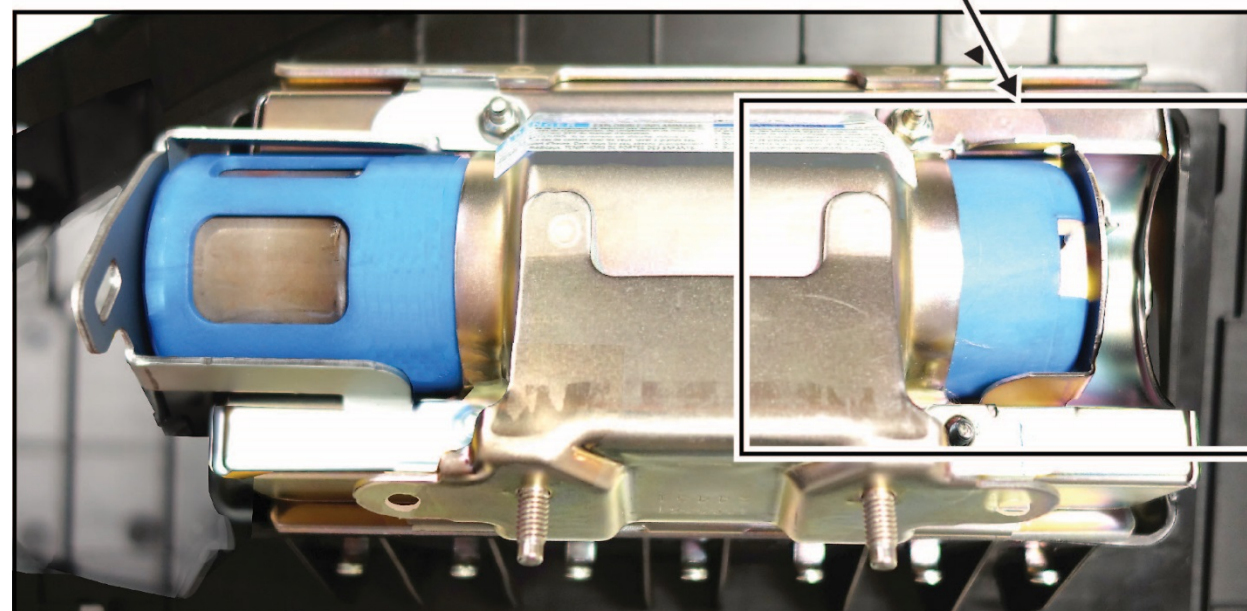
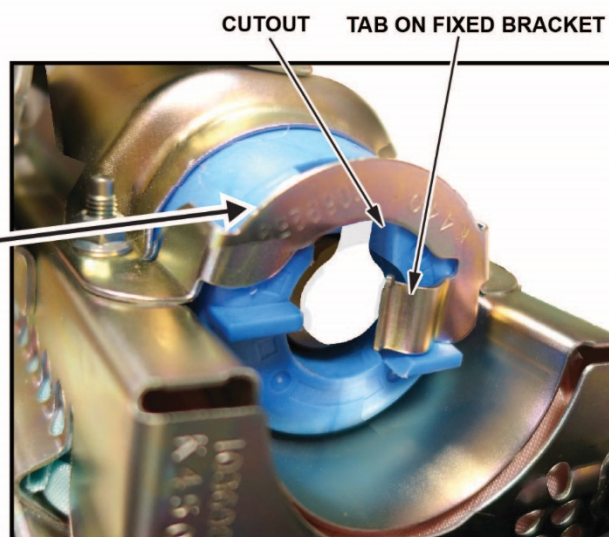
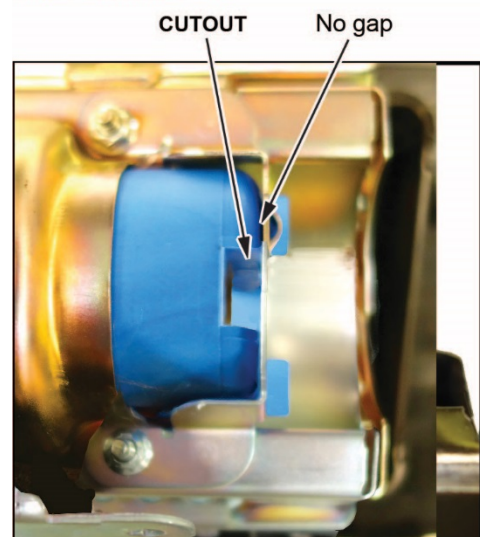

- Install the new bracket included in the kit onto the airbag module. Check there is no space or gap between the inflator and bracket by pushing the bracket against the inflator.

NOTE: The bracket may have a little bit of play before you install the new nuts.

ADJUSTABLE BRACKET END

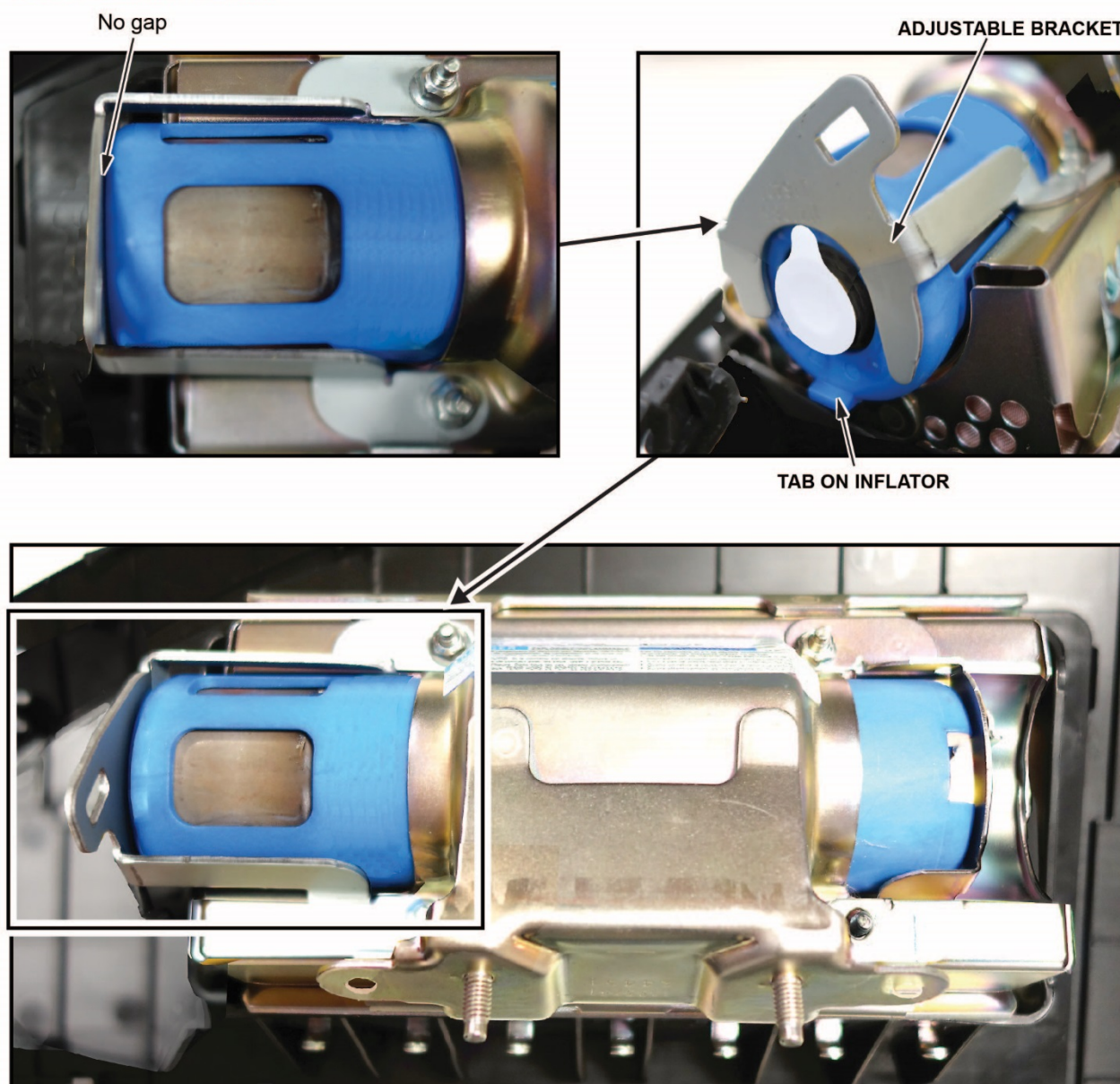

16. Hold the bracket against the inflator, then install the new 5 mm locknuts and torque them in sequence to **4.0 N•m (34 lb-in)**.

NOTE: Make sure you push the bracket against the inflator to ensure there are no gaps between the brackets and inflator when torquing the nuts.

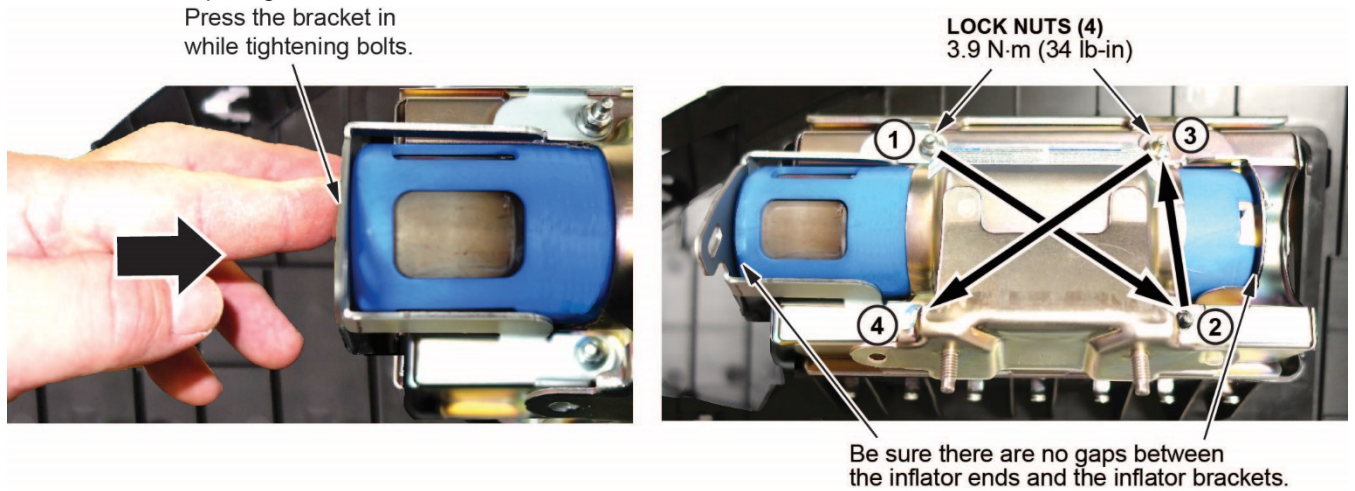

17. Remove the stickers covering the terminals on both sides of the new inflator.

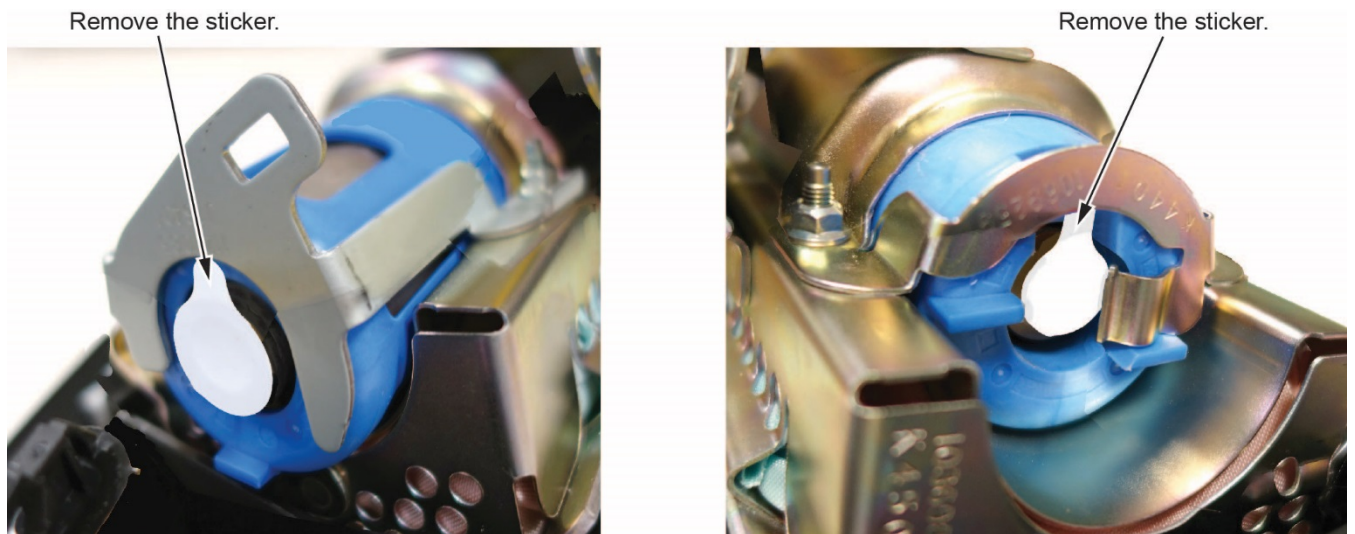

18. Install the new inflator harness.

- Make sure the airbag and harness are aligned as shown.

NOTE:

- **The replacement inflator harnesses have the wire colors in the opposite positions of the original harness.** If you connect the harness incorrectly, the harness cannot be removed, and you will not be able to reinstall the airbag because the harness will be too short.
- **Make sure the harness is routed through the airbag assembly bracket before you connect the harness to the inflator.**
- Connect the red wire connector to the side of the inflator with the red dot.
- On vehicles with the blue inflator, the red dot is not visible because it is covered by the bracket.

ORIGINAL INFLATOR HARNESS ROUTING

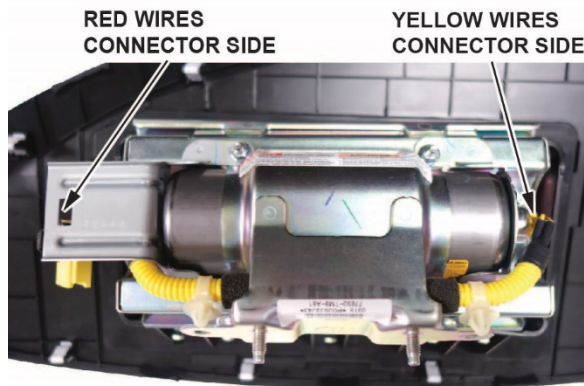

NEW INFLATOR HARNESS ROUTING

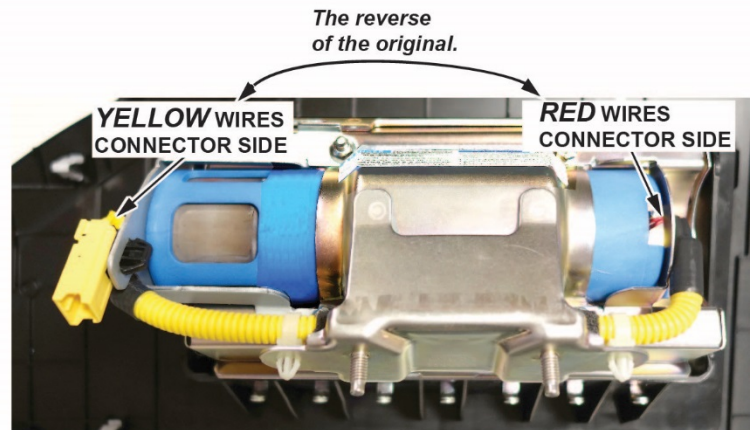

- Connect the red wire connector to the connector on the side with the short plastic cap. Align the “T” shape in the inflator harness connector with the T-shaped inflator connector, then press the connector into place.

- ① Match up the “T” shape as shown. The connectors are directional.

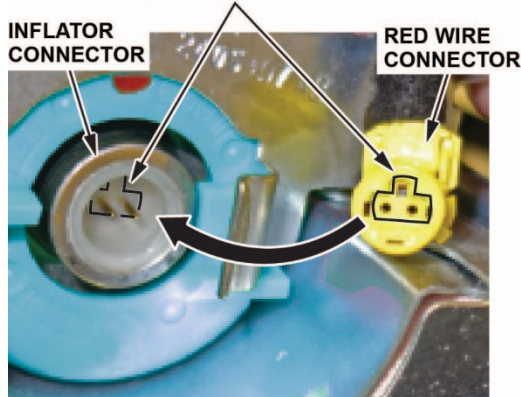

- ② Press the connector into place until it clicks.



- ③ Wiggle the connector to make sure it's secure.



- Connect the yellow wire connector to the connector on the side with the long plastic cap.
- After you hear each connector click, wiggle it to make sure it is secure.

NOTE: If the connector is not properly aligned, it will come out.

19. Make sure the connector is secure and in place by using the gauge tool. (PSPI6 Gauge Tool P/N: 070AJ-TA00A00 or 07AAJ-TA0AA00)

Be sure the connector is fully seated by checking it with the gauge tool.

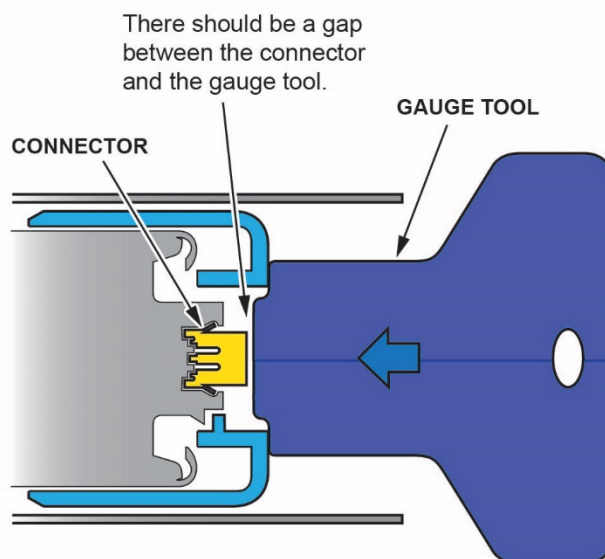
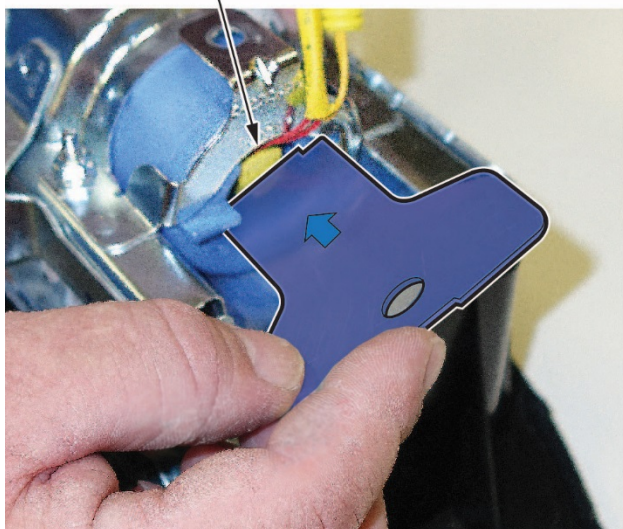

20. Connect the harness to the inflator brackets.

- Connect the harness clips as shown.
- Attach the 4-pin connector to the bracket as shown.

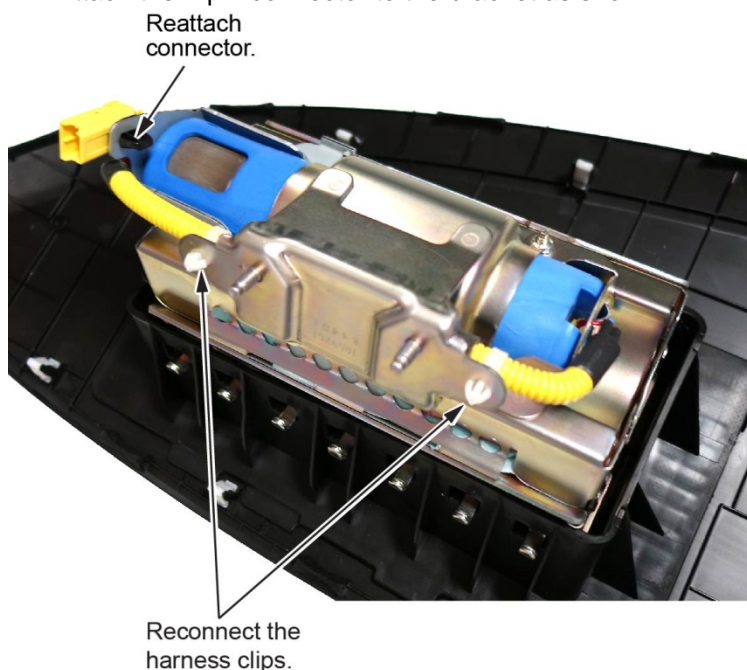

21. Reinstall the passenger's airbag into the vehicle and torque the new locknuts to **9.8 N•m (7.2 lb-ft)**.
22. Connect the dashboard wire harness 4P connector to the front passenger's airbag. Reinstall the glove box.
23. Reconnect the battery negative cable.
24. Turn the ignition to ON and make sure the SRS indicator comes on for about 6 seconds, then goes off.
25. Set the clock (for vehicles without navigation) and enter the anti-theft code for the audio and navigation system (if applicable).
26. Put the original inflator into the box the new one came in. Make sure there is no other hardware in the box because if the package rattles, it will not be accepted by the courier.
27. Follow the shipping instructions outlined in PIB A15-0002 to return the undeployed inflator.

28. Give your warranty clerk the RO that includes the replacement inflator serial number and replacement part number.
For the warranty claim to be paid, the replacement inflator part number must be included in the warranty claim.

END