

Federal Recall Information

817-D

What's New

Safety Recall – The Front Axle Sway Bar Links May Be Assembled Incorrectly

Supplier

KenMex

Description

The Front Axle Sway Bar Links May Be Assembled Incorrectly on Certain Vehicles.

Release Date

10/25/2017

Introduction

Peterbilt Motors Company has decided that a defect which relates to motor vehicle safety exists in certain model year 2009-2010 Models 220 and 210 vehicles manufactured from March 5, 2008 through April 03, 2009 and model year 2012-2018 Models 330, 337, 220, and 210 vehicles manufactured from March 15, 2011 through August 16, 2017. These vehicles may have a front axle sway bar link assembled incorrectly **on each side of the vehicle**. A missing or incorrectly assembled hardened washer used to attach the front axle sway bar link to the frame rail can result in the sway bar link becoming detached from the frame rail.

Resolution

CAMPAIGN

Dealers will inspect the upper sway bar link attachment **on each side of the truck** for the presence of the hardened washer between the bushing and the nut, and install the washer if not present or is in the incorrect location.

Review the attached chassis list for your dealer code and schedule your customer(s) for service as soon as possible. Service all chassis affected that enter your dealership, even if the customer has no issue with the chassis. Review the DWWC or SIR for "Complete" next to the "817-D" campaign code prior to performing this repair.

It is a violation of Federal law for a dealer to sell or lease new vehicles covered by this recall until the defect or noncompliance has been corrected.

Warranty

There is no time or mileage limit for this recall.

The SIR system will indicate chassis involved in this field repair with the designator for "817-D".

- For inspection only **on both sides of the vehicle** please file a quick claim for .3 hours for and reference "817-D".
- If the sway bar link has a hardened flat washer assembled incorrectly, file a quick claim "817-D1" .3 hours labor for inspection and reinstalling the hardened flat washer in the correct location **on both sides of the vehicle.**
- If the sway bar link is missing a hardened flat washer, file quick claim "817-D2" 0.30 hours labor for inspection and installing the hardened flat washer in the correct location **on both sides of the vehicle.**

For Field...	Enter...
Failure Location	016-009-029
Failure Type	705
Claim Type	C
SRT 016-996	0.30 hours labor to inspect for correct assembly and reassemble as required

Parts

Parts are now available through PACCAR Parts

Peterbilt will reimburse the dealer for parts plus applicable markup.

Quantity	Part #	Description
2	1400397PAC	WASHER

Take off parts disposition: There are no take off parts.

Procedure

Procedure for Sway Bar Inspection:

1. Inspect the sway bar link attachment **on each side of the vehicle** for the location of the retention washer as shown in the images below.
2. Reinstall the hardened flat washer in correct location if assembled incorrectly.
3. If the hardened flat washer is missing, install the hardened flat washer in the correct location.



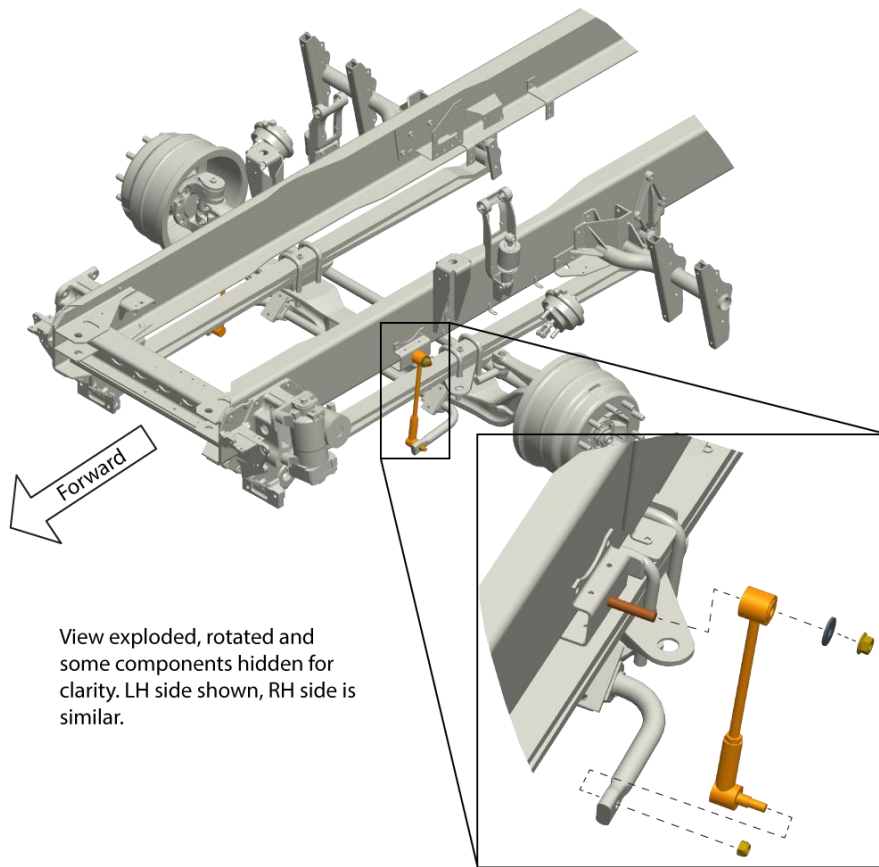

View exploded, rotated and some components hidden for clarity. LH side shown, RH side is similar.

Attachments

[817-D Chassis List](#)

[817-D Sample Customer Letter](#)