

# Federal Recall Information

---

217-A

## What's New

Safety Recall - Fuel Tee Leaking on Models 567 and 579 2017 emissions vehicles

---

## Supplier

VOSS

---

## Description

Fuel Tee Leaking on Model Year 2017 vehicles

---

## Release Date

3/31/2017

---

## Introduction

Peterbilt Motors Company has determined that vehicles built between November 19, 2015 and January 23, 2017 and manufactured with PACCAR MX and Cummins 2017 emissions engines, may have been built with defective Fuel Tees resulting in leaks. Fuel leaking in the presence of an ignition source, could result in a fire.

---

## Resolution

Fuel tees will be replaced on vehicles equipped with suspect fuel tees. Select vehicles will require a new bracket to be installed. See chassis list below for chassis-specific parts required.

---

**It is a violation of Federal law for a dealer to sell or lease new vehicles covered by this recall until the defect or noncompliance has been corrected.**

---

## Warranty

**There is no time or mileage limit for this recall.**

The SIR system will indicate chassis involved in this field repair with the designator for "**217-A**".

- If the vehicle is affected and is shown to have an open campaign, please complete the work and file a long form and reference "**217-A**".
  - 0.7 hours labor to R&R the fuel tee and bracket

For Field...	Enter...
Failure Location	044-001-014
Failure Type	705
Claim Type	C
Responsibility	09
SRT 044-A98	0.7 hours labor to R&R fuel tee and bracket

---

## Parts

Peterbilt will reimburse the dealer for parts plus applicable markup

Quantity	Part #	Description
1	K38-1057	FTG-SPLY FUEL TEE DUAL DR
1	K38-1059	FTG-SPLY FUEL TEE RH DRAW
1	K38-1060	FTG-RTN FUEL TEE DUAL DRAW
1	K38-1062	FTG-RTN FUEL TEE RH DRAW
1	K11-1291	FUEL TEE BRACKET (required on vehicles built before 01/01/2016)
2	0272563	M6 NUTS

Take off parts disposition: Destroy Take off parts.

---

## Procedure

### Tools List:

## Tools

- 10 mm 3/8 in. drive socket
- 10 mm 1/4 in. drive socket
- Battery impact driver
- Torque wrench with 7.9 N\*m (70 lb-in.) capacity
- Air blow gun
- Small flat-tip screwdriver
- Davco or Mity-vac fuel system priming tool



### NOTE

New fuel tees have a paint dot indicator (could be any color)



Use this procedure for trucks built BEFORE 01/01/2016 - [217-A Fuel Tee Procedure before](#)

### Trucks built before 1 January, 2016



### NOTE

Trucks built before 1 January, 2016 require replacement of the mounting bracket, in addition to replacement of the fuel tees. The original bracket does not have holes for the studs on the replacement fuel tees.

The old bracket on the left has no stud holes as shown on the new bracket on the right.

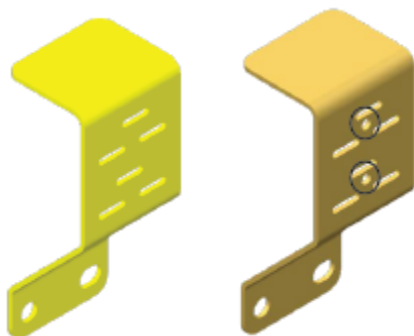

Use this procedure for trucks built AFTER 01/01/2016 - [217-A Fuel Tee Procedure After](#)

---

## **Attachments**

[217-A Chassis List by Parts](#)

[217-A Sample Customer Letter](#)

---