

December 21, 2016

05504 Version 1

## Non-Compliance Recall: Second Row Center Seat

### AFFECTED VEHICLES

Year	Model	Trim	VIN Range
2016	Odyssey	ALL except LX	Check the iN VIN status for eligibility

### BACKGROUND

The second row center seat slide lever may get stuck in the open position after moving the seat. If the seat slide lever does get stuck in the open (up) position, the seat will not properly lock into position, allowing it to slide while the vehicle is in motion. As a result, affected vehicles do not comply with applicable Federal Motor Vehicle Safety Standards 207.

### CUSTOMER NOTIFICATION

Owners of affected vehicles will be sent a notification of this campaign.

Do an iN VIN status inquiry to make sure the vehicle is shown as eligible.

Some vehicles affected by this campaign may be in your new or used vehicle inventory.

Federal law requires that all affected new vehicles be repaired before sale. In addition, failure to repair a vehicle subject to a recall or campaign may subject your dealership to claims or lawsuits from the customer or anyone else harmed as a result of such failure. Furthermore, state law may provide American Honda with the right to seek indemnification in any such claim or lawsuit. To see if a vehicle in inventory is affected by this recall, do a VIN status inquiry before selling it.

### CORRECTIVE ACTION

Inspect the vehicle and, if necessary, adjust the second row center seat slide lever.

NOTE: In rare cases the slide lever cannot be adjusted because it is out of specification and will need to be replaced. Order parts only when you find the slide lever is out of specification.

### TOOL INFORMATION

Part Name	Part Number	Quantity
Seat Slide Lever Adjuster	07AAG-TK8A100	1

### PARTS INFORMATION

Part Name	Part Number	Quantity
Second Row Center Seat Slide Lever	81998-TK8-A21	1
6 mm Push Nuts	82183-TK8-A01	2

NOTE: **Most vehicles do not need** a slide lever and push nuts – replace the lever only if after adjusting the clearance, the lever does not overlap the locking tabs properly. See REPAIR PROCEDURE A.

**CUSTOMER INFORMATION:** The information in this bulletin is intended for use only by skilled technicians who have the proper tools, equipment, and training to correctly and safely maintain your vehicle. These procedures should not be attempted by “do-it-yourselfers,” and you should not assume this bulletin applies to your vehicle, or that your vehicle has the condition described. To determine whether this information applies, contact an authorized Honda automobile dealer.

## REQUIRED MATERIAL

Part Name	Part Number	Quantity
Hondalock 2 Threadlock	08713-0002	1 bottle repairs 100 vehicles

## WARRANTY CLAIM INFORMATION

Operation Number	Description	Flat Rate Time	Defect Code	Symptom Code	Template ID	Failed Part Number
8515A0	Inspect the second row center seat and, if needed, do REPAIR PROCEDURE A to adjust the seat.	0.3 hr	6SC00	KD400	16-107A	81998-TK8-A21
8515A0	Inspect the second row center seat and, if necessary, do REPAIR PROCEDURE A.	0.3 hr	6SC00	KD400	16-107B	81998-TK8-A21
A	Do REPAIR PROCEDURE B to replace the slide lever.	0.3 hr				

Skill Level: Repair Technician

## INSPECTION PROCEDURE

1. Sit in the second row center seat, lift the slide lever and slide the seat all the way back toward the rear of the vehicle.



2. Slowly lower your hand to release the slide lever, then slide the seat forward to the first latching point.
  - If the slide lever returns to the original (lowest) position under its own force and the seat locks into place, the vehicle is OK.
  - If the slide lever is stuck in the up position, does not return to its original position under its own force, or doesn't lock, go to REPAIR PROCEDURE A.

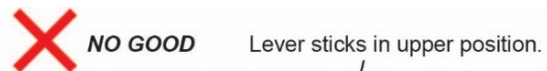

## REPAIR PROCEDURE A

1. Fold the second row center seat and unlatch it from the floor.
2. Place the center seat upside down on a clean surface.

NOTE: You can either work on the bench or in the vehicle. Make sure you protect the seat from getting dirty by using clean shop towels, plastic sheet, etc.



3. Using the seat slide lever adjuster and a feeler gauge, bend the slide lever to create 0.5 mm of space between the lever and the bracket as shown.

NOTE: Do not use too much force and do not bend the slide lever to more than 0.5 mm of clearance.

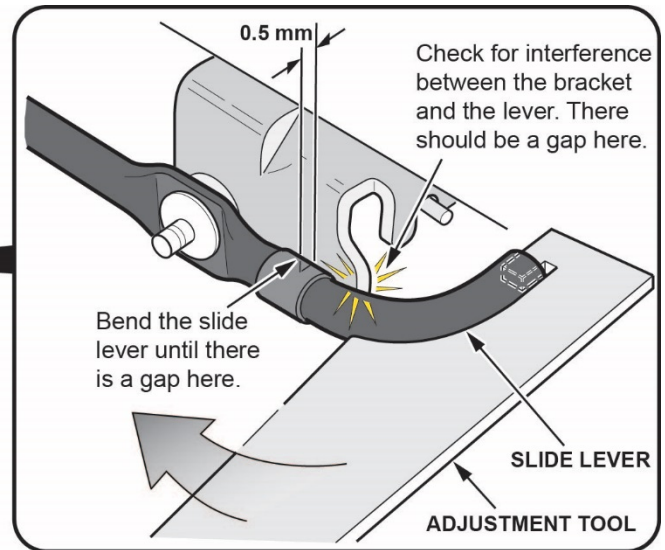
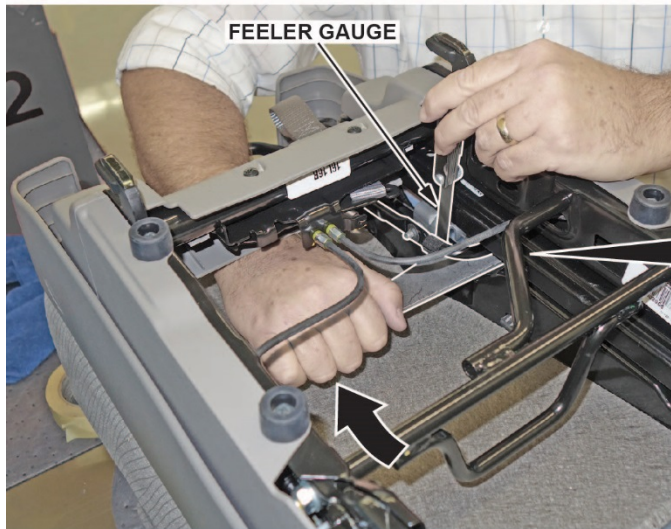

- Once there is 0.5 mm of clearance, check that the 6 mm push nuts are secure and they are pushed past the groove on the stud as shown.

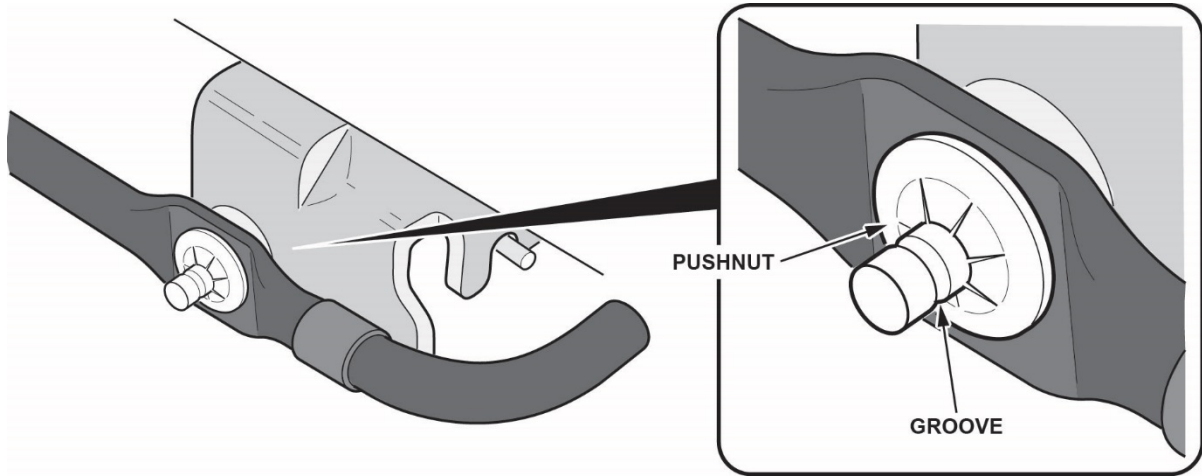

- If the push nuts are secure and pushed past the groove, go to step 5.
- If the push nuts are not secure or not pushed past the groove, use a 10 mm socket and small hammer to gently tap the push nut past the groove.

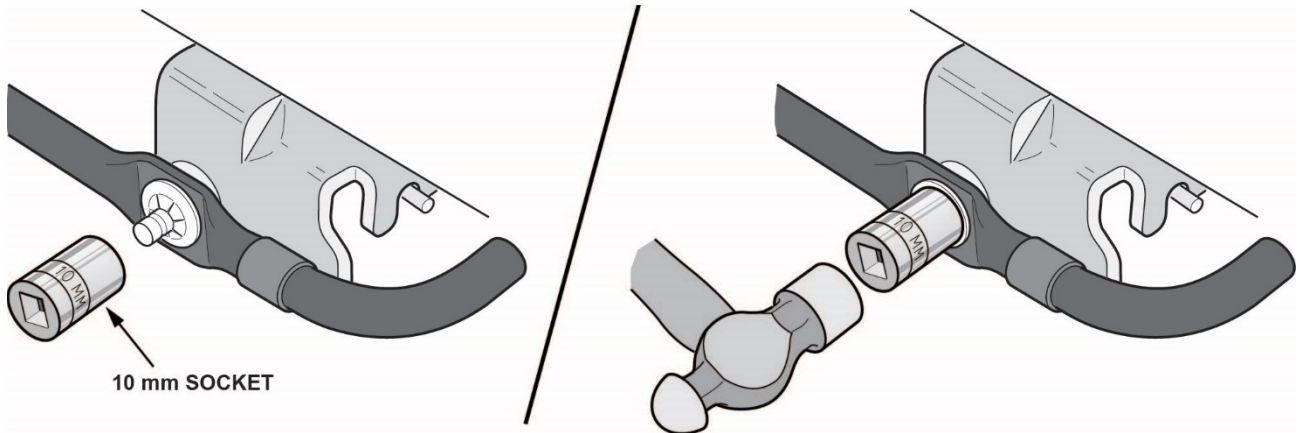

- Check that the ends of the slide lever properly overlap the lock tabs as shown.

- If the slide lever position is OK, go to step 6.
- If the slide lever position is no good, replace the slide lever. Go to REPAIR PROCEDURE B - SLIDE LEVER REPLACEMENT.

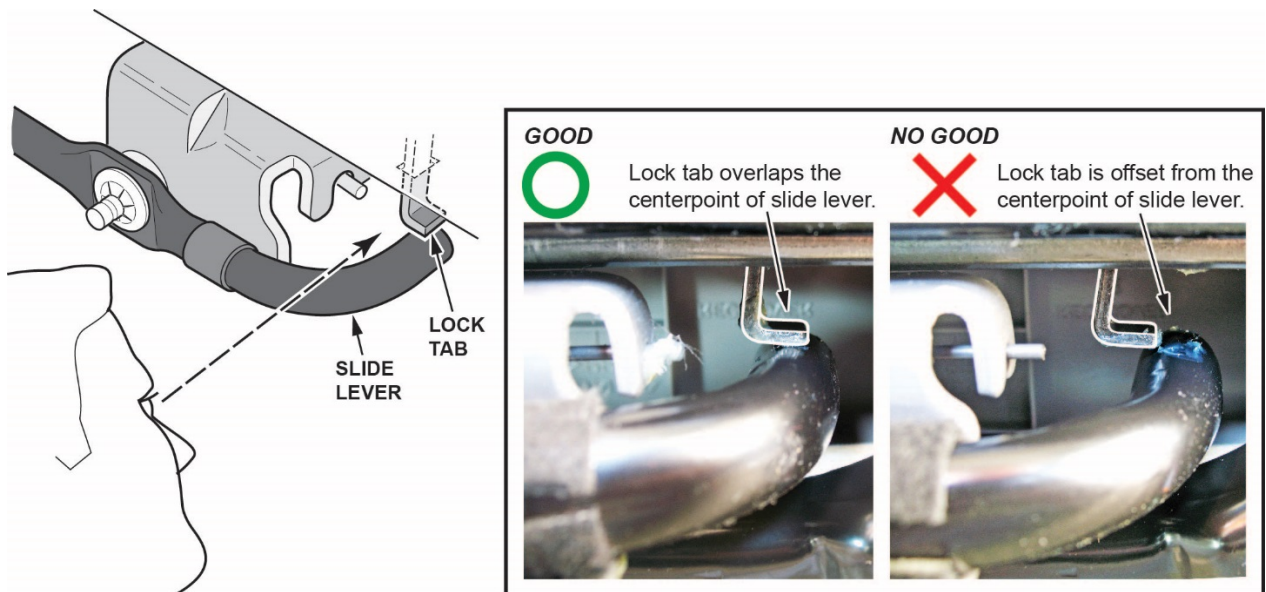

6. Install the center seat in the vehicle.
7. Sit in the second row center seat, lift the slide lever and slide the seat all the way back toward the rear of the vehicle.
8. Confirm the slide lever works properly by slowly lowering your hand to release the slide lever, then slide the seat forward to the first latching point. Verify that the seat locks into place and the slide lever returns to the original down position under its own force.



### REPAIR PROCEDURE B - SLIDE LEVER REPLACEMENT

NOTE: Use this procedure only if you found the slide lever and lock tab overlap no good in REPAIR PROCEDURE A.

1. Remove the seatbelt detachable anchor.

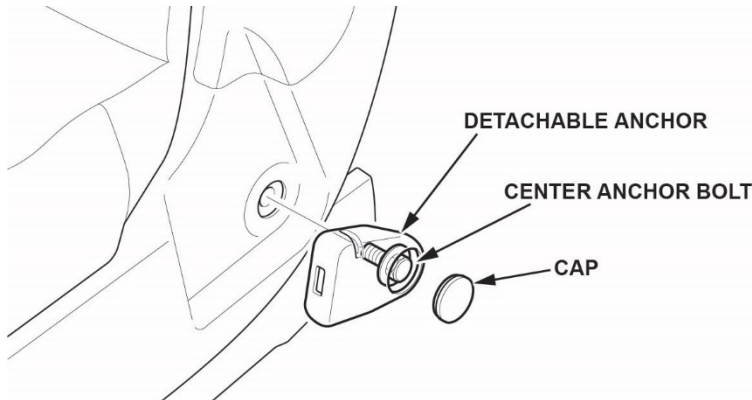

2. Remove the recliner cover.

- Remove the cap, then remove the screw.
- Pull up on the cover, then detach the clips and release the tabs.

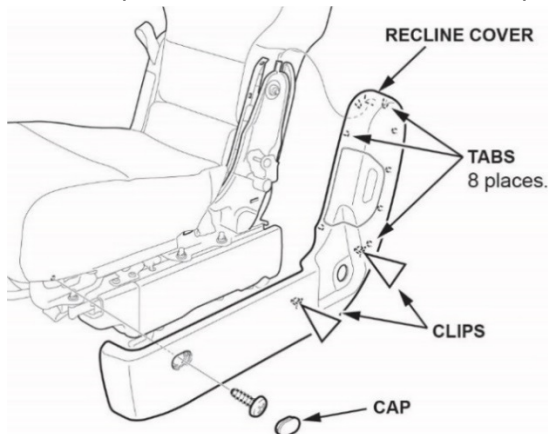

3. Remove the center cover.
- Remove the cap, then remove the screw.
  - Pull up the cover, then detach the clips and release the tabs.
  - If necessary, remove the upper recline inner cover.

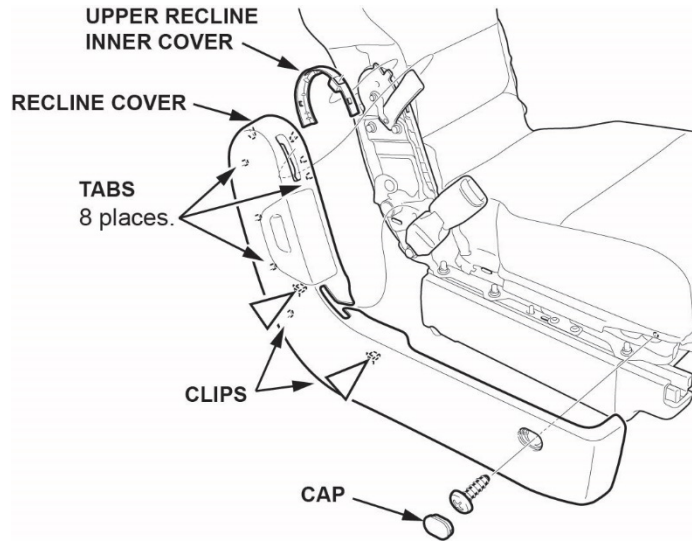

4. Remove the seat slide adjuster assembly by removing the 6 nuts.

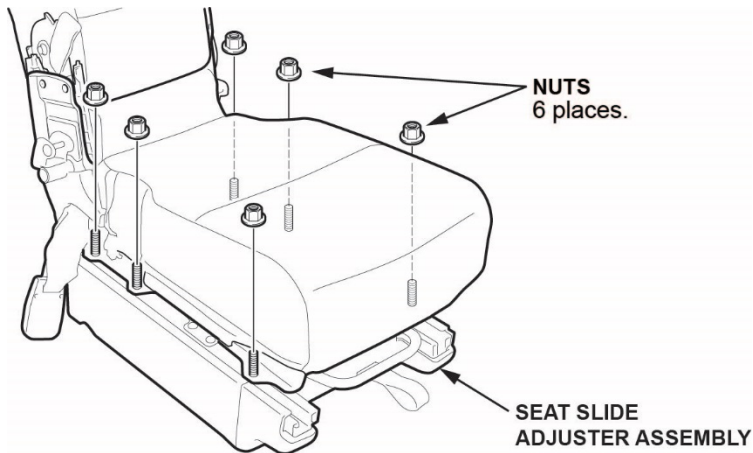

5. Remove the 6 mm push nuts using a grommet puller or a small screwdriver.

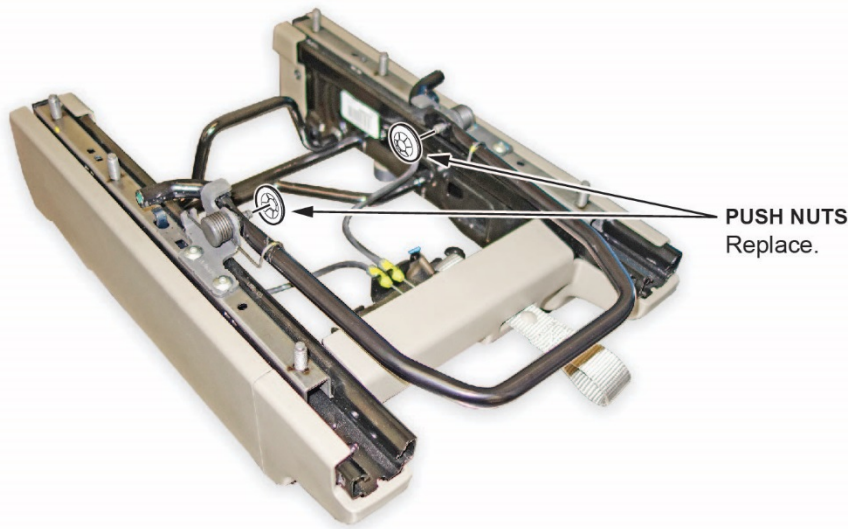

6. Release the springs from the slide lever.

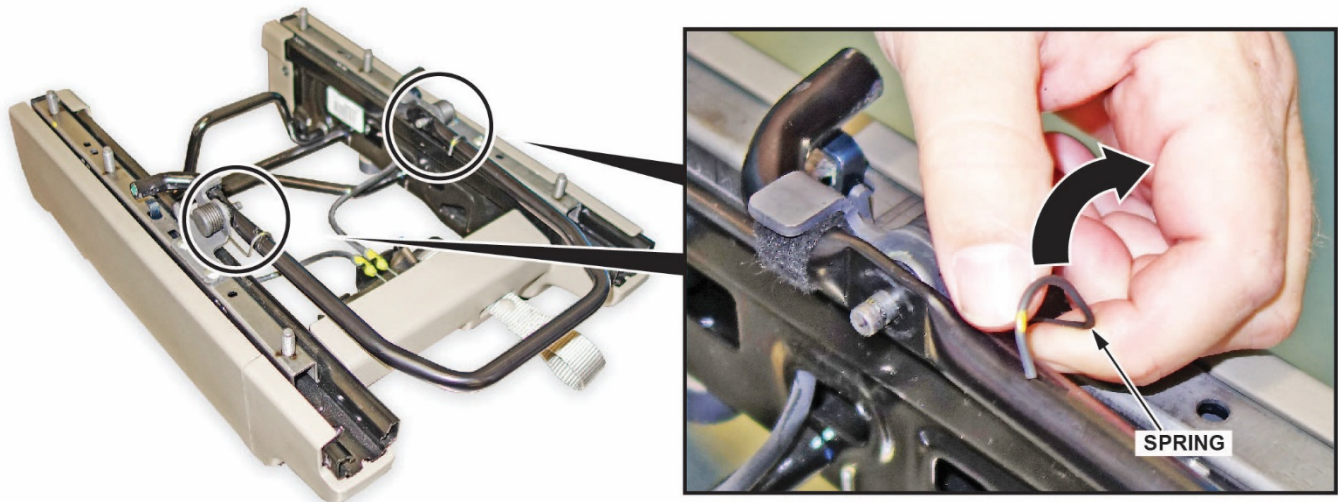

7. Pull or flex the slide bar to remove it.

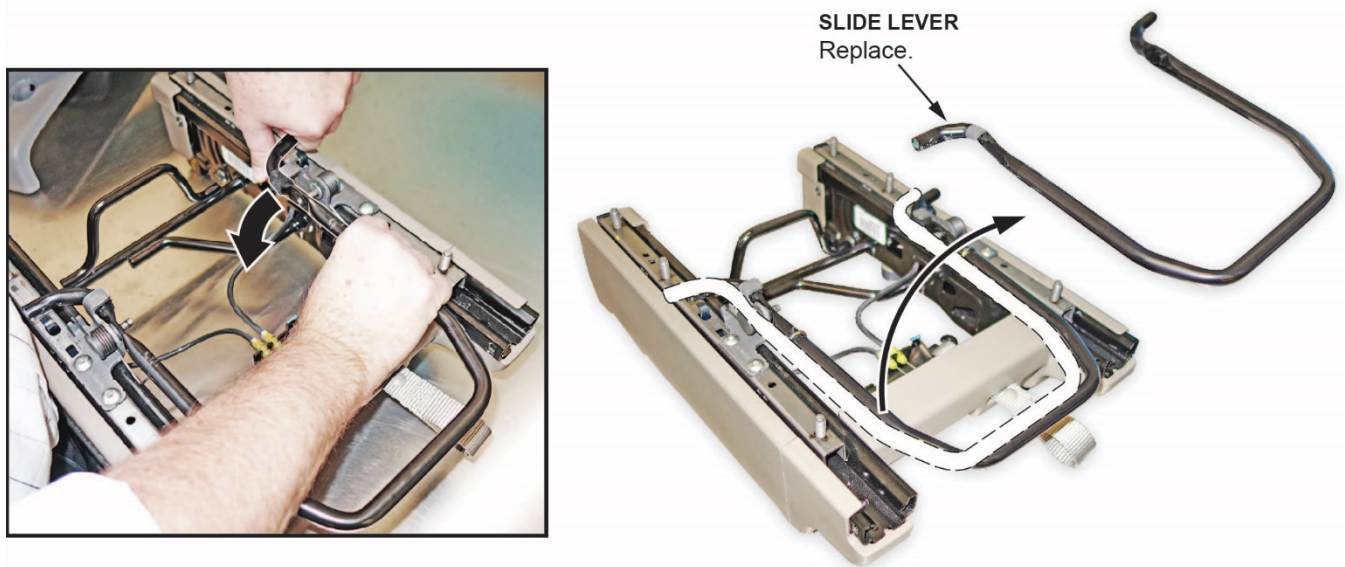

8. Install the new slide lever using new 6 mm push nuts and re-engage both springs.

NOTE: Make sure you install the push nuts past the groove.

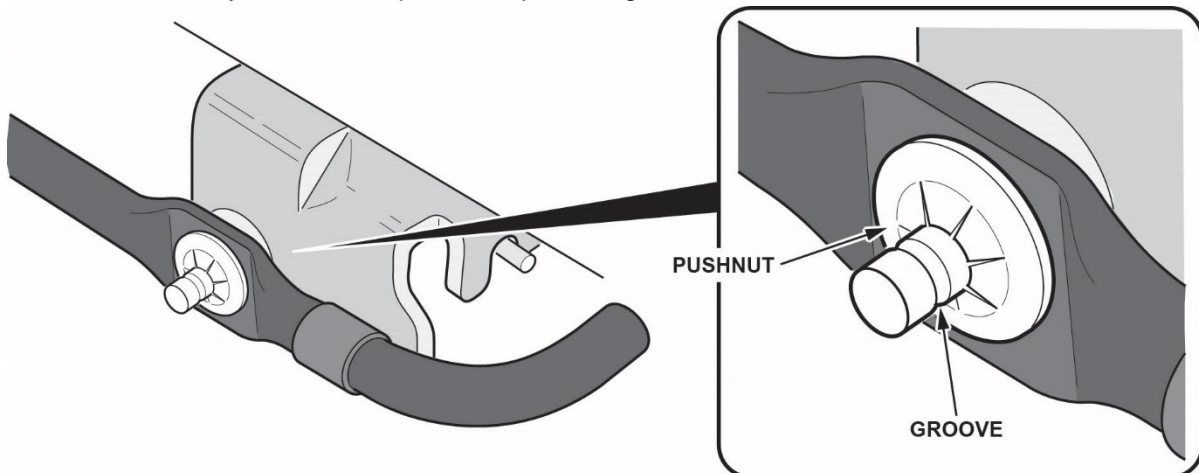

9. Reassemble the seat in the reverse order of removal and note the following.

- Install the slide adjuster assembly using the 6 nuts and torque them to **21 N·m (15 lb-ft)**.

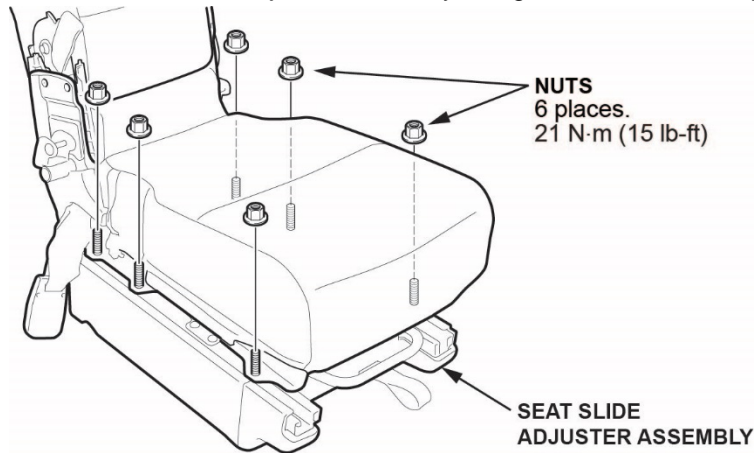

- Apply thread-lock to the seat belt anchor bolt and torque it to **32 N·m (24 lb-ft)**.

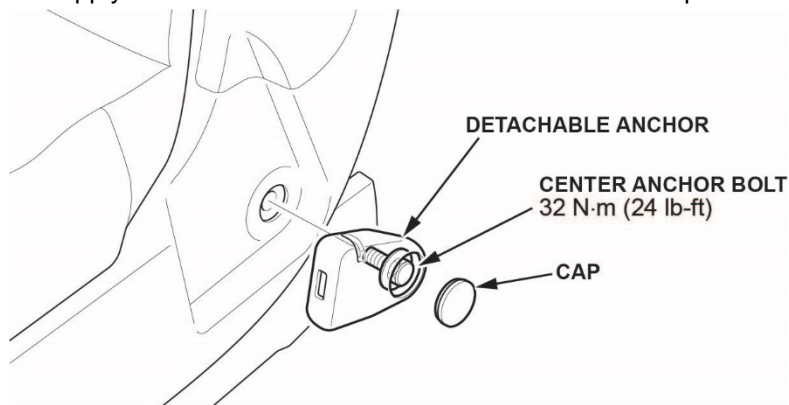

10. Install the center seat in the vehicle.

11. Sit in the second row center seat, lift the slide lever and slide the seat all the way back toward the rear of the vehicle.

12. Confirm the slide lever works properly by slowly lowering your hand to release the slide lever, then slide the seat forward to the first latching point. Verify that the seat locks into place and the slide lever returns to the original down position under its own force.

**GOOD** Lever returns to lower position.



**NO GOOD** Lever sticks in upper position.



END