

# Product Support Bulletin



## Service

Issue Date:

December 16, 2016

Global Lit Num:

CPGF - S - 00000403 - 0

Revision: 0

**Title:** Safety Campaign #2954 - Rental Hinge Replacement

**Model(s)** C60 D6R, C100 D6R, C200 D6R, C300 D6R, C150 D2RE, C200 D2RE, C275 D2RE

### Background/Description:

Some Rental Generators that were built in 2016 were equipped with composite hinges. If the composite hinges crack, they may fail to maintain attachment of the door.

If the door becomes detached during transport, it may fall into the roadway, increasing the risk of a motor vehicle accident. If detachment occurs while stationary, it may result in personal injury. This Safety Campaign addresses these conditions by replacing all door hinges and associated mounting hardware on the generator set with door hinges of a different design.

### Corrective Actions:

#### Take Care When Opening Doors

If a hinge has failed, the door is at risk of falling off. Use caution when opening the generator set doors to avoid a detached door causing personal injury.

#### Transporting the Generator Set

Before transporting the generator set, the doors should be secured externally. We recommend one of the following:

1. Wrap the entire circumference of the enclosure with pallet wrap material, covering 70% of the door surface with at least 5 layers.
2. Using ratchet strap (or similar) wrapping the entire circumference of the enclosure ensuring to support each door at a minimum of two separate heights. Ensure the paint has adequate protection.

#### Tools Required

13mm Socket and Ratchet  
13mm Wrench  
10mm Socket and Ratchet

10mm Wrench  
 9/16in Socket and Ratchet  
 9/16in Wrench  
 4mm hex key  
 Various Socket Extensions 2-4in  
 Universal socket joint or Wobble Extension  
 Adjustable Torque Wrench  
 Needle nose pliers

**Parts Required**

<b>Hinge Kit: A056P370</b>		
<b>Part Number</b>	<b>Description</b>	<b>Qty.</b>
A056H470	Hinge	12
A056M306	Carriage Bolt	50
A007L130	Washer Flange Lock	50
A004W640	Nut	50
A056S663	Strike Latch	3
A055G556	Screw Socket Head	6
A004W511	Flange Nut	6

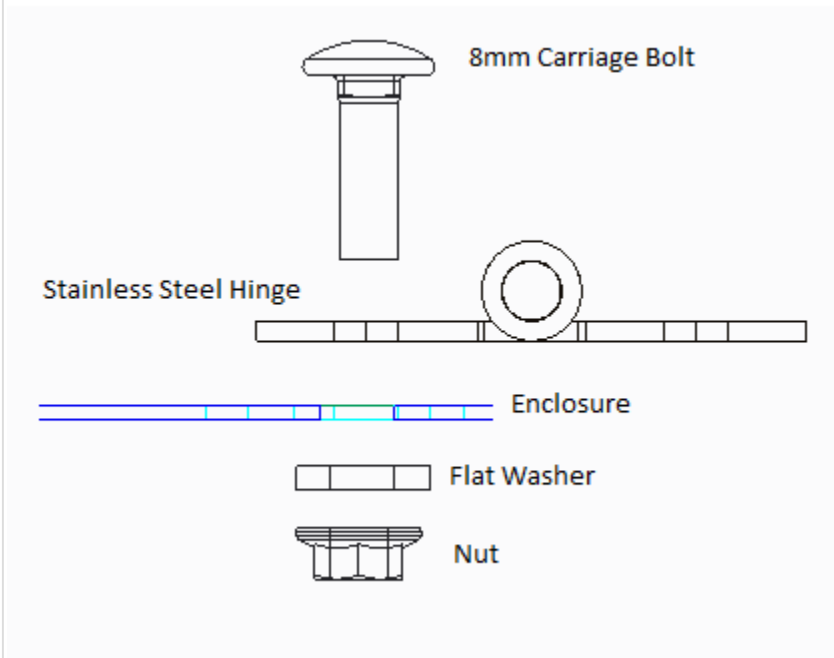

**Replacing Hinges**

While removing hinges, the door should be supported as to not fall. We recommend utilizing a crane or hoist to hold the door while performing the work. If a crane/hoist is not available, another technician is authorized to support the door while hinges are replaced.

1. While the end of the door is supported, remove the top hinge from the door
2. Next, remove the top hinge from the enclosure

3. Install the new door hinge on the enclosure using new hardware.
4. Next, install the new door hinge on to the door.
5. Once the first hinge is installed, repeat the same steps on the bottom hinge
6. If the door has three hinges, repeat the same steps on the middle hinge
7. Once all hinges are installed, adjust panel gap as needed ensuring that the door does not rub on the enclosure
8. Torque the hinge hardware to **26 Nm**

### **C275 D2RE**

The C275 D2RE generator set has a potential interference on the exhaust blanket on the right side of the engine. Remove blanket if necessary to access the top hinge on the right side engine door. The blanket is held on by springs which can be removed with pliers.

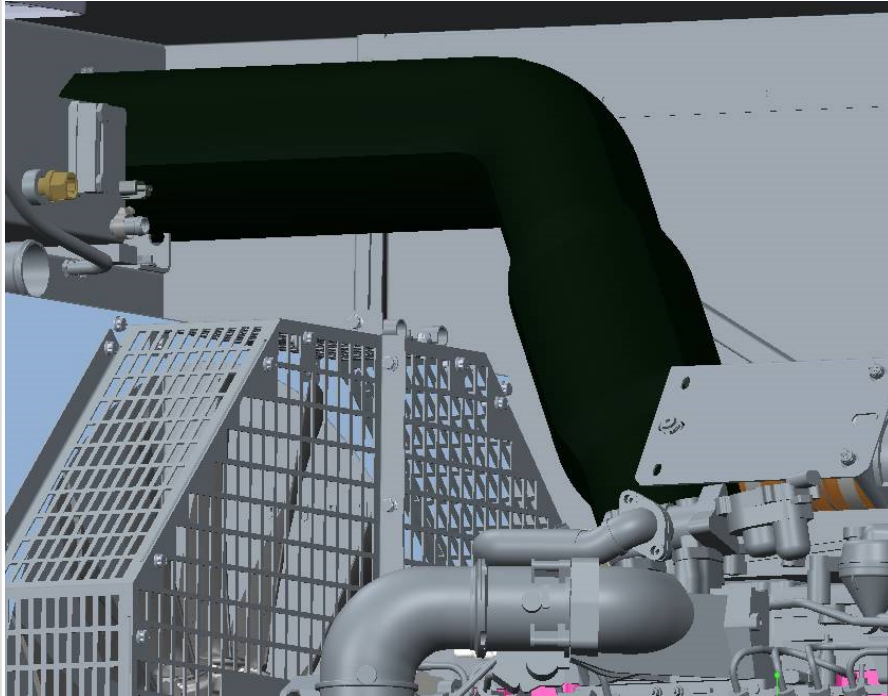

### **C300 D6R**

The C300 D6R generator set has a potential interference on the top hinge of the right side engine door. This may require components to be removed to gain access.

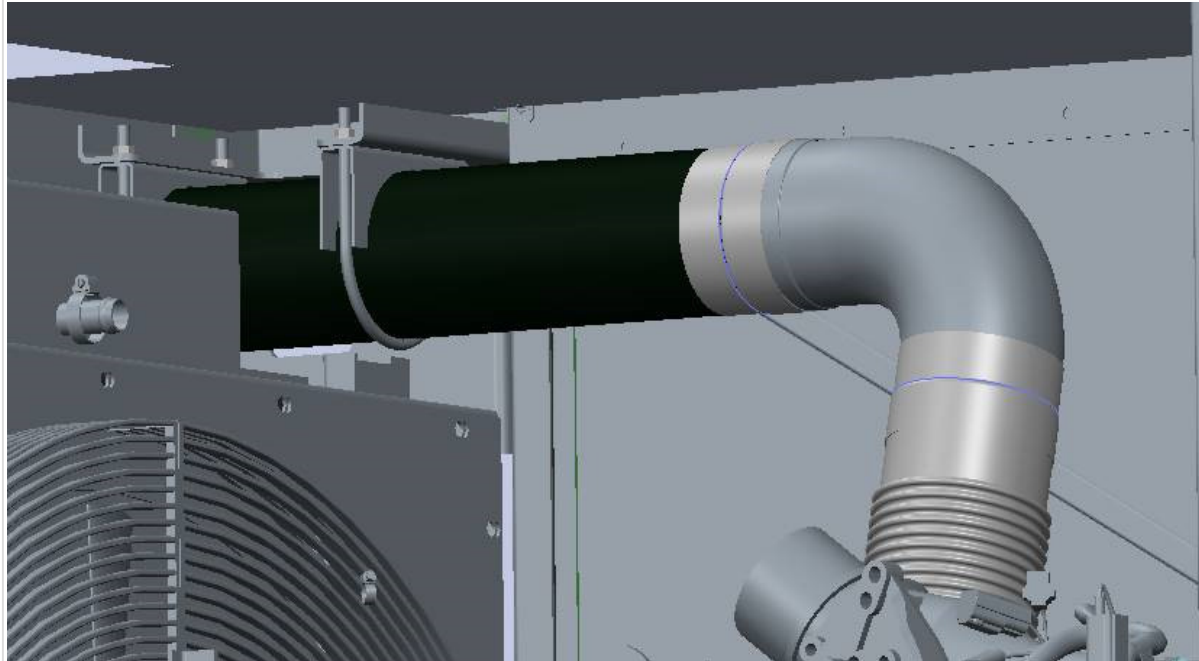

### **C60, C80, C100 D6R**

The C60-C100 D6R generator sets have a potential interference on the right side engine door. The muffler heat shield in the exhaust compartment may interfere with your ability to access the hinge hardware. The heat shield is connected with 4 bolts, two in the engine compartment and two under the heat shield. Once the heat shield bolts have been removed, the heat shield can be slid forward to gain access to the hinge hardware. Torque heat shield hardware to **27 Nm**

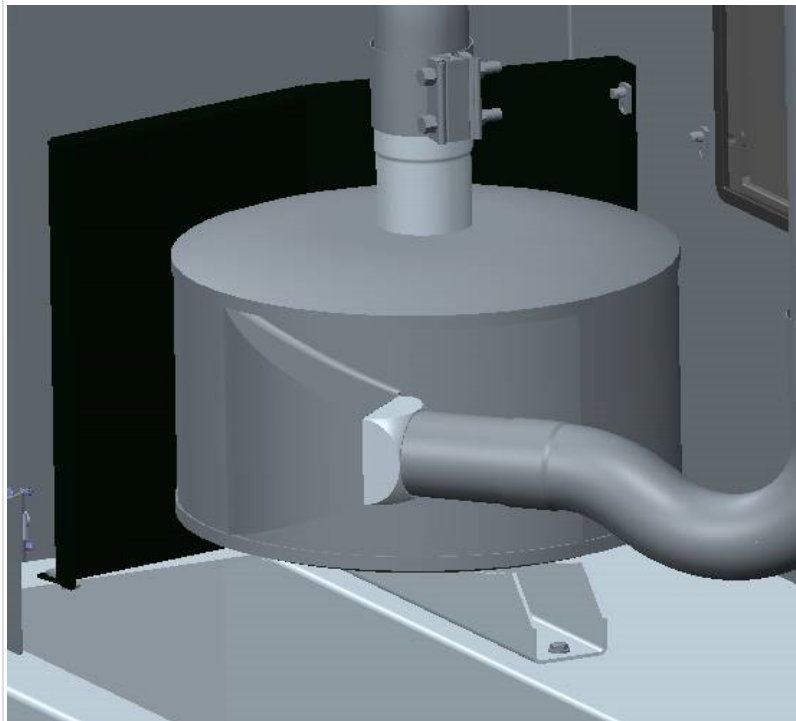

### **C200 D6R, C150 D2RE, and C200 D2RE**

The C150 and C200 generator sets have a potential interference in the exhaust compartment. There are two bulkhead supports that are structural support for the radiator. If there is an interference, unbolt from bulkhead only and flex the component out of the way. Ensure to only remove one from the bulkhead at a time to provide adequate support for the radiator. Torque hardware on the bulkhead to **42 Nm**

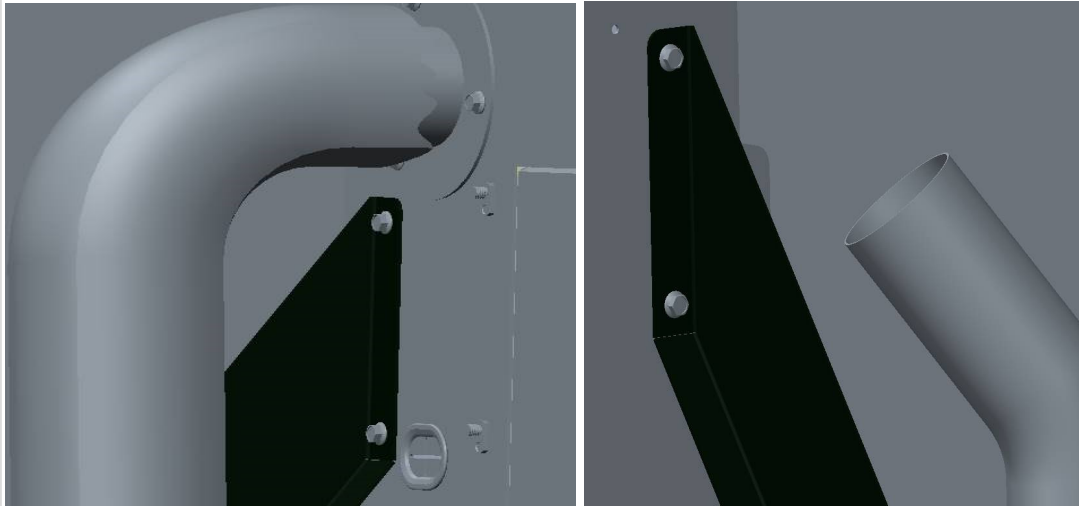

### **Door Striker Plates**

The replacement of the hinges may result in a tolerance stack up on the slam latch striker plate. Included in the kit is an adjustable striker plate. Striker plates are replaceable on the engine doors (all units) and the generator door (all units except C300 D6R and C275 D2RE)

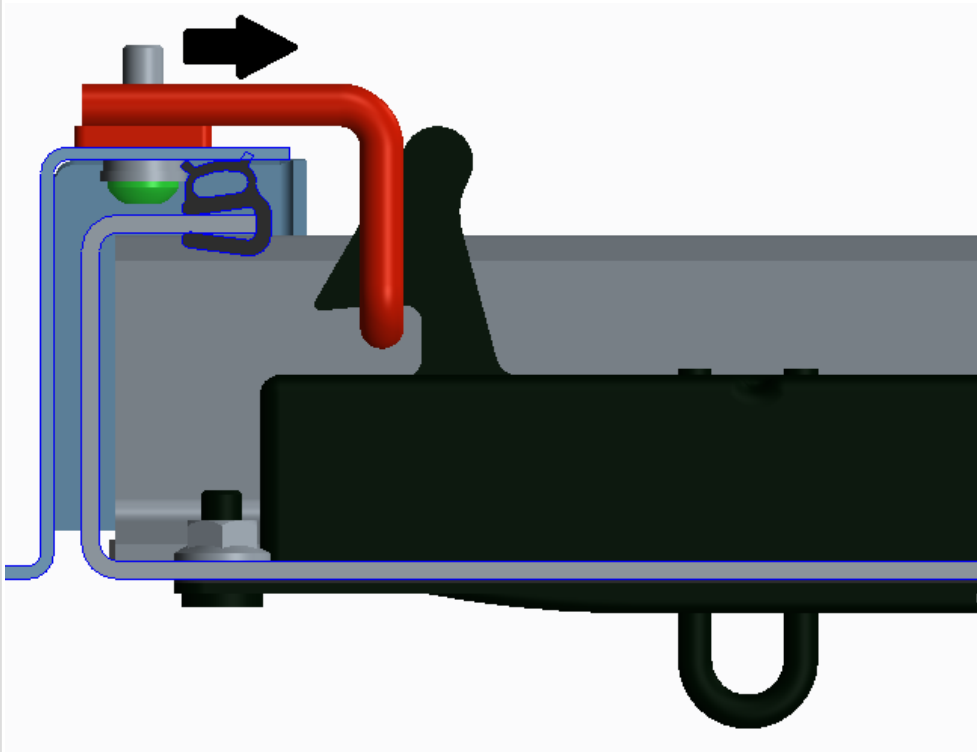

To install,

1. Remove existing striker plate
2. Install new striker with the hoop moved to the position closest to the hinges of the same door. Tighten and
3. Check actuation of the slam latch by closing the door and feeling for any interference in the mechanism.
4. Then install a padlock on the slam latch and then pull on the "locked" door handle. If the door does not open while locked and there is no interference in the mechanism, the striker is in the correct position.
5. If there is interference in the mechanism or the door opens on the pull test, adjust the position of the striker plate until satisfactory.
6. Torque the striker plate hardware to **8 Nm**

#### Affected Units

Model	Generator Serial Number
C100D6R	H160988953
C100D6R	H160988954
C100D6R	F160963767
C100D6R	F160963766
C100D6R	H160992155
C100D6R	H160992156
C100D6R	H160992158
C100D6R	H160989942
C100D6R	H160990892
C100D6R	H160990894
C100D6R	H160985711
C100D6R	H160989943
C100D6R	H160990893
C100D6R	H160987857
C100D6R	H160981927
C100D6R	H160981928
C100D6R	H160987856
C100D6R	H160987858
C100D6R	H160988358
C100D6R	G160979796
C100D6R	G160981430
C100D6R	G160981431
C100D6R	H160981863
C100D6R	H160981856
C100D6R	F160974524
C100D6R	F160974525
C100D6R	G160980846
C100D6R	F160971417
C100D6R	F160971418
C100D6R	E160955022
C100D6R	E160961329

C100D6R	E160963730
C100D6R	E160963731
C100D6R	E160961782
C100D6R	E160959252
C100D6R	E160955023
C100D6R	E160955524
C100D6R	D160950939
C100D6R	D160950940
C100D6R	E160953039
C100D6R	E160957601
C100D6R	D160940529
C100D6R	D160944880
C150D2RE	H160993148
C150D2RE	H160959254
C150D2RE	H160992159
C150D2RE	G160976882
C150D2RE	F160964629
C150D2RE	I160994926
C150D2RE	H160989448
C150D2RE	H160987855
C150D2RE	H160988955
C150D2RE	H160987854
C150D2RE	F160973198
C150D2RE	G160980845
C150D2RE	G160973200
C150D2RE	F160973196
C150D2RE	F160969969
C150D2RE	F160963733
C150D2RE	E160963728
C150D2RE	D160949947
C150D2RE	E160959655
C150D2RE	E160959659
C150D2RE	E160959660
C150D2RE	D160940513
C150D2RE	D160948591
C150D2RE	D160940482
C150D2RE	D160947180
C200D2RE	H160991346
C200D2RE	G160973387
C200D2RE	G160974529
C200D2RE	G160974530
C200D2RE	G160974527
C200D2RE	G160974526
C200D2RE	G160974531

C200D2RE	D160940512
C200D2RE	H160981857
C200D2RE	H160992157
C200D2RE	H160989447
C200D2RE	H160981854
C200D2RE	B160920960
C200D2RE	G160976879
C200D2RE	D160950062
C200D2RE	D160950584
C200D2RE	D160950585
C200D2RE	D160950063
C200D2RE	G160978644
C200D2RE	F160973197
C200D2RE	F160969970
C200D2RE	F160970895
C200D2RE	G160973199
C200D2RE	G160977394
C200D2RE	G160977395
C200D2RE	E160963729
C200D2RE	F160963732
C200D2RE	F160969343
C200D2RE	G160977393
C200D2RE	D160949949
C200D2RE	E160960587
C200D2RE	E160960588
C200D2RE	E160956681
C200D2RE	E160957602
C200D2RE	E160959662
C200D2RE	E160959657
C200D2RE	E160959663
C200D2RE	D160940514
C200D6R	I160976932
C275D2RE	G160976883
C275D2RE	H160980847
C275D2RE	H160980848
C275D2RE	H160980849
C275D2RE	H160980850
C275D2RE	G160974528
C275D2RE	G160976877
C275D2RE	G160976878
C275D2RE	G160976876
C275D2RE	E160955525
C275D2RE	E160955526
C275D2RE	I160994665

C275D2RE	H160981925
C275D2RE	H160981862
C275D2RE	H160988952
C275D2RE	H160981926
C275D2RE	G160977734
C275D2RE	G160979794
C275D2RE	G160977735
C275D2RE	G160979795
C275D2RE	G160977424
C275D2RE	G160977425
C275D2RE	G160977426
C275D2RE	F160970298
C275D2RE	G160977733
C275D2RE	G160977420
C275D2RE	F160970297
C275D2RE	F160969341
C275D2RE	F160969340
C275D2RE	E160959661
C275D2RE	E160959658
C275D2RE	F160966427
C275D2RE	D160953411
C275D2RE	E160953412
C275D2RE	D160940483
C275D2RE	D160949946
C275D2RE	D160949948
C275D2RE	D160952258
C275D2RE	E160963613
C275D2RE	E160963268
C300D6R	H160981855
C300D6R	H160981924
C300D6R	G160977736
C300D6R	E160959656
C300D6R	F160969339
C300D6R	F160969342
C300D6R	G160977737
C300D6R	E160960586
C300D6R	F160966428
C300D6R	F160966429
C300D6R	E160959253
C300D6R	C160914429
C300D6R	C160914430
C300D6R	C160914428
C300D6R	B160914426
C300D6R	B160914425

C300D6R	C160914427
C300D6R	B160914423
C300D6R	B160914424
C300D6R	B160914422
C60D6R	G160976880

**Warranty Statement:**

This work is authorized by a campaign. See details below.

**Campaign Authorization Details:**

This Campaign Has No Expiration  
 Campaign: 2954  
 Account Code: 65  
 Fail Code: YEHHR

SRTs Included:

SRT Code	Description	Hours
00-901 or 00-902	Administrative time	
99-999	Hinge Labor	2.5
99-999	Interference Labor	0.5
99-999	Striker Plates	0.2

Parts Included:

Part Number	QTY
A056P370	1

Travel: Travel is Authorized in the following order

1. If the unit is brought to the distributor, travel is not authorized
2. If the unit is in the field and a crane or hoist is on-site (or on truck), 1 trip is authorized
3. If a crane or hoist is not available, a second technician is authorized. Note: if this option is selected, an additional 3.5 hours of labor can be claimed in addition to the SRTs above
4. If all of the options above are not possible, this action authorizes transportation of the unit.

**Contact:**

For questions or concerns regarding this notification or the information stated above, please contact in the following order:

- 1) Your local Service Manager,
- 2) DFSE-Counterpart,
- 3) The Cummins Distributor Technical Support line at 812-377-6517