



Form No.	Issue Date	Rev. Date
I-2131	7/6/16	

K 1216

Pneumatic Shift Unit Clevis Pin Retrofit Kit Instructions NHTSA Recall 16E059

Consists of the following:

Part Number	Description	Qty
53322	Shoulder - Bolt, 1/2" x 1-1/4"	1
W3729-3	O-ring, 2"	1
W79006	Locknut – FlexTop, 3/8-16 UNC	1

Index:

Description	See Page
Clevis Pin Retrofit Instructions	2-6
Certificate of Remedy and Disposal	7

Pneumatic Shift Unit Clevis Pin Retrofit Kit Instructions

⚠ WARNING

Rotating Parts Hazard or Unexpected Truck Movement. May result in serious personal injury or death.

Stop the engine, set parking brake and chock the wheels before attempting to remove or repair the transmission.

1. Disconnect wiring harness, air lines, and manual override linkage (if equipped). This may not be required if air lines and harness allow clevis modification without removal.

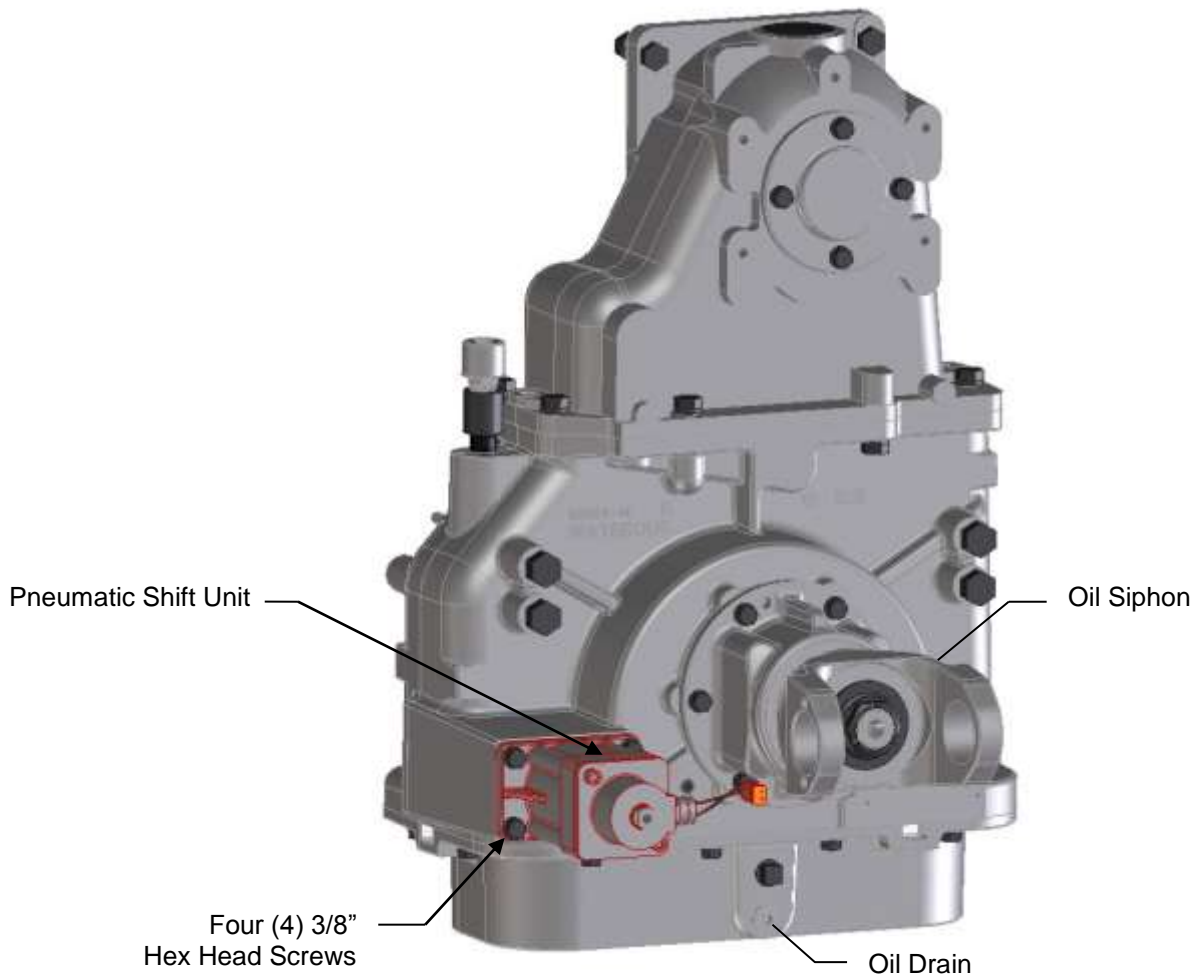

2. Drain or siphon the case lubricant below shift unit level (approximately 3.25 qts / 3.075 liters)

Pneumatic Shift Unit Clevis Pin Retrofit Kit Instructions

3. Place shift unit in ROAD mode by pushing override rod in.
4. Remove the four (4) 3/8-16 x 1 in. mounting screws and washers.
5. Pull shift unit straight back as far as possible.
6. Rotate shift unit towards case to disengage clevis from shift fork.

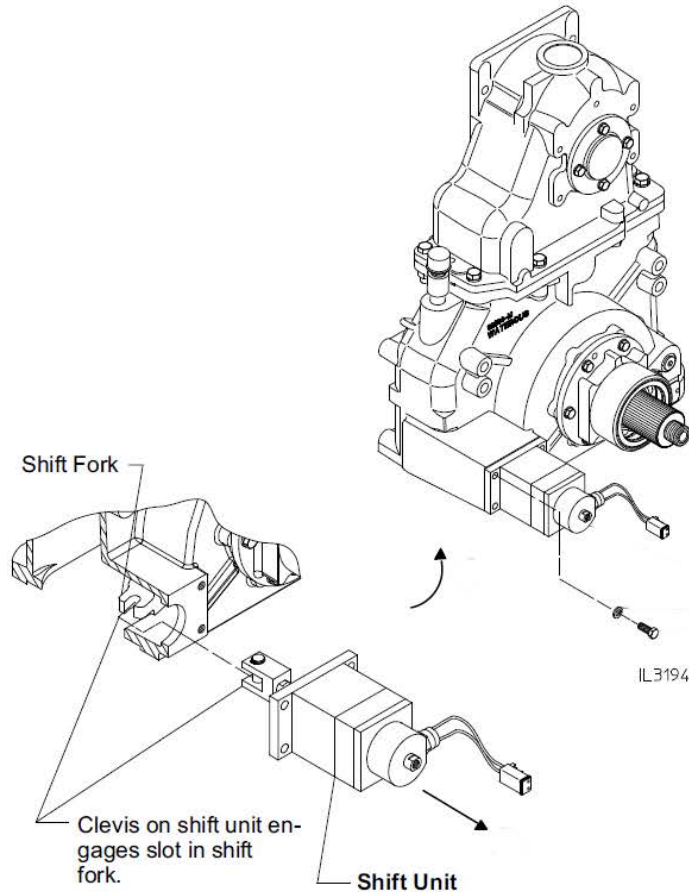

7. Record the shift unit date code stamped into the back of the shift unit as shown below and enter into Certificate of Remedy and Disposal.



Pneumatic Shift Unit Clevis Pin Retrofit Kit Instructions (con't)

8. Remove one retaining ring from the clevis pin and remove pin as shown below.

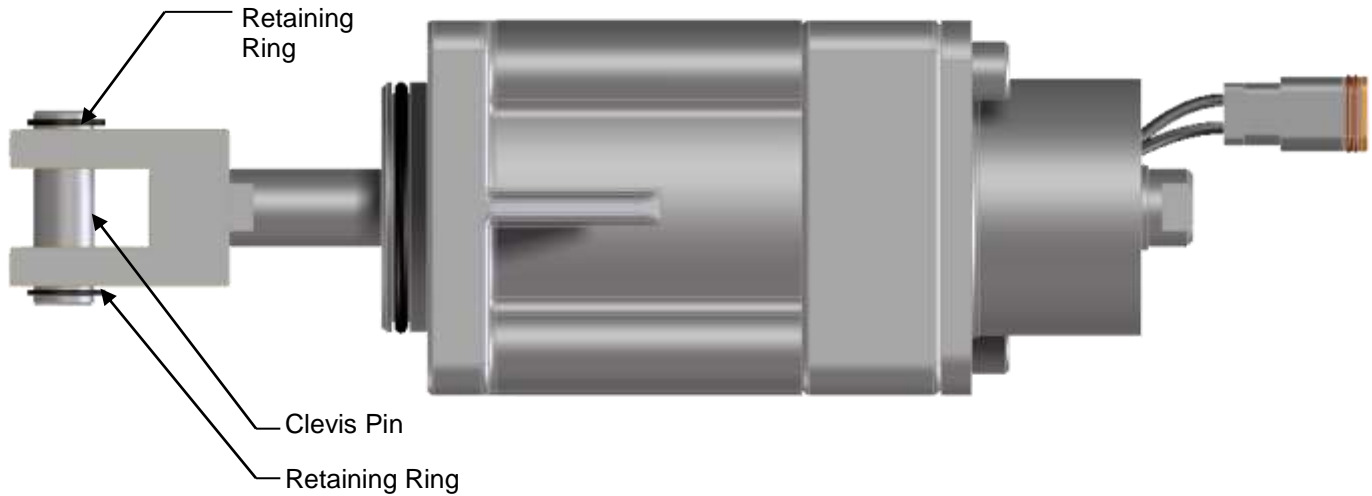

9. Remove and replace shift unit O-ring, coating O-ring with grease upon replacement.
10. Install shoulder bolt and locknut as shown below. Head of shoulder bolt must be on top. Torque to 170 inch-lbs. / 19.2 Nm.

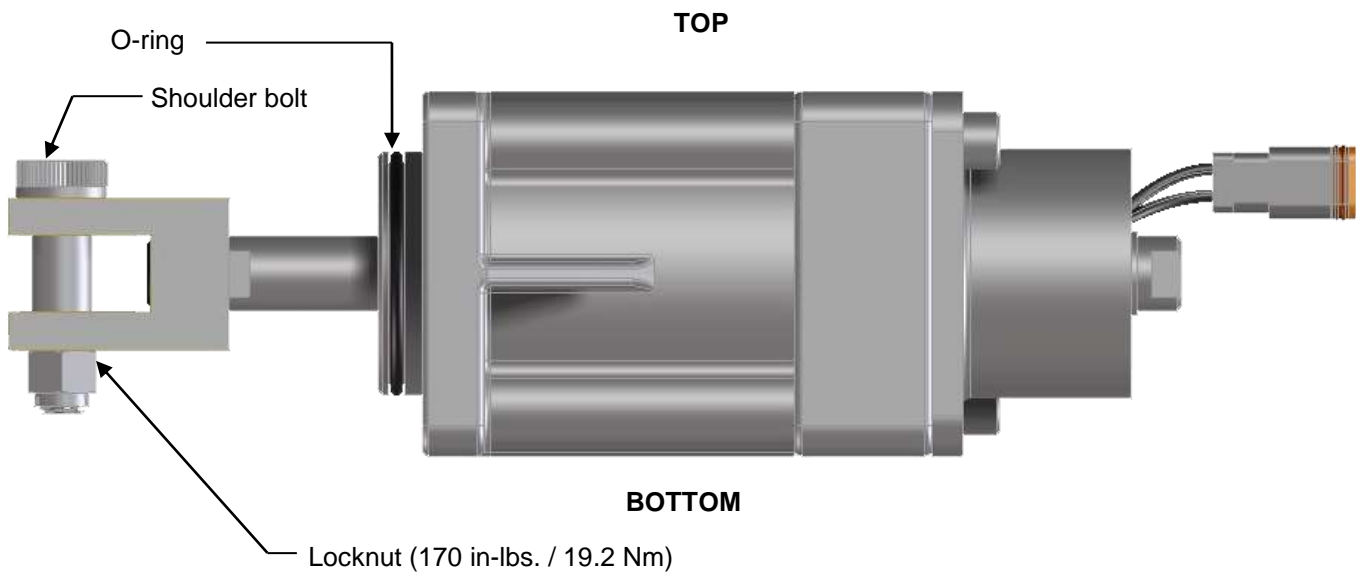

Pneumatic Shift Unit Clevis Pin Retrofit Kit Instructions (con't)

11. Place shift unit in ROAD mode by pushing override rod in.
12. Place shift fork in PUMP mode by pulling fork arm towards end of case where the shift unit mounts.
13. Rotate shift unit towards case and engage clevis in shift fork slot.
14. Push shift unit straight back in until flange contacts case.
15. Install four (4) 3/8-16 x 1 in. screws and lockwashers. Torque to 31 lb-ft/42 Nm.

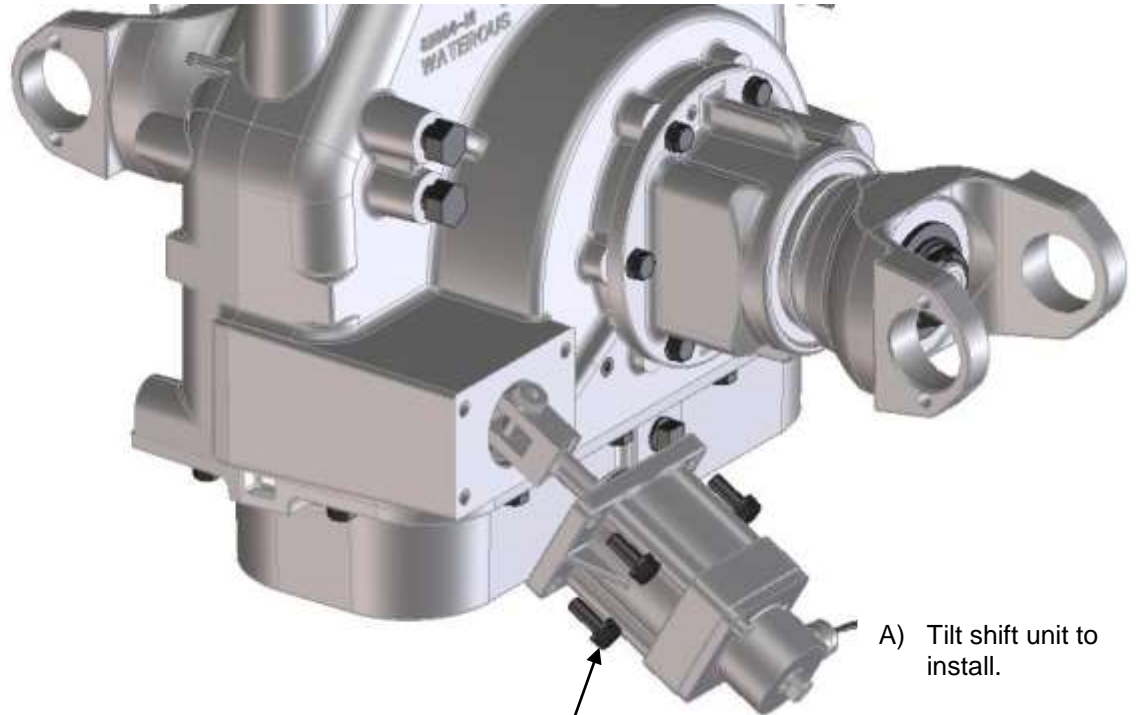

- A) Tilt shift unit to install.
- B) Head of shoulder bolt must be on top.

- C) Insert four (4) 3/8-16 x 1 in. mounting screws and lockwashers.
- D) Torque to 31 lb-ft / 42 Nm.

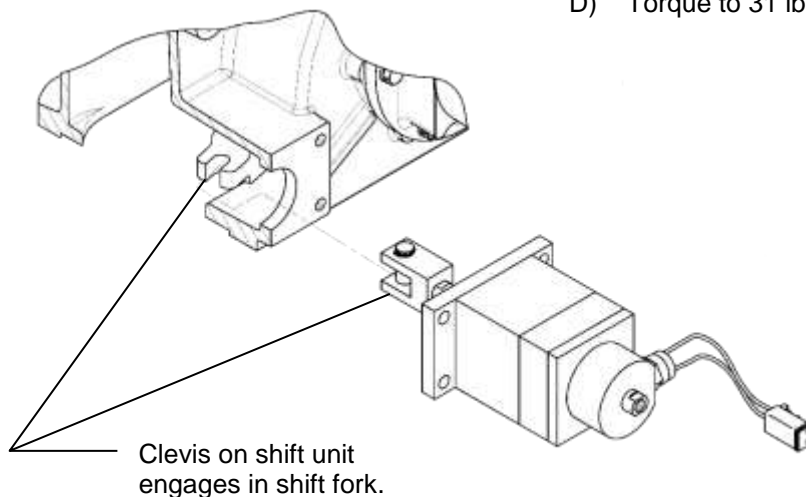

IL3194

Pneumatic Shift Unit Clevis Pin Retrofit Kit Instructions (con't)

16. Refill case lubricant to proper level.

- a. Fill the transmission through the oil level hole or by removing the breather and adding fluid through the opening. Any type of automatic transmission fluid (ATF) may be used. Capacity is approximately 6 quarts. Fill to the bottom of the threads in the oil level port.
- b. Re-check all fasteners for tightness.
- c. Check for fluid checks.

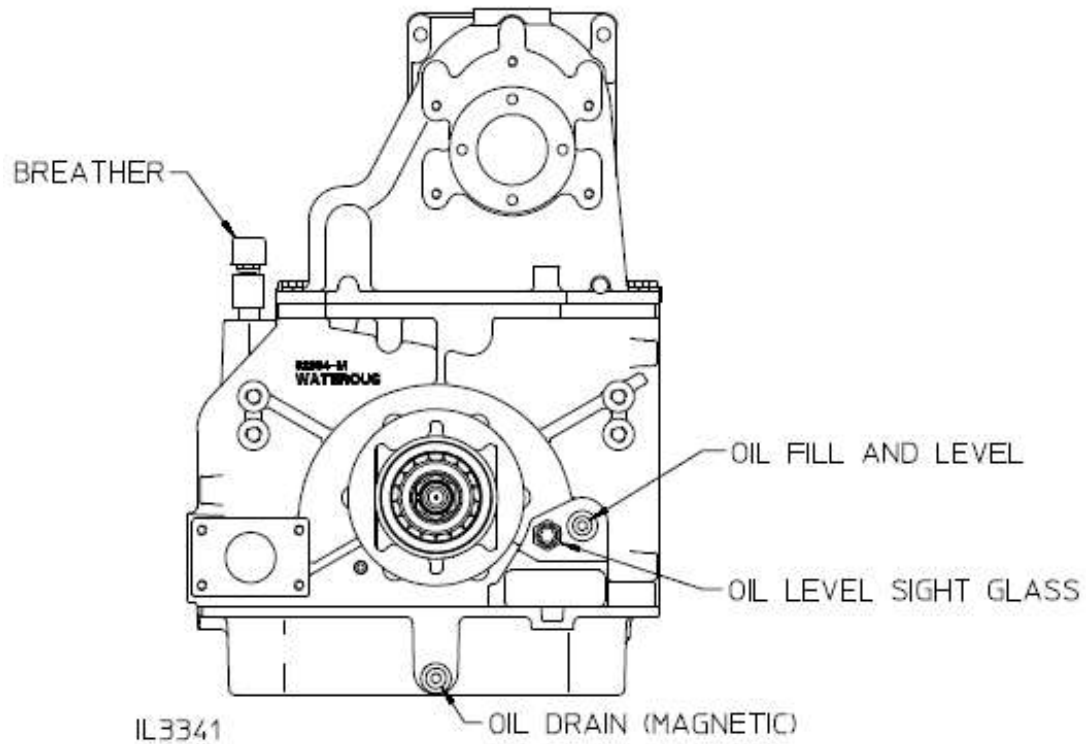

17. Reconnect wiring harness, air lines and manual override linkage (if equipped), if removal was required.

18. Operate shift unit to test actuation and pump engaged light.

19. Complete the Certificate of Remedy and Disposal and fax to Waterous Company at +1(651) 450-5090 or email to service@waterousco.com



**Certificate of Remedy and Disposal
Clevis Pin and Retaining Rings
NHTSA Recall 16E059**

REPAIR FACILITY NAME: _____
ADDRESS: _____
CITY: _____
STATE: _____ ZIP: _____
CONTACT NAME: _____
CONTACT TITLE: _____
CONTACT DAYTIME PHONE NUMBER: _____
CONTACT EMAIL ADDRESS: _____

I hereby certify the NHTSA 16E059 remedy has been performed as directed and the clevis pin and retaining rings for the unit identified below have been discarded.

PRINT NAME: _____
SIGNATURE: _____
DATE SUBMITTED: _____

Pump Transmission Serial Number	Shift Unit Date Code*

* The shift unit date code is the 5 character code (YY W XX) on the front surface mounting flange.

NOTICE: Please fax this completed document to Waterous Company at +1(651) 450-5090 or email to service@waterousco.com.

Questions: Contact Mark Blake at +1(651) 450-5067 or e-mail at mablake@waterousco.com.