

**TECHNICAL INSTRUCTIONS
FOR
SAFETY RECALL GLJ
CURTAIN SHIELD AIRBAG
CERTAIN 2011 –2012 MODEL YEAR CT200h**

The repair quality of covered vehicles is extremely important to Lexus. All dealership technicians performing this repair are required to successfully complete the most current version of the E-Learning course “Safety Recall and Service Campaign Essentials”. To ensure that all vehicles have the repair performed correctly; technicians performing this repair are required to currently hold at least one of the following certification levels:

- **Master Service Technician**
- **Master Diagnostic Specialist**

It is the dealership’s responsibility to select technicians with the above certification level or greater to perform this repair. Carefully review your resources, the technician skill level, and ability before assigning technicians to this repair. It is important to consider technician days off and vacation schedules to ensure there are properly trained technicians available to perform this repair at all times.

I. OPERATION FLOW CHART

The flow chart is for reference only. **DO NOT** use it in place of the full technical instructions. Follow **ALL** steps as outlined in the full technical instructions to confirm the campaign is completed correctly.

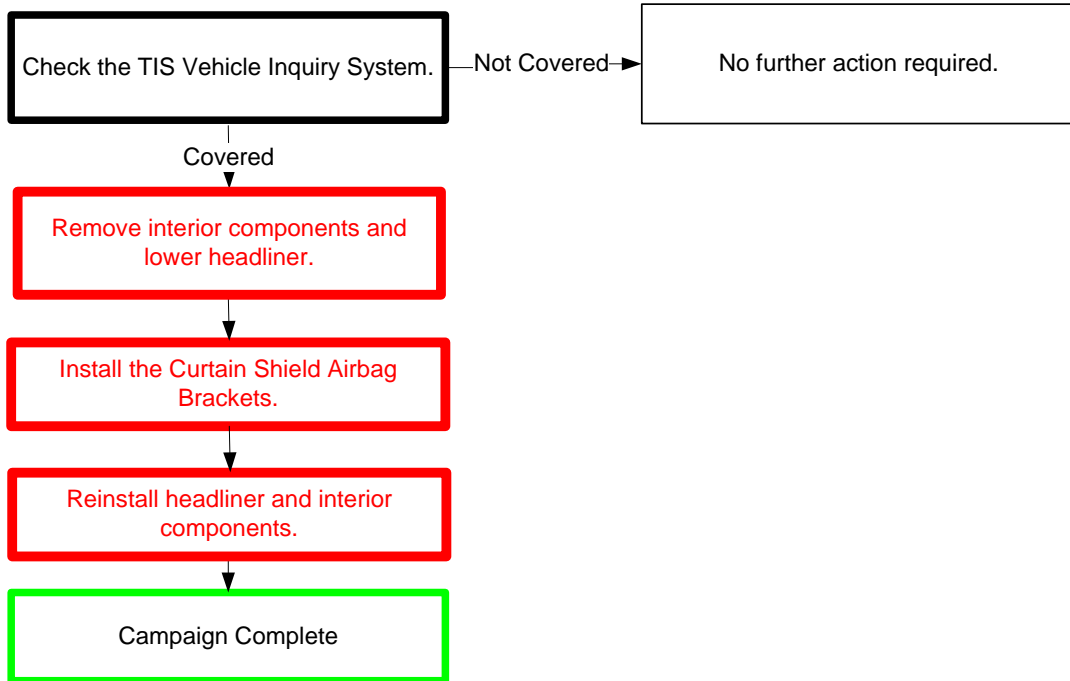

II. BACKGROUND

The involved vehicles are equipped with curtain shield air bags (CSA) in the driver and passenger side roof rails that have air bag inflators composed of two chambers welded together. Some inflators could have a small crack in the weld area joining the chambers, which could grow over time, and lead to the separation of the inflator chambers. This has been observed when the vehicle is parked and unoccupied for a period of time. If an inflator separates, the CSA could partially inflate, and, in limited circumstances, one or both sections of the inflator could enter the interior of the vehicle. If an occupant is present in the vehicle, there is an increased risk of injury.

The remedy will consist of installing retention brackets designed to prevent the inflator chambers from entering the vehicle interior if separation occurs.

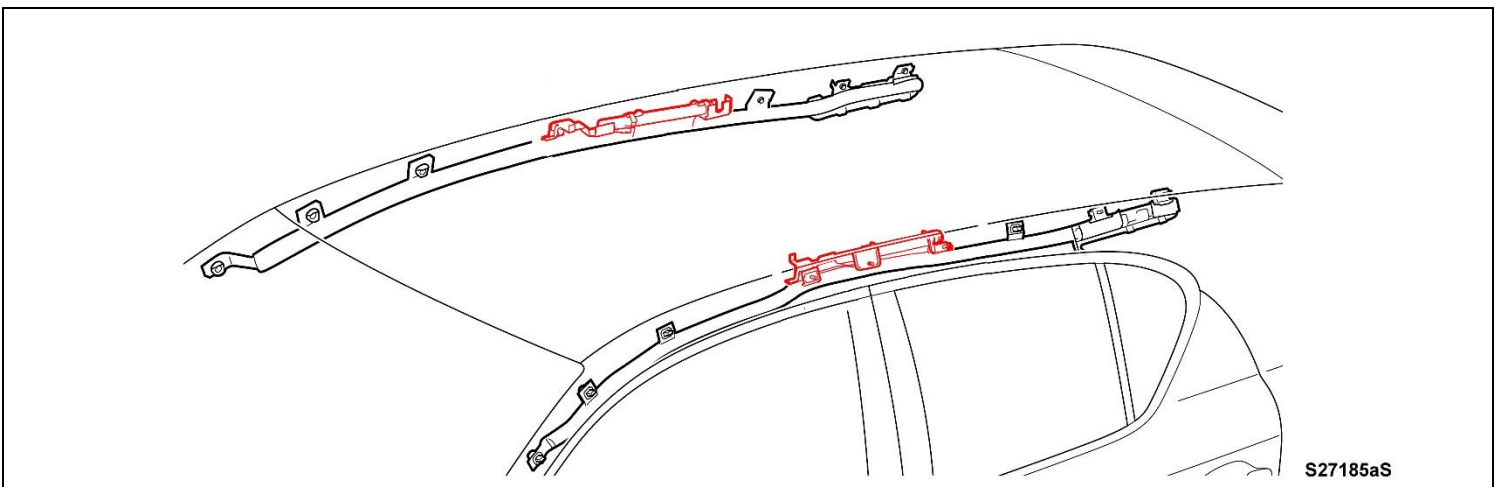

III. IDENTIFICATION OF AFFECTED VEHICLES

- Check the TIS Vehicle Inquiry System to confirm the VIN is involved in this Safety Recall, and that the campaign has not already been completed prior to dealer shipment or by another dealer.
- **TMS warranty will not reimburse dealers for repairs conducted on vehicles that are not affected or were completed by another dealer.**

IV. PREPARATION

A. PARTS

All applicable vehicles will require the parts in the table below

Part Number	Description	Qty
04006-40176	CSA Bracket Kit	1
62175-76030	FR RH CSA Bracket	1
62176-76030	FR LH CSA Bracket	1
62177-76020	RR RH CSA Bracket	1
62178-76020	FR LH CSA Bracket	1
90119-06869	Bolt w Washer and Thread Locker	2
90119-06897	Bolt w Washer and Thread Locker	2

B. MATERIALS

- Protective tape
- Marker Pen
- Protective Gloves

C. TOOLS & EQUIPMENT

- Standard hand tools
- Molding remover set
- Torque wrench
- Techstream
- Clip remover

CAMPAIGN TOOLS: These tools were provided to your dealer at the launch of the campaign remedy.



V. REDUCE INTERIOR TEMPERATURE AND INFLATOR TEMPERATURE



ALWAYS PERFORM THIS STEP TO ENSURE THE INFLATOR TEMPERATURE IS LOWERED. THIS IS CRUCIAL FOR YOUR SAFETY; SPECIFICALLY DURING THE HOTTER MONTHS WHEN DIRECT SOLAR LOAD IS PLACED ON VEHICLES.



REDUCE INTERIOR TEMPERATURE VIDEO

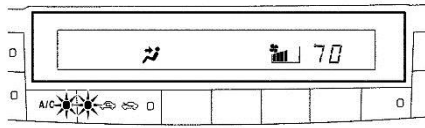

1. RECORD THE CUSTOMER CLIMATE CONTROL SETTINGS

- Temperature
- Air Inlet Setting (Recirculation or Fresh Air)
- Vent Setting
- Vent Position

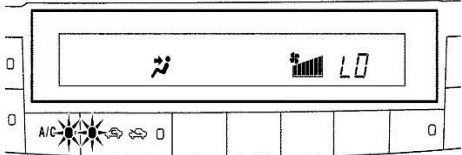

2. TURN ON THE A/C TO THE FOLLOWING SETTINGS

- A/C On
- Maximum blower/fan speed
- Max cool/LO setting
- Recirculation for air inlet
- Face/dash vent only mode
- Aim the dash vents upward toward the headliner

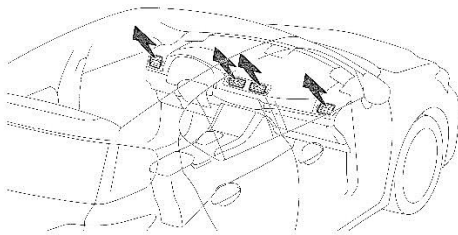

3. REPOSITION FRONT DOOR WEATHERSTRIP

- Remove the upper portion of the weatherstrip to allow the cool A/C air to enter the area between the headliner and roof panel.
- Using a cloth clean off the residual sealant left behind on the door frame from the weatherstrip.
- Place the loose weatherstrip inside the cabin of the vehicle to ensure that it does not get pinched by the door.

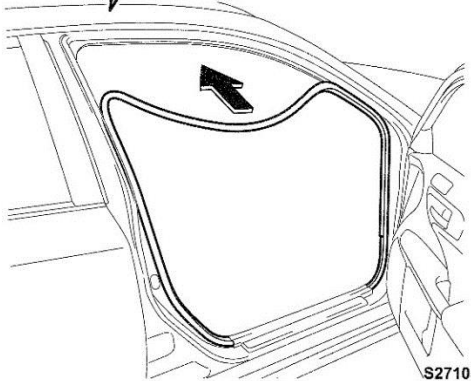
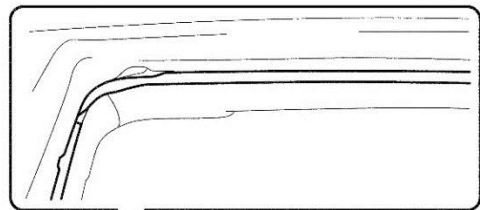

S27105aO



Ensure you follow this step, it is crucial to in order for the cool A/C air to reach the CSA Inflator Canister.

4. COOL INTERIOR

- Let the vehicle run for 15 minutes to lower the inflator temperature.



ALWAYS PERFORM THIS STEP TO ENSURE THE INFLATOR TEMPERATURE IS LOWERED. THIS IS CRUCIAL FOR YOUR SAFETY; SPECIFICALLY DURING THE HOTTER MONTHS WHEN DIRECT SOLAR LOAD IS PLACED ON VEHICLES.



VI. INTERIOR DISASSEMBLY

1. CONFIRM VEHICLES ORIGINAL CONDITION BY PERFORMING VEHICLE HEALTH CHECK
2. RECORD CUSTOMER SEAT POSITION AND RADIO SETTINGS
3. DISCONNECT 12V BATTERY

4. REMOVE THE FOLLOWING COMPONENTS

[HEADLINER REMOVAL REPAIR MANUAL LINK](#)

NOTE: On page TBD there are additional instruction for removing key components connecting the headliner to the roof of the vehicle, ensure you pay special attention to these steps.

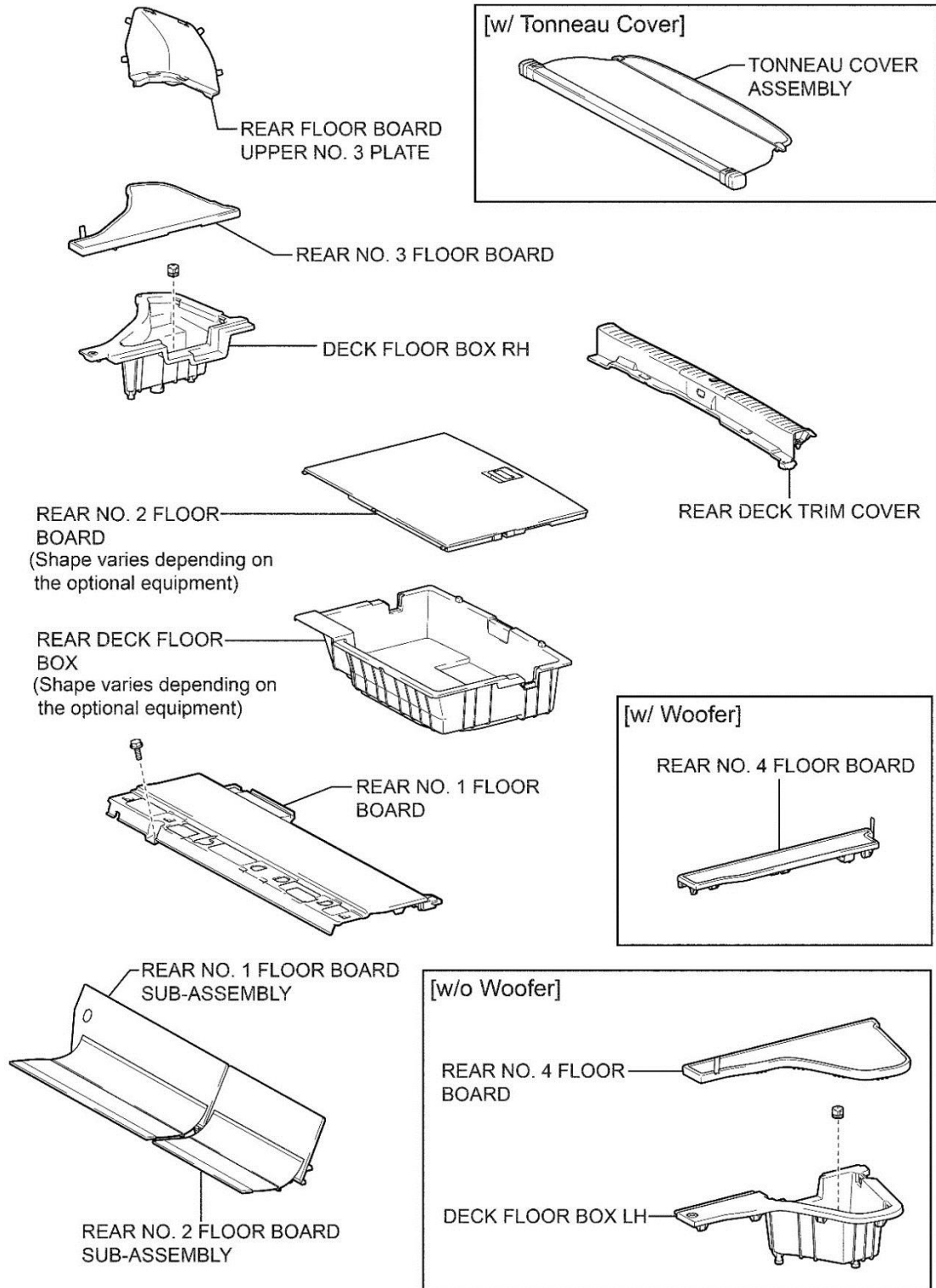

Component Removal Continued...

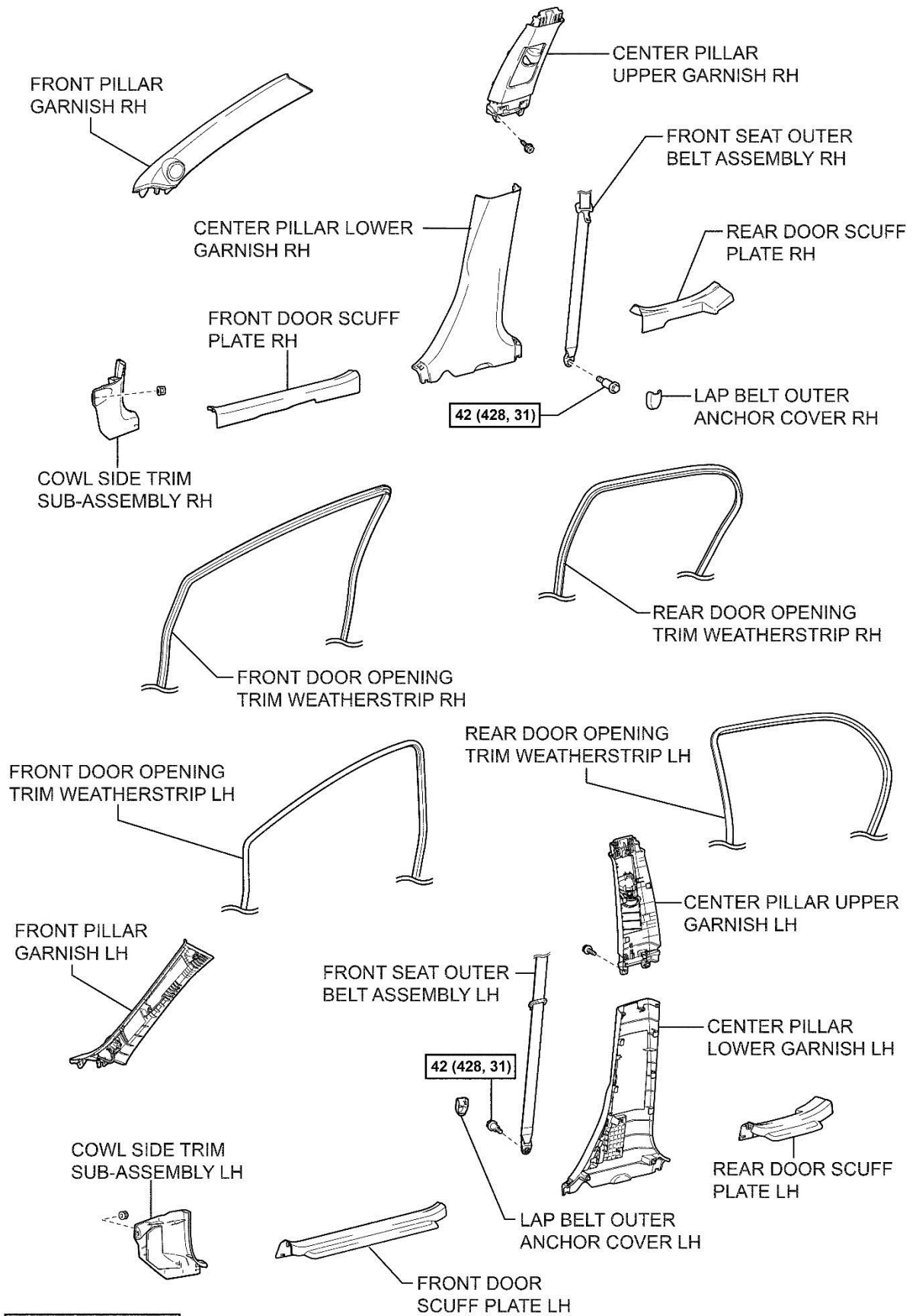

N*m (kgf*cm, ft.*lbf) : Specified torque

S27141aS

Component Removal Continued...

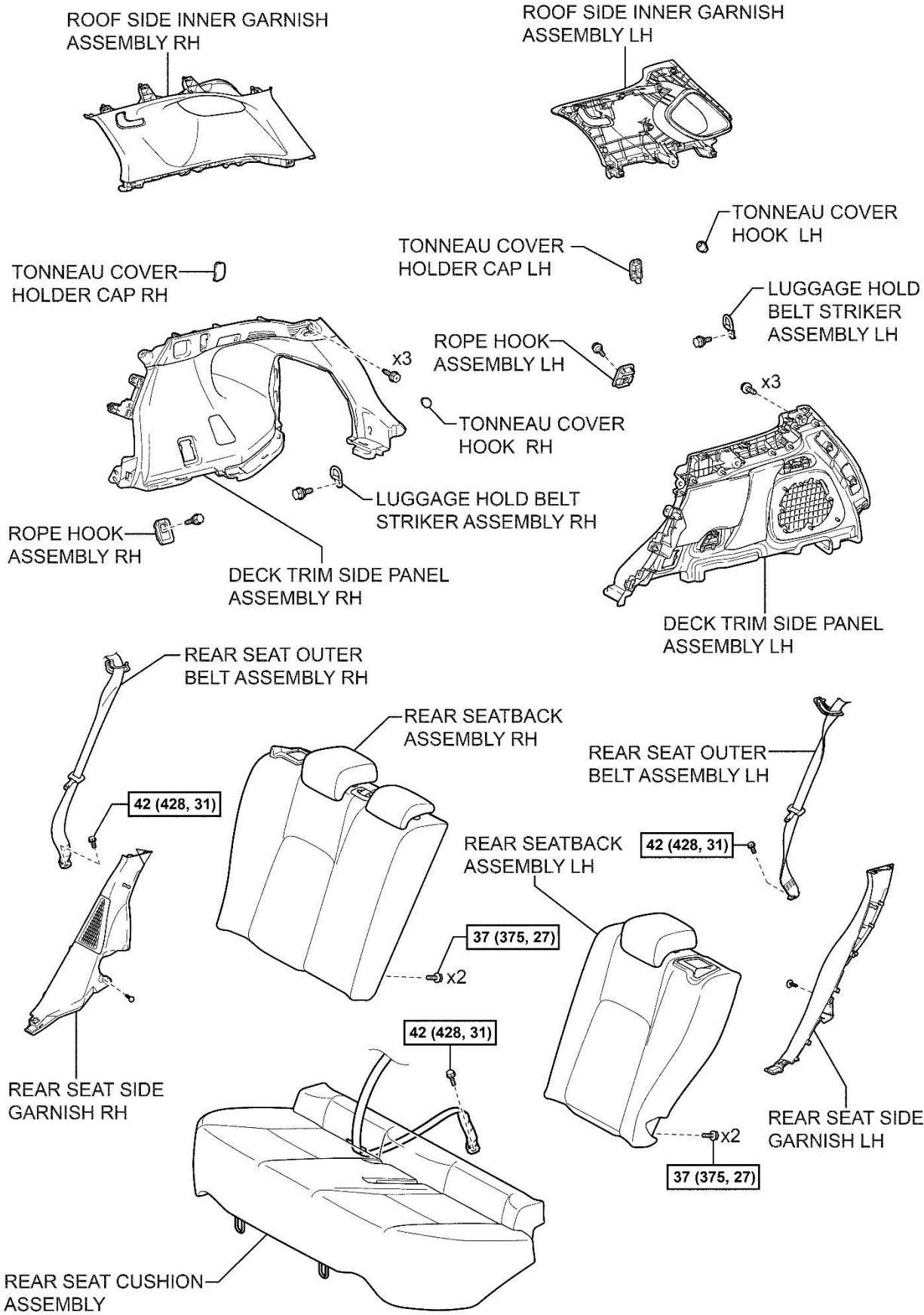

N*m (kgf*cm, ft.*lbf) : Specified torque

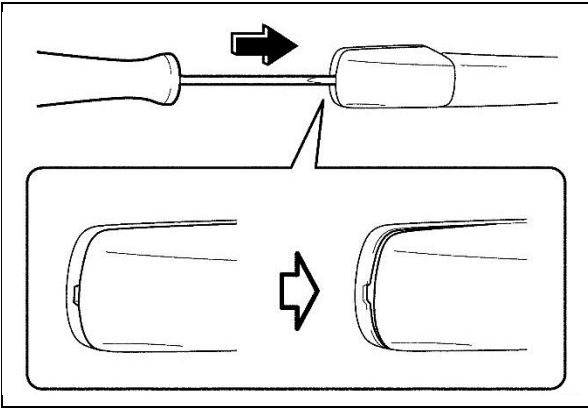

5. ASSIST GRIP REMOVAL

- a) Insert a pocket screwdriver into the notch on the assist grip cap on each side and create a slight gap for the assist grip removal tool.



DO NOT pry the assist grip cover, only make a slight gap for the SST. If the cover is pried on it will be damaged.

- b) Insert the assist grip removal tool all the way into the opening as shown and pull it straight outward.



- **DO NOT pull the assist grip remover at an angle or it can disengage and damage the cover.**
- **DO NOT forcefully pry the assist grip cover or they will be damaged.**

OK

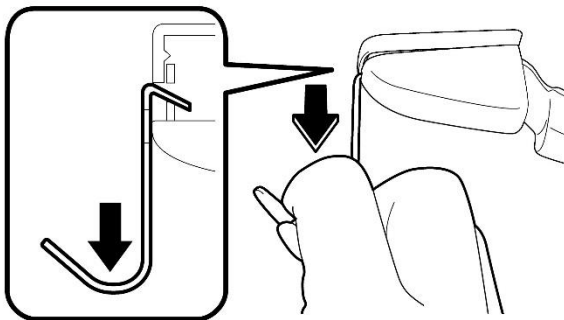

NG

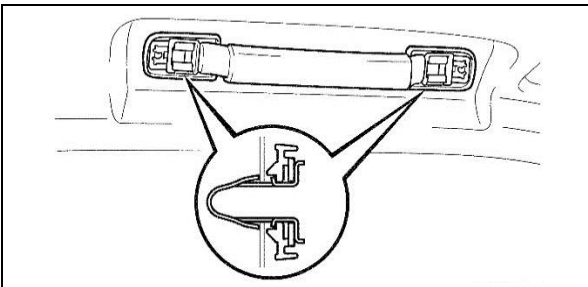
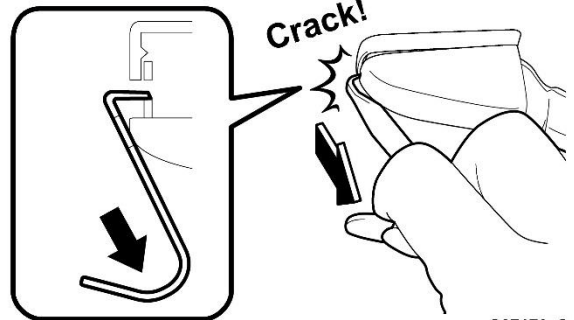

- a) Disengage the 2 clips and remove the assist grip.
- b) Remove the 2 clips from the vehicle roof assembly.
- c) Repeat this procedure for the remaining 3 Assist Grip Handles.

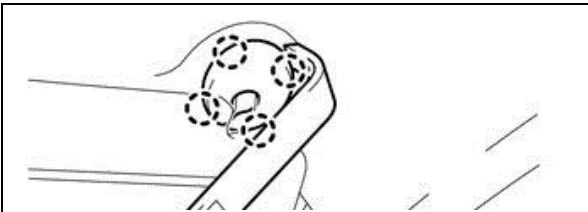

6. REMOVE SUN VISOR

- a) Using a molding removal tool disengage the 4 claws and remove the visor bracket cover.

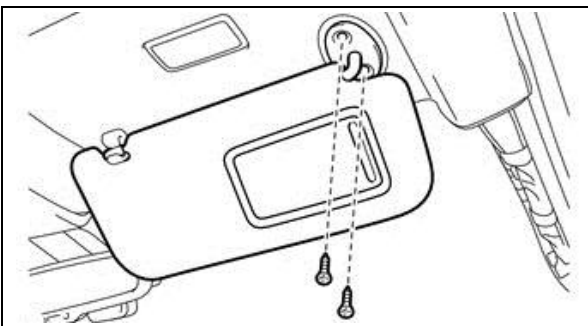

- b) Remove the two screws and visor assembly.

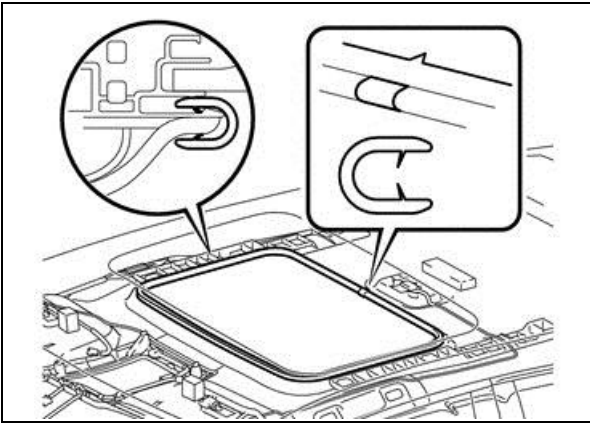

7. REMOVE SLIDE ROOF OPENING MOLDING (if equipped)

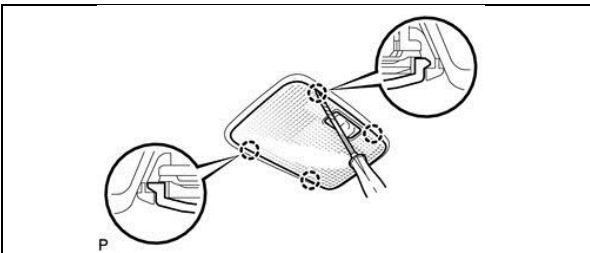

8. REMOVE DOME LIGHT LENS

- a) Using a pocket screwdriver wrapped in tape, disengage the 4 claws and remove the dome light lens.



9. PREPARE INTERIOR FOR LOWERING OF HEADLINER

- a) Remove the head rest from the front seat.
- b) Recline the seat back to the full recline position and cover the seats with seat covers.

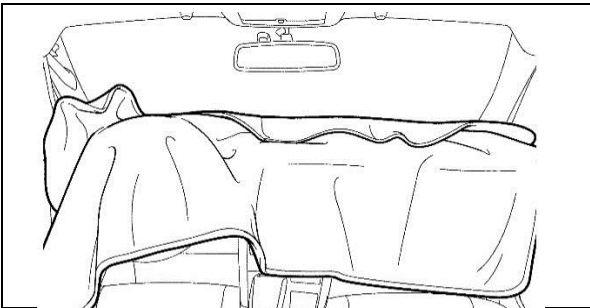

- c) Cover the instrument panel with a sheet to protect when the headliner is lowered.

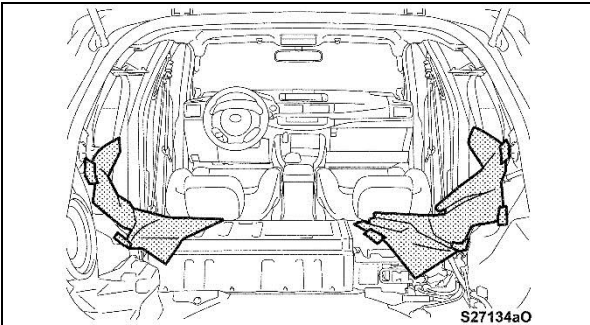

- a) Cover the rear wheel well area with protective blankets to prevent damage to the headliner when lowered.

10. PREPARATION TO LOWER HEADLINER ASSEMBLY



The following step should be performed with two technician to ensure that the headliner is not damaged. As clips are removed the headliner is going to start sagging and will need to be supported.

W/O SLIDING ROOF

a) Disconnect the electrical connectors and clips at the following locations as shown.

- Front Pillar Area
- Rear Pillar Area
- Roof Area

NOTE: It is not necessary to disconnect the connectors at the instrument panel because the headliner will not be removed from the vehicle.

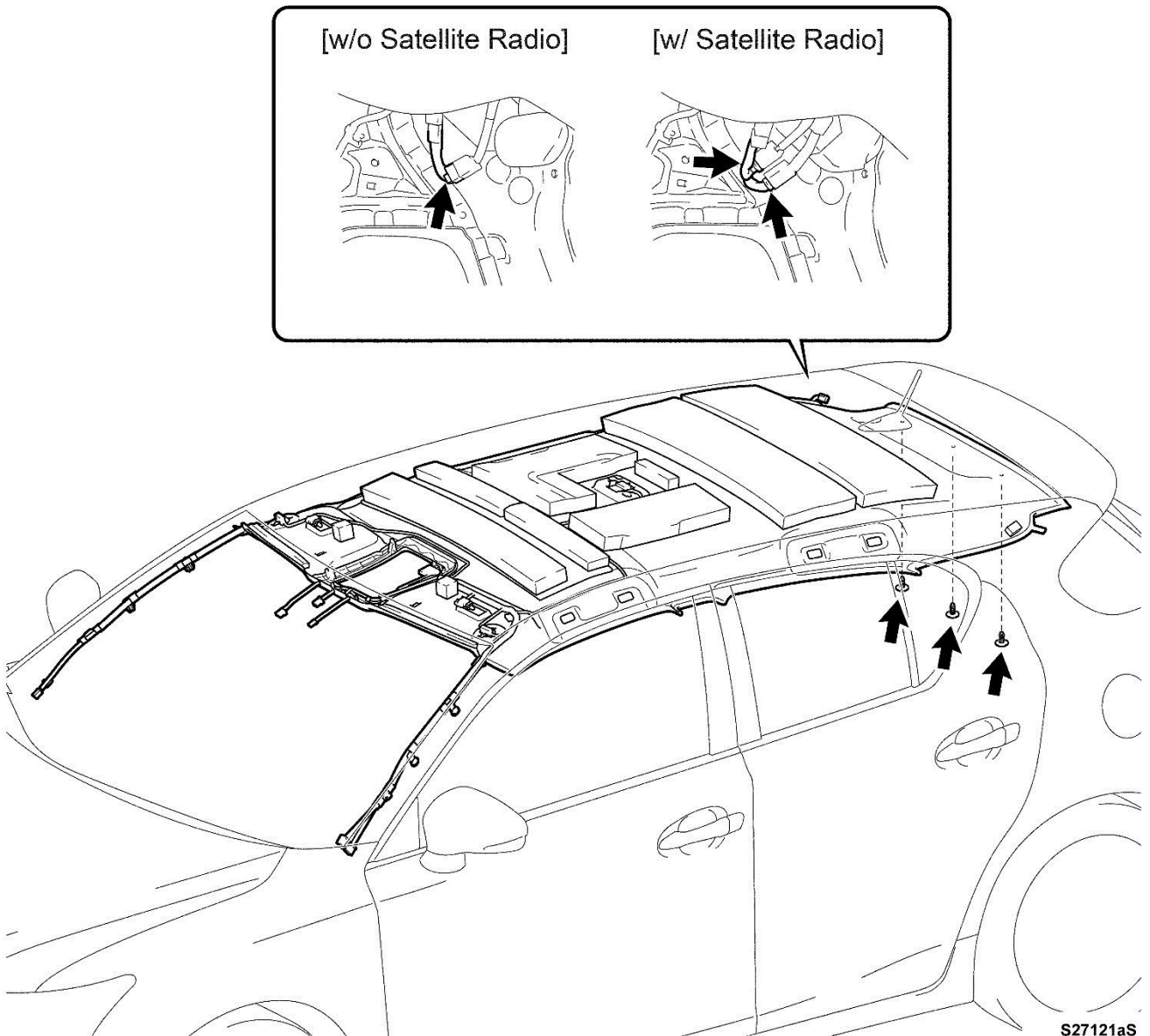

S27121aS

WITH SLIDING ROOF

b) Disconnect the electrical connectors and clips at the following locations as shown.

- Front Pillar Area
- Rear Pillar Area
- Roof Area

NOTE: It is not necessary to disconnect the connectors at the instrument panel because the headliner will not be removed from the vehicle.

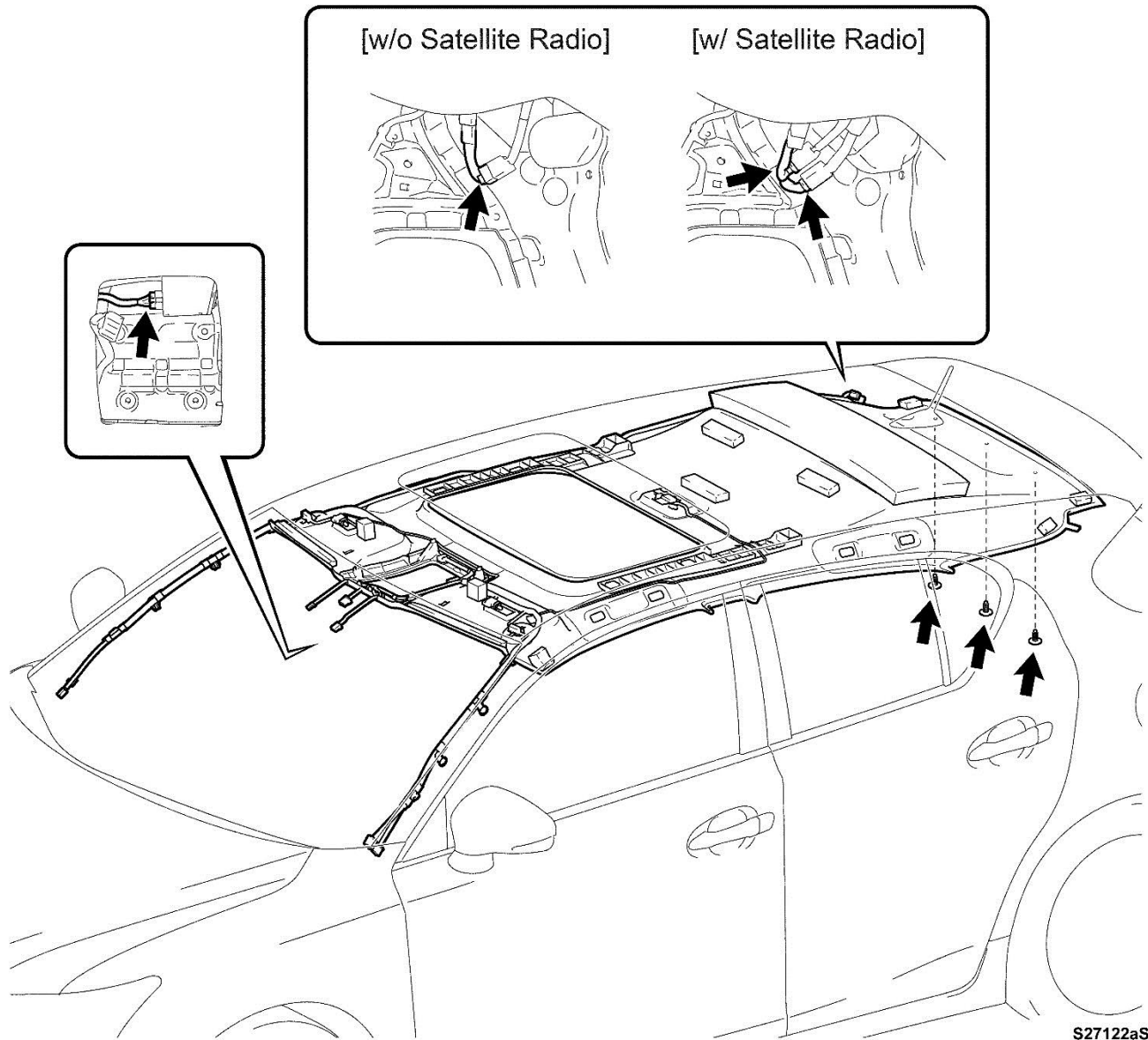

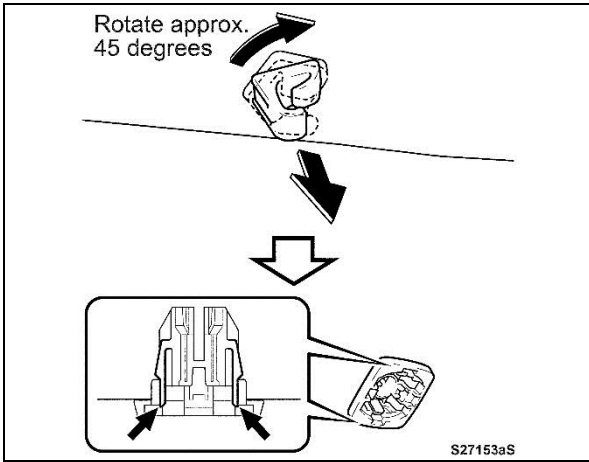

11. REMOVE THE SUN VISOR HOLDER

- a) Turn the sun visor holder 45 degrees clockwise to disengage it from the roof.
- b) Remove the base portion of the visor holder by disengaging the 4 claws.

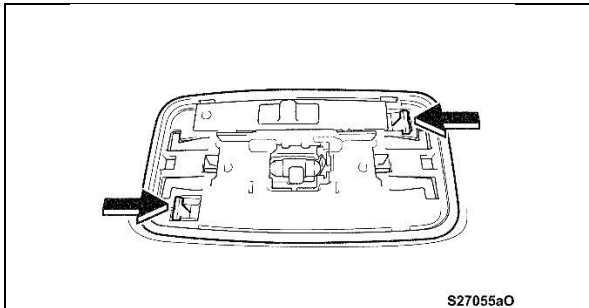

12. REMOVE THE DOME LIGHT FIXTURE

- a) Remove the dome light from the roof panel by disengaging the 2 claws.

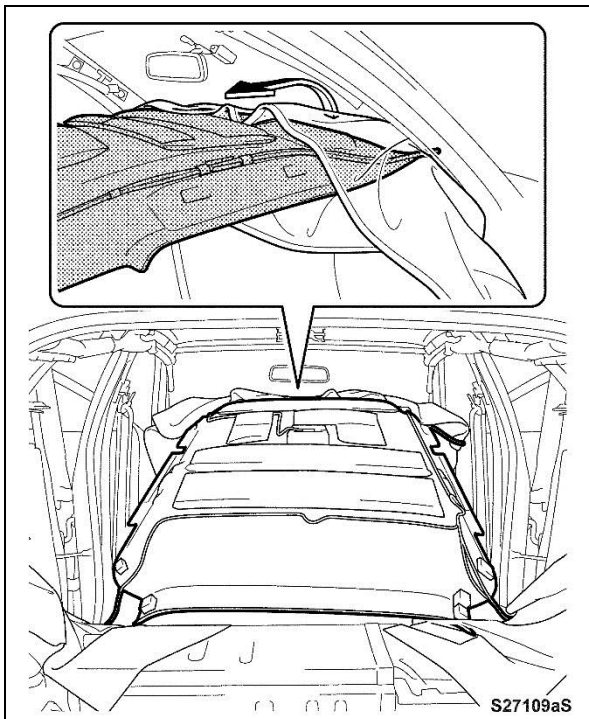

13. LOWER HEADLINER

- a) Cover the front edge of the headliner with the sheet protecting the instrument panel.
- b) Carefully lower the headliner inside the cabin.

VII. INSTALL CURTAIN SHIELD AIRBAG BRACKETS

[CSA BRACKET INSTALLATION VIDEO](#)

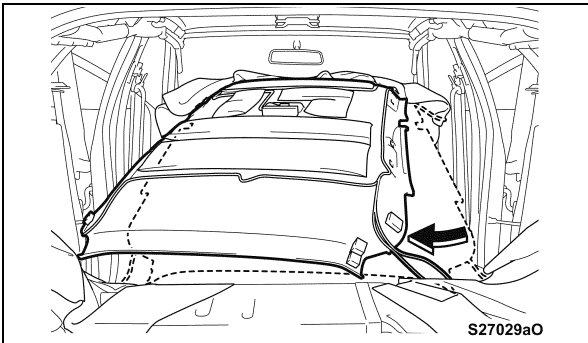

1. PROVIDE WORK SPACE

- a) As you install the brackets create work space by carefully shifting the headliner from side to side.



- Use caution when performing this step to ensure the headliner and vehicle interior is not damaged.
- Wear protective gloves during this procedure to protect your hands from sharp edges and burrs.

2. INSTALL THE FRONT RH AND LH CURTAIN SHIELD AIRBAG BRACKETS

- a) Remove the bolt from the curtain shield airbag. (RH side shown)
b) Mark the removed bolt so it does not get reused.

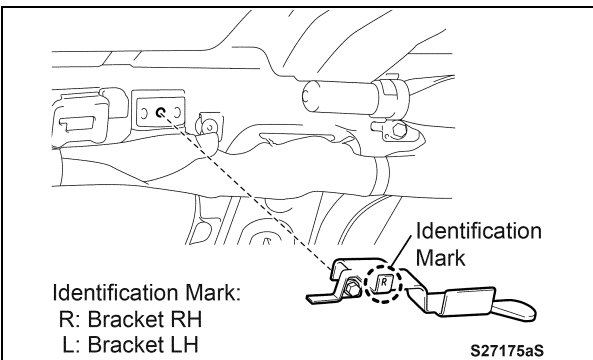
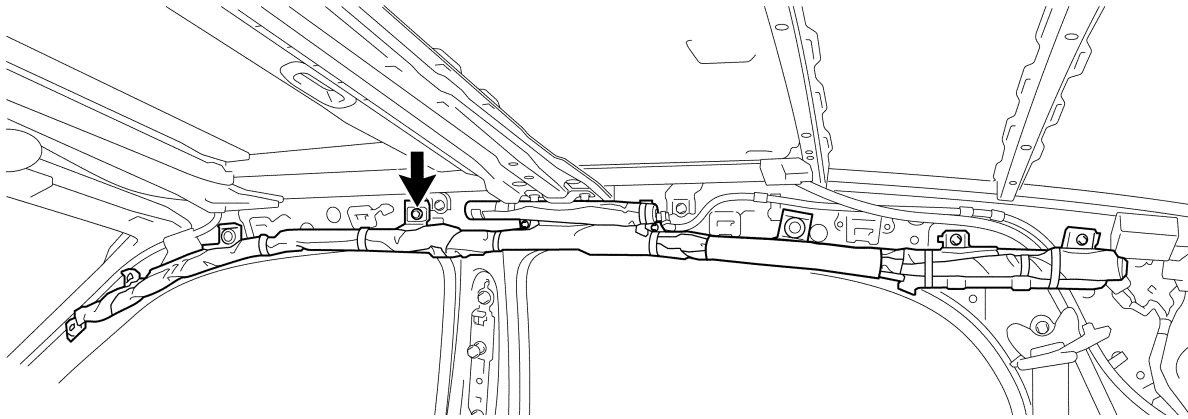

- c) Temporarily install the front RH CSA bracket on top of the CSA with the **NEW** bolt.

NOTE: The new bolt comes with thread locker already applied.

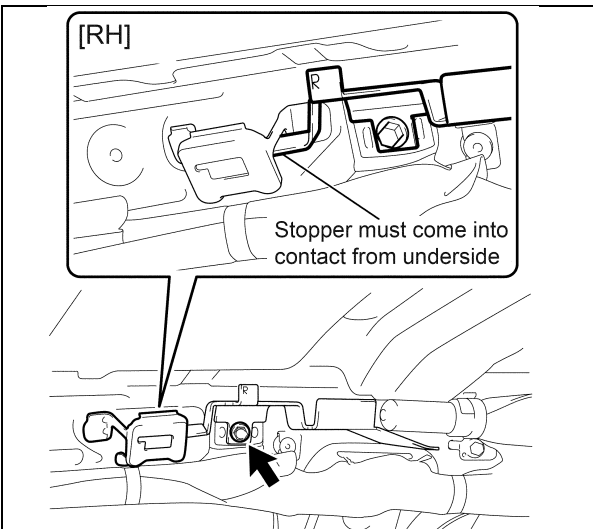

- d) Set the position stopper of the front RH CSA bracket so that it is in contact with the assist grip mounting bracket as shown.
e) Tighten the bolt to specification.

Torque Spec: 87in.*lbs (9.8N*m, 100kgf*cm)

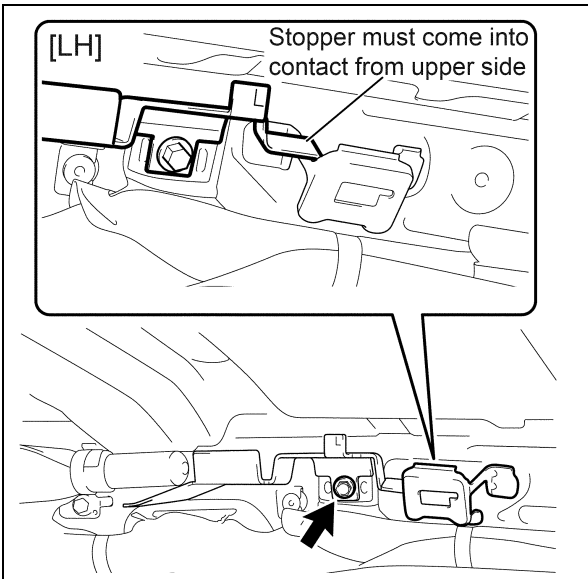

- f) Temporarily install the front LH CSA bracket with the airbag with the **NEW** bolt.
- g) Set the position stopper of the front LH CSA bracket so that it is in contact with the assist grip mounting bracket as shown.

STOP

The design of the left hand bracket is slightly different. Therefore when installing the bracket it will rest against the assist grip bracket differently.

- h) Tighten the bolt to specification.

Torque Spec: 87in.*lbs (9.8N*m, 100kgf*cm)

3. INSTALL THE REAR RH AND LH CURTAIN SHIELD AIRBAG BRACKETS

- a) Remove the bolt from the curtain shield airbag. (**Only if Equipped with Sliding Roof**)
- b) Mark the bolt removed from the vehicle to ensure it does not get reused. (**If equipped**)

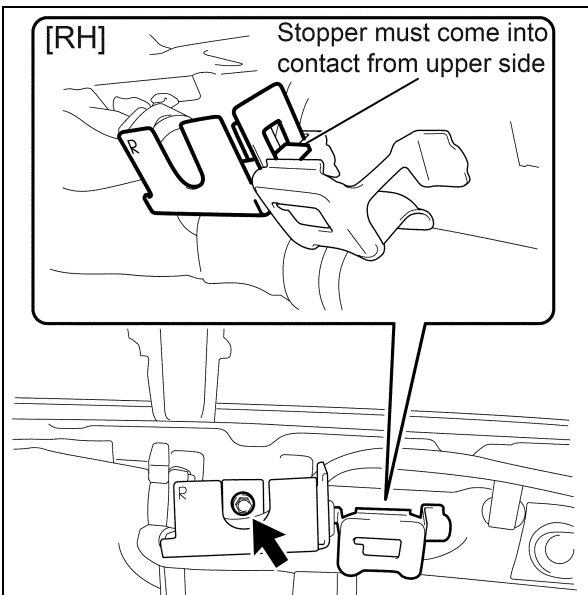
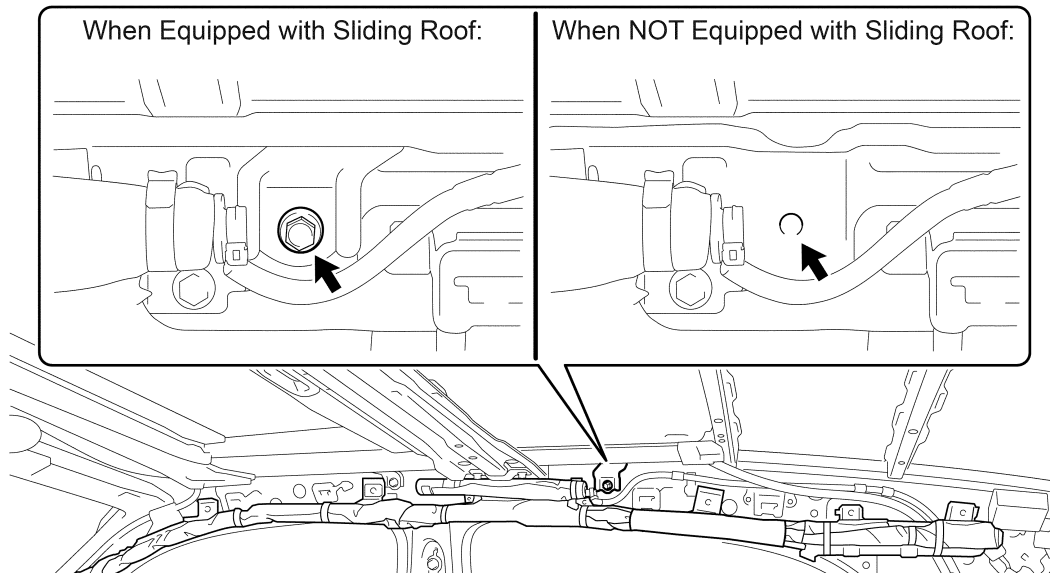

- c) Temporarily install the rear RH CSA bracket with the airbag with the **NEW** bolt that does NOT contain thread locker.
- d) Set the position stopper of the rear RH CSA bracket so that it is in contact with the assist grip mounting bracket as shown.
- e) Tighten the bolt to specification.

Torque Spec: 71in.*lbs (8.0N*m, 82kgf*cm)

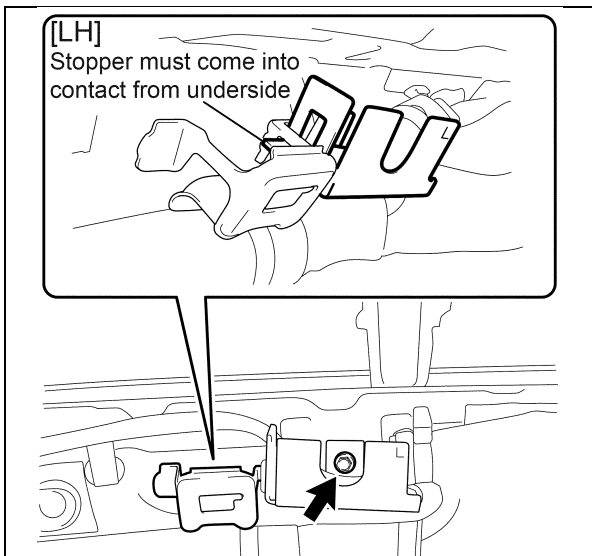

- f) Temporarily install the rear LH CSA bracket with the airbag with the **NEW** bolt that does NOT contain thread locker.
- g) Set the position stopper of the rear LH CSA bracket so that it is in contact with the assist grip mounting bracket as shown.

STOP The design of the left hand bracket is slightly different. Therefore when installing the bracket it will rest against the assist grip bracket differently.

- h) Tighten the bolt to specification.

Torque Spec: 71in.*lbs (8.0N*m, 82kgf*cm)

VIII. INTERIOR REASSEMBLY

STOP The following step should be performed with two technician to ensure that the headliner is not damaged during reinstallation.

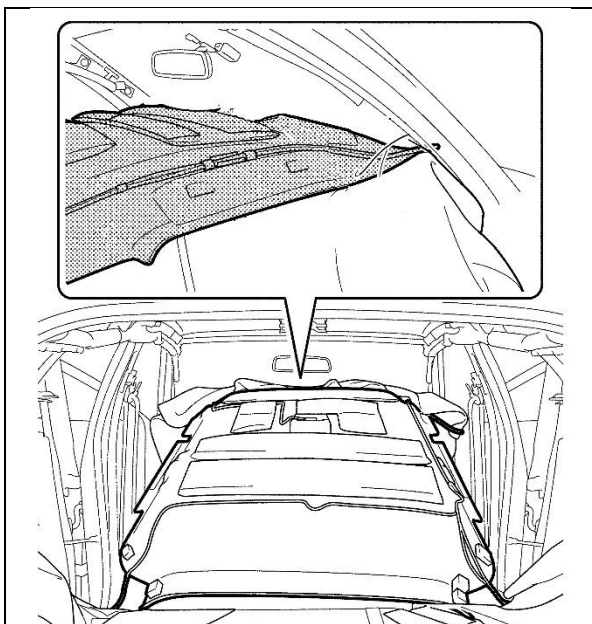

1. LIFT THE HEADLINER BACK INTO POSITION

- a) Using 2 technicians lift up the headliner and align it into the correct installation position.

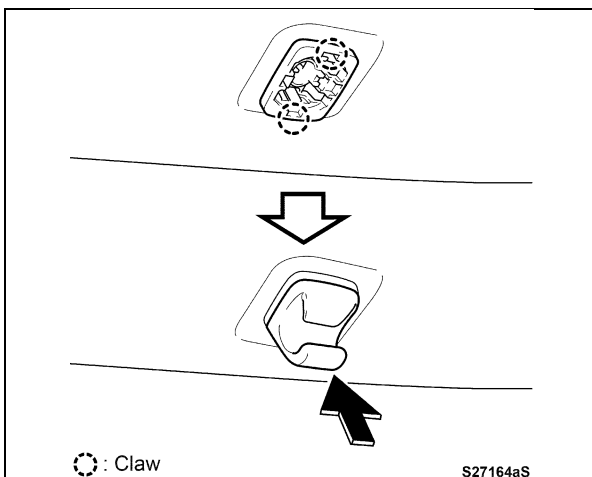

2. REINSTALL THE SUN VISOR HOLDER

- a) While supporting the headliner install the base of the sun visor holder by re-engaging the 4 claws.
- b) Reinstall the tip of the sun visor holder.
- c) Repeat on opposite side.

Claw

S27164aS

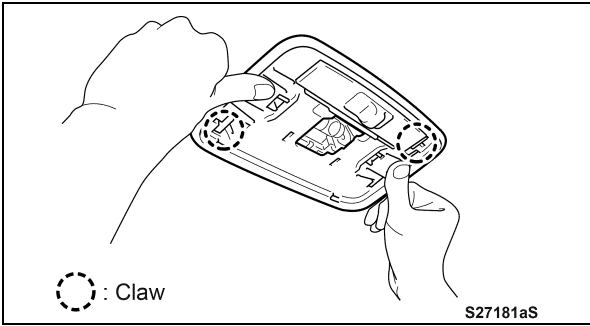

3. REINSTALL THE DOME LIGHT FIXTURE

- a) Reengage the 2 claws guides as shown.
- b) Engage the 3 claws as shown.

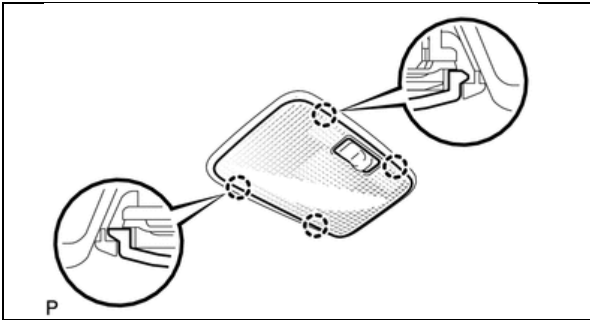

- c) Reengage the 4 claws to reinstall the dome light lens.

4. RECONNECT HEADLINER ELECTRICAL CONNECTORS AND CLIPS

W/O SLIDING ROOF

- c) Reconnect the electrical connectors and clips at the following locations as shown.
 - Front Pillar Area
 - Rear Pillar Area
 - Roof Area

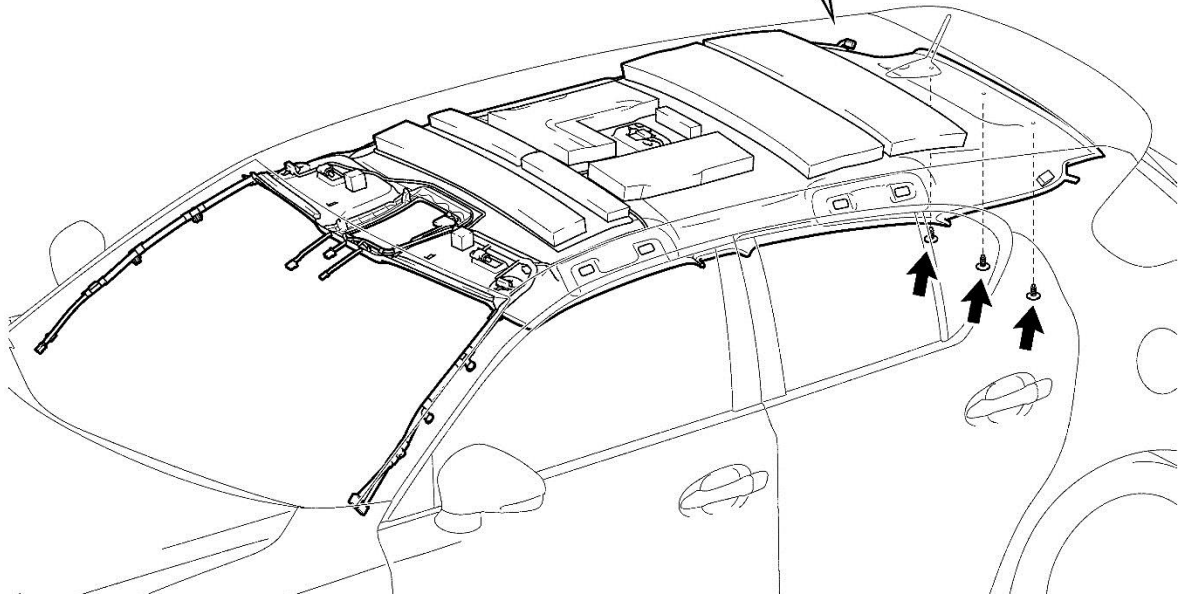
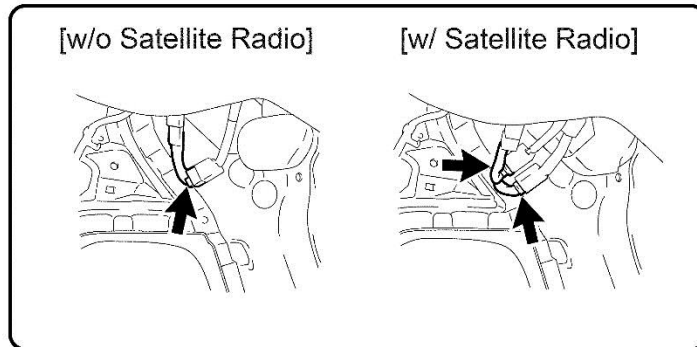

WITH SLIDING ROOF

d) Reconnect the electrical connectors and clips at the following locations as shown.

- Front Pillar Area
- Rear Pillar Area
- Roof Area

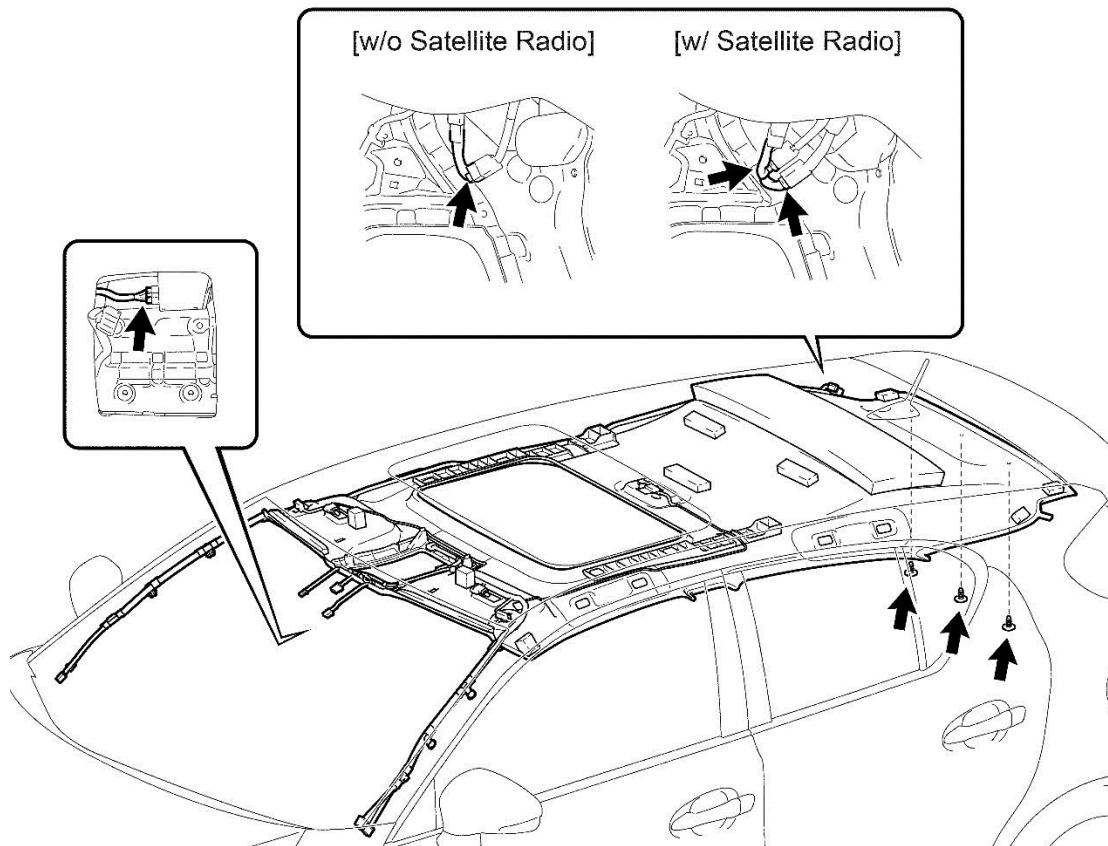

5. REMOVE PROTECTIVE MATERIAL

- Remove the instrument panel protective blanket.
- Remove the seat covers.
- Raise the front seat backs to the upright position and reinstall the head rest.
- Remove the rear wheel well protective covers.

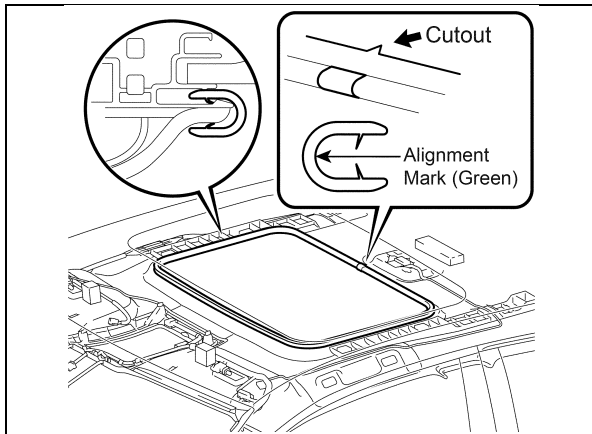

6. REINSTALL SLIDE ROOF MOLDING

- Align the green mark on the molding with the cut out in the roof headlining.
- Engage the molding completely around the opening ensuring that the corners fit correctly.

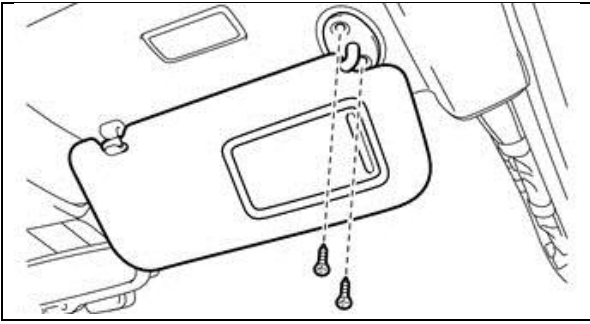

7. REINSTALL SUN VISORS

a) Reinstall the sun visor with the two screws.

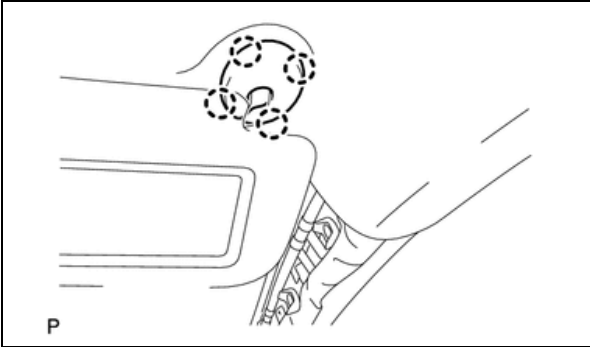

b) Reinstall the sun visor bracket by engaging the 4 claws.

c) Repeat procedure for other sun visor.

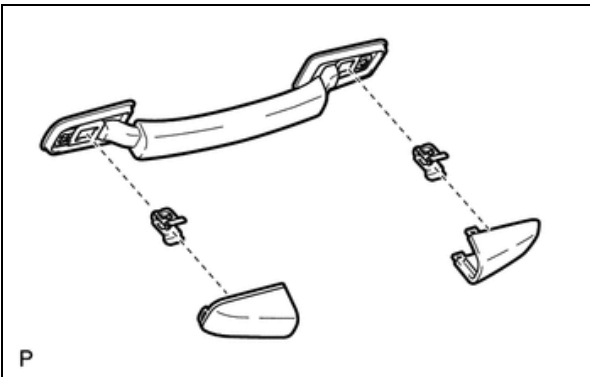

8. REINSTALL ASSIST GRIPS

a) Reassemble the assist grip with the 2 covers and 2 clips.

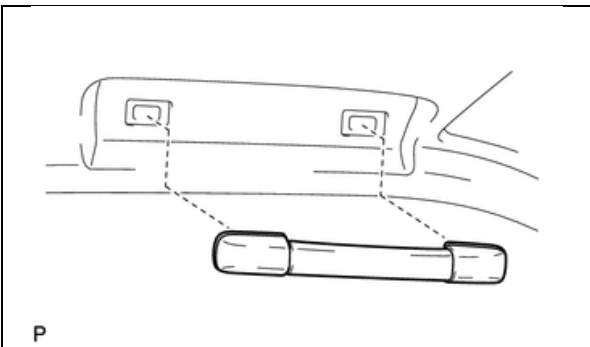

b) Reinstall the assist grip into the vehicle.

c) Use the same procedure for the other 3 assist grips.

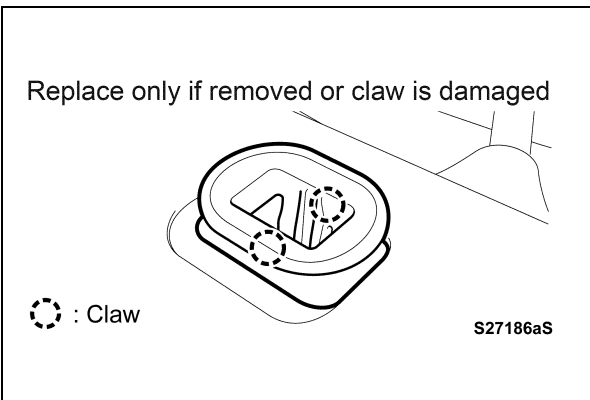

9. INSPECT THE REAR SEAT CUSHION LOCKS

a) Inspect the rear seat cushion locks to ensure they do not need to be replaced. Replacement should only be needed if one of the following occur:

- Lock assembly is remove during disassembly
- Retention claws are damaged during disassembly

NOTE: IT is anticipated that very few rear seat cushion locks will require replacement.

10. REINSTALL THE FOLLOWING COMPONENTS
[HEADLINER REINSTALLATION REPAIR MANUAL LINK](#)

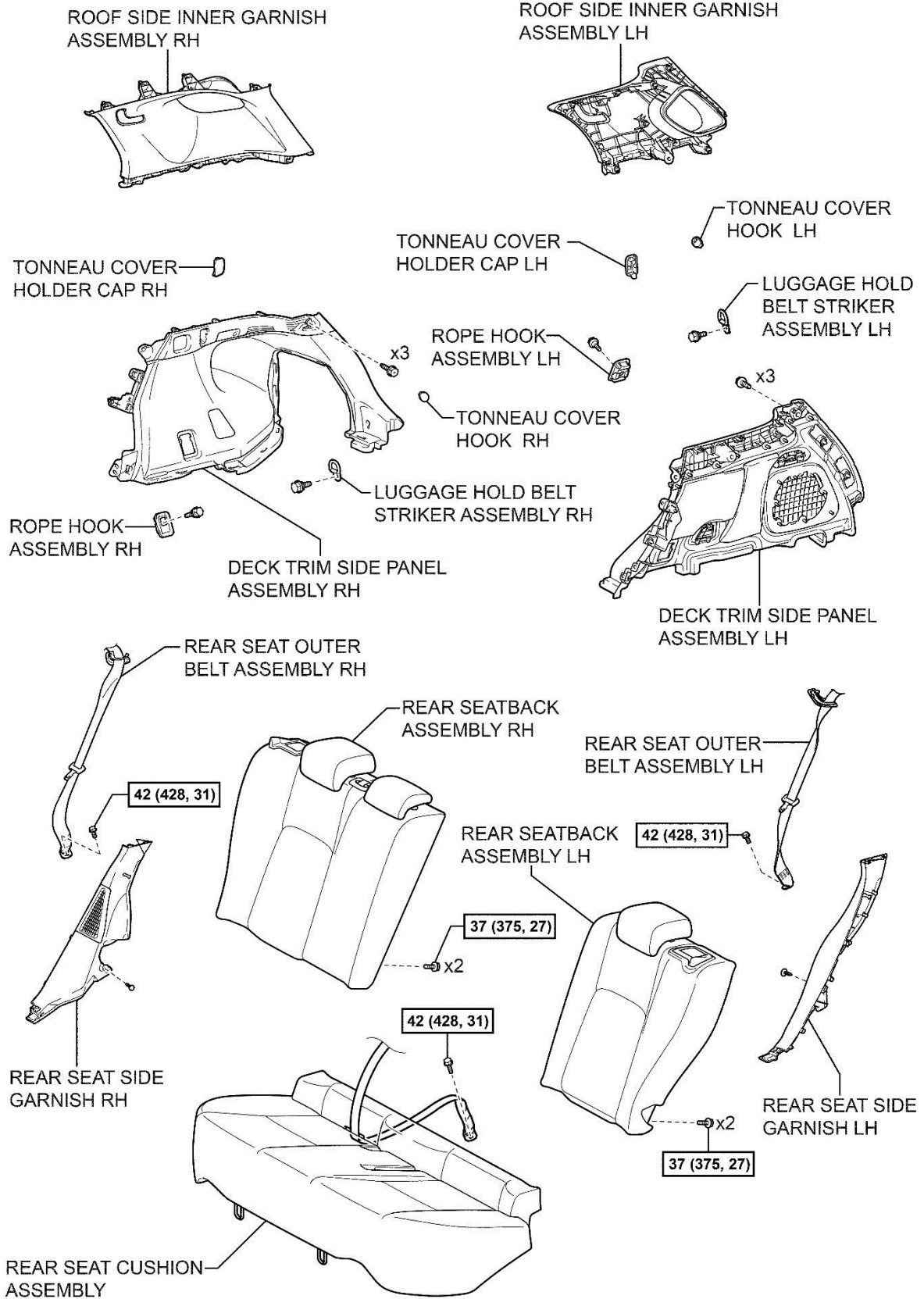

N*m (kgf*cm, ft.*lbf) : Specified torque

S27142aS

Component Reinstallation Continued...

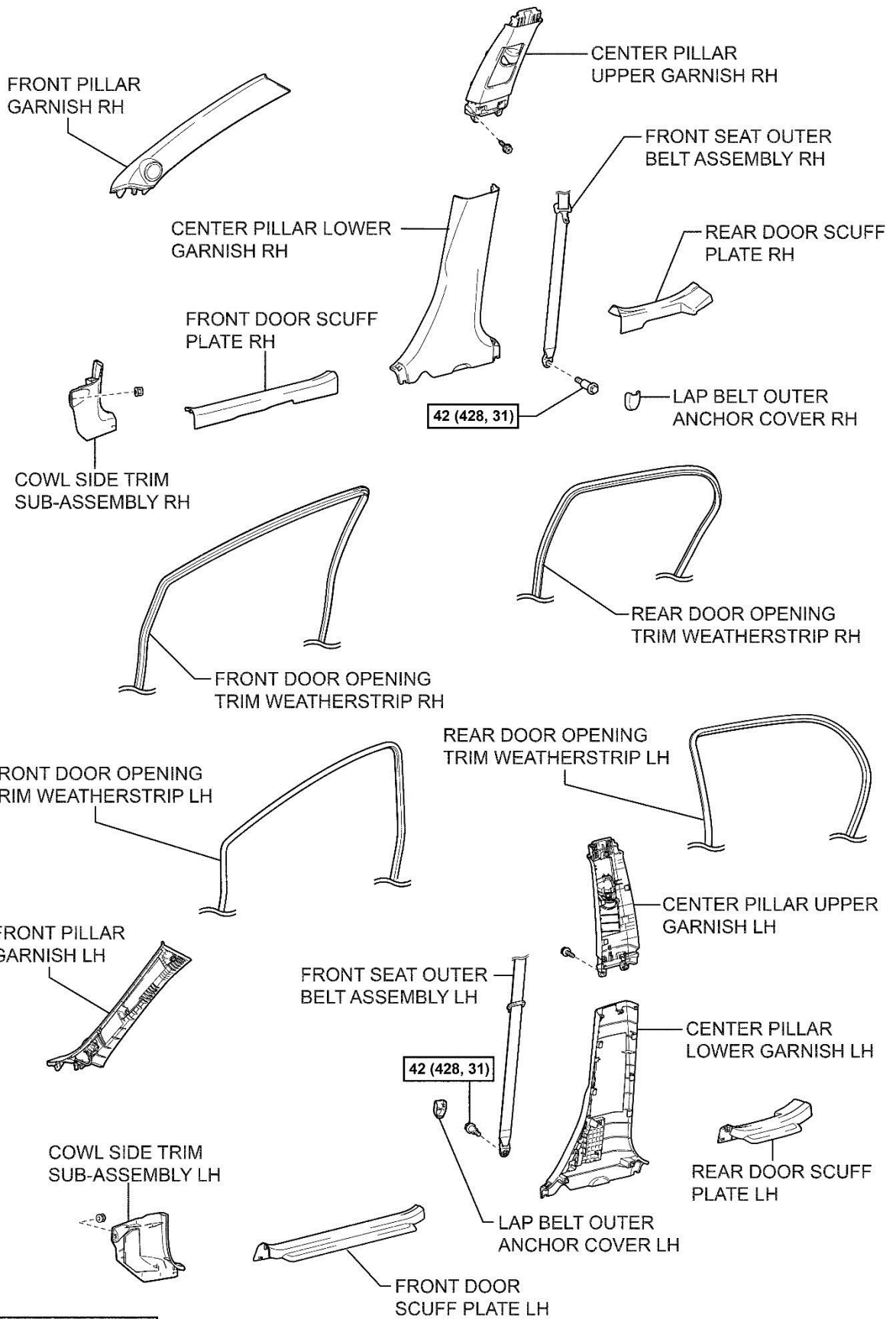

N*m (kgf*cm, ft.*lbf) : Specified torque

S27141aS

Component Reinstallation Continued...

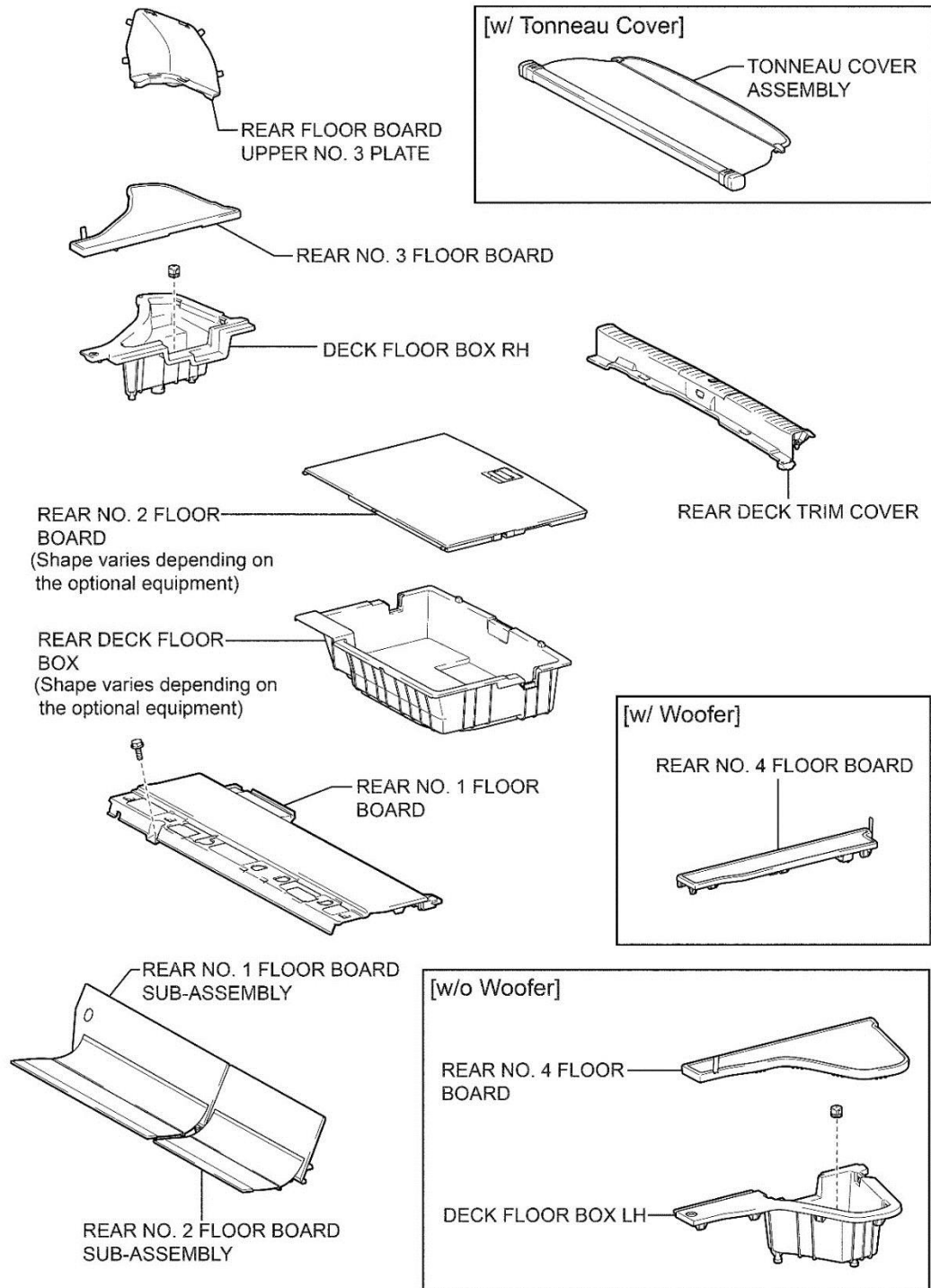

11. RESTORE SEAT POSITION
12. RESTORE CUSTOMER CLIMATE CONTROL SETTINGS
13. CONFIRM ALL INTERIOR COMPONENTS OPERATION
14. CHECK AND CLEAR ANY DTCS

◀ VERIFY REPAIR QUALITY ▶

- Confirm the interior temperature was reduced prior to disassembly
- Confirm the brackets are properly installed
- Confirm the interior settings are reset

If you have any questions regarding this update, please contact your area representative.