



Safety Action Recall Notice 534

Issue 1 - 03.2016

Subject: Fuel Tank Subharness				
Bulletin Number	Models Affected	VIN Range		Markets Affected
534	Street Twin	731919	739946	All Markets except Brazil
534	Bonneville T120	731919	739946	All Markets except Brazil

Background Information

Internal investigations have identified the need to replace a subharness in the fuel tank to prevent a potential fuel leak. This only affects subharnesses with the following batch codes; **X111540044** or **X111540060**. Dealers are required to check the batch code on the subharness label. If the batch code does not match the affected batch codes, then no further action is needed.

Dealers are required to replace the subharness if it matches the affected batch code.

Customer Contact Instructions

Notice

STOP DELIVERY OF AFFECTED MOTORCYCLES IMMEDIATELY.

DO NOT deliver a motorcycle affected by this Safety Recall Action Notice to a customer until you have completed, or confirmed completion of, the procedures described in this Safety Recall Action Notice.

Delivering a motorcycle subject to an outstanding Safety Recall Action Notice may contravene local or national laws in your market, territory or country.

Triumph subsidiaries and distributors must instigate a Safety Recall Action in their country in accordance with the national recall code of practice. For vehicles in dealer stock, the safety recall MUST be actioned before delivery to the customer.

Dealers are to prioritise repair of customer owned motorcycles before any unsold motorcycles.

Identification of Affected Motorcycles

Street Twin and Bonneville T120 models listed in the VIN ranges above.

Note:

- Some affected motorcycles listed in the VIN range will have been modified and repaired by Triumph prior to their release from the factory.
- The modified motorcycles can be identified by checking the 'Outstanding Service Bulletins' on Warranty Online.

Warranty Claim Instructions

Bulletin Number	Fault Code	Repair Code	Description	Repair Allowance	Time
534	02401299	995341	Check the batch code.	0,05 hours	
534	02401299	995342	Replace the subharness.	0,35 hours	

Genuine Parts Information

Bulletin Number	Part Number	Description	Quantity
534	T2401414	Subharness, Pump Plate	1
534	T2401214	Seal, Fuel Pump	1
534	T3350003	Lock Nut, Flanged, M6	1
534	T3500078	Circlip, Int Dia 81,4 x 1,2	1

Parts Ordering Instructions

For Triumph Subsidiary and Overseas Distributor dealers using Triumph Warranty On-Line with Parts Auto Ordering Flag switched on: Order all repair parts by submitting a New Prior through the Warranty On-Line system. Entering the above repair code in a New Prior will automatically add the parts required and labour times for this Service Bulletin.

For Overseas Distributor dealers NOT using Triumph Warranty On-Line or for Overseas Distributor dealers using Triumph Warranty On-Line with Parts Auto Ordering Flag switched off: Orders should be placed using the normal parts ordering procedure.

Genuine Parts Return

Dealer to retain parts for 90 days. All parts must be stored in a secure, non-public accessed area and correctly identified with a completed warranty label. Thereafter the parts must be rendered unusable prior to scrapping.

Other Instructions

Before returning the motorcycle to the customer, download the latest calibration to the engine control module using the current version of the Triumph diagnostic software.

Once completed, please mark the customer's Service Record Book that the requirements of the Safety Recall Action Notice have been complied with.

Procedures

Before completing the procedures, read the following warnings.

Warning

Petrol (gasoline) is highly flammable and can be explosive under certain conditions. When opening the fuel tank cap always observe all the following items:

Turn the motorcycle ignition switch OFF.

Do not smoke.

Always have a fire extinguisher containing FOAM, CO₂, HALON or POWDER close at hand when handling or draining fuel or fuel systems. Fire extinguishers must also be present in areas where fuel is stored.

Always disconnect the vehicle battery, negative (black) lead first, before carrying out, dismantling or draining work on a fuel system.

Whenever petrol (gasoline) is being handled, drained, stored or when fuel systems are being dismantled, make sure the area is well ventilated. All potential forms of ignition must be extinguished or removed (this includes any appliance with a pilot light). Any lead-lamps must be flame-proof and kept clear of any fuel spillage.

Warning notices must be posted at a safe distance from the site of the work to warn others that petrol (gasoline) is being openly handled. The notice must instruct the reader of the precautions which must be taken.

Failure to observe any of the above warnings may lead to a fire hazard which could result in personal injury.

Warning

No one should be permitted to repair components associated with petrol (gasoline) without first having specialist training on the fire hazards which may be created by incorrect installation and repair of items associated with petrol (gasoline). Repairs carried out by untrained personnel could bring about a safety hazard leading to a risk of personal injury.

Warning

Draining or extraction of petrol (gasoline) from a vehicle fuel tank must be carried out in a well ventilated area.

The receptacle used to contain the petrol (gasoline) must be more than adequate for the full amount of fuel to be extracted or drained. The receptacle should be clearly marked with its contents, and placed in a safe storage area which meets the requirements of local authority regulations.

When petrol (gasoline) has been extracted or drained from a fuel tank, the precautions governing naked lights and ignition sources should be maintained.

Failure to observe any of the above warnings could bring about a safety hazard leading to a risk of personal injury.

Checking the Batch Code

Complete the checks as described in the procedure detailed below.

Warning

Throughout the following procedure, make sure that the motorcycle is stabilised and adequately supported to prevent the risk of injury from the motorcycle falling.

1. Remove the seat. Refer to the Street Twin or Bonneville T120 Service Manual.
2. Remove the fixings securing the rear of the fuel tank to the frame. Discard the lock nut.

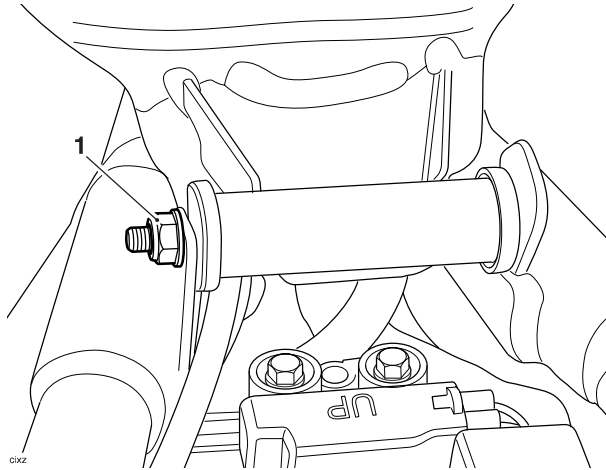

1. Fixings

⚠ Caution

Take care when raising the fuel tank as damage, particularly to the painted surfaces could result from inadequate care and/or protection during this process.

3. Raise the fuel tank upwards at the rear to view the subharness.

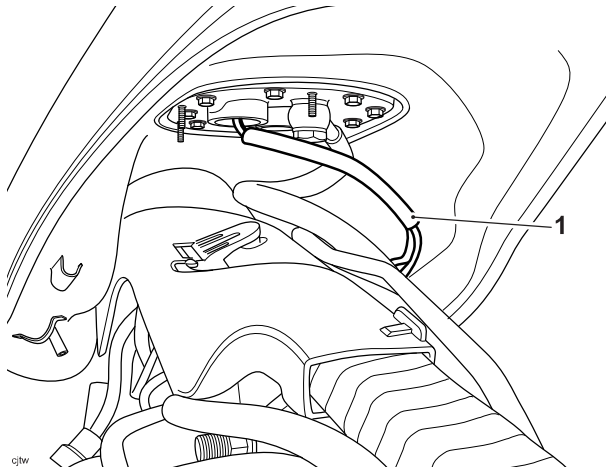

1. Batch code label

4. Check the batch code label on the subharness.
5. If the batch code on the label is **X111540044** or **X111540060** then replace the subharness following the Replacing the Subharness procedure in this Safety Recall Action Notice.
6. If the batch code on the subharness does not match the affected batch codes, then no further action is needed.
7. Lower the tank into position making sure the breather pipe is not trapped.
8. Renew the lock nut and refit the fixings. Tighten the rear fuel tank mounting bolt to 8 Nm.
9. Refit the seat. Refer to the Street Twin or Bonneville T120 Service Manual.

Replacing the Subharness - Removal

Complete the replacement as described in the procedure detailed below.

Note:

- Only replace the subharness if the batch code shown on the batch code label is **X111540044** or **X111540060**.

⚠ Warning

Throughout the following procedure, make sure that the motorcycle is stabilised and adequately supported to prevent the risk of injury from the motorcycle falling.

1. Remove the seat. Refer to the Street Twin or Bonneville T120 Service Manual.
2. Disconnect the battery, negative (black) lead first. Refer to the Street Twin or Bonneville T120 Service Manual.

⚠ Warning

Never drain fuel from the tank using non-approved, non-professional standard fuel handling equipment. A fire causing destruction of property and injury to persons may result from use of non-approved fuel handling equipment.

3. Using propriety professional automotive workshop equipment approved for fuel handling, drain all fuel from the fuel tank.
4. Remove the fuel tank. Refer to the Street Twin or Bonneville T120 Service Manual.
5. Remove the fuel pump assembly. Refer to the Street Twin or Bonneville T120 Service Manual.
6. Remove the electrical connector from the fuel pump.

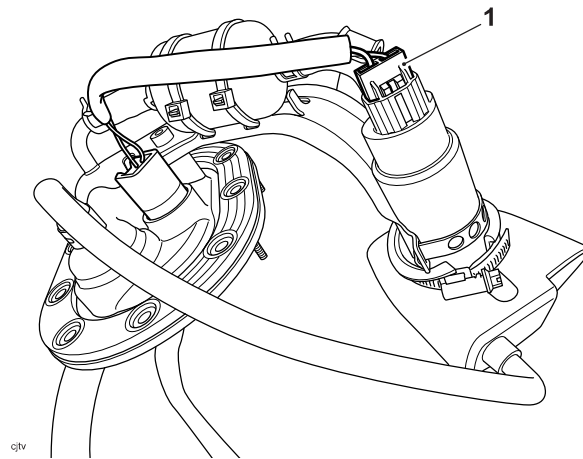

1. Electrical connector

7. Remove the circlip from the fuel pump plate.
8. Remove the subharness from the fuel pump plate.

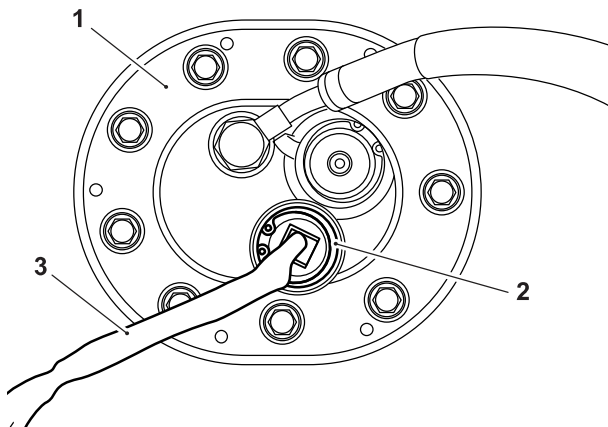

- 1. Fuel pump mounting plate
- 2. Circlip
- 3. Subharness

Replacing the Subharness - Installation

1. Fit the new subharness and connect the electrical connectors. Attach a new circlip as noted for removal.
2. Refit the fuel pump assembly to the fuel tank. Refer to the Street Twin or Bonneville T120 Service Manual.
3. Refit the fuel tank. Refer to the Street Twin or Bonneville T120 Service Manual.
4. Refill the fuel tank with the fuel drained during removal, and check carefully for fuel leaks.
5. Reconnect the battery, positive (red) lead first and tighten the terminals to 4.5 Nm. Refer to the Street Twin or Bonneville T120 Service Manual.
6. Refit the seat. Refer to the Street Twin or Bonneville T120 Service Manual.

Circulation

Initial and date when read and return to central file holder

Service Manager	Parts Manager	Sales Manager	Workshop Supervisor	Technician 1	Technician 2