



# SAFETY RECALL BULLETIN

NHTSA Recall No. 16V-028; Transport Canada Recall No. 2016-030

AUTOCAR, LLC SAFETY RECALL ACX-1601

March, 2016

## Attention:

Service Managers/Parts Managers

## Subject:

Autocar has determined that a safety defect exists in the brake pedal assembly of certain 2013-2016 model-year dual-drive, right-hand-stand-up Xpeditors.

## Safety Recall Information:

This document provides work instructions to ensure that the brake pedal pivot assembly will not become disengaged while the vehicle is operational.

## Vehicles Affected:

There are 1028 affected units assembled after August 15, 2012. Refer to the VIN list beginning on page 6.

## Service Responsibility:

Service sites must perform this recall on affected vehicles at no charge to the owner regardless of vehicle mileage, age or ownership. If a vehicle affected by this recall is taken into or is currently in your vehicle inventory, or at your center for service, you must perform this recall before the vehicle is sold or released to the owner.

## Required Parts:

- (1) S7200007K001 Brake Pedal Spacer and Ring Kit
- (1) GZ160004-001 Locking Cotter Pin
- (1) GZ070020-001 Spacer

## To Obtain Parts:

**DO NOT submit a Solutions ticket.**

Send an e-mail to:

warranty@autocartruck.com

And include the following:

- VIN(s) (or last 6 digits of VIN(s))
- 'Attention To' name
- 'Ship To' address

## Claims for Reimbursement:

Submit a claim for reimbursement in accordance with Autocar's Warranty Administration Manual.

## Claim Coding Information:

Labor Operation Code Number	Time Allowance SRT	Description
52490-0-04	1.0 HR	Brake Pedal Alteration

## Tools Required:

Standard screw driver

Needle-nose pliers

# SAFETY RECALL BULLETIN

NHTSA Recall No. 16V-028; Transport Canada Recall No. 2016-030

AUTOCAR, LLC SAFETY RECALL ACX-1601

March, 2016

## Safety Notices



### WARNING

To prevent eye injury, always wear eye protection when performing vehicle maintenance, service or inspection.



### WARNING

Before working on a vehicle, set the parking brake, place the transmission in neutral and block the wheels. Failure to do so can result in unexpected vehicle movement and can cause serious personal injury or death.



### WARNING

Autocar natural gas powered vehicles require specific compliance in the service, storage and refueling procedures.

If you store or dispense Compressed Natural Gas (CNG) or Liquid Natural Gas (LNG), or if you work on CNG or LNG trucks, your location must be fully compliant with applicable codes, regulations and standards, including National Fire Protection Association (NFPA) codes, Society of Automotive Engineers (SAE) standards, American National Standards Institute (ANSI), Natural Gas Vehicle (NGV) standards, the United States Code of Federal Regulations (CFR), and your state and local fire and other applicable codes (including the California Code of Regulations and the Texas Administrative Code, as applicable).

Contact your local fire department for guidance and additional compliance information. Technicians working on Autocar trucks with CNG or LNG engines must be trained in the proper repair of CNG and LNG engines and the safe storage and dispensing of CNG and LNG.

# SAFETY RECALL BULLETIN

NHTSA Recall No. 16V-028; Transport Canada Recall No. 2016-030

AUTOCAR, LLC SAFETY RECALL ACX-1601

March, 2016



### CAUTION

#### LOCKOUT/TAGOUT PROCEDURES

Before entering the vehicle or vehicle body, read and follow OSHA regulations concerning entry and working in "CONFINED SPACE" OSHA 1910.146 and "LOCKOUT/TAGOUT" OSHA 1910.147. Follow OSHA regulations while performing any work on the vehicle. The vehicle must be disabled by the following steps before performing any work on the vehicle:

1. Place the transmission in NEUTRAL.
2. Set the parking brake.
3. Shut the engine OFF.
4. Lock cab doors, keep the key in your pocket. Block the wheels before entering the body or performing any work on the vehicle.
5. Turn the battery disconnect switch OFF, if equipped.
6. Completely drain the air from the primary/A system and secondary/B system by opening the drain valves on the air tanks themselves or by using the drain manifold if supplied. When draining the air tanks, do not look into the area where air is draining. Dirt or sludge particles may be expelled in the air stream and can cause eye injury.
7. Place magnetic "DANGER" signs on both cab doors before entering the body or performing any work on the vehicle.
8. Take proper precautions before working under the vehicle. Use ramps approved for the weight of your vehicle, or use floor jacks and stands. Never work under a vehicle supported by jacks alone. Always use jack stands to support the vehicle.

# SAFETY RECALL BULLETIN

NHTSA Recall No. 16V-028; Transport Canada Recall No. 2016-030

AUTOCAR, LLC SAFETY RECALL ACX-1601

March, 2016

## PROCEDURE:

1. Locate the brake pedal (this recall covers dual-drive, right-hand stand-up brake pedal assemblies only) (See Figure 1).

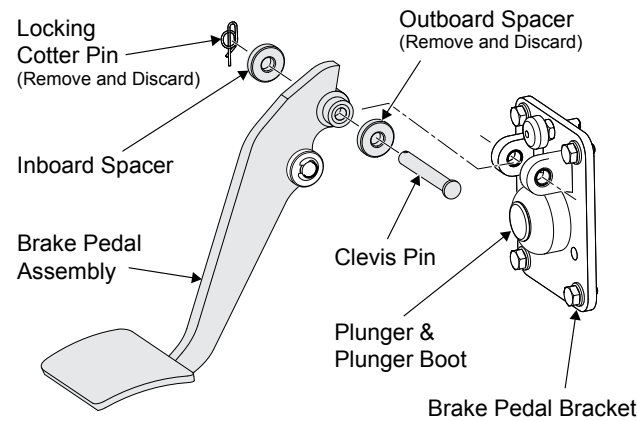

Figure 1

2. Using a standard screw driver and needle-nose pliers, remove the locking cotter pin, and discard (See Figure 2).
3. Remove the inboard spacer and set aside for reinstallation (See Figure 2).

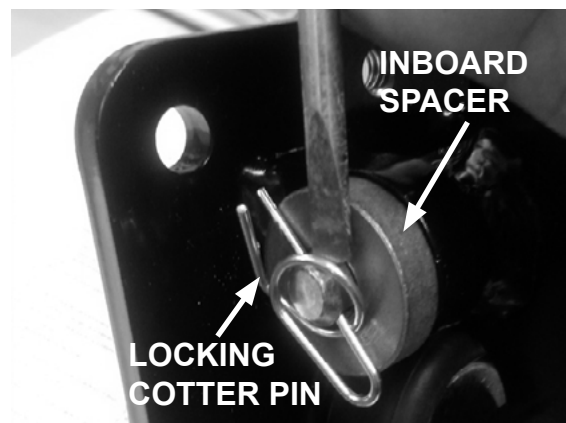

Figure 2

4. Remove the clevis pin, outboard spacer and brake pedal assembly. Set aside the clevis pin and brake pedal assembly for reinstallation and discard the outboard spacer (See Figure 1).
5. Install the new outboard spacer (GZ070020-001) onto the clevis pin (See Figure 3).
6. Align the brake pedal assembly with the brake pedal bracket and reinstall the clevis pin with the new outboard spacer.
7. Reinstall the inboard spacer that was removed in step 3 (See Figure 3).

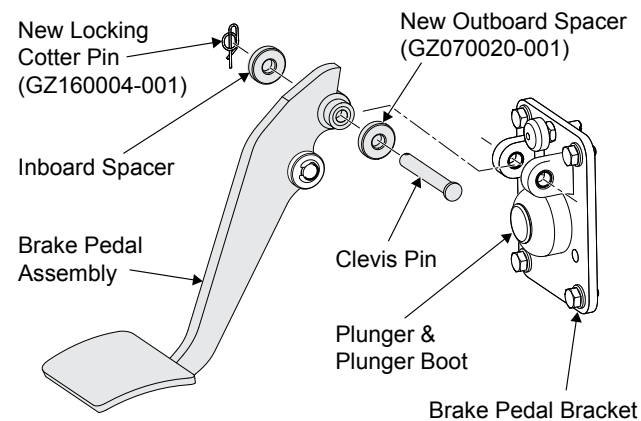

Figure 3

# SAFETY RECALL BULLETIN

NHTSA Recall No. 16V-028; Transport Canada Recall No. 2016-030

AUTOCAR, LLC SAFETY RECALL ACX-1601

March, 2016

8. Install the new locking cotter pin (GZ160004-001), making sure that it is fully engaged over the tip of the clevis pin (See Figure 4).

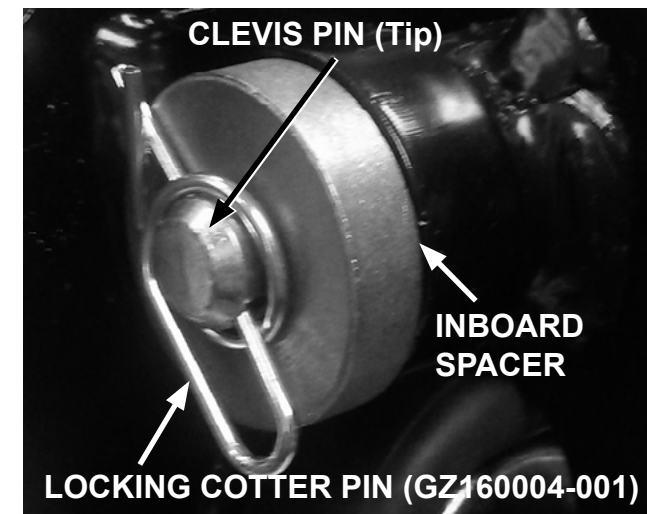

Figure 4

9. Perform a functional test by depressing and releasing the brake pedal several times to verify that the brake pedal is operating correctly.
10. Perform a short test drive to verify the brake pedal is functioning properly.
11. If no defects are found, the procedure is complete.