



October 11, 2016

IMPORTANT SAFETY RECALL NOTICE: 16V-569

IMPORTANT SAFETY RECALL

This notice applies to your vehicle(s) VIN:

Dear KME Chassis Owner:

This notice is sent to you in accordance with the requirements of the National Traffic and Motor Vehicle Safety Act. KME has decided that a defect which relates to motor vehicle safety exists in certain emergency vehicles equipped with Waterous C20 and C21 split shaft transmissions. We have received information from the Waterous Company that your truck may have a PTO that is the subject of a recent OEM, recall 16E-059.

Why is a recall being conducted?

Based on NHTSA recall 16E-059, issued by Waterous Company,

"Waterous Company has decided that a safety related defect may exist in certain model C20 and C21 split-shaft transmissions and model TC20 and TC21 PTO split-shaft transmissions manufactured from April 9, 2015 to April 20, 2016. This condition could potentially result in the inability to shift the apparatus from road to pump mode."

What are we doing about the problem?

Per attached NHTSA recall 16E-059, issued by Waterous Company,

"Waterous will provide a free remedy which consists of removing the shift unit assembly in the affected split-shaft transmission and replacing the shift unit's clevis pin and retaining rings with a shoulder bolt and locking nut. Detailed instructions for proceeding with the free remedy are enclosed. It will take approximately one hour of service time to perform the remedy."

This Safety Recall is expected to start on or before October 14, 2016.



What should you do?

Please contact Chris Morrison at the information provided below in order to make arrangements to have your vehicle scheduled for inspection.

After the repairs are complete, please fill in the appropriate information on the enclosed Owner Response Postcard, sign it, and mail it to: KME, One Industrial Complex, Nesquehoning, PA 18240.

What if you no longer own this vehicle?

If you are not the current owner of the vehicle, please indicate this on the Owner Response Postcard and return the card to us.

Federal law requires any lessor who receives a notification of a safety related defect or noncompliance pertaining to any leased motor vehicle shall send the notice to the lessee within 10 days. If you are no longer the owner of this vehicle, please provide us with any contact information so we may contact the new owner.

If you have already paid to have your vehicle repaired for this condition, you may be eligible for reimbursement of the charges you paid for the repair or replacement of components. If after having attempted to take advantage of this recall you believe you have not been able to have your vehicle remedied without charge and within a reasonable amount of time, you may submit a complaint to the Administrator, National Highway Traffic Safety Administration, 1200 New Jersey Ave., S.E., Washington, D.C., 20590; or call the toll-free Vehicle Safety Hotline at 1-888-327-4236 (TTY: 1-800-424-9153); or go to <http://www.safercar.gov>.

We apologize for any inconvenience this safety recall may cause, but your safety is our first concern.

Sincerely,

KME Inc

Attached: [Waterous NHTSA Recall 16-E059]



Form No.	Issue Date	Rev. Date
I-2131	7/6/16	

K 1216

Pneumatic Shift Unit Clevis Pin Retrofit Kit Instructions NHTSA Recall 16E059

Consists of the following:

Part Number	Description	Qty
53322	Shoulder - Bolt, 1/2" x 1-1/4"	1
W3729-3	O-ring, 2"	1
W79006	Locknut – FlexTop, 3/8-16 UNC	1

Index:

Description	See Page
Clevis Pin Retrofit Instructions	2-6
Certificate of Remedy and Disposal	7

Pneumatic Shift Unit Clevis Pin Retrofit Kit Instructions

WARNING

Rotating Parts Hazard or Unexpected Truck Movement. May result in serious personal injury or death.

Stop the engine, set parking brake and chock the wheels before attempting to remove or repair the transmission.

1. Disconnect wiring harness, air lines, and manual override linkage (if equipped). This may not be required if air lines and harness allow clevis modification without removal.

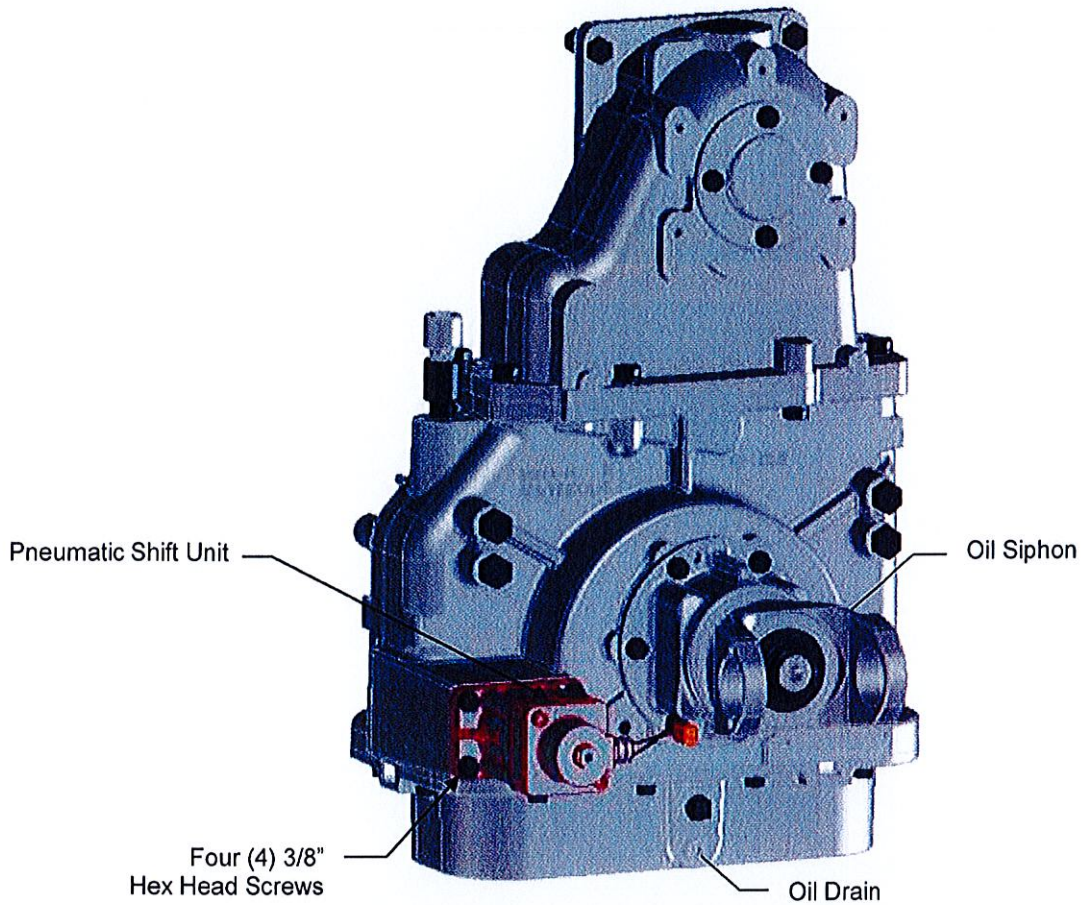

2. Drain or siphon the case lubricant below shift unit level (approximately 3.25 qts / 3.075 liters)

Pneumatic Shift Unit Clevis Pin Retrofit Kit Instructions

3. Place shift unit in ROAD mode by pushing override rod in.
4. Remove the four (4) 3/8-16 x 1 in. mounting screws and washers.
5. Pull shift unit straight back as far as possible.
6. Rotate shift unit towards case to disengage clevis from shift fork.

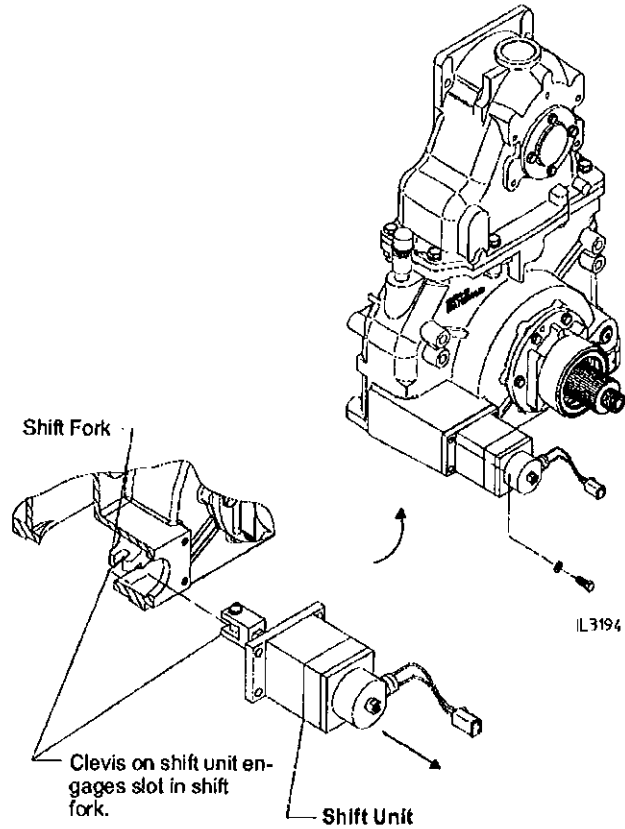

7. Record the shift unit date code stamped into the back of the shift unit as shown below and enter into Certificate of Remedy and Disposal.

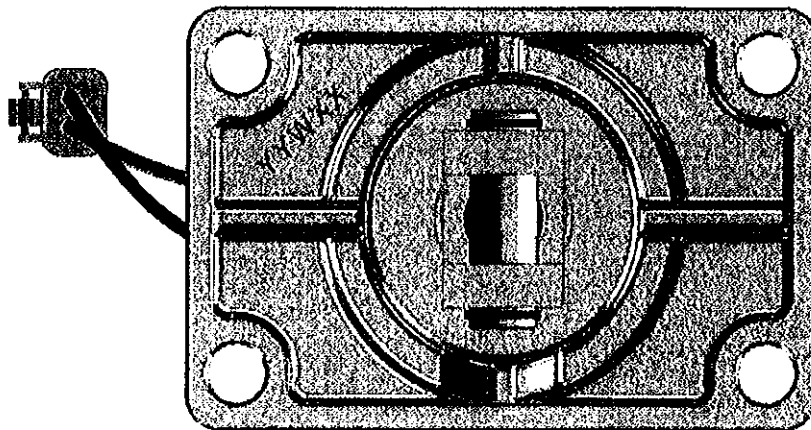

Pneumatic Shift Unit Clevis Pin Retrofit Kit Instructions (con't)

8. Remove one retaining ring from the clevis pin and remove pin as shown below.

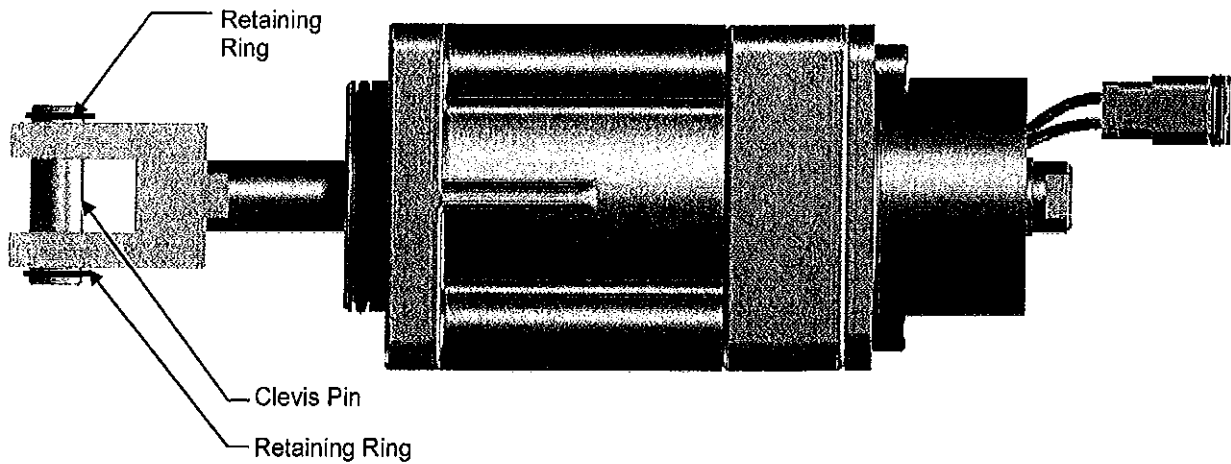

9. Remove and replace shift unit O-ring, coating O-ring with grease upon replacement.
10. Install shoulder bolt and locknut as shown below. Head of shoulder bolt must be on top. Torque to 170 inch-lbs. / 19.2 Nm.

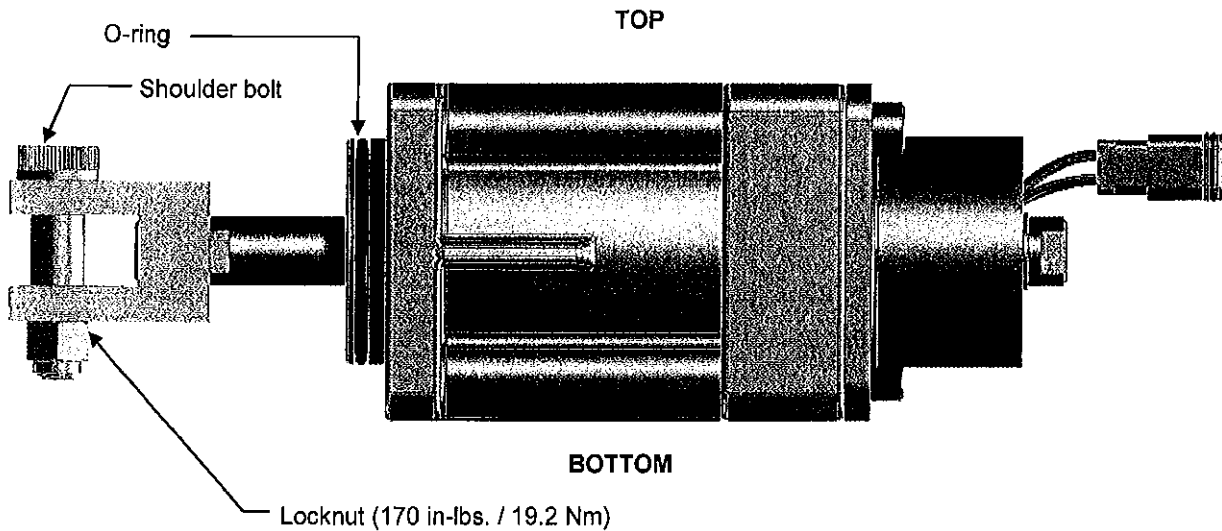

Pneumatic Shift Unit Clevis Pin Retrofit Kit Instructions (con't)

11. Place shift unit in ROAD mode by pushing override rod in.
12. Place shift fork in PUMP mode by pulling fork arm towards end of case where the shift unit mounts.
13. Rotate shift unit towards case and engage clevis in shift fork slot.
14. Push shift unit straight back in until flange contacts case.
15. Install four (4) 3/8-16 x 1 in. screws and lockwashers. Torque to 31 lb-ft/42 Nm.

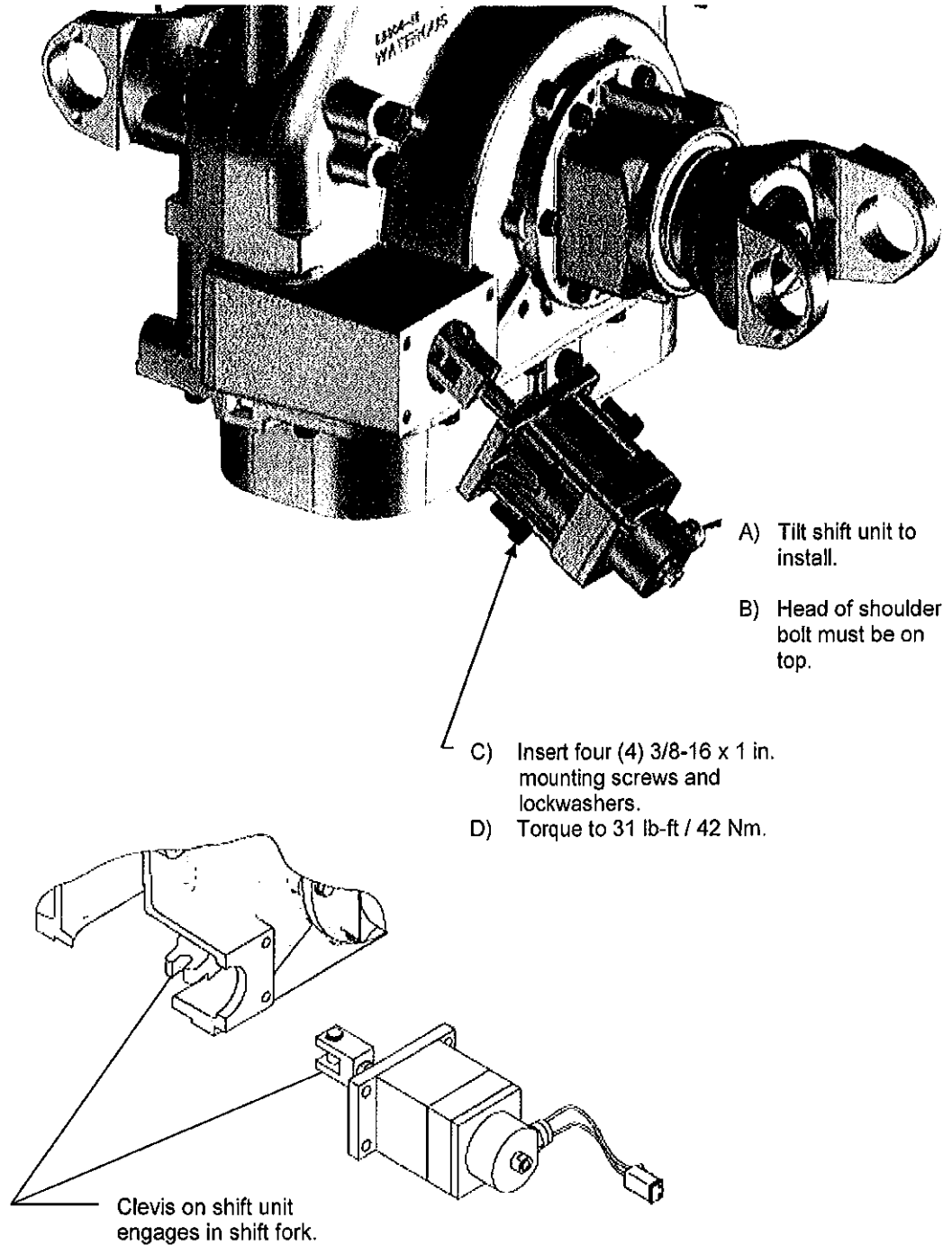

Pneumatic Shift Unit Clevis Pin Retrofit Kit Instructions (con't)

16. Refill case lubricant to proper level.
 - a. Fill the transmission through the oil level hole or by removing the breather and adding fluid through the opening. Any type of automatic transmission fluid (ATF) may be used. Capacity is approximately 6 quarts. Fill to the bottom of the threads in the oil level port.
 - b. Re-check all fasteners for tightness.
 - c. Check for fluid checks.

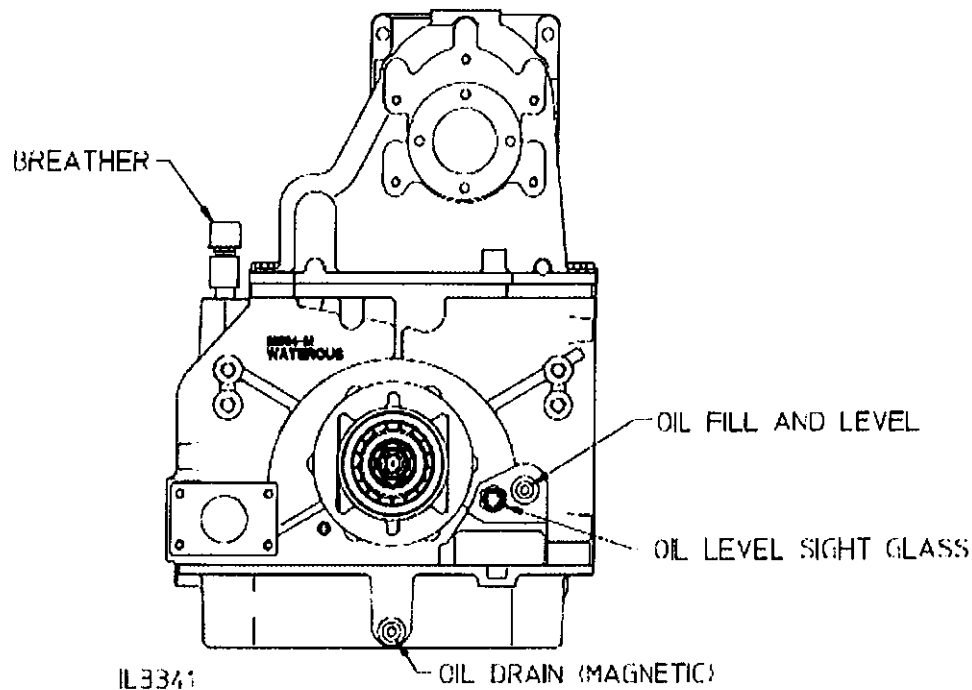

17. Reconnect wiring harness, air lines and manual override linkage (if equipped), if removal was required.
18. Operate shift unit to test actuation and pump engaged light.
19. Complete the Certificate of Remedy and Disposal and fax to Waterous Company at +1(651) 450-5090 or email to service@waterousco.com



Waterous Company
125 Hardman Avenue South
South St. Paul, MN 55075

**Certificate of Remedy and Disposal
Clevis Pin and Retaining Rings
NHTSA Recall 16E059**

REPAIR FACILITY NAME: _____

ADDRESS: _____

CITY: _____

STATE: _____ ZIP: _____

CONTACT NAME: _____

CONTACT TITLE: _____

CONTACT DAYTIME PHONE NUMBER: _____

CONTACT EMAIL ADDRESS: _____

I hereby certify the NHTSA 16E059 remedy has been performed as directed and the clevis pin and retaining rings for the unit identified below have been discarded.

PRINT NAME: _____

SIGNATURE: _____

DATE SUBMITTED: _____

Pump Transmission Serial Number	Shift Unit Date Code*

* The shift unit date code is the 5 character code (YY W XX) on the front surface mounting flange.

NOTICE: Please fax this completed document to Waterous Company at +1(651) 450-5090 or email to service@waterousco.com.

Questions: Contact Mark Blake at +1(651) 450-5067 or e-mail at mablake@waterousco.com.