



Volvo Car Customer Service

TJ 31955

Title	Climate unit drain hose	Page	1 (11)
Action	Inspection	Operation number:	98635-2

Issue	Date	Reason
1	2016-09	First issue

Affected vehicles

Model year	Model
2017	S90 (17-)
2016, 2017	XC90 (16-)

Equipment

Designation	Part No.
Interior trim remover	

Orientation view



XC90



S90



V90

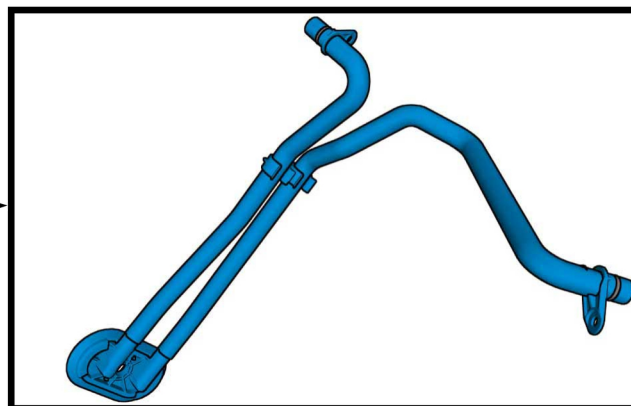
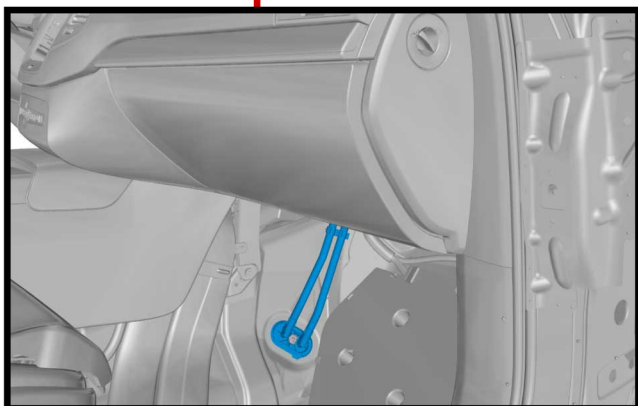

Color symbols

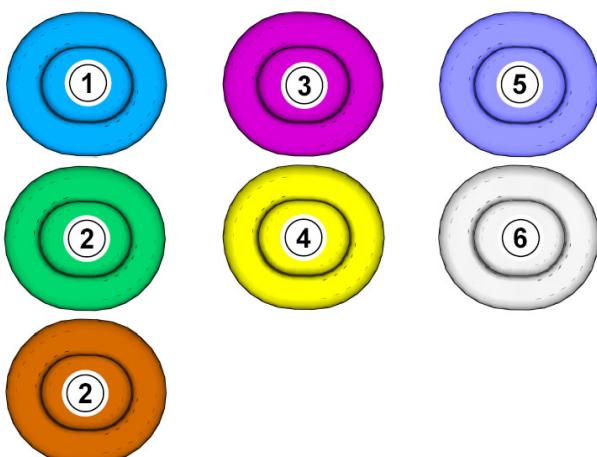

Note! This colour chart displays (in colour print and electronic version) the importance of the different colours used in the images of the method steps.

- 1 . Used for focused component, the component with which you will do something.
- 2 . Used as extra colors when you need to show or differentiate additional parts.
- 3 . Used for attachments that are to be removed/installed. May be screws, clips, connectors, etc.
- 4 . Used when the component is not fully removed from the vehicle but only hung to the side.
- 5 . Used for standard tools and special tools.
- 6 . Used as background color for vehicle components.

Applies to the passenger side

Removal

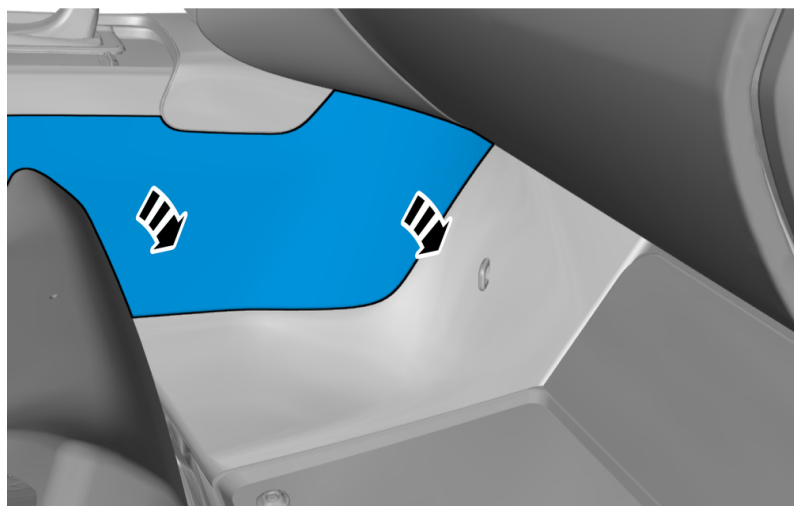

Remove the part carefully
Remove the panel.

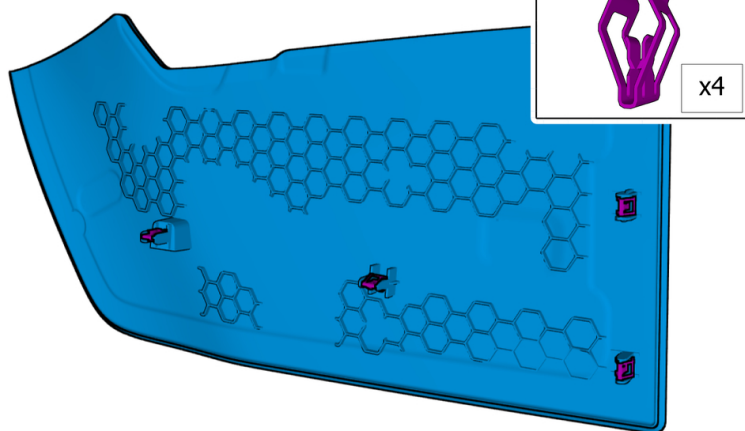

The graphic shows the back of the component.

Remove passenger side sill moulding front ,
refer to:

Removal, replacement and installation
8 - Body and interior
84 - Exterior trim, glass, weatherstrips
845 - sealing and protect. molding for
door, lid, and side window

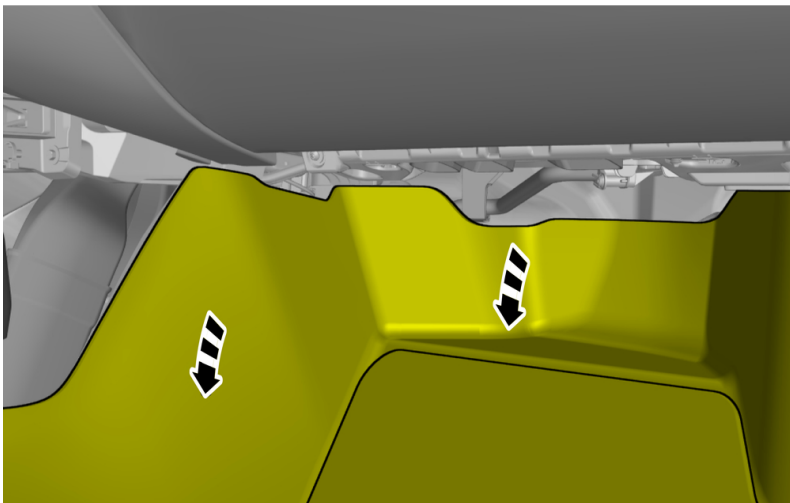

Remove the part carefully
Fold the carpet to the side.

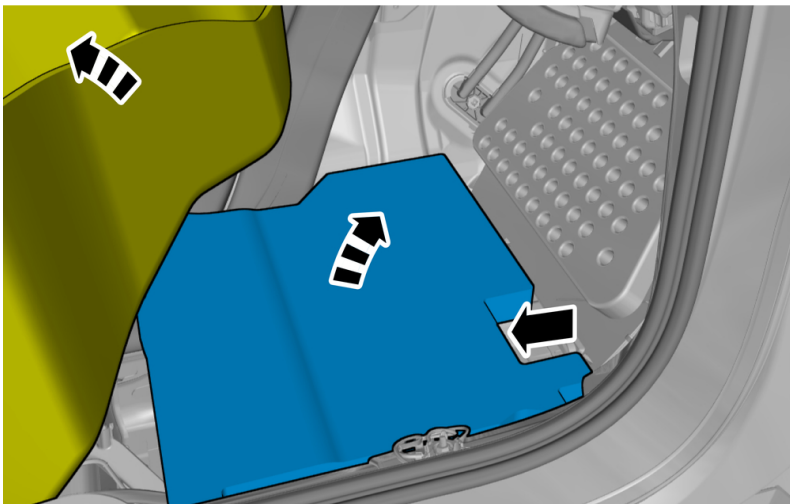

Caution! Make sure that the component is positioned correctly.

Fold the carpet to the side.
Remove the part carefully
Remove the marked part.

Check

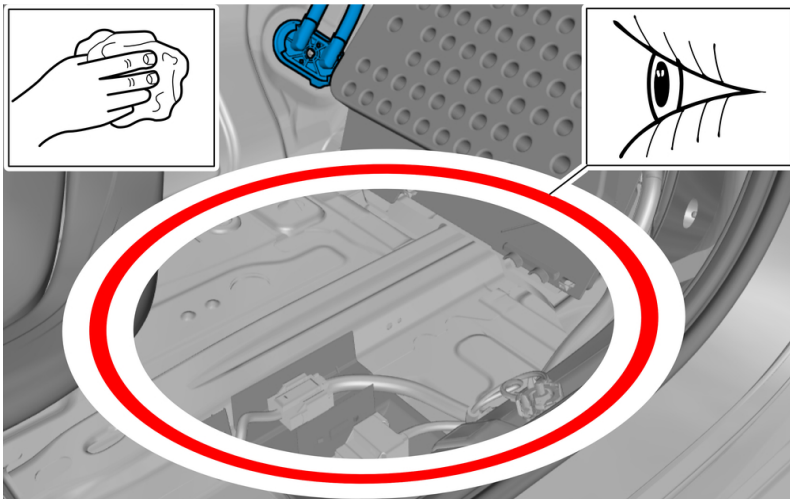

Note! Check for moisture in the area indicated.

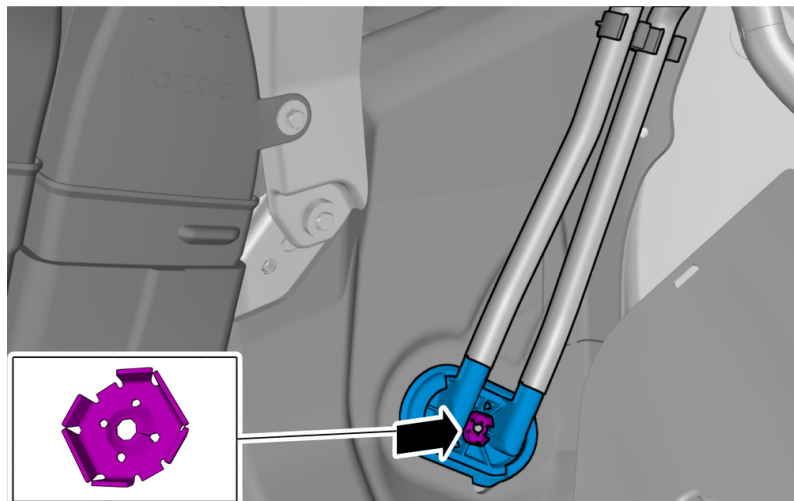

Remove the nut.

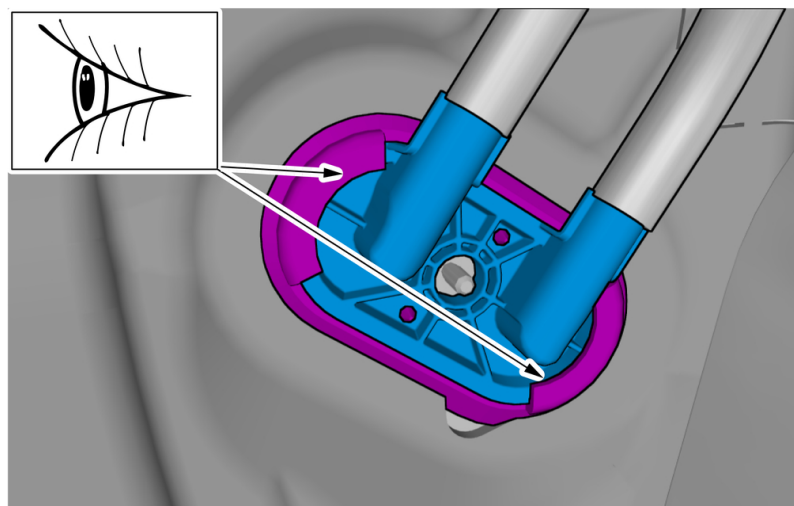

Caution! The grommet seal must rest on the metal surface, not on the carpet.

Note! Make sure that the seal is correctly located.

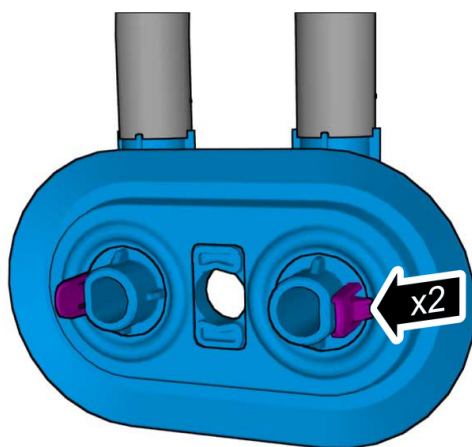

The graphic is just to show the back of the component and the location of the tabs. The component does not need to be removed if it is already correctly installed.

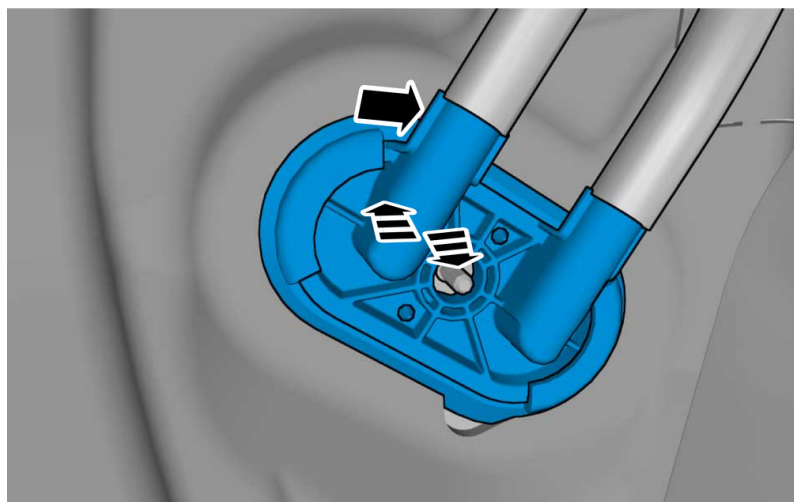

Check that the rubber grommet is not loose:
1 -First grab the hose connection and press inwards. 2 -Then pull outwards. 3 -Again push inwards.

If no faults are detected, to install, reverse the removal procedure.

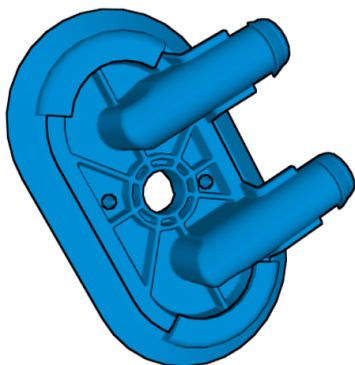

If the result of the checking procedure is not OK, the component must be replaced with a new component.

Applies to the driver's side

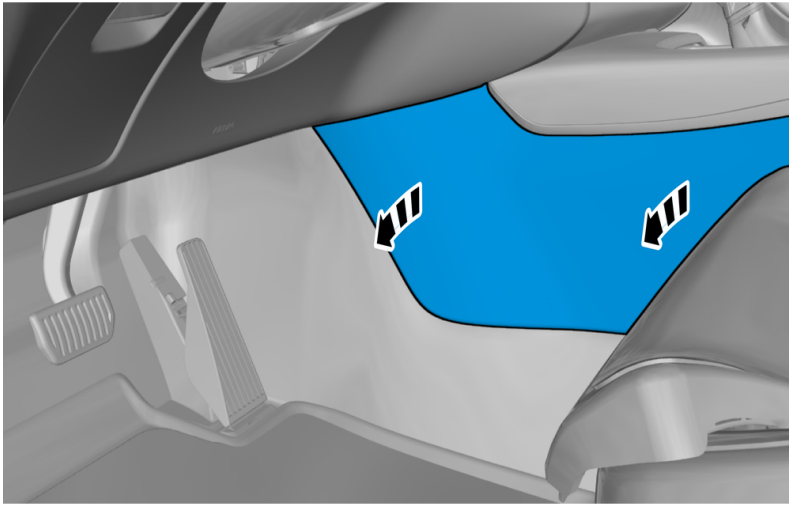

Remove the part carefully
Remove the panel.

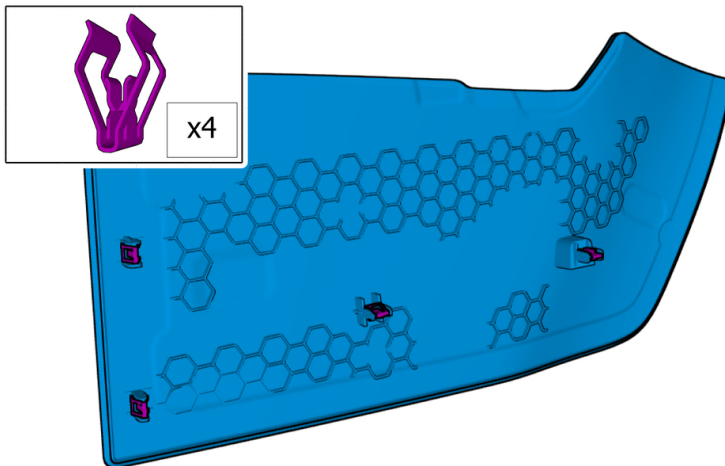

The graphic shows the back of the component.

Remove driver side front sill trim panel , refer to:

- Removal, replacement and installation
- 8 - Body and interior
- 84 - Exterior trim, glass, weatherstrips
- 845 - sealing and protect. molding for door, lid, and side window

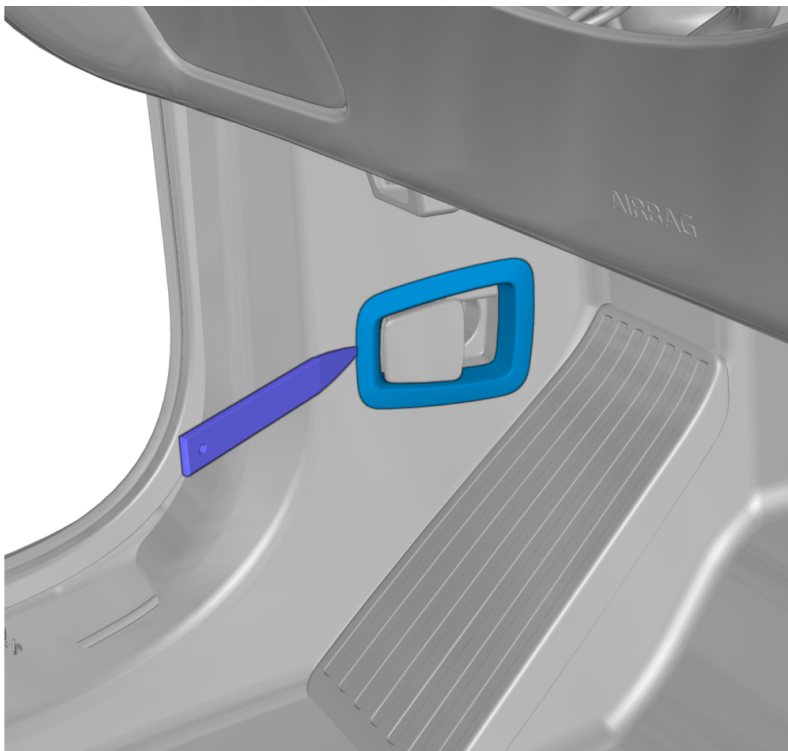

Remove the part carefully

Use: Interior trim remover

Remove the marked part.

Remove accelerator pedal , refer to:

Removal, replacement and installation

2 - Engine with mountings and equipment

27 - Engine control

271 - gas pedal control

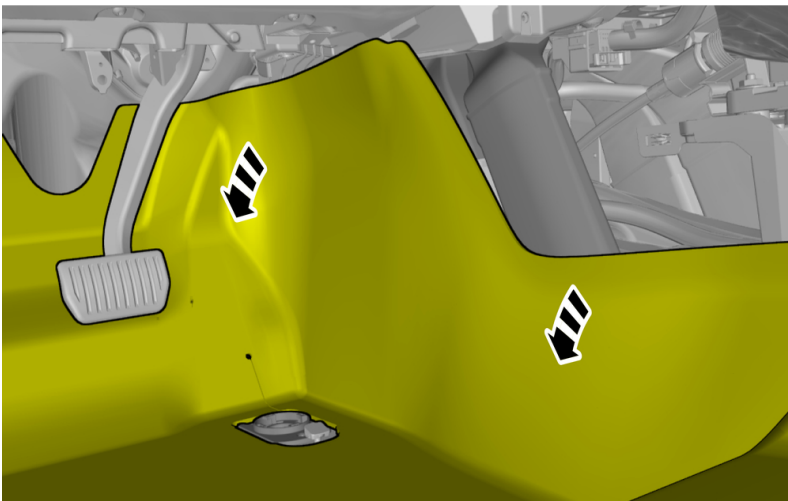

Remove the part carefully

Fold the carpet to the side.

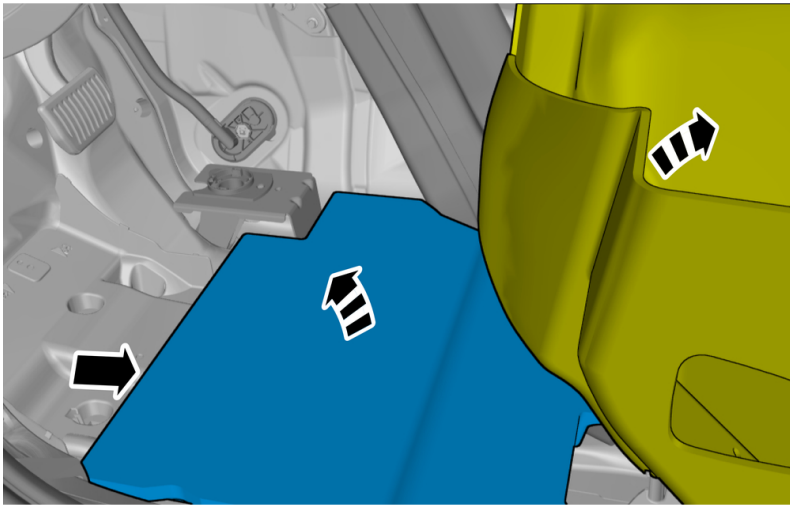

Caution! Make sure that the component is positioned correctly.

Fold the carpet to the side.
Remove the part carefully
Remove the marked part.

Check

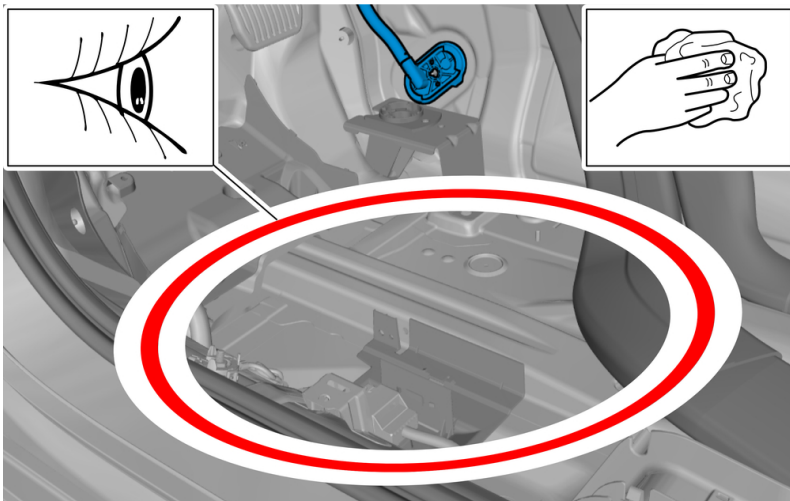

Note! Check for moisture in the area indicated.

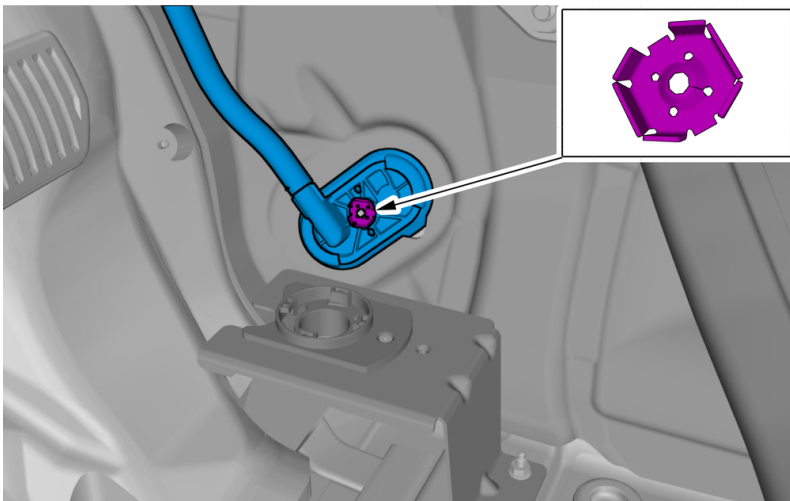

Remove the nut.

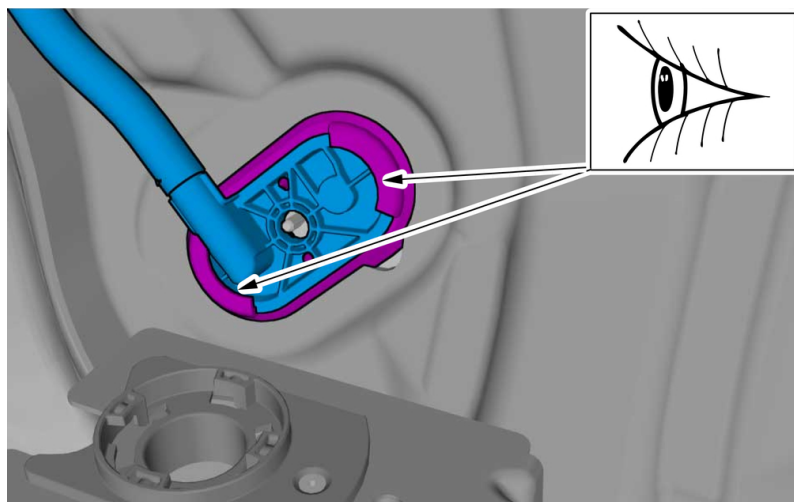

Caution! The grommet seal must rest on the metal surface, not on the carpet.

Note! Make sure that the seal is correctly located.

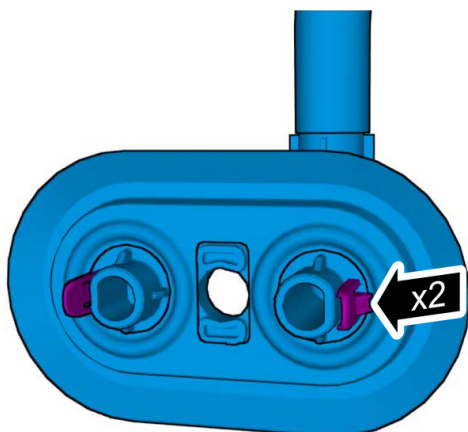

The graphic is just to show the back of the component and the location of the tabs. The component does not need to be removed if it is already correctly installed.



Check that the rubber grommet is not loose:
1 -First grab the hose connection and press inwards. 2 -Then pull outwards. 3 -Again push inwards.

If no faults are detected, to install, reverse the removal procedure.

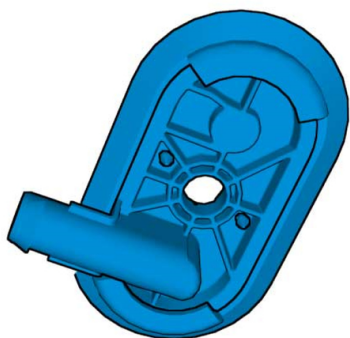

If the result of the checking procedure is not OK, the component must be replaced with a new component.