



Volvo Car Customer Service

TJ 31955

Title	Climate unit drain hose	Page	1 (10)
Action	Replacement	Operation number:	98636-3

Issue	Date	Reason
1	2016-09	First issue

Affected vehicles

Model year	Model
2017	S90 (17-)
2016, 2017	XC90 (16-)

Materials

Materials	Qty.	Part No.	Notes
Draining hose	1.0	31455693	XC90 - LHD - DRIVER SIDE;
Draining hose	1.0	31455694	XC90 - LHD - PASSENGER SIDE;
Draining hose	1.0	31390488	S90 - LHD - DRIVER SIDE;
Draining hose	1.0	31390489	S90 - LHD - PASSENGER SIDE;

Orientation view



XC90



S90



V90

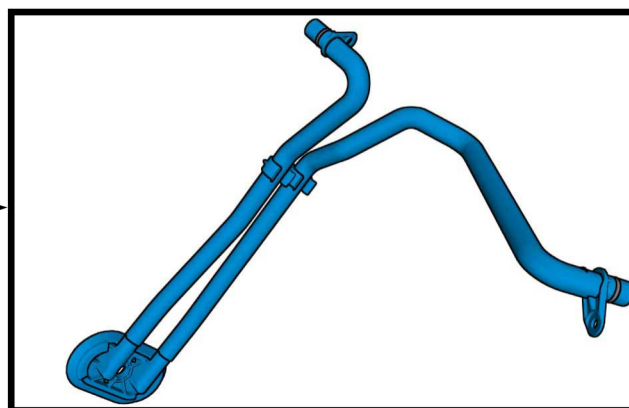
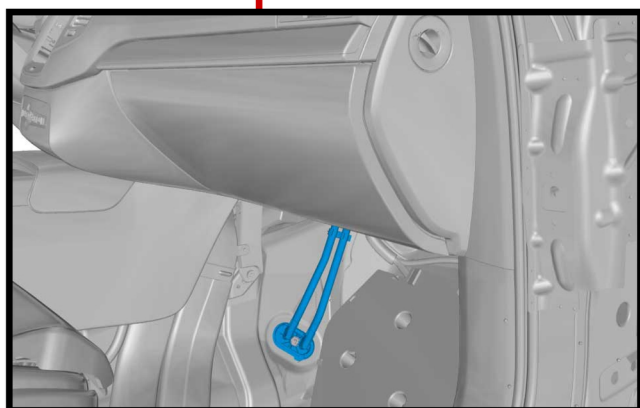

Color symbols

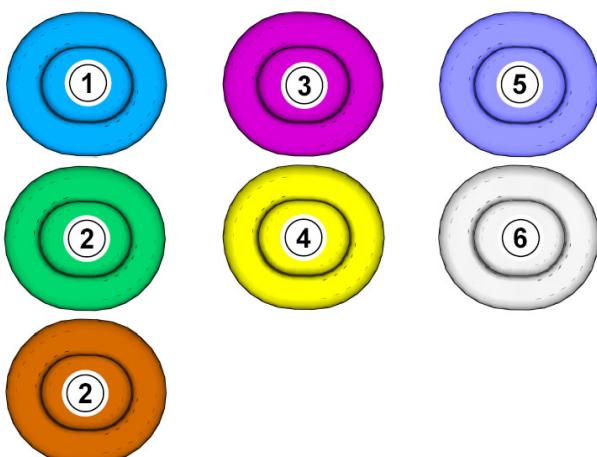

Note! This colour chart displays (in colour print and electronic version) the importance of the different colours used in the images of the method steps.

- 1 . Used for focused component, the component with which you will do something.
- 2 . Used as extra colors when you need to show or differentiate additional parts.
- 3 . Used for attachments that are to be removed/installed. May be screws, clips, connectors, etc.
- 4 . Used when the component is not fully removed from the vehicle but only hung to the side.
- 5 . Used for standard tools and special tools.
- 6 . Used as background color for vehicle components.

Applies to the passenger side

Removal

Remove the part carefully

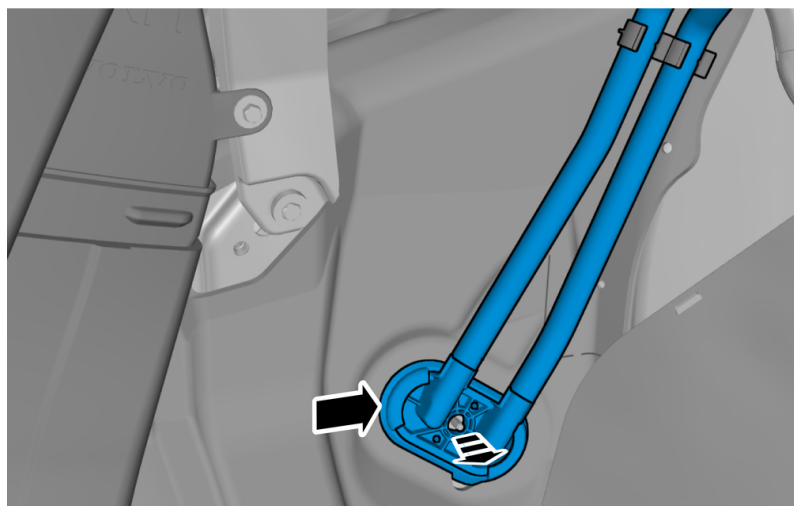

Note! Use suitable paper to absorb any escaping fluid.

Undo the hoses from the connections.
Remove the marked part.

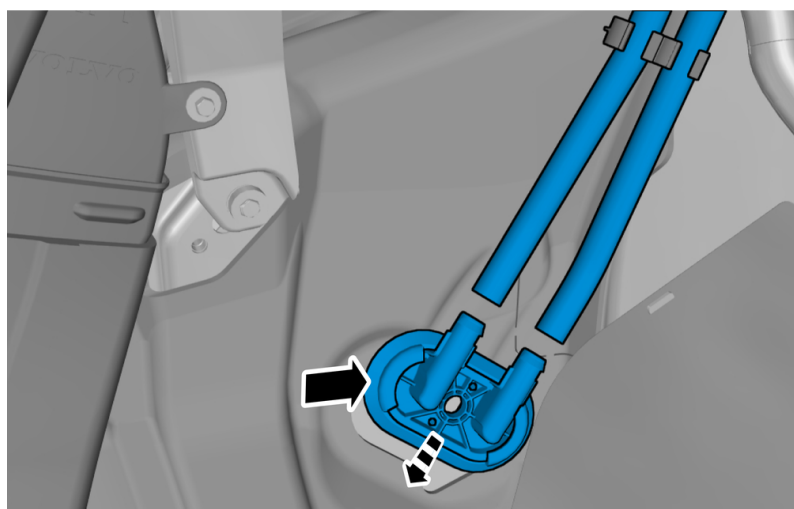

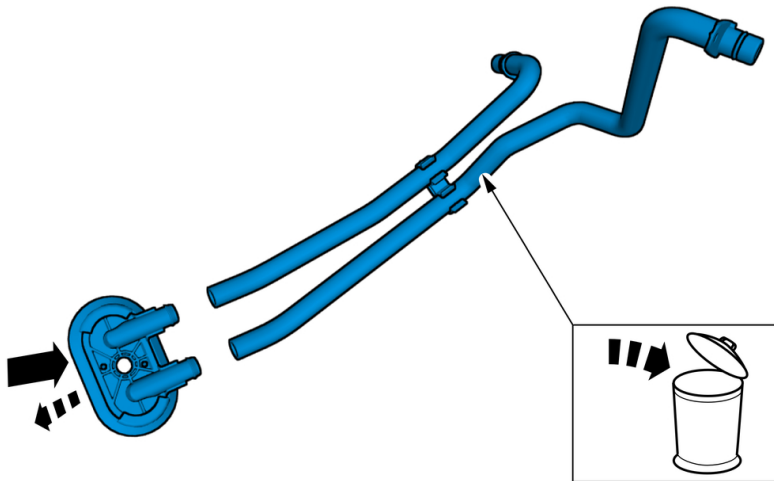
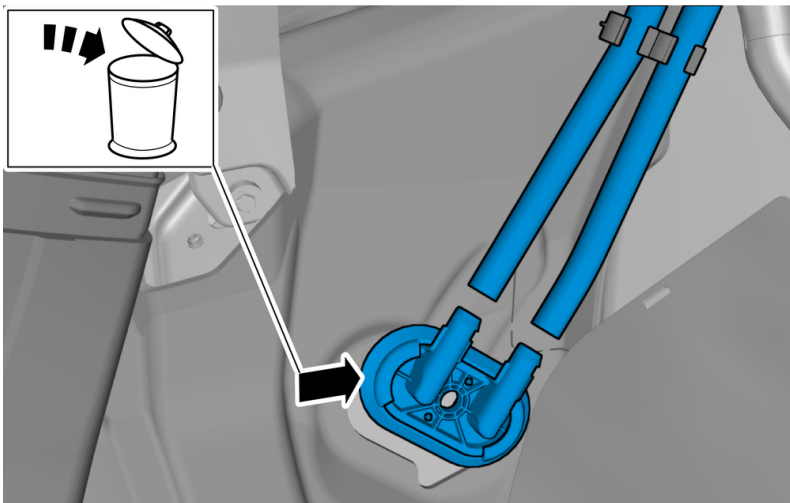

Make sure to replace the marked component with a new.
Undo the hoses from the connections.
Remove the marked part.

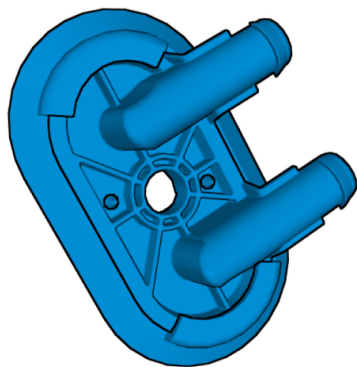

Use the marked component only.

Check

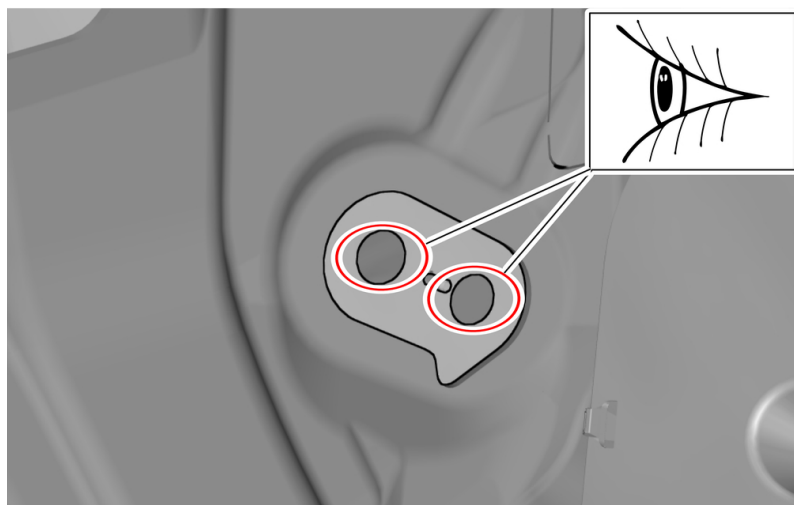

Caution! Make sure that the area indicated is flat and free from damages.

Installation

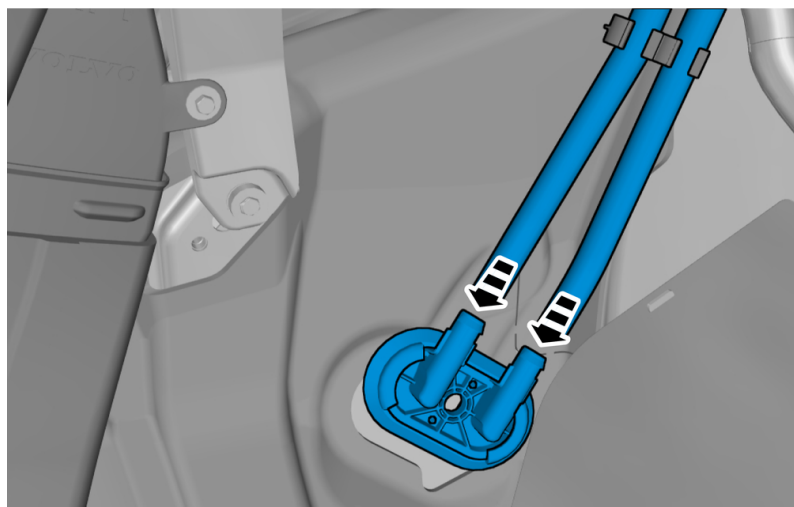

Note! Use soap solution.

Install the hoses.

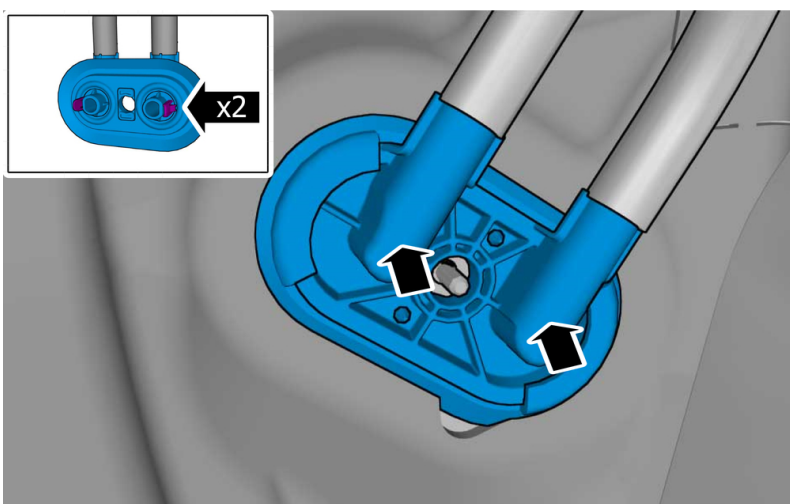

Caution! The grommet seal must rest on the metal surface, not on the carpet.

Caution! Be careful not to damage the catches.

Install the marked component.
Press the marked component.

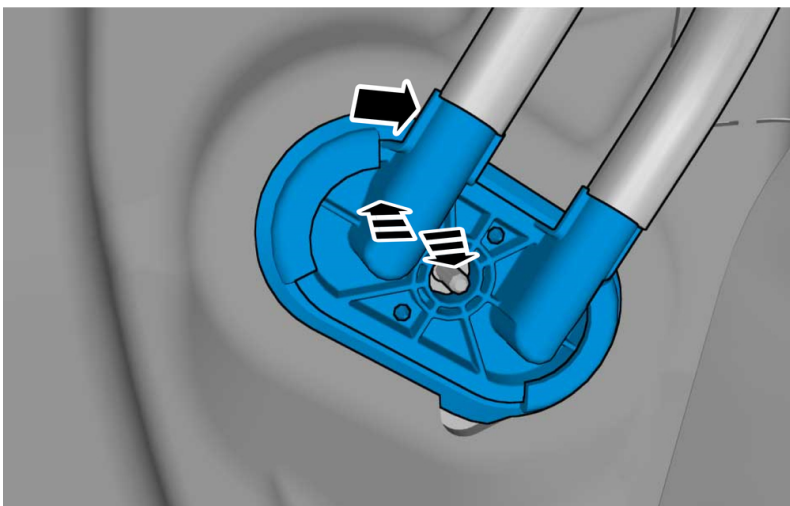

Check that the rubber grommet is not loose:
1 -First grab the hose connection and press inwards. 2 -Then pull outwards. 3 -Again push inwards.

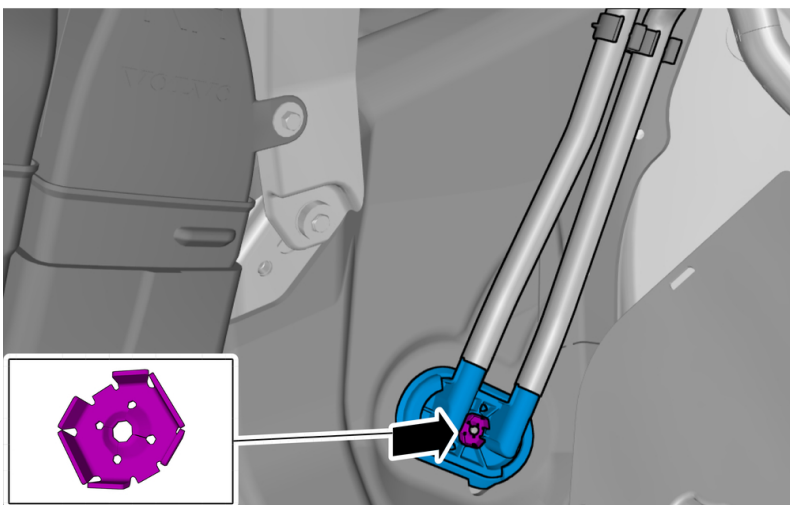

Note! Make sure that the seal is correctly located.

Install the nut.

To install, reverse the removal procedure.

Applies to the driver's side

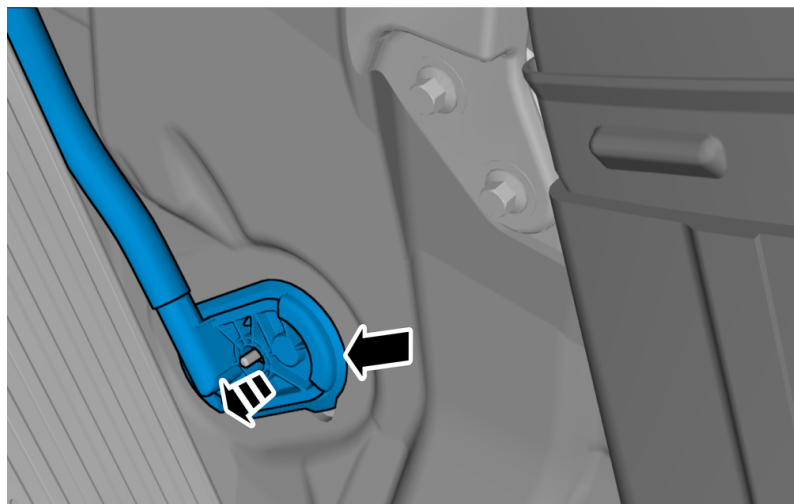
Removal

Remove the part carefully

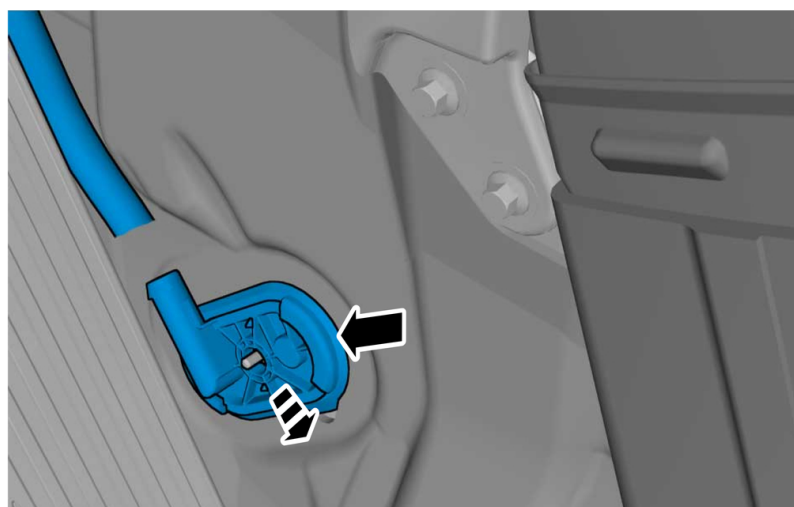
**Note! Use suitable paper to absorb any escaping fluid.**Undo the hose from the connection.
Remove the marked part.

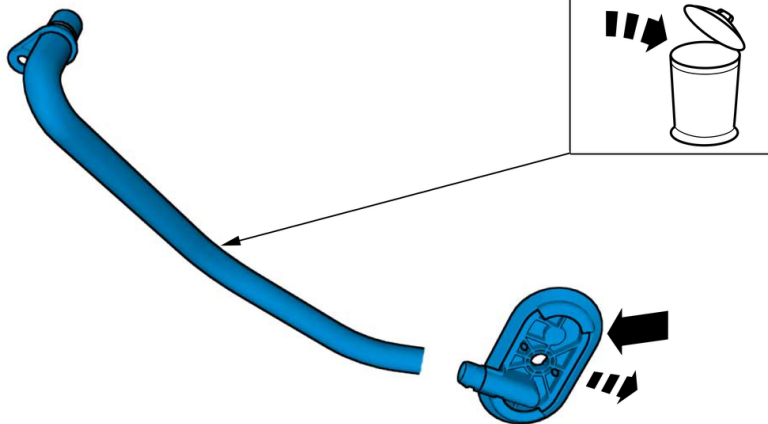
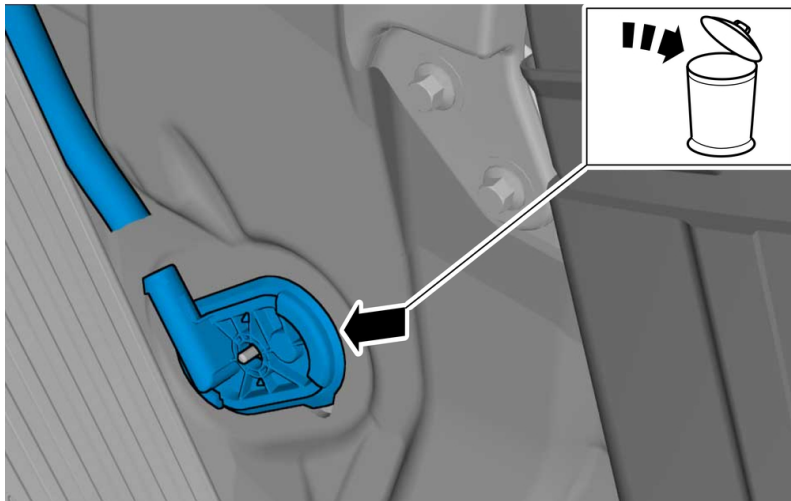

Make sure to replace the marked component with a new.
Undo the hose from the connection.
Remove the marked part.

Use the marked component only.

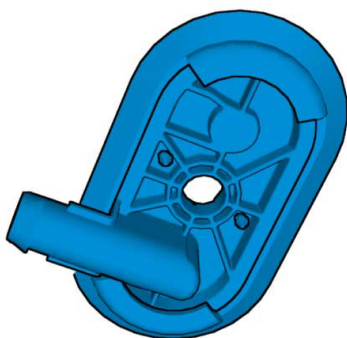

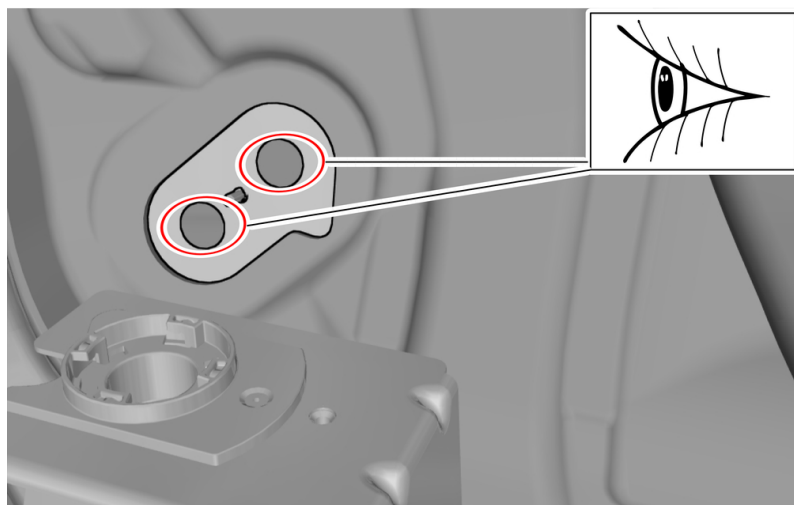
Check

Caution! Make sure that the area indicated is flat and free from damages.

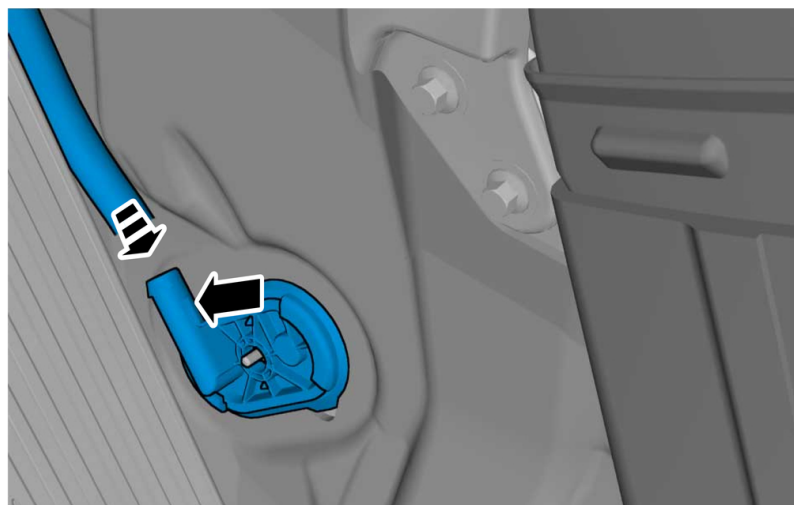
Installation

Note! Use soap solution.

Install the hose.

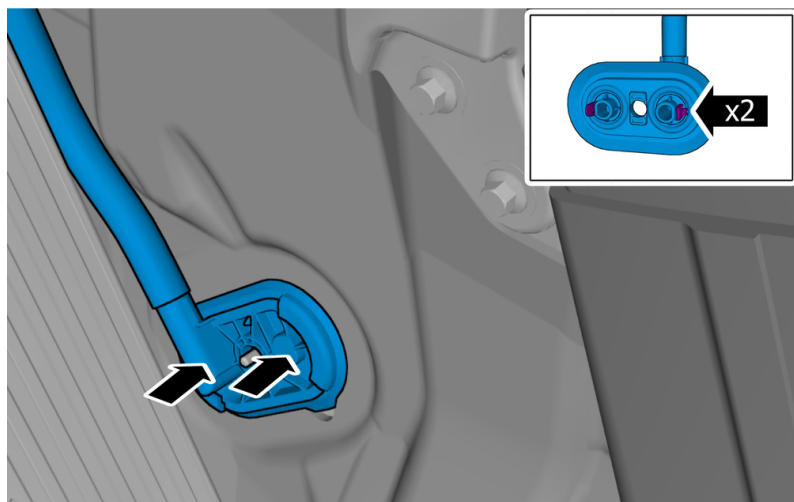

Caution! The grommet seal must rest on the metal surface, not on the carpet.

Caution! Be careful not to damage the catches.

Install the marked component.
Press the marked component.



Check that the rubber grommet is not loose:
1 -First grab the hose connection and press inwards. 2 -Then pull outwards. 3 -Again push inwards.

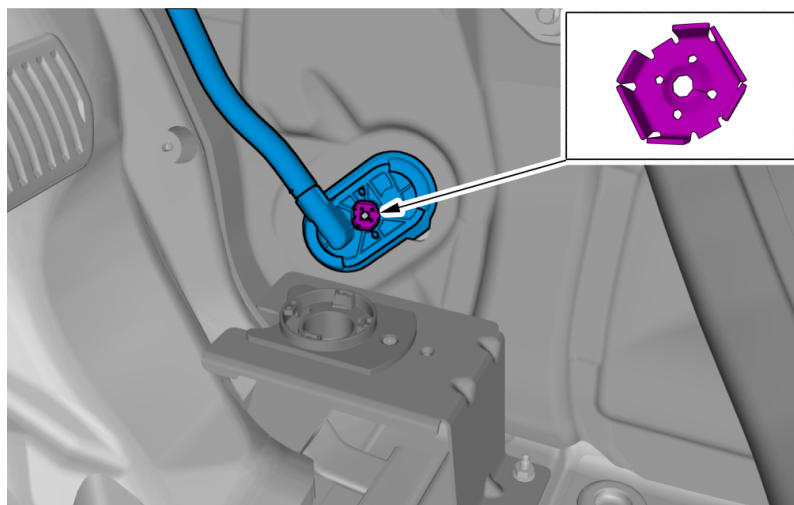

Note! Make sure that the seal is correctly located.

Install the nut.

To install, reverse the removal procedure.