

MANDATORY SERVICE RECALL

RECALL NO: 2015APR22.RC-001
 SUBJECT: TRAILER COMPLETE
 HARDWARE REPLACEMENT
 MODEL(S): SELECT 2015 TRAILERS

CONDITION

Recent testing on the swing tongue system used in our trailers indicated that some of the material properties of the bolt are under specification and the bushing is incorrect. This condition can potentially lead to the bushing and the bolt breaking which causes the swing tongue system to become ineffective and may result in some loss of vehicle control. This is a registered DOT recall and needs your immediate attention.

CONCLUSION

All 2015 trailers identified in the list that will be provided to you separately by MasterCraft are considered 'suspect' to the aforementioned condition and require a pivot bolt replacement. The pivot bolt sent will be certified Grade 5 without a drilled grease hole, and the bronze bushing will be replaced with a painted steel bushing. Pull pins will be replaced with certified diameter pull pins.

PART REQUIRED

4" Frame Repair Kit

MasterCraft Part Number 650713
 Supplied by Vendor via MasterCraft

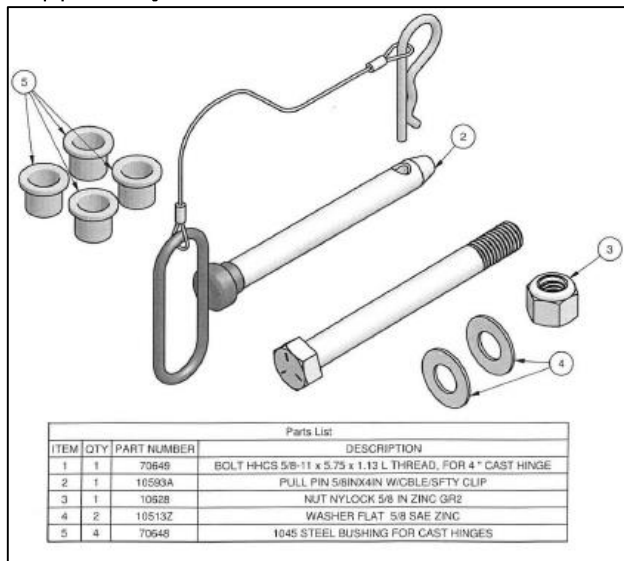

OR

5" Frame Repair Kit

MasterCraft Part Number 650715
 Supplied by Vendor via MasterCraft

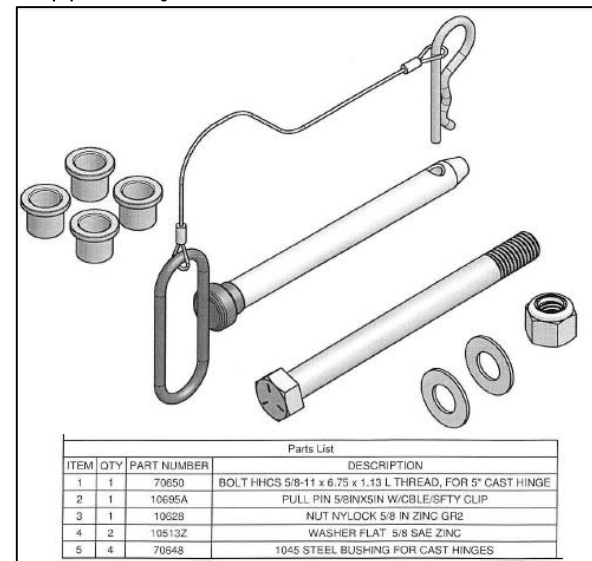

TOOLS REQUIRED

Repair Tool Kit

- Hammer
- 15/16" Sockets - 2 each
- Adjustable Wrench
- Torque Wrench - capable of applying 110 - 120 ft. lbs.
- ½" Drive Ratchet - 2 each
- ½" 12 pt socket - ½" drive - 1 each (used to drive tap)
- Pliers
- Grease to apply to new bolt and pin
- MasterCraft Part Number 650714 (Supplied by Vendor via MasterCraft)

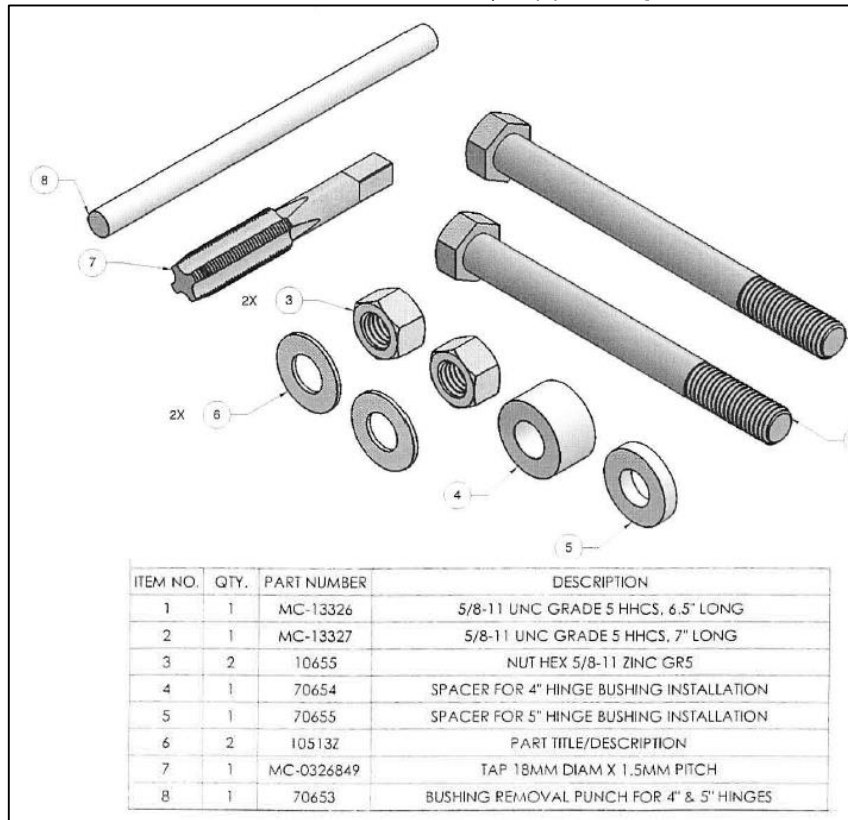

HARDWARE REPLACEMENT

Estimated time to complete: 0.25 hours

Labor Code 9015015

Instructional Video Link: <https://vimeo.com/user27464834/review/125577455/105602a016>

Removal of Original Bushings from Pull Pin Side of Casting:

1. Remove pull pin from cast hinge block and swing tongue to fully open position
2. Position supplied 18mm tap into top of the upper bushing.
3. Use hammer to seat the tap approximately 1/8" into the center of the bronze bushing. Tap lightly to prevent damage to the tap.
4. Using the ½" 12 pt socket, ½" drive ratchet, turn the 18mm tap 5 revolutions in a clockwise direction to thread the tap into the bushing.
5. Insert the supplied punch through the bottom bushing to make contact with the underside of the 18mm tap.
6. Using the hammer, lightly tap the punch to push the bushing out of the cast hinge block.
7. To remove the tap from the bushing, use the pliers to hold the bushing, and use the ½" 12 pt socket and ratchet once the bushing has been cleared from the cast hinge block.
8. Use the same process to remove the lower bushing from the cast hinge block.

Installation of New Bushings in Pull Pin Side of Casting:

9. Using the supplied repair tool kit, put one washer on the installation bolt.
10. Insert the bolt through a steel bushing. Verify that the flange of the bushing is upward.
11. Insert the installation bolt into the cast hinge block. Note that the steel bushing will remain on top of the cast hinge block until pressed into the block.
12. Hammer the top of the bolt until bushing is seated to casting.
13. Remove the bolt and washer and put second bushing on bolt and insert through the bottom of the casting upward.
14. Hammer the top of the bolt until bushing is seated to casting.
15. Remove the bolt and washer from the bushing.
16. Swing the tongue to the closed position.
17. Apply a thin layer of grease to the new pull pin and install into the swing tongue.

Removal of Original Bushings from Pivot Bolt Side of Casting:

18. Remove the pivot bolt from the opposite side of the cast hinge block.
19. Remove the upper and lower bushings using the same method as outlined in Steps 2-8 above.

HARDWARE REPLACEMENT cont'd

Installation of New Bushings in Pivot Bolt Side of Casting:

20. Install the new upper and lower bushings using the same method as outlined in Step 9-15 above.
21. Apply a thin layer of grease to the new pivot bolt.
22. Install the new pivot bolt, washers and Nylock nut into the bushings.
23. Place 15/16" socket or wrench on top of pivot bolt. Place the torque wrench with 15/16" socket on Nylock nut. Tighten until 110 - 120 ft. lbs. of torque applied to Nylock nut. **DO NOT TORQUE DOWN WITH AN IMPACT!!!**

AFFECTED TRAILER LIST

Each Product Support Representative will contact each dealer directly to supply the respective list of affected trailers that **REQUIRE REPAIR** related to this recall.